

BMD

E

O
R
E

G

DEVELOPMENT

CAN A MUSEUM BE MORE DOG?

BMD (Be More Dog/Brunel Museum Development) responds to the brief of reengineering Happiness within the Brunel Museum. The proposal delivers an inter-species public space, inviting a new type of audience to the museum.

Exploring positive qualities of dogs including sensitivity and comfortability, the space aims to strengthen, or further, evolve human-canine bonds. Elements of the space trigger human visitors to act more dog, challenging their levels of curiosity and sensitivity. Simultaneously, embracing spatial features to encourage interaction and a play of hierarchy between the two species, the proposed design aspires to enliven the community.



HUMAN PERSPECTIVE

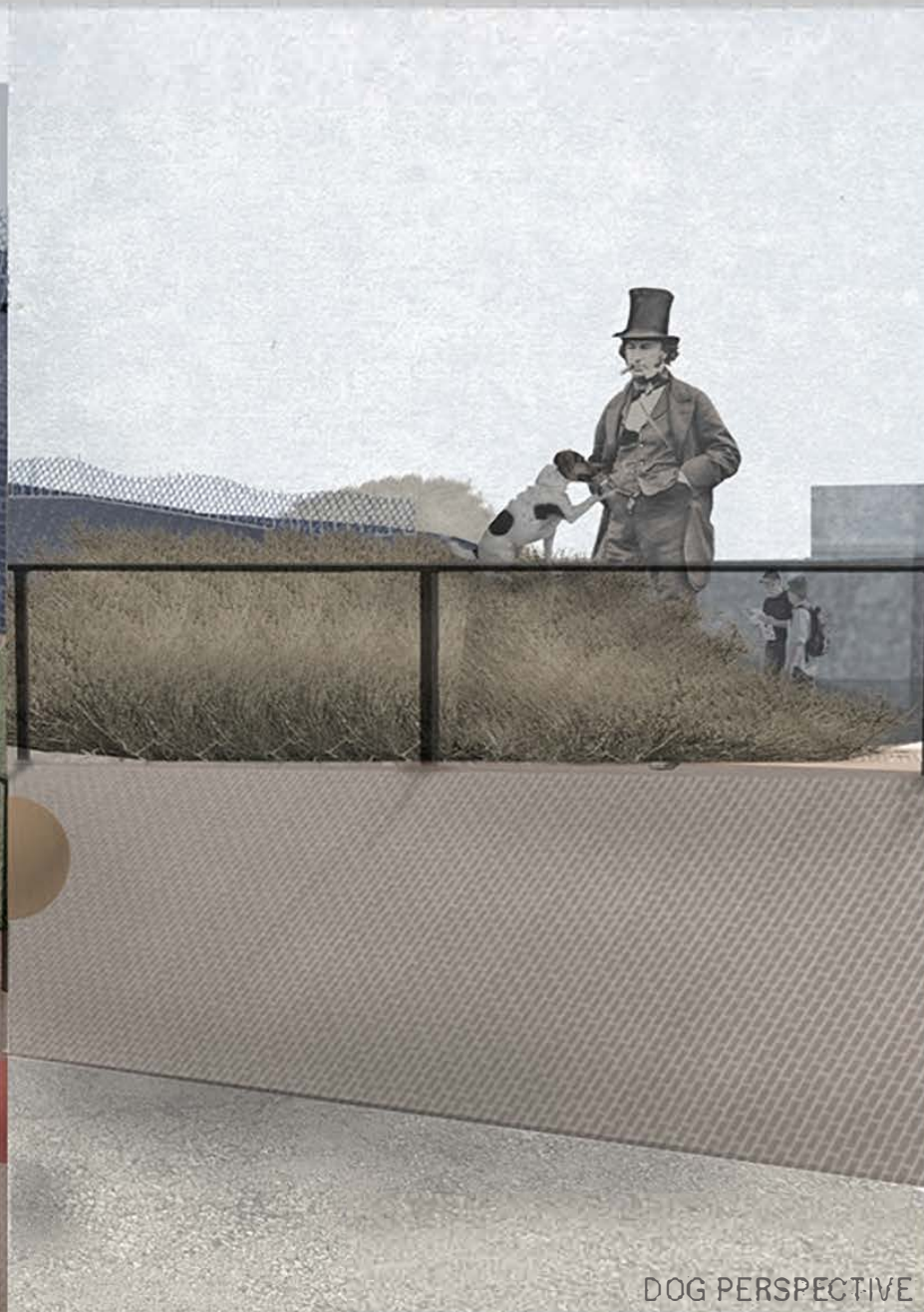

DOG PERSPECTIVE

• BMD •

CONTEXT

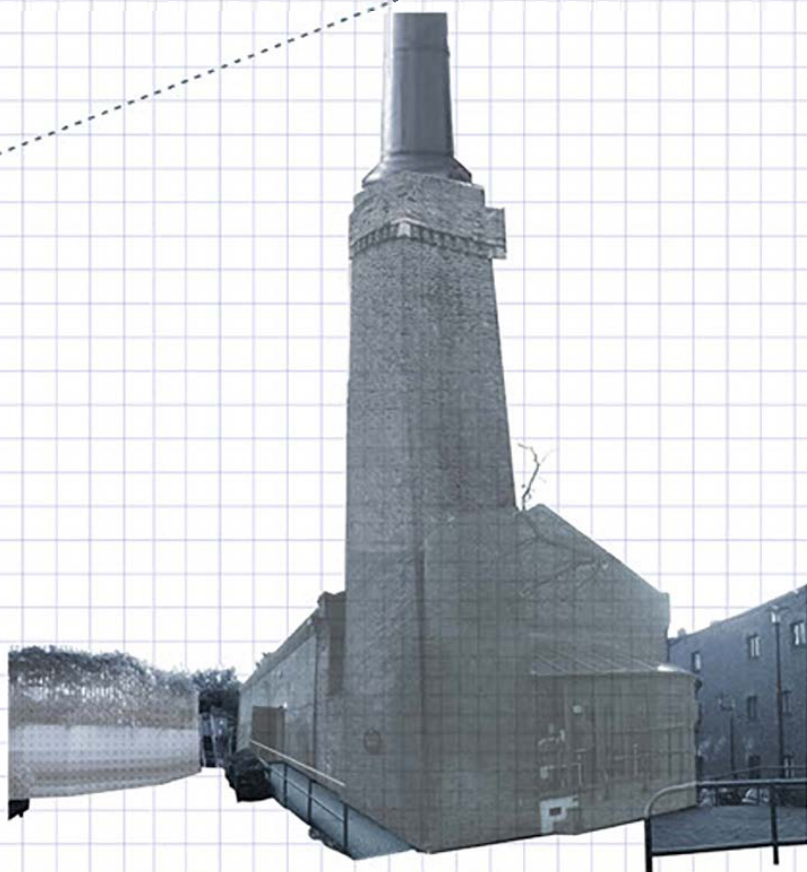
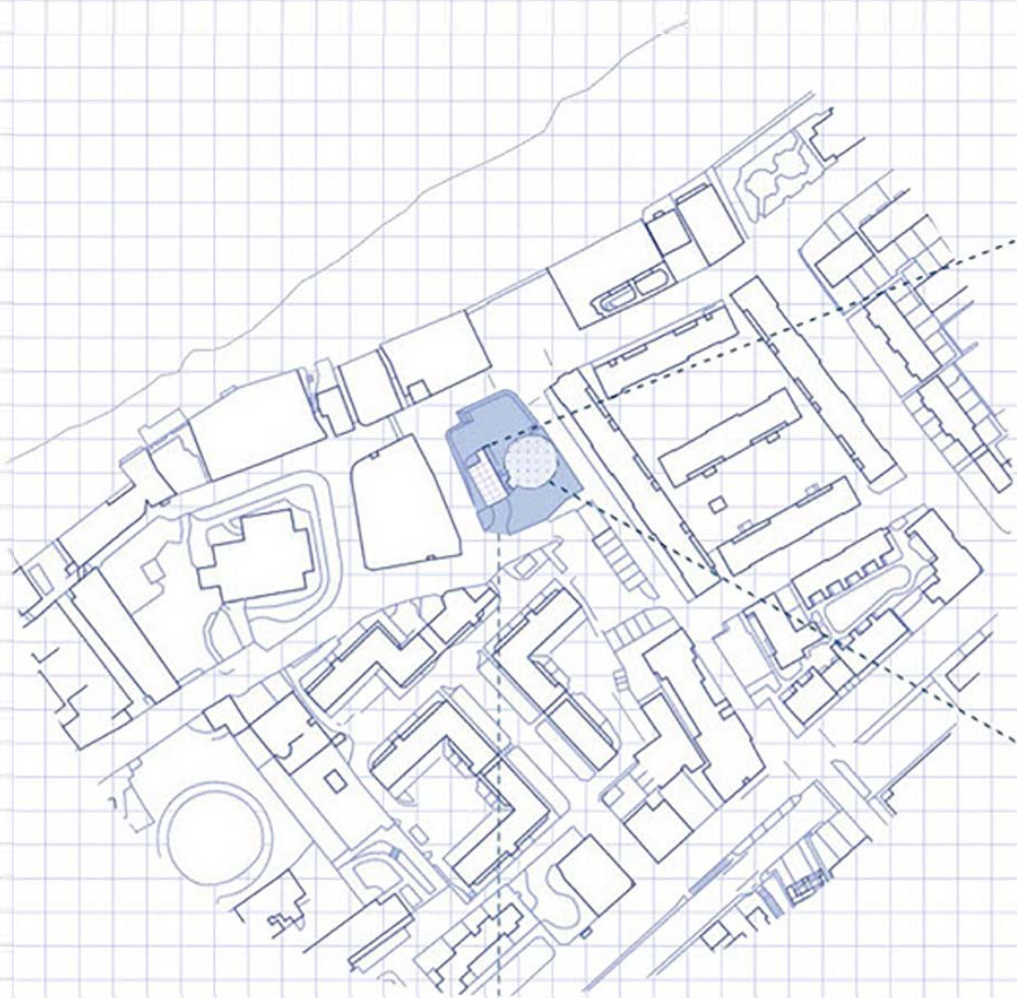
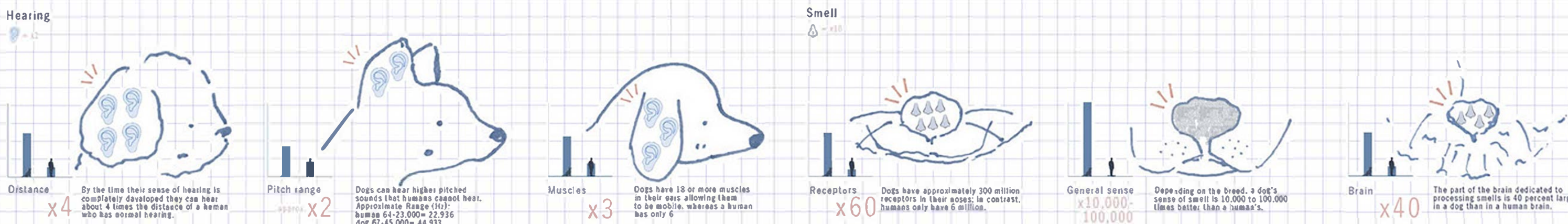

"Learn the art of being more dog." - ALISON DAVIES -

For decades, dogs have been offering friendship and obedience to their human partners. However, although the human-canine relationship is a very long-lasting symbiosis, we know that dogs have higher sensory abilities and are able to notice small details more than us. "Can we be more dog?" was a question that arose from this point, further evolving to the question, "Can a museum be more dog?"

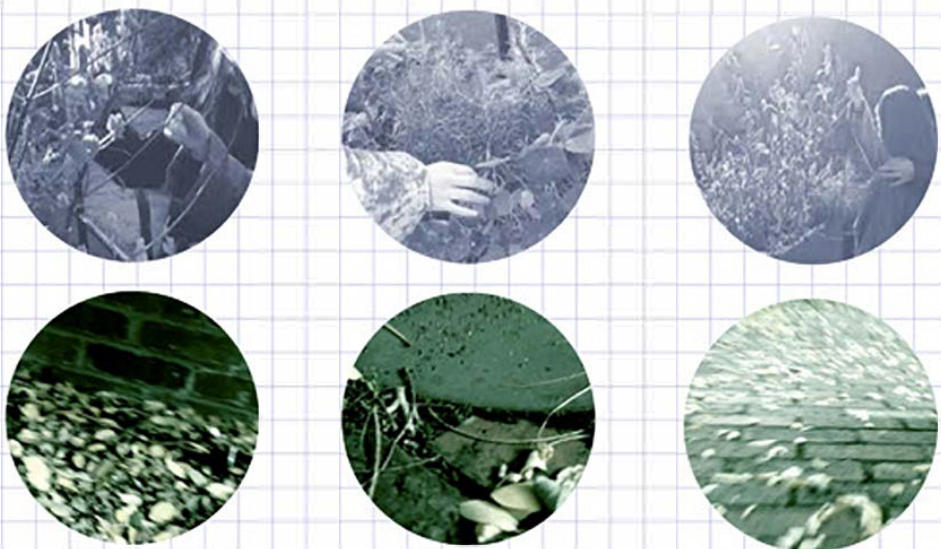

Site observation through dog vision and sensitivity, reviving forgotten senses. BLUE, being one of the strongest colours dogs can see with their dichromatic vision, is the predominant colour of most imagery in the following pages, as an aim for the project narrative to be experienced while "being more dog".

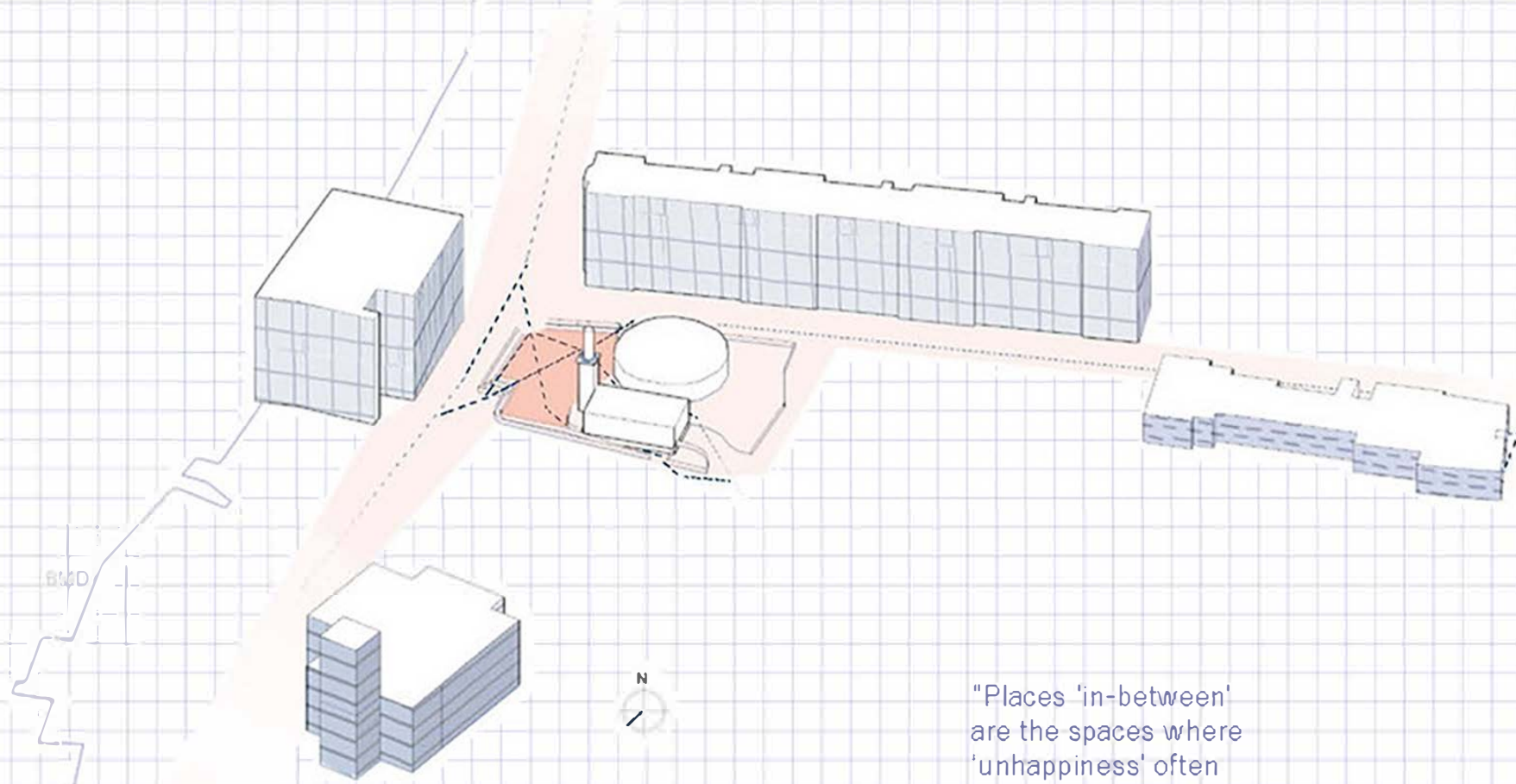

"Places 'in-between' are the spaces where 'unhappiness' often occurs." - KEITH BRADLEY -

Opportunities for happiness lie in the courtyard of the Museum, which acts as an "in-between" space of the area.

INTERACTION

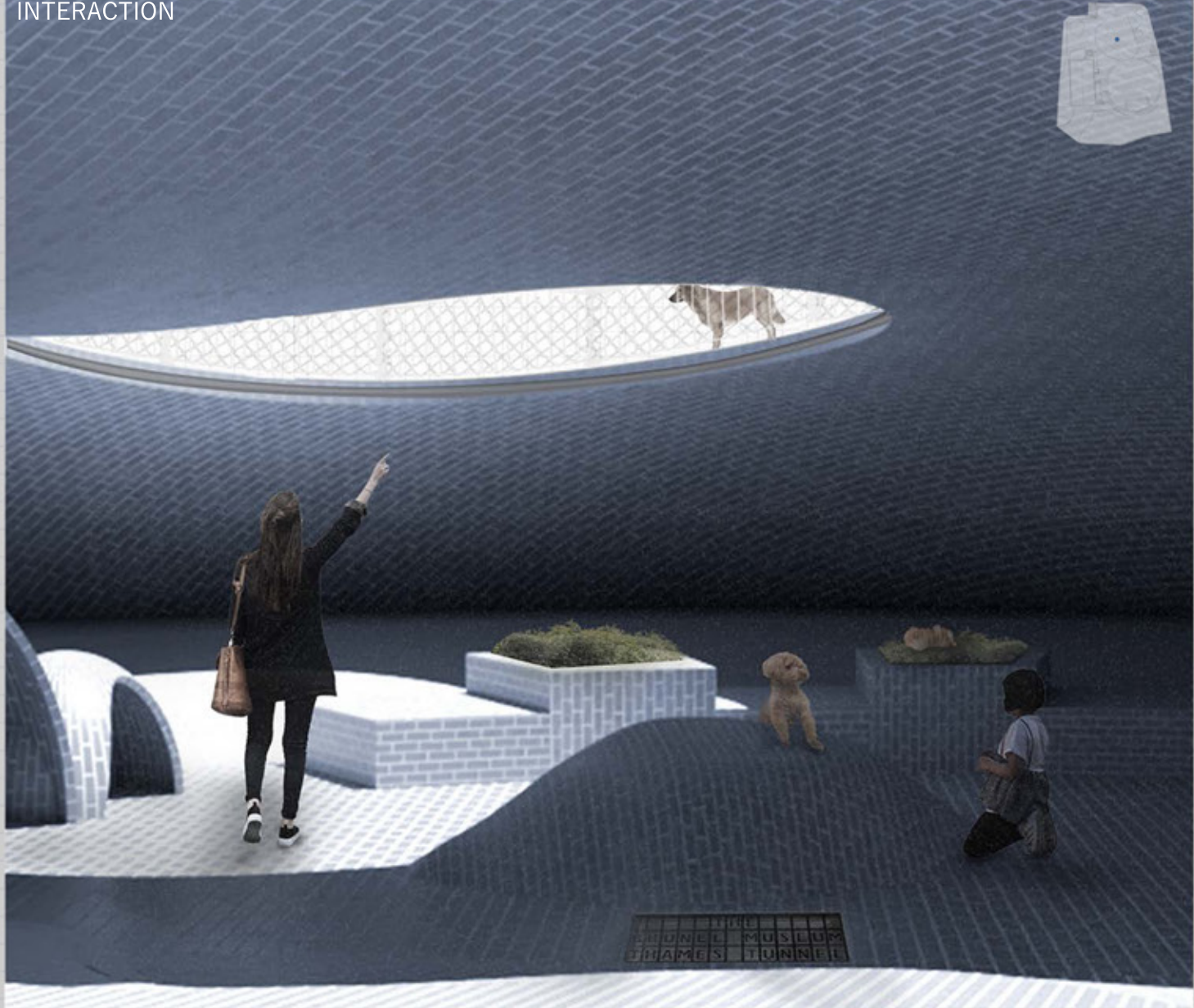

SMELL

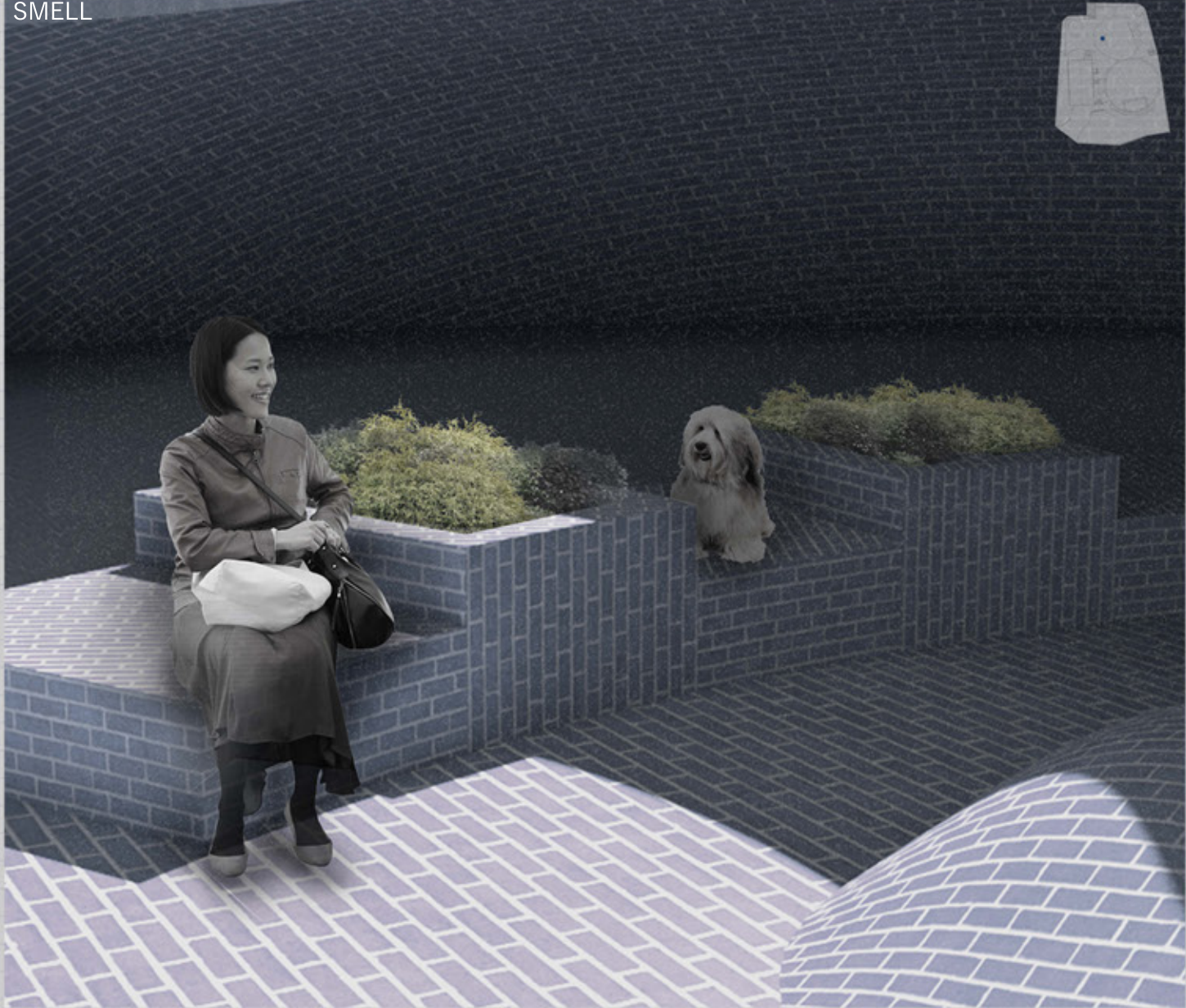

SOUND

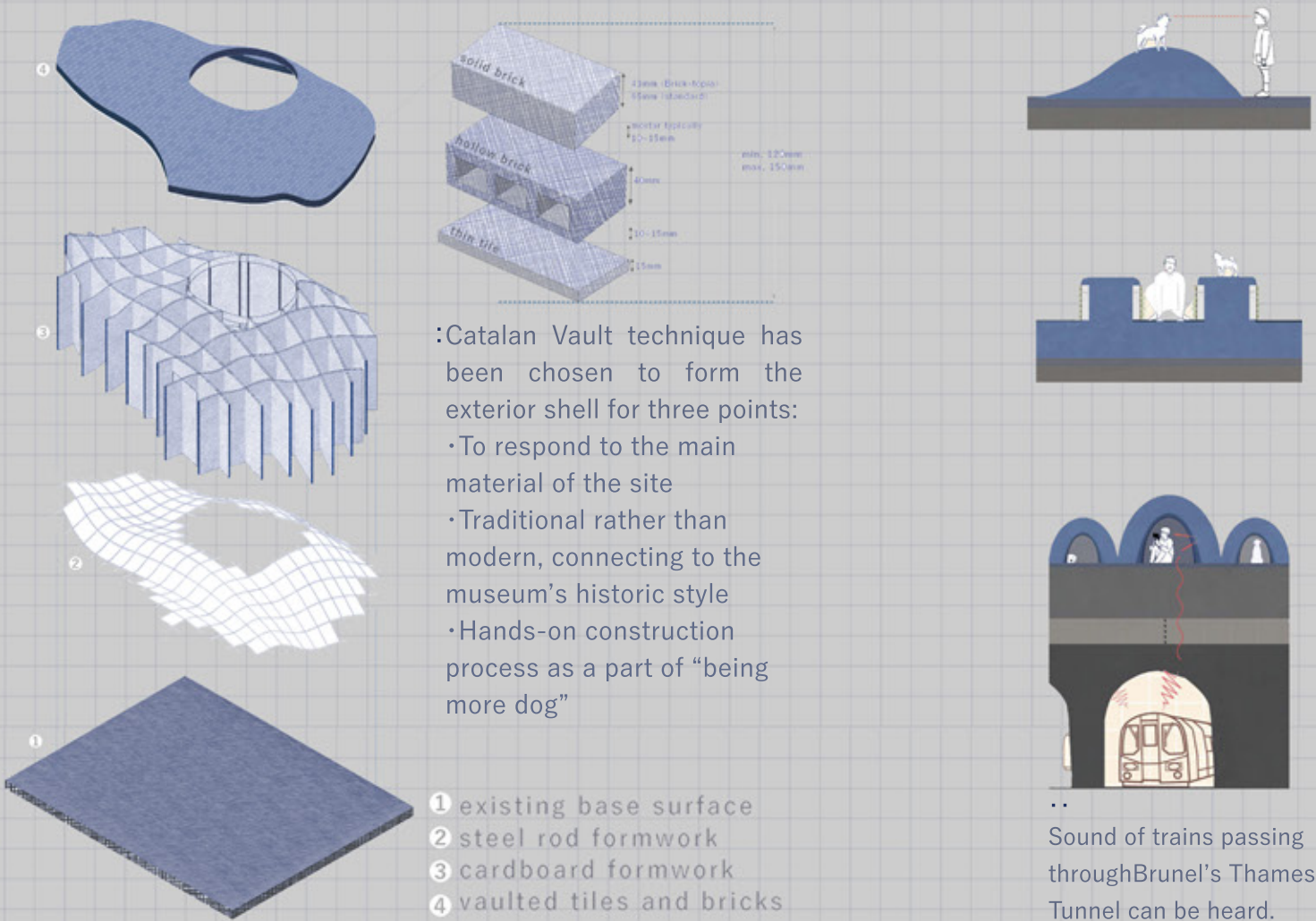
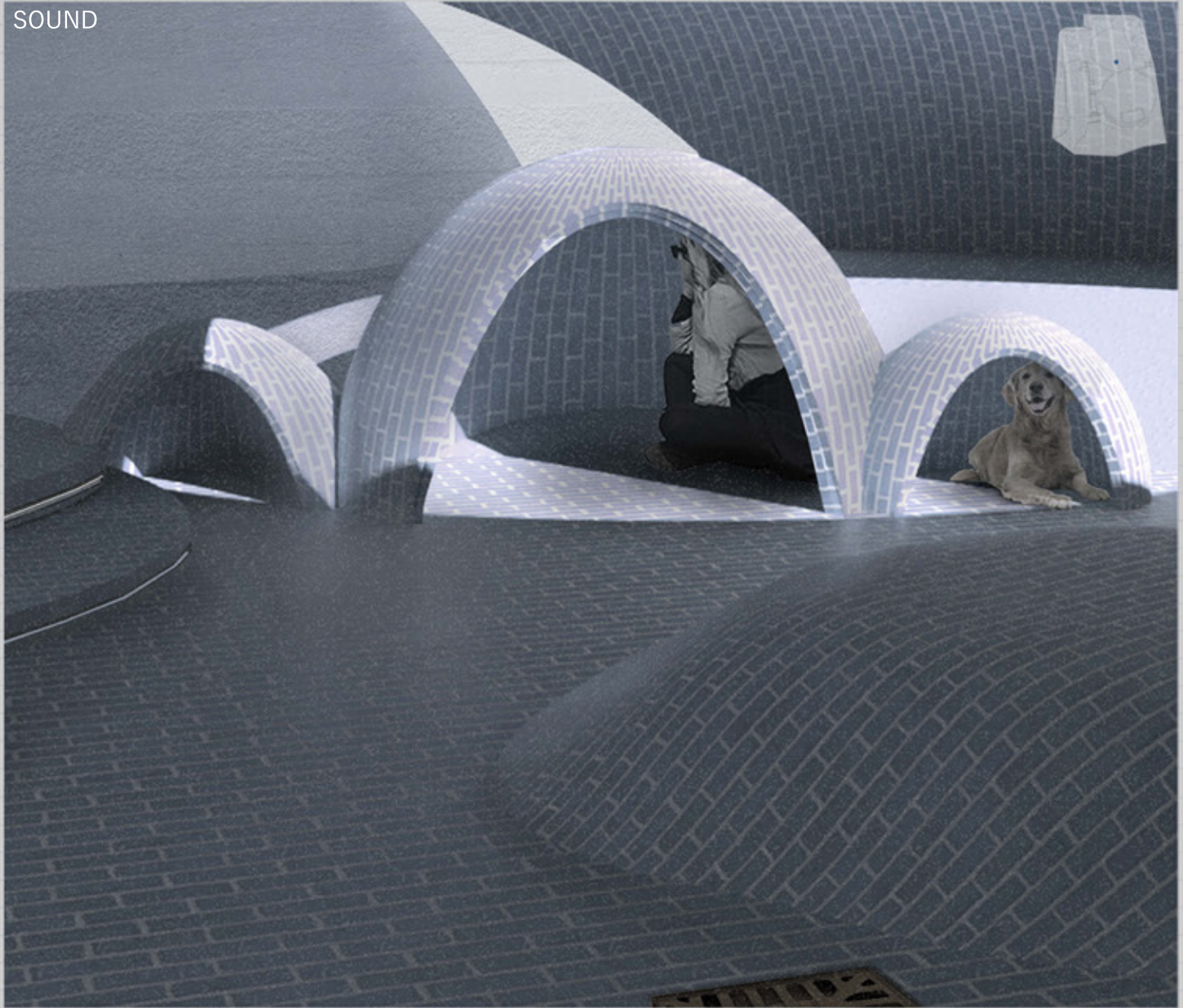

• BMD •

PROCESS

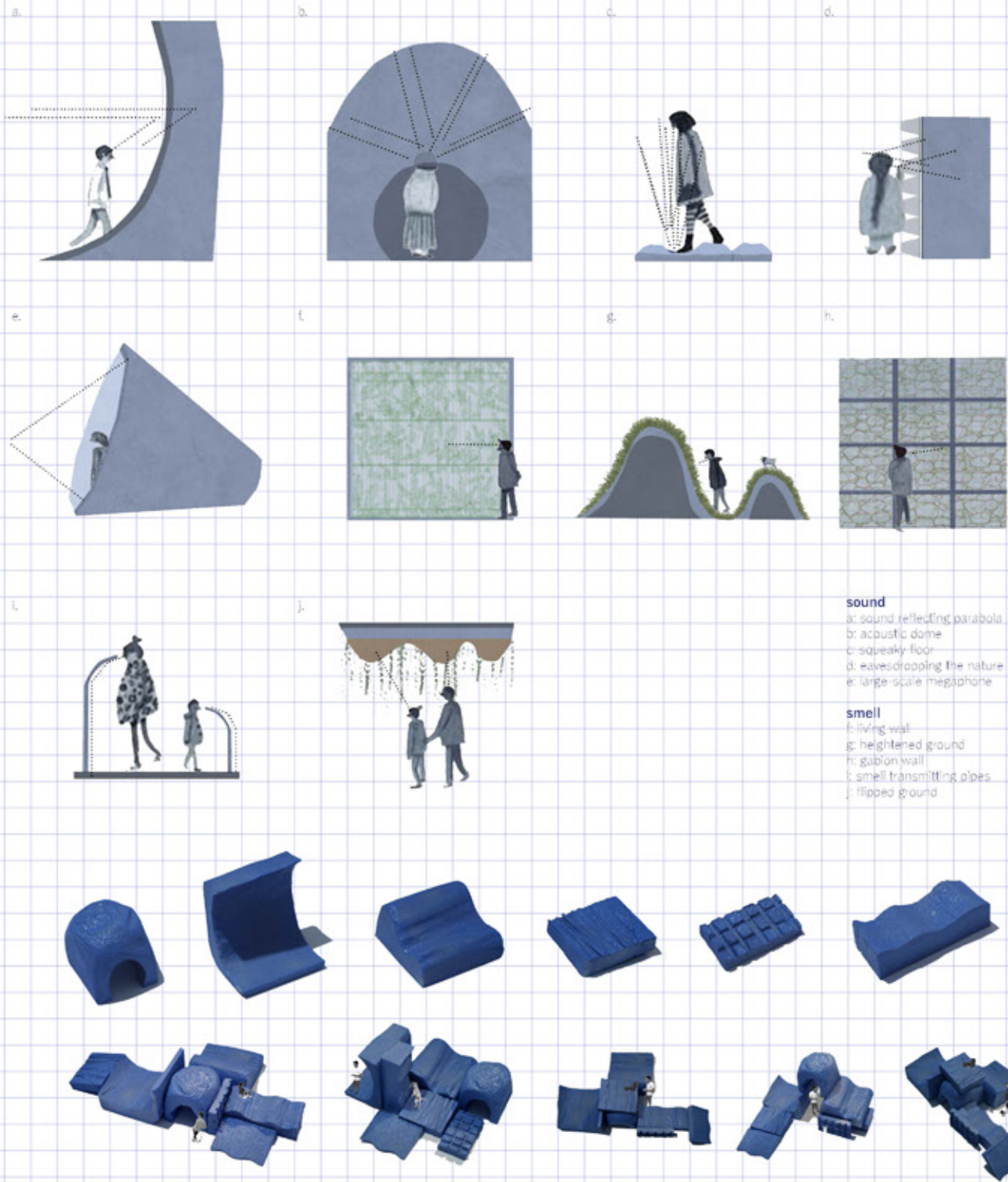
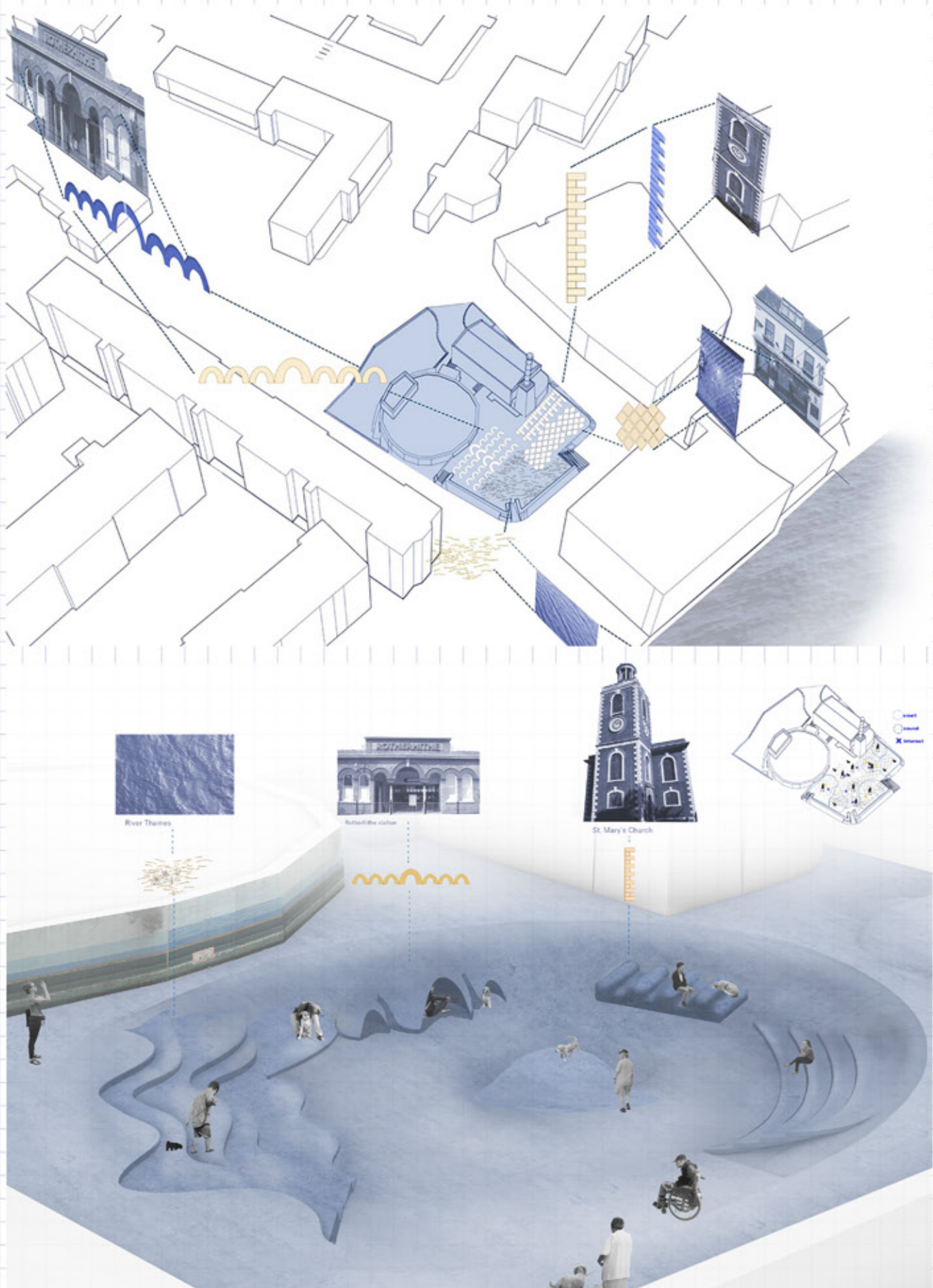

sound
a. sound reflecting parabola
b. acoustic dome
c. dog park
d. dog park
e. dog park
f. dog park
g. dog park
h. dog park
i. dog park
j. dog park

smell
a. dog park
b. dog park
c. dog park
d. dog park
e. dog park
f. dog park
g. dog park
h. dog park
i. dog park
j. dog park

:Dogs are advanced at sensing details. The proposal incorporates patterns from the surrounding neighbourhood, learning from their sensitivity, while visually connecting the community.

Exploring ideas to enhance senses of sound and smell for human users to experience dogs' capabilities/Prototype experiments to negotiate relationships between different elements.

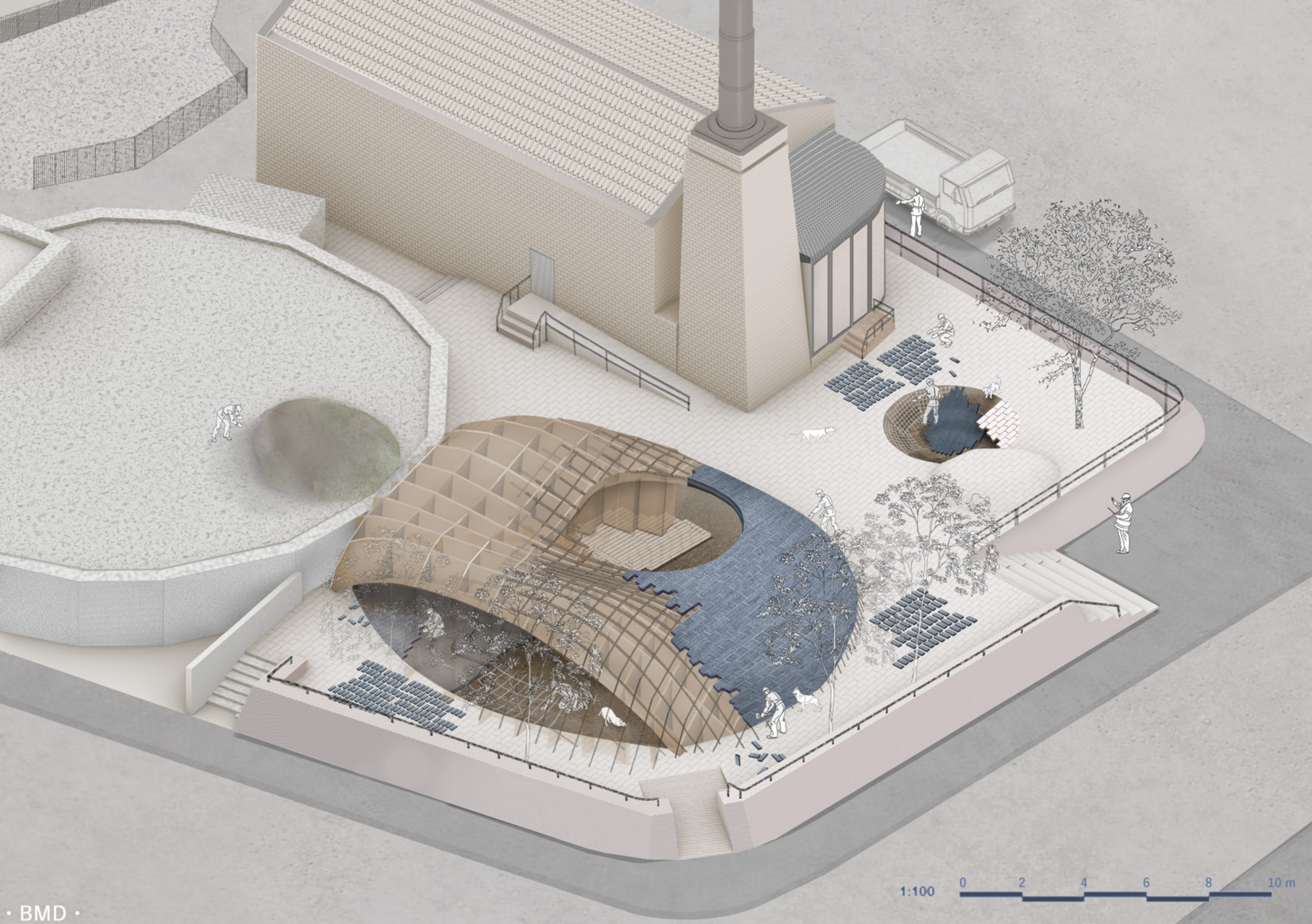

• BMD •

CONSTRUCTION

Phase A: shifting existing features

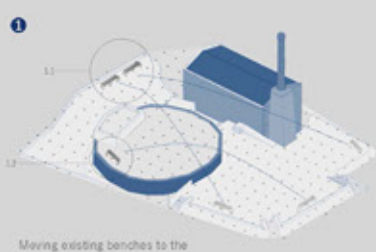

1. Moving existing benches to the rear garden and shift garden.



2. Royal Albert Railway Bridge bench placed by new railings, which also imitate the iconic bridge.



3. Other two benches shifted to rear garden to keep the site lively in all areas.

Phase C: constructing the vault

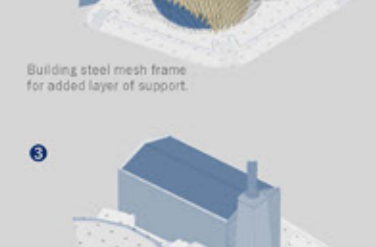
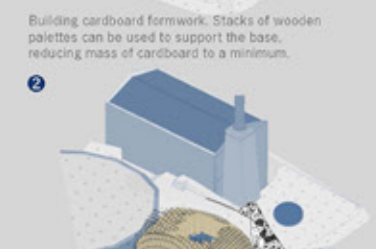

Phase B: constructing the underground

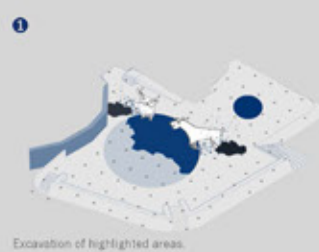

1. Excavation of highlighted areas.

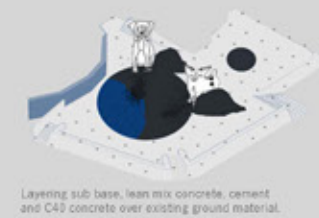

2. Layering sub base, lean mix concrete, cement and C40 concrete over existing ground material.

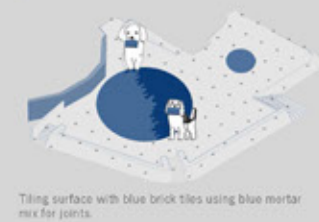

3. Tiling surface with blue brick tiles using blue mortar mix for joints.

Phase D: constructing new greenery

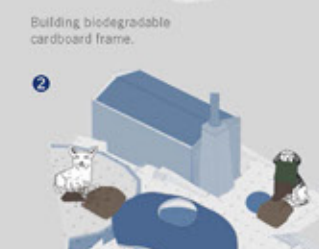

Brick vault

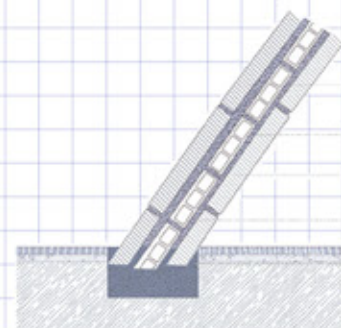

A- Existing ground material
B- Existing ground surface
C- Natural fast-setting cement
D- Cement mortar
E- Handmade tile
F- Hollow brick
G- Solid brick

Railing

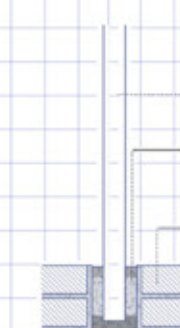

A- Fiberglass handrail
B- Anchoring cement
C- 1

LED lighting

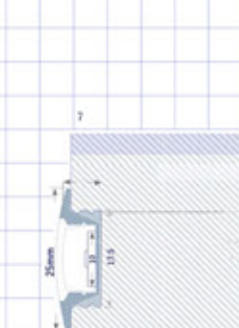

A- Profile
B- LED strip
C- 1

Underground surface

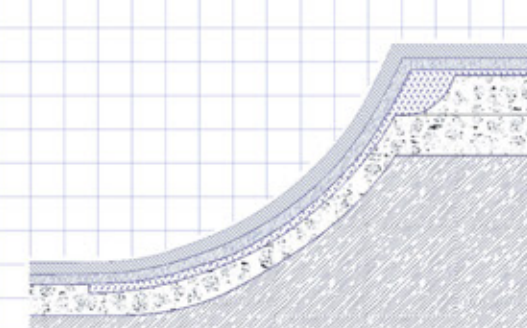

A- Existing ground material
B- Mot Type 1 sub base
C- Lean mix concrete
D- C40 concrete
E- Brick tiles, mortar joint

Drainage

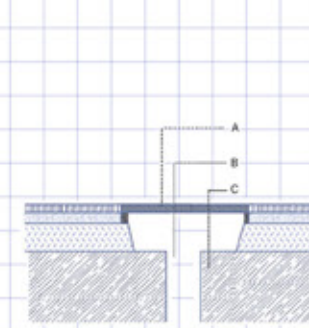

A- Drain cover
B- Drain pipe
C- 1

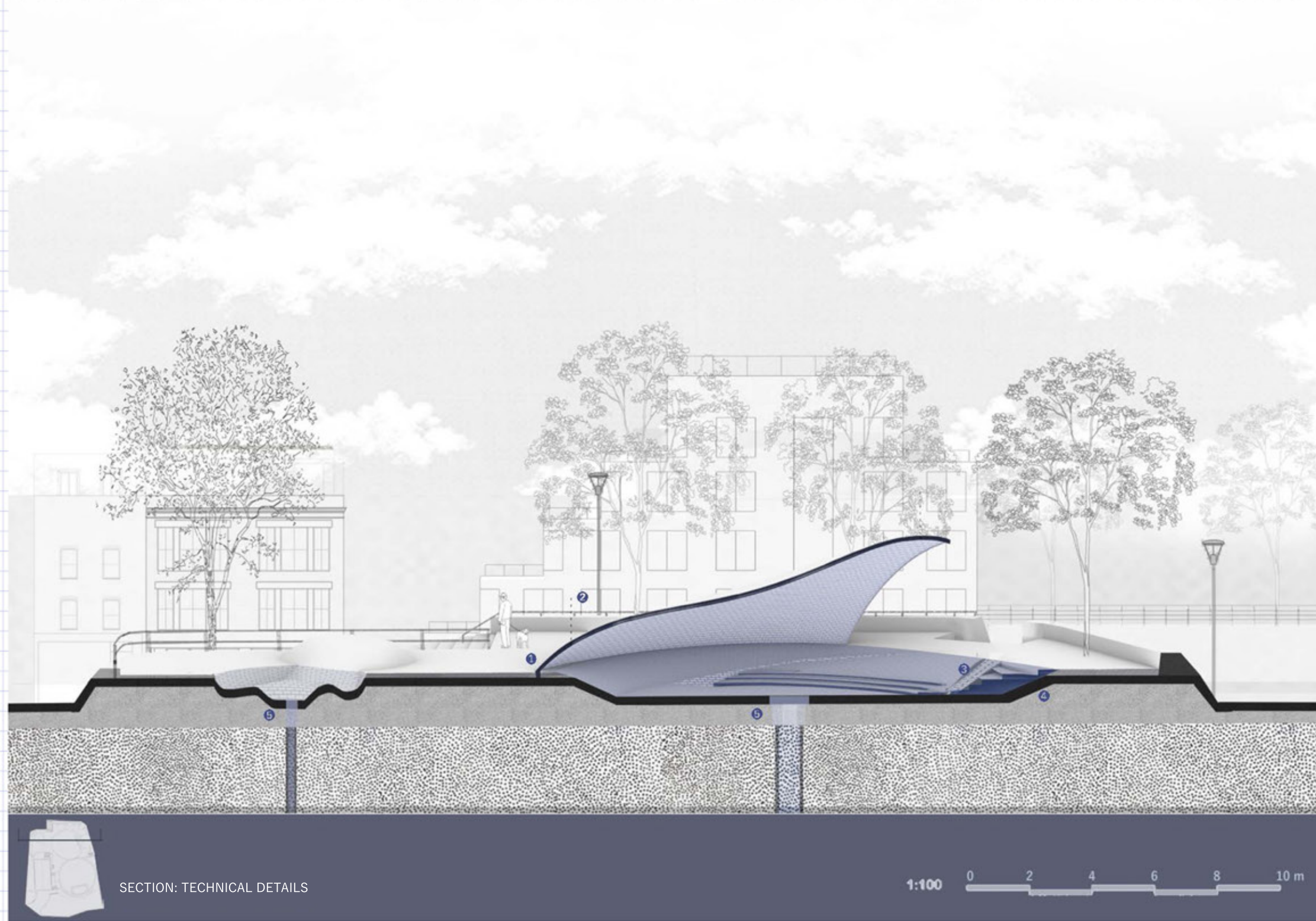

SECTION: TECHNICAL DETAILS

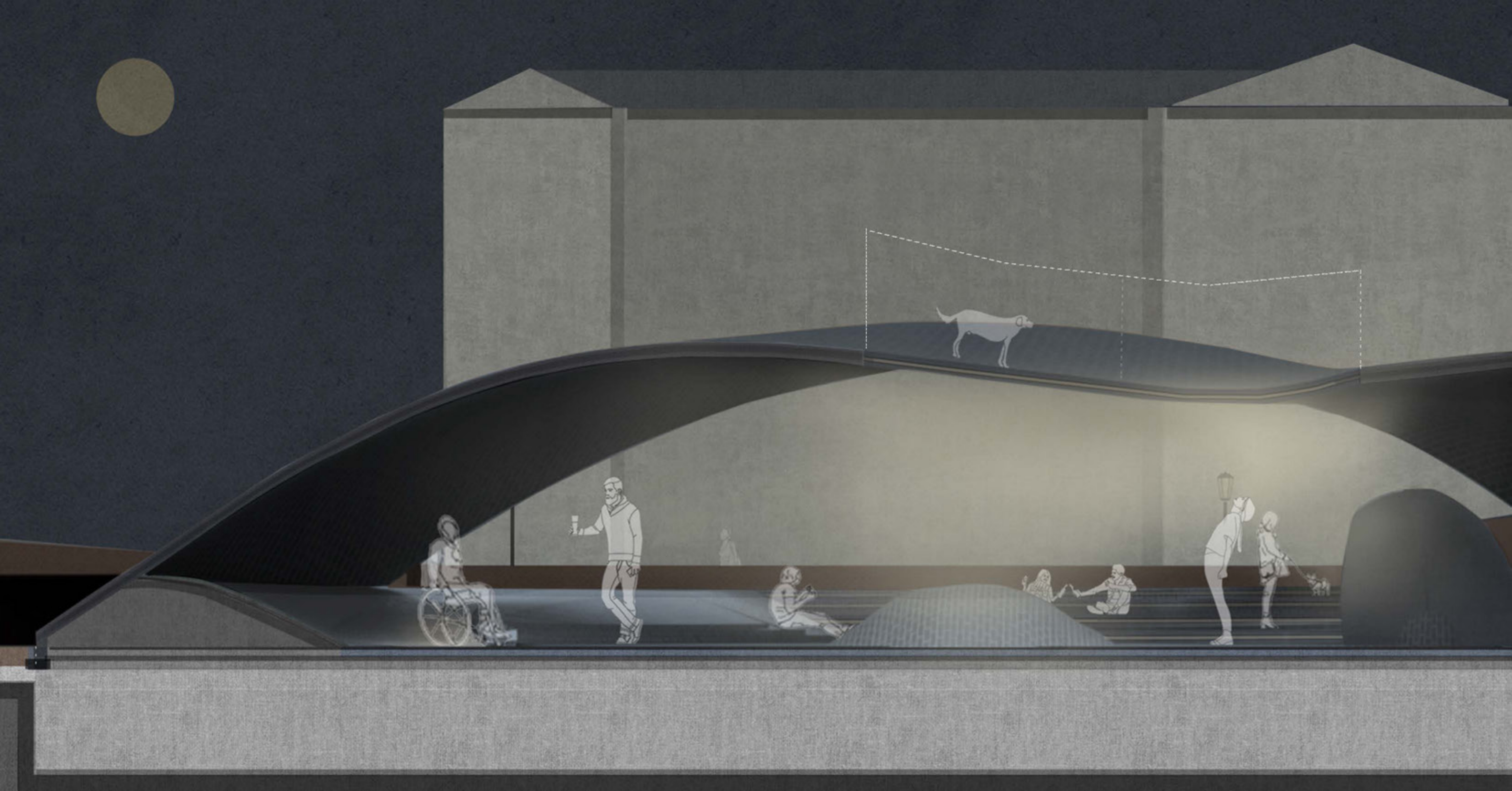

SECTION: NIGHT TIME LIGHTING

Keeping the space alive at all times.
Supporting "Midnight Apothecary",
evening event held at the museum.



• BMD •

PROPOSAL

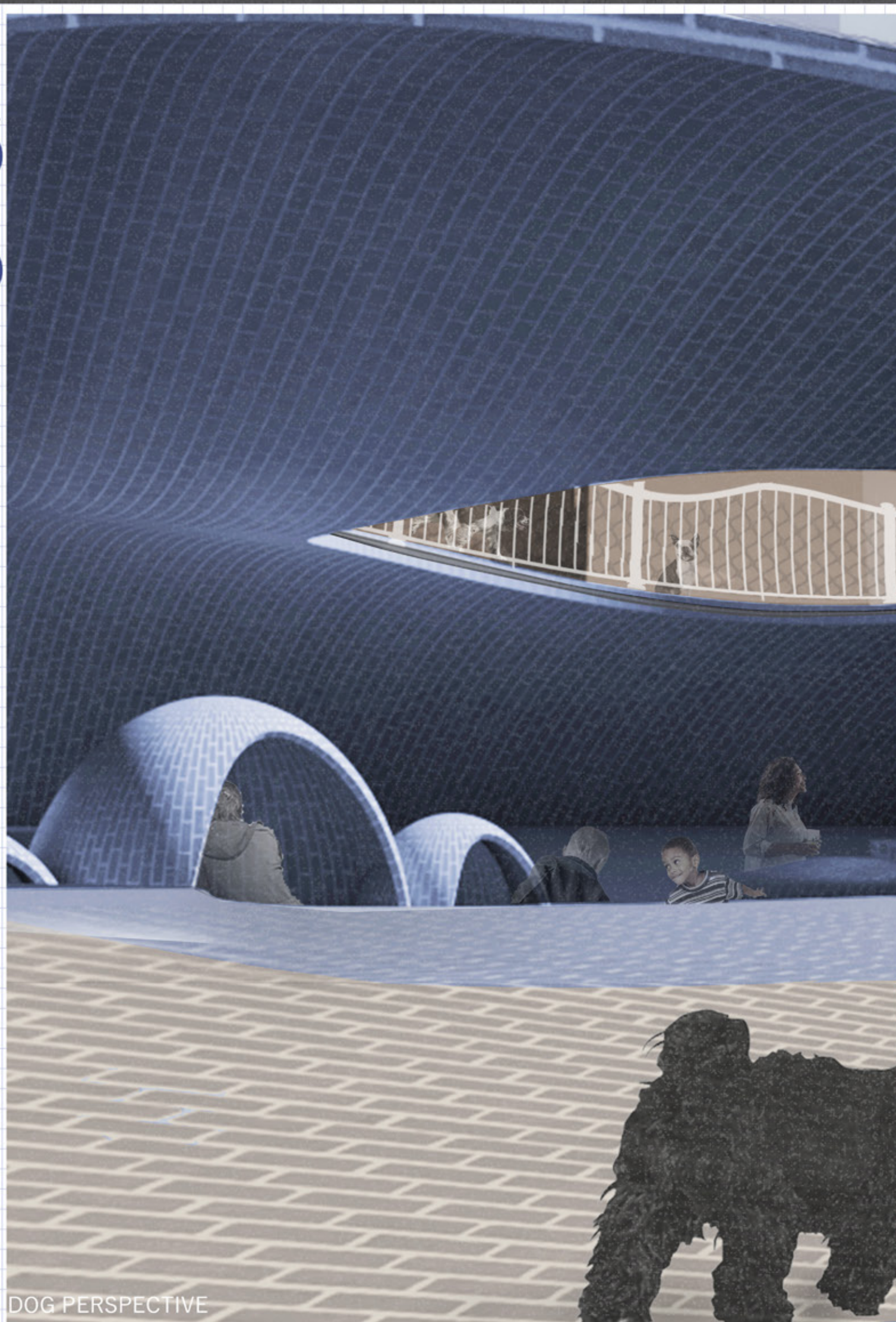

DOG PERSPECTIVE

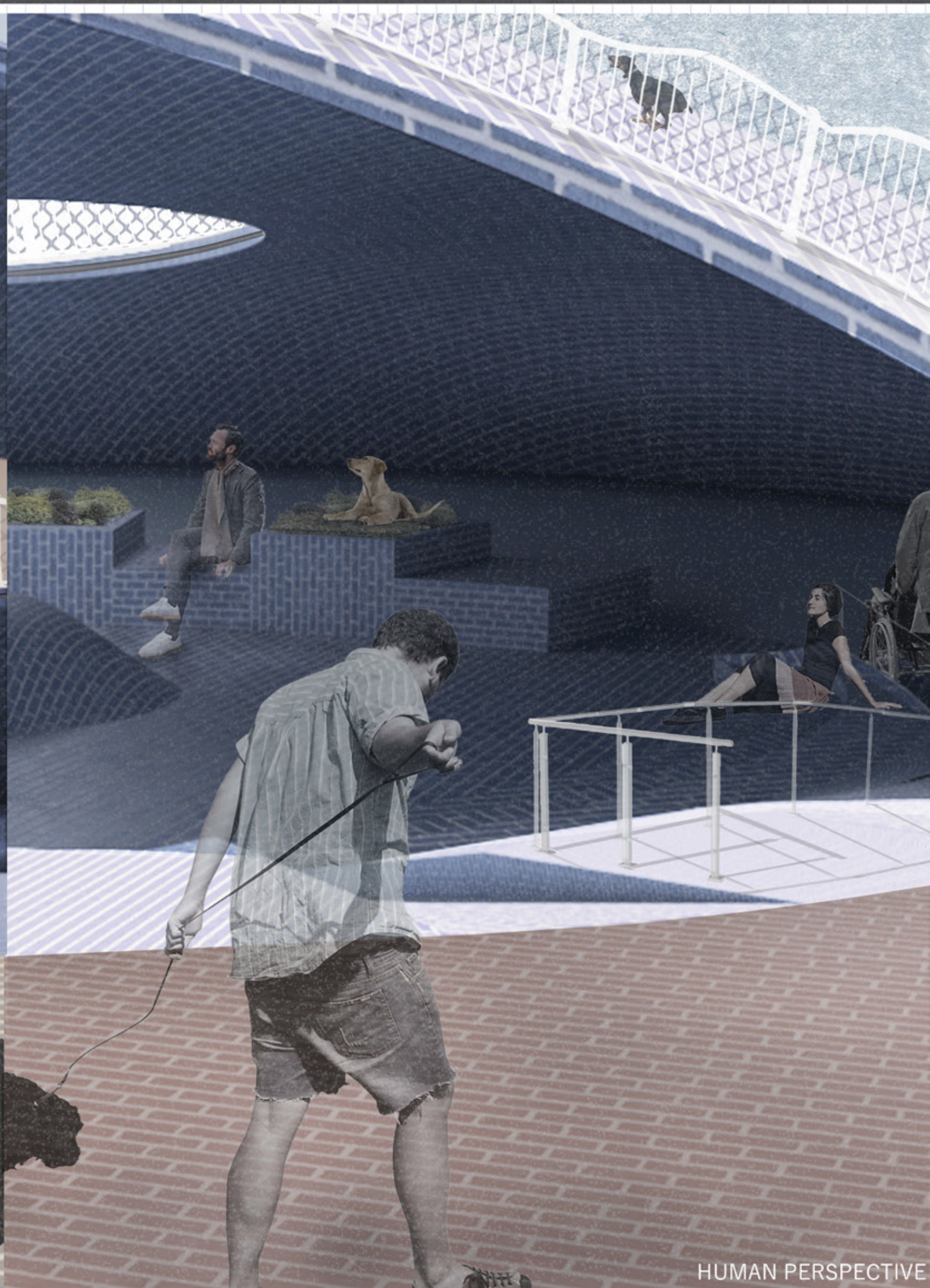

HUMAN PERSPECTIVE