

A CHANGE OF STATE

BY ALEXIS SOUTHEY
UNIVERSITY OF BRIGHTON - YEAR 3

My work is influenced by the joining of materials and how people interact with them. With a background studying maths and physics, I am passionate about the technical side of design. This interest in physical change has influenced my projects to be dynamic with balancing, moving elements, as well as structures dissolving over time. I am passionate about sculptural installation work and the relationship between structures and the natural elements. Like installation work, I also like to focus on personal experiences and the journey people take when interacting with a project; this journey does not have to be only physical, I like my work to have a message behind it and make people think.

Here you will find a selection of exploratory models and from the project a Change of State. These models went on to inform a series of totems that signified the beginning of the Festival of Britain 2021 on Brighton's Pier with one of many pavilion's, this one designed to raise awareness of the UK's coastal erosion issues. As such by using salt and steel the totems are intended to erode and decay through the duration of the festival.



Salt and steel models

The process of erosion on chalk cliffs:

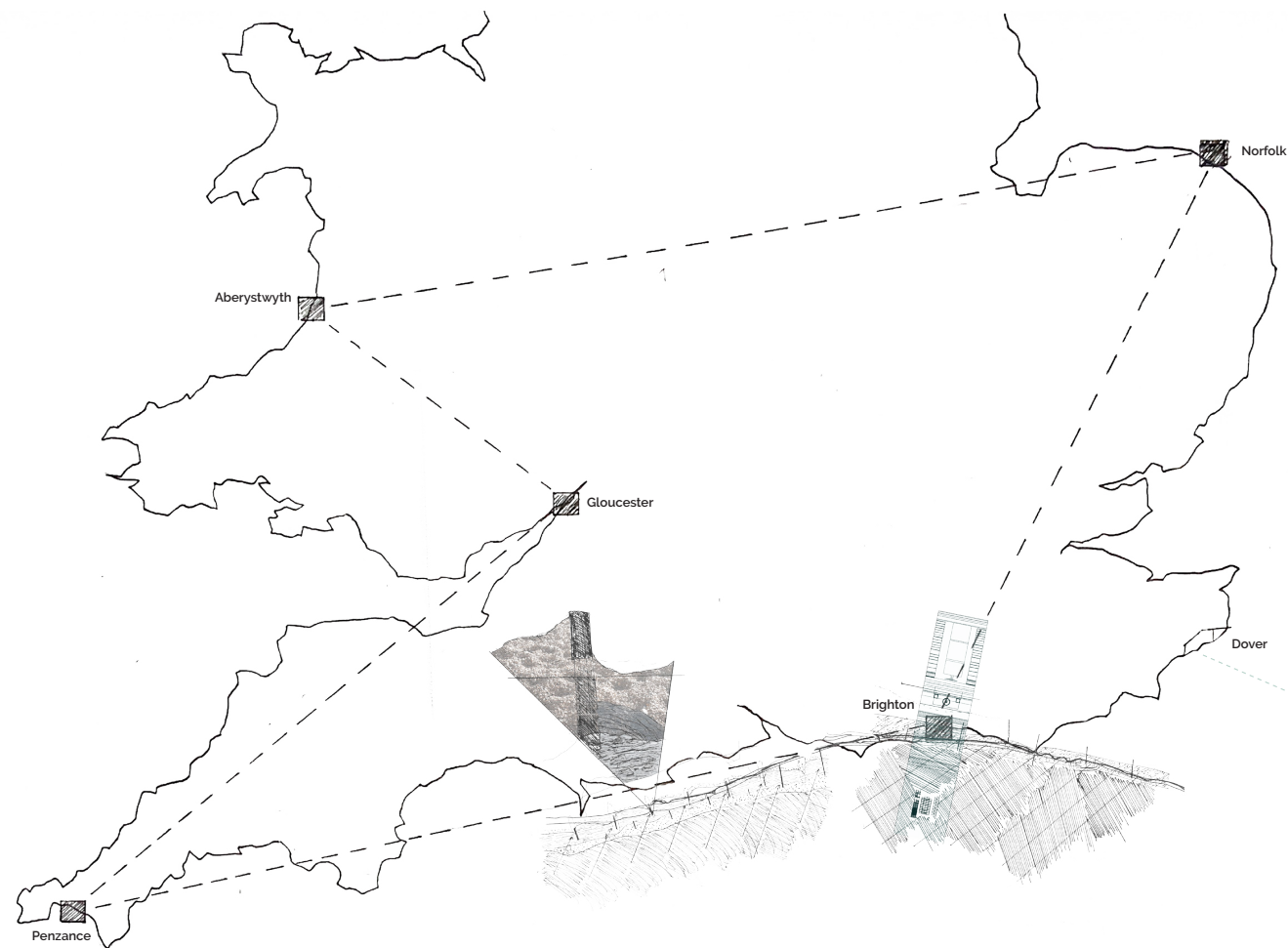

South Coastal Erosion - Chalk Cliff Erosion and Waste Material

This diagram highlights the affects of the weather on the coast. The squares which are dotted around the South of the UK are the points most affected by coastal erosion.

The purpose of the pavilion in the Festival of Britain will be to raise awareness of the UK's coastal erosion issues. The regional town of Dover, is mainly affected by waves crashing against cliff faces and this breaks down cliff material over time.

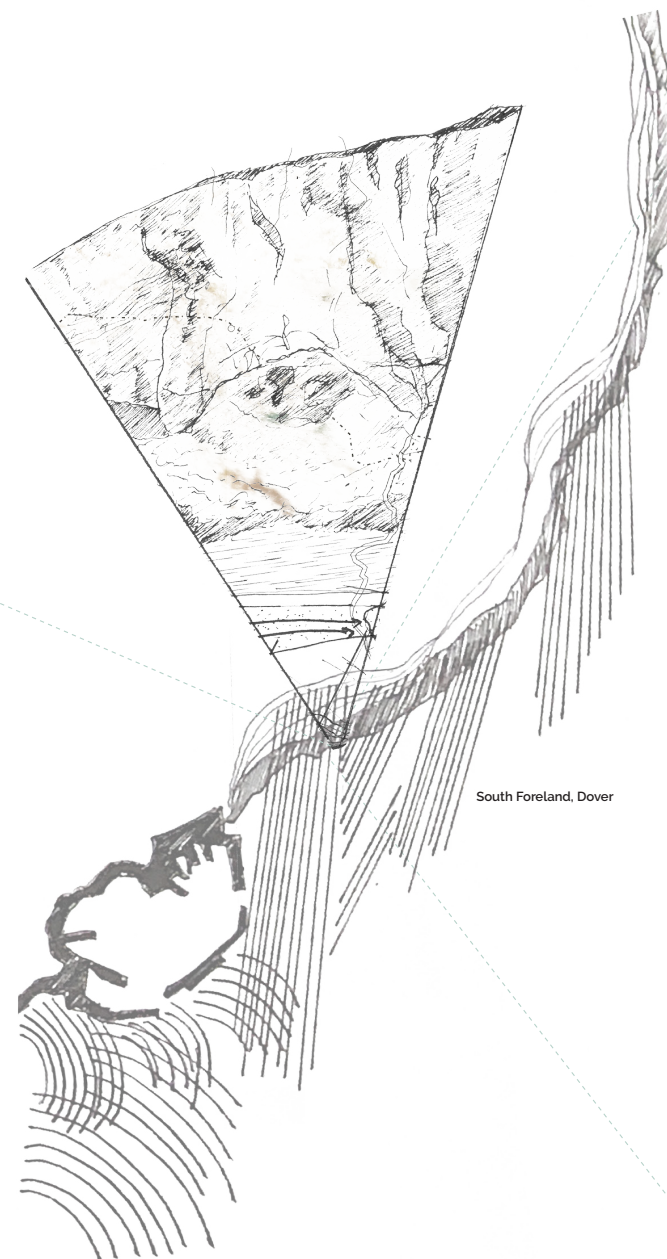

South Foreland cliff face, Dover

South-west wind direction and North/ North-west tides hit the cliff surface

Over time, these elements cause the cliff face to wear down and weaken

Eventually, the exterior layers of the cliff will break away, causing tonnes of chalk and sediment to go to waste



Totems before and after decay

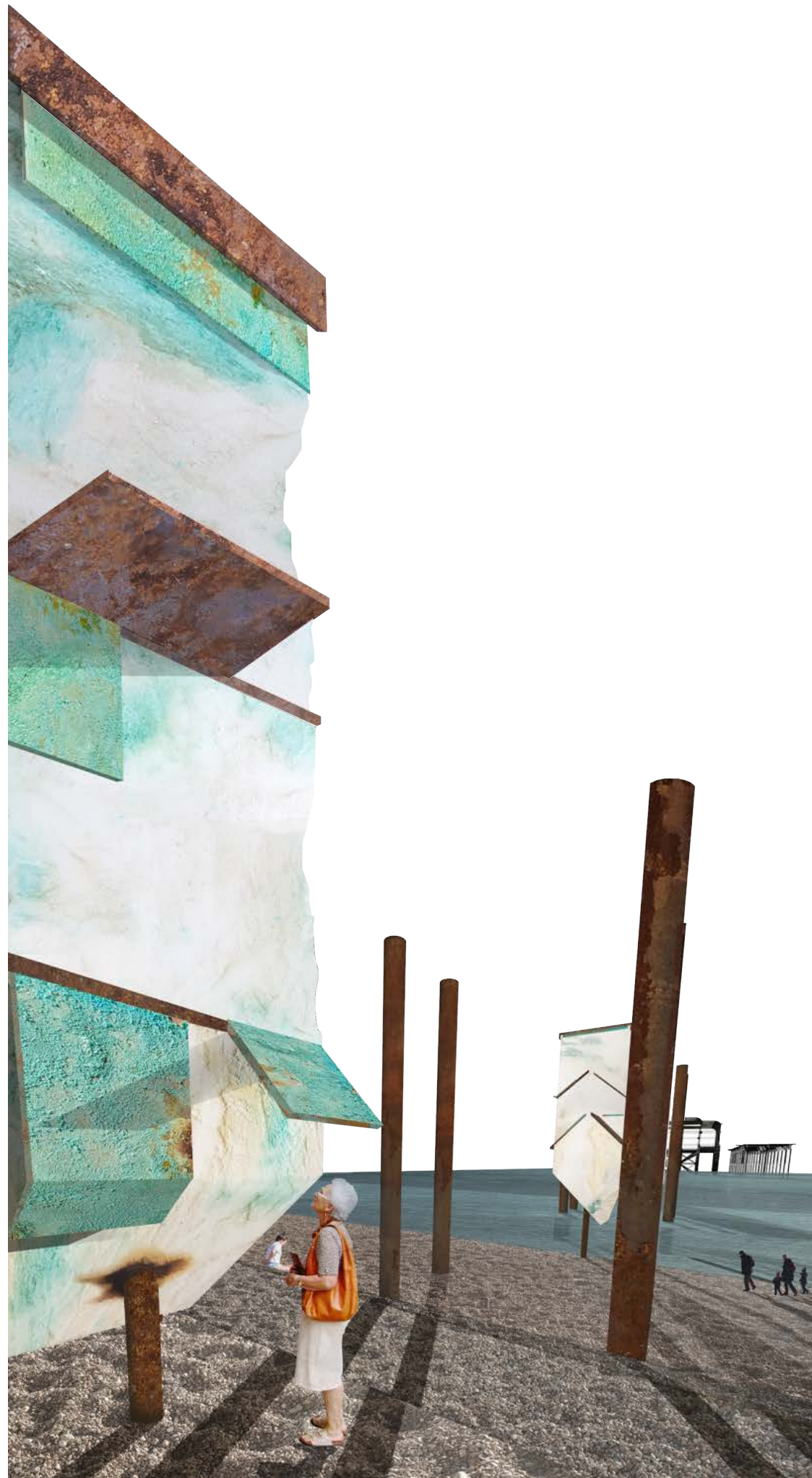

These three totems are a metaphorical and physical representation of the issues behind climate change and specifically coastal erosion.

By using materials susceptible to decay, over the course of the Totems' standing exposed to the winter weather along the seafront, the totems will rust and pigment the salt. Alongside this process, the salt, when exposed to water (from sea or rain) will slowly dissolve, eventually leaving an empty skeletal like structure behind. This large installation will highlight and raise awareness towards the current and future conditions of Britain's beautiful south coast.

