

BY TATE

A textiles gallery that connects.



Site: The former nurses home
55 Ludgate Hill, JQ

80%

The design has a textiles emphasis due to being a textile exhibit space. This approach was formed from Paige Hills' participation within 'Lania Paige Designs', a mother and daughter textiles business.

Broader site, sun placement and the rich heritage analysis led to 80% of the building being repurposed without comprising function and user experience.

Function: Exhibits, theatre, workshop & bar

Grids and Frames

Eisenman's grids and frames method strengthened the conceptual development and determined building removals and circulation.

The removal of centre outer building opened the south facing courtyard which connected each space within the gallery.

Eisenman's deconstructivism approach then led to the creation of the projects concept...

CONNECTION
not deconstruction

Eisenman

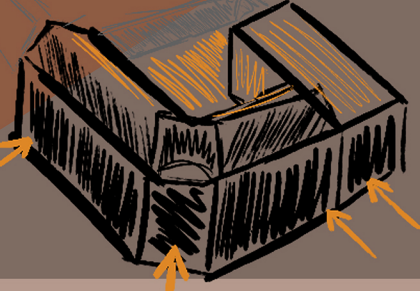
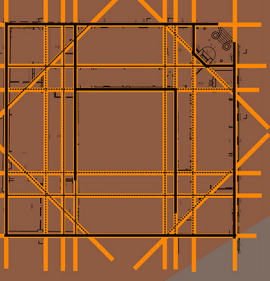

"Creating the perception of space leads to an open mind and invites positive energy" - Cubicool, 2021

Taking you from observation to participation.

Visitors are taken on a journey where the higher up the building you go, the more involved in textiles you become. This is then symbolised through material selection becoming brighter and lighter the more enlightened with knowledge you are.

It was important for the design to feel approachable and enticing due to the ethos of the Stakeholder. TATE has shown their drive for education and creativity which became an important factor when making design decisions.

Previous studies into service design has also been woven into the design through placing importance on employees and their functionality.

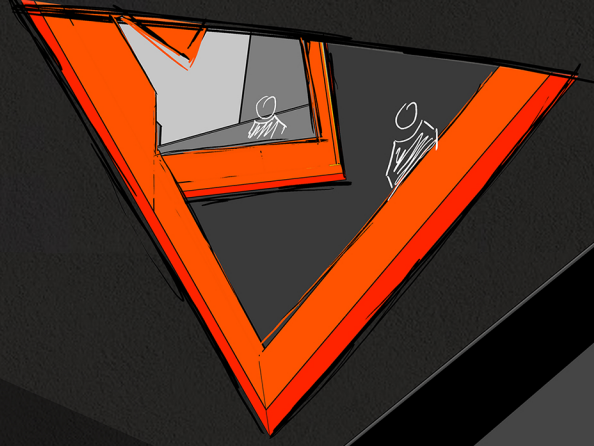

View of void above reception

"Look again,
Think again"

-TATE

Connection element diagram

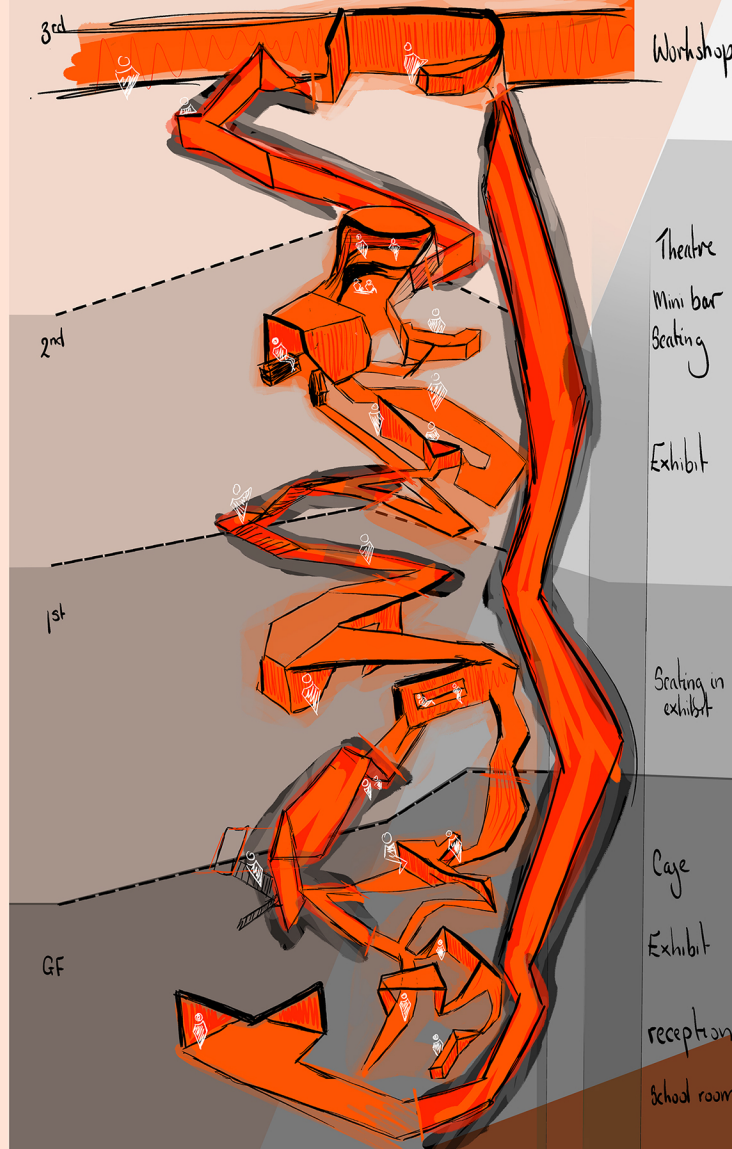

Using regulations, planning of passive and active spaces and design theories such as denial and reward, a user journey and circulation plan was created.

Using the circulation plan, space forming could commence through internal walls, suspended ceilings and furnishing. These design elements were then all connected through a guiding orange wrapping element.



Section

Section and diagram show how the spaces connect and how the percentage of orange increasing in higher levels much like the material selection becoming lighter symbolising the transition from observation to participation.

The Workshop

A place for visitors to get involved with textiles and learn new skills in a means to live more sustainably.

Tree access to art

The balconies create the connection to each floor and space which creates the sense of freedom to explore the gallery your way.

Free to access both financially and physically



Third Floor

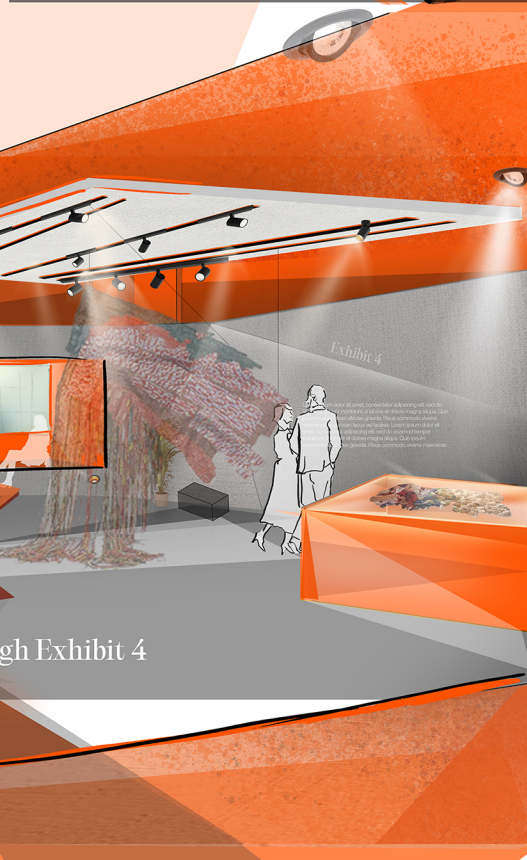

View through Exhibit 4

Exhibit 4

Exhibit 4 features a built-in seating that releases a vibrant orange and the fabric wall folds, bends and wraps around the exhibit for an immersive and holistic experience.

Suspended ceilings with channels for artwork and lighting to be manipulated and show cases define the passive and active moments.

The openings down into the floor below have vibrant perimeters topped with glass to become a stage for the exhibits.

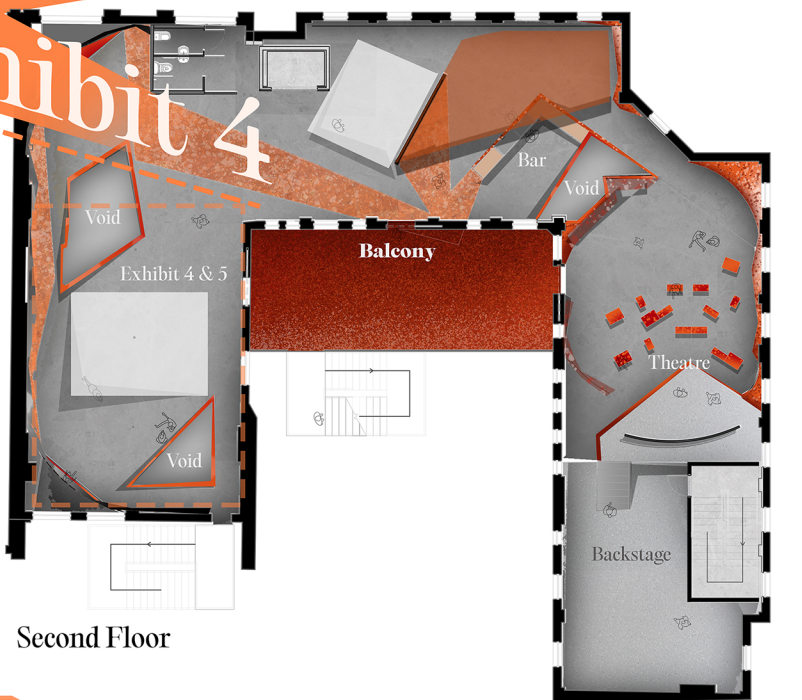

Second Floor

Immersive room

The immersive room plays of the compression with a low ceiling and deep tones, creating a perfect conversation, meeting and public talk area.

Moveable cuboids upholstered seating provides the freedom for visitors to use the space as they wish, perfect for school groups or just individuals.

A moment to be fully immersed and reflect on what is to be seen at the TATE gallery.



First Floor

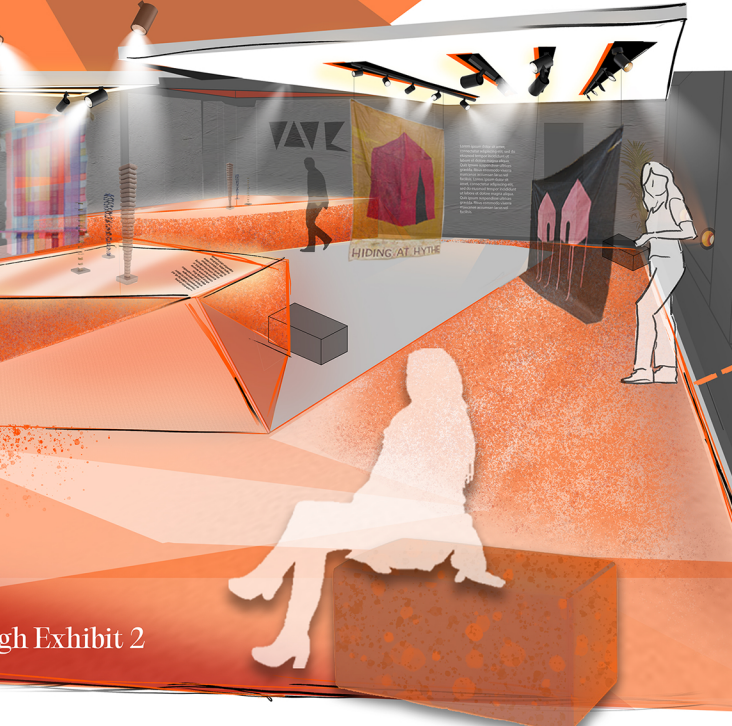

View through Exhibit 2

Reception

The reception presents the beginning of the orange element. The bright colour becomes the circulation and guidance of the gallery.

To support the guidance lighting is used throughout the design to gesture where to look or gravitate towards.

Visitors are met with a statement desk that folds into the floor and appears to wrap and attach to different surfaces creating a connection to the art, the people and the building.



Ground Floor

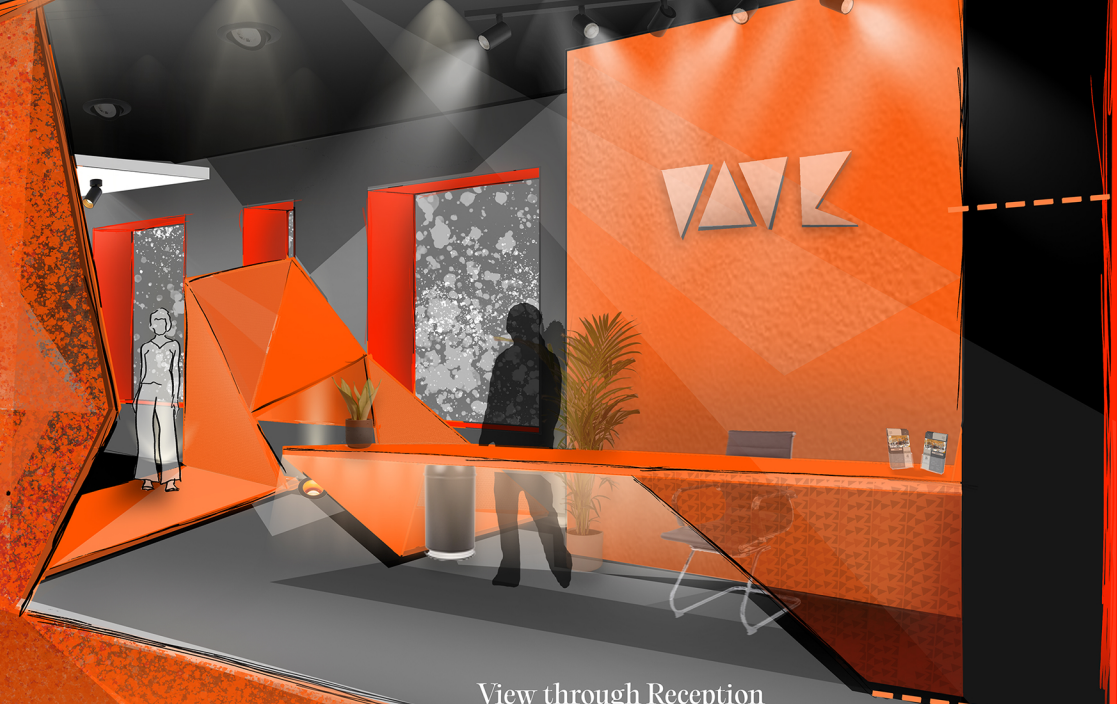

View through Reception

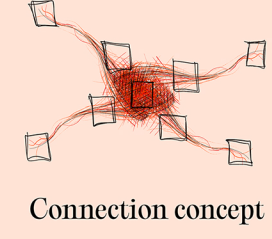

Connection concept

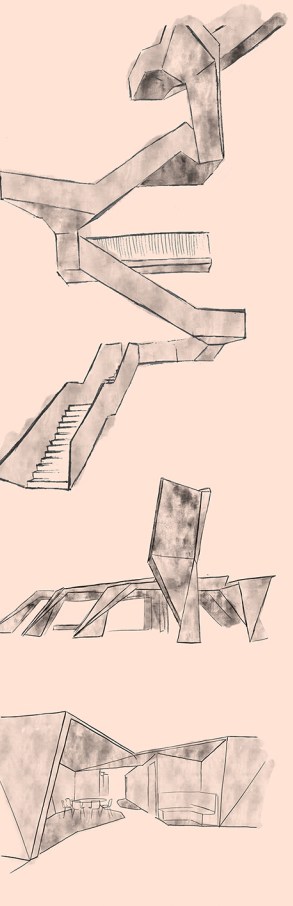

Precedent sketches

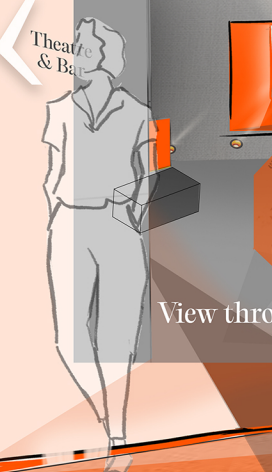

Theatre & Bar



Immersive room

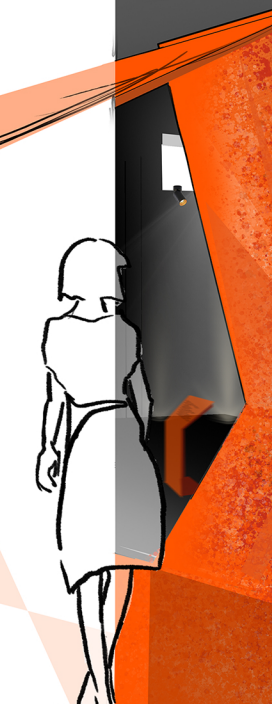

View through Reception

ENTRANCE