

How Will You Go Beyond The Grid?

Craft & Making

The Predetermined

Georgia Whitham

Theory Theory

The Predetermined Theory Theory

Flipping The Theory Around

The Predetermined Theory

The Predetermined Grid provides the 3D spatial that the theory is implemented within, providing the base for spatial thinking and informing facadism. The structure is built up using graphical thinking; latching on and deconstructing a historic building.

Spatial Thinking
3D Space

2D Graphics
Informing

2D

3D

3D



graphics



How can a middle ground be found between 2D graphics and 3D architecture?

Can the 2D element unfold and then refold into a new 3D spatial envelope?

The Predetermined Theory delves into the interconnection of graphic design and architecture through spatial thinking informing graphical thinking. Through reacting to previous theories like Alberti's Window, by flipping it around with the final outcome informing a physical, 3D graphic rather than a 3D spatial.

3D Graphics
Graphical Thinking

After the gathering of research and the looking into theories such as Albert's Window and Henri Lefebvre and their correlation and direction of research. The hypothesis will design a test around going the opposite direction to their approaches through the incorporation of spatial thinking, informing graphical thinking with the blurring of 2D and physical forms in the process representing these two theories and how they can work.

The test will go further than the predetermined grid by opening up a new dialogue to physical space. The outcome will provide the interconnection and perceive a spatial envelope that will unfold into the predetermined grid allowing the theory to delve back to the base aims of deconstructivism, facadism, modernism. Encapsulating the grid and breathing life back into architecture with graphical thinking.

The test will begin through model making with graphical thinking, the models will blur the distinction between 2D and 3D through being formed from 2D posters and screenprints that will then be manipulated through being folded, cut and intersected to curate a 3D spatial from the 2D graphics. With this an independent variable will be created informing the example structure, while allowing the space interpretation to fall down to spatial perception the example will inform a spatial envelope able to be unfolded into the predetermined grid; curated out of context and placed in with no awareness of the current spatial considerations; allowing it to

Hypothesis

4.

3D Space

2D Graphics

3D Graphics



Screen Prints

Intersecting and extruding the 2D graphics into a 3D spatial envelope, which is placed within the grid.

Intersect

Does It Deserve
Facadism
Modernism
Deconstructivism

Graphical Output

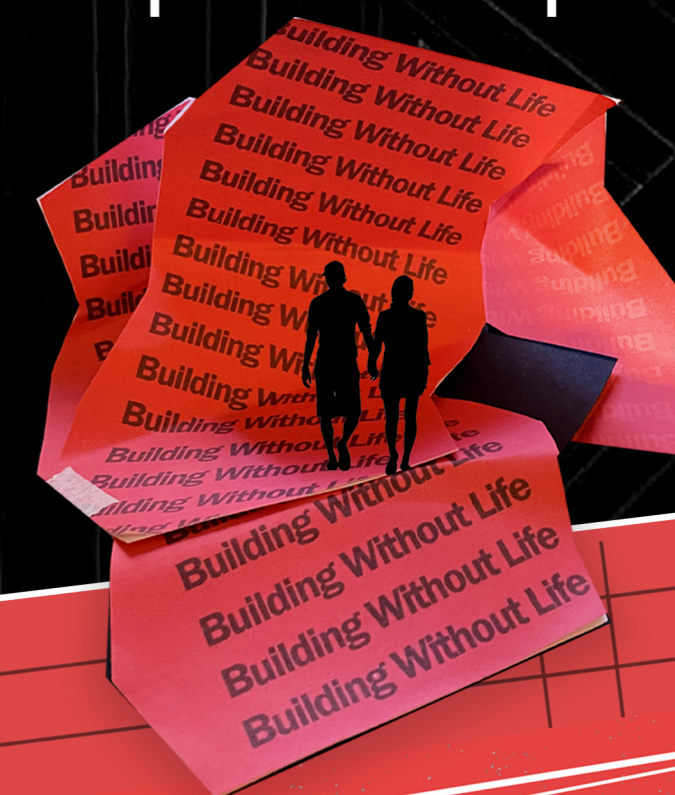

Blueprint Structure

Where The Grid Grasps

Intertwining The Grid And Modernist Facade

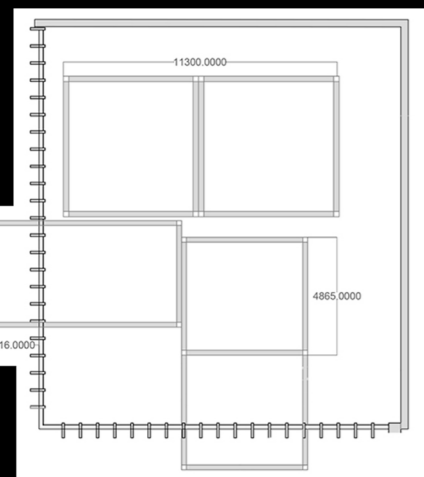

Ground Floor

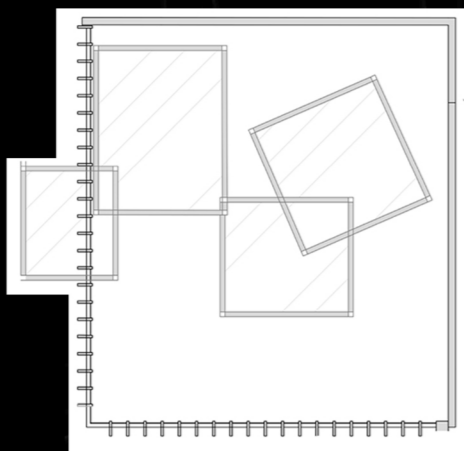

First Floor



Beyond The Grid



2D Graphics

3D Space

Deconstructivism



Graphics

3D Graphics

Physical

cal

Physica
cal Graphics

The Predetermined Theory Blueprint Booklet - Graphically showcasing the process and a step-by-step guide on how to curate and follow the theory in detail; allowing future designers to take architecture 'beyond the grid'.

Contents

Page
Page

Research And Analysis

6 The Predetermined Grid
10 Theory And Analysis

The Predetermined Theory

14 Introduction To The Theory
18 A Toolkit For Revitalising Modernism

3D Spatial → How To Create

22 How To Construct A Grid System 26 Site Deconstruction
24 Grid Variations 32 Grid And Facade Joinery
36 The Predetermined Grid Example

2D Graphics → How To Test

46 Hypothesis Test Design
50 Spatial Thinking

3D Graphics

54 Graphical Thinking Test



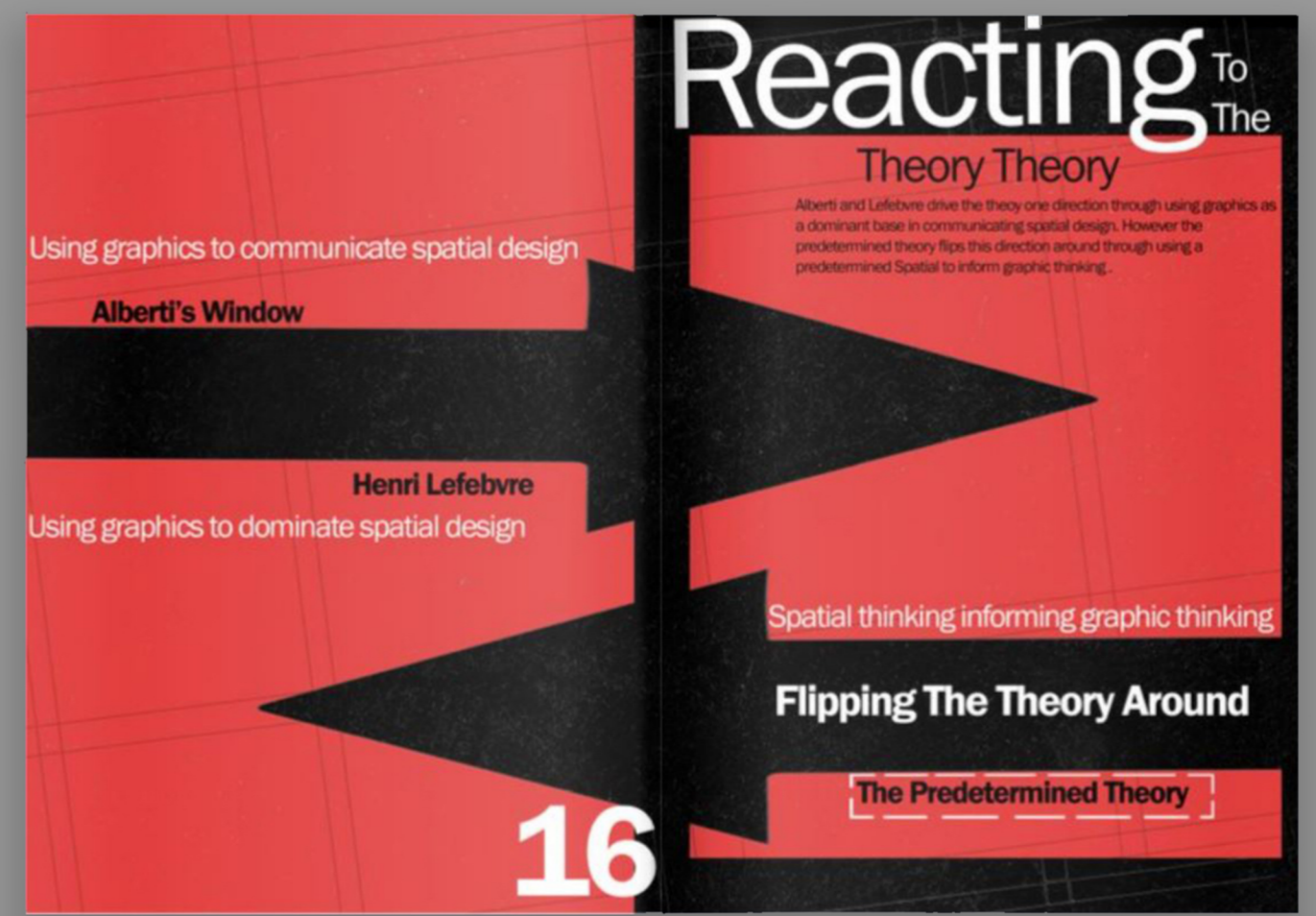
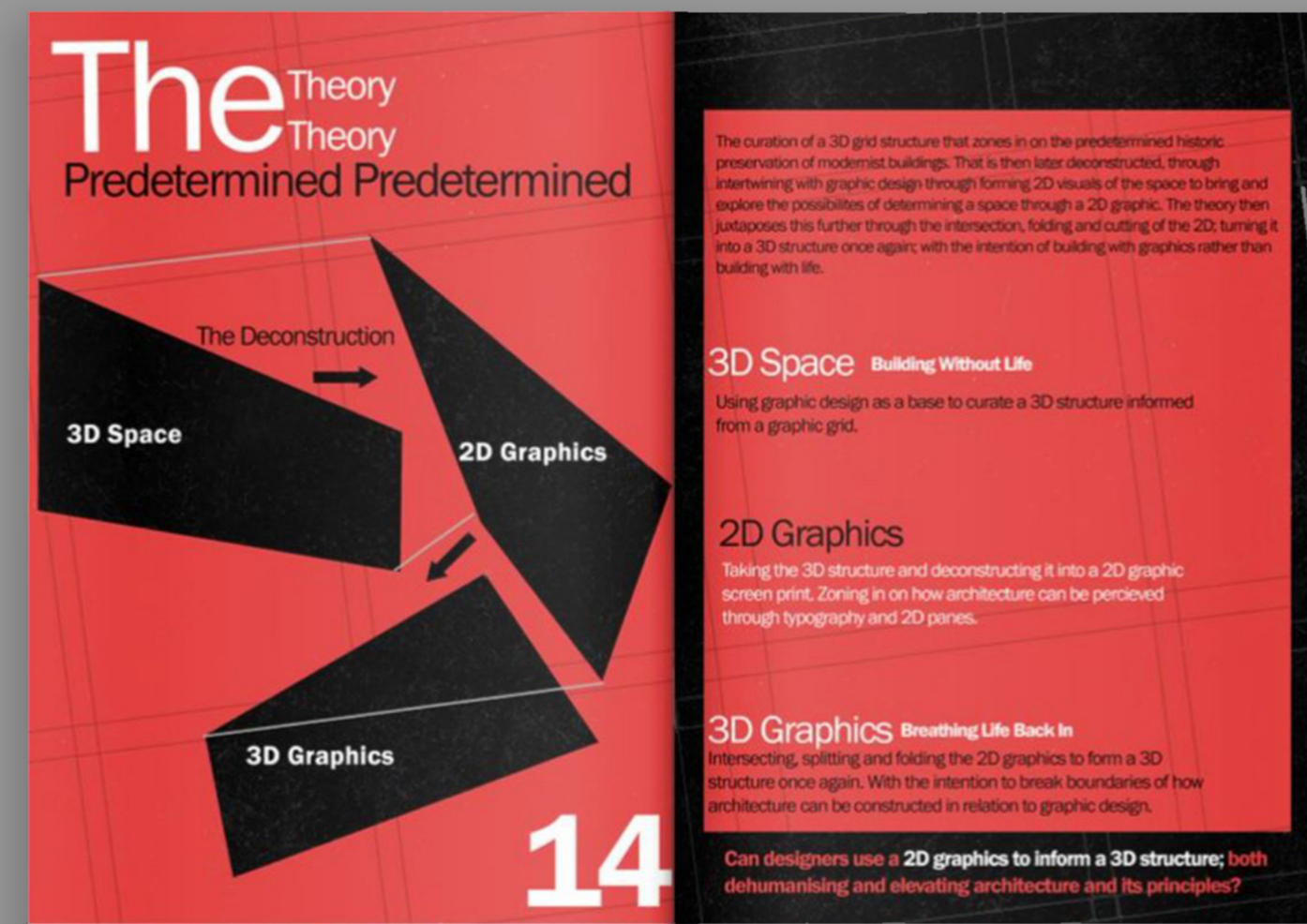
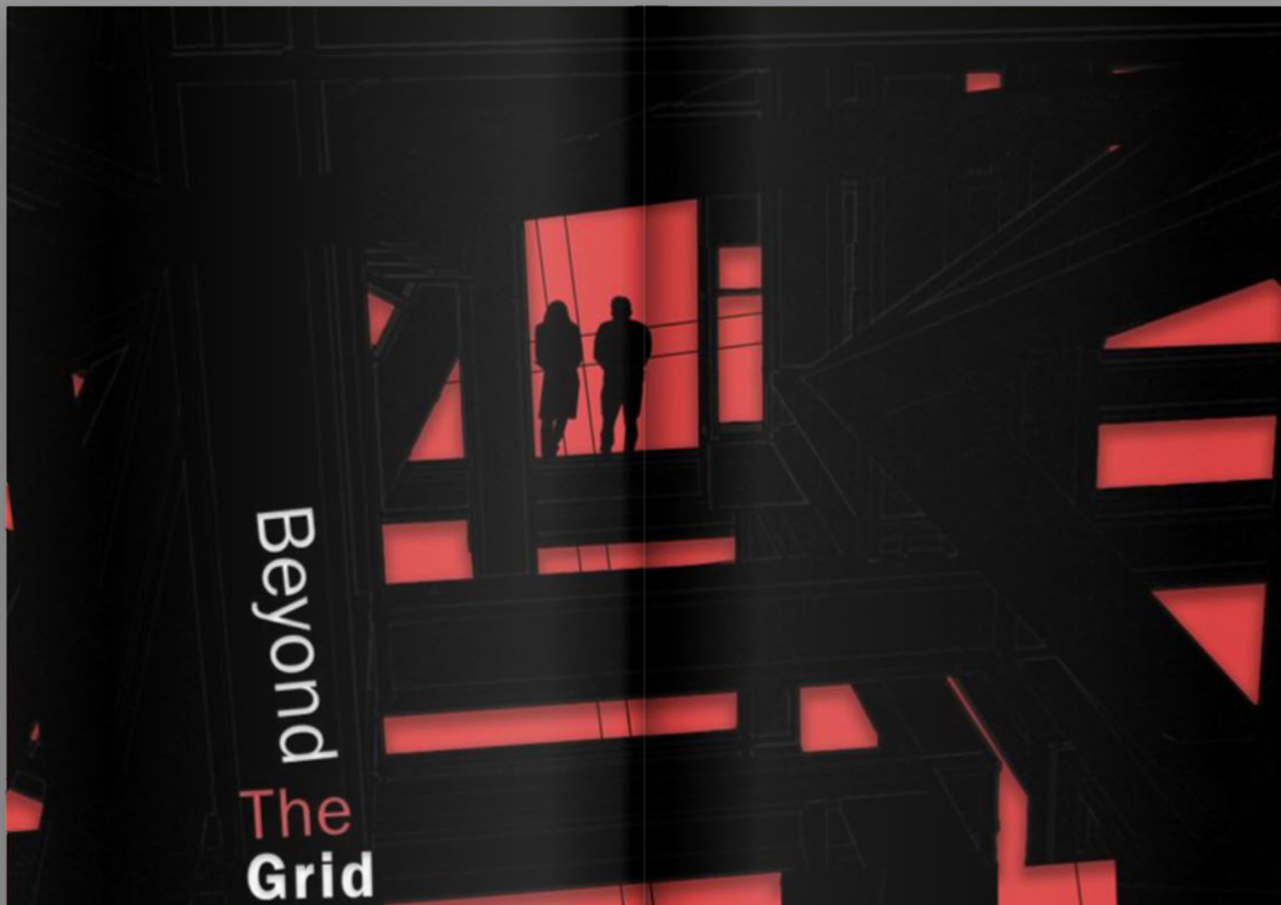

The Theory Booklet Predetermined

