

BRIEF

This space is a Metal Music Culture Hub created to encourage Women and Young Girls to explore music and feel comfortable. In the space the user will be introduced to metal music and develop their knowledge of the music as well as the culture through performance and exhibitions.

GROUND FLOOR

The Ground Floor is a mix of heritage, performance and exhibition spaces. All the spaces are open this allows the user to explore and learn as they please. There are two lifts allowing all to access the spaces. Minimal changes have been made to the structure of the site so that the buildings original structure is impacted as little as possible.

- The open spaces promote collaboration and allow the user to see the whole space. Safety and comfort are key factors of the space. The main stage is open and can be viewed from the whole building. The heritage spaces remain intact and functional alongside the new spaces. The artefact presentation methods have been updated and artefacts are encased in safety store and preserve them.
- Unisex toilets are in the space so that anyone can use them.
- Lifts and ramps were added so that the space is more accessible and all are welcome.
- The entrance to the site remains the same and has a large wooden door. The reception is the first thing the user sees and can be directed from there.
- Original materials remain in the site, flooring which couldn't be used is covered with removable vinyl tiles so that if needed the existing flooring can be used.
- The bar uses brick from the exterior as well as metal connecting the exterior and interior also respecting the heritage of the existing building.

FIRST FLOOR

The First Floor allows the user to explore heritage spaces and their musical ability. There are spaces to practice as well as view the music on the other floors, there is a bridge that connects the two buildings allowing the user to navigate the space easier. On this floor are spaces for performers to prepare as well as access to the stage below.

- Heritage spaces are retained so that people can still learn about the history, these are all open and not locked away.
- The joining of metal music and heritage is explored on this floor as everything is open and usable.
- There is a large void to see down into the exhibition below as well as to see the hanging wire exhibition of the guitar forms.
- The glass landing is surrounded by metal wires wrapping around it this is an interpretation of a guitar neck and strings.
- The void is visible out of all windows on this level the wire hung leather and steel pieces are connected to the roof level of the south building.
- All spaces are accessible because of lifts on the floors.

SECOND FLOOR

The Second floor is dedicated to music, lessons and practice this is where the user can express themselves and feel safe. The space has sound dampening and sound proofing so that users can practice without worry of being too loud or interrupting someone else.

- Spaces for staff are available.
- Rooms for group or individual lessons or practice are on the top floor so that they are away from the exhibition because this will be quite noisy. The rooms have some sound dampening and proofing but not to the level that they will be sound proof completely.
- There are lockers all around the site so that the users feel comfortable leaving their belongings to focus on the music and their instruments. These can also be used during the performances so that people don't have to carry their things around.
- There are pods that individual or small groups of people can use to practice away from others so they can feel comfortable.

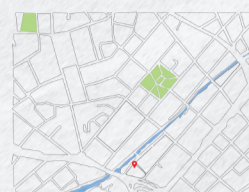

Newman Brothers Coffin Works Factory
The structure of the original building is retained as its a grade II listed building of architectural or historic importance. It's a metal working factory, including warehousing, workshops and offices built in 1892 with 20th century alterations and additions. There is a clear divide between the existing and addition to the building this was my intention so that the materials are either honest to the original building or clearly dishonest to the original building.

SITE

The site is in the Jewellery quarter the area has a history of creating jewellery from stamping and casting metal, the same machinery that was used in the Newman brothers factory has been used in the area for 100s of years creating a variety of different objects. To retain the heritage of the building and machinery, users will be able to see how the metal was stamped and how jewellery and intricate metal pieces were created in the original factory. History and Heritage is very important in this site as the space is used to educate people about the factory and the people who worked there.



EXISTING MATERIALITY



The original press shop has exposed cross-braced joists and fixed benching below windows, supporting hand-operated fly presses. Battery of 4 drop stamps against rear wall, with wall shelving for stamping dies. At the northern end, a larger single stamp, and above, line-shafting with pulleys and reducing wheels extends along the shop. Plating shop to right-hand end retains 20th century vats and electrical equipment for the electro plating process. Upper floor workshops, used for polishing and finishing of goods retain work benching, and evidence of gas fittings for soldering. (known as Birmingham side-lights) and floor-level line shafting. A small brick furnace survives at upper workshop level. Original joinery and fittings survive throughout the frontage range, together with a hand operated hoist serving all floors. Workshop range to north-east with press shop to left and plating shop to right of stair access.

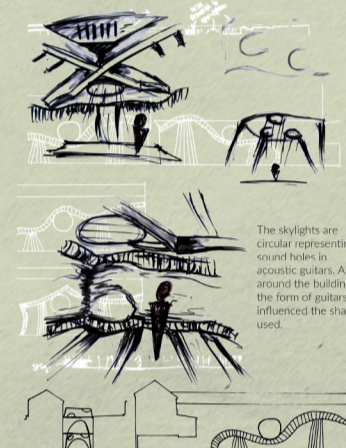

The skylights are circular representing sound holes in acoustic guitars. All around the building the form of guitars influenced the shapes used.

A hung structure is above the stage stretching to the bridge. The idea was to use forms of a guitar to create a waving shape, as it developed further the sound of a guitar was used to create the form.



Women and Metal Music

A study was conducted with 10 women aged 19-50. The women all have different backgrounds and economic statuses, as well as different interests and music tastes the results of this study were that Women don't feel comfortable at metal concerts or engaging with the music, some do feel comfortable. The space I create will allow women to feel safe and learn the music and pass it onto their children. Key words like Tension, Leather, Safety, Comfort, Secret, Metal.

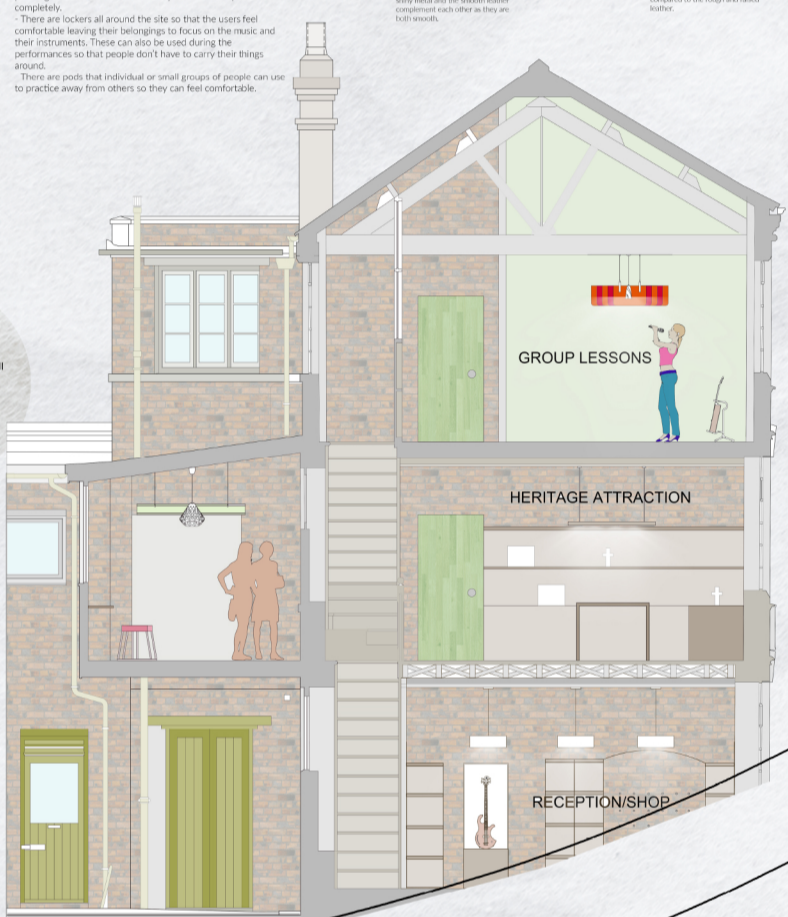

Re-introduction
The space will re-introduce the coffin works to Birmingham with a different use as well as re-introducing metal music to the area and people. The space will allow the user to explore not only the coffin factory heritage but metal music as well. The space will have a focus on women and women in metal music they are the targeted user of the space.

Honesty and Dishonest
Within the space the theory of honesty and dishonesty will be explored through materiality. There will be a contrast between new and existing materiality in the space and the contrast between the two.

Safe Connections
The space promotes safe connections of groups people and the connection to metal music. The environment will be a safe place for people and allow people to be comfortable to express themselves.

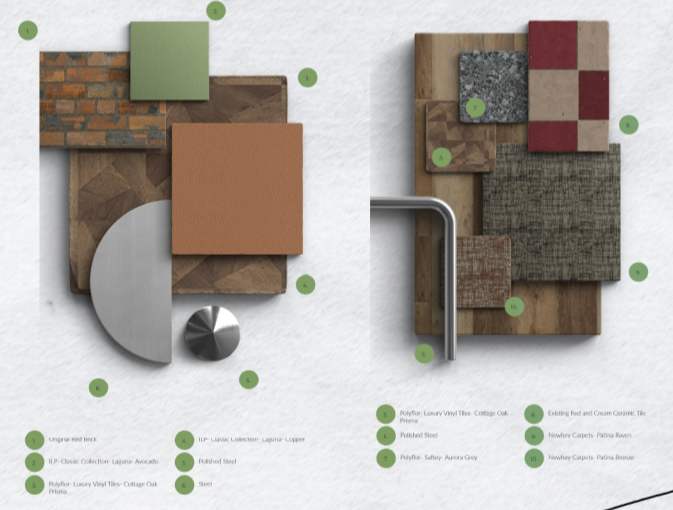

The materials used are split into two: HONEST and DISHONEST anything original to the site is Honest and anything additional is Dishonest

The materiality of the original site influenced what materials were chosen for each area. Leather and metal is used through the spaces as well as red and blue brick. The heritage of the materials is retained and keeps the space honest to its original state.

BAR DETAIL

The form of the back bar and ceiling feature was inspired by sound waves produced by metal music and songs made and produced by women. The rise and fall of the wave, created the smooth wave of the front of the bar and the length of each piece is made by waves as well.

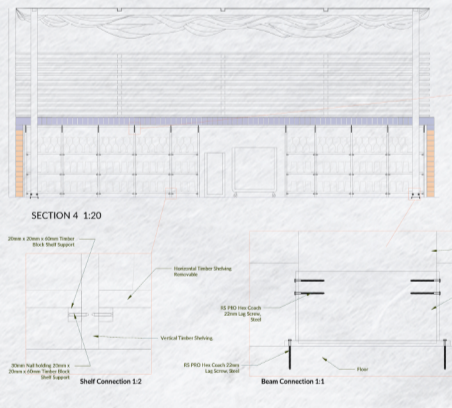

The bar is multi-use it can be used as a place to relax and drink or a place to wait while having a lesson. It will allow people to stay on site while lessons take place and might make them look around the heritage sites and exhibitions.



ACOUSTIC DETAIL

The form of the acoustic is drawn from the fret board of a guitar specifically the fret markers on the neck and the shape of them. They are placed into the guitar at intervals and layered through the guitar. There are many spaces in the site that will produce sound, each area in the spaces has some sort of sound dampening or sound proofing so that sounds don't clash and the user can enjoy their individual or group music without interruption.

