

Microindustry in Newhaven and Social Justice

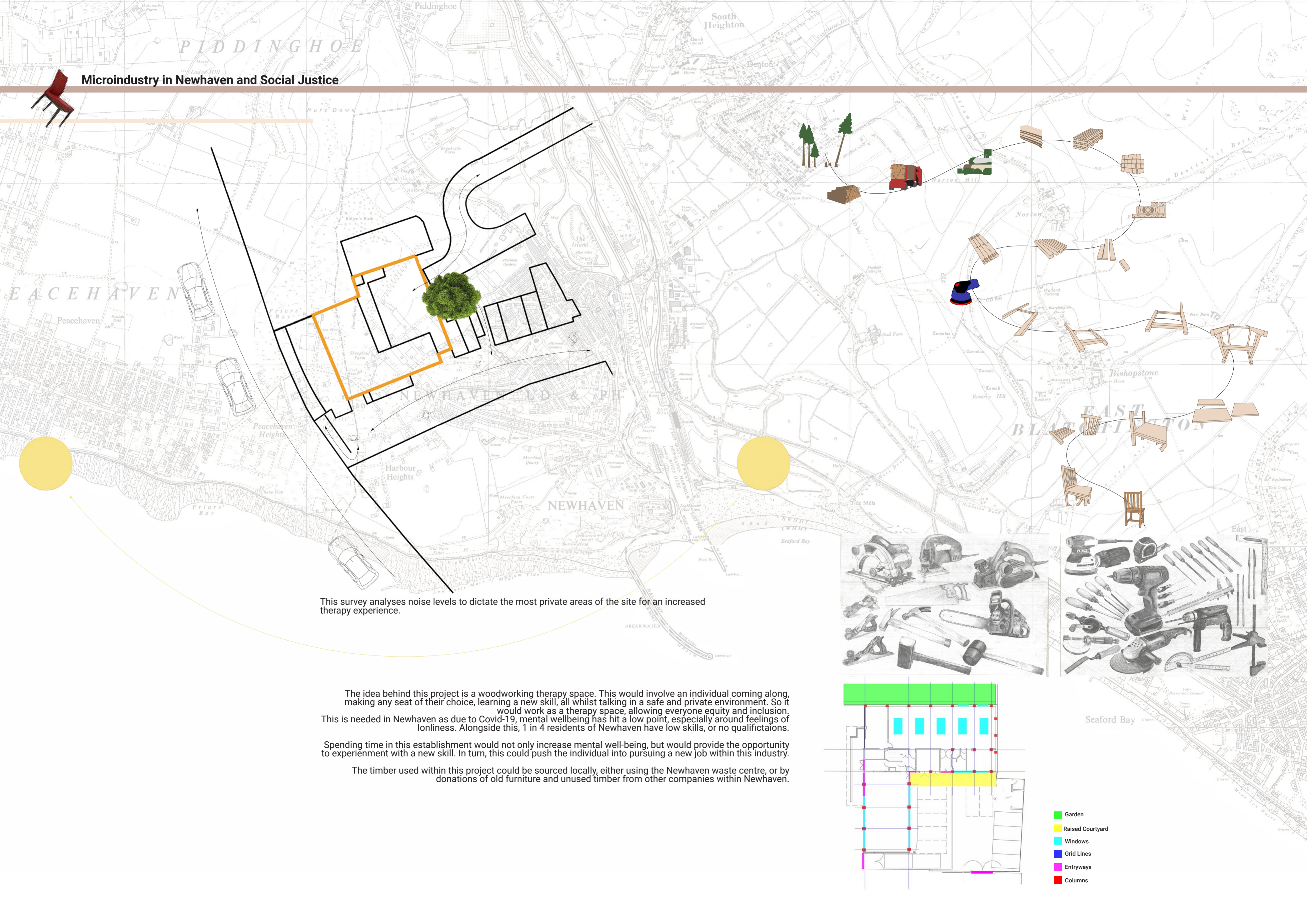

This survey analyses noise levels to dictate the most private areas of the site for an increased therapy experience.

The idea behind this project is a woodworking therapy space. This would involve an individual coming along, making any seat of their choice, learning a new skill, all whilst talking in a safe and private environment. So it would work as a therapy space, allowing everyone equity and inclusion. This is needed in Newhaven as due to Covid-19, mental wellbeing has hit a low point, especially around feelings of loneliness. Alongside this, 1 in 4 residents of Newhaven have low skills, or no qualifications.

Spending time in this establishment would not only increase mental well-being, but would provide the opportunity to experient with a new skill. In turn, this could push the individual into pursuing a new job within this industry.

The timber used within this project could be sourced locally, either using the Newhaven waste centre, or by donations of old furniture and unused timber from other companies within Newhaven.

- Garden
- Raised Courtyard
- Windows
- Grid Lines
- Entryways
- Columns

Spatial Mapping and Manifesto

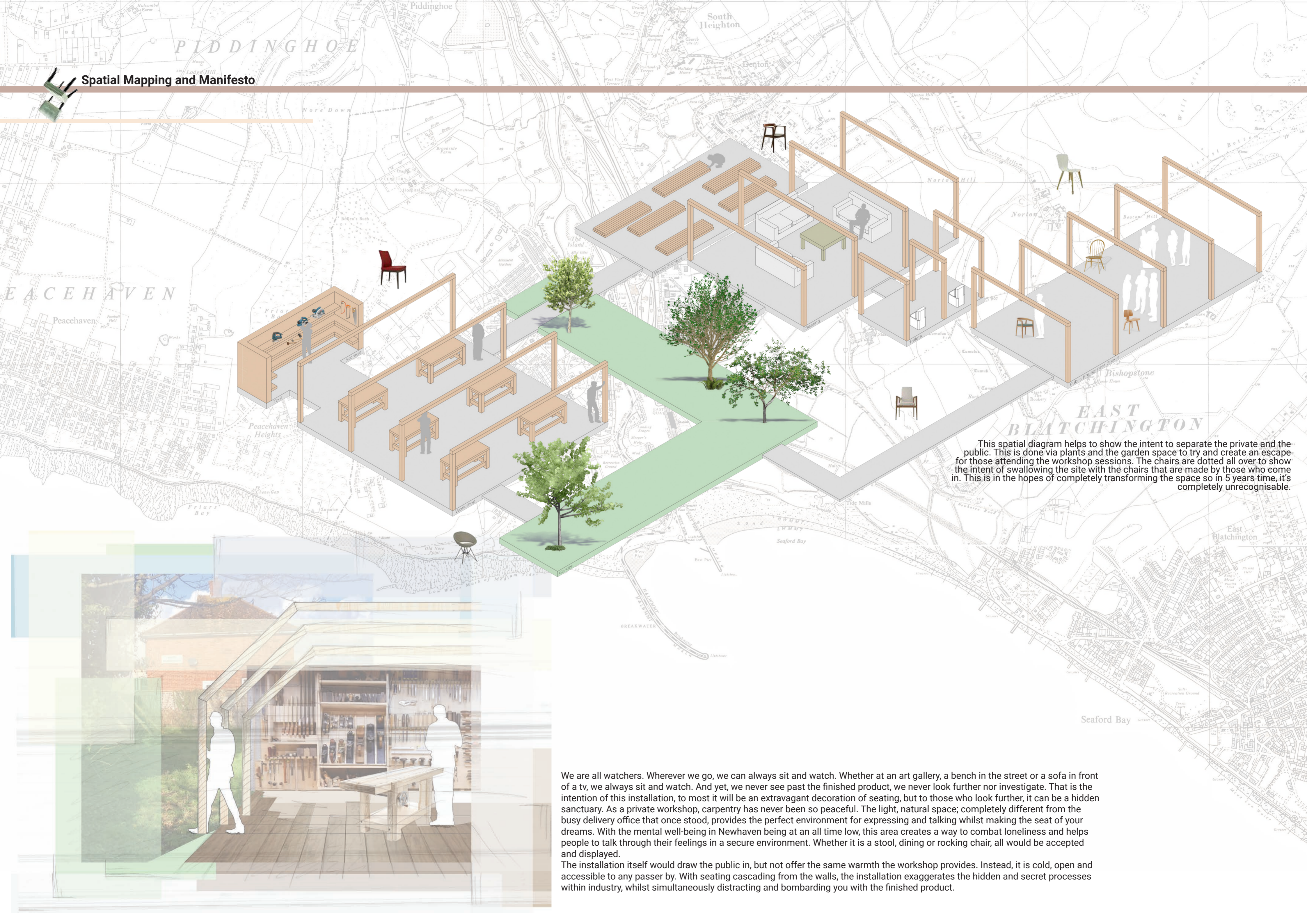

This spatial diagram helps to show the intent to separate the private and the public. This is done via plants and the garden space to try and create an escape for those attending the workshop sessions. The chairs are dotted all over to show the intent of swallowing the site with the chairs that are made by those who come in. This is in the hopes of completely transforming the space so in 5 years time, it's completely unrecognisable.

We are all watchers. Wherever we go, we can always sit and watch. Whether at an art gallery, a bench in the street or a sofa in front of a tv, we always sit and watch. And yet, we never see past the finished product, we never look further nor investigate. That is the intention of this installation, to most it will be an extravagant decoration of seating, but to those who look further, it can be a hidden sanctuary. As a private workshop, carpentry has never been so peaceful. The light, natural space; completely different from the busy delivery office that once stood, provides the perfect environment for expressing and talking whilst making the seat of your dreams. With the mental well-being in Newhaven being at an all time low, this area creates a way to combat loneliness and helps people to talk through their feelings in a secure environment. Whether it is a stool, dining or rocking chair, all would be accepted and displayed.

The installation itself would draw the public in, but not offer the same warmth the workshop provides. Instead, it is cold, open and accessible to any passer by. With seating cascading from the walls, the installation exaggerates the hidden and secret processes within industry, whilst simultaneously distracting and bombarding you with the finished product.



Design Development, Iterations

The first model made originally had the concept of being abstract and conceptual. This was to get across the element of breaking through the site in the most dramatic way possible. This was achieved by representing the build via the columns and grid structure, and breaking through with the longest piece of wood that would fit the structure. From this, the first floor was added to try and resemble the site further, along with the context also being added to help resemble the site further. This model helped to infer design decisions, imagining the wood as walls, or facades, and allowing the ability to play around with the spaces to create an intricate and dramatic design.



Each iteration of the design contains the same elements, but utilises the space in different ways. In the end, elements from each iteration were used within the final design to create a perfectly spaced design. This plan was then used to create an abstract collage to show the uses of space more clearly.

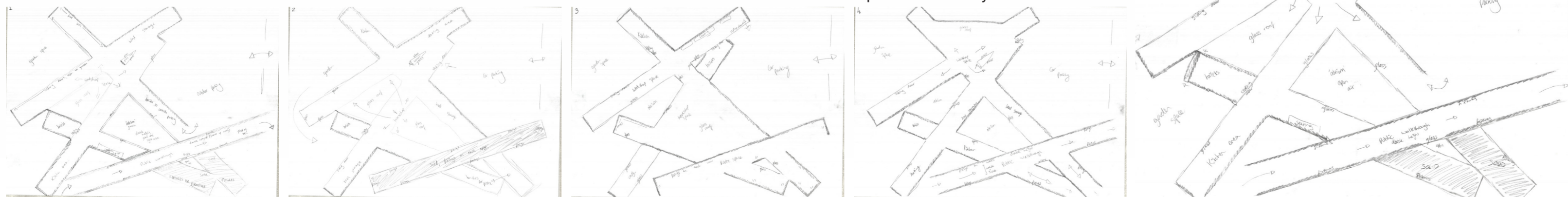
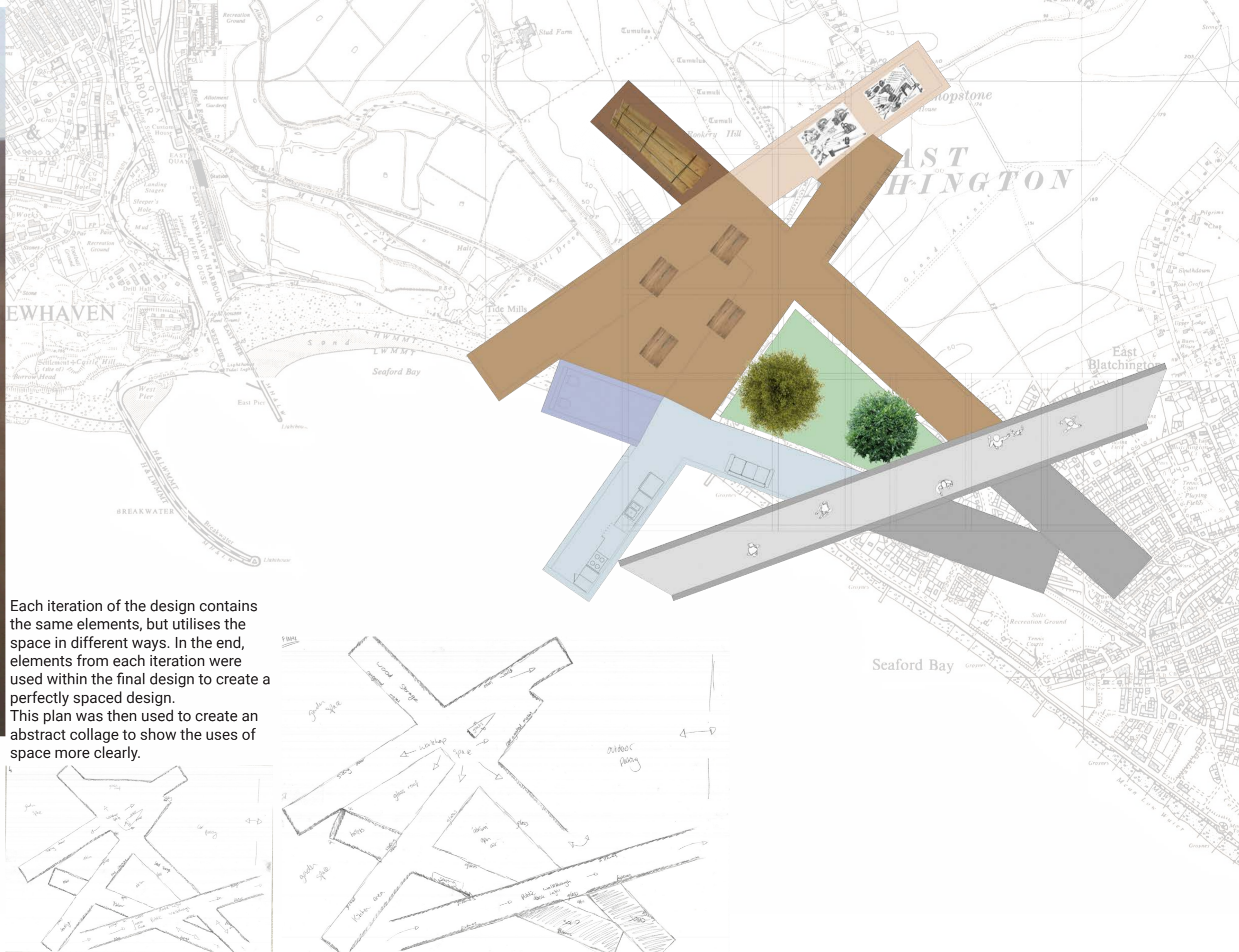

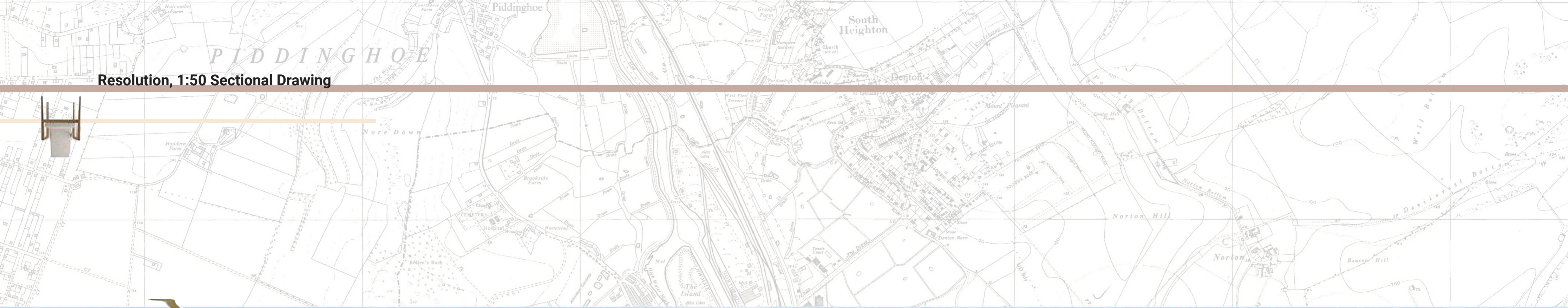

Resolution, 1:50 Sectional Drawing

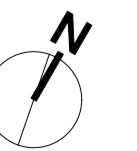
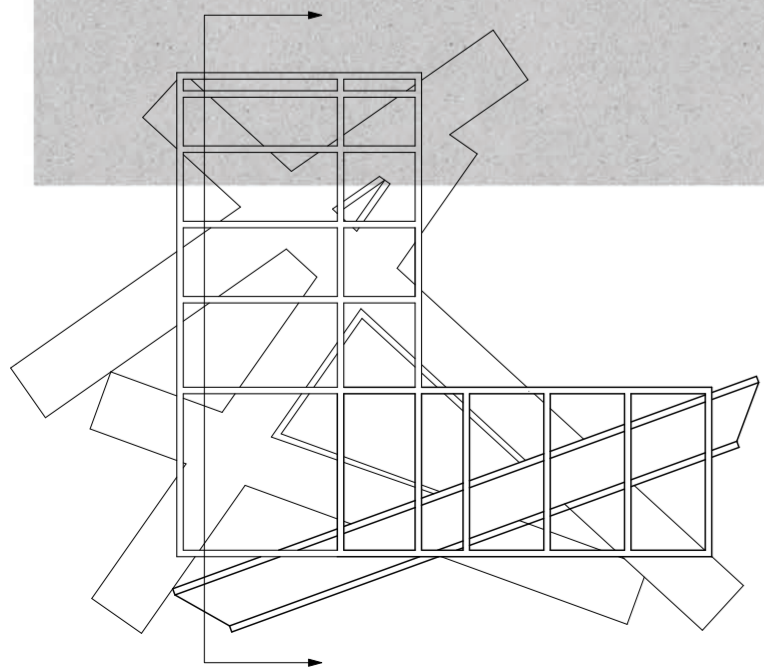

Technical Detailing and User Experience

