

RE-WILDER: RE-WILDING MACHINE

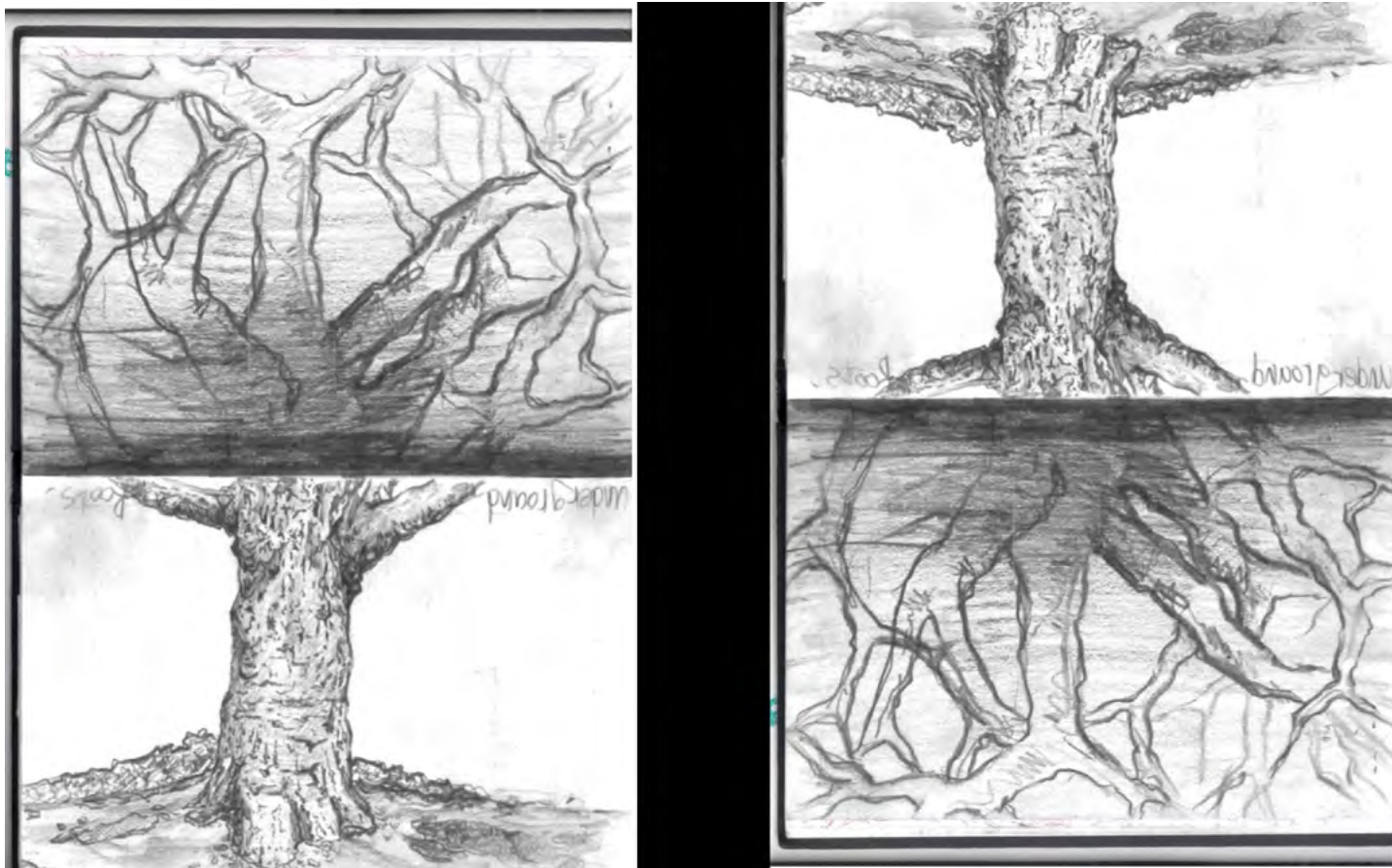

This project is about how humans can help nature take up space naturally. We distinguish between the natural and the artificial. However, in the end, since humans are also part of nature, nature is essential when living, even though we can distinguish them from ourselves. That's why we should allow nature to invade our space. To do this, I made an RE-WILLDER machine that facilitate nature to take over humans space.

This machine will be used as a chair.
As people keep use this chair to sit, rolling around the site a lot, it will slowly crack and agitate the concrete ground more, spreading seeds to the cracks with hidden seeds container inside.
People will contribute to the RE-WILDING without actually knowing that they are doing it, just like gorilla gardening.

HANJOO KIM
2025



1 Wilson Road, London, SE 5, England



Project location is a open space for UAL students. Trees are making this place looks green but the floor is messy concrete.

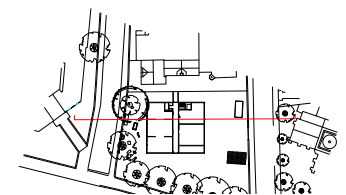



Cracks on the floor made by tree roots.

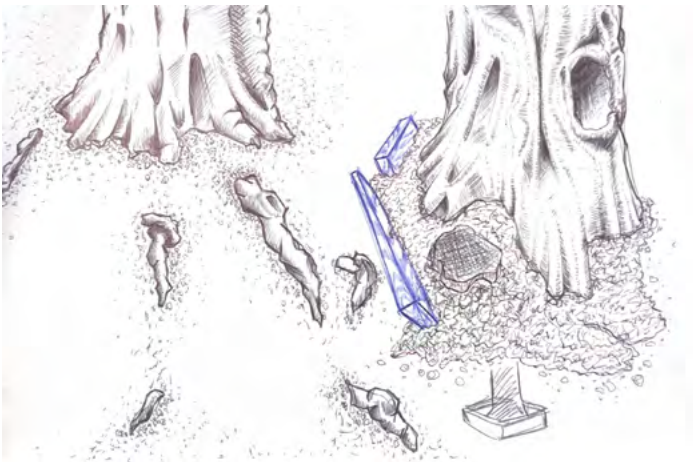

all the cracks telling that trees are trying to bring the nature back to this place.

https://www.123rf.com/photo/119444488-Vector-illustration-of-a-tree-trunk-with-cracks-in-the-ground.html



A1 1:20 Section drawing: tree roots

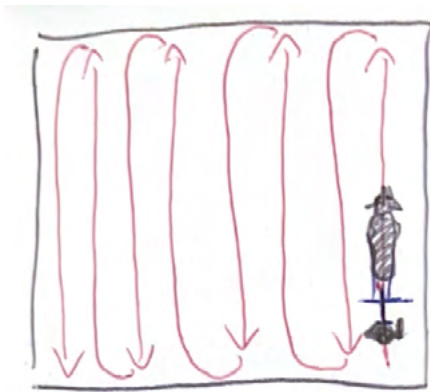
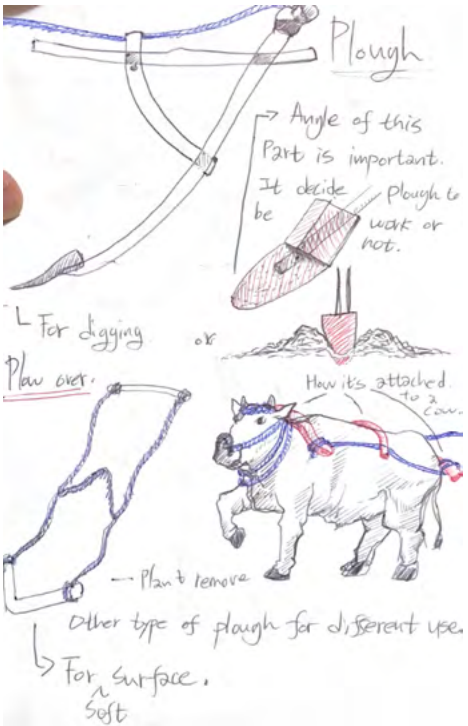

Ploughing adds new value to useless grounds. It makes ground softer, allowing better circumstance for crops to grow.

I used this method to repair the ground of the site, building a machine to help trees to crack the ground more, facilitate Re-wilding.



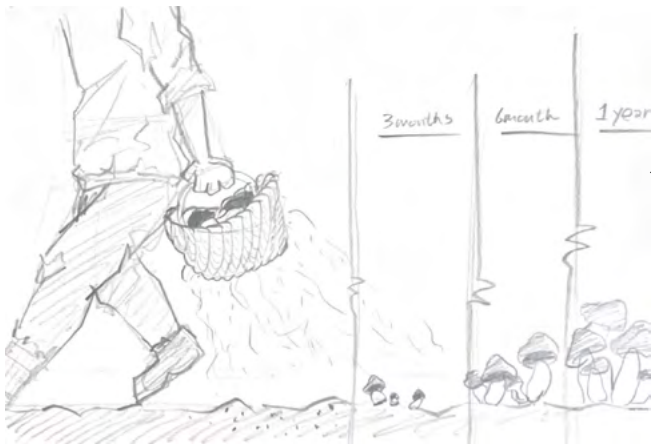

Just holding mushroom basket around spreads a spore. I applied this to my machine, spreading wild flower seeds. (Helps re-wild)

Machine that you can sit down on it, and roll it around the site when you need to move your sitting spot.

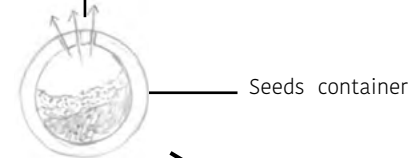
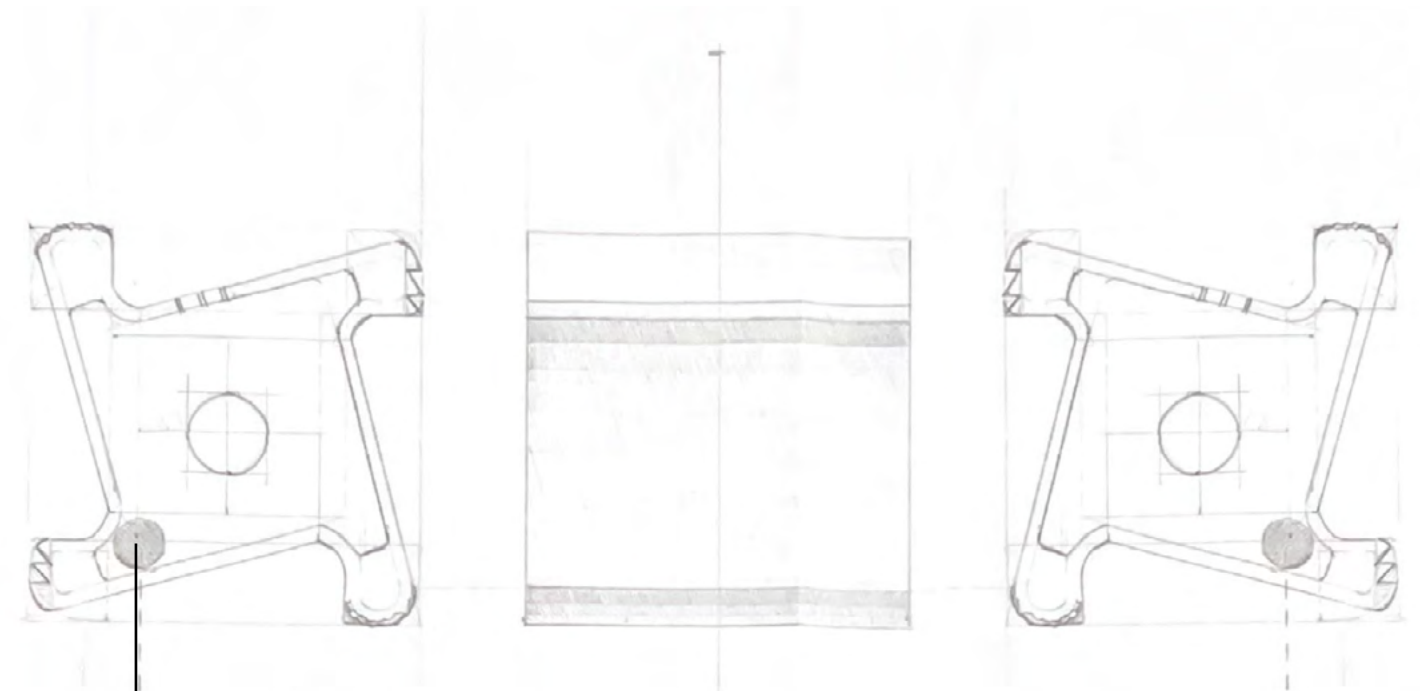
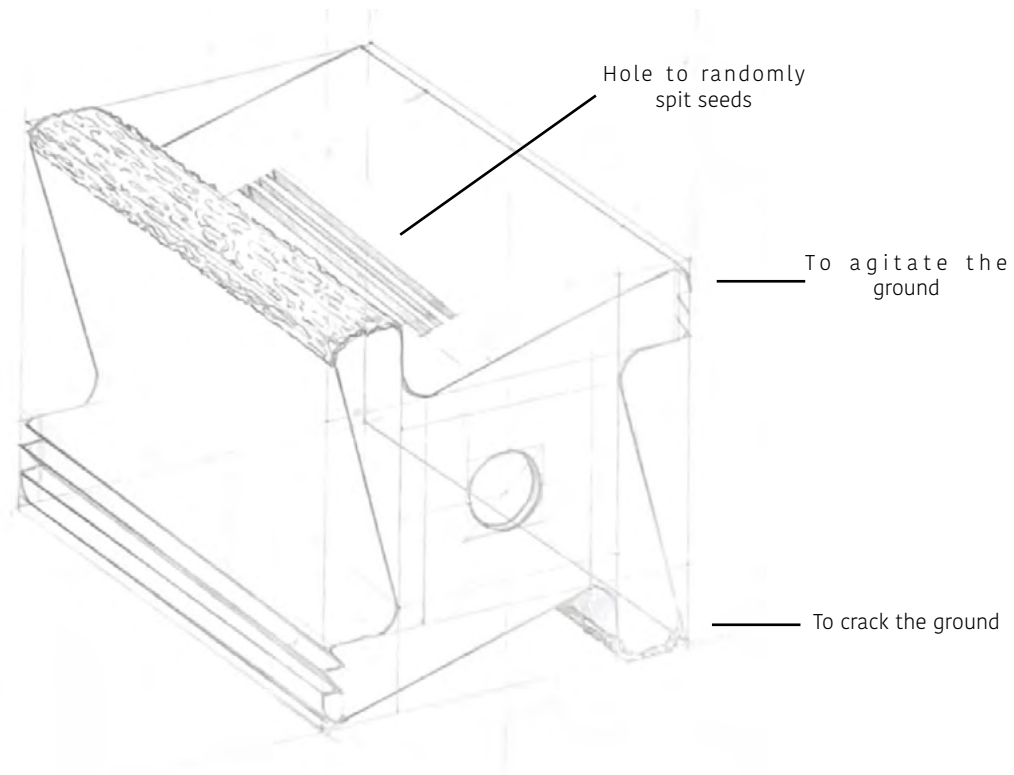
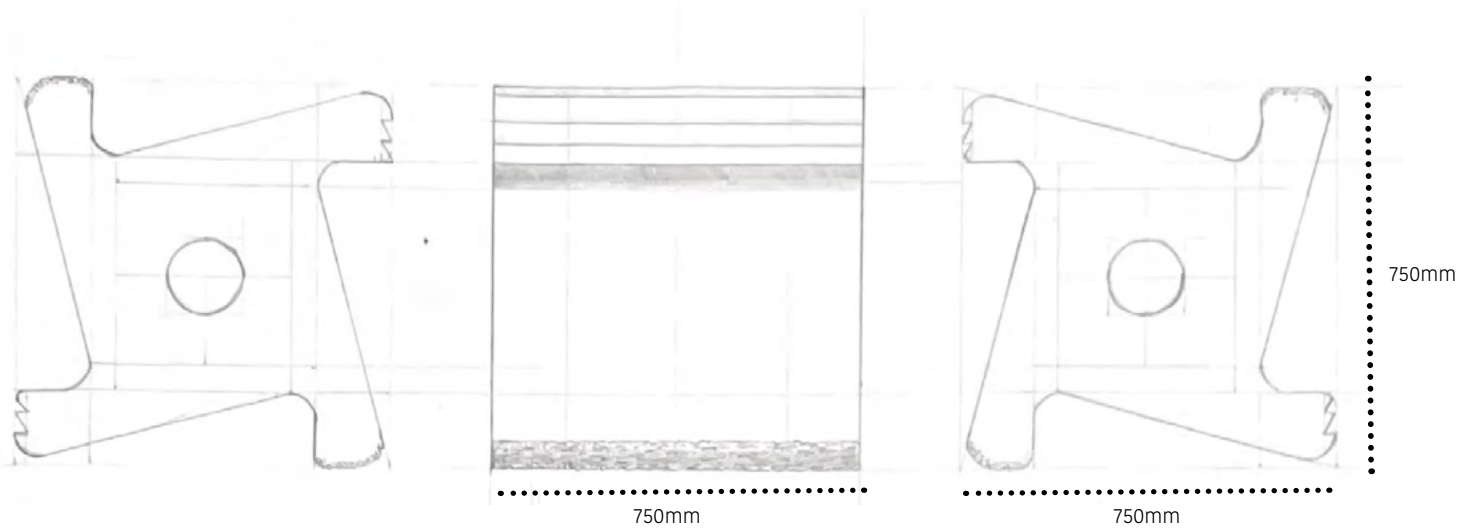

Hole to randomly spit seeds

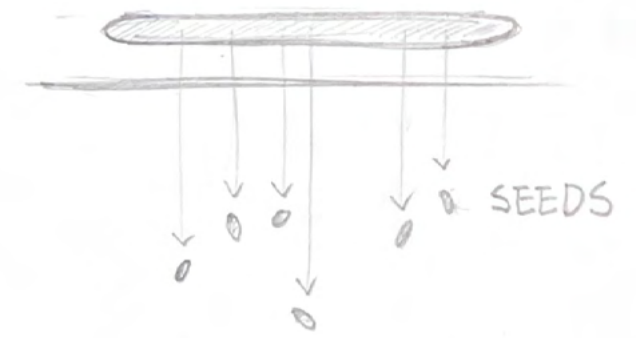
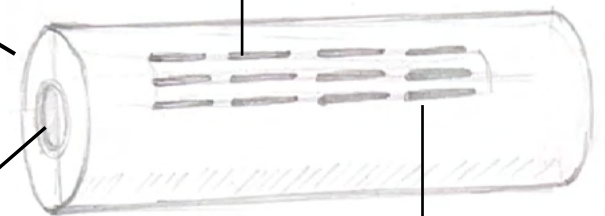

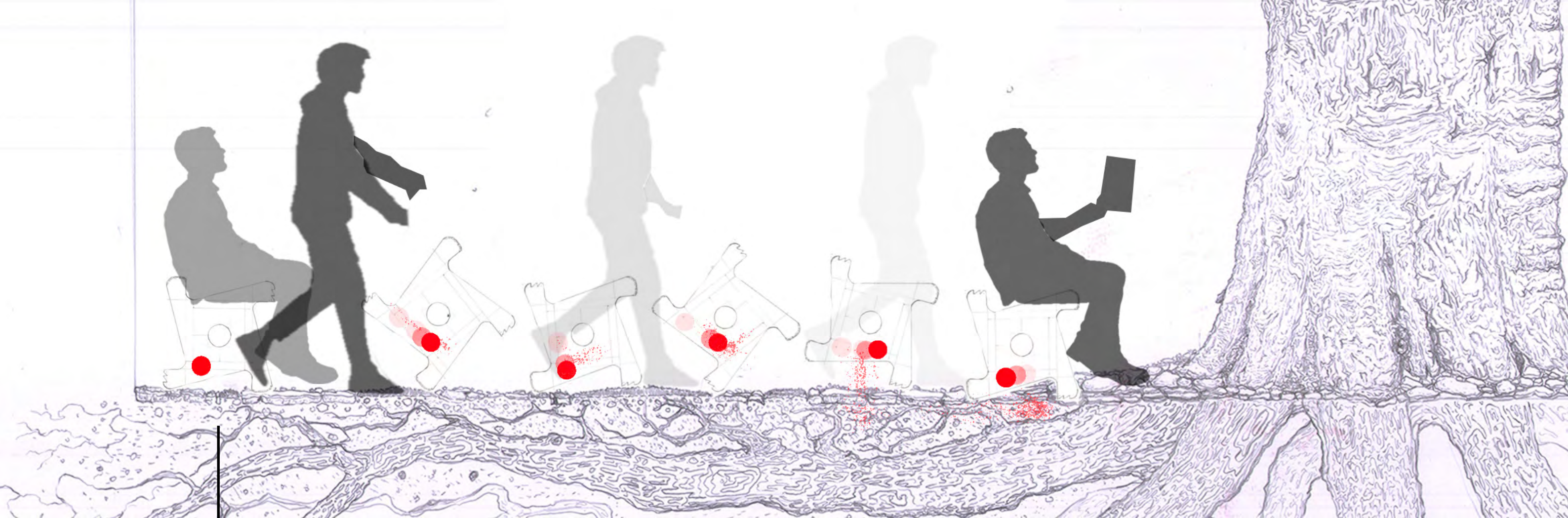

Showing what happens when people roll around this machine to change their sitting spot.

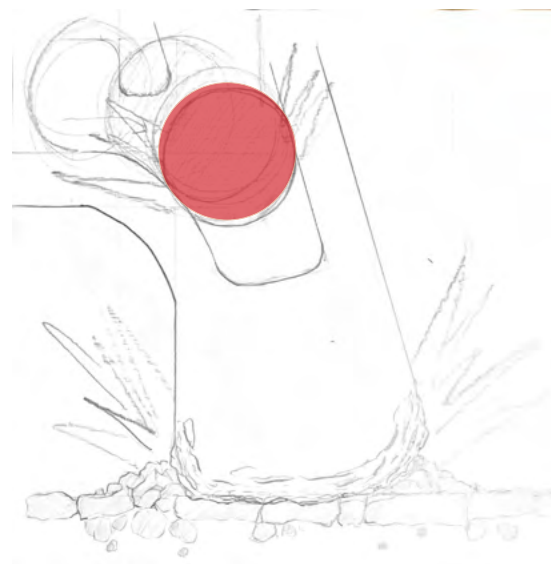

1. Making cracks/
cracks bigger

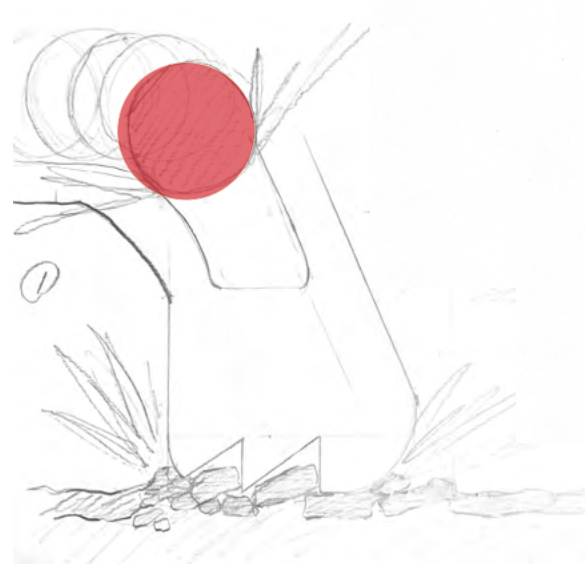

2. Agitate the ground, revealing
dirt



3. Spreading seeds to revealed
area

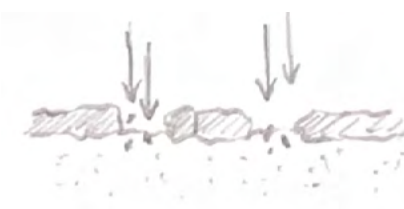

4. Plants grow



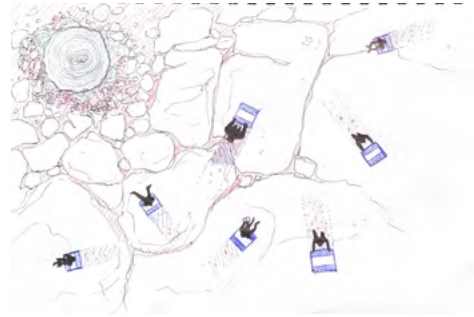

I made a stopmotion video about how it will effect to this site in 100 years.

You can bring this machine to anywhere, more than this site and help natures RE-WILDING.



~10 years



~50 years

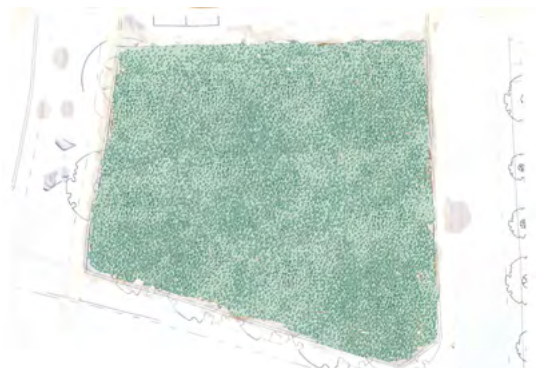

~100 years