



FLIRT FACTORY - A PLACE TO BE REAL, AND MAYBE FALL IN LOVE

Welcome to Flirt Factory — where butterflies are expected, eye contact lingers a little longer, and sparks are just waiting to fly. It's the kind of place where an online match turns into more than just a profile picture. And maybe, just maybe, someone worth holding hands with walks through the door.

First dates often come with a mix of nerves, curiosity, and quiet hope. Is this person real? Are they who they say they are? Will it be awkward? (Spoiler: probably just at first.) That's exactly why Flirt Factory exists — to turn the tension into play, the doubt into dialogue, and the awkwardness into laughter. It's not just a space to meet — it's where things click. Think soft lighting, cosy corners, and playful moments that make eye contact feel easier than small talk. Whether it's a first meeting or a test of “friends or more?”, the space helps set the mood for genuine connection.

It all starts with a calm, open lounge — a place to relax before the fun begins. From there, the journey moves through a series of light-hearted activities designed to break the ice and spark chemistry. The bracelet acts as a personal guide, unlocking each experience, tracking compatibility, and even offering a gentle way out if the vibe just isn't there.

As the night unfolds, who knows what kind of feelings might quietly sneak in...

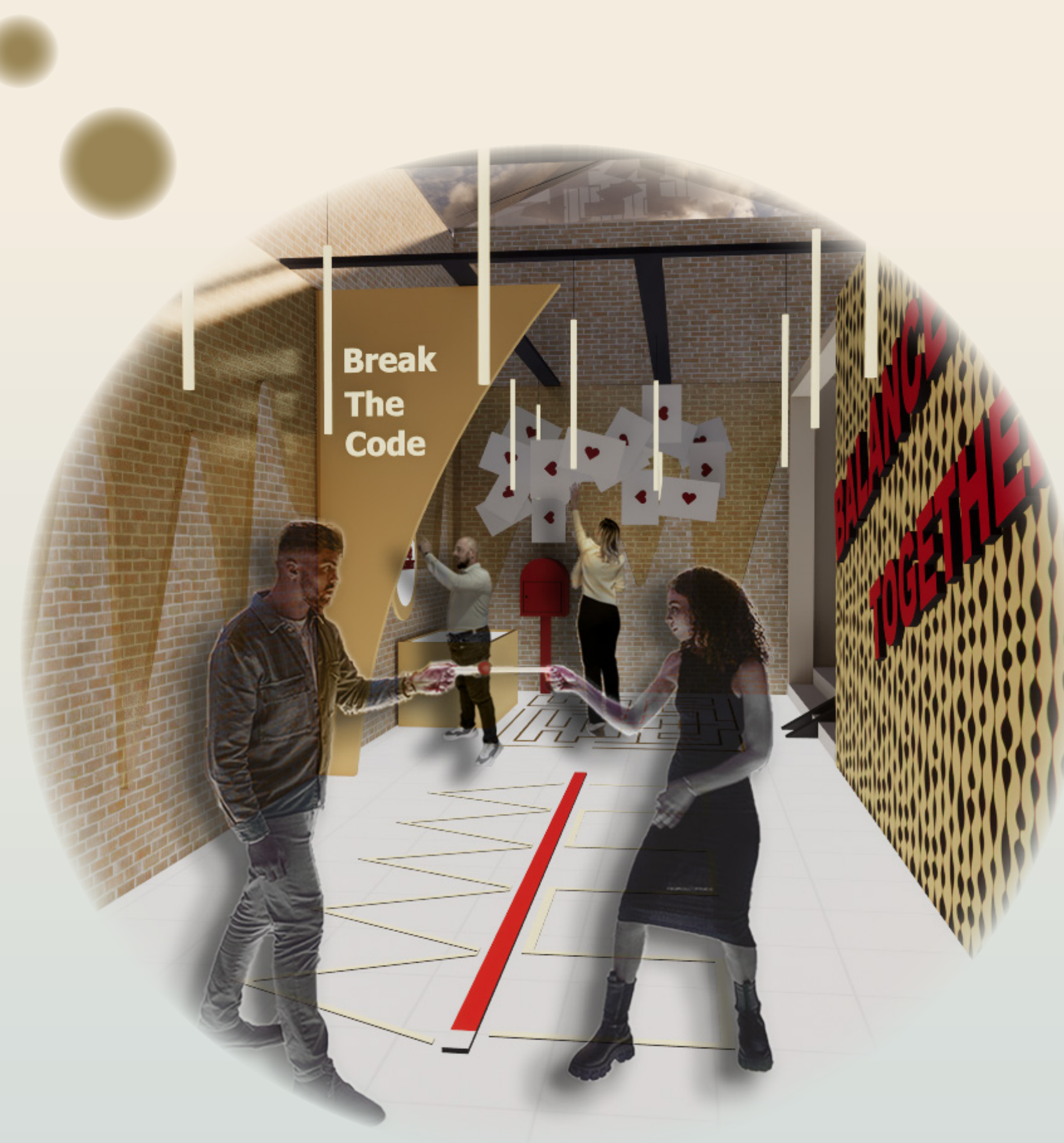
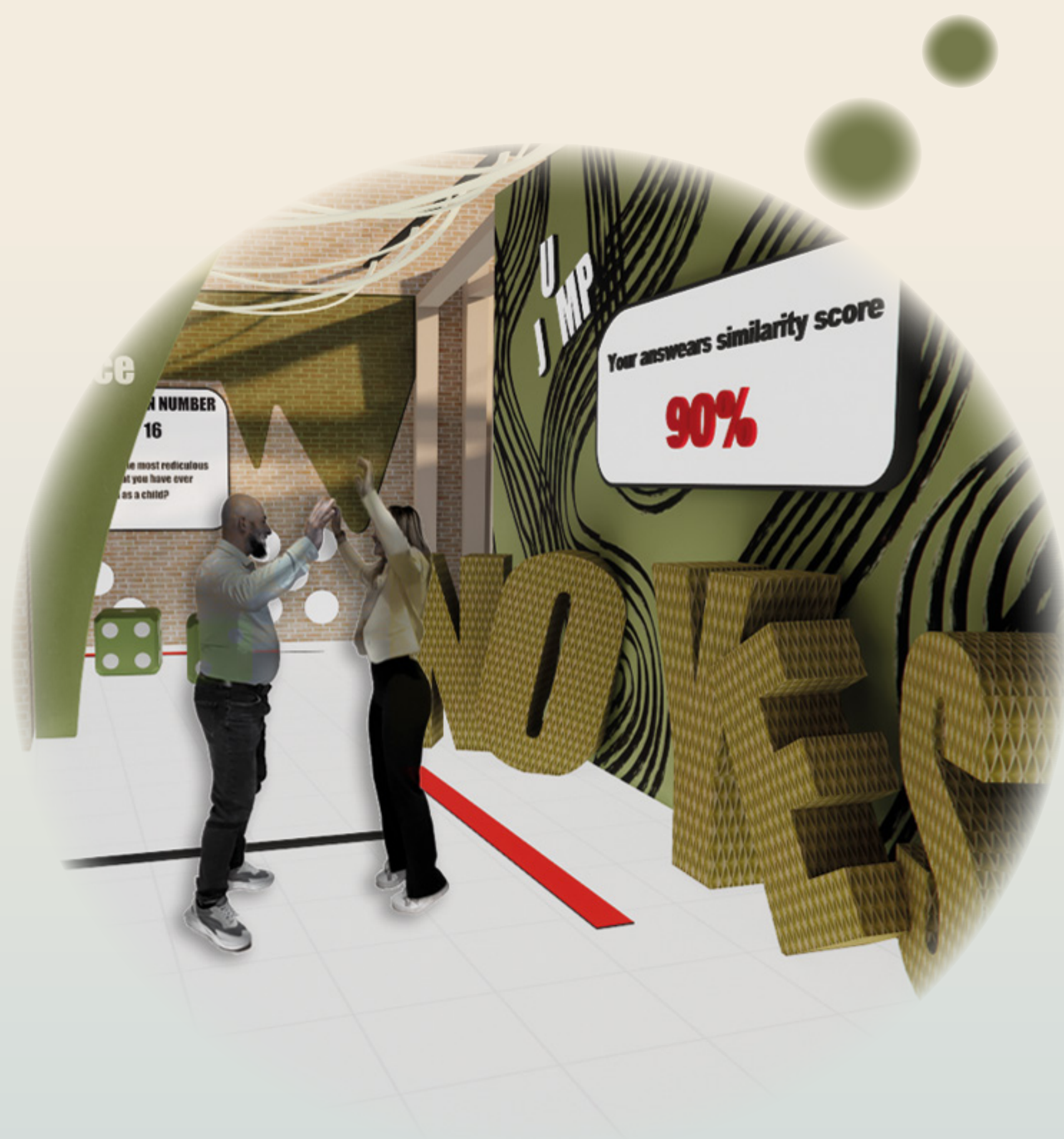

PROBLEM

Digital dating has taken over in recent years, offering a fast and easy way to meet new people. But with that rise comes real risks — from catfishing and fraud to data breaches and harassment. The excitement of a match can quickly turn into something uncomfortable, or even unsafe.

SOLUTION

Flirt Factory offers a playful yet secure space designed to support the growing dating app culture — but with real-world connection and safety at its heart. With over 349 million users on dating apps worldwide, most between 25–35 and often looking for serious relationships, there’s a clear need for safer spaces. Flirt Factory fills that gap, helping to reduce fraud, protect personal data, and create a setting that puts comfort and consent first — without killing the vibe.

LOCATION



72-74 Great Central St,
Leicester
LE1 4JT

HOW PEOPLE DATEED IN THE PAST?

Before the digital swipe era, dating relied on real-world connections — through mutual friends, school, community events, or shared social circles. In smaller towns and villages, reputation played a huge role. Word spread fast, and someone’s behaviour — good or bad — was often known before a first conversation ever happened. Familiar faces and trusted environments made dating feel safer and more natural. People had the chance to observe each other in everyday settings, picking up on habits, manners, and how someone treated others — all before deciding if they wanted something more. It was less about guessing and more about getting a sense of someone, gradually and organically.

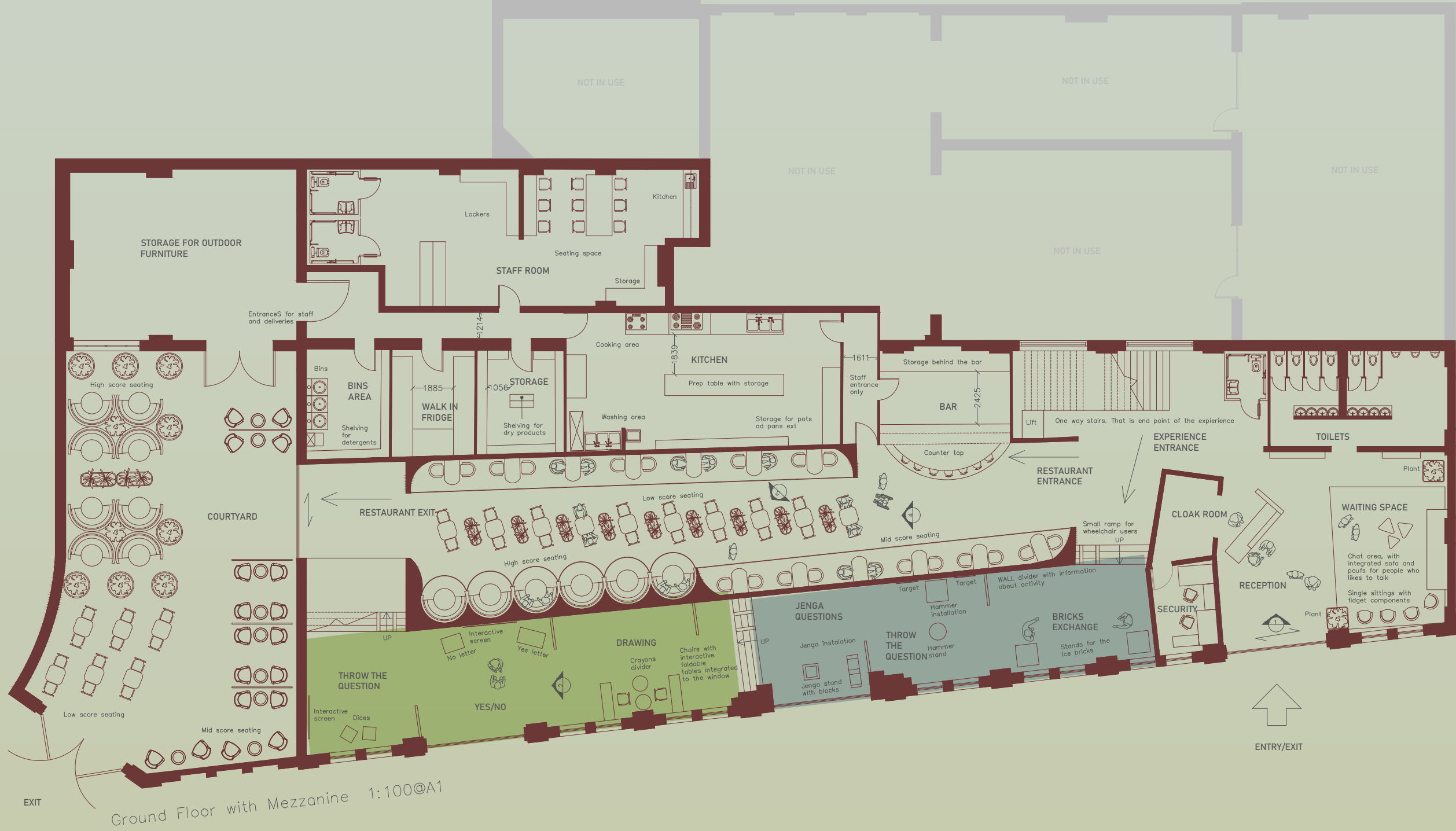
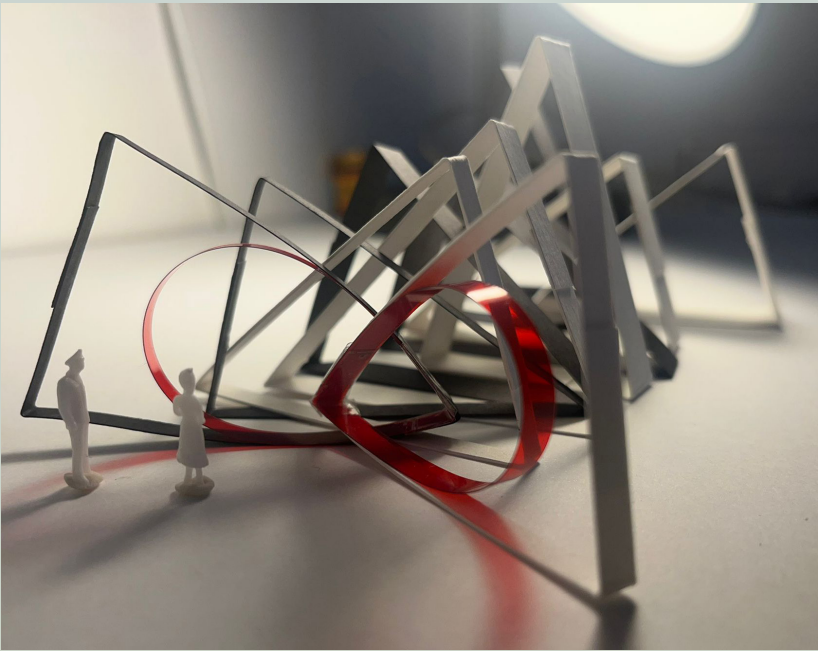
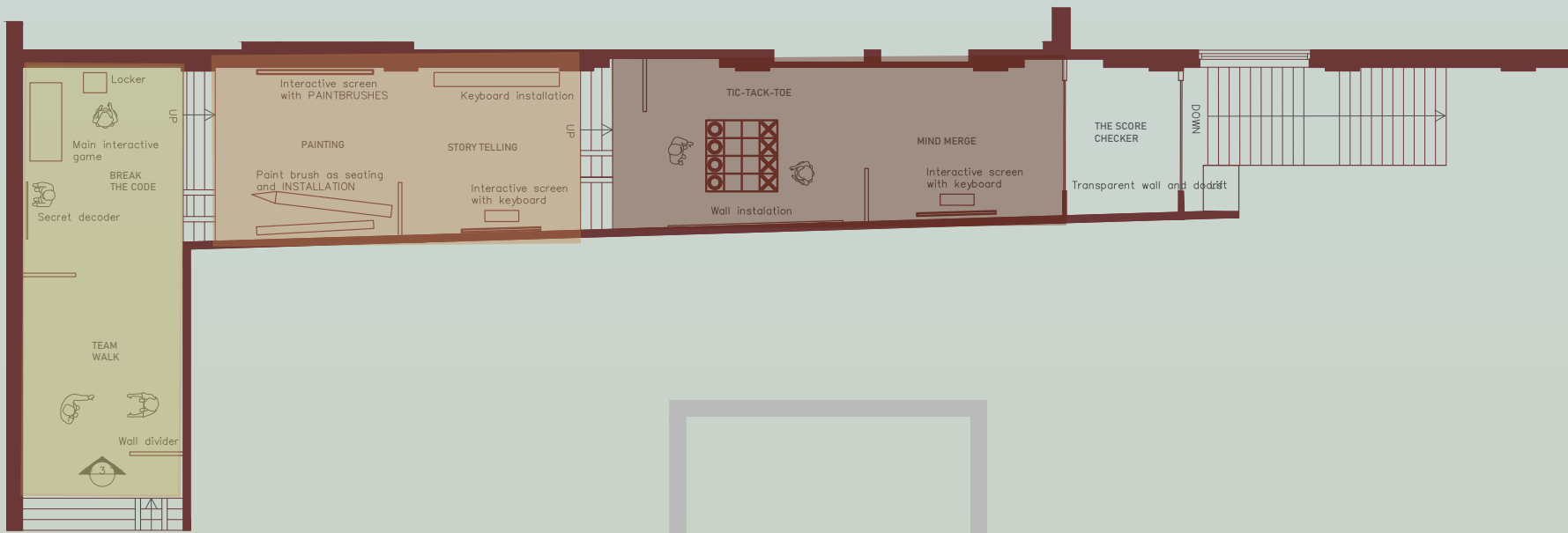

KEY DESIGN FEATURES:

- No walls, no pressure, just easy movement and eye contact;
- High security so everyone can feel relaxed and comfortable;
- Bracelet-activated games – a simple tap starts the fun;
- Soft gradient colours;
- Each area is slightly raised to help guide the flow;
- Time limits keep things fun and fast;
- The floor lights up and responds, adding a little extra sparkle.

Communication zone contains:

- Let's Draw- this playful challenge puts two people back-to-back with interactive drawing tables. One gives the instructions, the other draws. It's a test of communication, trust, and how well directions are followed;
- Yes/No – participants answer quickfire questions by jumping to a side – “yes” or “no.” Every answer reveals a little something: belief in soulmates, karaoke habits, or whether pineapple really belongs on pizza;
- Roll the dice – Two oversized dice hit the floor, revealing a surprise question on the screen. From bold confessions to playful ‘Would You Rather’ dilemmas.

Breaking The Ice zone contains:

- Ice Exchange – coloured ice bricks fly back and forth while the clock ticks – and not a single one can hit the floor. It's fast, funny, and the perfect way to break the awkwardness;
- Throw The Question – each person throws a rubber hammer at a big target. The top scorer picks someone to answer a surprise question. It might be deep, cheeky, or just plain unexpected;
- Jenga Questions – these giant Jenga blocks hide playful questions inside. When a block is taken, its question sparks a smile and a moment to keep the tower – and the vibe – standing strong.

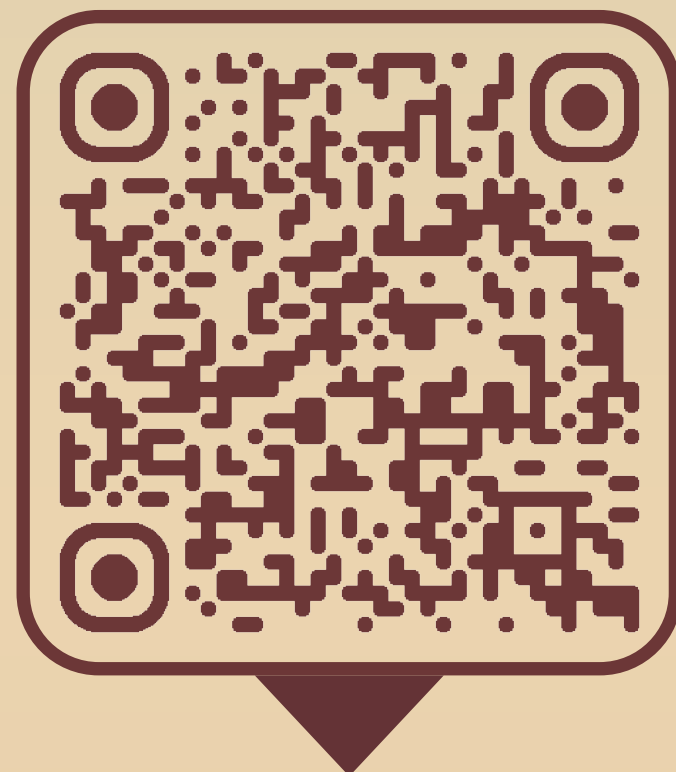
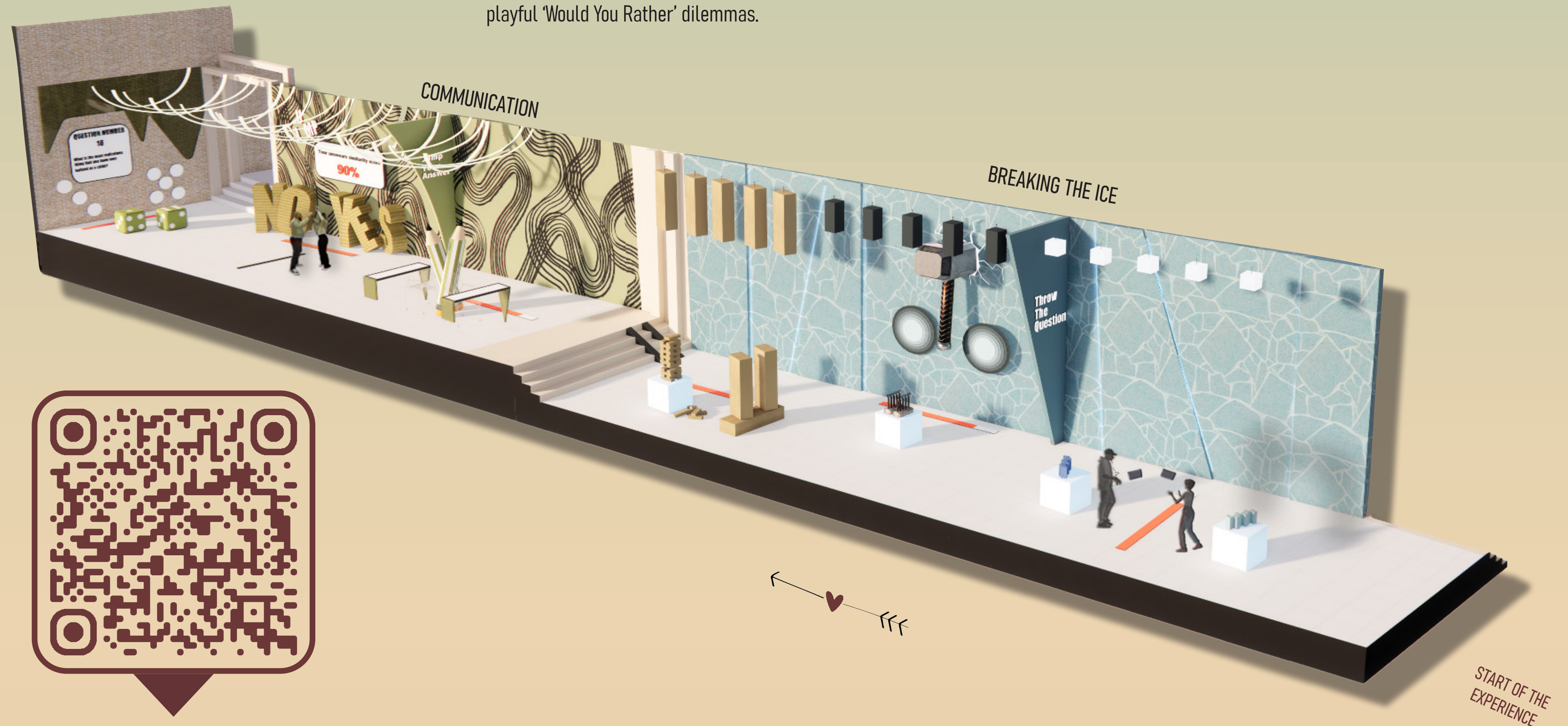

SCAN ME
AND ROLL THE DICE

Creativity zone contains:

- Painting – one digital canvas, two minds. Each person gets 30 seconds to add their touch, building a fun and totally one-of-a-kind piece of art;
- Story Telling– one sentence at a time, a wild little story is born. Each person adds the next line on a digital screen.

Cognitivity zone contains:

- Tic-tac-toe – a giant, floor-sized classic. Players take turns placing physical pieces on the glowing grid – simple and perfect for some playful rivalry;
- Mind Merge – a random image, sound, or idea appears on the screen. Both players write down three words they think fit best – it's a fun way to see how much their minds really click.

The Score Checker

to unlock this final space, both participants scan their bracelets together. Inside room with screens on either side share playful snapshots about each person, pulled from their answers throughout the night.

The room glows with clear walls and smart lighting that shifts colours and sounds based on their match score. Whether it's a soft red or a pastel blue, the mood sets what's next.

And here's the twist – their score also decides where they'll sit for dinner, turning the night's connection into a shared meal (and maybe something more).

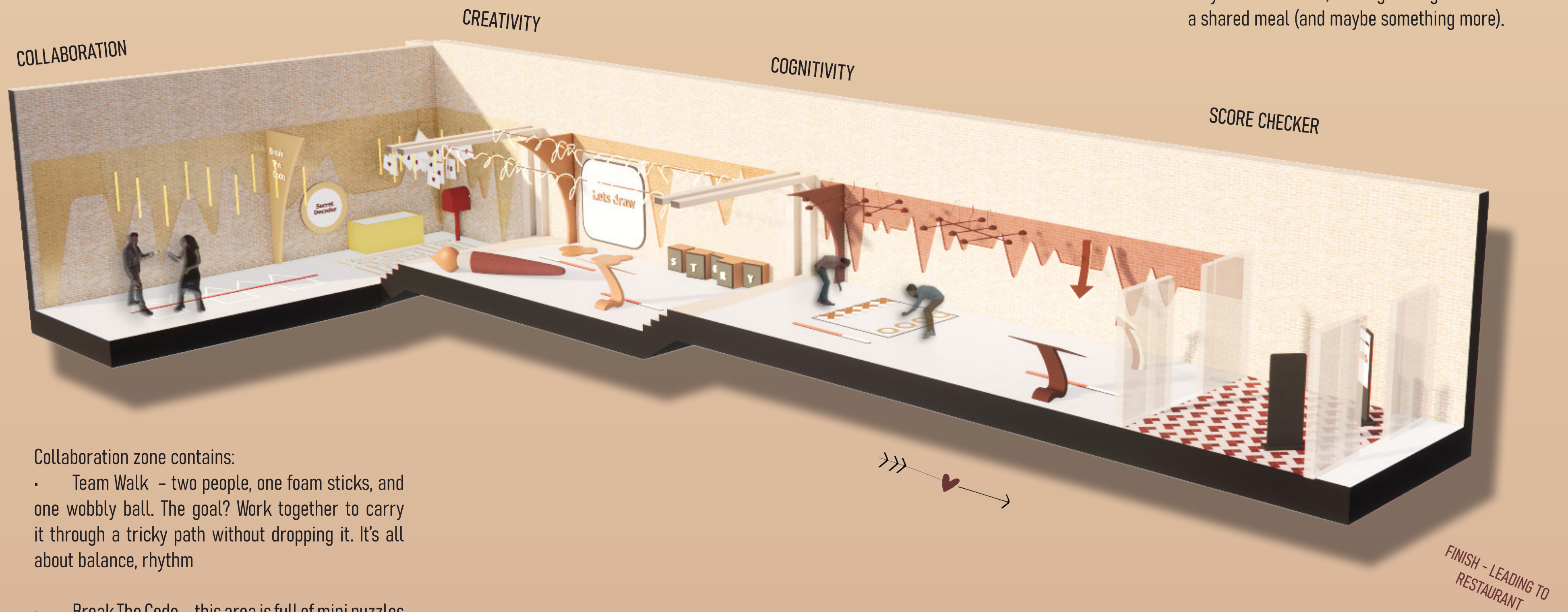

Collaboration zone contains:

- Team Walk – two people, one foam sticks, and one wobbly ball. The goal? Work together to carry it through a tricky path without dropping it. It's all about balance, rhythm
- Break The Code – this area is full of mini puzzles waiting to be cracked. Teaming up is the only way to open the red letterbox... and reveal a little surprise inside



BECAUSE EVERY GREAT CONNECTION
DESERVES A DELICIOUS FINISH!



From heartbeat to shared moments, Flirt Factory sets
the vibe and leads straight to the perfect spot for two.

