

# ABOUT

The Power of Movement is a dance theatre with accompanying bars, celebrating rhythm through architecture. Grand, repeating forms echo the choreography of dance itself. The modular structures separate the space with layered arches and sweeping curves that mirror the dancers' bodies.

Movement becomes space, and space becomes movement, showcasing energy, performance, and community in seamless harmony.

# THE POWER OF MOVEMENT

By Hatty Daly

This project's design outcome was achieved through experimental and ambitious conceptualisation through hand crafting models utilising different mediums. Sketch modelling with paper and card, acrylic modelling, refined woodwork and metalwork were all explored to create moving, interactive structures, embodying contemporary dance and architecture.

## RYTHMIC LUMINOSITY Concept Model

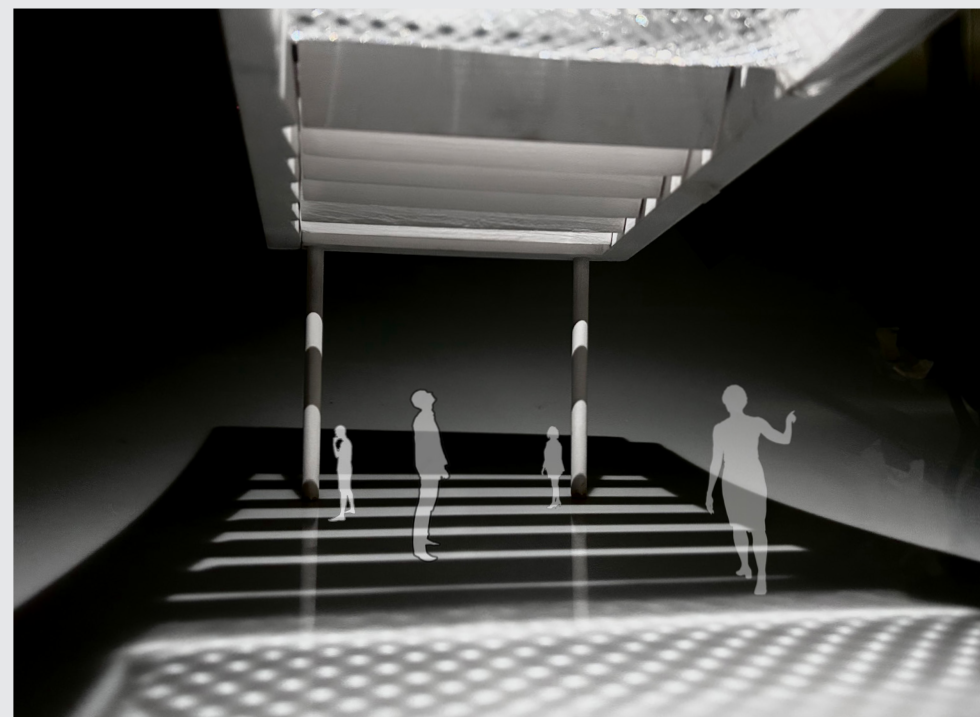
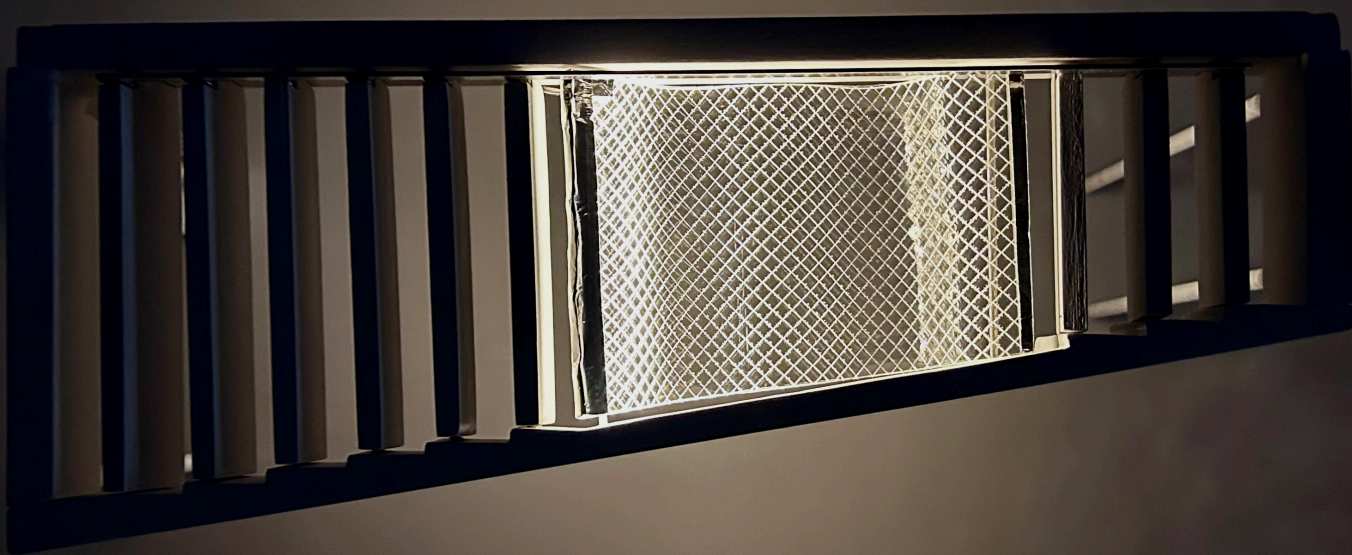

SCAN TO WATCH IT MOVE!

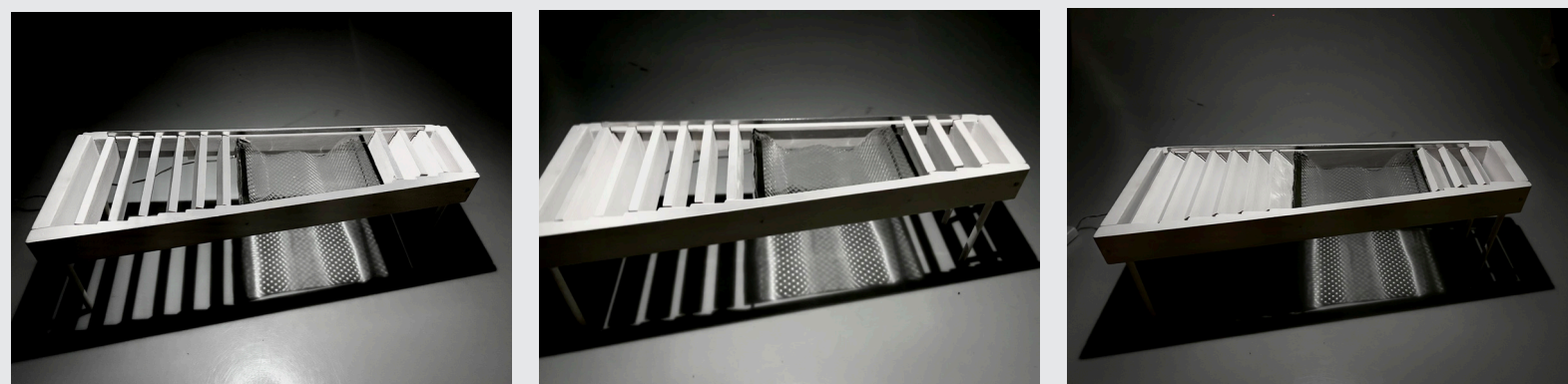

Showcasing the moving louvers, how they close to block light and open to create dynamic shadows on the floor.

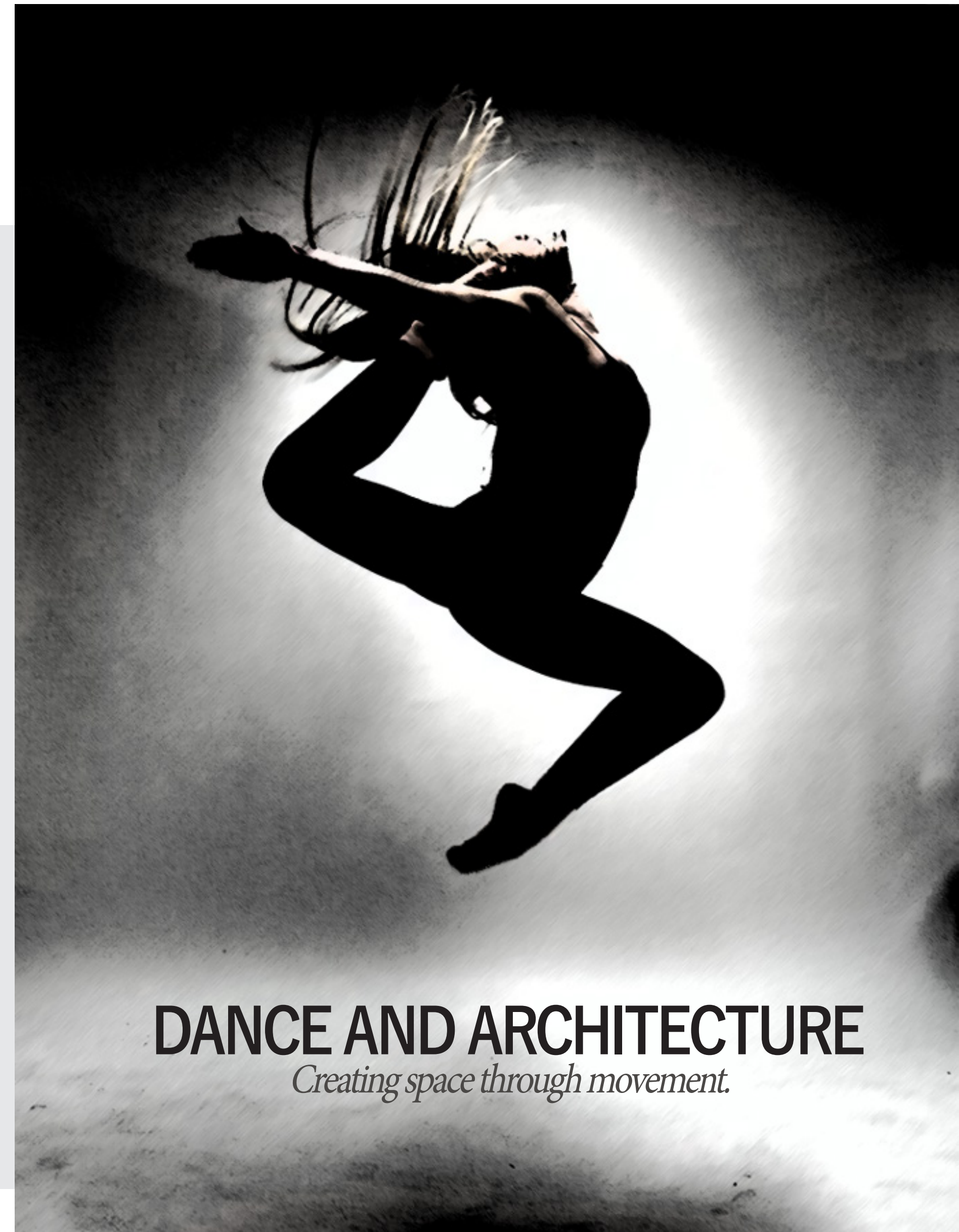

## DANCE AND ARCHITECTURE

*Creating space through movement.*



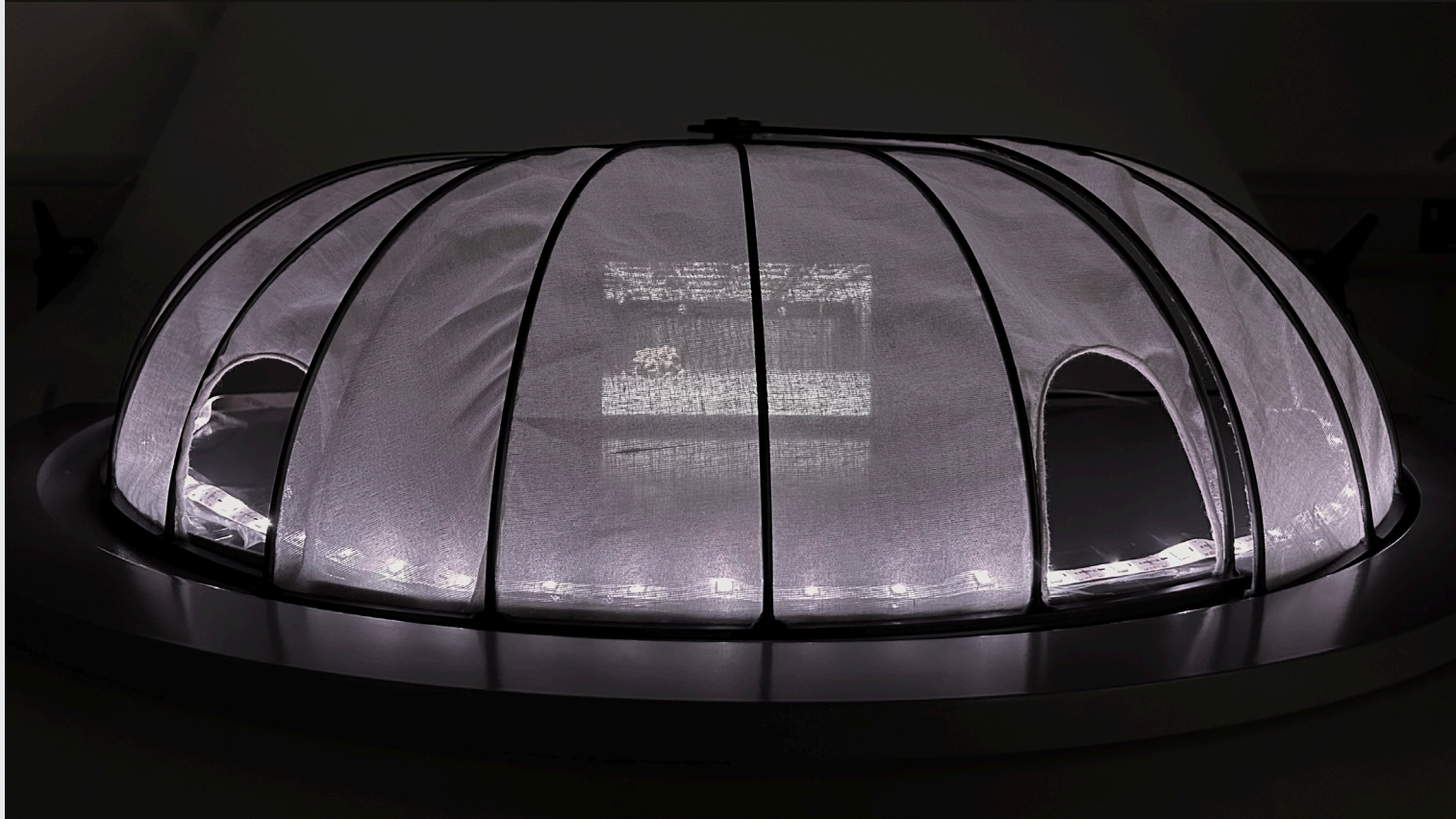
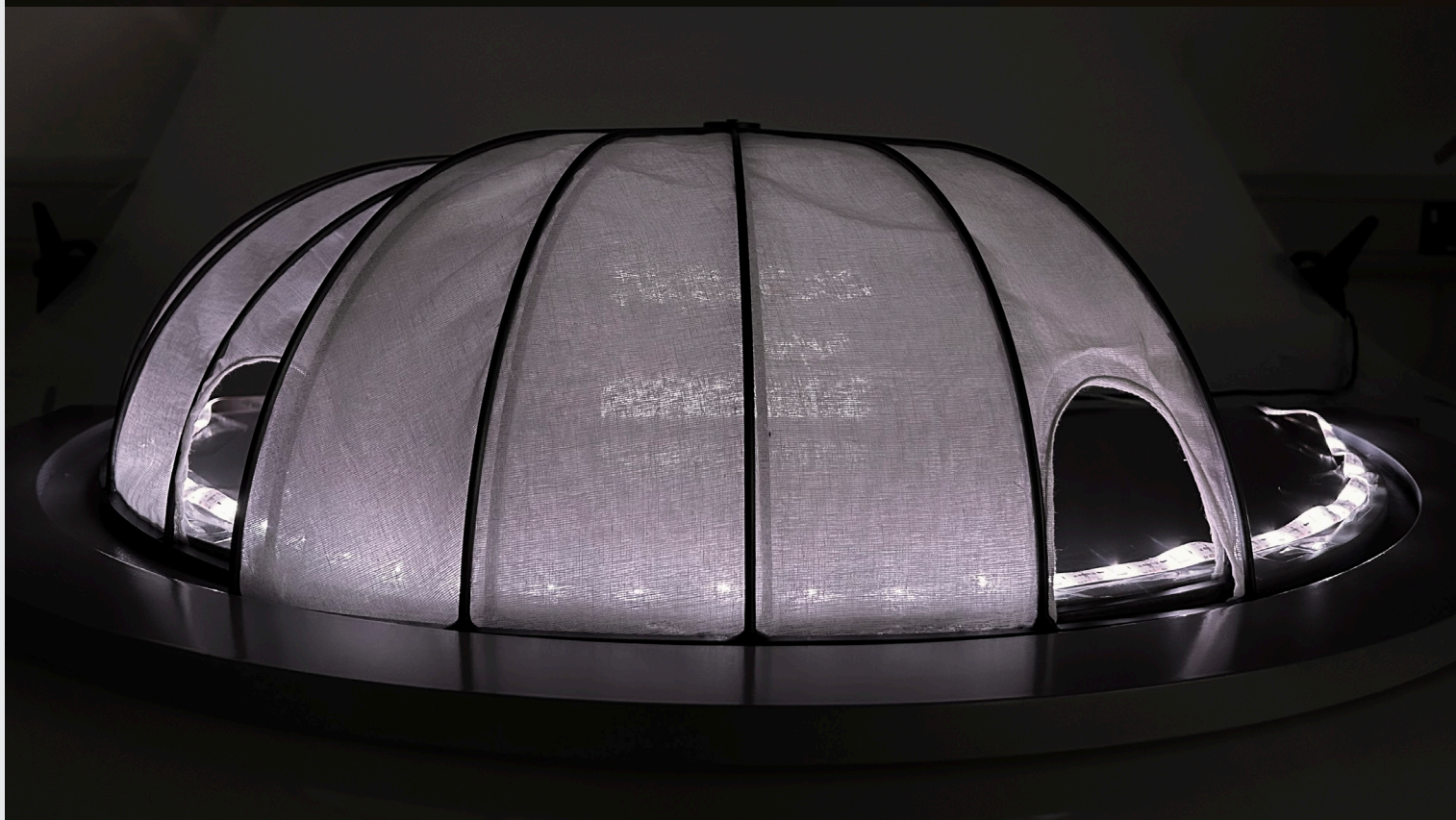
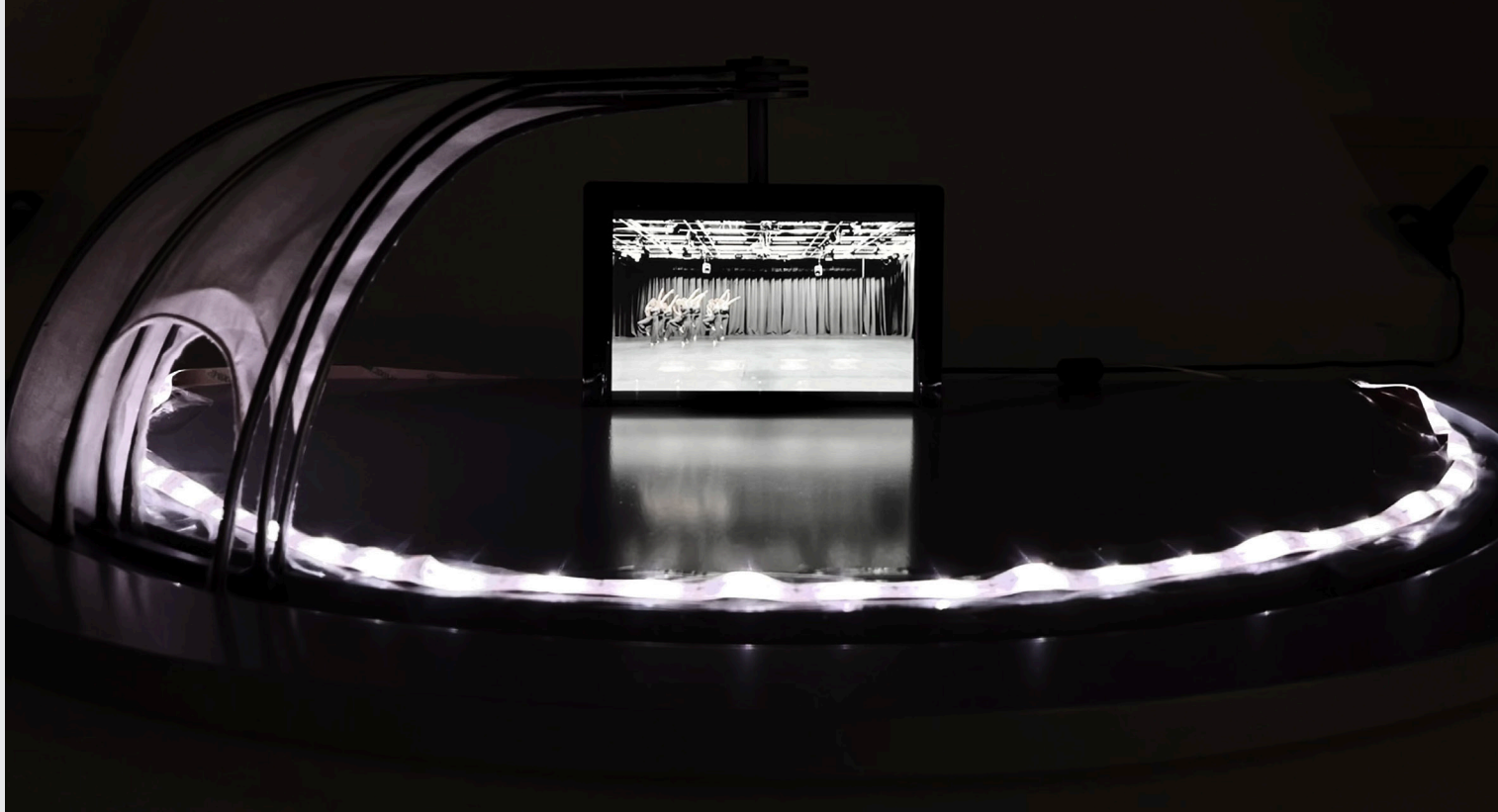

# THEATRE DOME SCALE MODEL

1:30 Scale model of theatre dome. This dome continues the motif of modular structures throughout the space, creating a smaller, intimate performance environment when closed and a vibrant, exposed space when open. With a light, UV resistant, cotton fabric surface, the structure allows for some natural light to shine through whilst retaining the dynamics of the stage light.

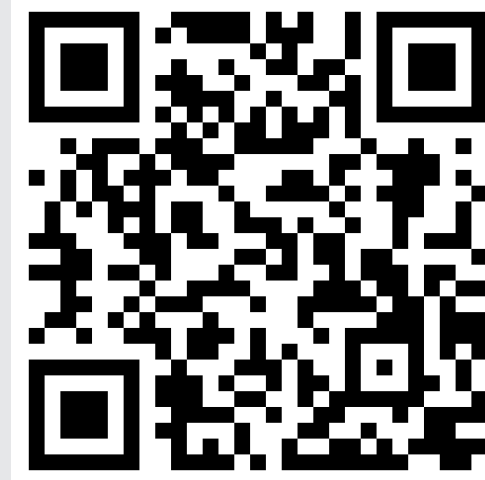
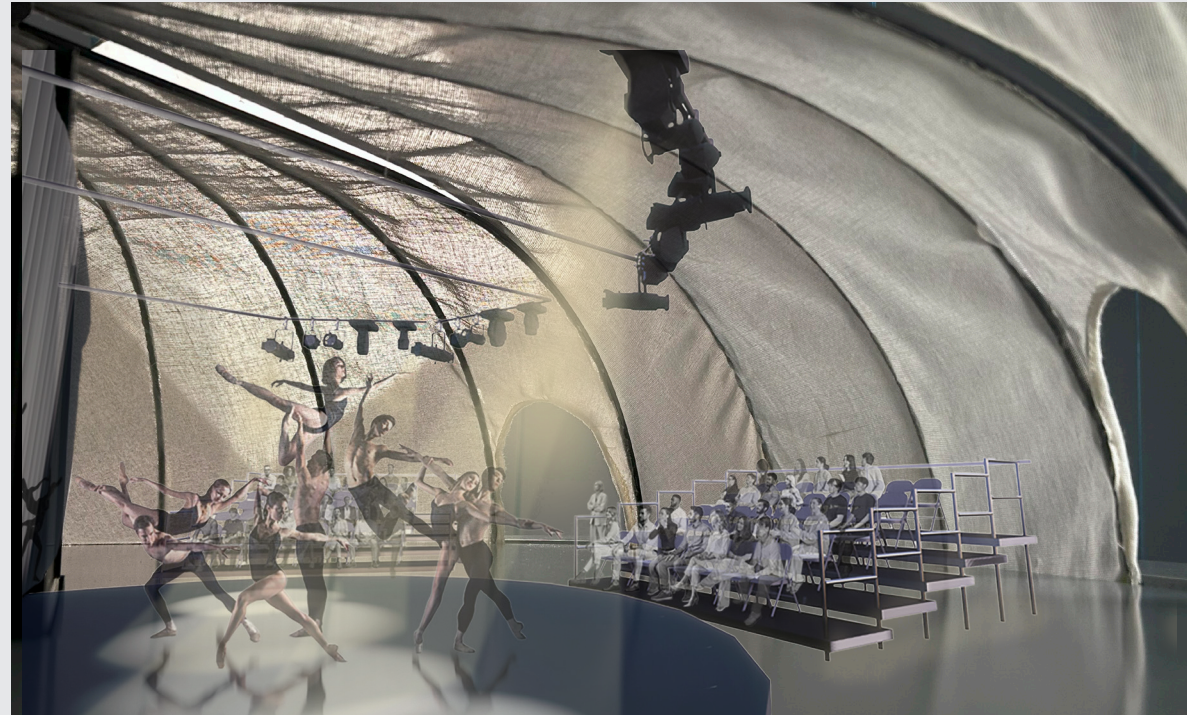

SCAN TO WATCH IT MOVE!

## CONSTRUCTION:

*Concept Model:*  
DESIGNING AND PROTOTYPING

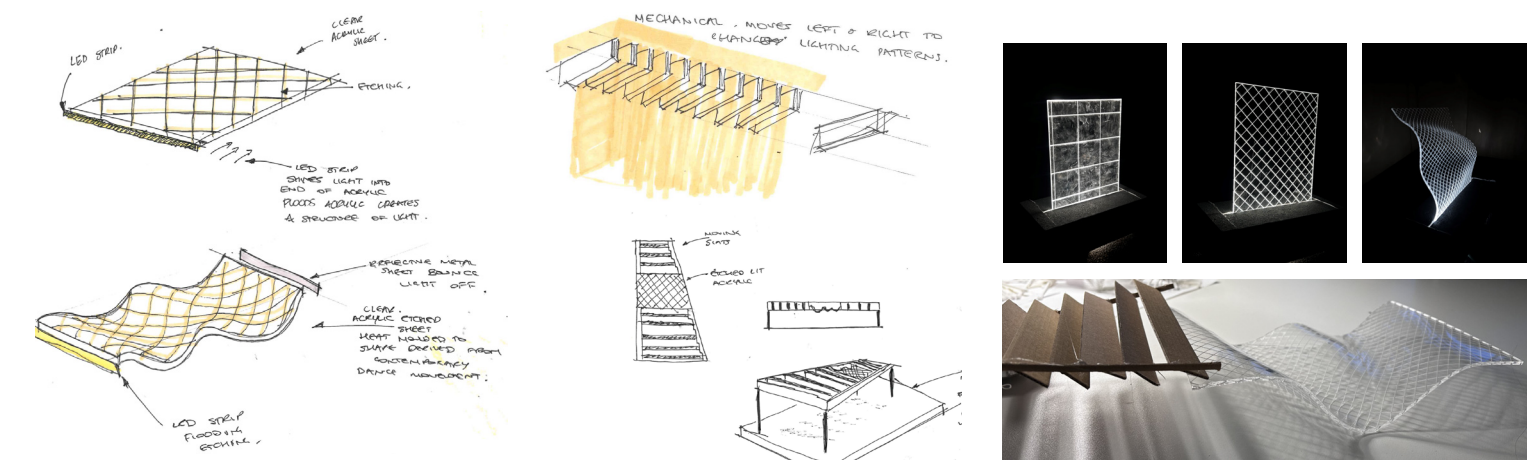

### MAKING

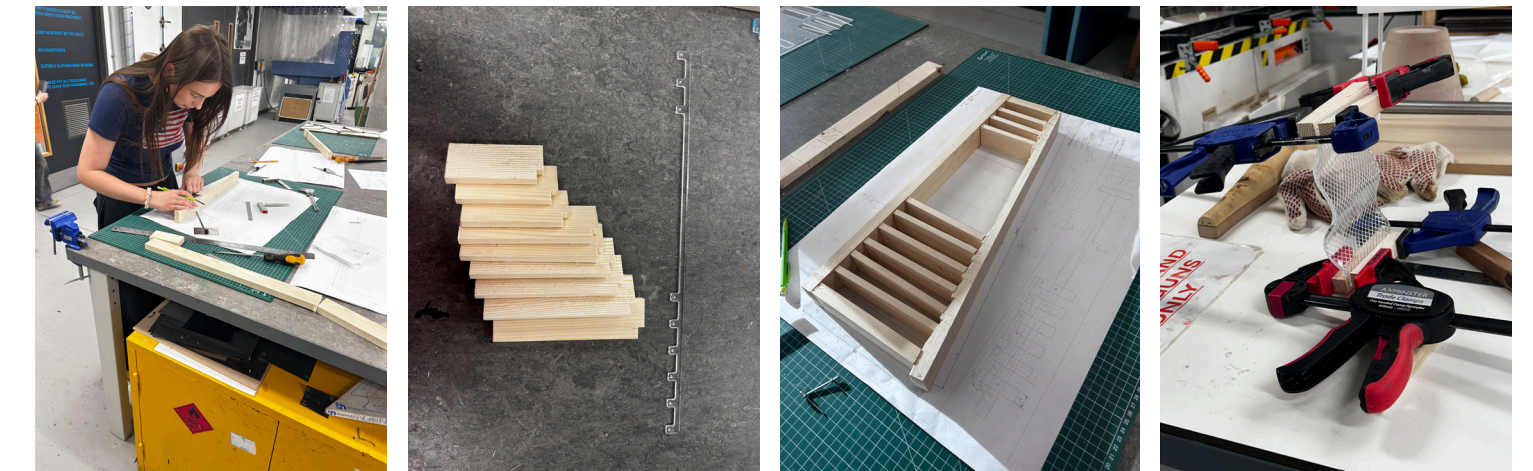

*Theatre Dome Scale Model:*  
DESIGNING

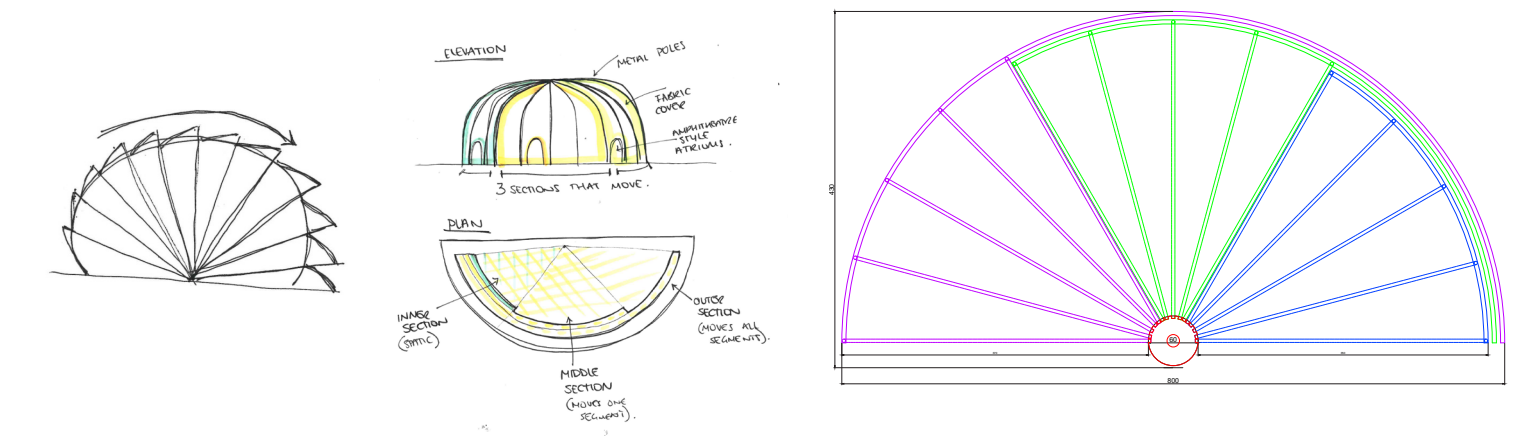

### MAKING

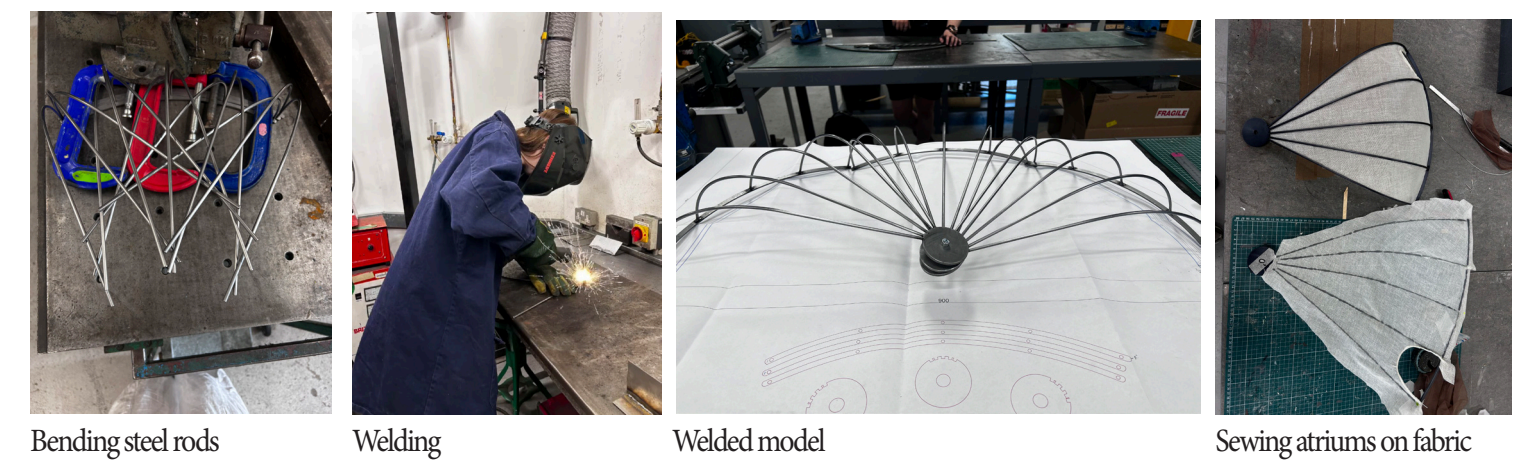

Sketches  
and sketch  
modelling:

