

# HAME

## DUNDEE



HAME Dundee aims to provide a new living experience for everyone, and offer an alternative to those who otherwise might face deep isolation. Targeted at people aged 18-25 and 65+, the unit wants to bridge a gap between two generations who are quite often at odds with each other. By creating spaces for them to interact and create meaningful relationships, while also giving them room to assert independence, the different age groups will be able to create a harmonious environment where they can learn and grow together. The Unit is also set in an old community centre within the Blackness Conservation Area of Dundee; left derelict for years, this project has the opportunity to uplift and transform the formal industrial district and spread a regenerative spirit throughout the city. The local community would be encouraged to contribute and grow with the scheme, with spaces provided to facilitate this.

A NEW COHOUSING UNIT IN THE BLACKNESS CONSERVATION AREA OF DUNDEE DESIGNED TO BRIDGE THE GAP BETWEEN THE ELDERLY AND YOUNG ADULTS

# SITE

# DUNDEE

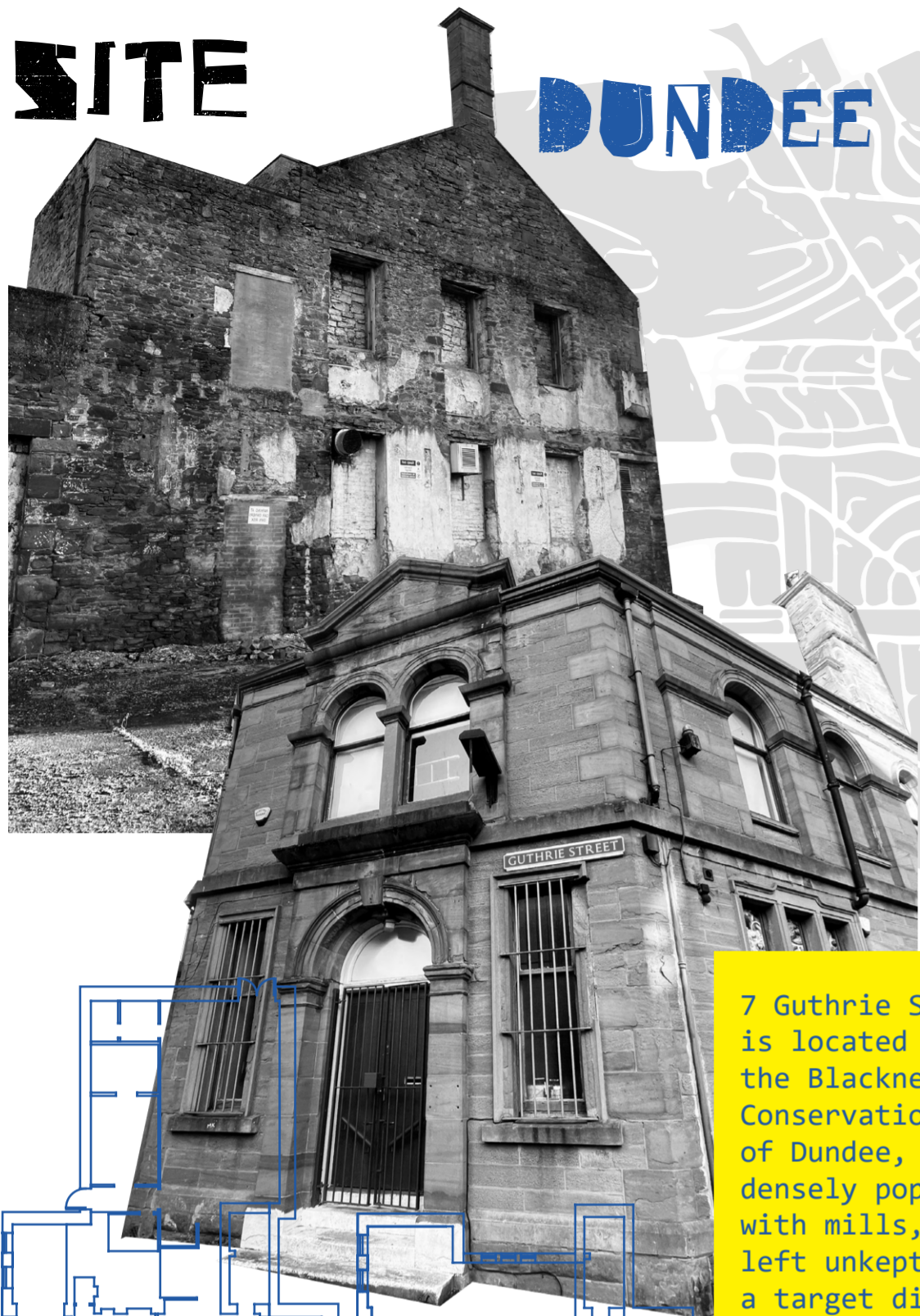

7 GUTHRIE STREET

One of the defining features of Dundee is its chimneys, which can relate to the idea of fire. Hearths have typically been related to storytelling, allowing shared connections between old and new through memories.

Materials always play an important part in design, but here the materials tell a story, taking old industrial, historical and new materials to tell the story of the city and what is to come, much like what this unit is trying to achieve.

7 Guthrie Street is located in the Blackness Conservation area of Dundee, once densely populated with mills, now left unkept. It is a target district for regeneration and redevelopment, and perfect to bring the old and young together

## THEMES

### NEW AND OLD

The Blackness conservation area is ripe for new energy, but the past of its streets shouldn't be lost, the same should be said in this co housing unit, the older residents should be just as appreciated as the younger ones.

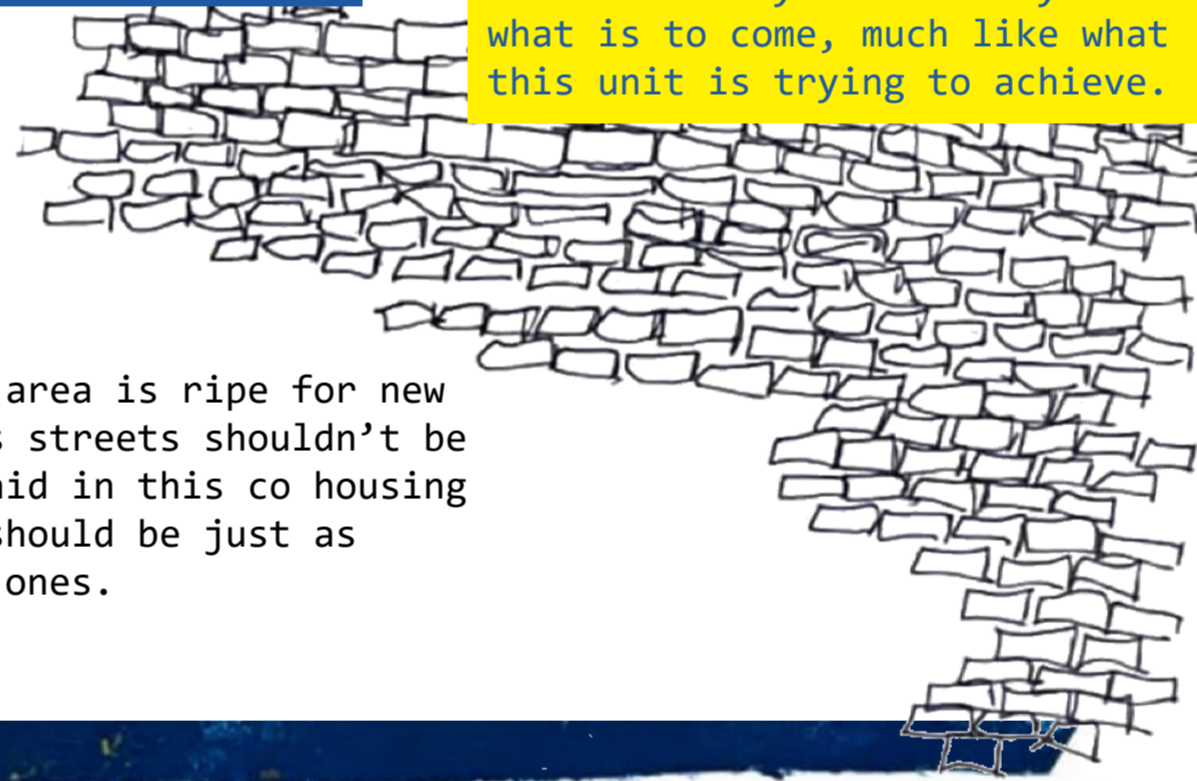

SLATTED OAK WOOD



BURLAP LINEN

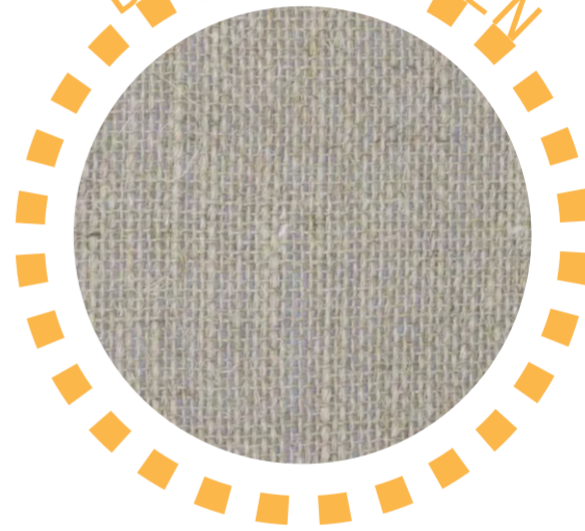

POLISHED CONCRETE

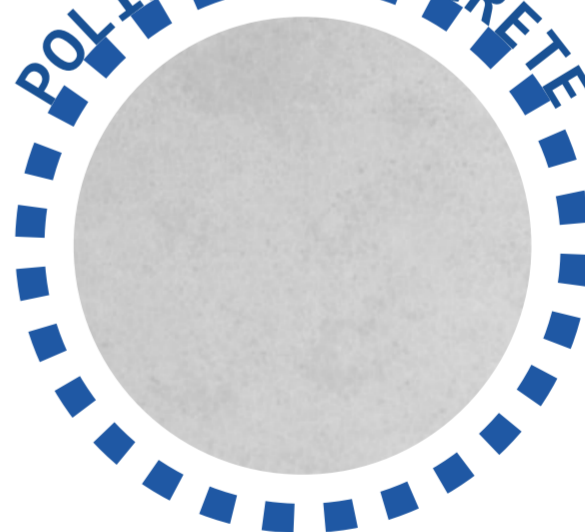

PARTIALLY PAINTED EXPOSED BRICK

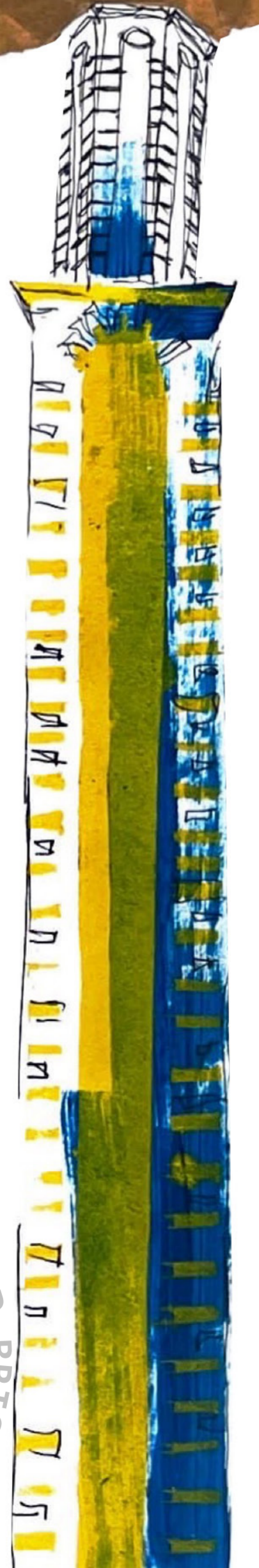

## CASE STUDIES



### UKO STANMORE

- Individual living units based around a central court yard
- private living areas are small and compact, encourages inhabitants into larger communal areas
- outdoor community space for a breath of fresh air



### MARMALADE LANE

- Private homes on a pedestrianised road with communal house and garden
- communal garden allows for local produce and cheaper groceries
- family friendly spaces that gives a break to parents



### SALLBO

- Private homes on a pedestrianised road with communal house and garden
- communal garden allows for local produce and cheaper groceries
- family friendly spaces that gives a break to parents

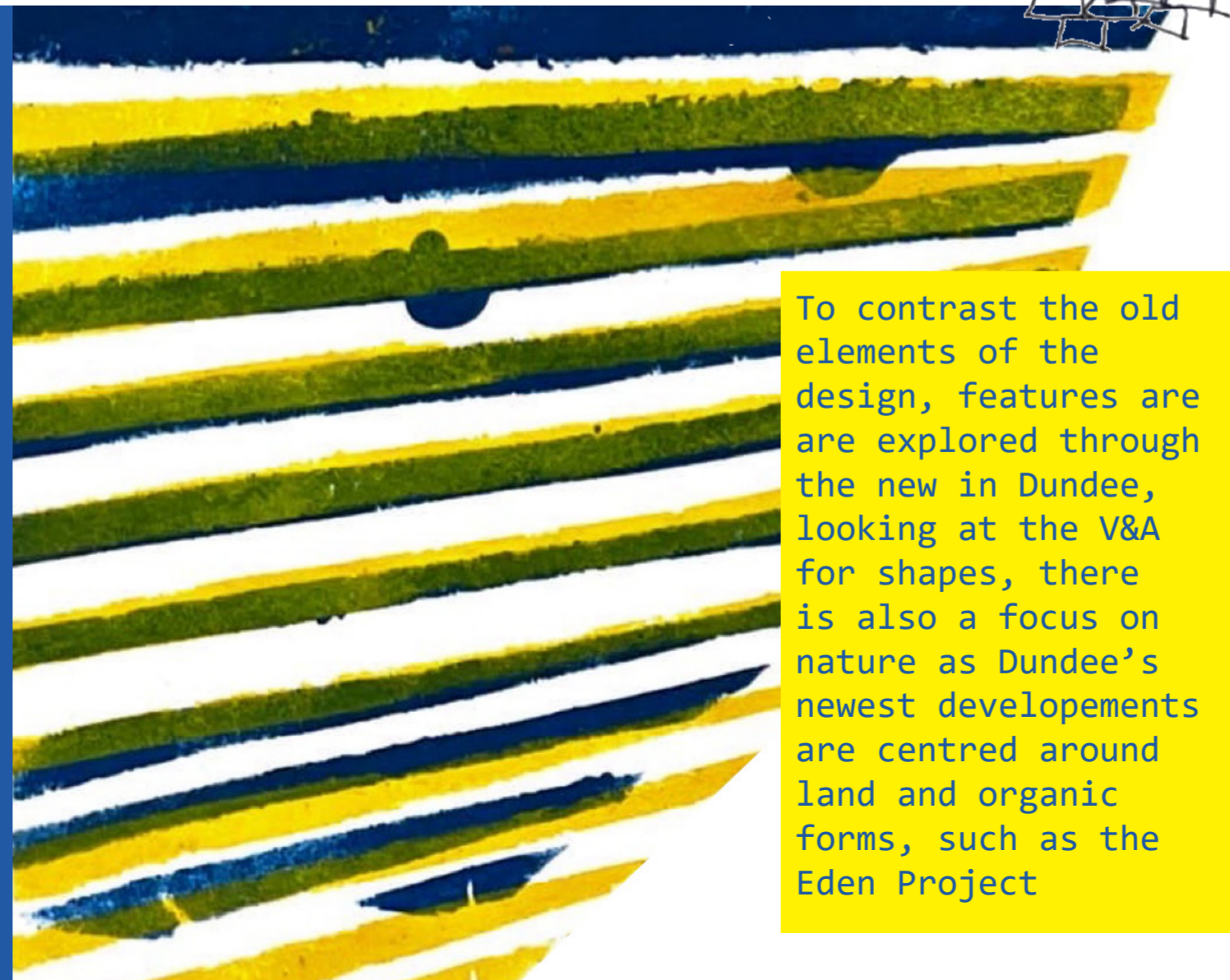

To contrast the old elements of the design, features are explored through the new in Dundee, looking at the V&A for shapes, there is also a focus on nature as Dundee's newest developments are centred around land and organic forms, such as the Eden Project



spatial sketches



# ENGAGEMENT TASK

An engagement task was also carried out, with two participants living in student accommodation and the other being a more elderly person living alone. Through activities of collage and word association, insights were gathered that showed a shared want for a space to be by themselves while also showing a positive view on the other age group, inviting a environment to induce intergenerational connection.

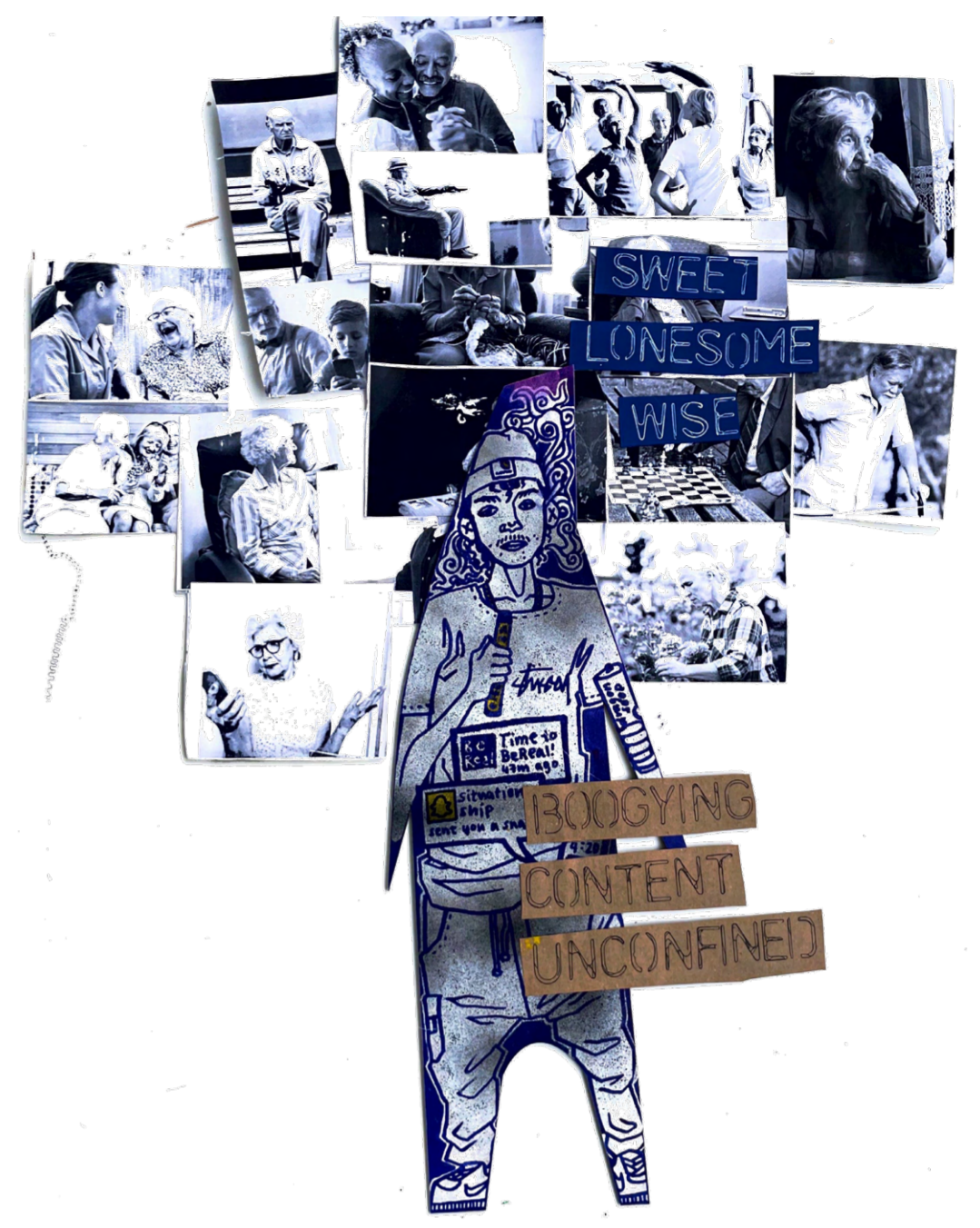

OPEN UP

Windows are fitted in every room looking out into the hallways, allowing passing residents to stop for a quick chat. A signal system is used, with an open window they are open to chat, a closed window means they don't mind if someone comes knocking, and a closed curtain signifies they do not want to be disturbed.

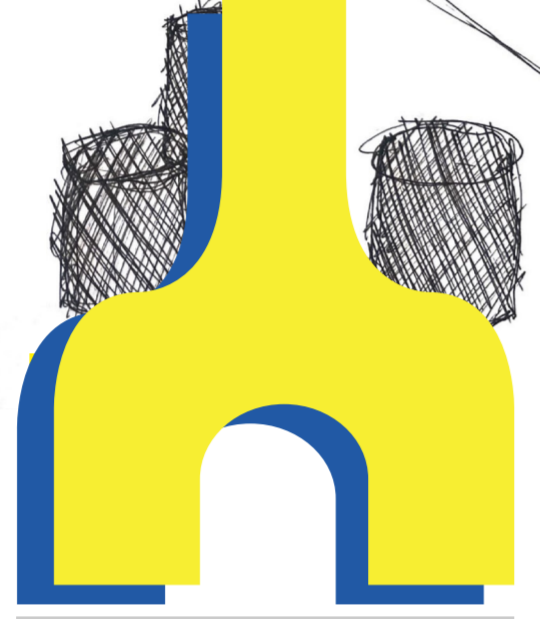

HEARTH

There are two fire places in the unit, one in the community space for cold winter nights, and one in the wider community space, perfect for late summer evenings and barbeques, for sharing stories and creating memories.

Development of the design started with sketchbook work, using different sketch and print methods to explore the shapes and forms of the building, and taking themes from this and the surrounding area to create a cohesive design language. One of the themes that developed was around the chimneys of Dundee, a historic feature of the city. They are also linked to the idea of hearth, so by creating a community feeling around this allows the older and younger residents to form relationships. This was also further developed through sketch modelling. Making the ideas 3D helped visualise the space, especially with zoning, to see how the space could be most effectively used. Through this process, windows became an important part of the design, letting people have a peak into other peoples lives, and so they were implemented into the interior.

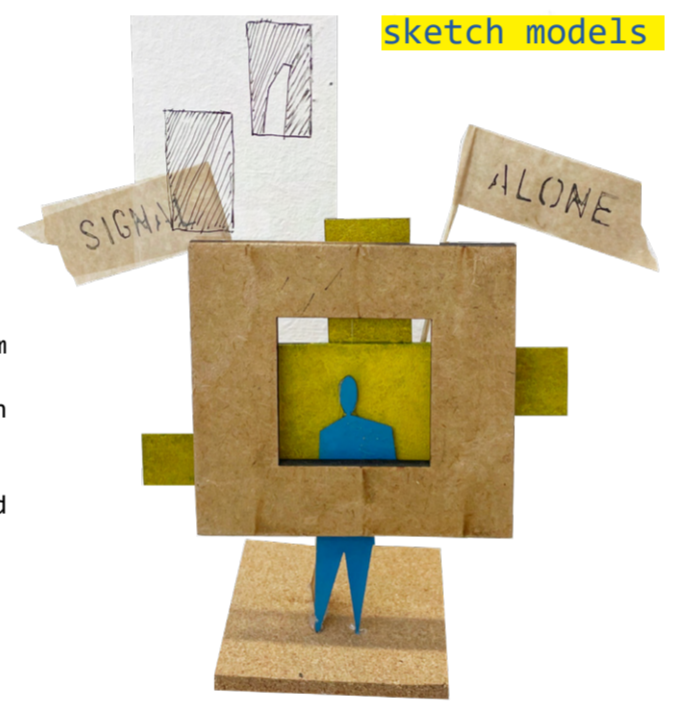

sketch models

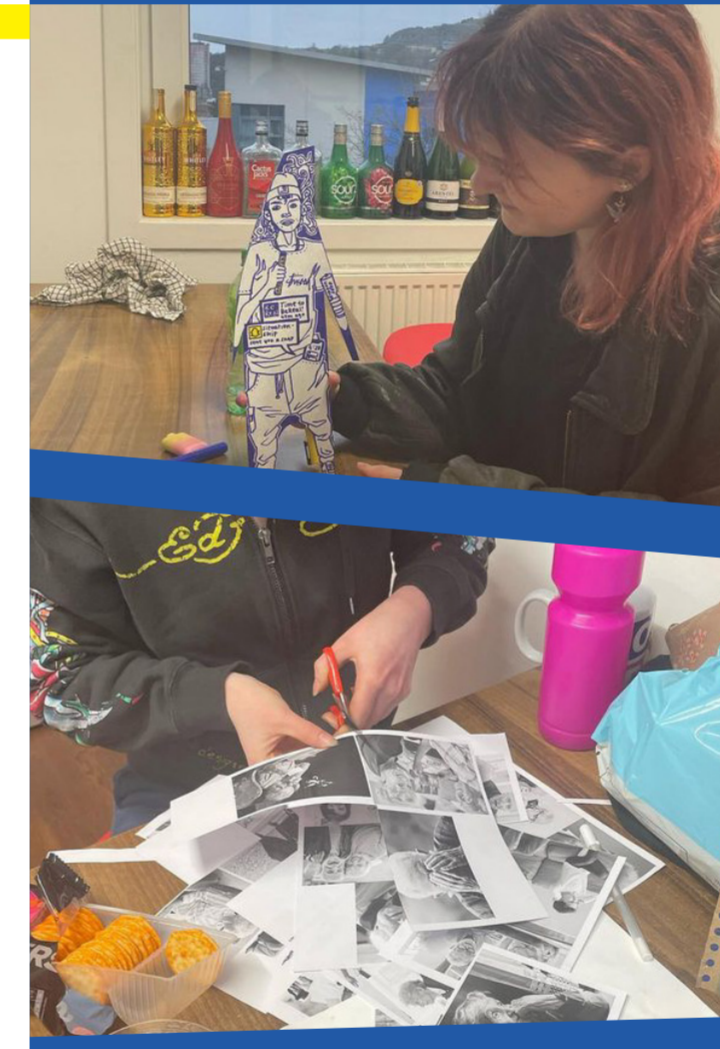

# DEVELOPMENT

developing window idea



planning spaces



RELAXED  
PEACEFUL  
NEVER ALONE



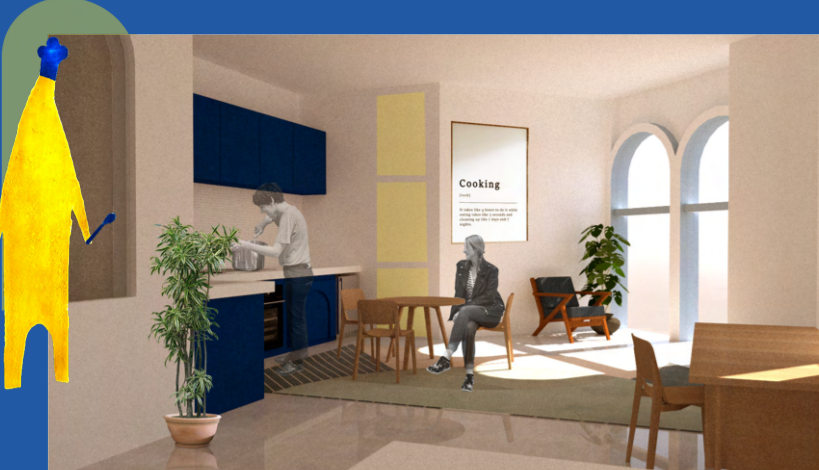

## THE COOK

- Larger kitchen space
- More space to entertain
- Large communal kitchen to show off and teach



## THE GREENTHUMB

- Bright south facing windows and dimmer east facing windows for plants
- Communal garden for larger outdoor plants, and opportunity to teach green skills



## THE TINKERER

- Large room and desk to allow for new inventions
- lots of space around the building to exhibit their creations



## THE SOCIAL BUTTERFLY

- large living space in apartment for entertaining
- windows into hallways to have quick conversations with neighbours
- large communal areas to have more relaxed social interaction and bigger social functions



## THE ATHLETE

- lots of floor space
- flexible communal areas that could be used for more intense workouts and training of others

HAME Dundee has a variety of apartment sizes, fit for a wide variety of people with a wide variety of skills and requirements. the spacious communal spaces also offer an opportunity for inhabitants to enhance their interests in a larger area, and allow them to pass on their knowledge to others. Everyone is equal in HAME, young or old. Above are a few examples of who might thrive here.



exploded view of spaces



final Model - scale 1:50

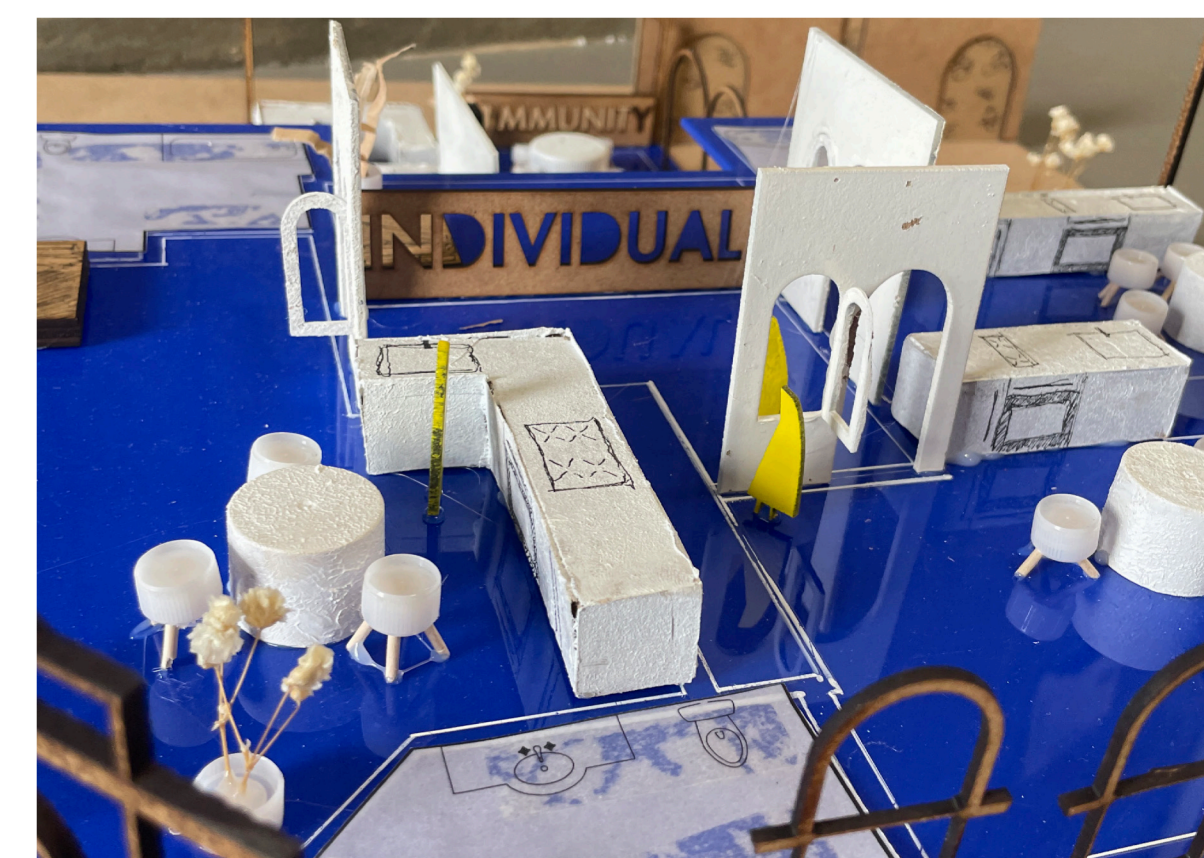

This new model of living, while novel for Dundee, is a common practice in many other places and has been shown to improve relationships between neighbours and create new and often unparalleled relationships. This unit would be perfect for an old and underused district like the Blackness Conservation Area to create a new and revolutionary idea that could transform the city back to its former glory, which it is already on its way to.

- Individual development
- HAME community socialising
- Community learning
- Wider community interaction

how the space could be used - Scale 1:200



The spaces provided in the unit offer a unique experience for the older and younger generations to connect. With a variety of environments that give flexibility in terms of residents social levels; there are spaces for them to be by themselves, for them to socialise with a small or large group and for them to interact with the outside world and bring in the local community to this unique complex within Dundee.

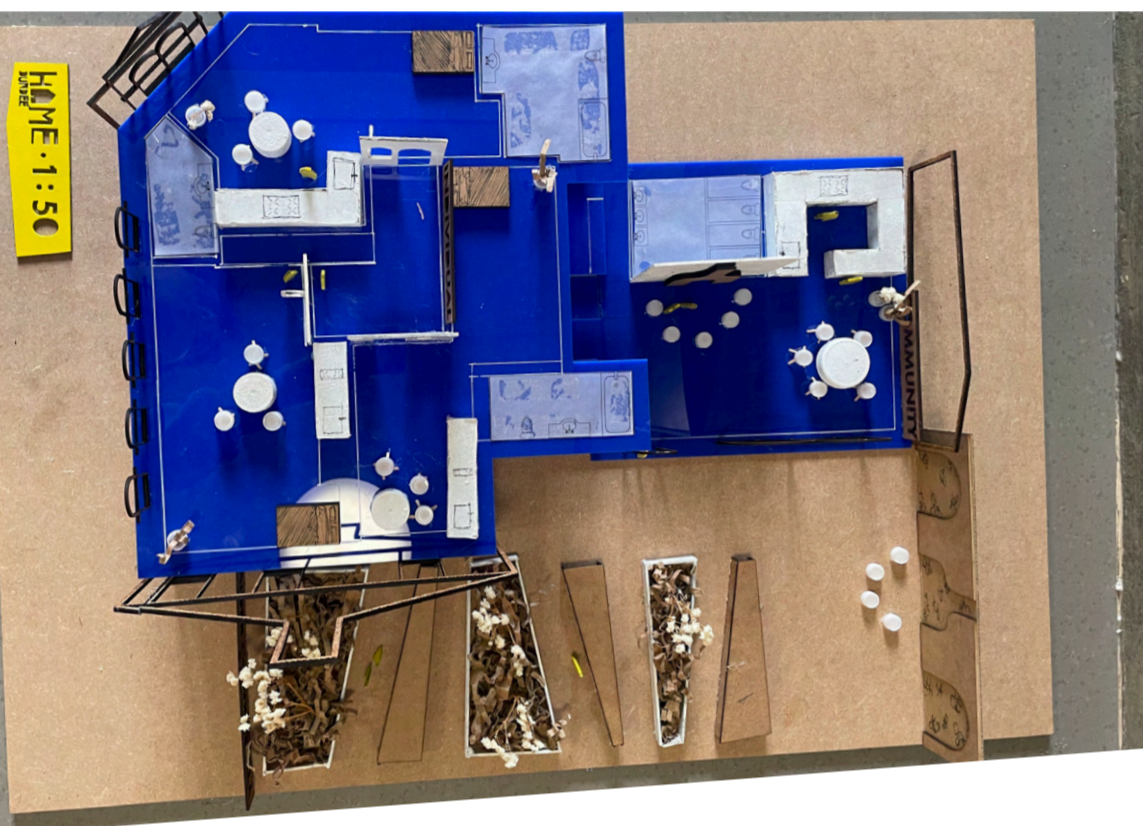

one on one space in communal space



Communal Space



wider community outdoor area

