

REBIND

REBIND, an adaptive reuse project, reconnects people through the power of books. Books are important in many ways, for example, storytelling and making practices like bookbinding can bring people together. Bookbinding emphasises the importance of tactility, and connecting with a physical object that holds memory. Using creative therapy to reconnect is incorporated in REBIND, through making as well as through the history and design that surround you throughout.

Reconnection can be found in solitude as well as in connecting with others. Similarly, books can allow you to connect with others, but also encourage being alone - but not lonely. Reading provides bibliotherapy and an escape from the busy world, and can make you feel less isolated.

REBIND also draws from the growth and life cycle of mycelium. For example, mycelium can embrace and adapt to its environment, and the hyphae that make up its network can communicate and hold memory.

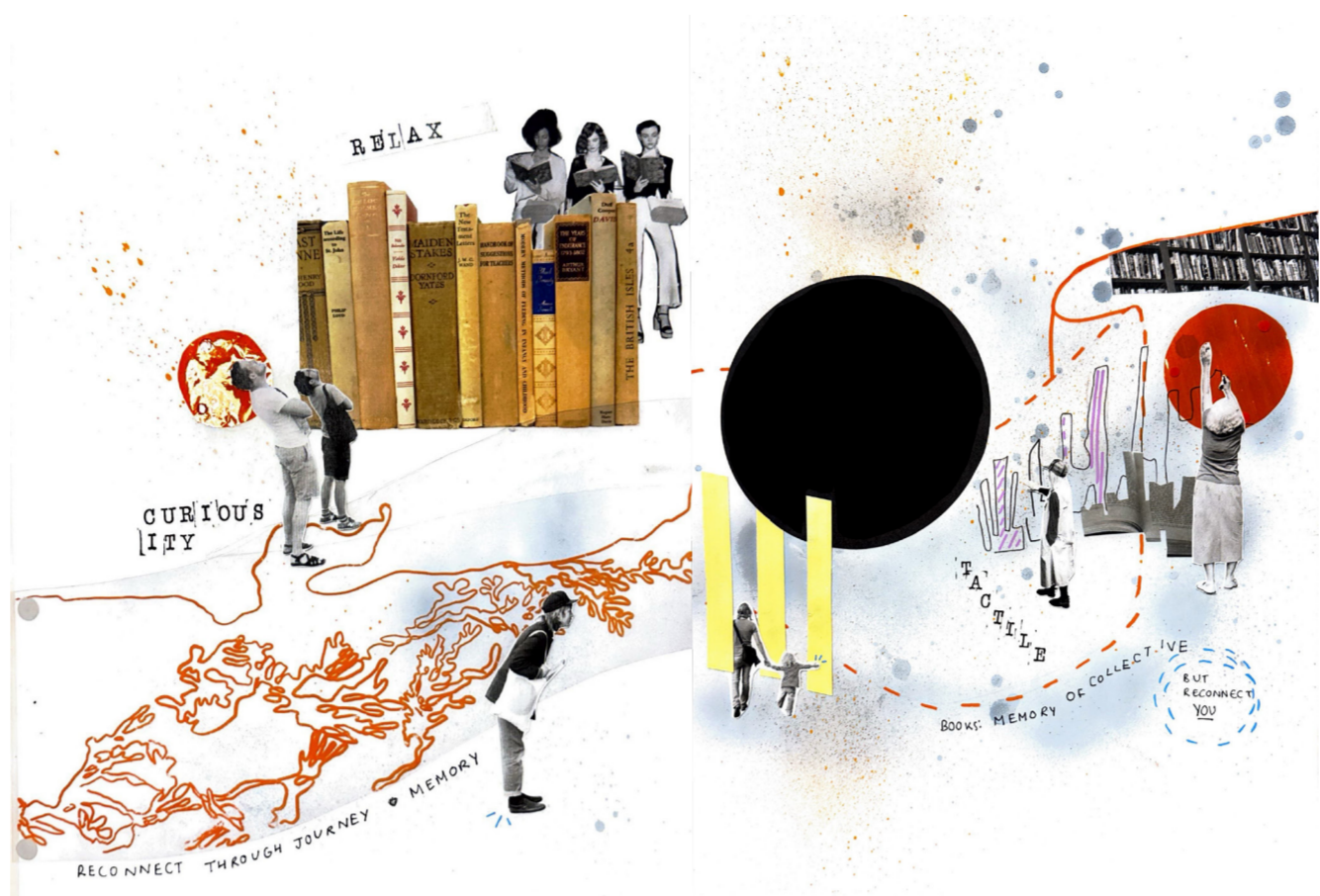

CO-DESIGN



finding out 'your story to reconnection'

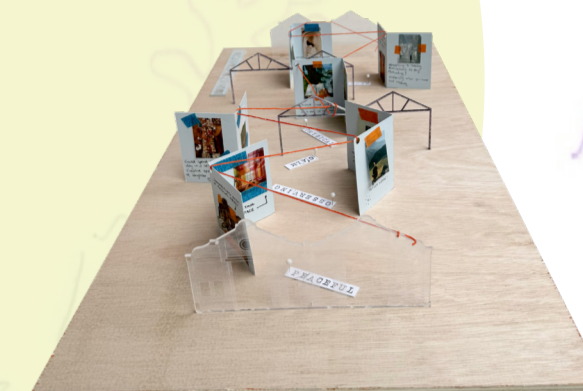

physical co-design aided in engaging others, and creating expressive sketch models brought information to life in a spatial concept

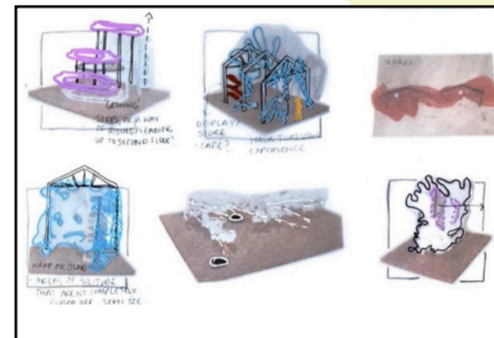
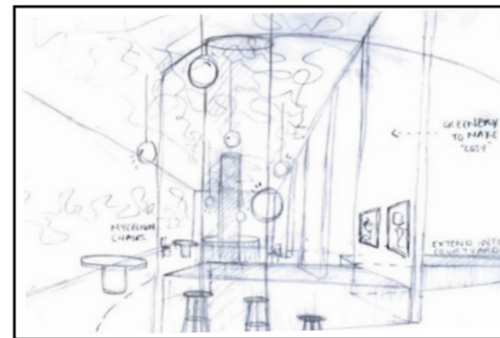
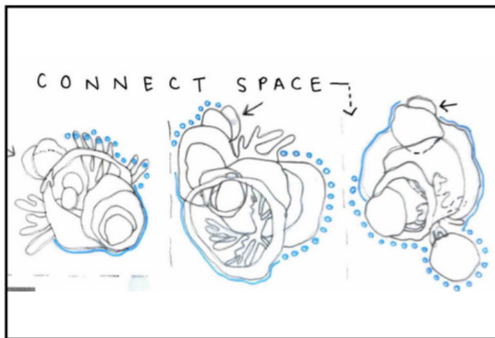
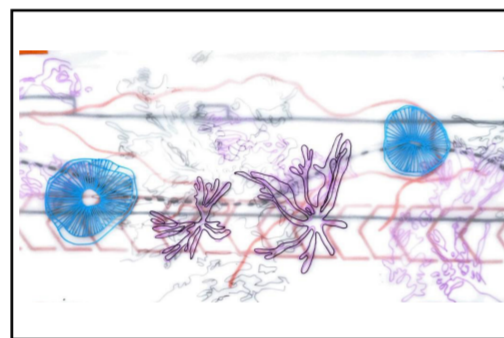
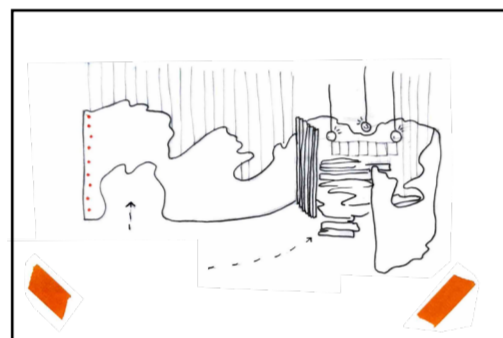

DEVELOPING...

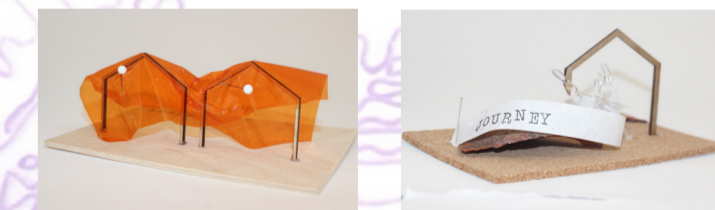

CONCEPT VISUALISATION



beijing city library, snøhetta

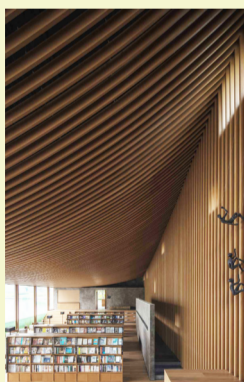

chengdu xinglong lake CITIC bookstore, MUDA architects



intentionally opaque, brush collective

POWER OF BOOKS



NATURE RECLAIMING... RECONNECTING



men sheds

ART HEALING AND RECONNECTING... IN-DIRECT THERAPY



HEALING THROUGH CRAFT.

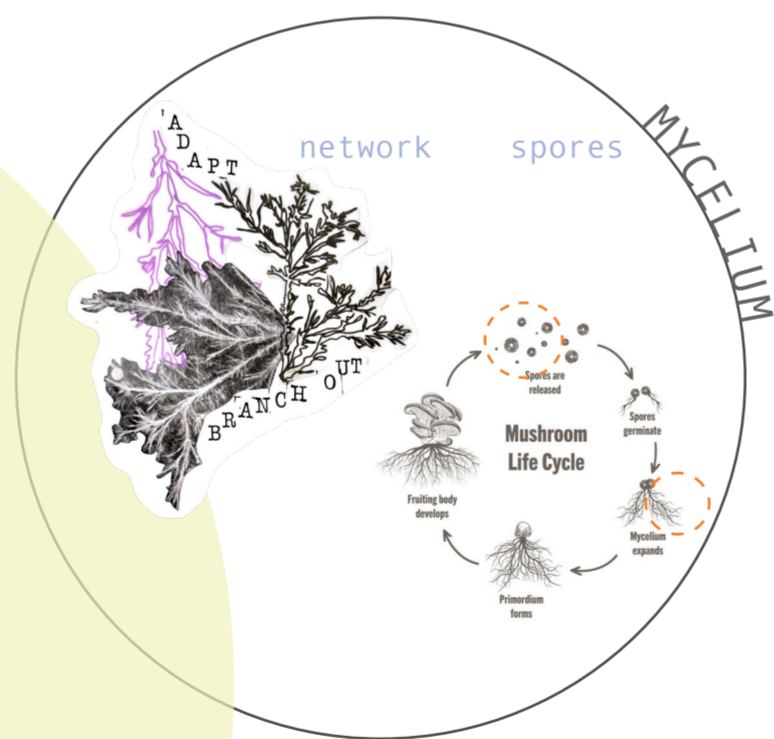

SITE: MARYFIELD TRAM DEPOT

old tram lines can still be seen outside and this history further links to the concept of reconnecting through a journey and memory.

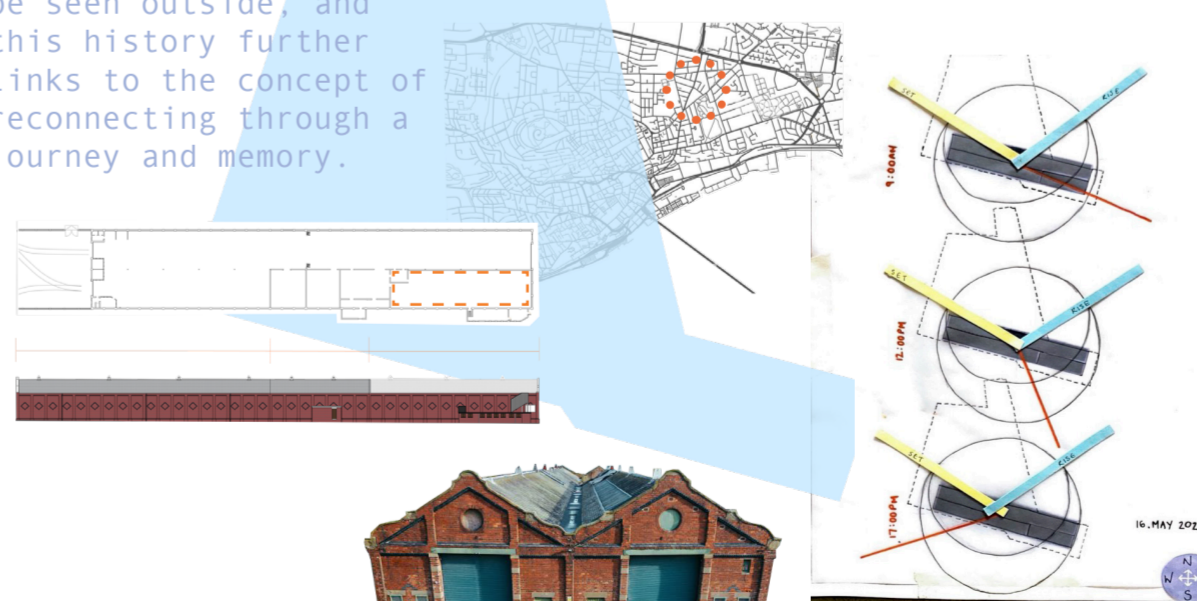

CASE STUDIES



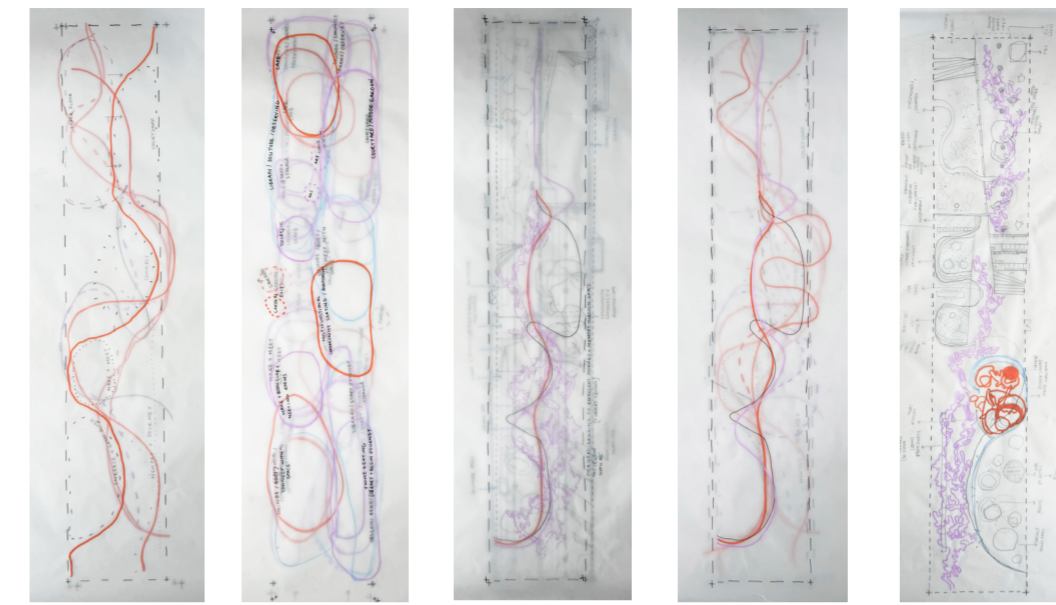

ZONING AND FINDING SPATIAL JOURNEY

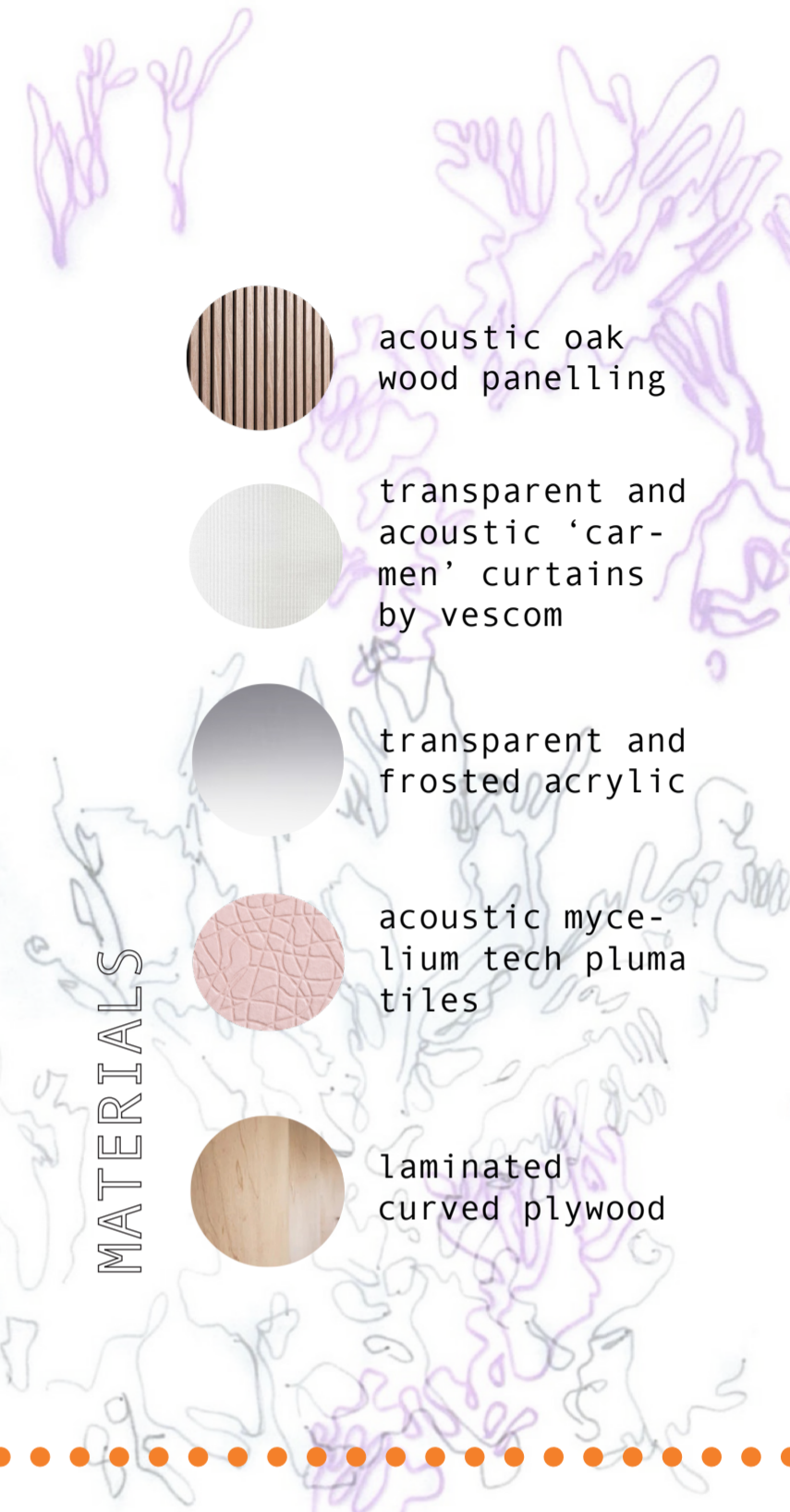
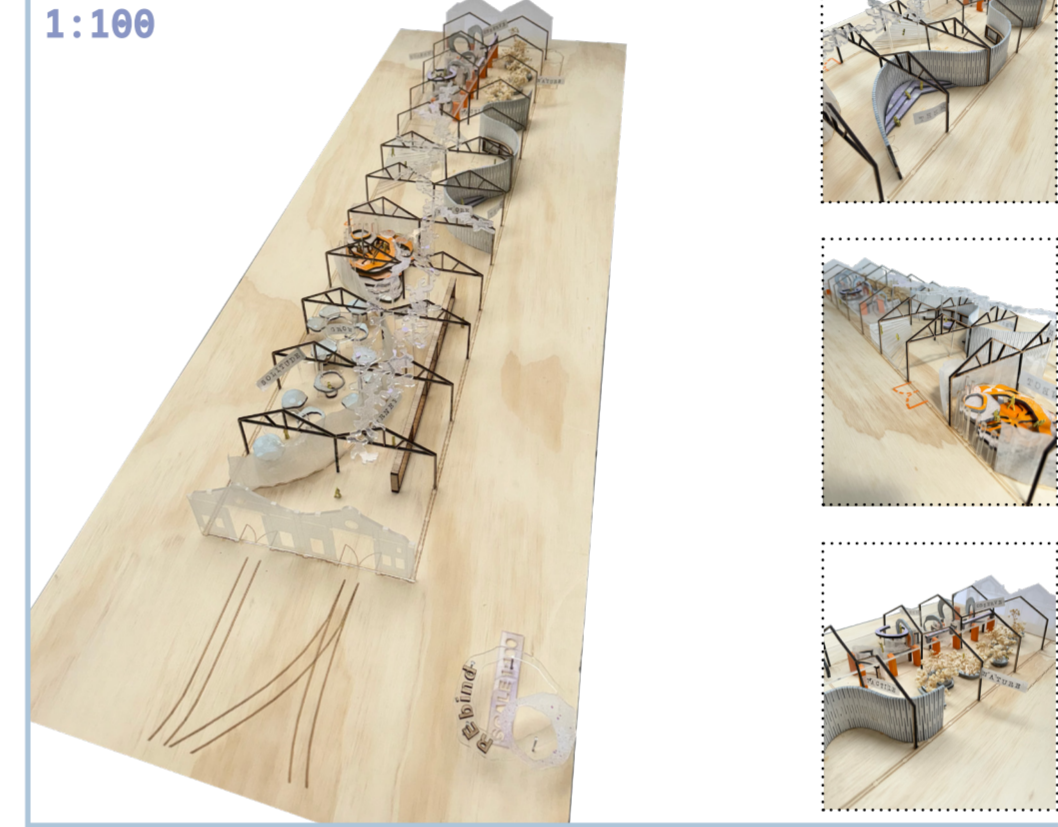

SCALE MODEL
1:100

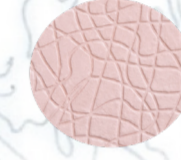

MATERIALS

-  acoustic oak wood panelling
-  transparent and acoustic 'carmen' curtains by vescom
-  transparent and frosted acrylic
-  acoustic mycelium tech pluma tiles
-  laminated curved plywood

FLOOR PLANS

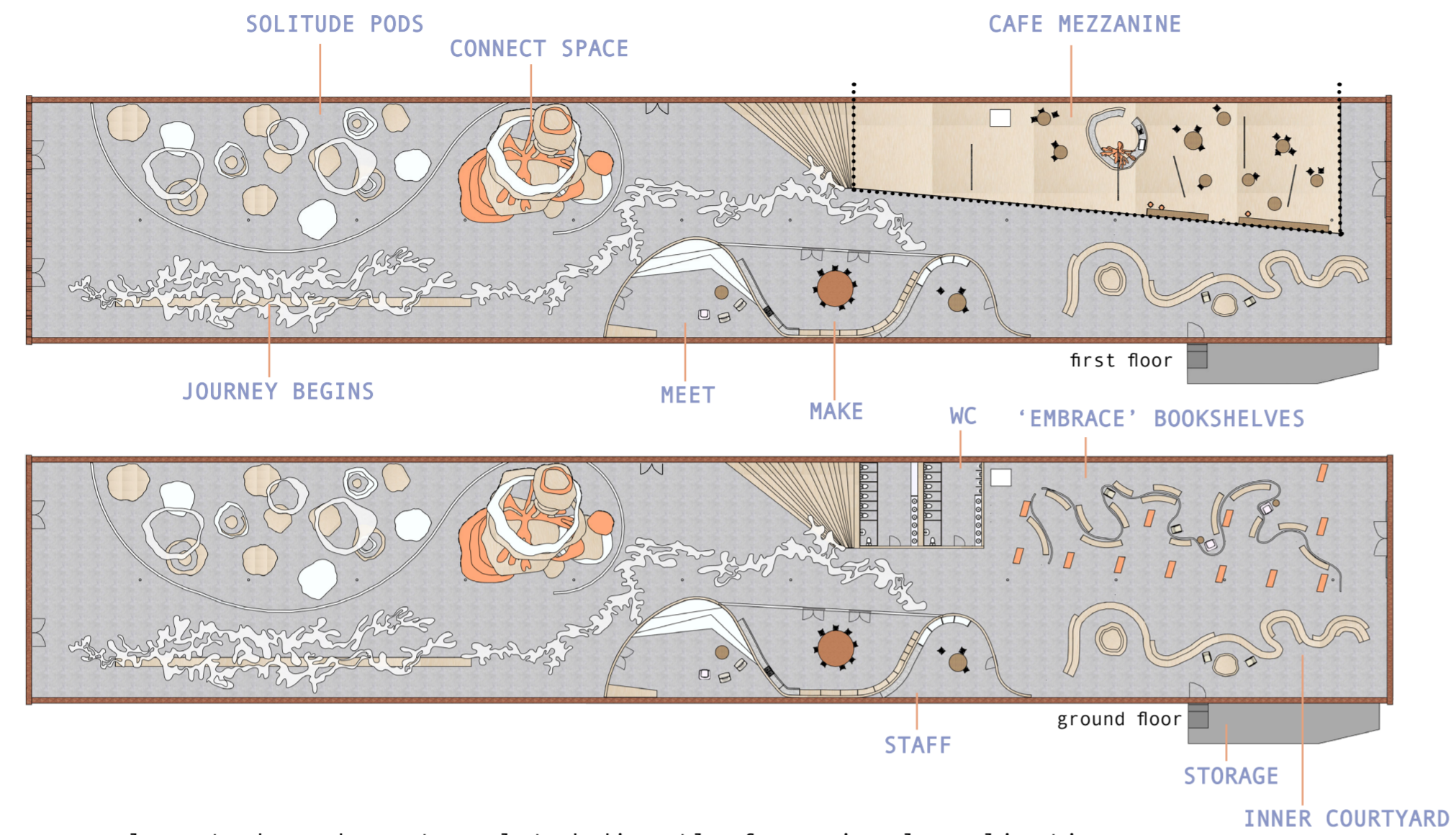

many elements have been translated directly from visual realisations found through model making and sketching.

THE INTERIOR



ENTRANCE
.. memory
.. journey
.. network



osmose studio
BioCast Kit

MAKE
.. connect
.. tactile



CAFE MEZZANINE
.. observe
.. meet



SOLITUDE PODS
.. grow
.. quiet
.. re-connect



CONNECT SPACE
.. interact
.. grow



LIBRARY
.. embrace
.. tactile
.. adapt



COURTYARD
.. nature