

west EXTend

is a spatial design proposal for a neglected public space in Dundee's West End. Local independent businesses will use it as an extension of their space and offering. Transformable furniture/objects made from locally re-used materials (predominantly plastics) allow for adaptation of the site to hold markets, events, exhibitions and many more...

4. Climate Emergency & Sustainability

The recent Plastic: Remaking Our World exhibition which I visited in Germany at the Vitra Design Museum and V&A Dundee have greatly inspired me to work with this fascinating material. Plastics are all around us, they have contributed to life-saving advantages in the field of medicine and to immense pollution all over the planet. For this project, I have developed a way of reusing plastics from local businesses and transforming them into outdoor furniture prototypes. On a bigger scale, they could become building blocks and stalls that create a versatile communal market/event space used by those businesses as an extension of their shop/cafe.

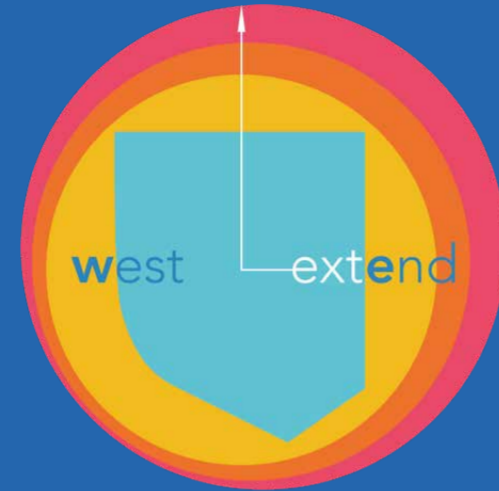

Logo/Branding; site, name and orientation



plastic:facts

Littering puts 1.000 tonnes of plastic into Scottish seas each year. This is the equivalent of 9 adult blue whales.

Single use plastic films make up 85.000 tonnes of the general waste that is incinerated or put into landfill in Scotland each year.

In the past 6 years the amount of plastic waste recycled in Scotland has only increased by 8.3%.

People in Scotland use 694 million plastic bottles every year.

On average only 37% of plastics are correctly recycled in Scotland.

V&A Dundee, Plastic: Remaking Our World



a chair with a twist '22



Stool, Chair & Clock '22



Dec. 2022: me at V&A Dundee Plastic Lab talking



inspiration



Dave Hakkens, Precious Plastic



Assemble Studio, Cineroleum



Jane Atfield, RCP2 Chair



Assemble Studio, Brutalist Playground

location

The 197sqm large site is in a great location on Perth Road, Dundee's buzzing street with independent businesses. It is southfacing and flooded with light and sunshine all year round. The space is accessible from the south and west through adjoining sidewalks and closed off by walls and fences to the north and east. Being in private hands and neglected since decades, this place has been an unused potential for way too long.



500 meter (0.3 mile) radius

was a first attempt to narrow down the self-written brief for this project. All objects/ furniture for the public space should be fabricated within a 500 meter radius of the site, using found materials from within the same radius.

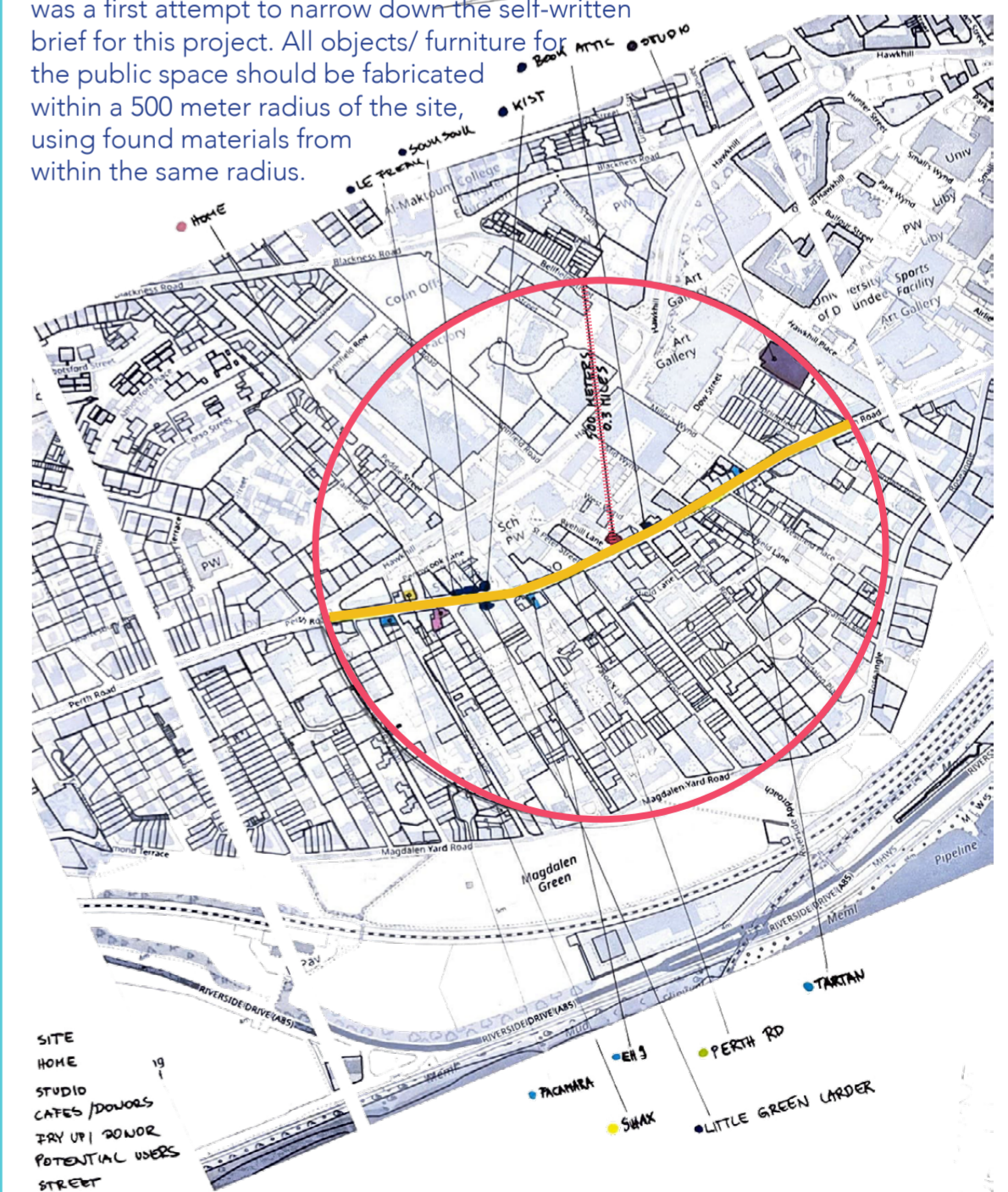

SITE HOME 19
STUDIO CATES / POWERS TRY UP! POWERS POTENTIAL USERS STREET
PACAMBA ER 3 PERTH RD SWAX LITTLE GREEN LARDER TARTAN

co-design

Engaging with parts of the community was vital. As this project was about them it was necessary to get a first-hand view of the proposed concept. Offering an engaging tool by which the proposed users of the space, local independent businesses, could interact with, helped carry across the proposal and for them to visualise what it would mean to them in the context of the site. To gain more in-depth feedback and ideas, a 5-question WHO, WHAT, WHEN, WHERE and HOW questionnaire was asked to be filled in. This resulted in a clear understanding, that the space needed to be flexible in order to offer many different uses for many different users. It meant that the furniture couldn't be static and needed to fulfil multiple tasks.

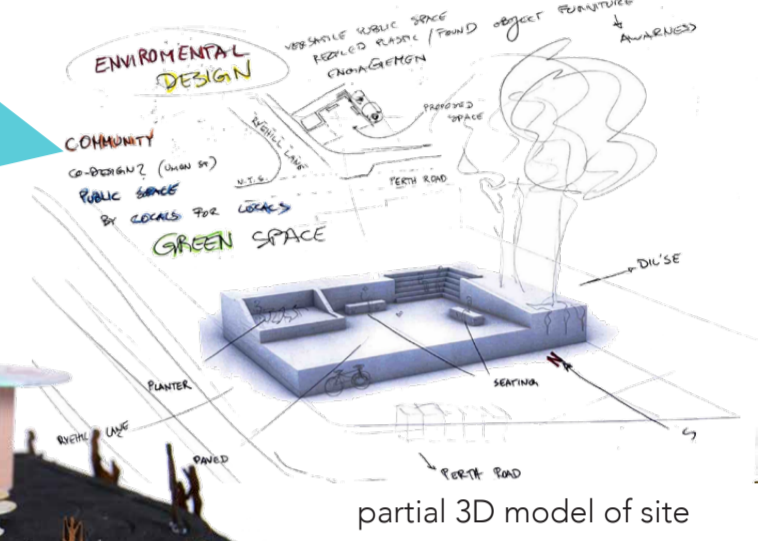

HOW would your business use the space?
WHAT would you like to attract?
WHERE on the site would your preferred zone be?
WHEN would you like to attract?
WHO would you like to attract?

THE LITTLE GREEN LARDER
SOOKSOUK



process

Plastic recycling techniques:
Collecting
Sorting
Cleaning (opt. Shredding)
Melting
Shaping through moulding and/or machines/tools after
A CNC routing machine shaped one of the prototype seats, through digital input.

Analogue sketching, fast and freehand, drove the design process. This allowed for potential spatial outcomes to be explored efficiently.

Digital 3D modelling and CAD drawings were used simultaneously to gain more experience, practice and visualise to higher detail.

Sketch- and final model-making, physically visualised concepts and final design outcome more tangible.

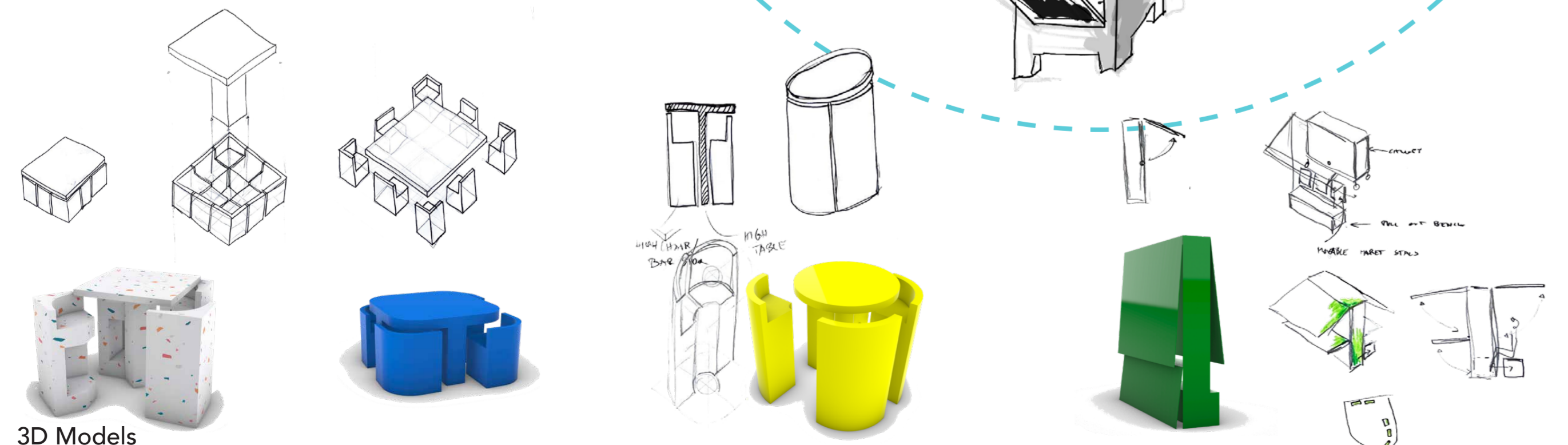
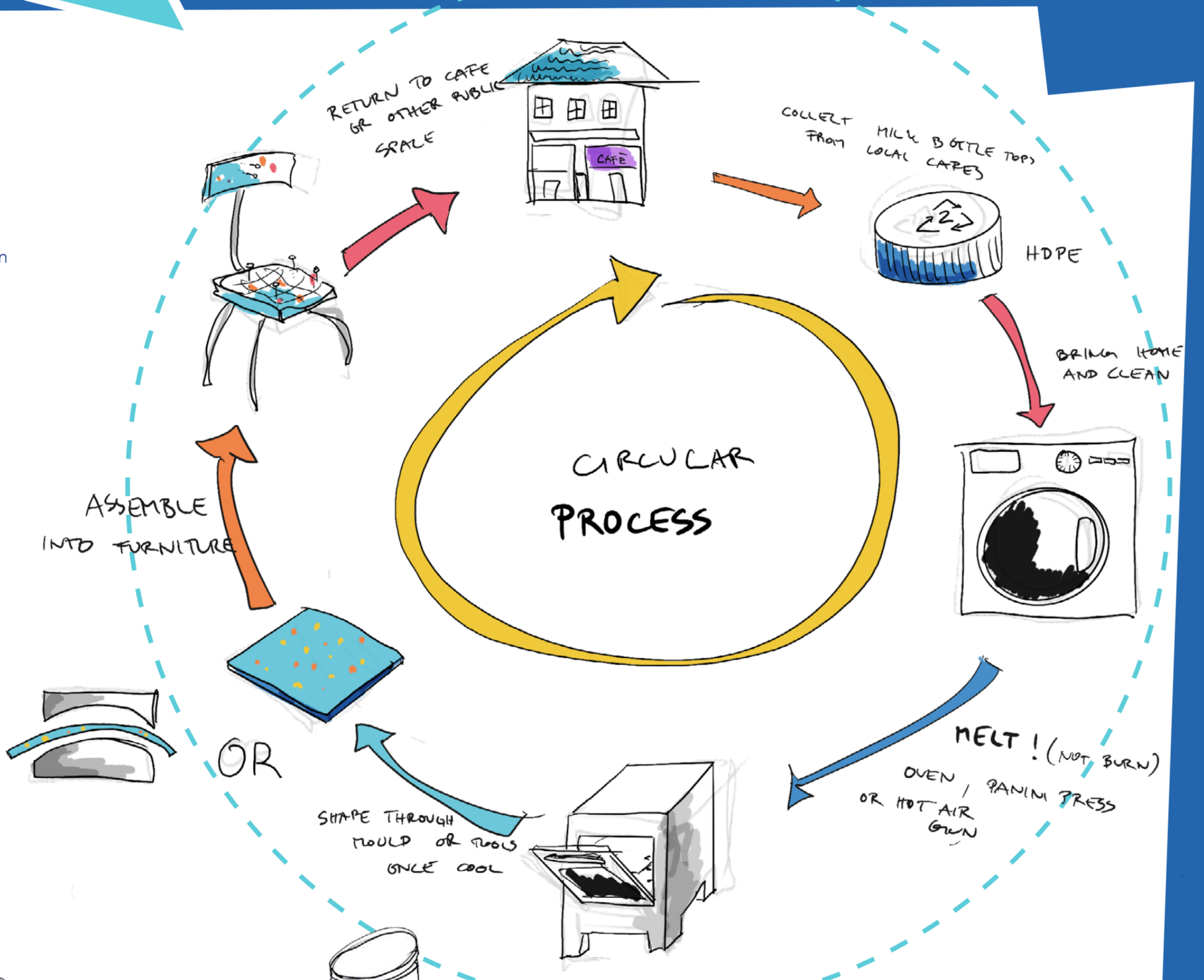

outcome 1

The final spatial design outcome provides a flexible and transformable space for the local businesses to use as an extension of premises and offering. Visual and physical outcomes included 3D renders, sketches, a scale model, a banner and technical drawings. Perspectives and Plans below showing three possible uses of west EXTend; market, exhibition and event.



Market
separating tables and chairs for visitors and opening stalls for vendors

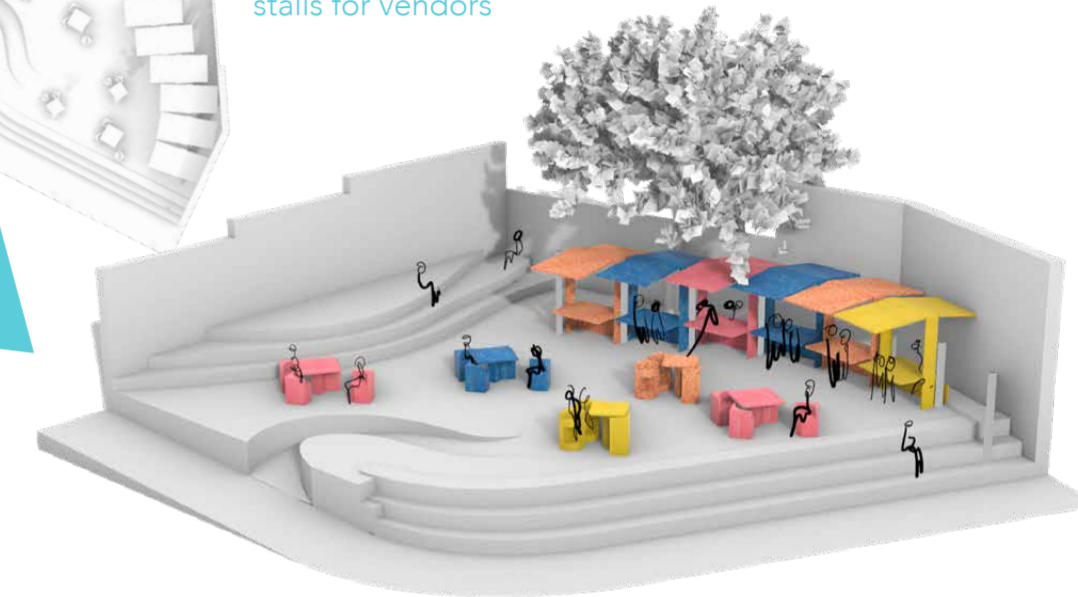

Event
combining tables and chairs into blocks that could function as stage. Closed stalls will be pushed to the sides

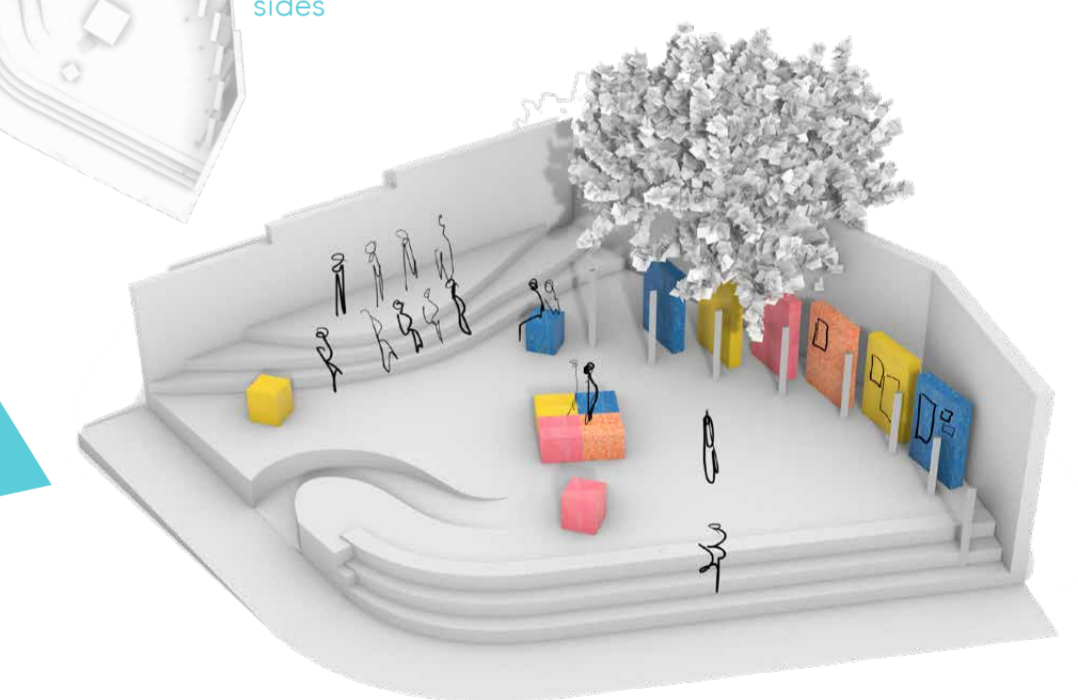

Exhibition
using the closed stalls as exhibition surfaces, pushing tables and chairs to the sides



The **Final Model** is at Scale 1:20 showing a potential market setup. The blue furniture models are made from predominantly blue milk bottle tops. Other materials include MDF and foam.



The **Hero Image** is a digital sketch over a black & white photograph of the existing site

outcome 2

Reused plastic and found object prototypes that depend understanding for the materiality and versatility of plastic.

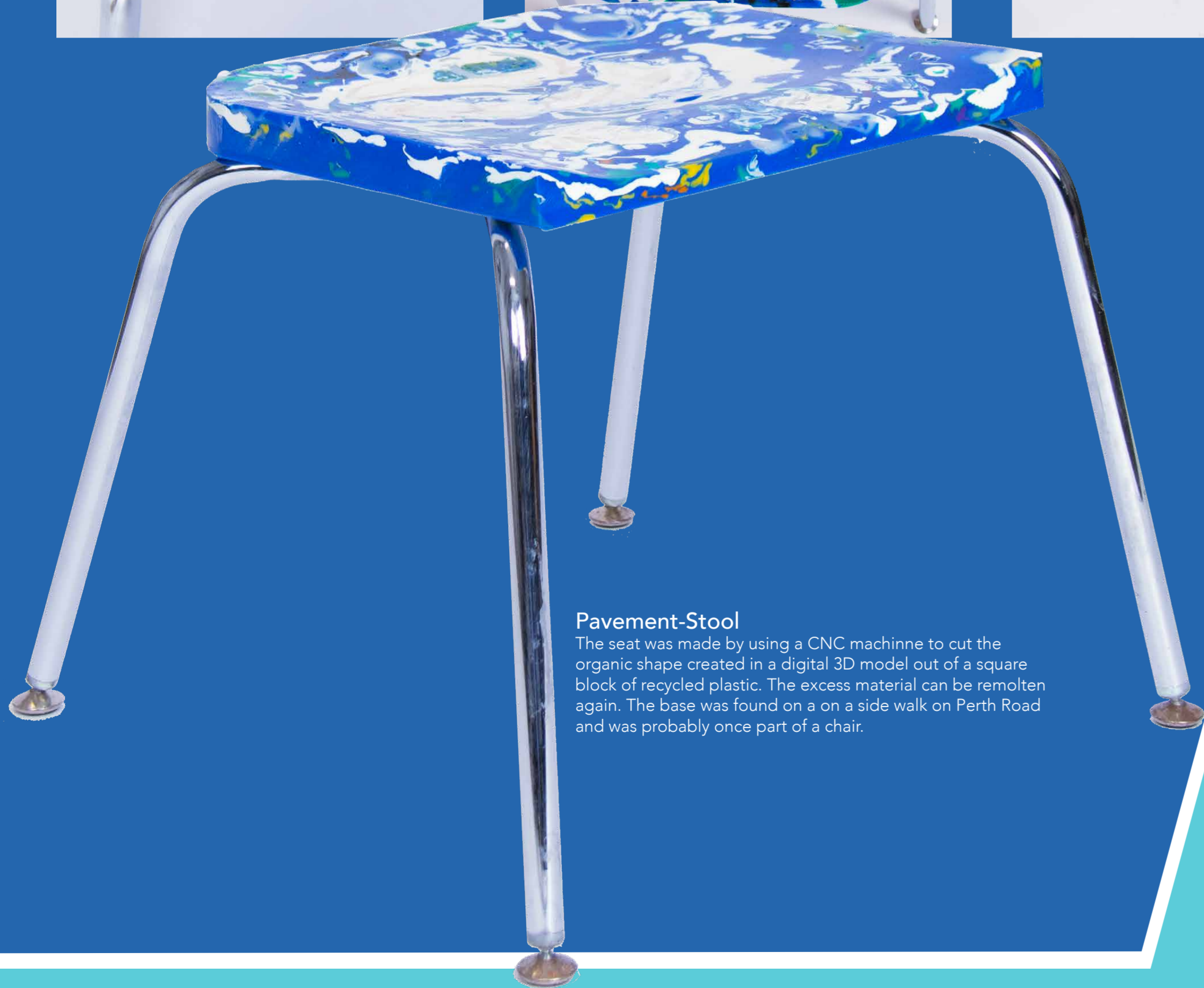

Pavement-Stool

The seat was made by using a CNC machine to cut the organic shape created in a digital 3D model out of a square block of recycled plastic. The excess material can be remolten again. The base was found on a on a side walk on Perth Road and was probably once part of a chair.



Bin-Stool

The frame of this stool was found behind a bin on Perth Road. In good shape but with pieces missing, I redesigned and made all three pieces using plastic moulding techniques.