

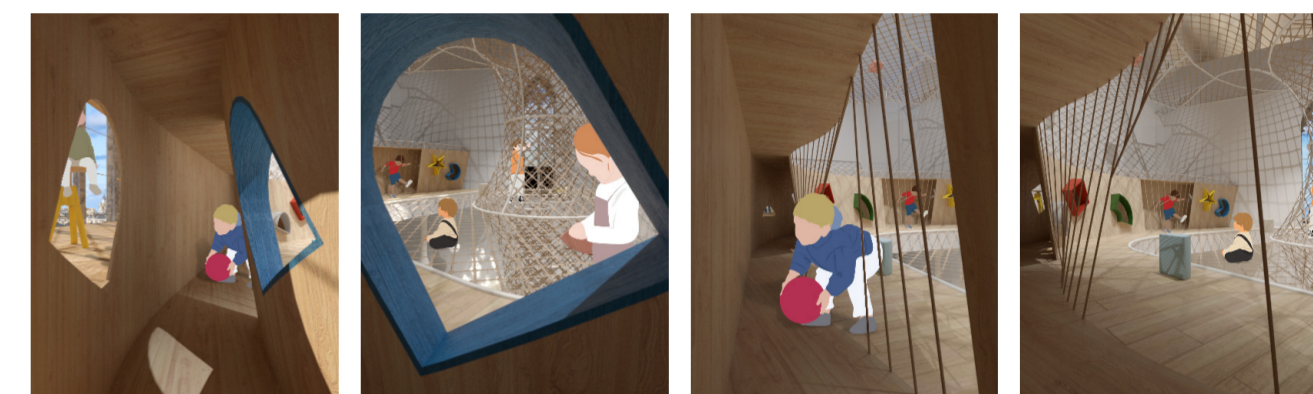

First Floor Visual Top View



First Floor Tunnel



Main Space



Child Resilience Centre

The 'Child Resilience Centre' is dedicated to supporting children and adolescents under 18 as they navigate the challenging journey after the loss of a loved one. Current local facilities provide therapy meeting rooms but do not provide a dedicated space for children to take part in other activities to support them through difficult times.

Designed as a nurturing environment, the centre offers a comprehensive range of services tailored to address various aspects of grief and coping. These services include access to playground facilities, hands-on craft workshops, family retreats, counselling sessions, and specialised professional training.

Housed within a former Edinburgh church, the centre ingeniously incorporates a "safety net" feature that spans across two floors, facilitating vertical movement within the playground area. This innovative design element serves as a metaphorical and literal shelter, symbolising a sense of security and home-like comfort for bereaved young individuals seeking solace and support.

RESEARCH SPECIFIC AREAS OF SUPPORT

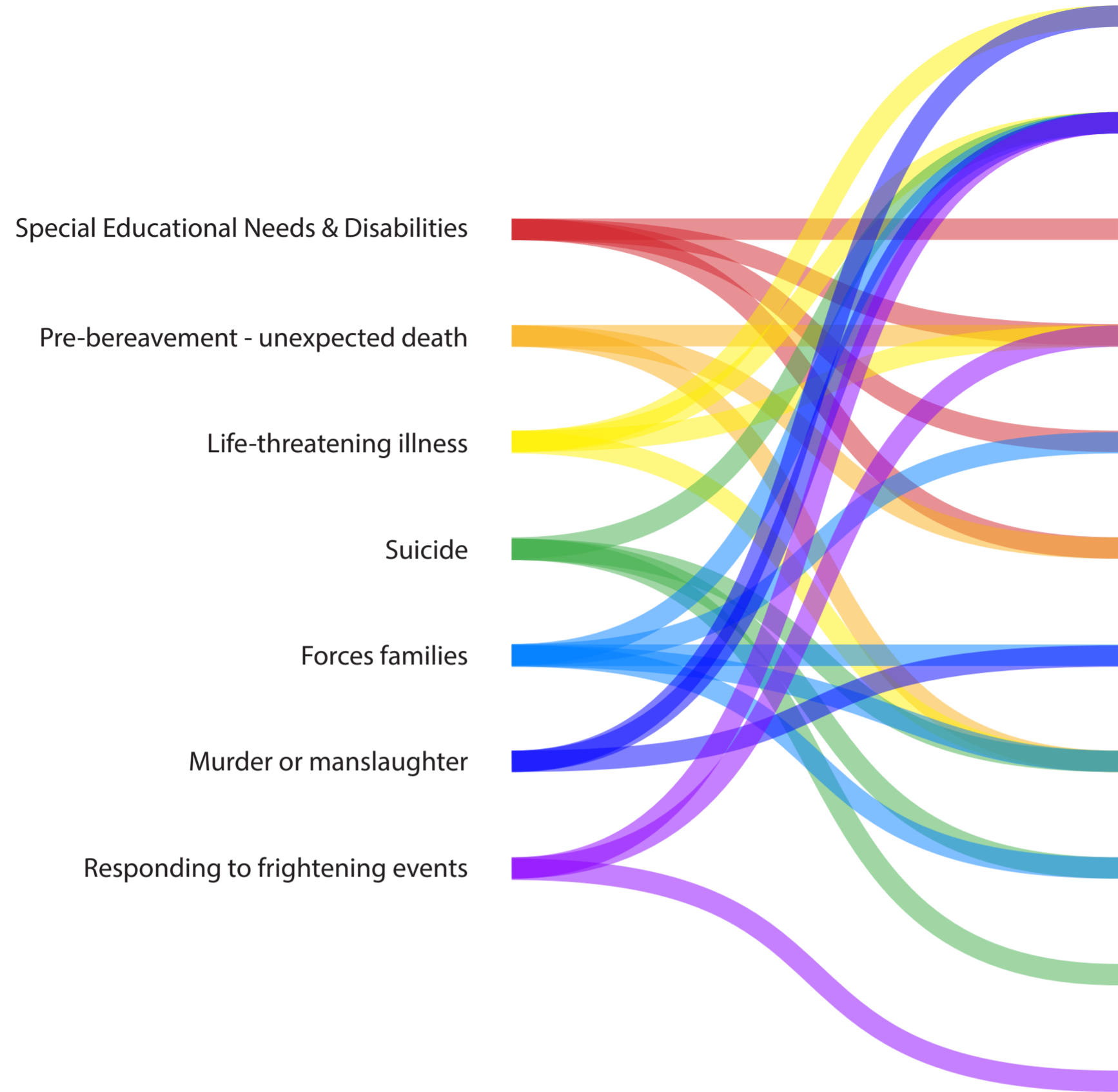

HOW TO SUPPORT A CHILD

- Communication with peers
- Opportunity to forget about grief
- Remembering the person who has died
- Honest communication of truth
- Understanding the concept of death
- Expressing their grief
- Rehearse managing difficult questions
- Helping the families
- Professional help
- Support of familiar and trusted adults
- Quiet space or time out

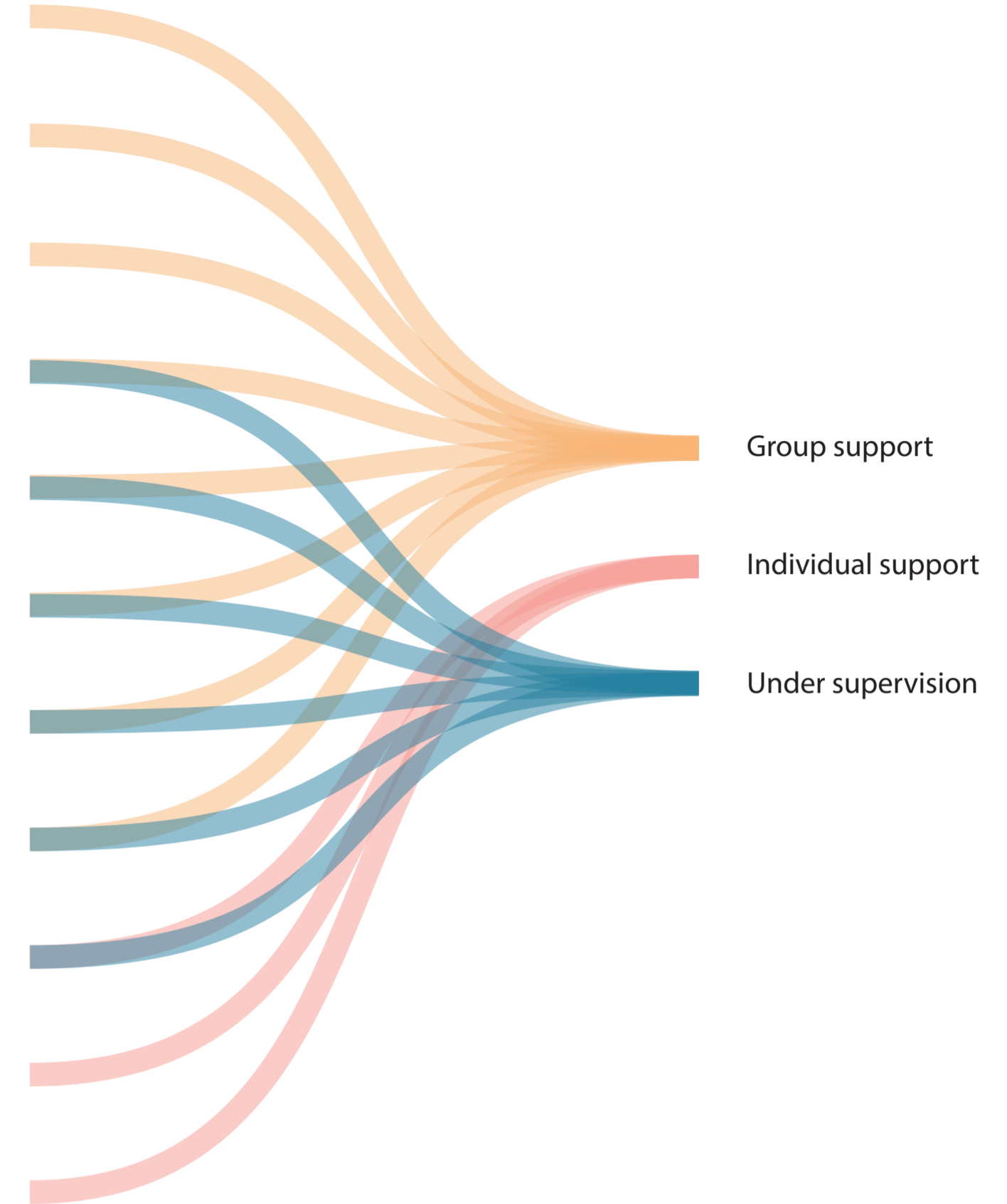

Hand Craft Activities

Memory box
Remember someone special.

One more minute star
Feel connected to special person.

Worry Monster
Help child manage their worries.

Salt jar
Remember someone special.

'Who is there for me?' Hearts
Help child identify people who can support them.

Paper person
Help child recognise, express and talk about how to manage their feelings.

Users

Children & Young People

- 4-8
- 8-12
- 12-19
- play area, activities, family counselling
- play area, activities, family counselling, group counselling
- play area, activities, family counselling, group counselling, individual counselling (Under 12s need to be accompanied by adult, over 12s could attend on their own)

Families

- Away Days
- Counselling
- to help families to be away from grieving
- in group or individually

Professionals

- Training sessions
- Counselling
- develop practical strategies, gain greater confidence
- reduce grief impact, build resilience, build life-work balance

First Floor

Tunnel and desk designed between with playground and bar area separate. Nets on existing void area, with structure supporting.

Upper First Floor Plan

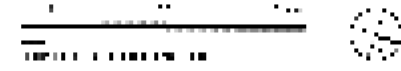
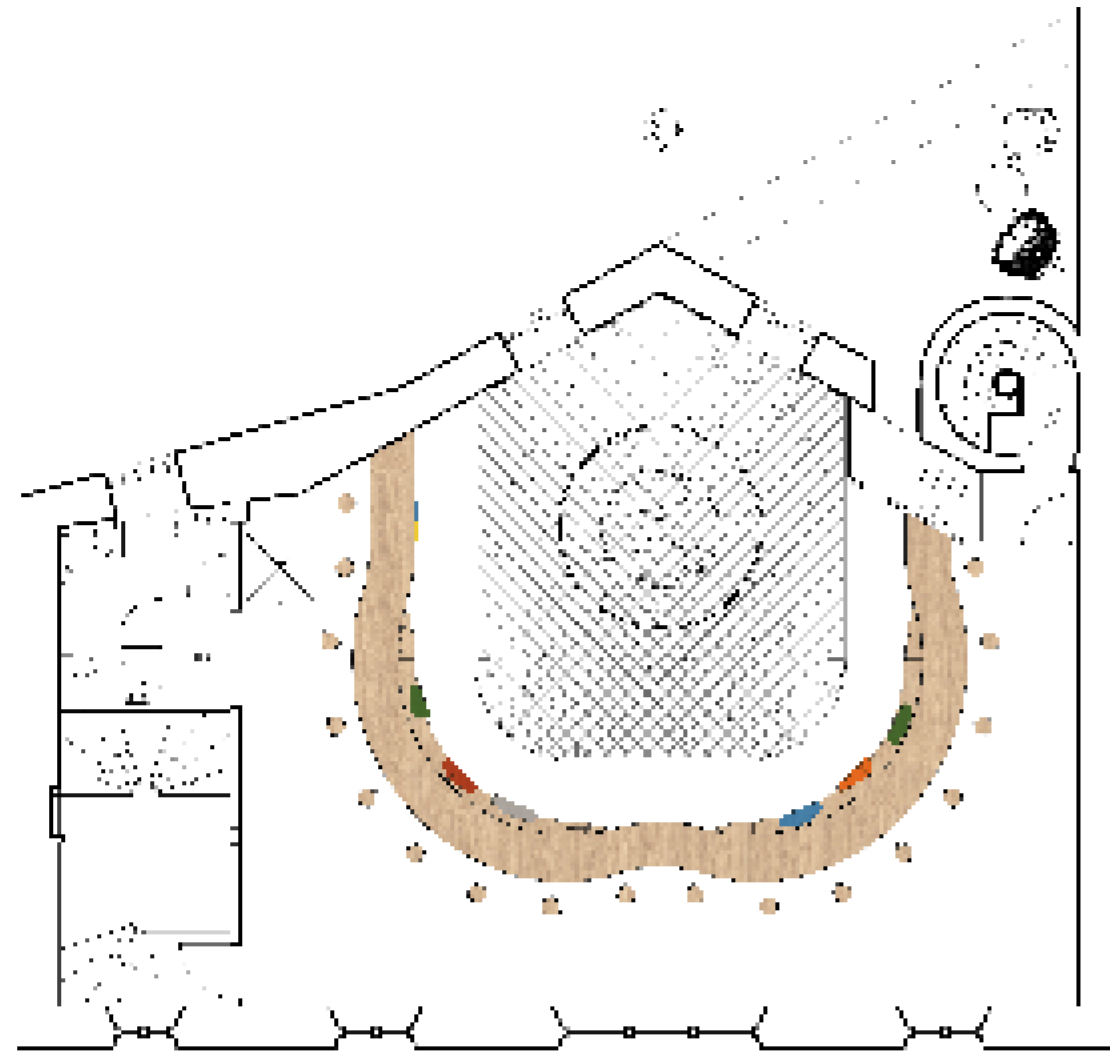
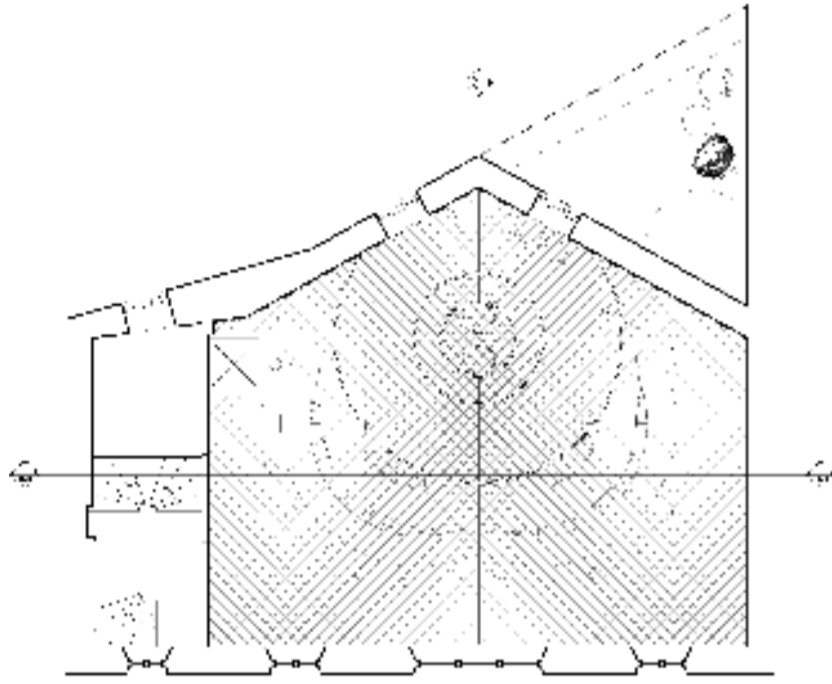

First floor view focus on the tunnel desk, children within show visual connections between spaces. Light from above shows shadow effect of net, with children sitting and climbing on nets. Ceiling above shows blurred mirror effect. Sunlight from window creates unique light effect of existing building.

Ground Floor Plan

From main entrance, coat-hanging area on left hand walls, with small reception desk for guidance. Ball pit and climbing net in middle, with sponge steps on side. Knit seating with carpet surround. Storage shelf and reading area on side.

Ground Floor Ceiling

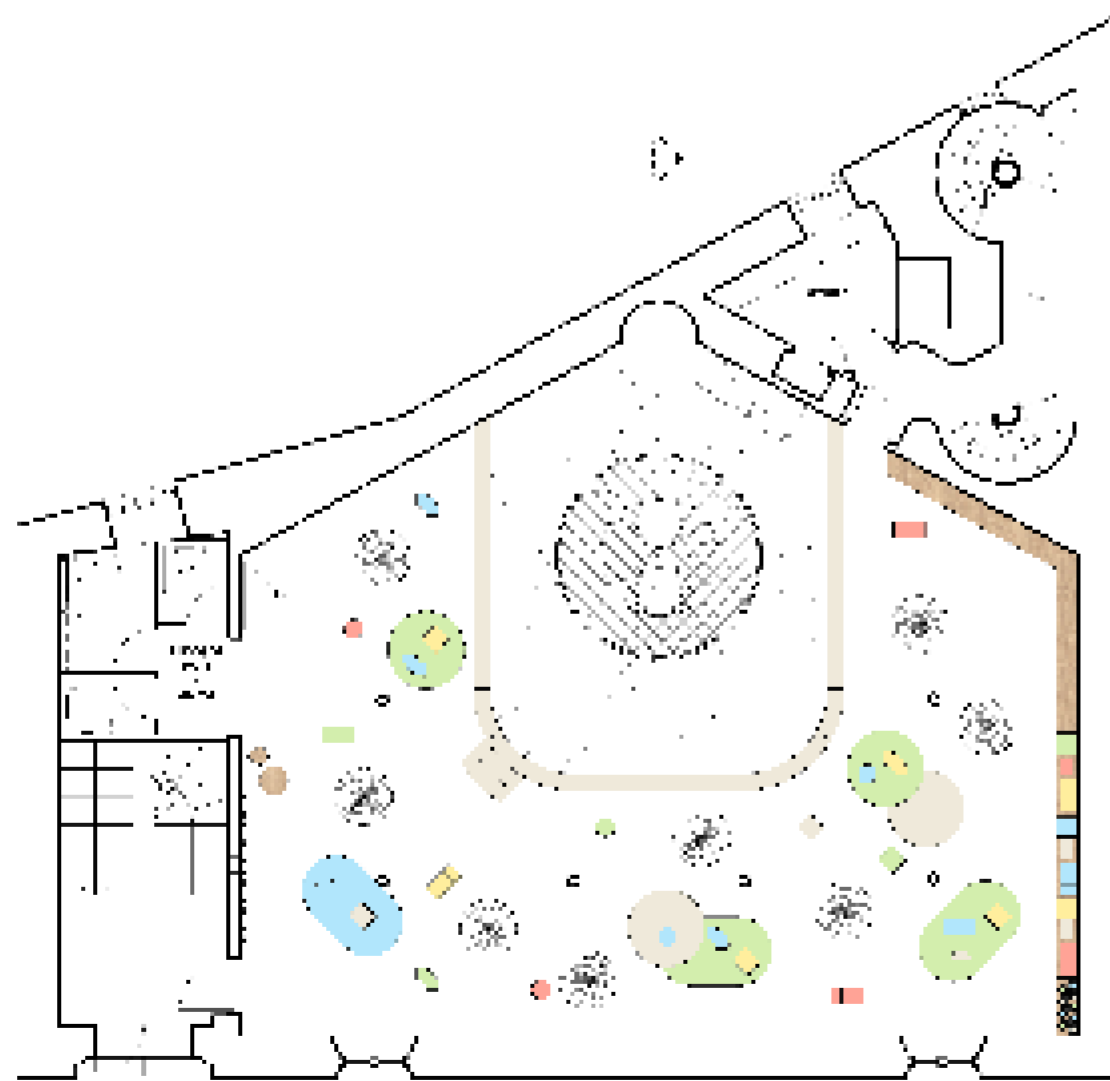
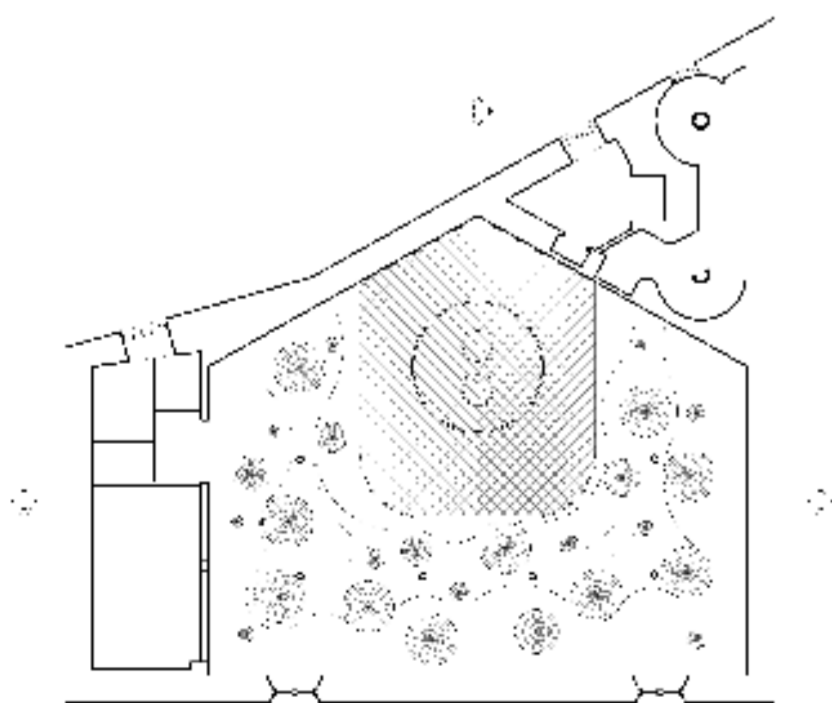

Knit seating for reading with children, shows transparency of knitted fabric. Children doing activities in other areas, on floor, in ball pit or in climbing net. Light from climbing net in middle creates shadow effect on floor. Relatively dark atmosphere for reading and talking help to relax.

Lower Ground

Two concrete columns partly removed, three vaults into one room. Dining area next to sensory room with kitchen on side. Group counselling next to window, has three groups with partition on side. Flexible and moveable seat unit in each group.

Sensory Room

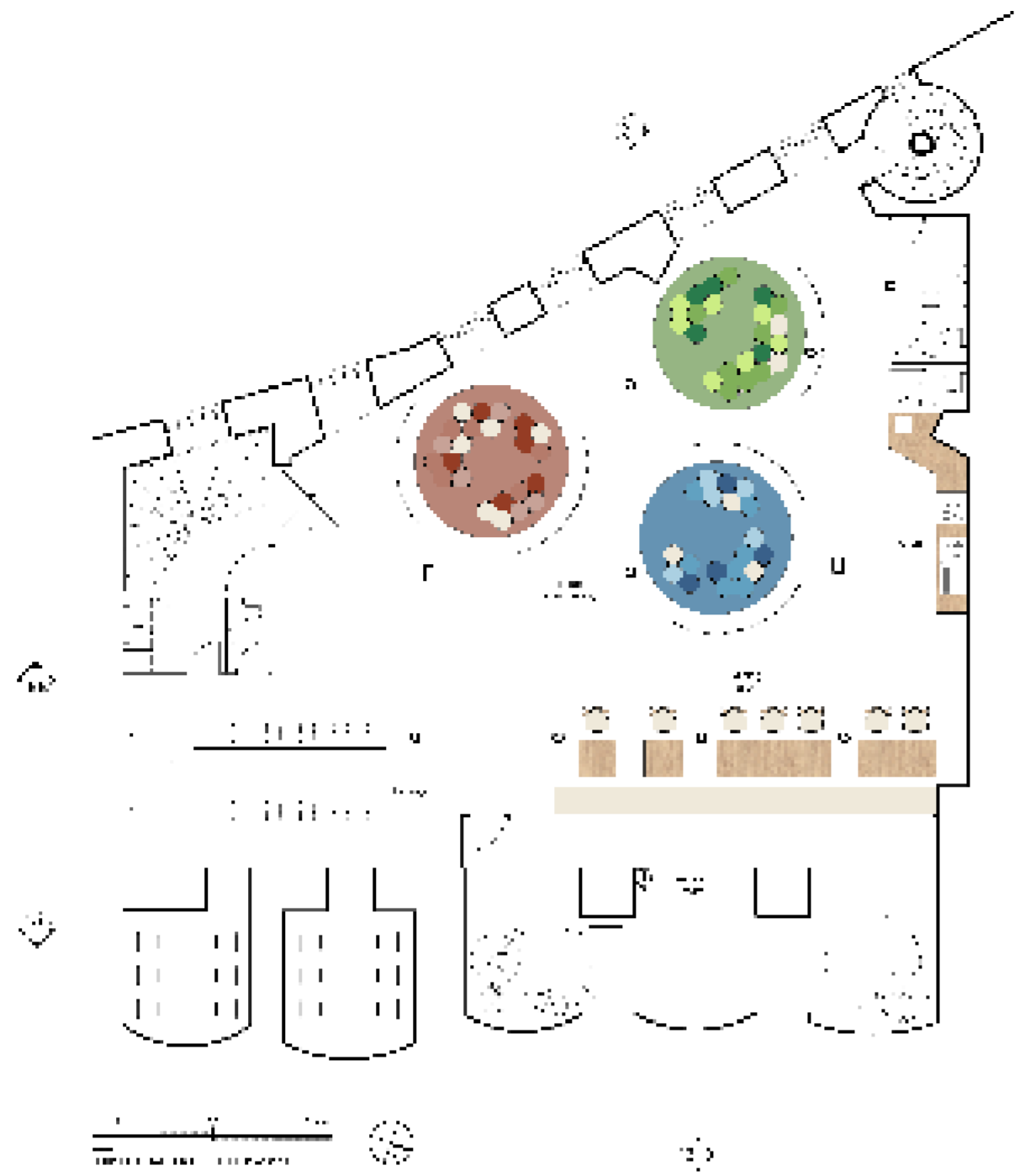

Group Counselling

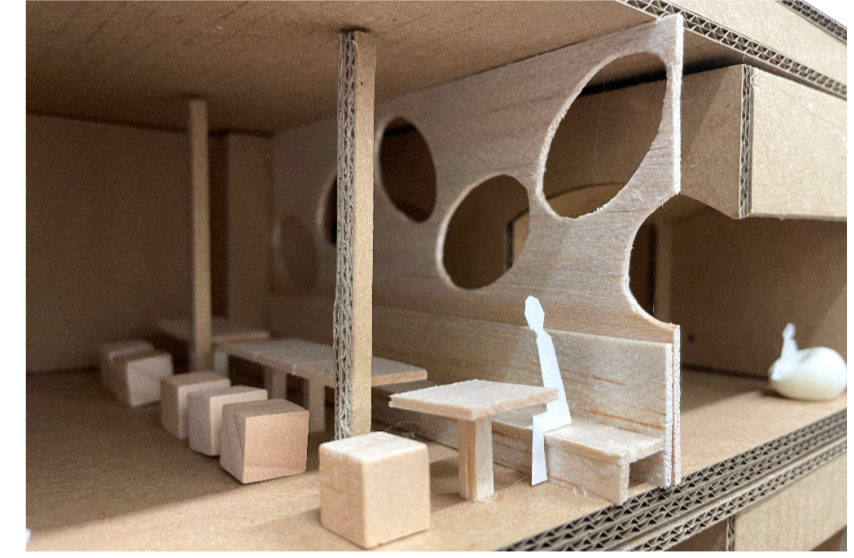

Restaurant

Basement

Unit desk for workshop, moveable for different situations. Curve shaped partition in between individual counselling and family workshop. Individual counselling has three separate rooms for different situations, with different furniture choice and layouts. Each has curtain to block view.

Individual Counselling

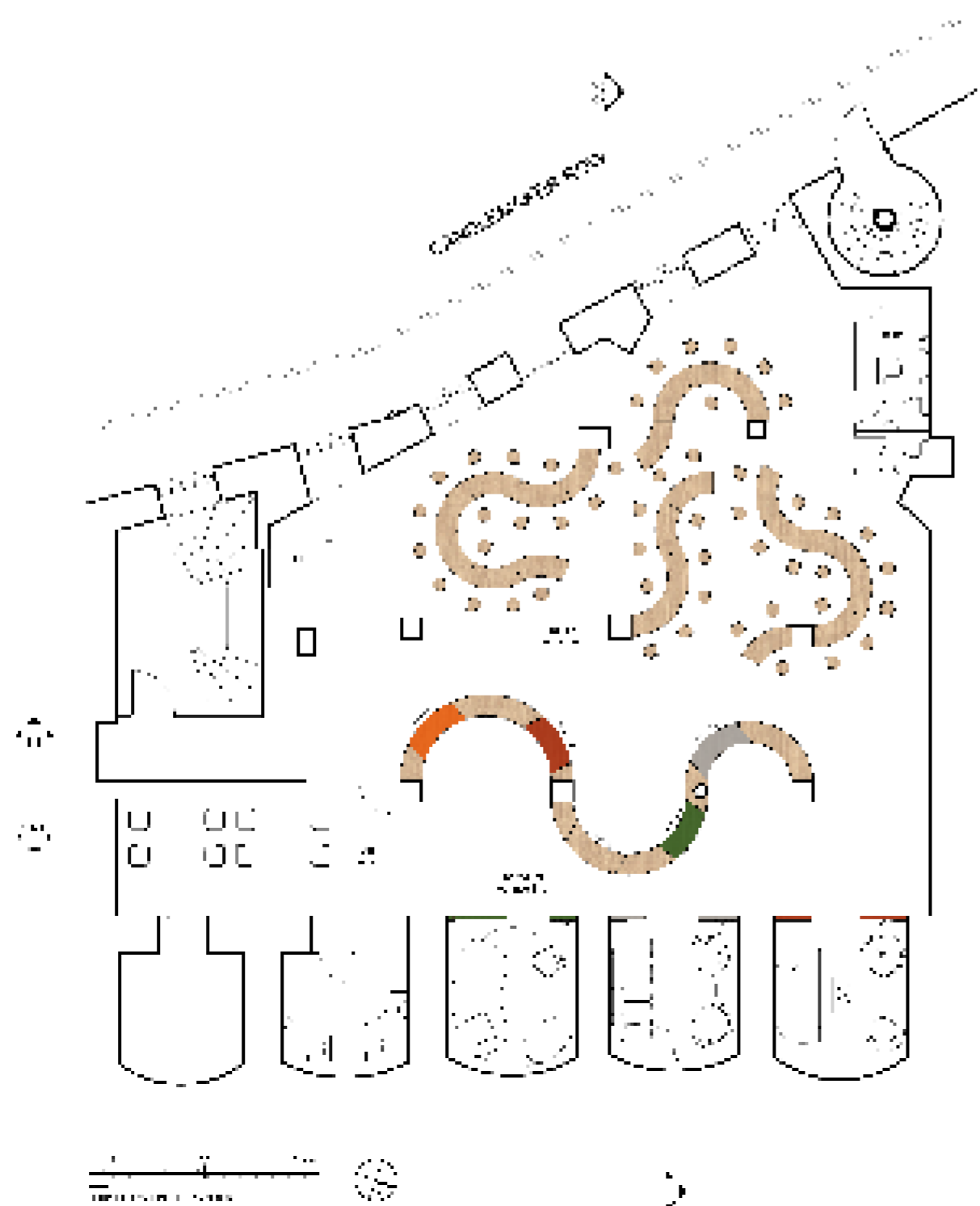

Workshop



Workshop Partition

