

# Volt

## ACCOMMODATING THE EV FUTURE

'A typical passenger vehicle emits about 4.6 metric tons of carbon dioxide per year'.



WHAT IF WE RECHARGED OURSELVES AND OUR VEHICLES SIMULTANEOUSLY



WHAT IF TIME BECAME A GIFT



WHAT IF A CHARGING HUB COULD ENCOURAGE SUSTAINABILITY

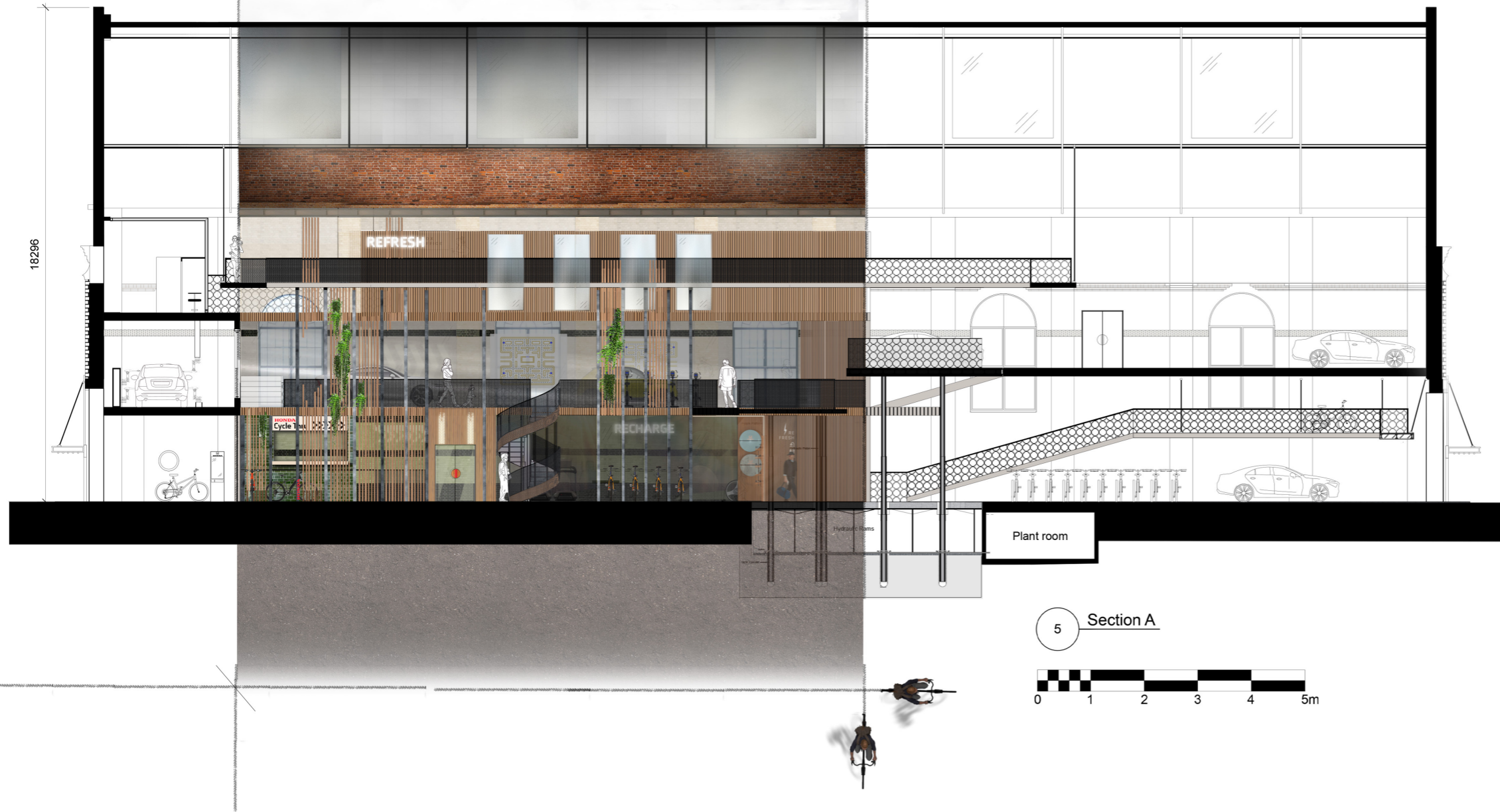

## BRIEF

Volt is located in White City, Shepherds Bush in central London, and with the impact of the automotive industries' global greenhouse gas emissions contributing to an all-time high, Electric cars, plug-in hybrids, and other battery-powered vehicles are viewed as a vital particularly in ULEZ zones. The transition to electric powered vehicles is a vital change to aid the climate crisis. In the near future, how will we adapt the thousands of petrol and service stations to accommodate electric charging?



## CONCEPT

A self-sufficient, sustainable charging point in central London where time is a gift. The charging hub is for the car, the cyclist, the commuter, and open to everyone wanting a re-charge. The hub intertwines the car and user, as the vehicles that get us from A to B deserves a pamper as much as we do. Users are free to find their charge whether that is a quick coffee, haircut, game of ping pong, or a spin class which contributes to the power generated to charge your electric car.

## SUSTAINABILITY

Volt encourages sustainable travel, whether you drive a electric car or ride a bike. As the use of electric vehicles increase, what else can we do to encourage and live sustainably? As Volt encourages getting people moving, using specialised gym equipment, our energy can provide power to the building. Renewable energy sources are another way to make the building sustainable, sources such as Solar Power will be placed on the roof to provide energy to the building. The Volt building will have a green roof which will improve drainage and the air quality.

## GLOBAL GOALS

-  **TARGET 11.6 : REDUCE THE ENVIRONMENTAL IMPACT OF CITIES**
-  **TARGET 7.2 : INCREASE GLOBAL PERCENTAGE OF RENEWABLE ENERGY**
-  **TARGET 9.4 : UPGRADE ALL INDUSTRIES AND INFRASTRUCTURES FOR SUSTAINABILITY**



RECHARGE



REFUEL



REFRESH

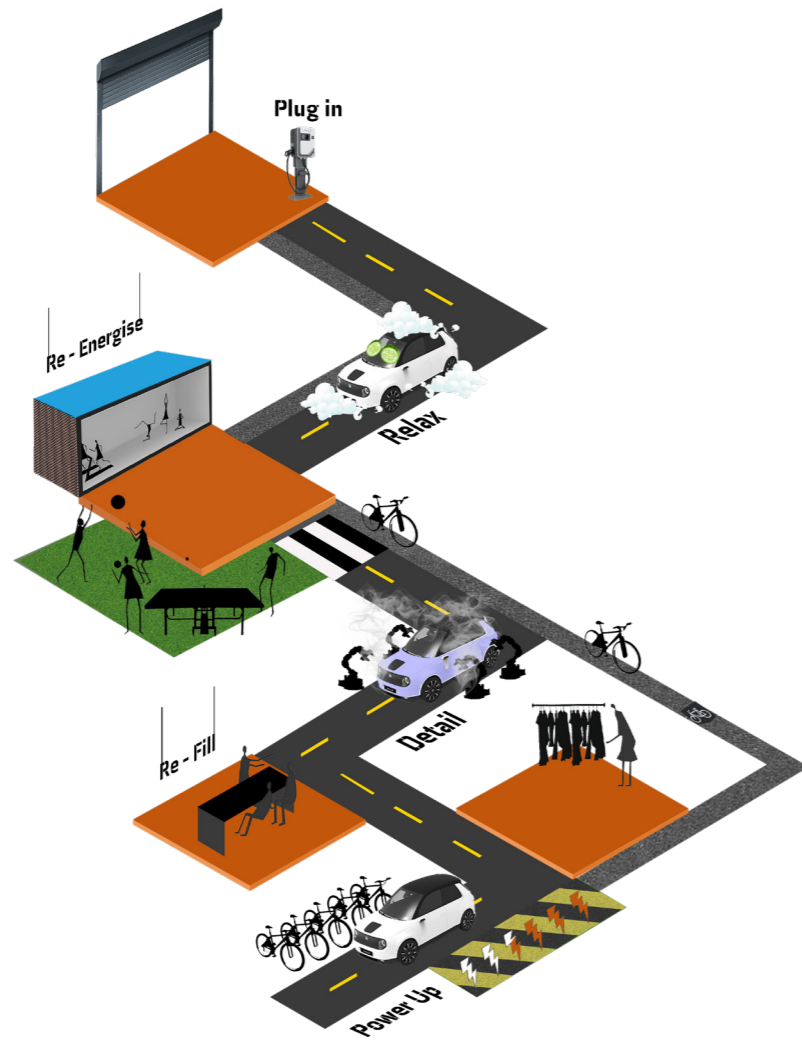

**SECOND FLOOR PLAN KEY**

1. Welcome desk
2. Spa
3. Sauna
4. Nail salon
5. Treatments / Barbour
6. Micro Offices
7. Business cafe
8. Business cafe counter
9. Stock room
10. Suspended running track

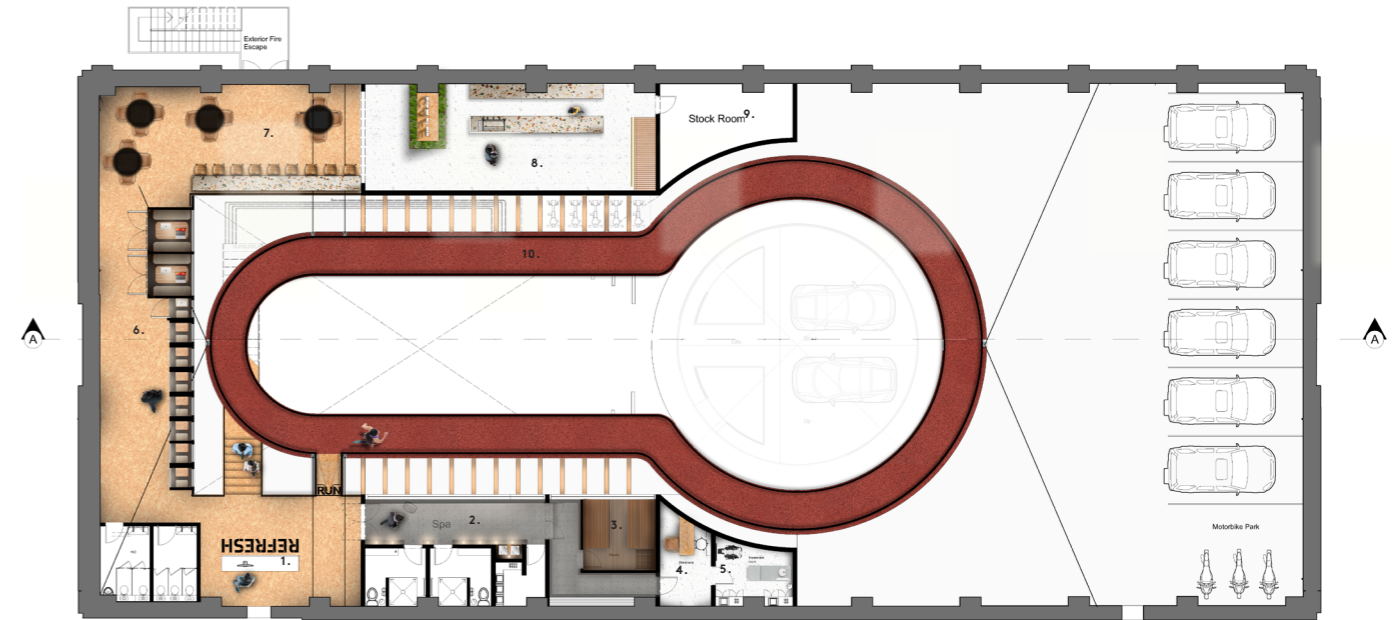

3 Second Floor  
Scale: 1:100

**FIRST FLOOR PLAN KEY**

1. Vehicle Entrance
2. Pedestrian Walkway
3. Fire Exit
4. Charging Bays
5. Motorbike Park
6. EV Journey Conveyor
7. Car Wash
8. Robotic Valet
9. Vending Machine
10. Car Rotation
11. Power Up Spin

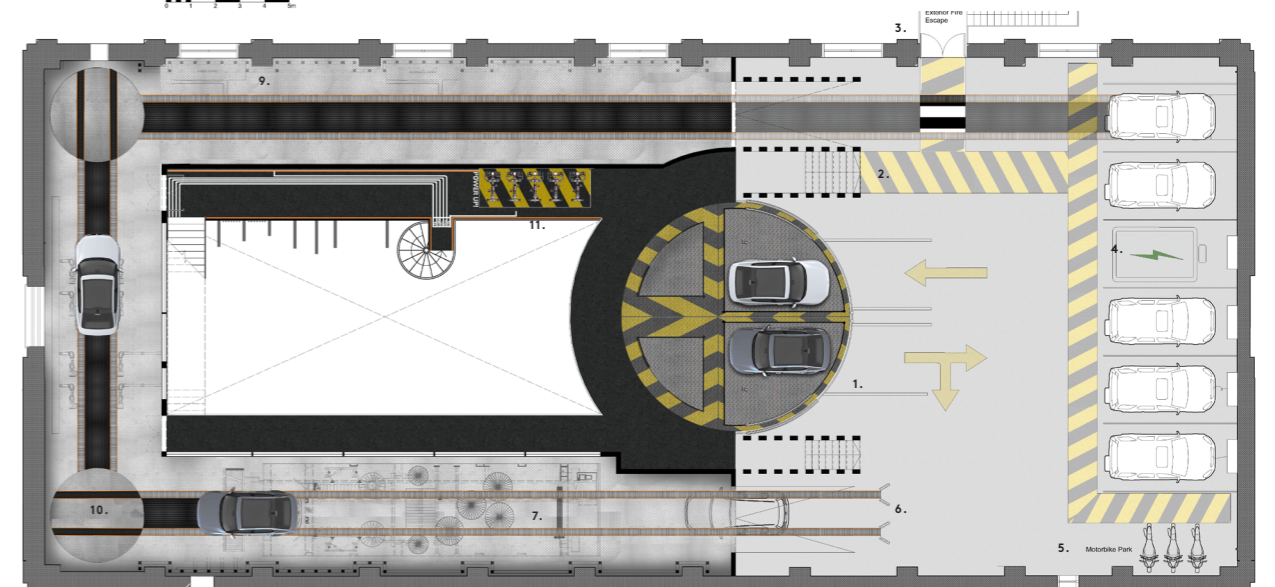

2 First Floor  
Scale: 1:100

**GROUND FLOOR PLAN KEY**

1. Pedestrian Entrance/Exit
2. Central Reservation
3. Ping Pong
4. Cafe
5. WC
6. Kitchen
7. Accessible WC
8. Gym
9. Repair Store
10. Cycle Lane
11. Cycle 'Drive Thru'
12. Bike Park
13. Pedestrian Exit
14. Vehicle Entrance
15. Vehicle Exit
16. Cycle Lane Exit
17. Staff Room
18. Pedestrian Up/Down Lift
19. Vehicle Up Lift
20. Vehicle Down Lift

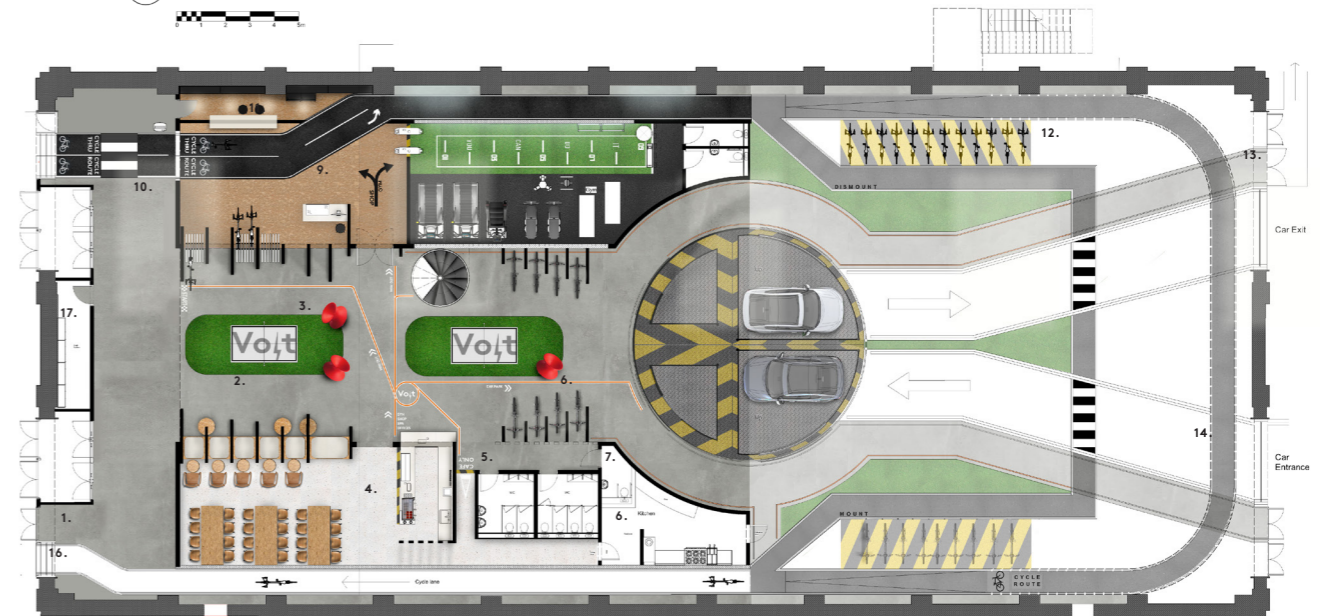

1 Ground Floor  
Scale: 1:100

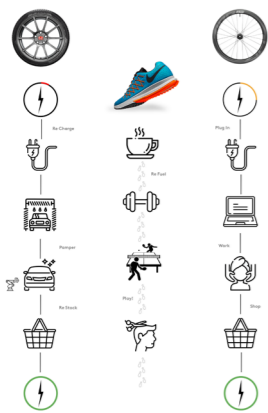
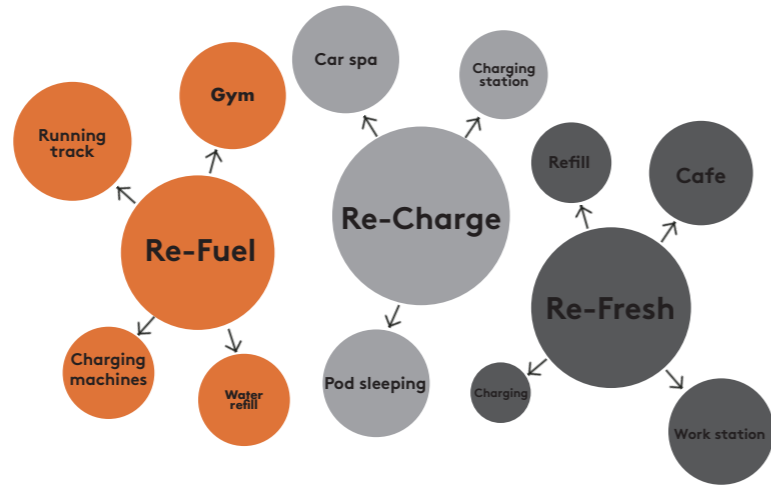

BRAND

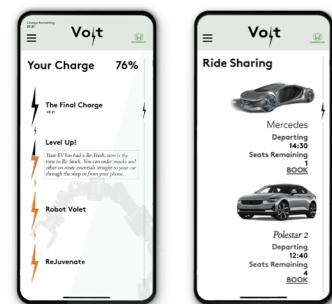



## POWER UP!

The First floor is predominantly for the EV, getting pampered throughout its robotic journey, the track ends with a final push from the user, a quick spin is a small contribution to powering Volt with electricity producing spin bikes. Riders spin to a Volt game to push the charge.



## THE CENTRAL RESERVATION

The Central Reservation is the 'open' middle area of the building. Surrounded by a streetscape facade on either side, the central reservation is open to all, whether it is to play ping pong or sit and chill.

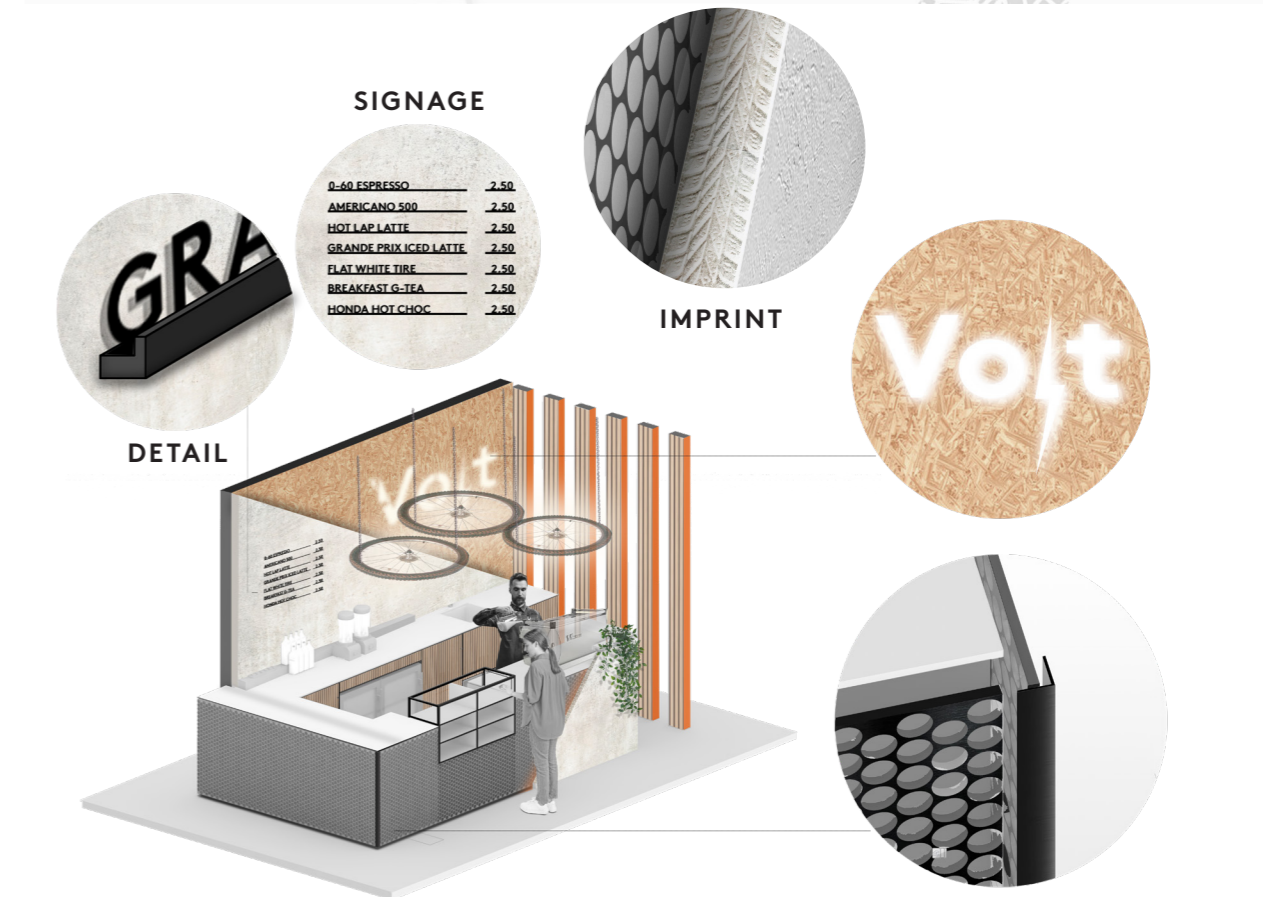

## SCHEME

The overall scheme portrays a variety of wayfinding and signage in order to assist each user. The bright floor graphics will direct those on foot, bike or car around the building, each line or sign leading to a destination for example the gym, cafe or spa. I will repurpose spare parts from bikes, cars and other vehicles for furniture, fittings and materials. Other recycled elements include OSB board and recycled tire rubber flooring. The materials used in my scheme will be chosen with longevity in mind, as the space will endure a constant flow of people and variety of trails for example footsteps and tire marks.

# Volt

