



CONTACT INFORMATION

phone: 07472033683
email: carrielouise.wilkinson@gmail.com
LinkedIn: Caroline Wilkinson
Instagram: @carrie...interior

WE ARE NATURE

Rebuild the bond between humans and nature, through adaptive reuse and Right to Roams ethos.

CURRENT PLANS AND SECTIONS

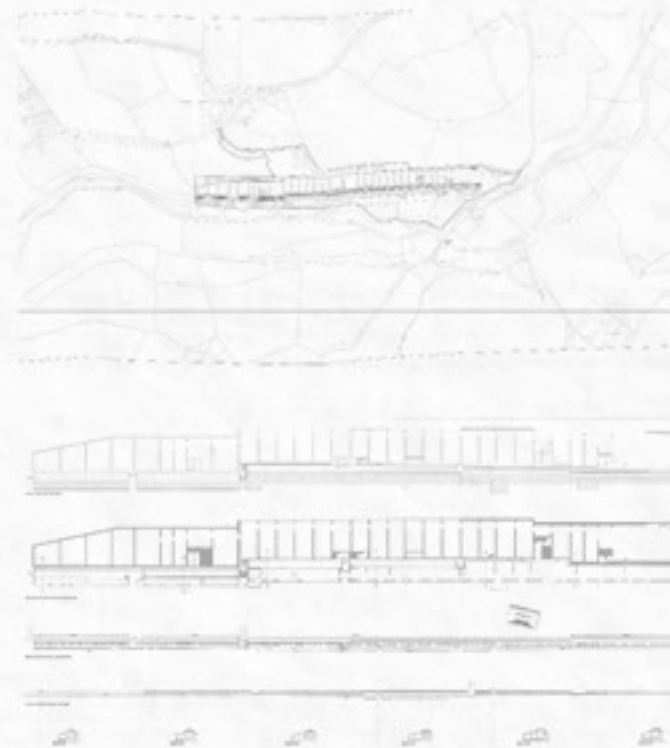

CRITICAL POSITION

As a designer we have a duty of care to the earth and the impact our designs have on our environment. Going beyond sustainability and into phenomenology and the way humans are impacted deeply by the spaces we inhabit.

As a climber my connection to the earth is through my sport, connecting to the rocks as they support me in my ascent, knowing rock types and how my interactions with them effect their degrading process brings me closer to the natural environment. My approach to design reflects this, in my empathetic user centred attitude that aims to educate others through FF&E and design choices that have a positive impact.

SITE IMAGES



SITE ANALYSIS

Wendford Dries is an old clay drying factory

abandoned since 2002.

The site sits set back into the countryside alongside the Camel river. The Camel Cycle trail runs along this river and right past Wendford Dries, the trail itself is wide and tarmacked making it accessible and ideal for anyone getting into rambling. The trail itself links up to the Cornwall coastal path. All these things make it an ideal location for Right to Roam.

CONCEPTUAL FORMULA

STEP 01 - Existing Site



STEP 02 - Wattle and Daub Structures



STEP 03 - Recycled Textiles Protecting from the Elements



STEP 04 - Found Furnishing



ORDINANCE SURVEY



BLUE SPACE

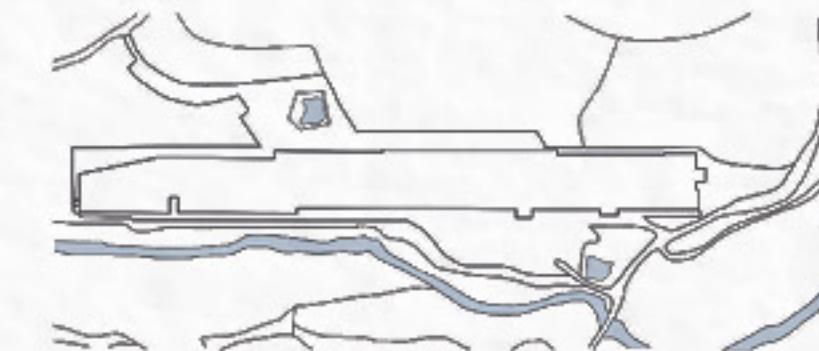

Blue space is especially important for this project because of its calming quality in humans and natural ability to connect people with nature, they also create zones of interest and show the Camel River cycle trail.

SUNPATH

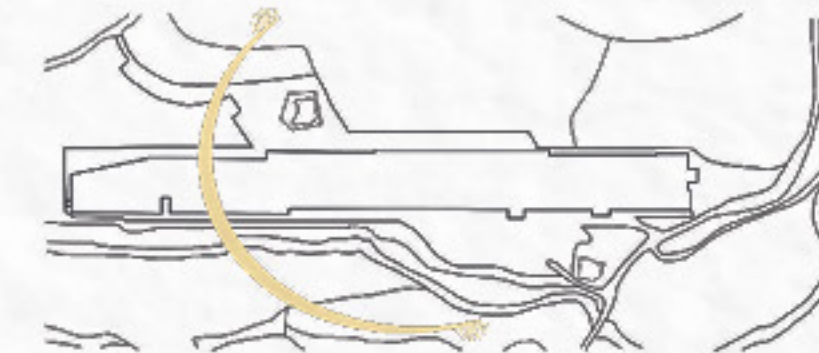

Due to the landscape the site has great sun potential and gets lots of natural light

VIEWS

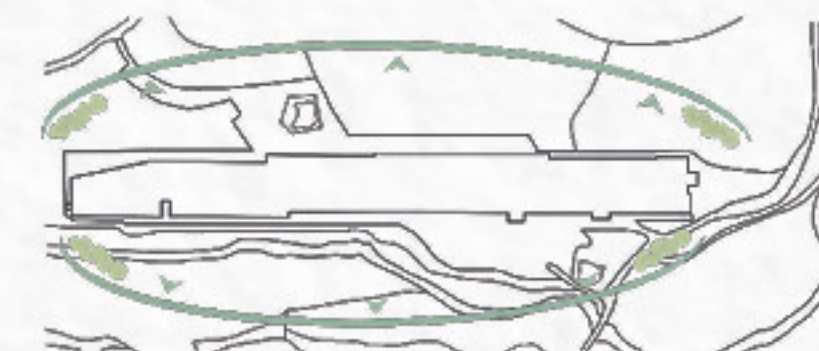

The site has great views from the main floor but also 365 views from the dries

DESIGN STATEMENT

92% of England's countryside has no free roaming access rights.

I've teamed up with the Right to Roam charity organisation to design a hub, colonising an abandoned clay factory in Cornwall, that has strong ties to the natural environment, considering creative re-use as an adaptive strategy. The space aims to provide ramblers with a place of refuge and also provide workshops that inspire people to consider their relationship with nature, inviting new people to join the fight! Rekindling the bond between humans and nature.



BUSINESS CASE

Right to Roam will be able to generate income from this dedicated space, from the restaurant and the shop. Also continuing their current donation based ticket system for events and workshops, whereby you can buy a ticket for the event at a ranging selection of prices based on what you feel you can contribute.



WHERE

Wendford Dries, Bodmin, Cornwall PL30 4QX

WHO

Right to Roam, and anyone who believes in their cause, as well as ramblers and passers by.



CLAY AS A CREATIVE STARTING POINT FOR ADAPTIVE REUSE

WE ARE NATURE



CLAY FORMS INSERTED INTO SITE



Clay is an important material for this project as the site has strong ties to the material as it is a drying factory. Clay is also a historically important material rich in storytelling another key part of the concept, finally the ability to connect with nature through pottery and other clay work.

The impact that humans have on a natural material can be demonstrated using clay as shown by the images to the left.

Creating shapes that suited the flow of the space and provided areas of shelter.

First clay forms were created for all the chosen spaces but only the most suited ones will stay, those that are positioned where appropriate level of shelter is needed and those that add to the journey throughout the space

STEP 01 - Hand Moulded Clay Model

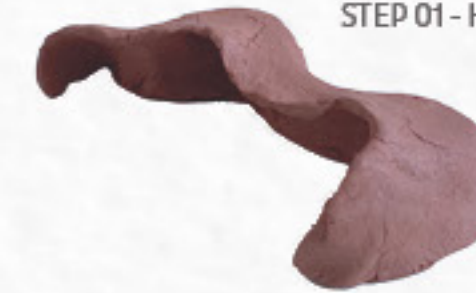

STEP 02 - Digital Scan of Clay Model



STEP 03 - Add Model Into Design

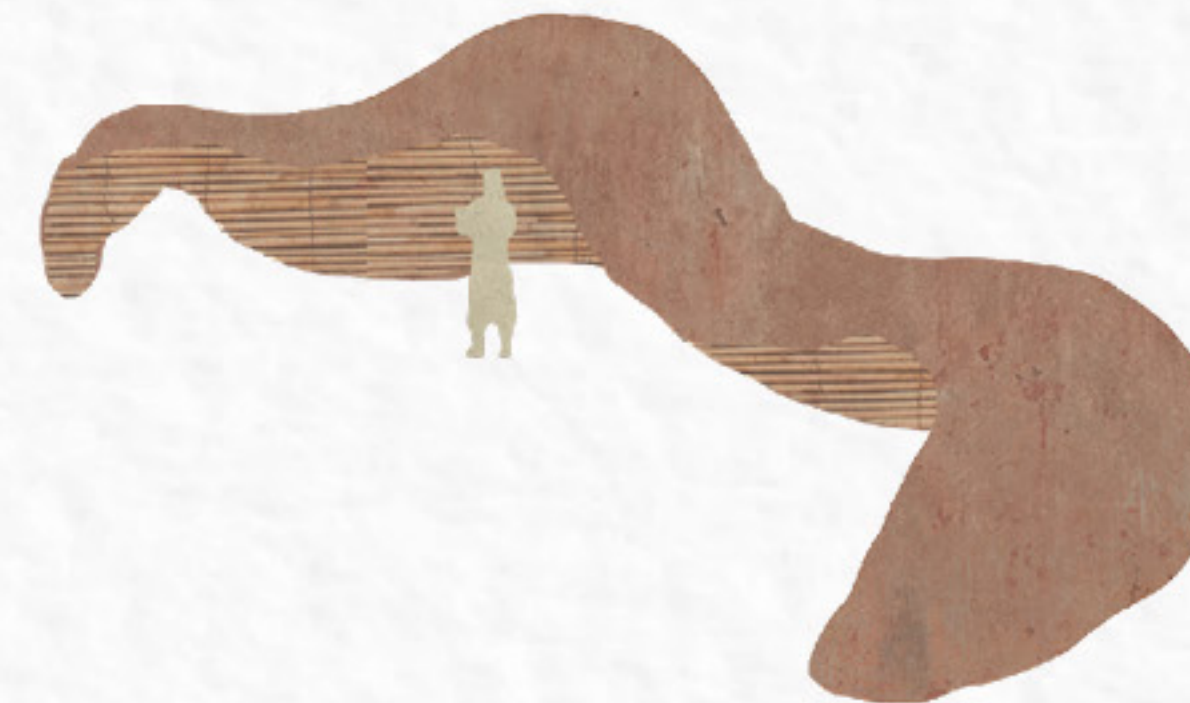

MATERIALITY OF THE STRUCTURES

The structures that were formed through clay experimentation must now be considered as area of inhabitation that need to provide shelter but also be made from materials that can be abandoned to degrade over time.

They are also going to serve as a community creative project therefore need to be simple to assemble.

The structures will be formed from weaved willow and then a natural fabric that has been treated with beeswax will be fixed over the outer surface to create a waterproof barrier.

WELL v2- 8 CONCEPTS TO IMPROVE WELLNESS IN BUILDINGS

Clay as a material allows for many of these conceptual principles.

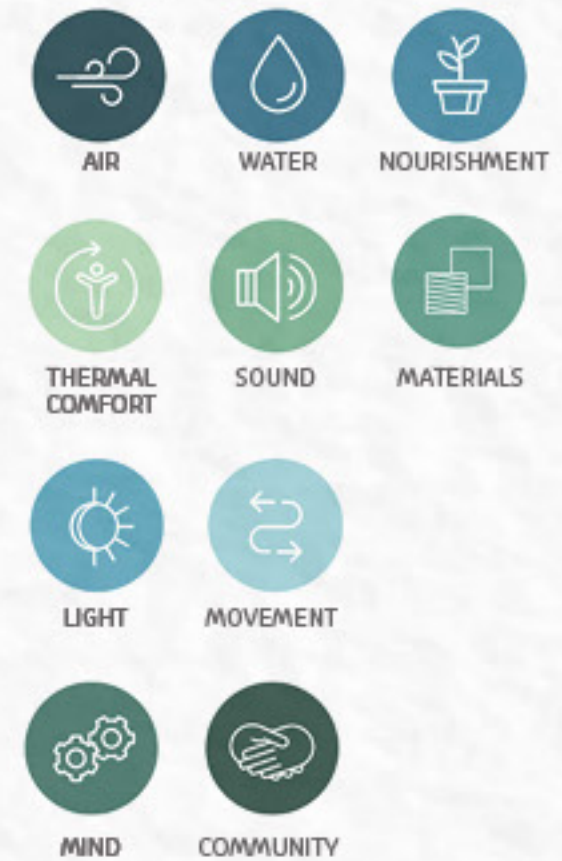

most amount of human intervention
Considering what happens when humans come into contact with nature and the transformative effect this can have both positively and negatively.

least amount of human intervention

"Over 49,000 miles of historic paths have disappeared from the official maps' and '32,000 rights of way have been blocked or obstructed."



USER JOURNEY

01 Mud Room - First clean your boots and hang your coat to dry

02 Restaurant - Grab a coffee in the restaurant

03 Exhibition - See local artists in our exhibition space

04 Lecture Theatre - listen to one of our informative speakers about our planet

05 Library - relax in the library and expand your knowledge of the natural world

06 Shop - support Right to Roam by visiting our shop

07 Cafe - Have dinner by the fire

08 Workshop - Immerse yourself in nature with art workshops that encourage you to explore your relationship with natural materials

09 Camp - Spend the night and camp with like minded people

10 War Room - Join the fight! Right to Roam war room for planning protests and organising events

SCHEDULE OF ACCOMMODATION

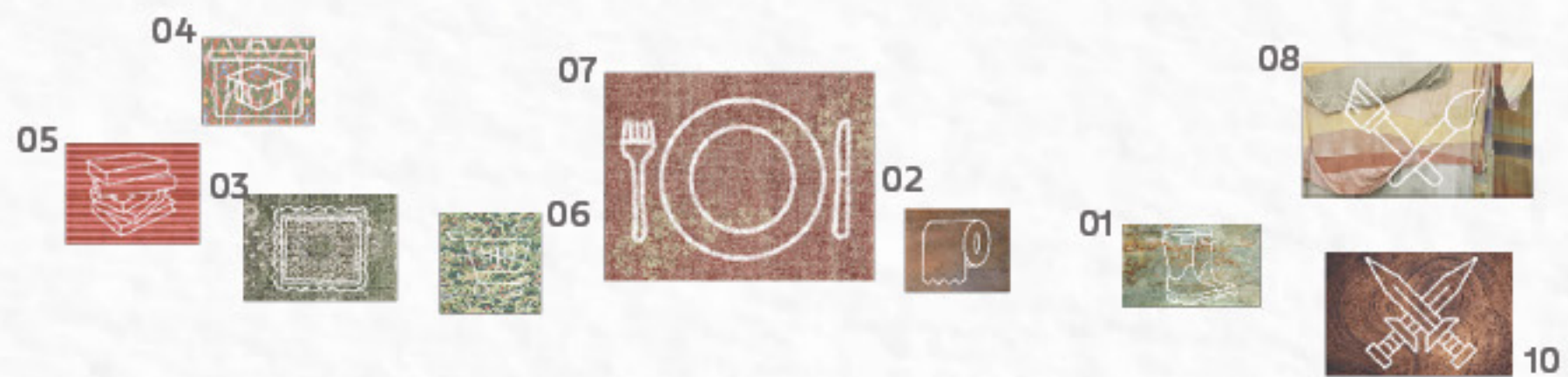

CONCEPT

IMPACT

Impact as a concept displays the effect that we as humans have on a space, this shows the area that will be inhabited in red and the areas that will be left to be taken over by nature in green. Access limitations to land partially exist because of the negative impact humans have on the environment, these spaces will be demonstrating how humans can inhabit a space and still consider the impact they are having.

CONNECT

Connect conceptually demonstrates the warmth and areas of exposure in the space, this is linked to my critical report and Maslow's hierarchy of needs, in order for humans to be fulfilled in a space they need shelter from the elements and warmth. The existing chimneys in the site can be used as sources of heat, while structures can be built in the more open areas to fulfil these needs.

MOVEMENT

Movement as a concept discusses the transient nature of the right to roam act, and the act of trespass two ideologies that are crucial in the discussion of access rights. This shows the organisation of the schedule of accommodation in response to the site. These include the chimneys, the openings that provide views of the countryside, the various access points in and out of the building and the areas that are beginning to fall apart and become exposed.

EARLY MATERIAL CONCEPTS



"92% of the countryside has no right to roam"

IMPACT

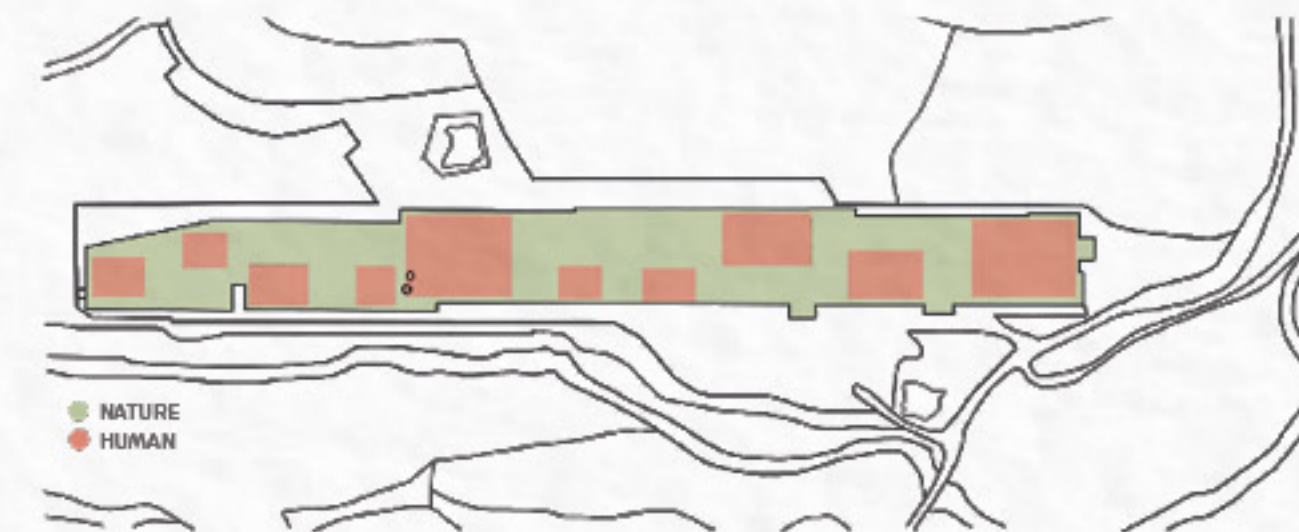

CONNECT

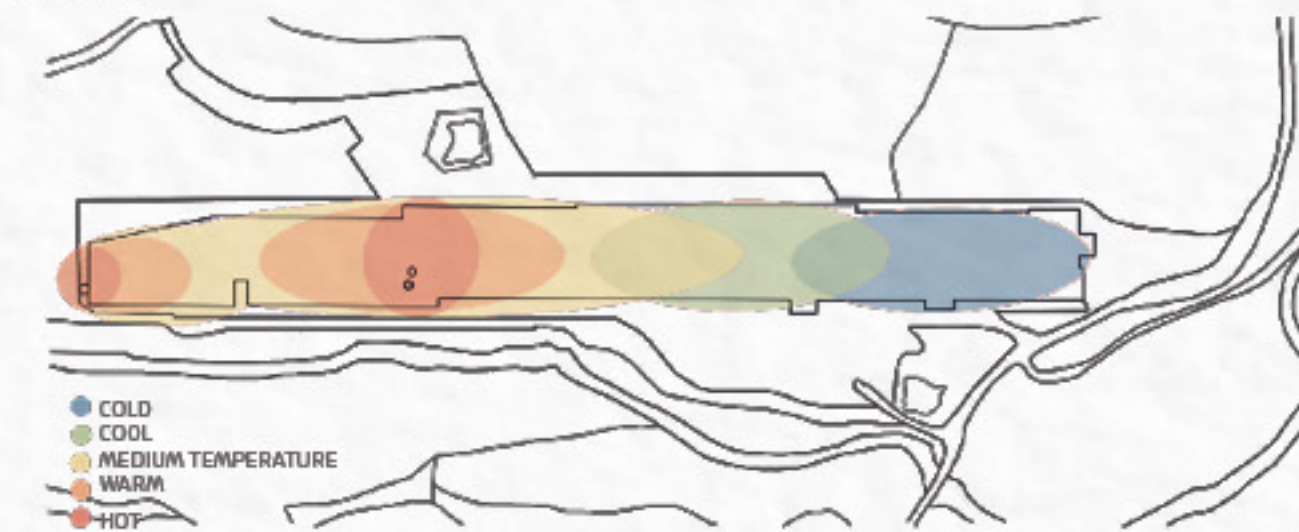

MOVEMENT



OPENINGS ALONG THE FACE OF THE SITE



MAIN ENTRANCE RAMP



LARGE AREA OF BROKEN ROOF



WE ARE NATURE



WE ARE NATURE

PLANS AND SECTIONS



01 SNUG



04 MARKET

02 SPEAKERS CORNER



07 WORKSHOP



FIRST FLOOR

01 SNUG

02 SPEAKERS CORNER

04 MARKET

07 WORKSHOP

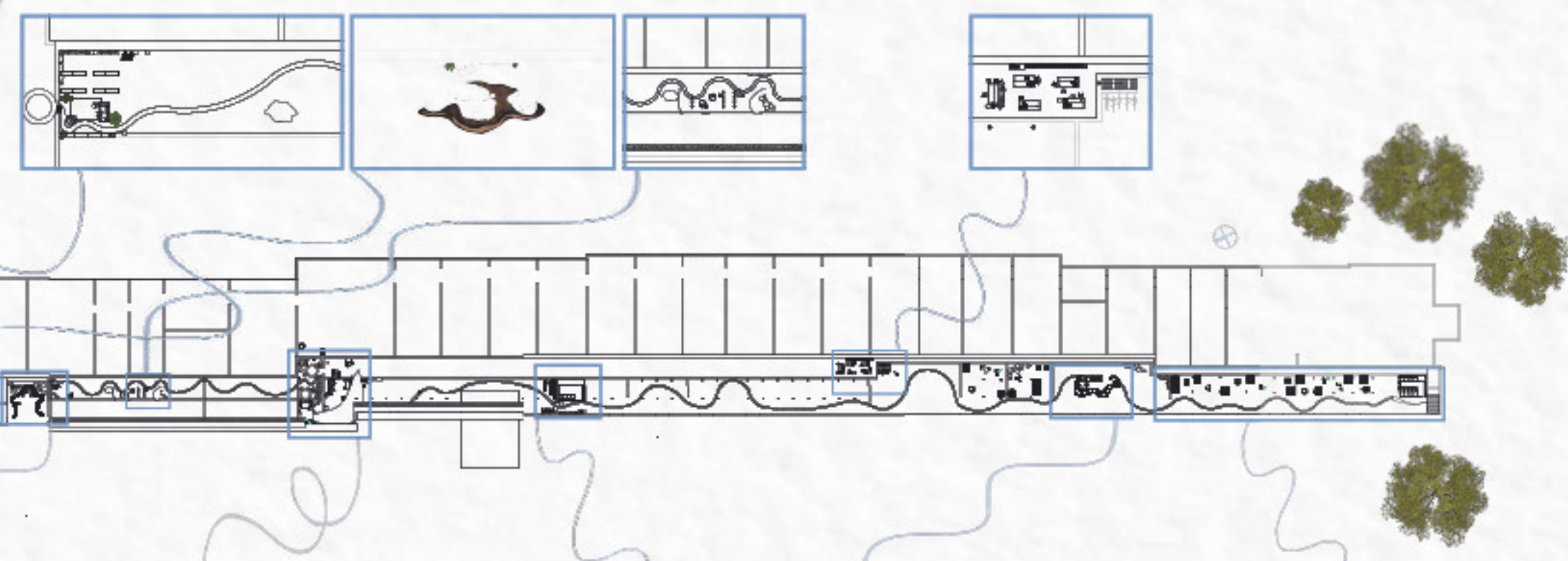

THE SITE AS A BACKDROP

Continuing to look to the site as a creative starting point and considering all the existing materials in the site, as the backdrop for Right to Roam Inhabited spaces



GROUND FLOOR

03 EXHIBITION



05 LARDER

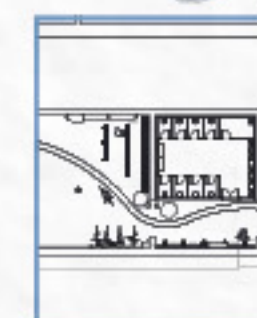

06 MUDROOM



08 WAR ROOM



09 CAMP GROUND



05 LARDER



08 WAR ROOM

03 EXHIBITION



06 MUDROOM



09 CAMP GROUND



SUSTAINABILITY STATEMENT

This project will reduce its environmental cost using a light touch that aims to not change the existing site, considering inhabiting the space very temporarily with a low impact on the natural environment and by extension the building and the nature that has begun to take it over.

Right to Roam will consider reuse by using found furniture and materials, second hand, Facebook marketplace or donations to the charity.

Recycling, where reuse is not possible will consist of all natural materials that are found from the earth when sourcing clay for structures and any finishes for the inserted structures in the space. Natural materials create a carbon neutral environment. Choosing local materials and materials that are the byproduct of the china clay industry so nothing is wasted.

"There's a right to roam in only 8% of England, much of it in remote areas of mountain, moor, heath and down, rather than the places the majority of us live."

REFLECTION

In conclusion this project fulfils Right to Roams needs whilst also allowing them to expand their following as an organisation and inspire even more people to fight for better access rights in the uk and use this space to prove how we are connected to nature in the hopes that we learn to take care of it.

DECONSTRUCTION FORMULA

Continuing to emphasise a light touch and adaptive reuse, with Right to Roams natural ethos by having a plan in action to quickly and safely return the site back to nature.

BRANDING

The branding for this project comes directly from its ethos and partner Right to Roam Kernow.

Taking their symbol and simplifying it, to combine it with the logo for we are Nature. Creating a new revenue stream for the Right to Roam organisation.

RIGHT TO ROAM KERNOW LOGO



WE



ARE



NATURE

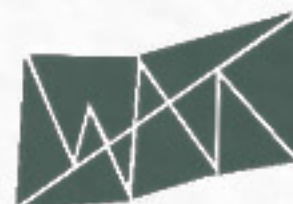

BACK

FRONT

WE ARE NATURE

WATTLE AND DAUB STRUCTURES

STEP ONE

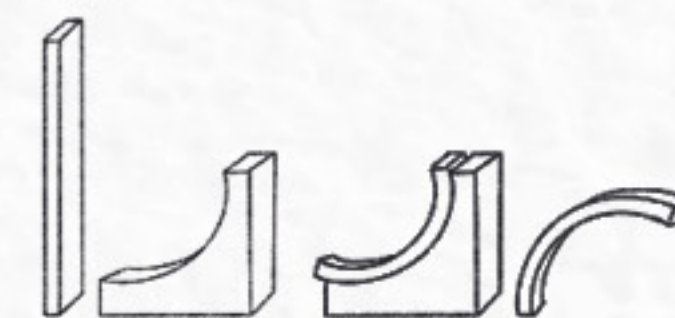

STEP TWO

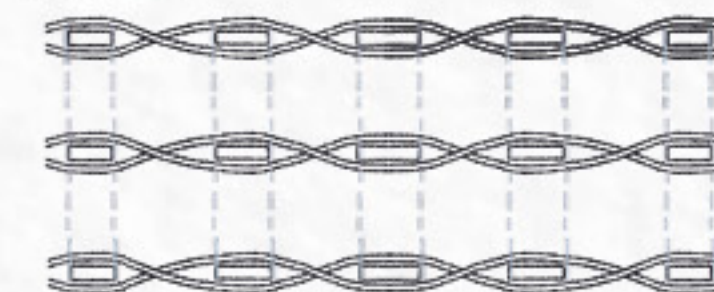

STEP THREE



RECYCLED FABRIC AS PROTECTION FROM THE ELEMENTS

STEP ONE



STEP TWO



STEP THREE

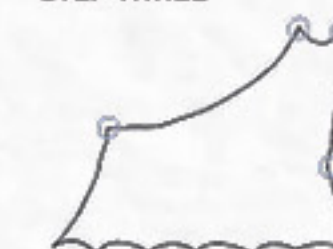

DECONSTRUCTION FORMULA

STEP 01 - Furnishings that can be easily removed.



STEP 02 - Patchwork fabric to be de-constructed and reused or left to biodegrade.



STEP 03 - Wattle and Daub returning to its base elements.



STEP 04 - Original Site.



MATERIALITY AND TECHNICAL DESIGN

CURVING STRUCTURAL BEAMS

The structural beams will need to be bent using a mould, the wood is made damp and then bent and clamped to the mould in order to keep it bent as it dries. The wood then remains permanently bent. They can then be used to create the main structure of the form before the wattle and daub is added.

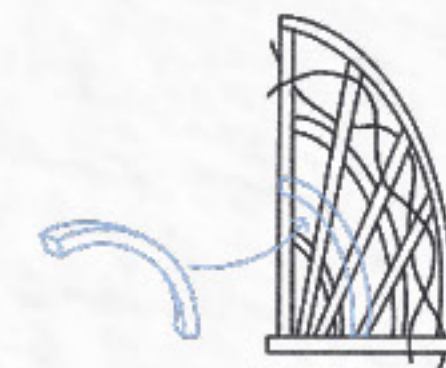

WATTLE

The wattle is woven between the structural beams. The second piece being woven in the opposite direction to the first, continuing to alternate until you have built a wall of interlacing willow branches.

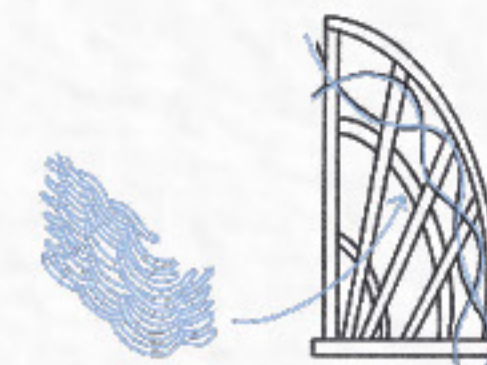

DAUB

First gather the clay dust as a bi-product of the Wenford dries clay drying factory, gather straw and add to your mixing bowl add water and knead together until it forms a paste. Finally apply this to the wattle you may need to do a few layers letting each layer dry before adding the next.

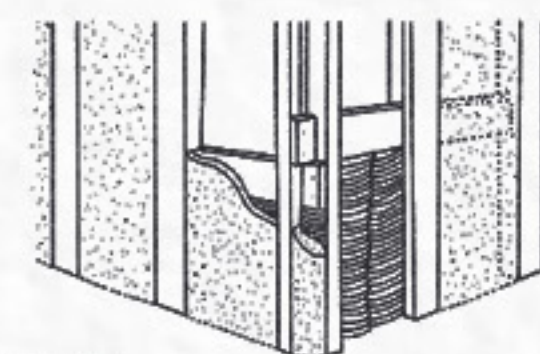

PATCHWORK

Textiles can be found from charity shops or recycled from industry bi-products. In order to create a large enough piece of fabric, all the scraps should be cut into rough squares in order to be sewn together in a patchwork pattern.



BEESWAX

The beeswax is added by first melting the wax and adding it to a spray bottle this is then sprayed onto the patchwork fabric and left to dry, the fabric is now more structurally sound and completely waterproof.



ATTACHMENT

The stiff fabric forms are then hung from the existing site beams, using organic or found rope at regular intervals to ensure its safely attached.

