

The Web - a female focused co-working and nursery space

The Web has been designed with the aim of creating a female co-working space and nursery space that can aid the return to work for mothers. As we all know, motherhood is a significant phase in a woman's life, and it comes with its unique set of challenges. Unfortunately, statistics show that **only 27.8% of mothers return to full-time work within the first three years following the birth of a child**. Therefore, this project aims to bridge the gap and support mothers who want to return to work by providing a comfortable, safe, and functional space that caters to their needs and those of their children.

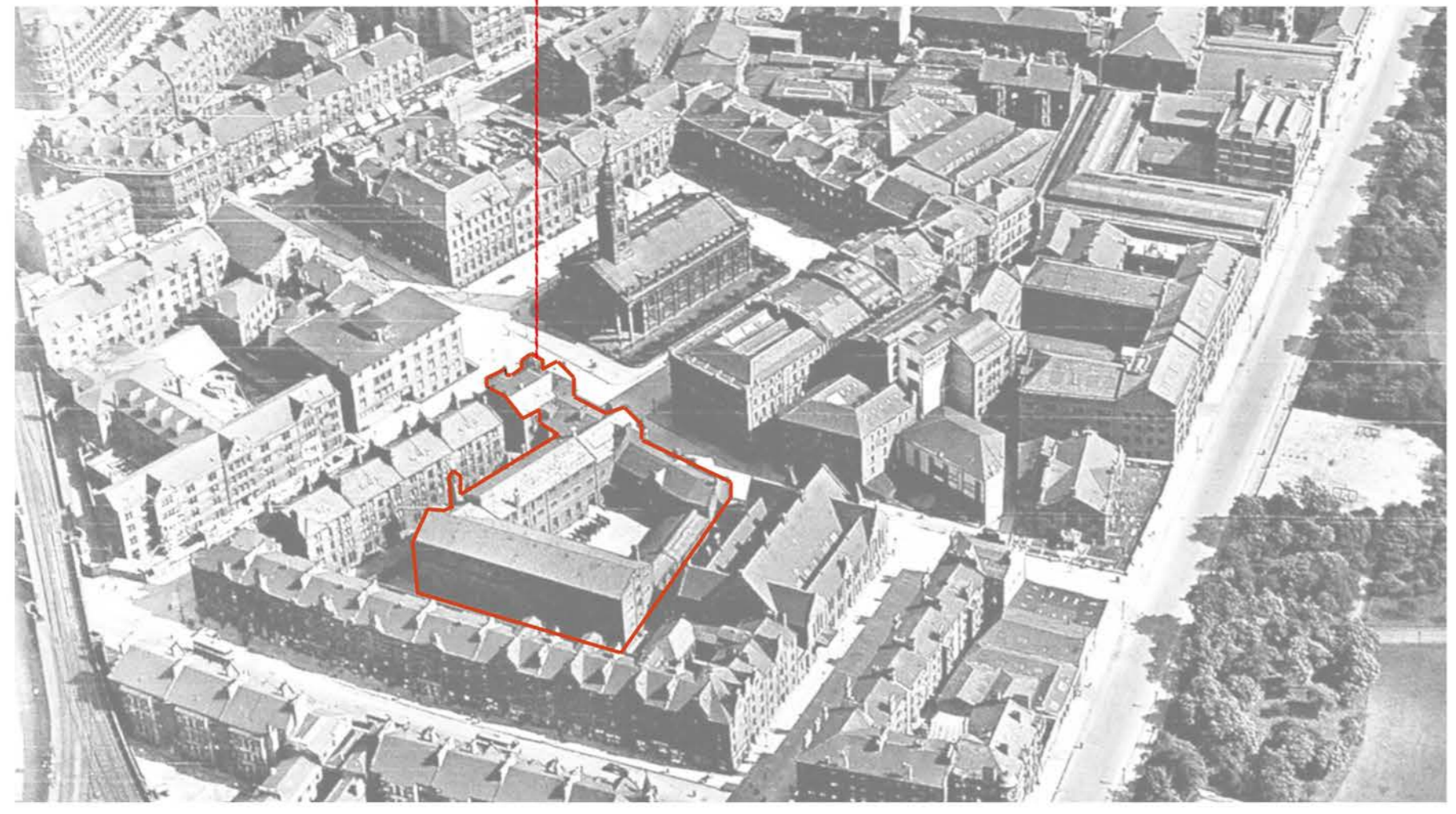
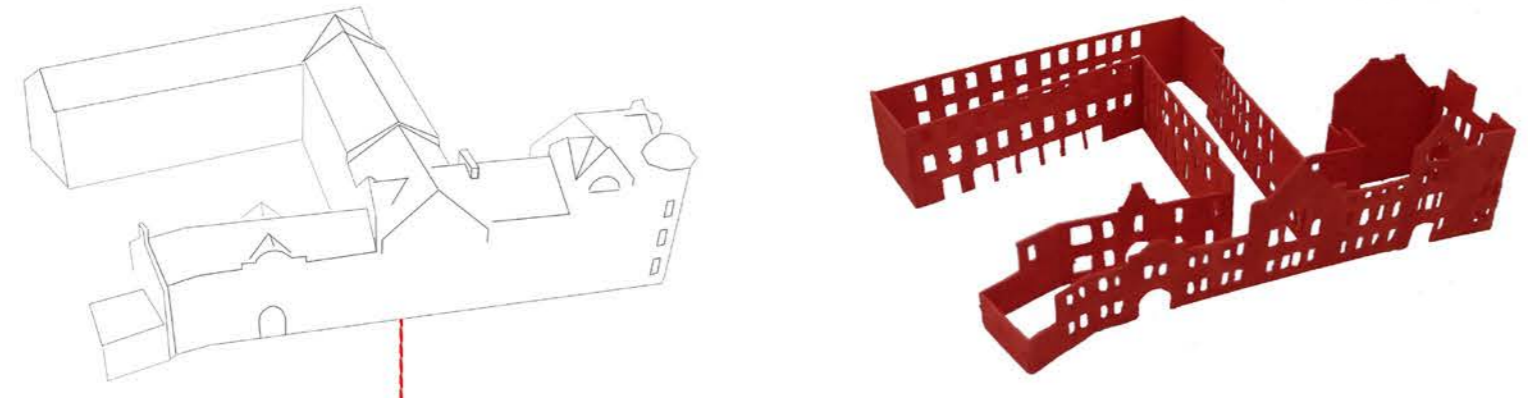

Site: 4-16 Turnbull Street, Glasgow

Formally known as Glasgow's District Court Headquarters and prison.

The three story, 49,500 square foot, Renaissance-style structure was constructed in 1903 and functioned as the Glasgow District Court Headquarters until 2008 when it ceased operations. Located on the Eastern edge of the city and part of the Calton Ward, the area has a rich history and is known for its sense of community and activism.



current photographs of site

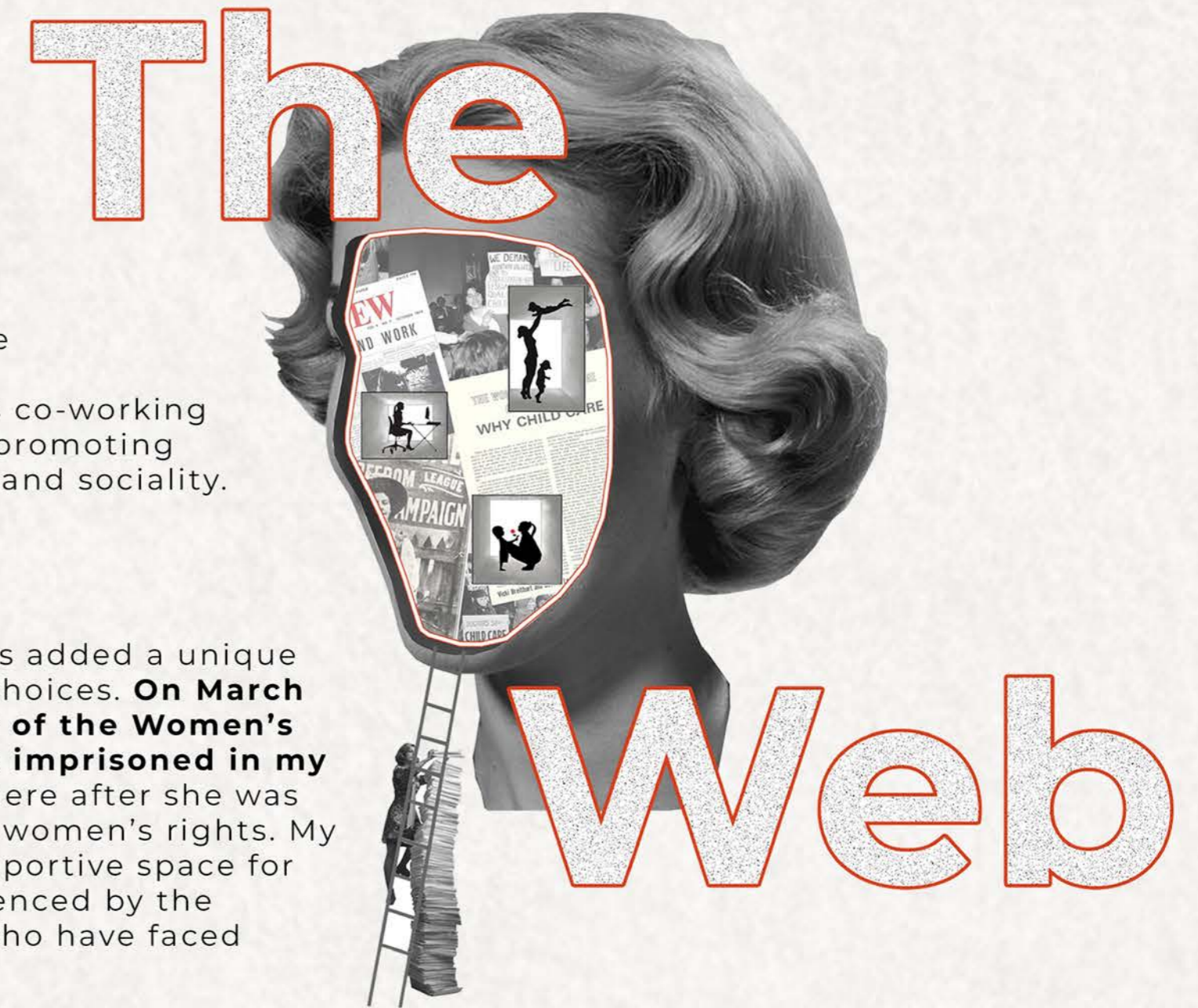

Concept : Co-working and nursery space

Typology : Women's / non-binary / trans co-working space defined as: a collaborative space promoting accessibility, community, collaboration, and sociality.

Historic significance / Narrative

The buildings former use as a prison has added a unique and inspiring dimension to my design choices. **On March 9th, 1914, Emmeline Pankhurst, leader of the Women's Social and Political Union (WSPU) was imprisoned in my chosen building.** She was imprisoned here after she was arrested for protesting and fighting for women's rights. My proposal for providing a secure and supportive space for women in the workforce has been influenced by the experiences of women like Pankhurst who have faced oppression and discrimination.



Screenshot from a GIF which highlights the struggles of working from home with young children.

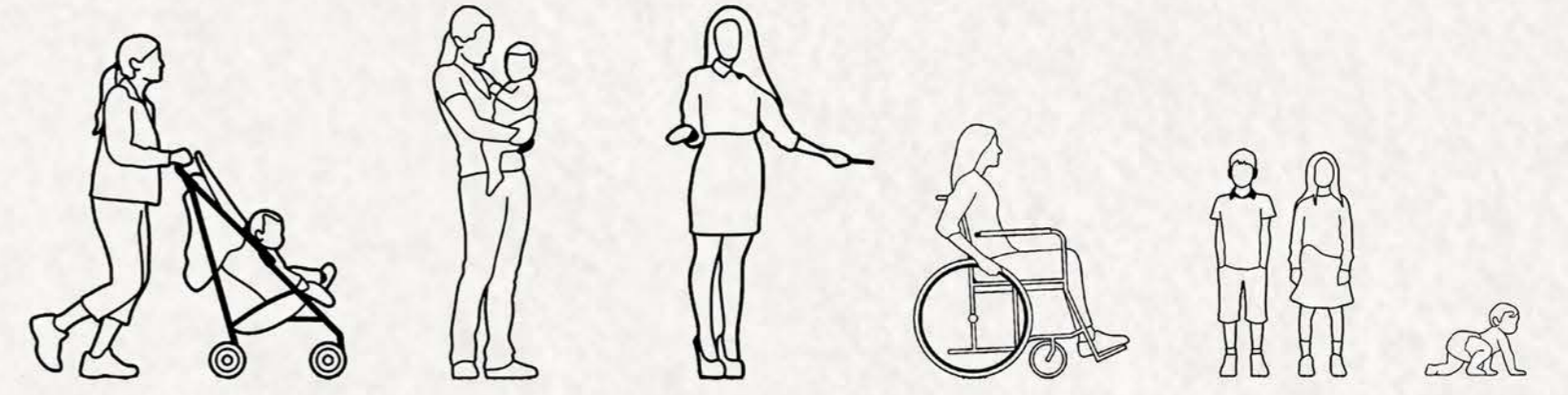
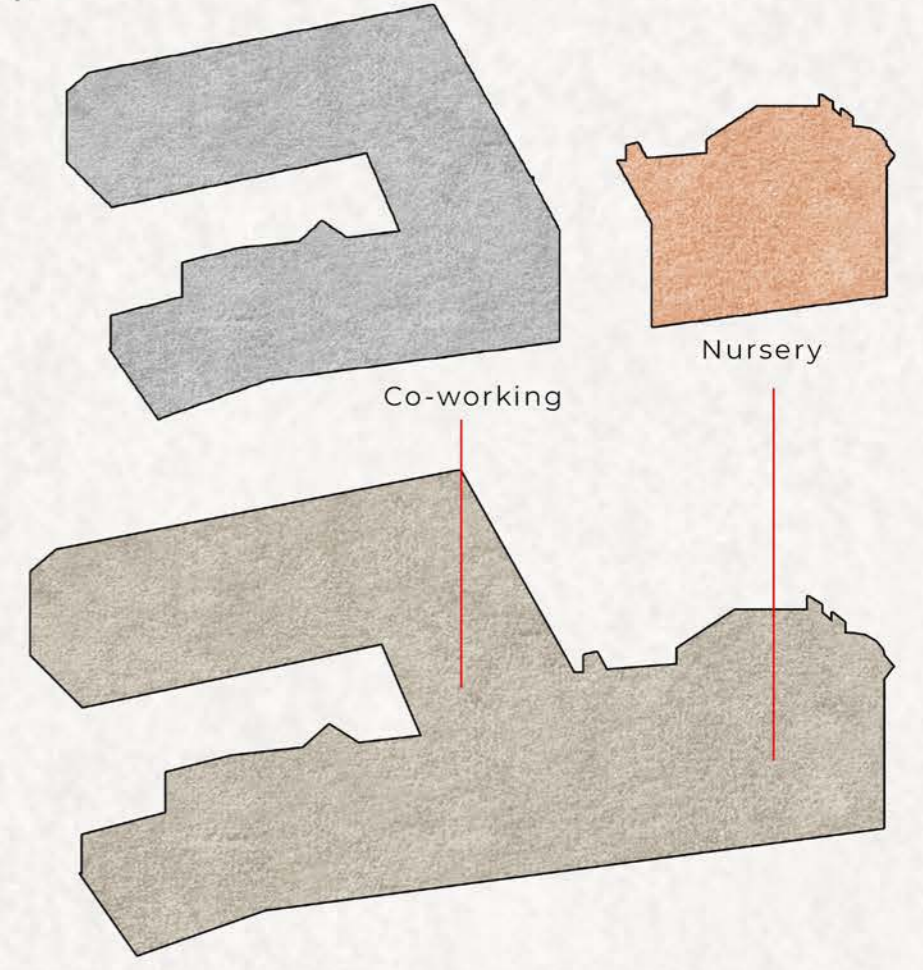

Who are the users?

- Freelancers
- Working mothers
- Remote workers
- Women returning to work
- Nursery teachers
- Young children

Communal areas

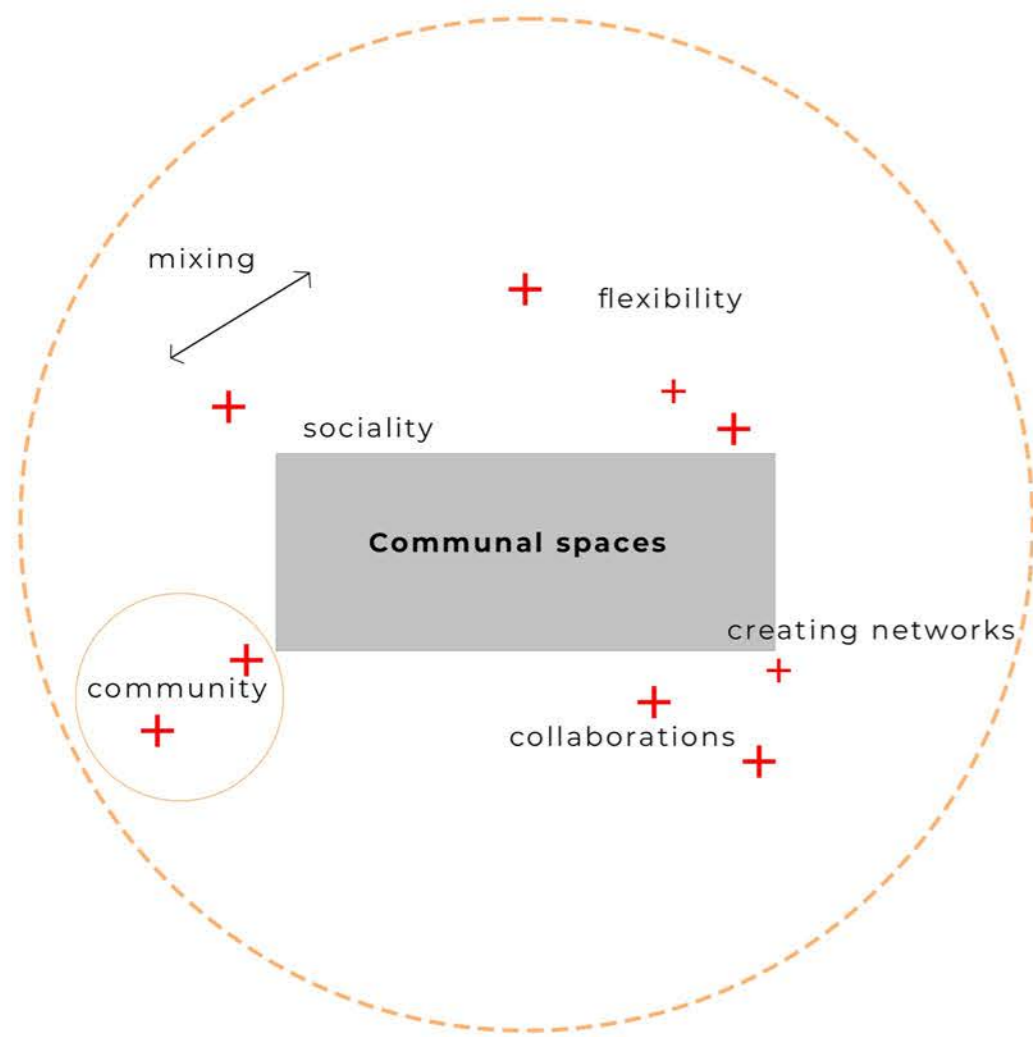

Community and **inter-user collaboration** are strongly emphasised throughout the co-working facility and the communal spaces have been designed to promote this. Throughout the space there are various communal spaces seen as relaxed lounge spaces, coffee shops, dining area's and a central court yard.

The former courtroom, now known as the court hall lounge is a place where users can interact, exchange experiences, form communities, and collaborate. The proposed design has preserved the room's structural integrity while celebrating its original elements to produce a lounge area that feels exclusive to members. A lot of light enters the room through the Venetian-style arched window and the original domed roof enhances the depth of the space.



View of Court Hall lounge space

Cellblock Coffee Shop



View of coffee shop



View of coffee shop interior

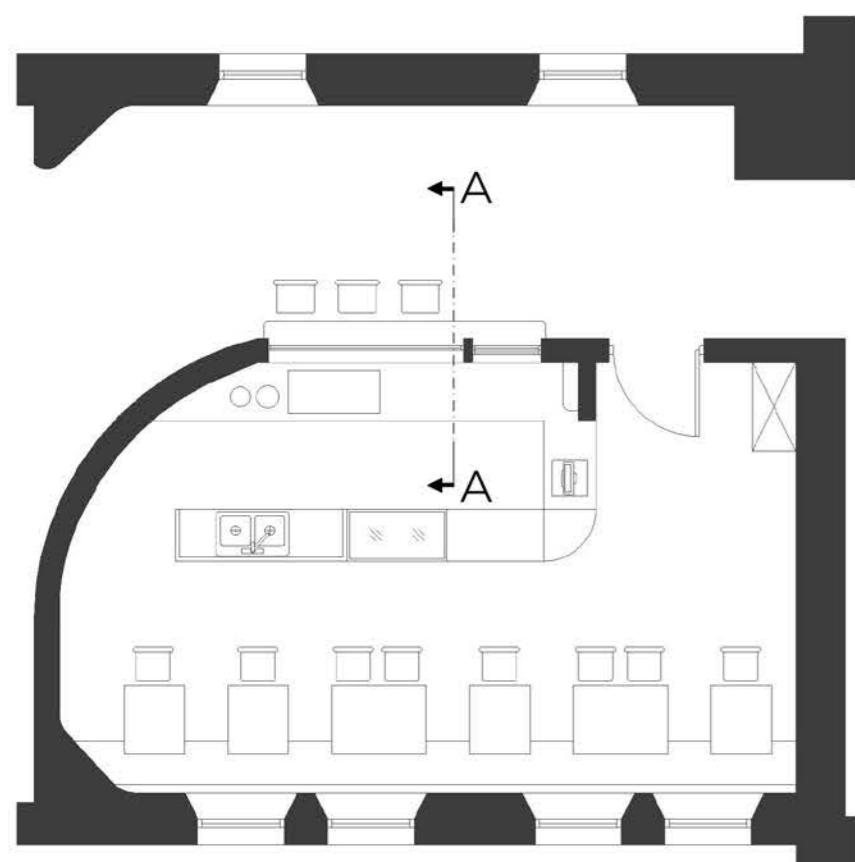

Floor plan of coffee shop

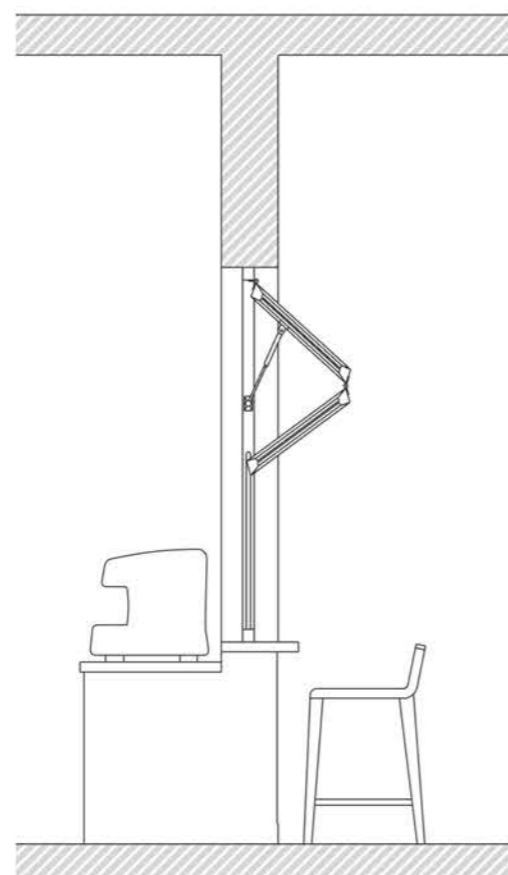

Section A-A

The co-working space's on-site coffee shop, Cellblock Coffee, serves users hot beverages and freshly baked pastries. It is located within the entryway of the co-working space and where the chief lieutenant's former's office was situated. Due to the coffee shop's proximity to the entrance area, a takeaway hatch window connects the hallway to the coffee shop, giving customers the option to buy a takeaway item on route to their work space.

Meeting rooms



View of conference room



View of communal kitchen



View of office

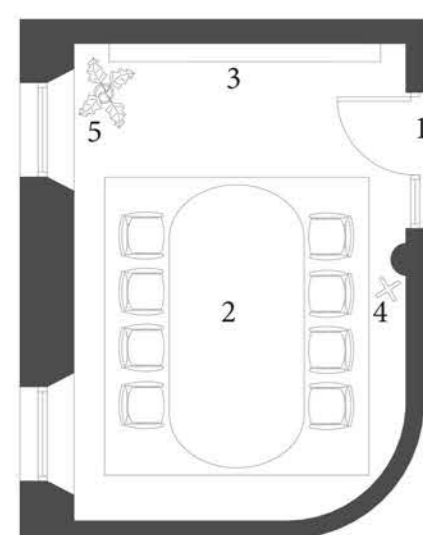
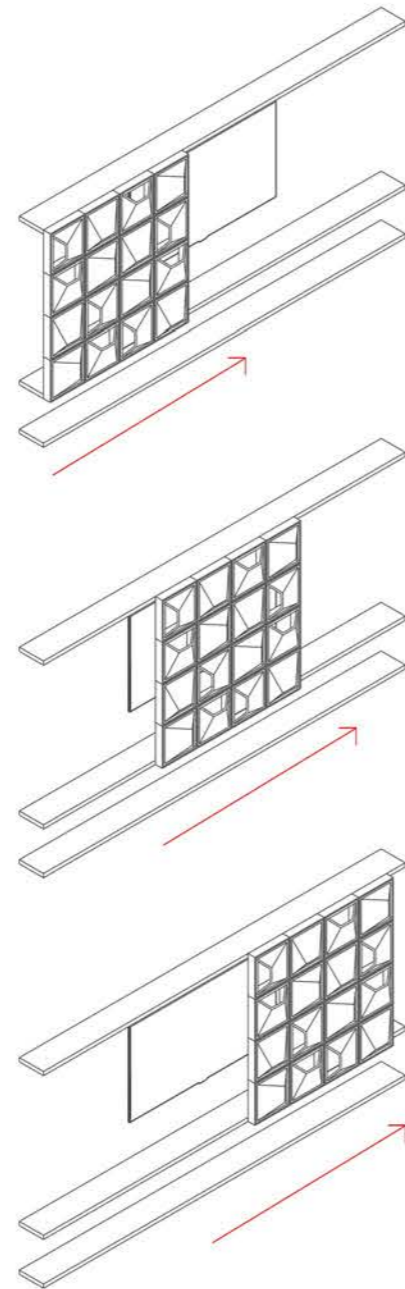
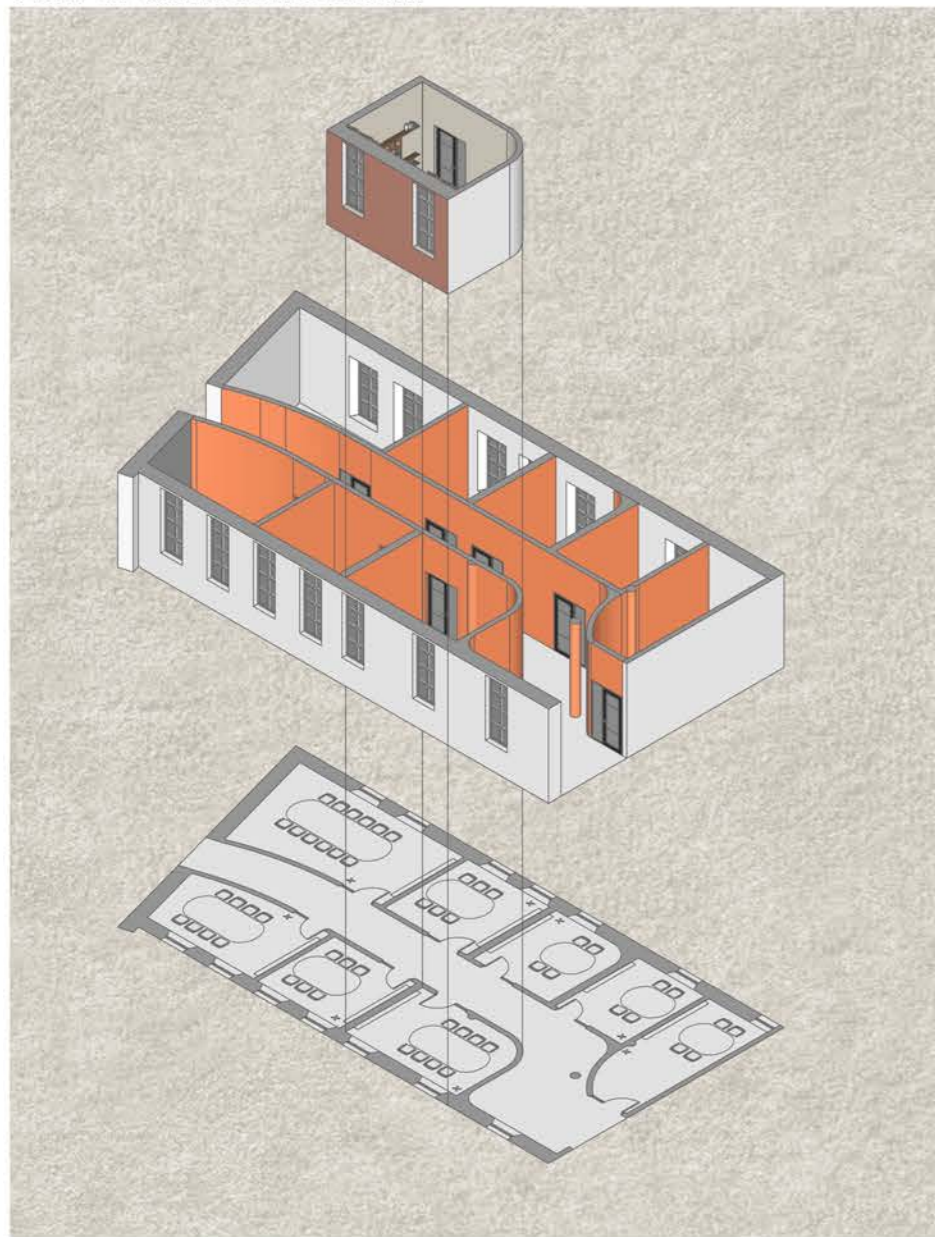

Conference room (8 person)
Floor Plan

Key -

- 1 - Entrance
- 2 - Group table
- 3 - Wall mounted unit with TV
- 4 - Coat Hanger
- 5 - Indoor Plant

Function: The sliding panel gives the technical specification a creative twist whilst allowing the user control over whether or not to reveal the TV.

Materiality:
Handmade
Terrecotta Clay tiles



Hotdesking



View of Hot Desk space

Hot desking is a flexible workplace setting without assigned desks or workspaces for employees. Instead of having a designated seat, users can occupy any available space. Hot desking can have several benefits, such as **increasing collaboration and communication among employees, and promoting a more agile and dynamic work culture.**

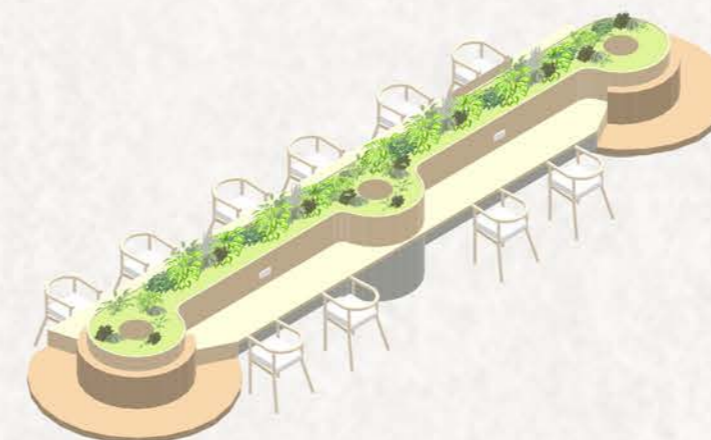

Social seating

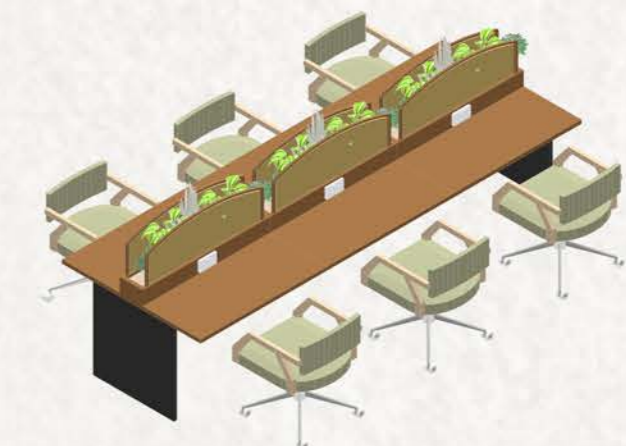

Group collaborative seating

Study pods

What is a study pod? an enclosed workspace designed for focused and uninterrupted work or study.

The hot desk area is lively and busy and therefore study pods are essential for allowing users to have a private space to take confidential calls or meetings.

The design of the study pods have been carefully considered around soundproof structure, non claustrophobic and appropriate lightening. The finished designs are functional and stylish.

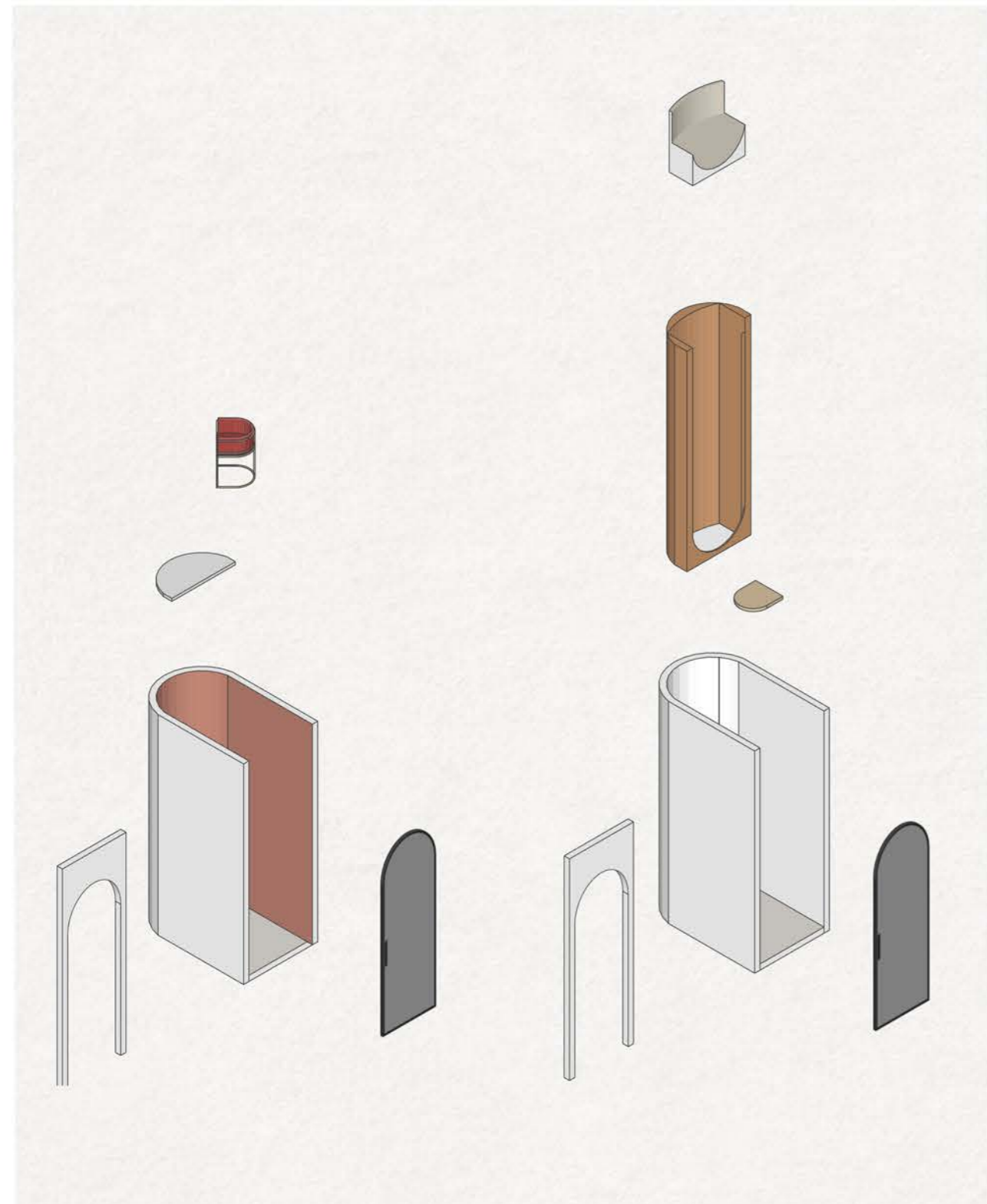

Exploded axonometric

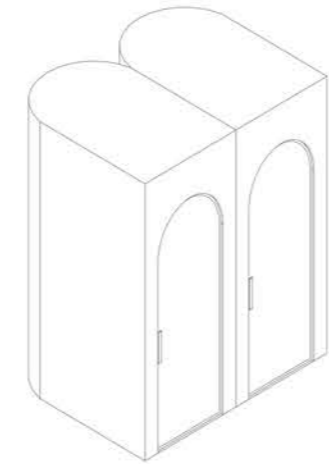

View of Study Pod

Event space



The use of sliding curtains allows for the creation of a number of private spaces for various activities, or for the creation of a large open area for large events and the display of substantial works of art.

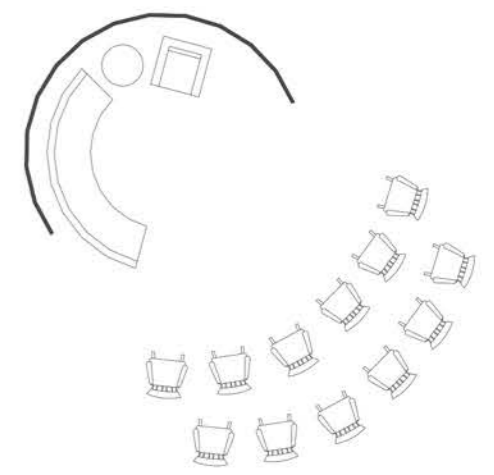

Live talk

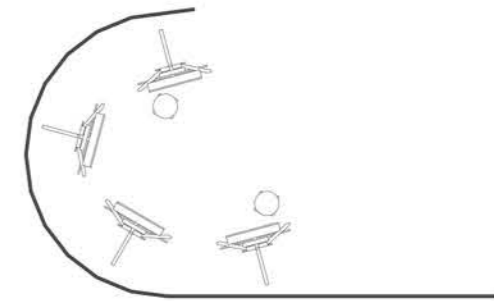

Art exhibition

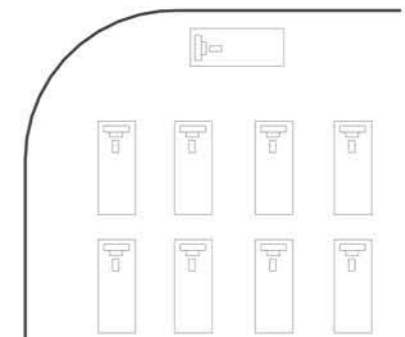

Yoga class



View of live talk taking place in the event space

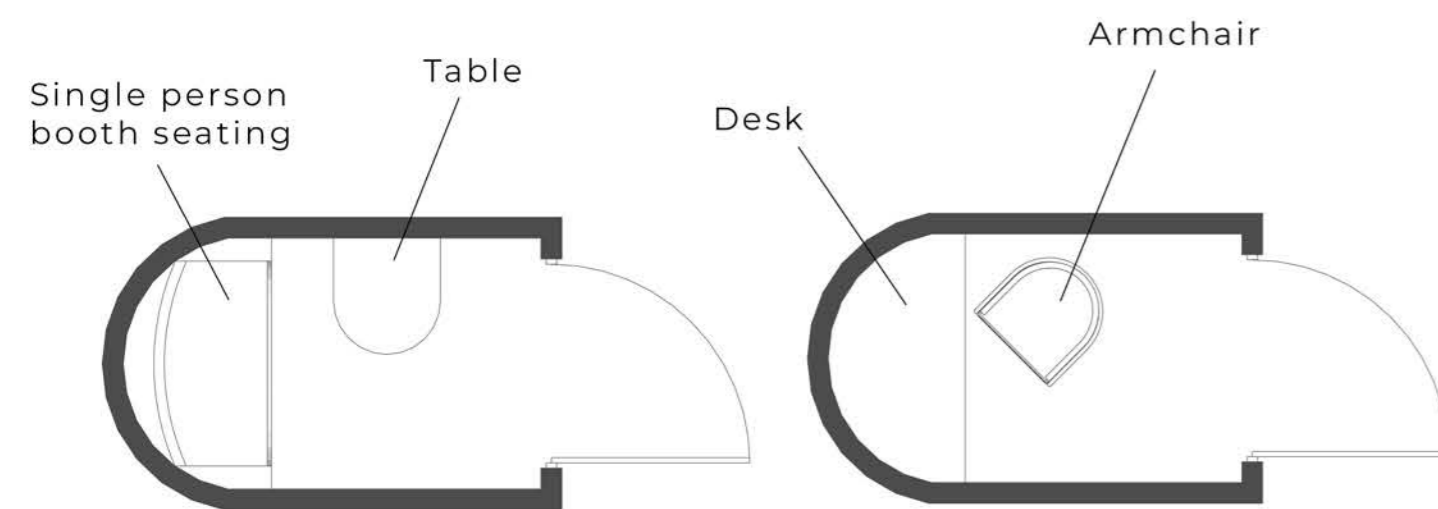

Study pod 1

Study pod 2

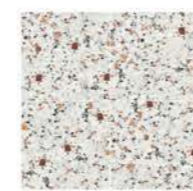

Terrazzo floor tiles



Velvet texture wallpaper



Orange textured wallpaper

Nursery Space



- PLAY** - areas within the interior which support imaginative play
- CREATIVE LEARNING** - painting, drawing and sensory areas where open-ended materials are used to aid learning
- REST** - calming areas for napping and sleeping
- EAT** - a dedicated social space designed for eating

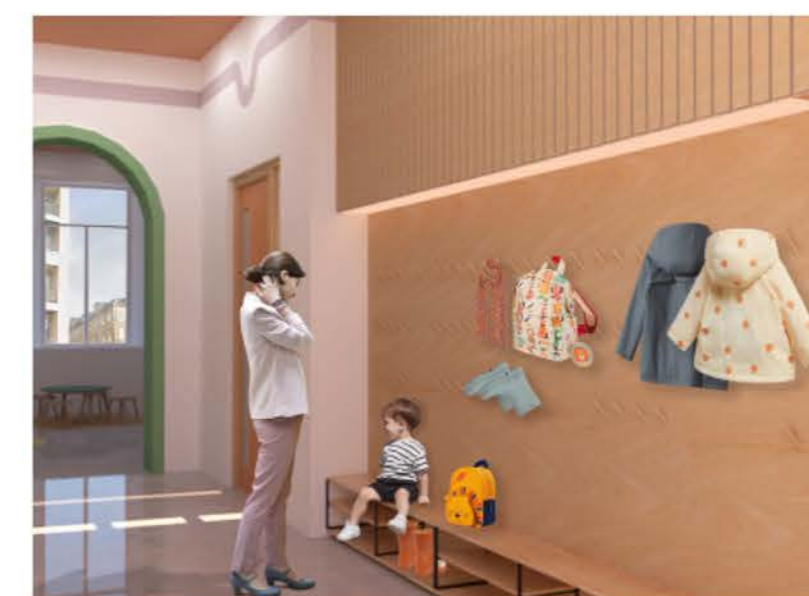

View of clockroom



View of buggy storage



View of creative learning space

Ground floor plan

Key -

- 1 - Entrance
- 2 - Reception
- 3 - Staff office
- 4 - Toilets
- 5 - Sand pit
- 6 - Climbing area
- 7 - Elevator
- 8 - Stairwell
- 9 - Cloak room
- 10 - Buggy Storage

First floor plan

Key -

- 1 - Hallway
- 2 - Storage
- 3 - Toilets
- 4 - Art and craft room
- 5 - Reading room
- 6 - Story time corner
- 7 - Lunch area
- 8 - Kitchen hatch
- 9 - Kitchen
- 10 - Utility

Second floor plan

Key -

- 1 - Hallway
- 2 - Baby changing room
- 3 - Toilet
- 4 - Storage
- 5 - Classroom
- 6 - Sleeping room
- 7 - Sensory room
- 8 - Soft play area
- 9 - Staff room
- 10 - Utility

