

# MAKER'S PLAYGROUND

Haeun Kim • the Glasgow School of Art

1:50 LIBRARY MODEL



1:50 LIBRARY MODEL VIDEO



<https://vimeo.com/953078424>

GLUE FACTORY TANK ROOM VIDEO



<https://vimeo.com/953079383>

## ON-SITE MATERIAL COLLECTION



- ⋯ Timber from the roof
- ⋯ Timber pieces from the joist
- ⋯ Timber from the flooring

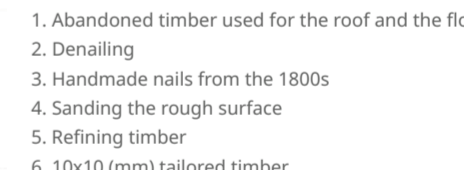
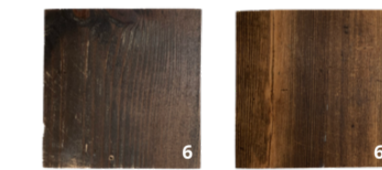

1. Abandoned timber used for the roof and the floor
2. Denailing
3. Handmade nails from the 1800s
4. Sanding the rough surface
5. Refining timber
6. 10x10 (mm) tailored timber

### MAKERS

■ Entrance for makers

- a Cloakroom / Bike storage
- b Assembly area
- c Material re-use station
- d Photo studio
- e Toilet
- f Wood workshop
- g Metal workshop
- h Security door
- i Material library
- j Seating working area
- k Book binding workshop
- l Printing station
- m Flexible working area
- n Cafeteria
- o Kitchen
- p Small tea station

### VISITORS

■ Entrance for visitors

- a Reception
- b Bookshop
- c Library
- d Reading area
- e Screening room
- f MM. Small cafe
- g Toilet
- h Exhibition room

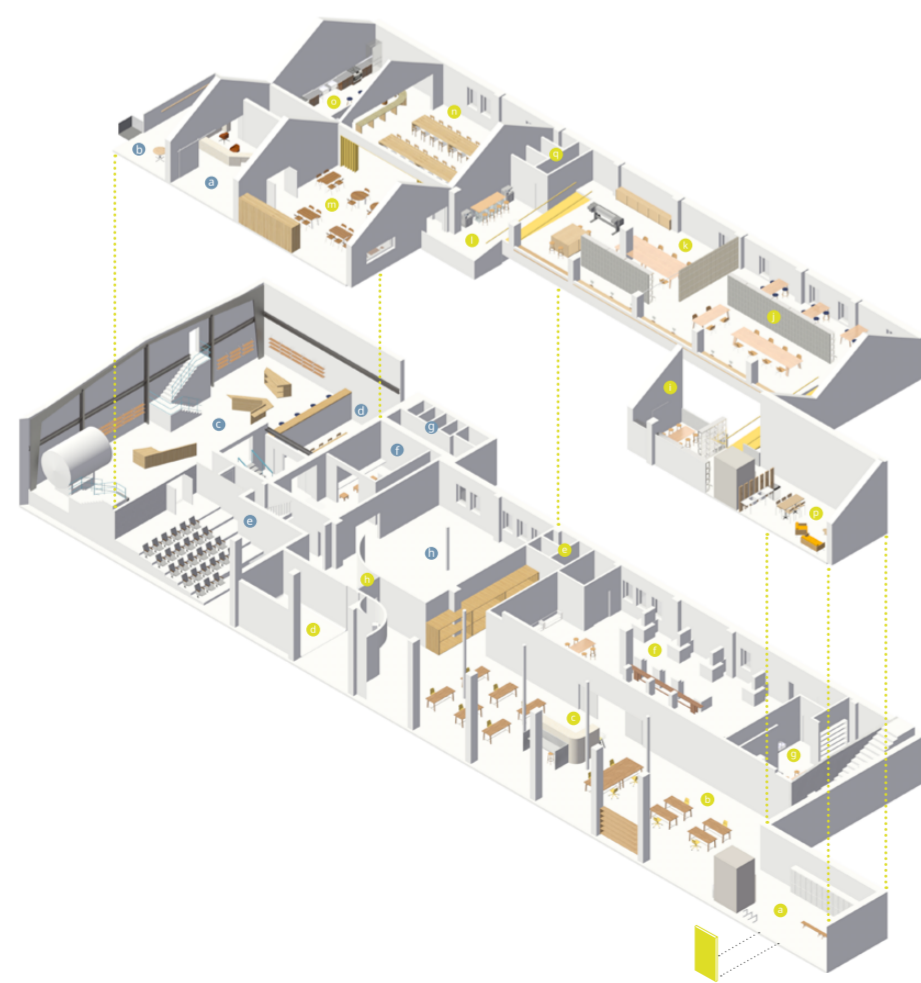



**MAKER'S PLAYGROUND** will serve as a **design-centred knowledge incubator**, facilitating the exploration, experimentation, and expression of personal creativity. The user group, referred to as **"makers"**, will converge in this space. The aim is to bring together individuals with similar interests in a shared environment that inspires **collaboration through teaching and learning**. This venue could serve as an entry point for recent graduates taking their initial steps into becoming pre-designers, while also providing an opportunity for more established designers to take "time out" for a mid-career break or transition. Additionally, the space is envisioned to be accessible to the public, providing easy access to the realm of design, thereby contributing to a greater sense of community. **The space is designed to inspire participation in 'exploring', 'doing', and 'making'**, offering diverse facilities and workshops spanning culture, design, art and various other activities.

**"MAKER'S PLAYGROUND is a collaborative haven for makers of all stages to explore, experiment, and express creativity, fostering a vibrant design community."**

**SITE** **Glue Factory**  
22 Farnell St, Glasgow G4 9SE



The Glue Factory, originally built in 1981 for the British & Foreign Aerated Water Co. Ltd., later housed the Scottish Adhesives Co. Ltd. (hence 'Glue Factory') and was repurposed in 2020 as an artistic venue.

Preserving the authentic character of the building's predecessor, the Glue Factory, was paramount. Elements such as exposed brick, wooden roofs, pipes, and tanks were retained, reflecting the structure's industrial heritage and enriching its narrative with depth. Internally, the ground floor includes a spacious layout encompassing a double-height tank room, warehouse, and former machine space. The first floor features a high-pitched ceiling and offers natural light from the roof's windows.

**ASSEMBLY AREA**



**LIBRARY**



This Assembly area is the essential space reflecting the identity of Maker's Playground, where makers can freely discover and develop their creativity. Located on the ground floor, next to both the wood and metal workshops, with a high ceiling. While retaining the original materials, the addition of acoustic panels has enhanced both its aesthetic appeal and functionality.

To address a major environmental concern for makers, a material re-use station was created to enable the reuse of discarded items. Makers can store unwanted materials of any size, type, or weight, creating a system where others can access and repurpose them.

**MATERIAL RE-USE STATION**

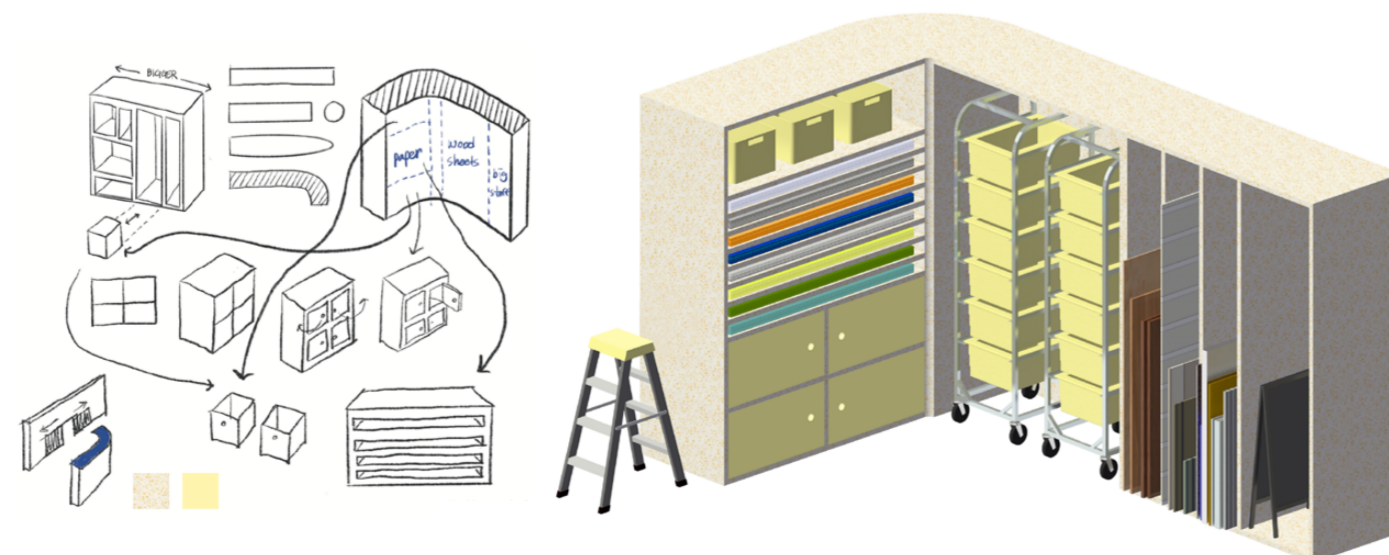

This space is dedicated to a collection of books focused on design and art. It offers a variety of reading materials covering different fields, with the option for visitors to buy from the bookshop located at the mezzanine.

The annual maker's market and design talk events will also be held here, allowing people to engage with products and hear from industry professionals. The proposed bespoke furniture can serve various functions as needed, offering flexibility to the space and moving beyond the typical image of a library.

**BESPOKE FURNITURE**

