

Caring Home

With a spatial approach centred around compassion, the 'Caring Home' enables elderly residents' autonomy, connecting them with the life-affirming energy of nature and reassurance of community.

Challenging institutional stereotypes, the Home as imagined supports the continuation of life and its shared activities. Allowing inhabitants to enrich relationships with loved ones and expand wider social opportunities.

Embedding connections between the interior, exterior and surrounding landscape of Glasgow's Pollok Park, the intimate village-like Complex encourages multi-sensory experiences. Navigating dualities of light, sound, smell, and temperature, provides a therapeutic context that supports well-being.

Sensitive interventions to the historic buildings embed accessible spaces, offering independence for residents to live in the environment as they choose.



Courtyard Extension looking towards the large Communal Kitchen and Dining Area, in Spring



Weir's cascade, March

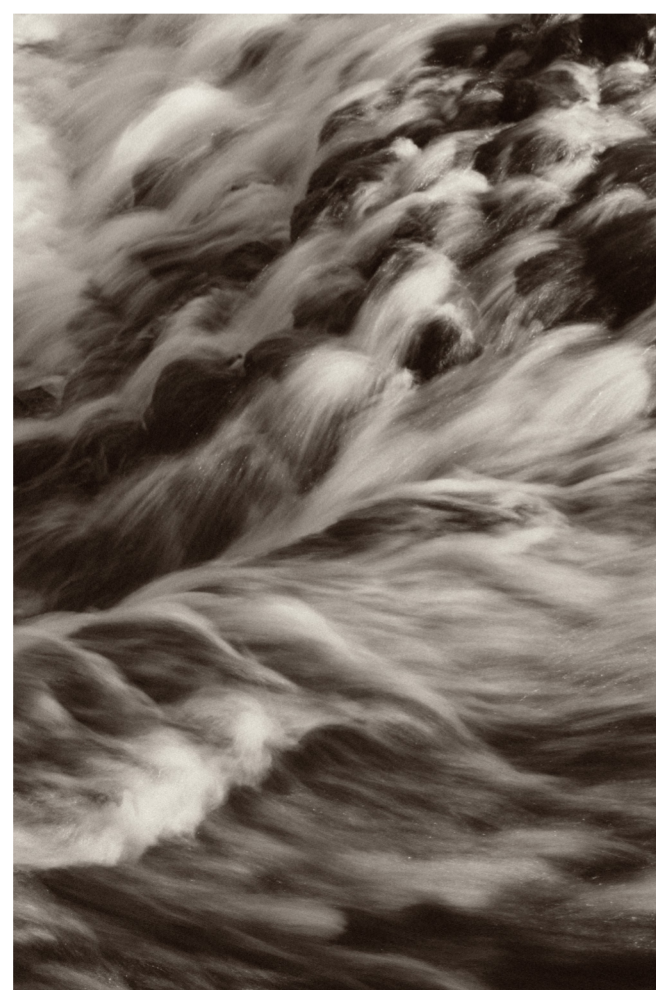

Site observation, October



Site observation, November

The Complex; Proposed Site Context Map

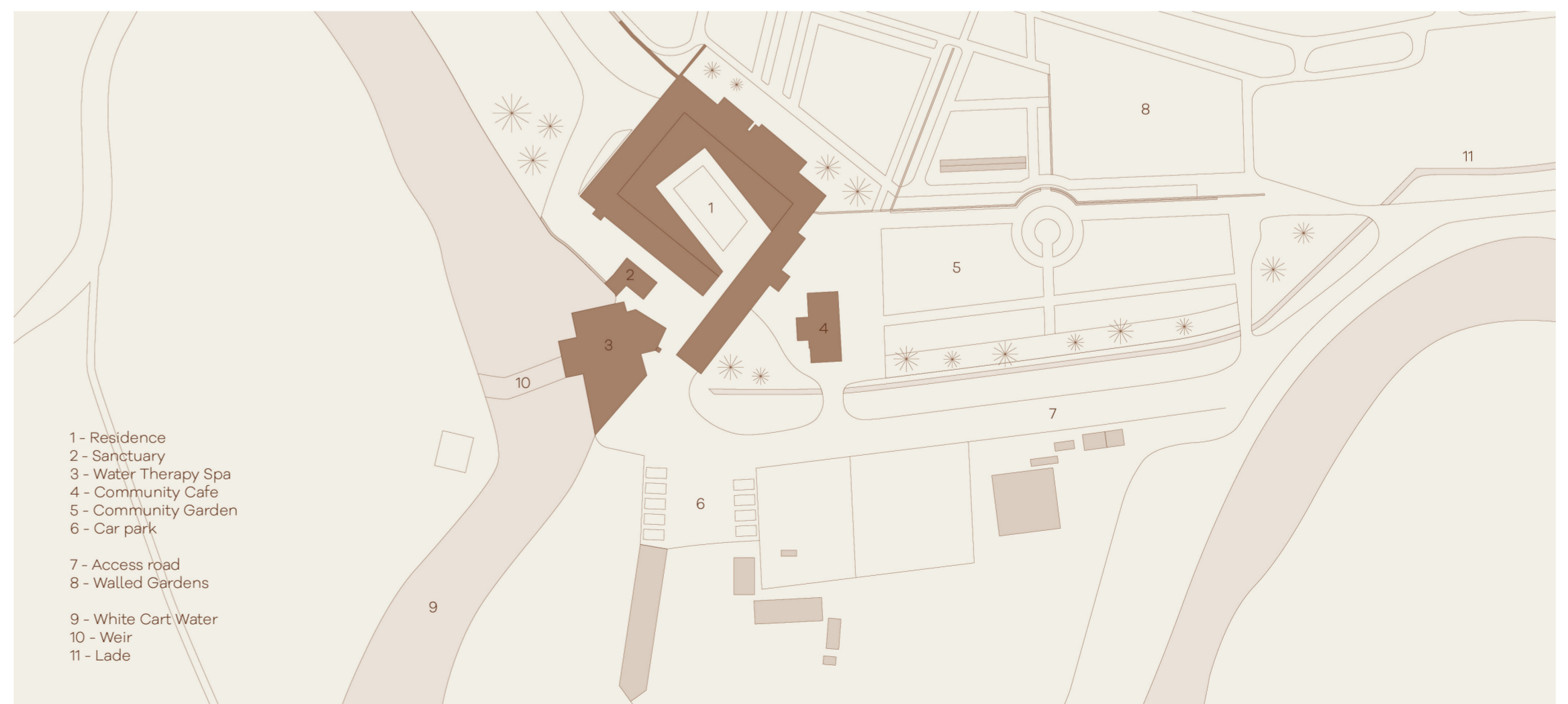

The Complex

Utilising the site and its context is a key facet of enhancing inhabitant well-being. Emphasising the therapeutic qualities of the historic buildings and natural surroundings aims to provide a reassuring and stimulating environment. The relationship between interior and exterior is fundamental to the Caring Home, therefore, the atmosphere of site forms a central contribution towards the inhabitant experience.

Valuing the autonomy of residents, the Complex supports individual desires for human connections and sensory stimulation through a range of well-being enhancing activities. All spaces are accessible, inclusive of health and mobility needs.

The domestic scale of the village-like cluster enables secure private accommodation and communal areas for residents and loved ones, while creating social opportunities by integrating with the multi-age public.



QR to 3D VR Model of the Complex

1:100 Scale Model of Threshold



The threshold to the Residence hallway reveals the historic structure, forming a semi-enclosed internal garden. Honesty in exposing the original construction states the symbolic acceptance of patina and a less fearful approach to aging.

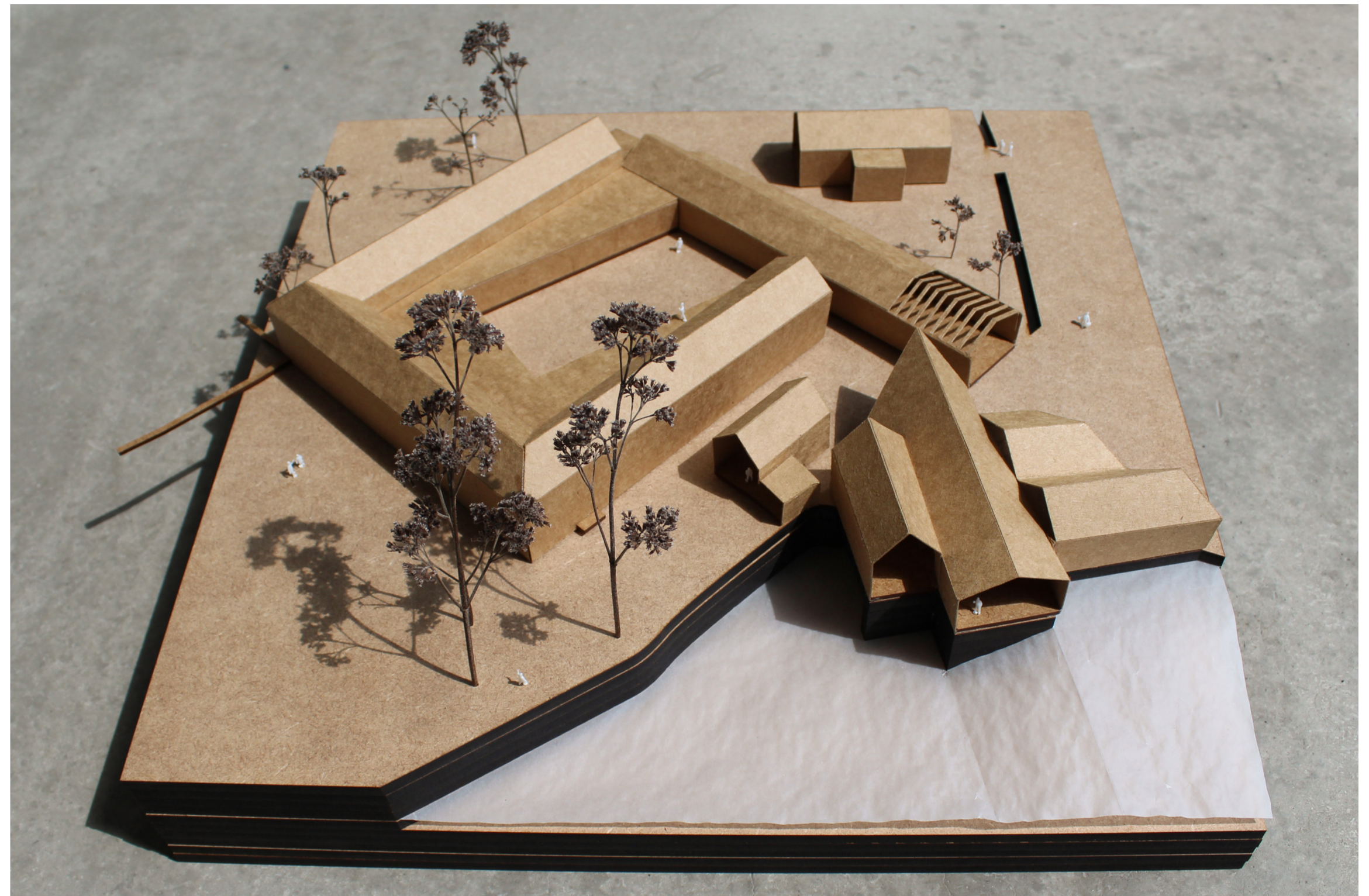

1:200 Site Context Model

Exploring Roof Structures



Residence

At the heart of the Complex, the Residence comprises varied living accommodation for 6-10 residents and 2 apartments for staying guests. The flats aim to provide a framework for evolving routines and activities, allowing flexibility for residents to play an active role in the creation of their home.

The extension bridges private and communal spaces, linking residents together and inviting interaction across the courtyard. Its offset form is orientated towards the South, angling inhabitants towards the sun and shade across vertical perspectives.



1: 50 Scale Model of Extension

Sliding doors adjust shelter and exposure to air and weather along the ground floor. A Glue Laminated Birch framework forms a cloistered pathway, graduating the transition between indoors and outdoors.



Section A - Cut Ground Floor

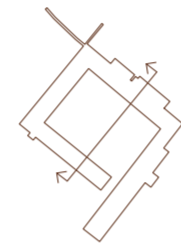

Section A - Cut First Floor

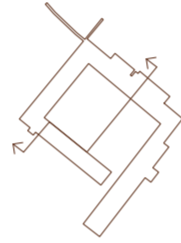

Section A Visual Public and Private Residential Areas, in Spring

Section B

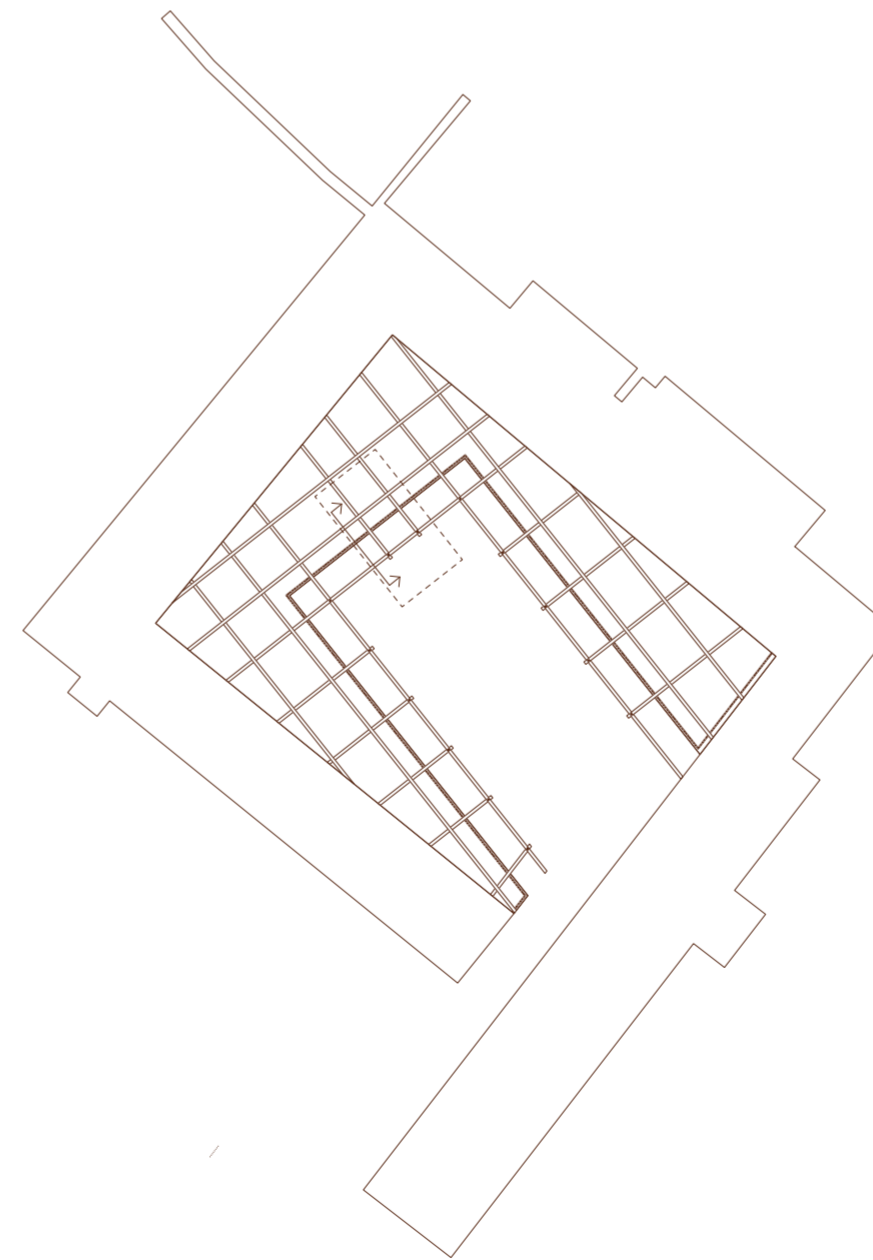

Residence; Plan of Extension
1: 500 A3



Residence; Detail A showing Column
1: 25 A3

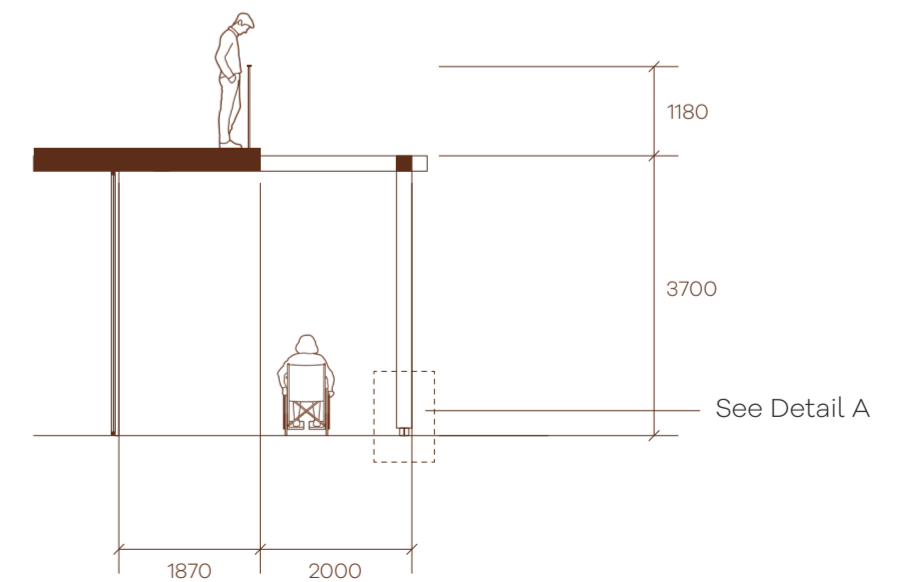
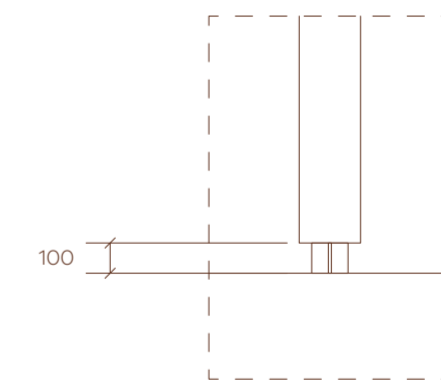

Residence; Section B showing Over-hang
1: 100 A3

Sanctuary

The former Chapel provides a quiet Sanctuary within the Complex, where inhabitants can shelter and relax.

A place to sit and read a book, while watching the White Cart Water as it flows past. Offering space for conversation over a cup of tea, perhaps between loved ones and carers. Here, those experiencing loss or anxiety can come to feel a sense of calm and reassurance.

While access remains private, the Sanctuary may be used by the loved ones of former residents, to maintain relationships with those who knew or looked after their resident. Enabling the reassuring continuation of community support, and providing a familiar place to remember.

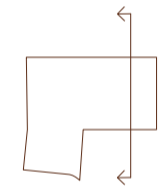

Section C



Section C of the Reading Area looking West, in Summer

Water Therapy Spa

The Water Therapy Spa offers a regenerative retreat for inhabitants, where the therapeutic properties of water are heightened through immersion in the surrounding landscape.

At the meeting point of the White Cart, its weir and lade, spatial connections to the fluctuations and energy of the waterways enhance the atmospheric experiences of swimming and relaxing.

Soaking in the heat of the pool contributes towards healing, relaxing muscles and relieving joint pain. Weekly hydrotherapy classes encourage routine exercise, and the building of strength and confidence. In such classes, inhabitants may mix with the public to partake in low-impact activities, beneficial for the elderly and those with dementia.

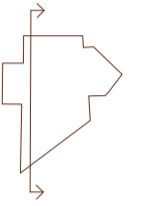

Section D



Section D of the Pool area and Steam Room, showing interaction with the River, in Autumn

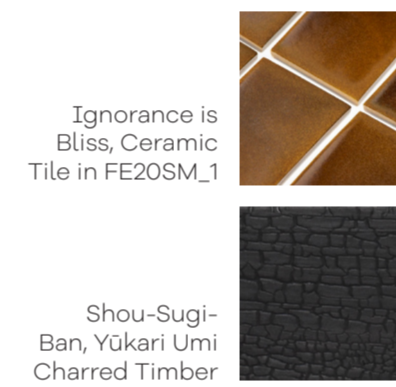

1:200 Site Context Model showing Sanctuary and Water Therapy Spa



The Pool's deepest area, looking out towards the River, in Autumn

Community Cafe

The Community Cafe serves as a neutral interaction space between inhabitants and the public, where people can eat together and participate in the sensory aspects of cooking.

Focused on widening inhabitants social opportunities through activity, people are invited to take time to connect over a sit-in lunch.

Encouraging multi-age involvement in cooking, the central kitchen accommodates public/private events and workshops. Blending front and back of house aims to create an open atmosphere, enabling the sharing of skills and knowledge around cooking and ingredients.

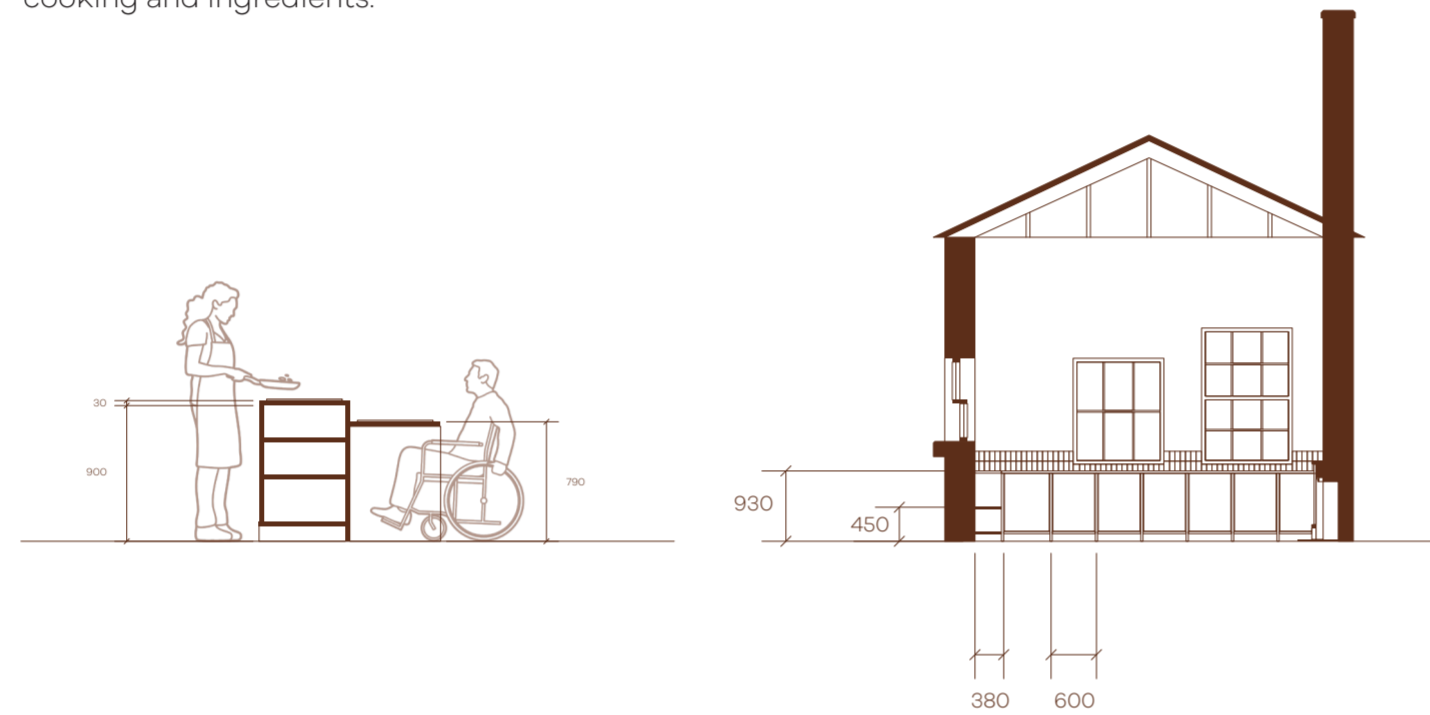
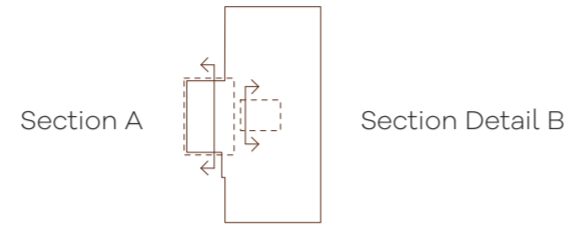

Community Cafe; Section Detail B showing Central Kitchen 1: 50 A3

Community Cafe; Section A showing Central Kitchen 1: 100 A3

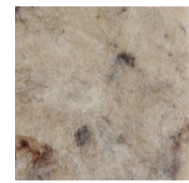

Solidwool, Welsh Mountain Biocomposite



Nunoko, Kepure Pendant Lamp



Resident, Carousel custom Armchairs in Kvadrat, Vidar 4 0146

Community Garden

The Community Garden forms an outdoor gathering point, where inhabitants can socialise, garden and exercise, while enjoying the south-facing sun.

Connecting elderly residents to the outside world in an immediate and accessible way, bringing them together with a range of multi-generational people within renewing fresh air and natural surroundings.

Enveloped within a variety of green-spaces, the Community Garden enables safe access to the outdoors within the Complex, as overseen by staff. Answering the need for inclusive access to gardening activities, this space invites inhabitant and public involvement regardless of mobility issues.

Designed to be accessible for all, the custom raised bed sits 670mm above the ground, enabling those in wheelchairs to be involved in activities.

Arranged to encourage the social aspect of gardening, people can face towards each other, creating opportunities for conversation and workshops.

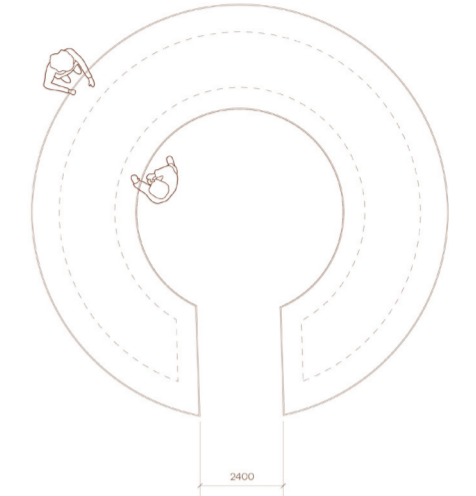

Community Garden; Plan showing Raised Bed 1: 100 A3



Community Garden; Side Elevation showing Raised Bed 1: 100 A3

Raised Bed Construction Detailing



Stone Cycling, WasteBasedBricks in Almond Punched



Dining and Lounge Areas surrounding the Central Kitchen, in Winter



Looking towards the Raised Bed and Community Cafe, in Spring