

# THE EXHIBITION AND BUILD

INTERIOR DESIGN LEVEL 5  
 INTERIOR DESIGN LEVEL 5  
 INTERIOR DESIGN LEVEL 5  
 INTERIOR DESIGN LEVEL 5

18/24 -25/25

Monday- Thursday

Brabham  
 STORY

By Vienna, Jaimie, Milly



In collaboration with  
 Community Brain  
 platform gallery



We used the CNC machine was used to cut our CAD joints from the plywood. We worked together to sand each piece by hand. Then using wood glue, we carefully joined the pieces for added structural integrity, we clamped the pieces to hold them together while the glue dried.

Below is a link to a video, showcasing our journey constructing the final model. The intagram account below explores the process of the project.

<https://www.instagram.com/reel/C4h26MqoXpo/>



thebrabhamstory

26 posts 44 followers 27 following

(Bræbem)  
 // Need For Speed  
 // Brabham BT46B "Fan Car"  
 // BA Interior Design group - 02

After assembly, we moved on to the finishing stage we spray painted the continuous lines for emphasises. We chose a color palette that aligned with our exhibition's theme, enhancing the visual appeal and coherence of the model. Finally, we applied varnish to protect the painted surfaces and add a polished finish.



# OUR STORY

## THE BRABHAM STORY

Our group exhibition is themed around speed, specifically drawing inspiration from the Brabham Formula One team and their iconic fan car. The Brabham fan car, known for its innovative engineering and unique design

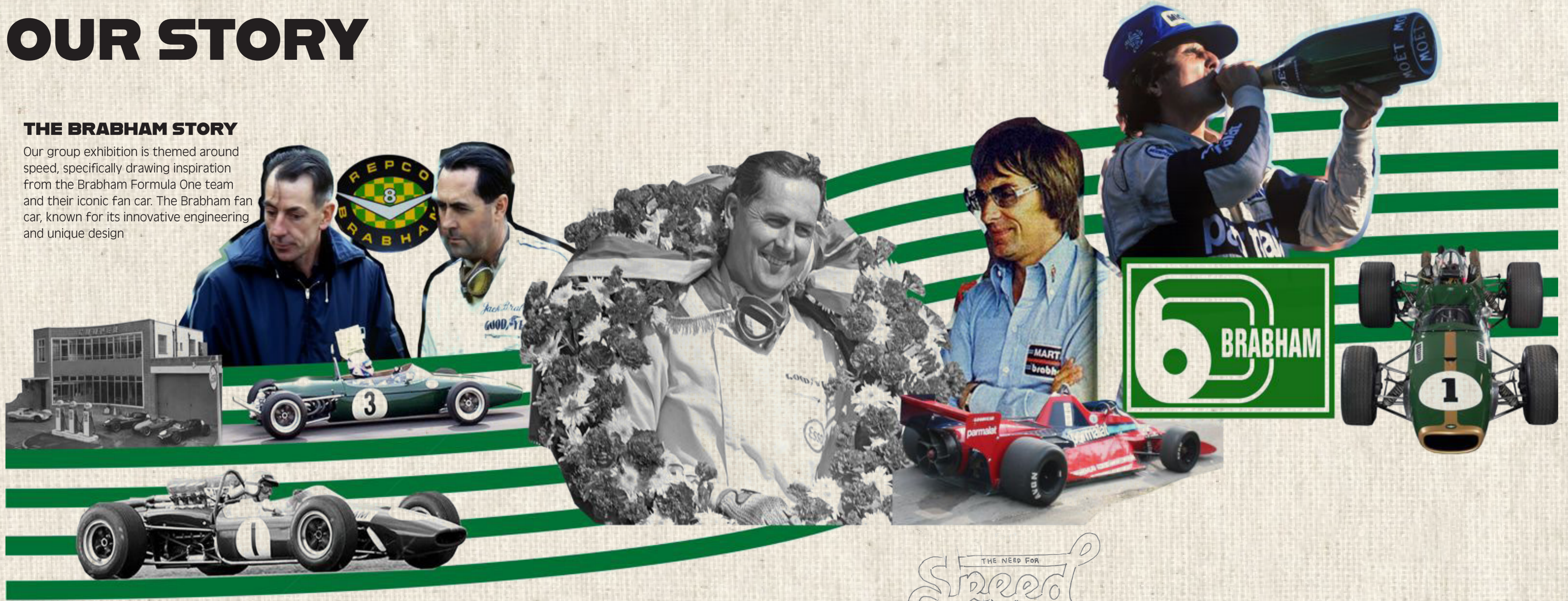

The Brabham Formula 1 team led by the three-time Formula 1 World Champion Sir Jack Brabham himself, the team achieved notable success pushing the boundaries of engineering in pursuit of speed and performance.



However, like many teams in motorsport, Brabham also faced its fair share of challenges. Changes in ownership and financial difficulties plagued the team in the latter years, leading to its eventual withdrawal from Formula 1 in 1992.

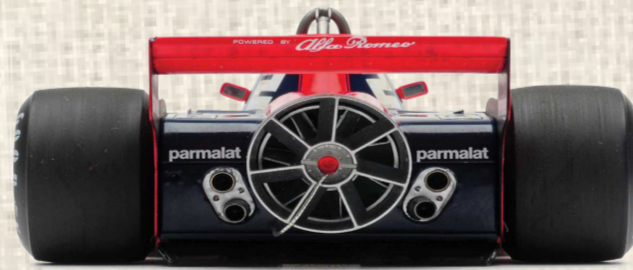

The Brabham BT46 "Fan Car" was a revolutionary. It featured a unique cooling fan mounted at the rear of the car, which served a dual purpose: to improve aerodynamic downforce and to enhance engine cooling.



## TICKET STUB INSPIRED BY THE POP CULTURE AT THE TIME THE TEAM STARTED UP



The design of our exhibition ticket draws inspiration from the pop culture prevalent during the era when the Brabham Formula One team first started. The retro ticket stub adds an element of authenticity to the exhibition. It reinforces the historical theme and sets the tone for the experience right from the point of entry. The design elements typical of that time, such as bold typography, distinctive color schemes, and vintage graphics, create a cohesive visual narrative that aligns with the overall theme of speed and innovation during the Brabham era.





# CONCEPT

Our concept originates from the theme of perspective and emphasising viewers ergonomics.

To capture the theme of speed, we chose to construct the exhibition space around two parallel arcs. When these curves are joined viewed from the front, they form a complete circle, representing the continuous nature of speed and motion.

Speed is often associated with continuous lines and shapes getting smaller at one end due to perspective. The shape of the curve gradually gets smaller, imitating and exaggerating the perspective. The height of the concave allows viewers to change views and directs them towards the star of the exhibition, the Brabham car.

This structural design provides a fluid and fascinating path for visitors, The curvature and flow of the exhibition are crafted to guide visitors naturally, ensuring a comfortable and immersive experience. The design encourages movement and interaction, aligning with the kinetic energy inherent in the concept of speed.

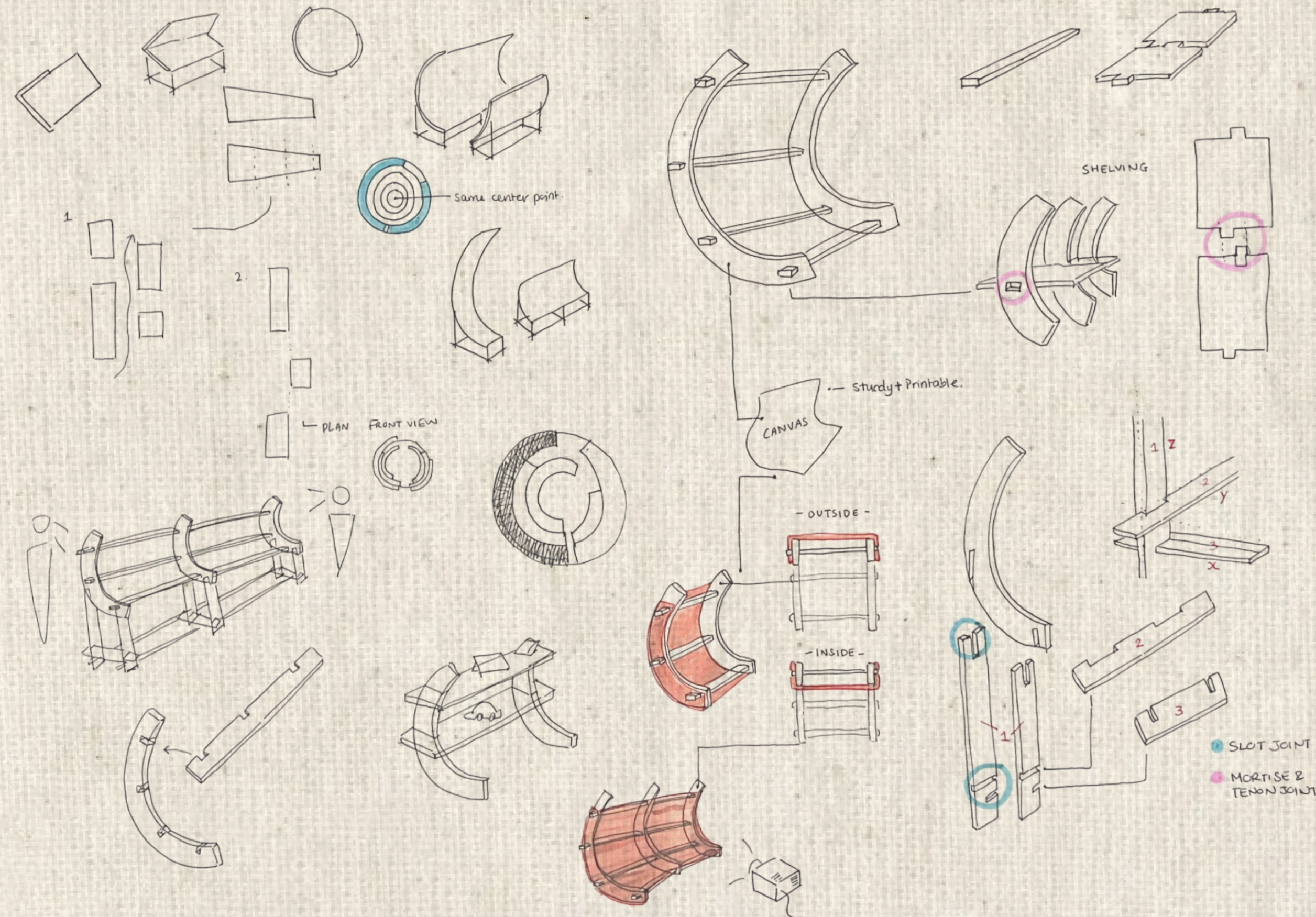

# Precedents



Obra Archietcts, Beatfuse



Tatsuo Mijajima, Tadao Ando



Bernard Koury Vitrus in Quarantine



Kengo Kuma Botanical Pavilion as a "tridimensional puzzle"

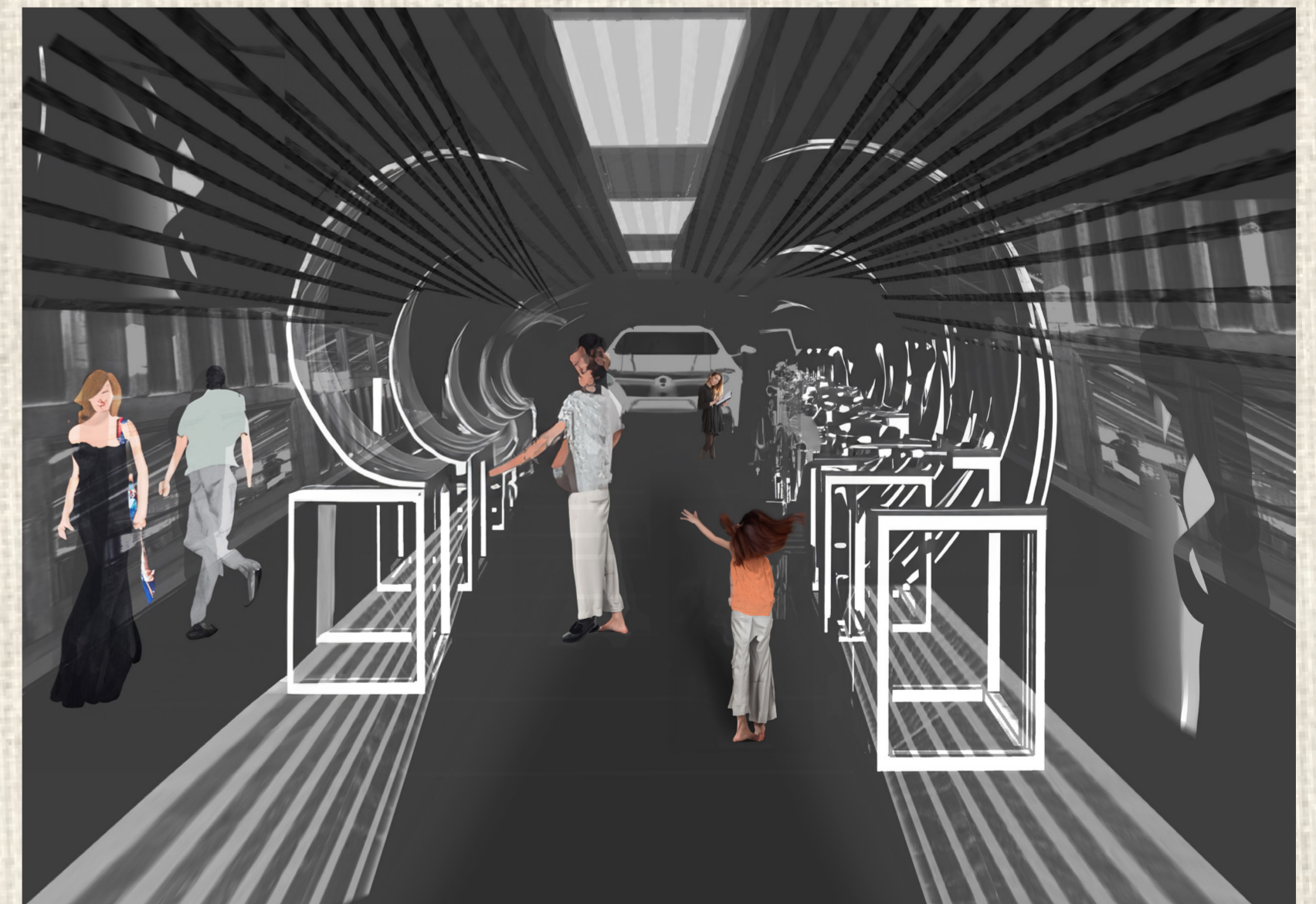



# PROCESS

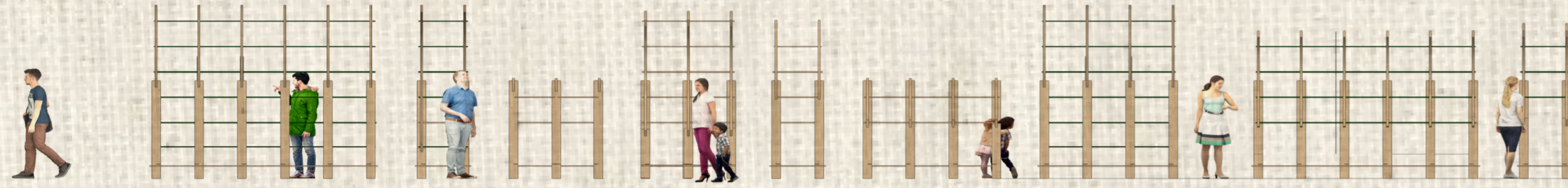

**Front View**

## Visual

Showing the left side of the exhibition, where the list of figures, artefacts, and projection is displayed.



## Ikea style Flat Packable joints and construction

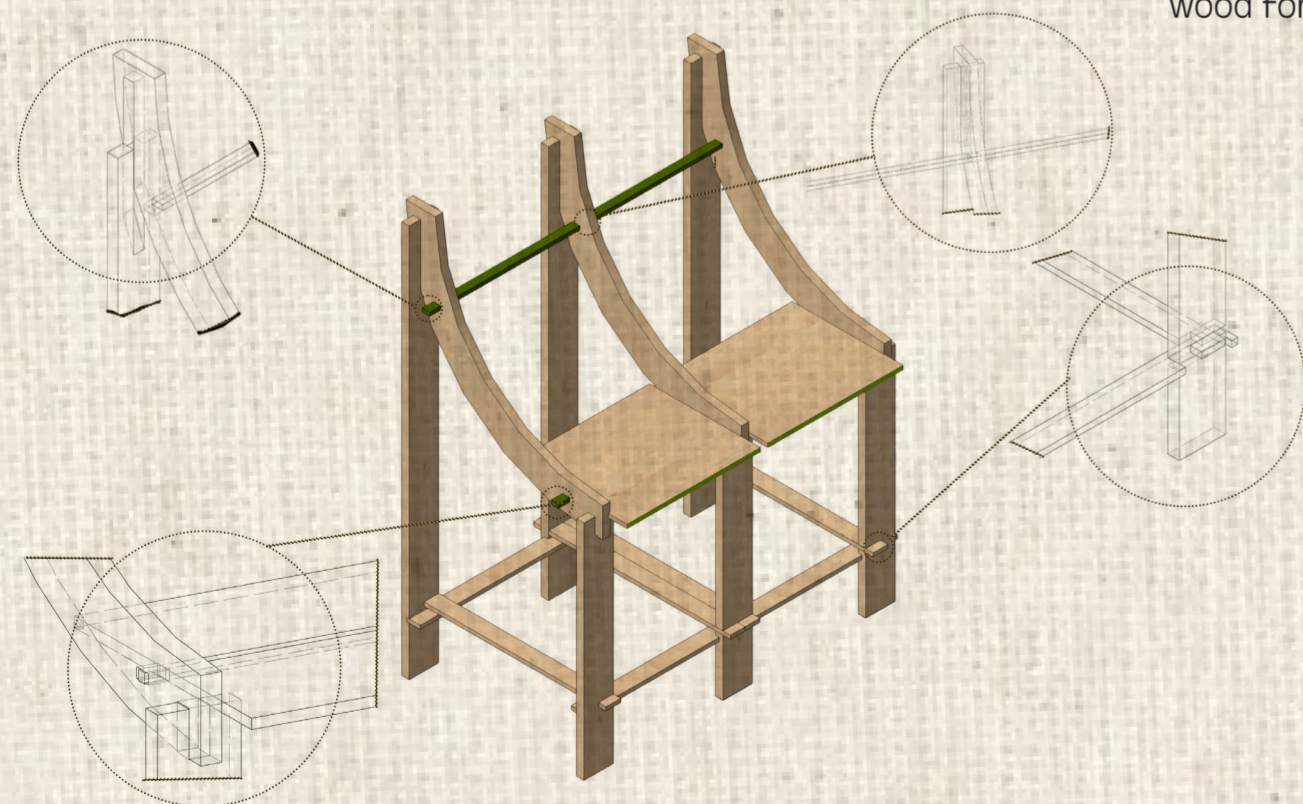

## Test Joints and Materiality

Our simple material palette incorporates the prominent green lines inspired by the Brabham Logo. The pop of the brabham green helps extenuate the effect of the lines for perspective and compliments the ply wood for an overall cohesve look.



## 1:5 Laser Cut Model

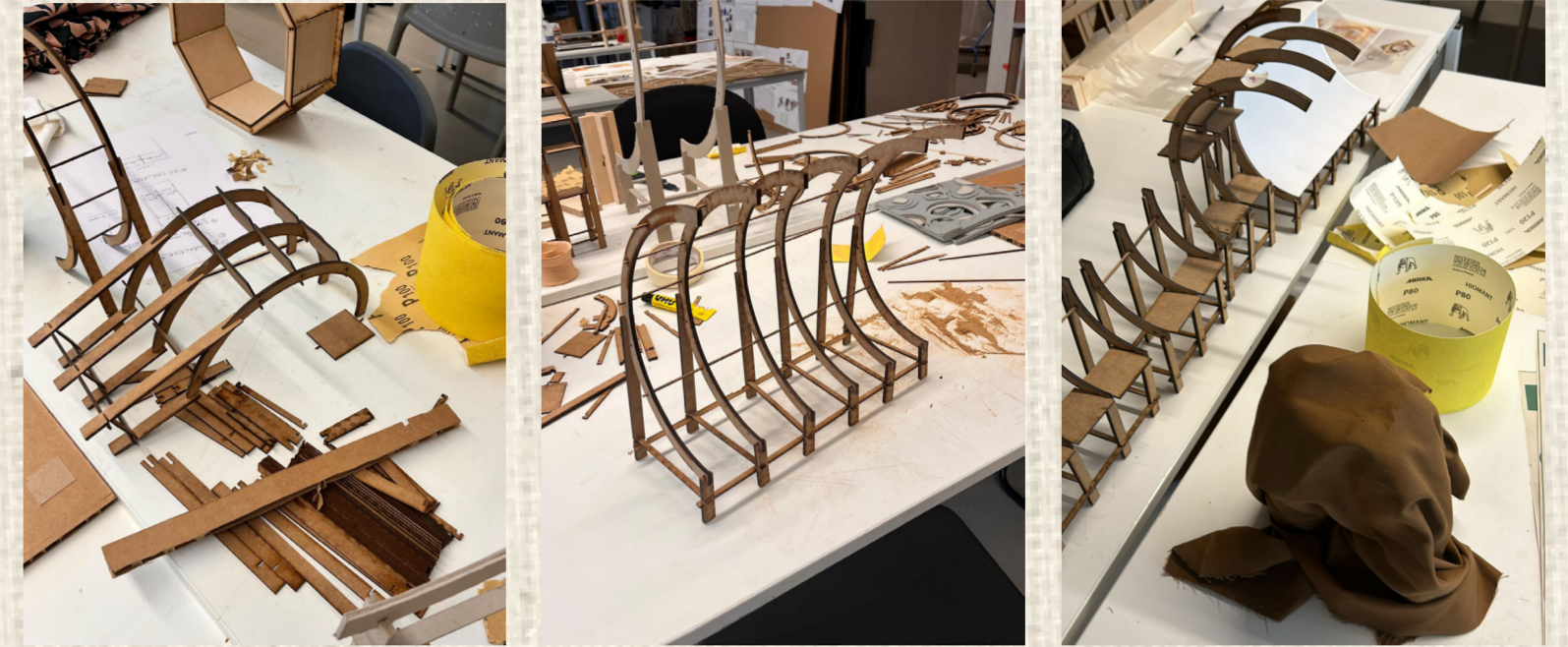

With the 1:5 model we started experimenting with colour and what we are exhibiting and where this is how we came up with the decision to paint the parallel viewing lines green





# 1:1 MODEL

This was the final 1:1 CNC model; the birch ply we used was 15mm thick, so we doubled up on each leg and curve for extra support, which, along with the tight slot joints, resulted in a very solid structure.

The exhibition's curves represent the engine's round parts and the relationship between sound, loudness, and speed. The exhibition is designed to enhance the viewing experience by allowing visitors to move around the exhibits.

To increase the sense of perspective, the curves are locked around the same central point. The horizontal green lines emphasise the viewpoint. To distinguish amongst stands, their length and overhang vary in different ways. Some include shelves for antiquities, while others are flat for text displays or projections.

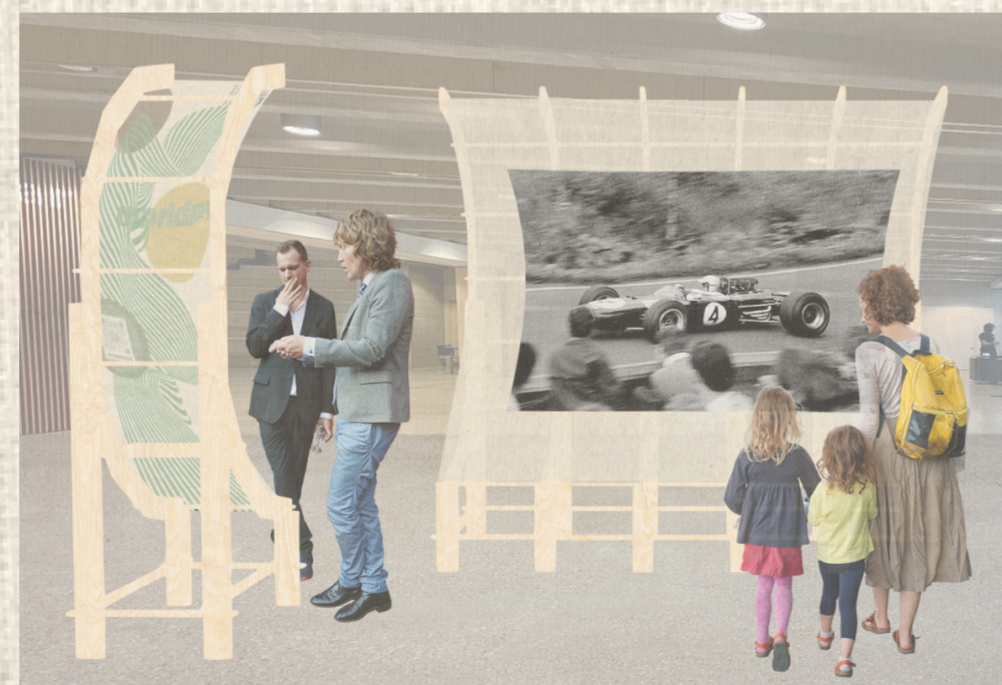
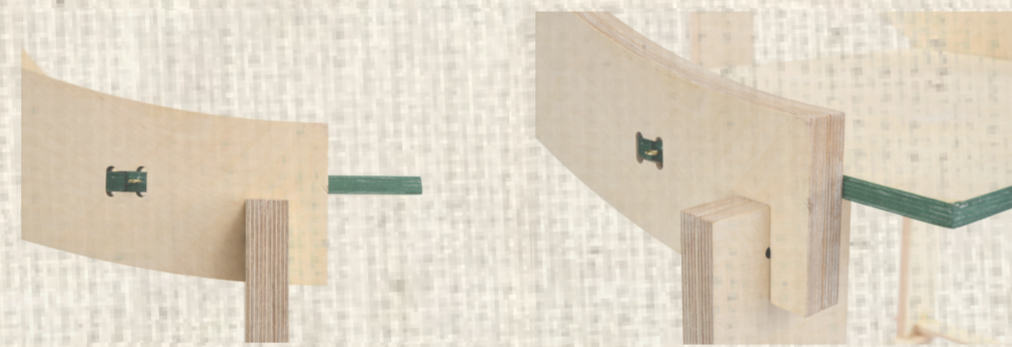
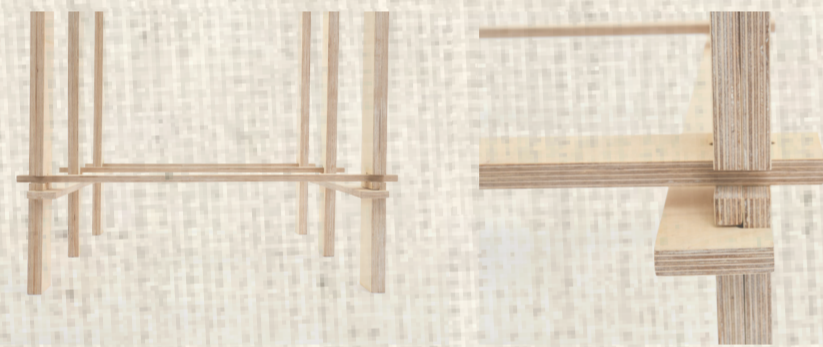
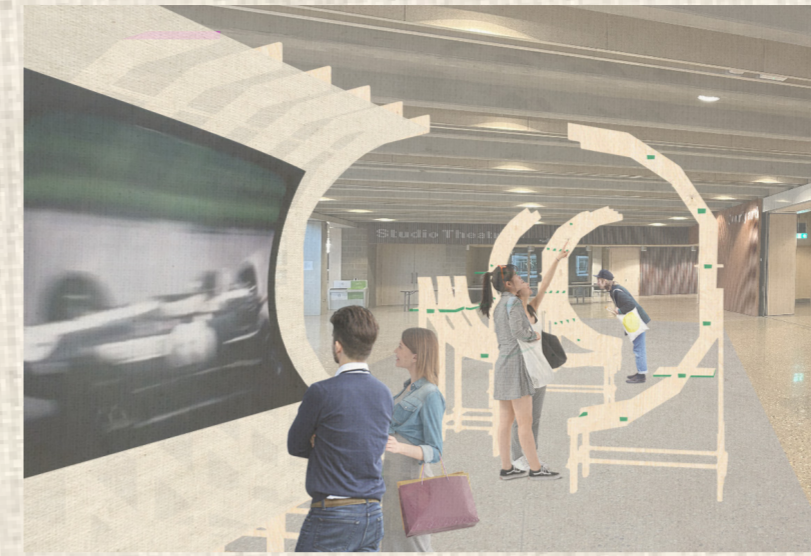
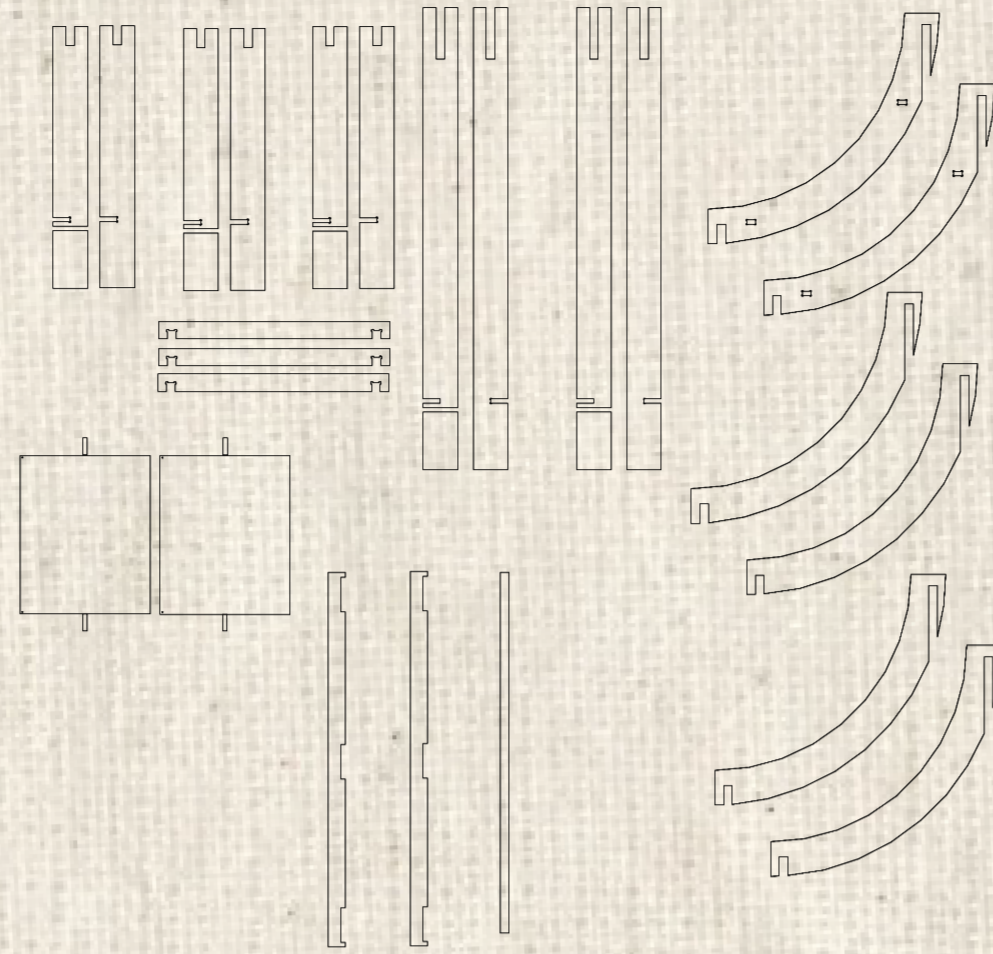

Plan in site

