

MAKING THE INVISIBLE VISIBLE: REFUGEE CENTRE IN HOLBECK ALAA ALKURDI

Refugees are people who have crossed an international border in search of protection, often fleeing violence, conflict or other persecution. An internally displaced person is fleeing similar things, but has not crossed an international border. Globally, human displacement is now at the highest level ever. The UN and others need to deploy a new generation of housing, especially in light of the numerous looming catastrophes. The climate crisis is predicted to uproot 1.2 billion people by 2050. There are rumblings of another World War in Russia's attempted invasion of Ukraine, and in the placement of nuclear weapons and NATO bases.

It is especially difficult for refugees to find employment. Some left their homes before finishing their studies, others have qualifications from their home countries that are not recognised in the countries where they have sought refuge, some simply have not been able to bring their documentation with them. Without qualifications, refugees' options are severely limited.

This project therefore runs across two programs, one visible, the other invisible. The visible program provides a methodology for assessing and certifying refugees' qualifications, facilitating further studies, employment and integration. This program runs on the ground floor, and will be visible to everyone.

The invisible program will be used during the next World War, to accommodate and protect refugees. Refugees in the basement will be invisible from the outside world and from the people in the visible program, providing a space for sub-terranean experimentation.

USERS:



STUDENT/ ADULT



INTERVIEWERS



REFUGEES

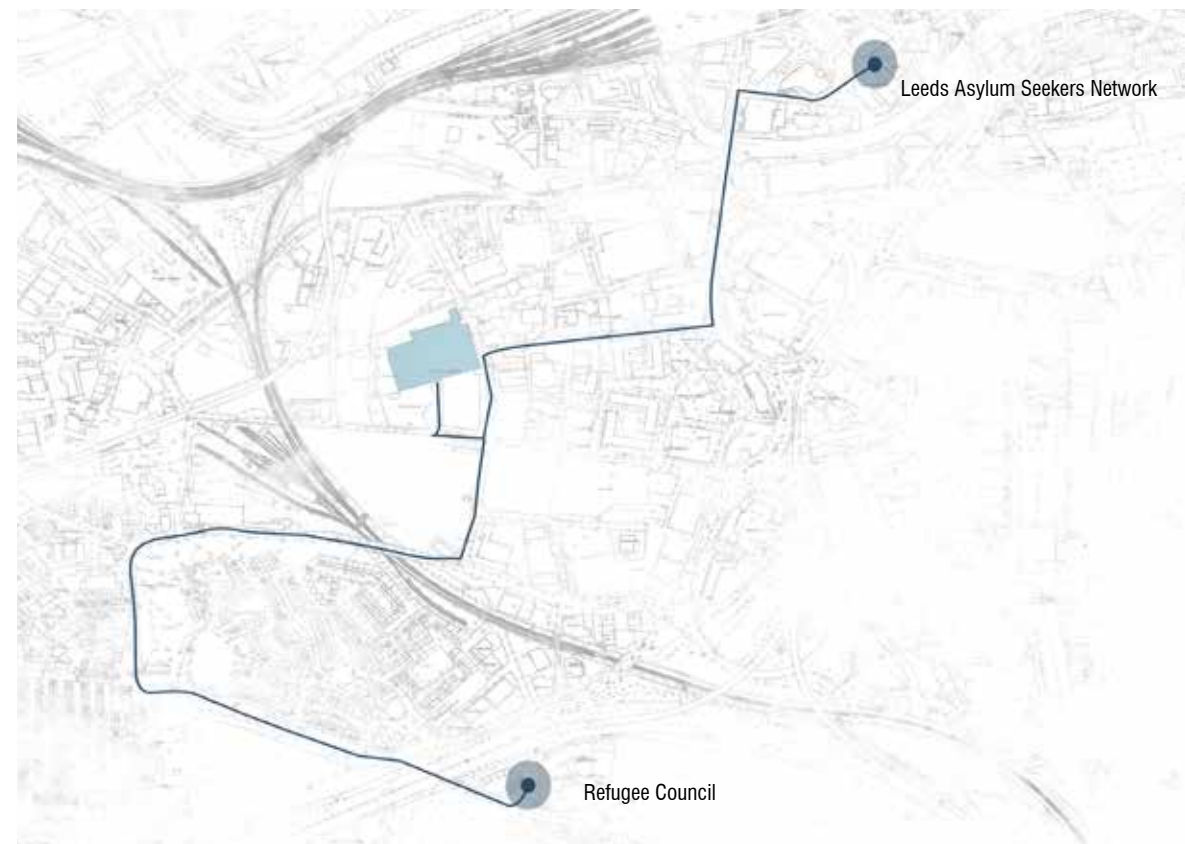

REFUGEES ORGANISATIONS IN HOLBECK, LEEDS.

THE SYRIAN REFUGEES

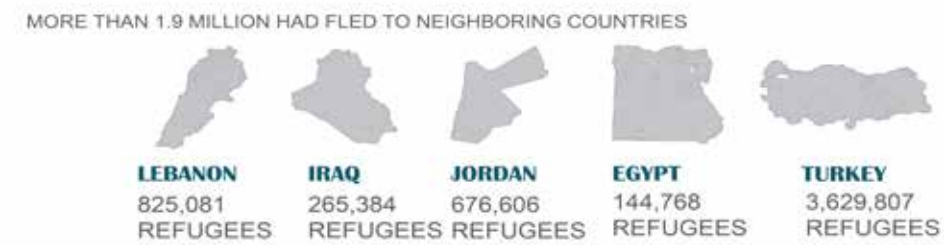
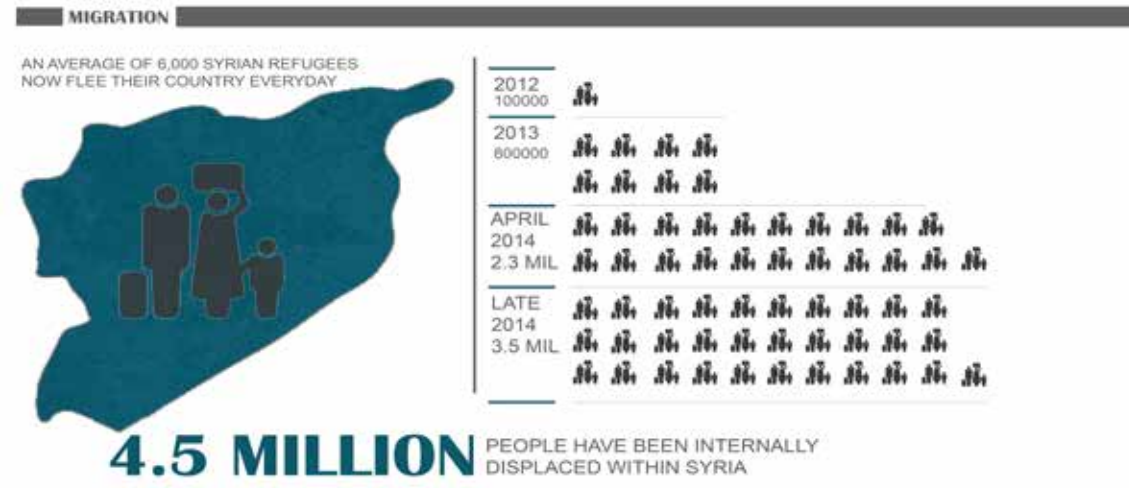

MOST LEFT THEIR HOME ON SHORT NOTICE AFTER FACING SHOOTING, BOMBINGS, AND ARTILLERY FIRE. OFTEN THEY ARRIVE IN THE COUNTRY OF REFUGE WITH LITTLE MORE THAN THE CLOTHES THEY ARE WEARING. SOME HAVE NOT HAD THE CHANCE TO GRAB THEIR IDENTITY PAPERS.

SYRIAN REFUGEES ARE ONE OF THE TOP TEN NATIONALITIES IN THE UK SINCE 2014

6.7 MILLION
SYRIAN REFUGEES WORLDWIDE

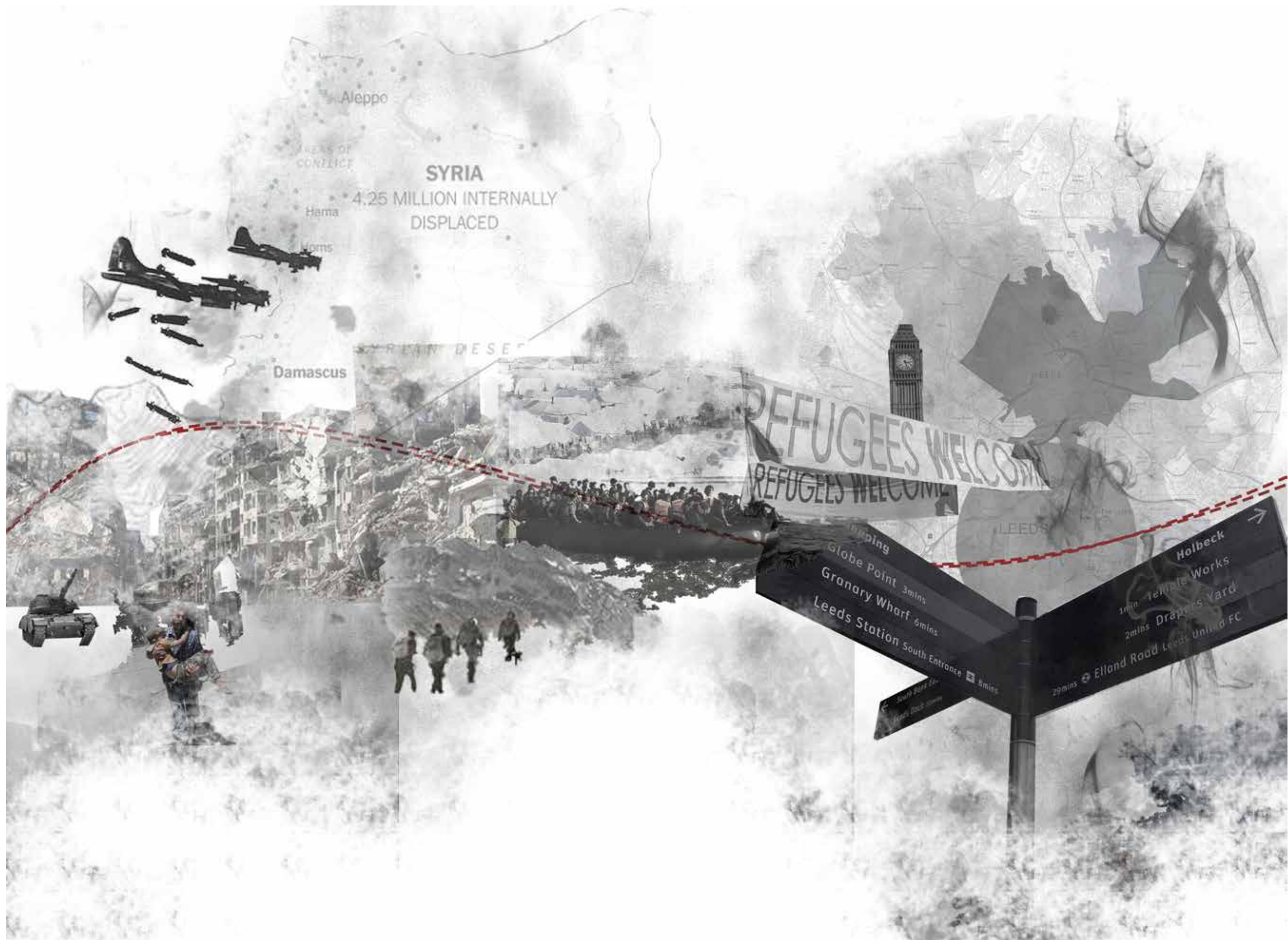
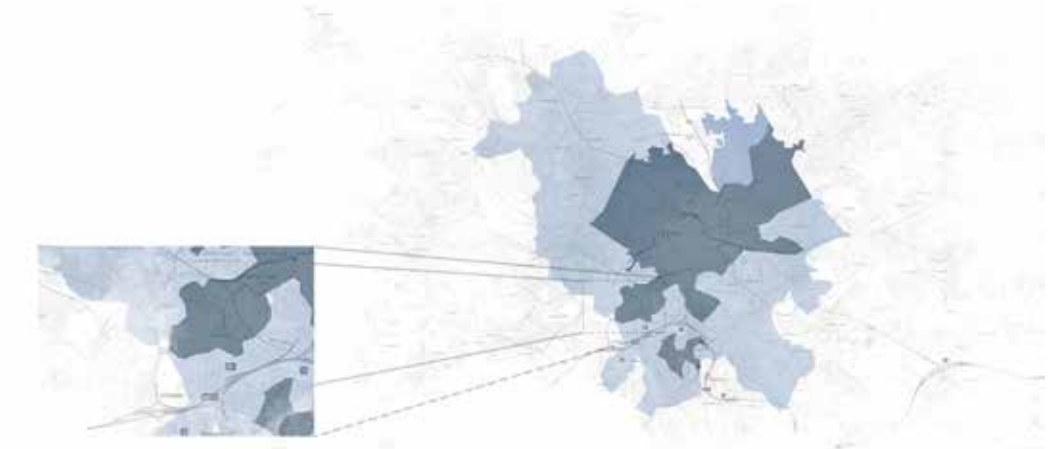

CONCEPT AND DEVELOPMENT

The concept for this project investigates the idea of juxtaposition between light and dark, the concept is splitted into five phases and each phase represents a moment or a struggle in a refugee life. The concept of darkness represents the past of Syrian refugees and the experience they have been through during war time. Lightness represents hope, integration and a bright future for refugees.

The conceptualisation of juxtaposition is driven through both programs within the building, the invisible programme will represent the darkness part to accommodate refugees during third world war to protect them and to provide safety and peace for all refugees. The space will be very futuristic and will have an illusional atmosphere. The visible programme will represent the lightness part which will help all refugees who already live in the UK and wishing to pursue their academic and professional career within a European country and the UK, as well as helping refugees to integrate.

The diagram effectively presents the layout of the space on the ground floor, illustrating the proposed design and showcasing how each phase of the concept is transformed into the building. The diagrams highlight the progression of the concept within the space during phase two and three. These phases primarily serve as exhibition areas within the building, dedicated to showcasing various wartime events and providing educational resources for visitors to learn about different wars.

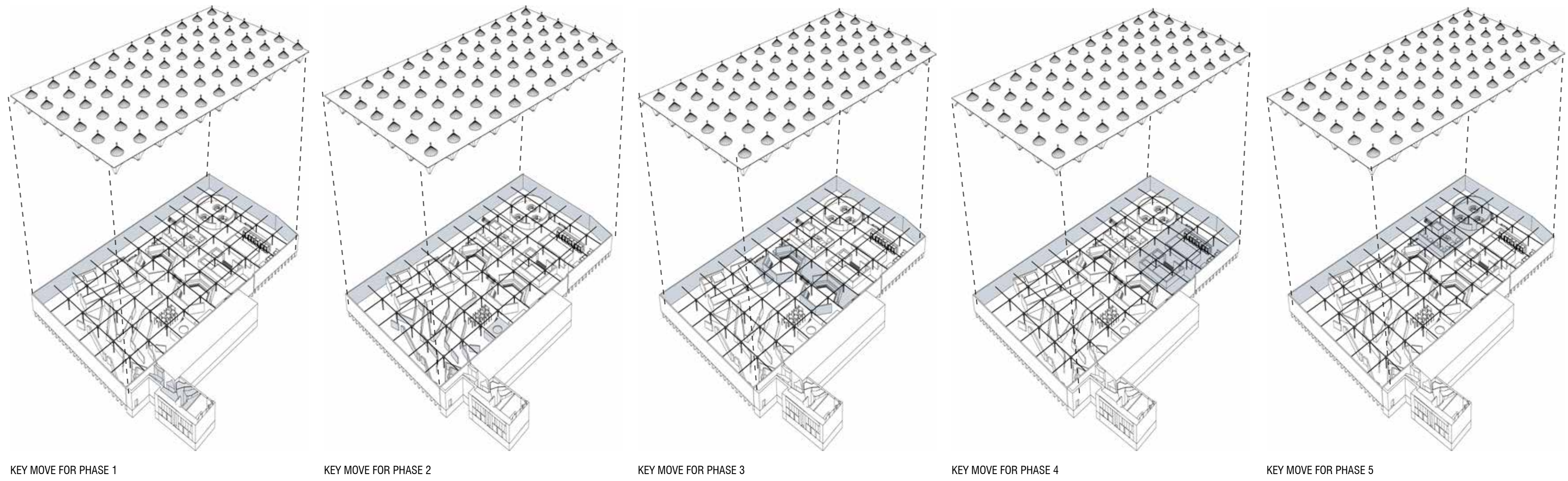

KEY MOVE FOR PHASE 1

KEY MOVE FOR PHASE 2

KEY MOVE FOR PHASE 3

KEY MOVE FOR PHASE 4

KEY MOVE FOR PHASE 5



Scars of the past concept represents the past of refugees and the scars that have been caused from the war.

The concept of being trapped and lost, trying to start your journey but unsure how to move forward to find hope and run from the scars of the past.

Walking through a long tunnel, looking for hope during the journey that can help you to move forward and find a better future.

Hope started to reveal slowly. Many options are open. More ways to integrate but still unsure how to make that step forward.

Making the final step of the journey. Following the route to reconnect and integrate. Found a bright and better future.

PHASE 1: SCARS OF THE PAST

PHASE 2: TRAPPED AND LOST

PHASE 3: GLIMPSE OF LIGHT

PHASE 4: HOPE

PHASE 5: RECONNECT

NEW INTERVENTION AND INTERIOR VIEWS

The ground floor plan contains an invisible entrance door for refugees to use, and also an integration and teaching spaces which they are also for refugees to access and are invisible from the visible programme in the ground floor.

The visible programme will contain...

1. Entrance for refugees
2. Public entrance
3. Reception
4. Waiting space
5. Staff space
6. Exhibition
7. Learning space (different wars)
8. Female toilet
9. Male toilet
10. Exhibition canteen
11. Meeting room
12. Female toilet
13. Printing space
14. Offices
15. Heart of space
16. Interview space
17. Advice space
18. Male toilet
19. Quiet space
20. Cafe
21. Female toilet
22. Integration space
23. Teaching space
24. Exam space
25. Female toilet
26. Disabled entrance
27. Exhibition exit
28. Second entrance for students and staff
29. Second exit
30. Integration space for refugees
31. Teaching spaces for refugees.



EXHIBITION SPACE



INTEGRATION SPACE



GROUND FLOOR PLAN - 1:200 SCALE

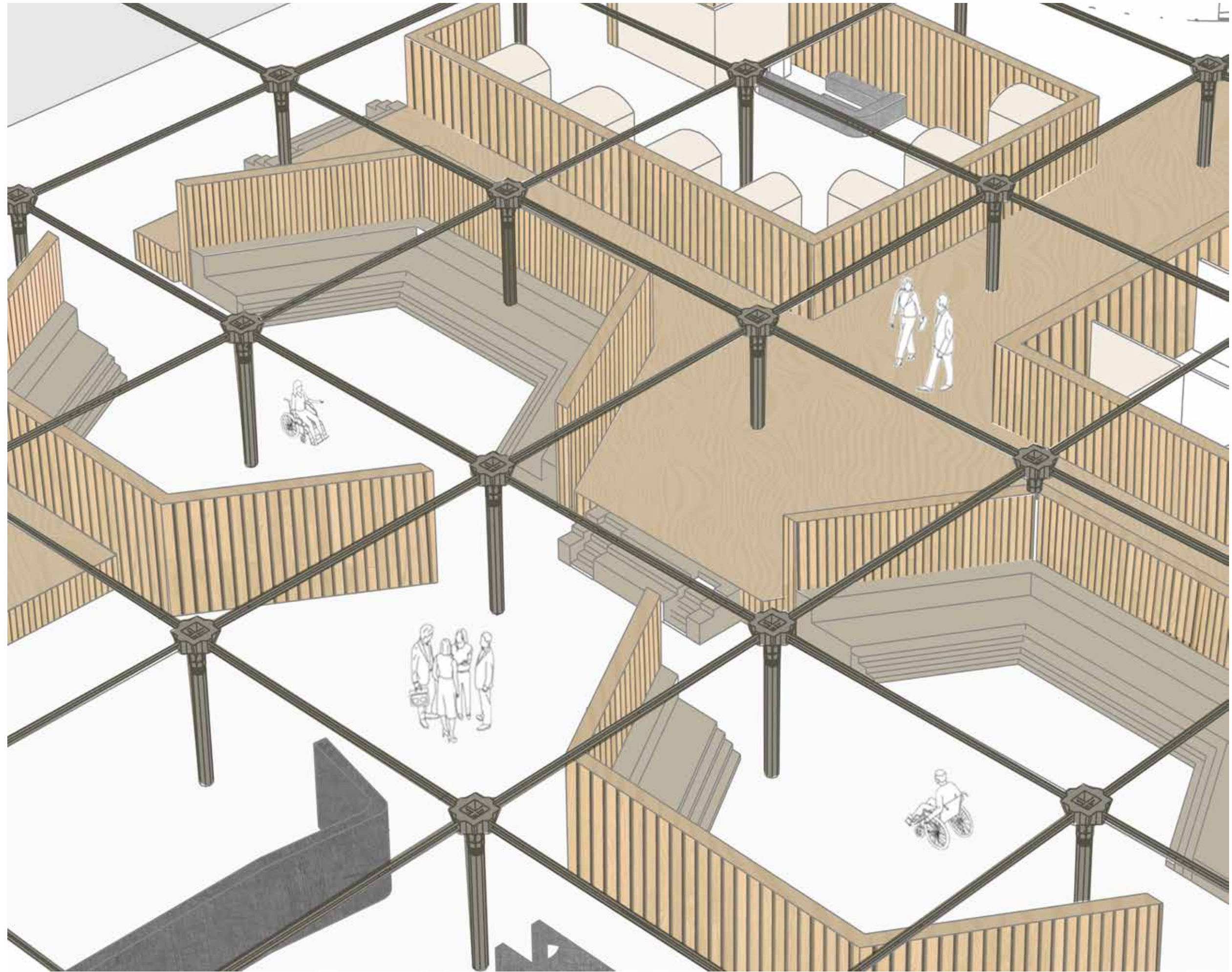

BASEMENT: DETAILING OF THE SLEEPING PODS

To gain an understanding of the arrangement and placement of the pods within the bricked arches, an axonometric diagram of the basement has been generated. This provides an overall view of the pods and their spatial relationship within the arches. To further explore the design of the pod, axonometric diagrams were created to illustrate both the detailed elements and the pod as a whole. These diagrams aid in understanding the pod's functionality and also serve the purpose of showcasing the chosen materials.

In terms of material selection, laminated marine plywood was chosen for the construction of the sleeping pods. This particular material offers a combination of functional and aesthetic advantages while also being environmentally friendly. The warm and natural tones of laminated marine plywood contribute to creating a comfortable and inviting atmosphere within the pod space.

The invisible programme contain...

1. Entrance
2. Medical Space
3. Canteen
4. Kitchen
5. Storing space for clothes
6. Storing space for food
7. Bathrooms
8. Walkways
9. Sleeping pods

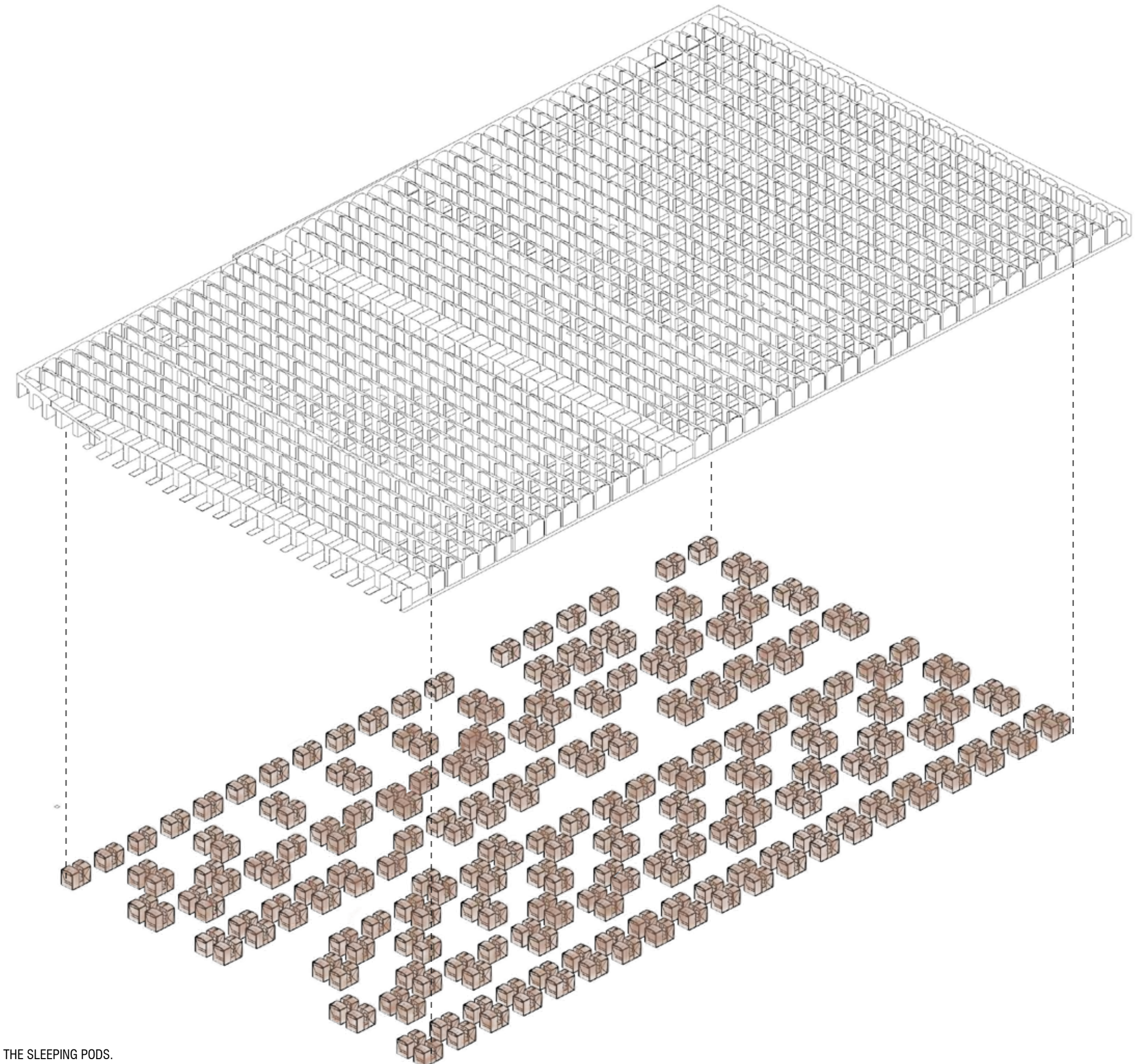
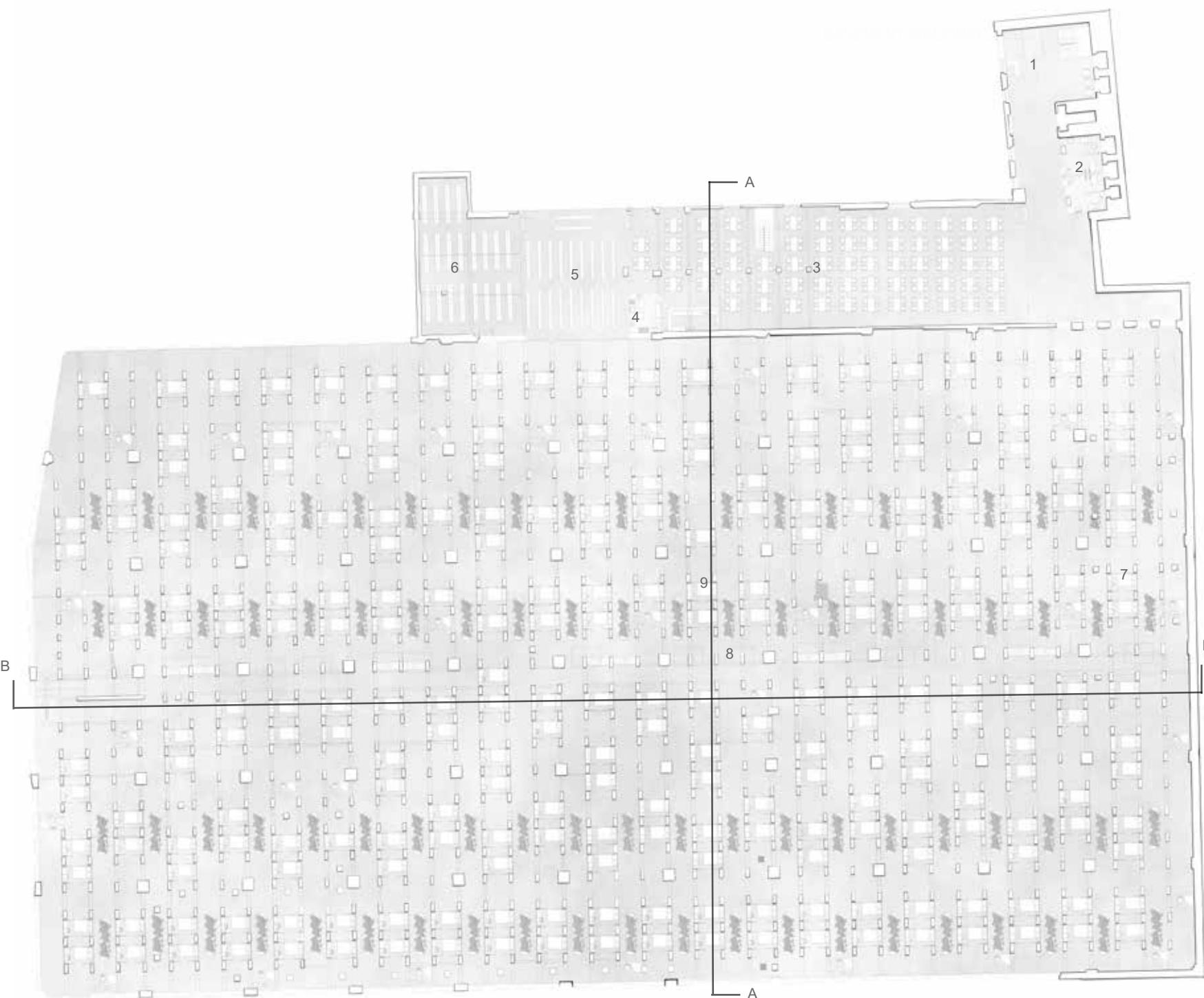
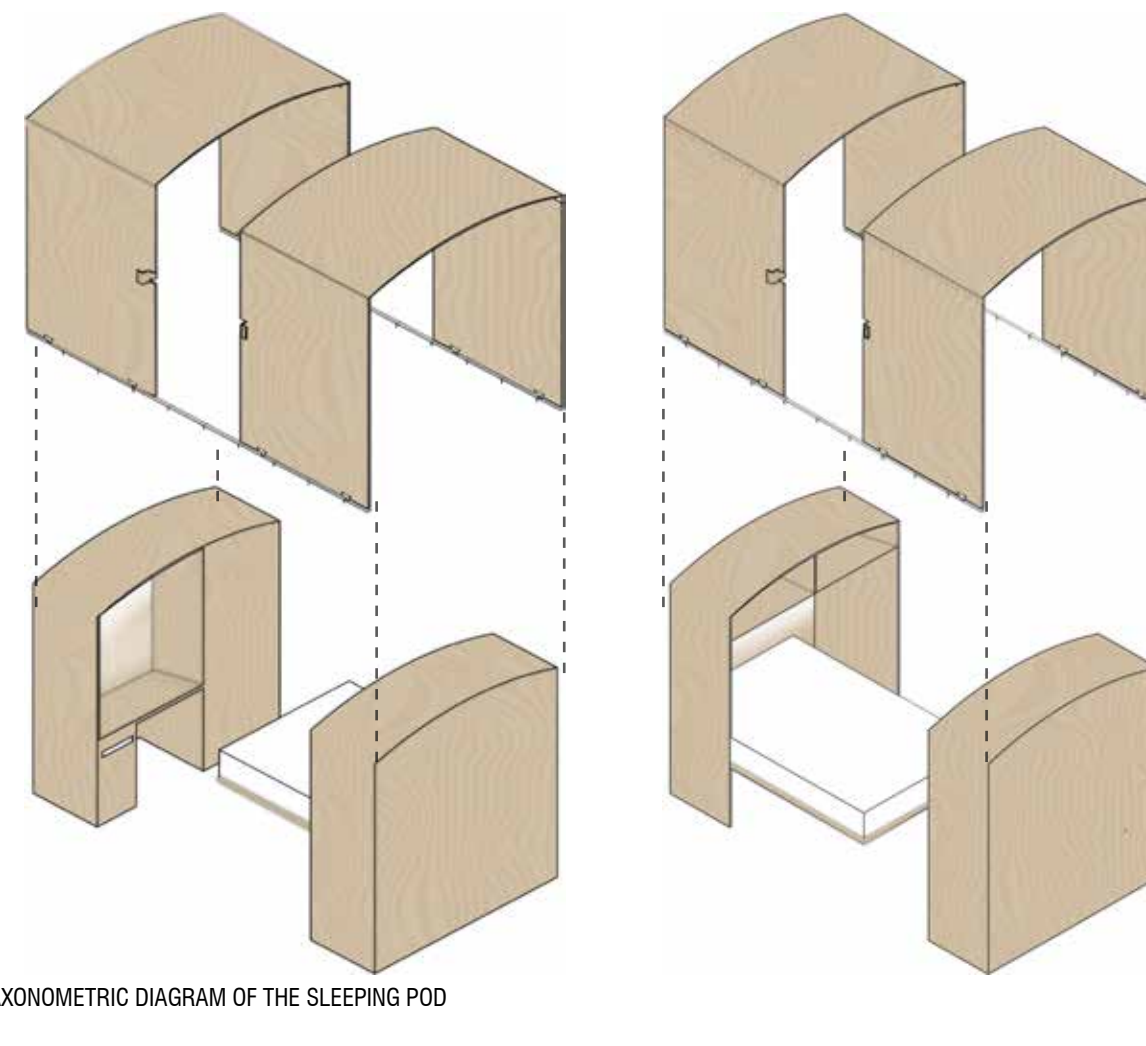
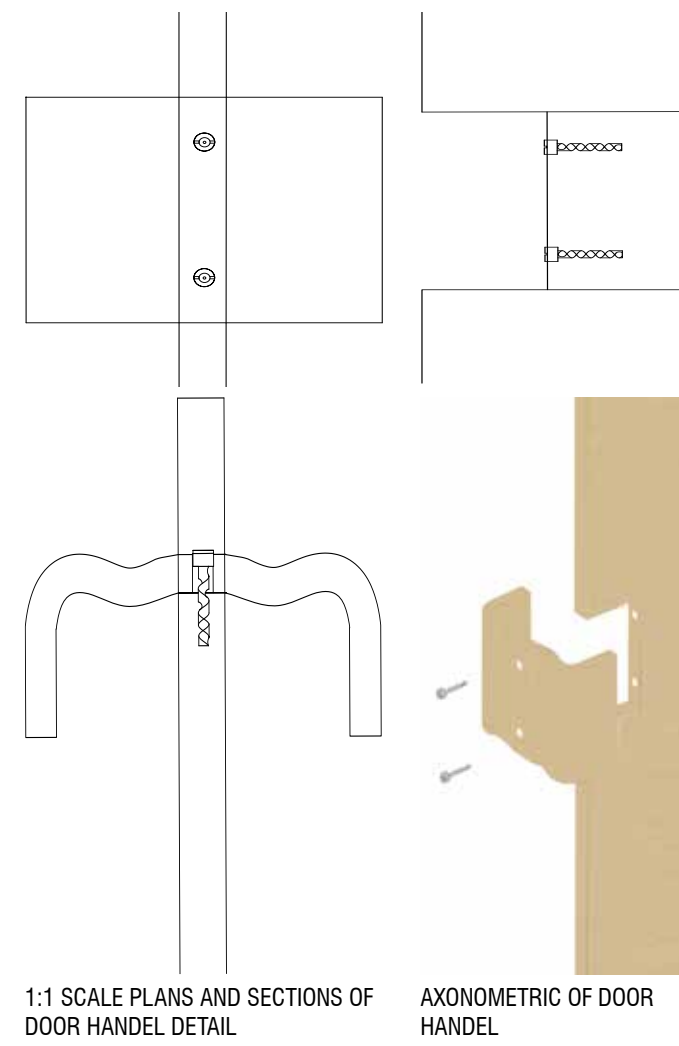

SECTIONS AND INTERIOR VIEWS

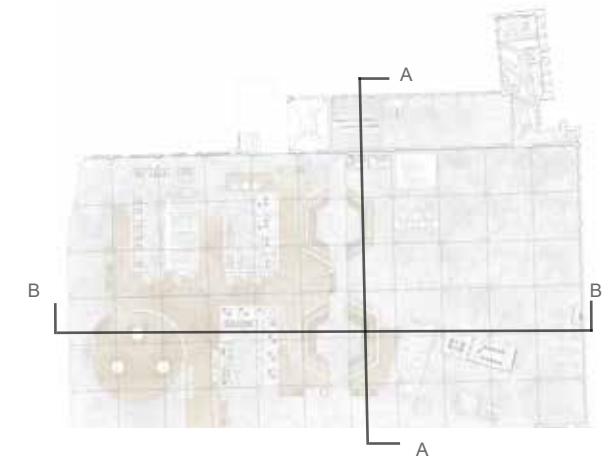

SECTION AA - 1:100 SCALE

INTEGRATION SPACE.



QUIET SPACE.

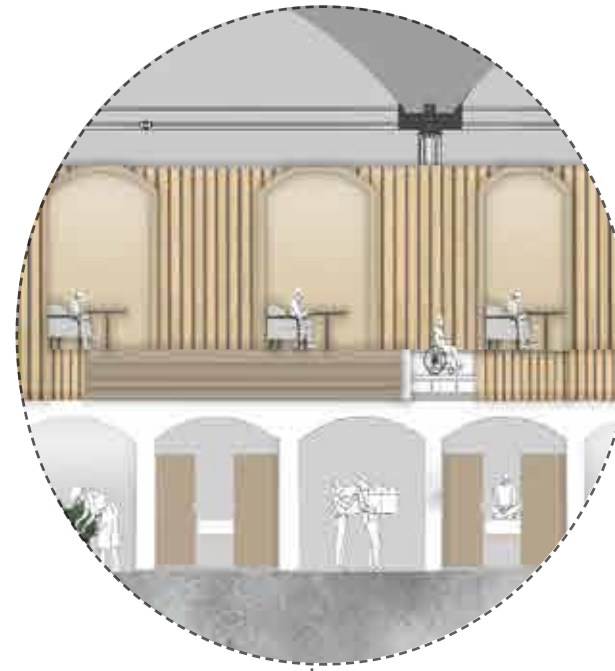

HEART OF SPACE.



EXHIBITION SPACE AND SLEEPING PODS IN THE BASEMENT.



SECTION BB - 1:200 SCALE