

LEGACY NEXUS

'How do we build bridges, and not walls, between people?'

What is legacy? Is it a material expression of value, where the future meets past in the old skin? What does this 'old skin' hold, and what are the nexus? There is more than just wheel scratches and the smell of fuel.

"What if" there is a bridge between past and future that holds forgotten values? "What if" there is an unseen intertwining for community? "What if" the legacy lies in something that today's well-being needs the most?

It signifies shaping the legacies of tomorrow. It signifies a space for building a nexus for tradition honoring, story sharing, and unforged narratives, by building bridges of shared messages from the old through a new vision.

LEGACY

something transmitted by or received from an ancestor or predecessor or from the past

NEXUS

a connection or link between things, persons, or events especially that is or is part of a chain of causation

By respecting the building's history and character, the brief for the Stockwell Bus Garage project is to create **multi-functional and carbon emission free community space** for local people and London's Transport community. The goal is to create **well-designed community space** that will not only highlight building's significance and rich history but more important, will **support healthy environment and will relive local area** by building bridges between people with diverse backgrounds and interests and space.

The project requires an exploration of Lambeth Borough, Stockwell local area, Post World War II period in 1950s, Transport for London, Go Ahead London, modernism architecture, and London Plan 2021 to acknowledge existing circumstances in the local area and develop proposal for sustainable future building. By drawing nexus and realizing differences between modern-day people needs, the brief ultimately asks for a **safe space that specifically responds to the needs for today's wellbeing to create legacies for the future.**



BRIEF

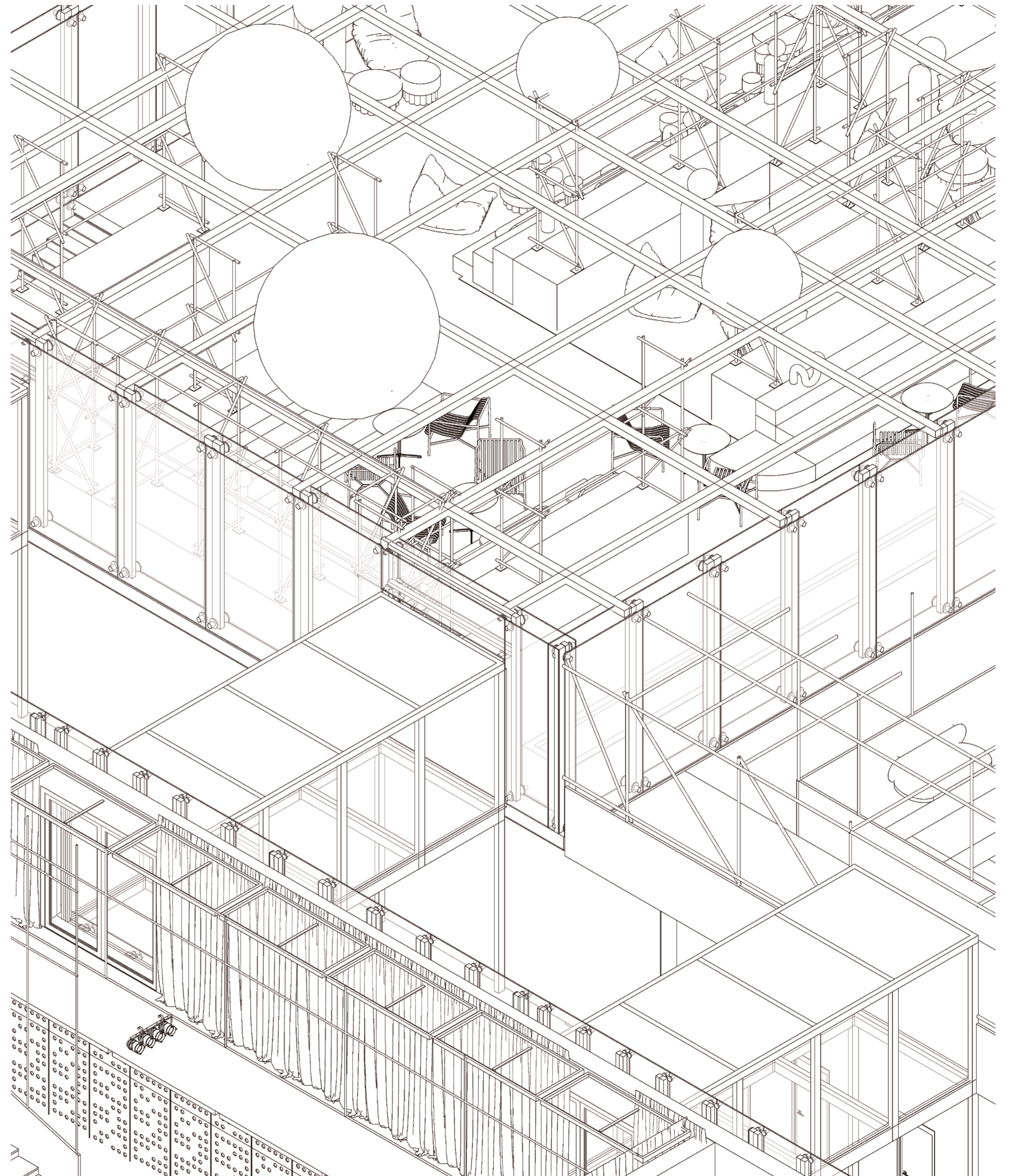
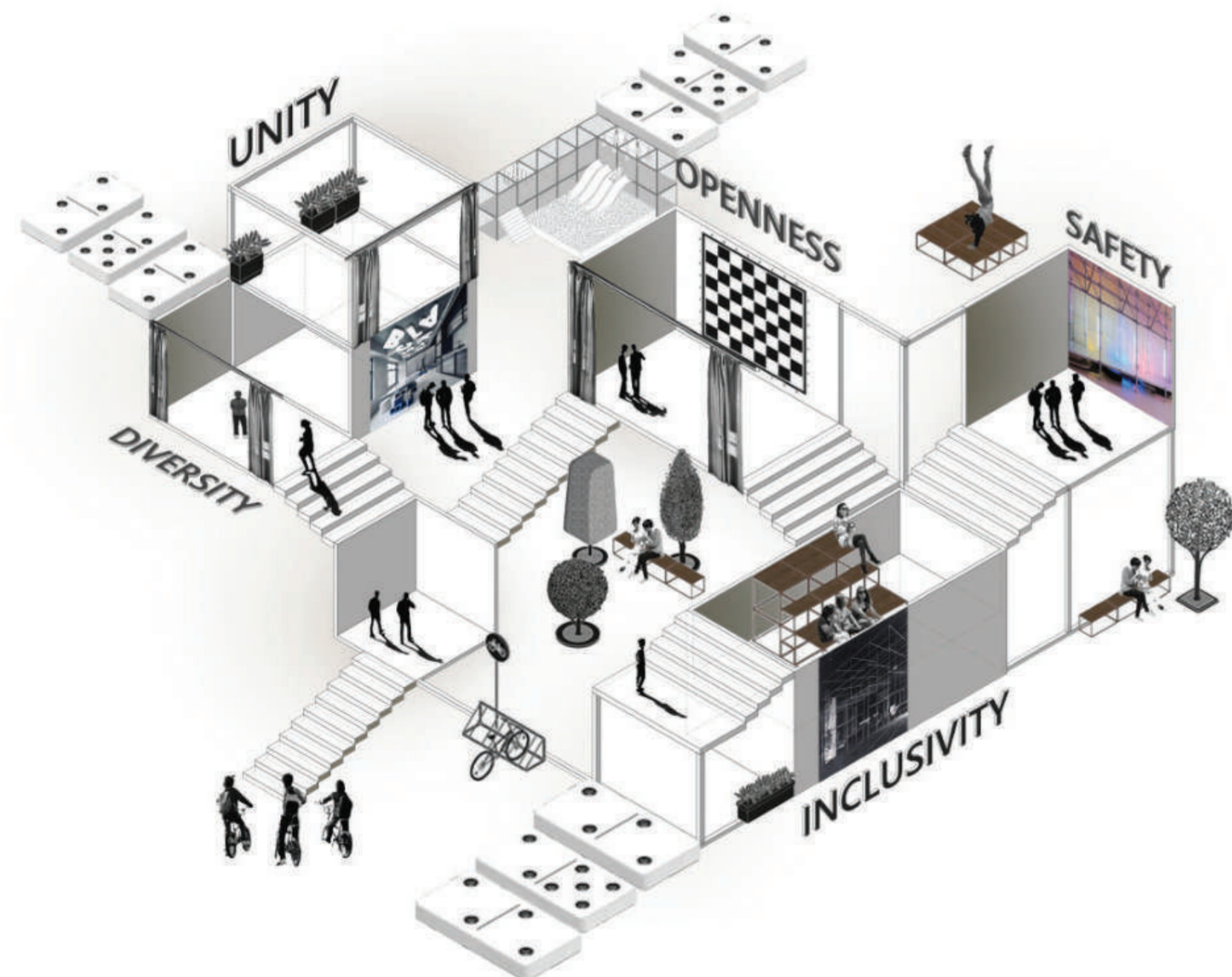

CONTEXT MAP

The map shows the research area in the local vicinity of Stockwell Bus Garage. The site is situated near a main road between Lansdowne Road and Binfield Road. The closest station is Stockwell Station. The site is surrounded by some small retailers, but mostly this area is residential. The opposite side of the main Clapham Road is more active, offering educational and social activities. Despite the presence of Stockwell Bus Garage, the area didn't seem loud or overly active. Other local areas, such as Brixton, offer more activities and possibilities than Stockwell.

TAGS:

- 01 BUILDING TAGS
-  PUBLIC TRANSPORT
-  PROJECT SITE
-  GREEN AREAS

- 01 Stockwell Bus Garage
- 02 Stockwell War Memorial
- 03 Stockwell Baptist Church
- 04 Stockwell Park Community Centre
- 05 Stockwell Playhouse
- 06 Stockwell Skatepark
- 07 Van Gogh House
- 08 Stockwell Gardens Nursery & Pre-School

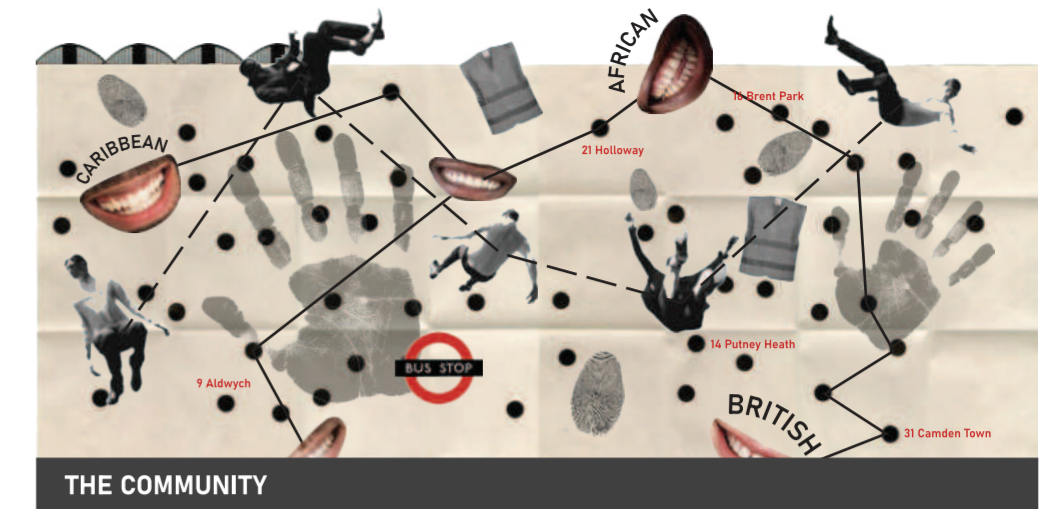

Currently, approximately 600 people with diverse backgrounds work at Stockwell Bus Garage, forming a large community that provides services to over 6 million people around London each day. As they say, there is a little bit of every culture, and approximately 50 languages are spoken at the garage. Coworkers span a wide spectrum of ages, and there is a significant range in the number of years some drivers have worked at Stockwell Bus Garage. This is a mixed-culture environment because, at some point, individuals had to leave their countries for personal or other reasons. When asked why they chose to be bus drivers, most of them mention the pursuit of freedom.



WINDRUSH GENERATION

Lambeth borough role in the lives of the Windrush immigrants: Lambeth became a hub for Caribbean immigrants arriving in the post World-War II period. Many people settled in Lambeth and surrounding areas, where they contributed to the local economy by taking up jobs in various sectors, including public transport. Caribbean immigrants in Lambeth formed a strong community. Community centres played a crucial role maintaining a sense of identity. They contributed to various sectors, including healthcare, public services, transportation, and other essential industries, helping to rebuild the country.



THE USER

Referring to the research and the concept, four potential user groups have been identified. To align with the envisioned multi-purpose spaces in the building, the potential user groups include the driver's community (retired drivers, drivers' families and friends, technical staff) and the local community (culture enthusiasts, elderly people, younger generation, community engagement seekers). The third group is visitors, including people from outside such as tourists, event attendees, and explorers. The last group is professionals, such as performers, guest artists, educators, and others.

MATERIALS

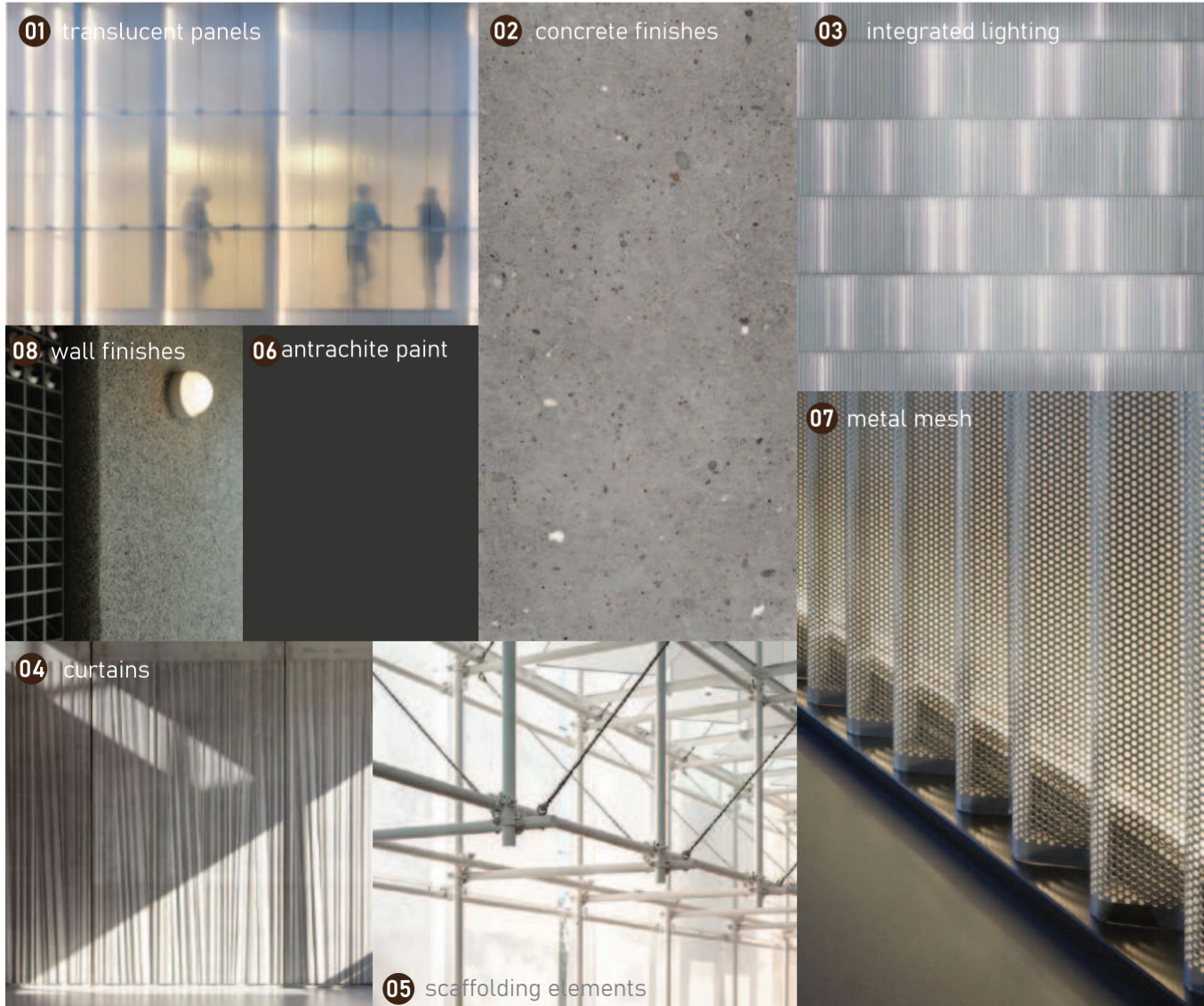

VISUAL FOR OPEN SPACE ATRIUM | VIEW FROM 1ST FLOOR, NEXT TO TERRARIUM ENTRANCE



OPEN SPACE ATRIUM | VIEW FROM ENTRANCE

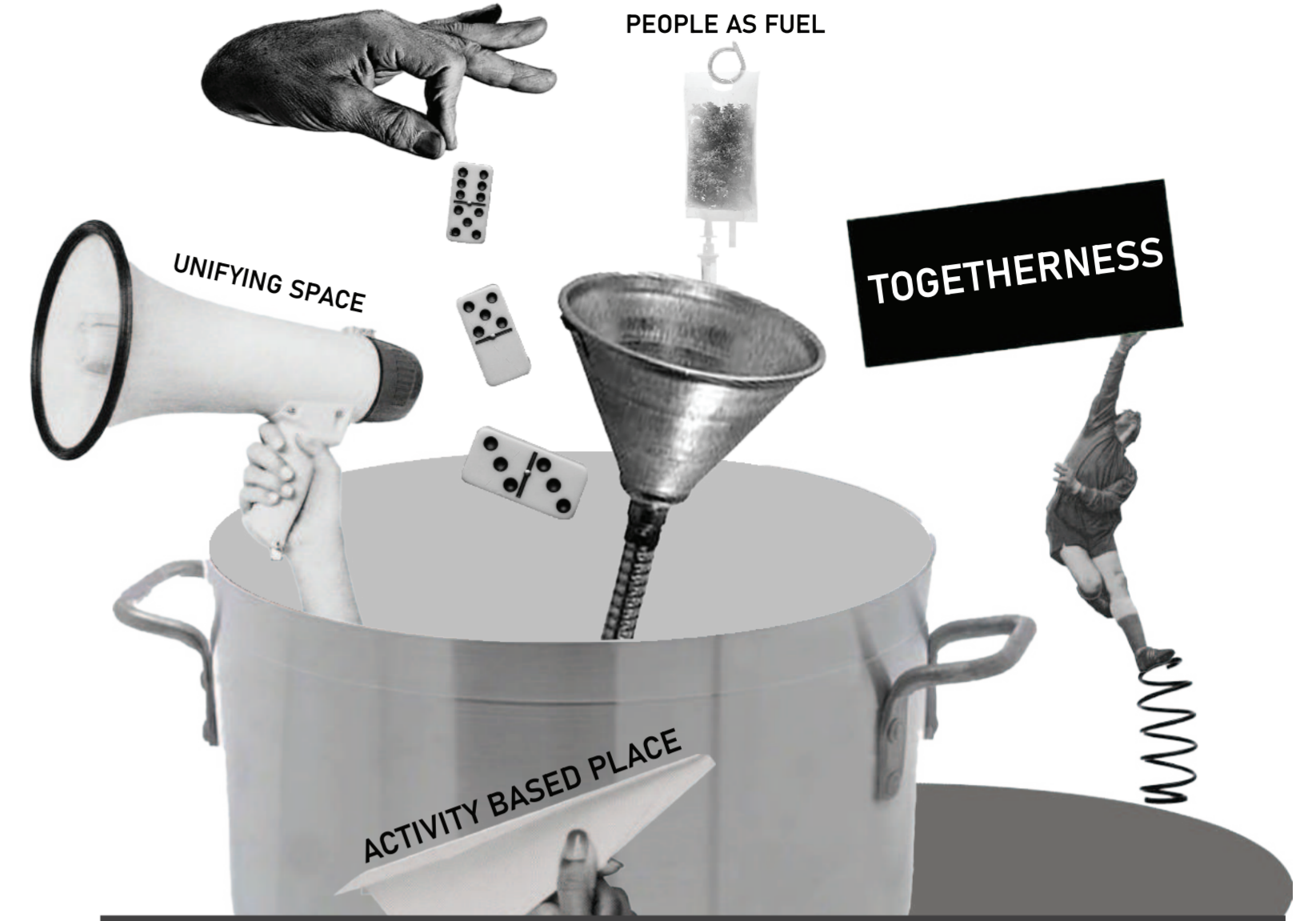

CONCEPT

Referring to the previous research and the future purpose of Stockwell Bus Garages, the goal is to create a **mixed-use space for locals, visitors, and, most importantly, Stockwell's Bus Garages driver community**. At the core of this vision is a **commitment to inclusivity and diversity**, creating nexus between people and space that aims to revolutionize the space into a **dynamic, carbon emission-free, multi-functional hub** that not only caters to the needs of the bus drivers' community but also serves as a connection for Stockwell's locals and visitors alike. The building's functional program will be developed with a **focus on its use by adding spaces for Go-Ahead London outreach programs** such as partnering events, collaborative community events, a service center, a public transport education center, and local business incubators. Activities will be curated to engage people of all ages and backgrounds, allowing the **building to function as an educational center itself**. The diverse program, including community events, art exhibitions, a performance hall, study and meeting rooms, and workshops, ensures that there is something for everyone, contributing to well-being.

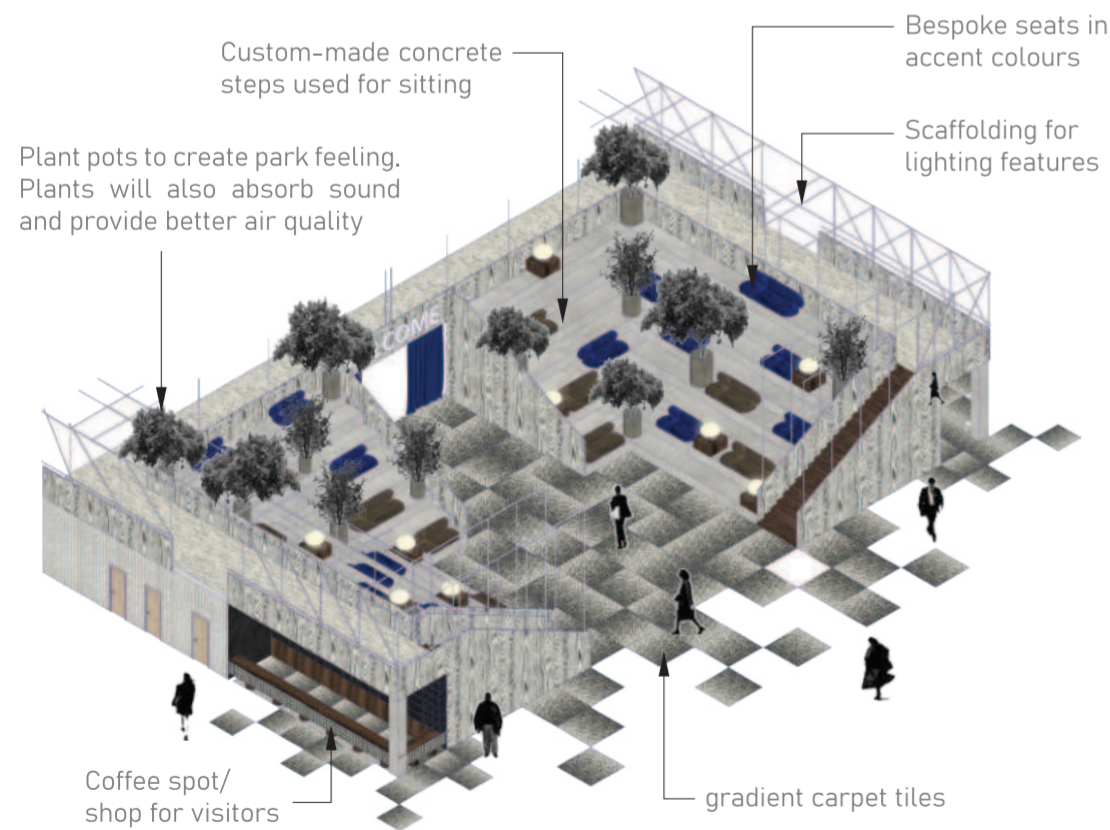

OPEN SPACE ATRIUM

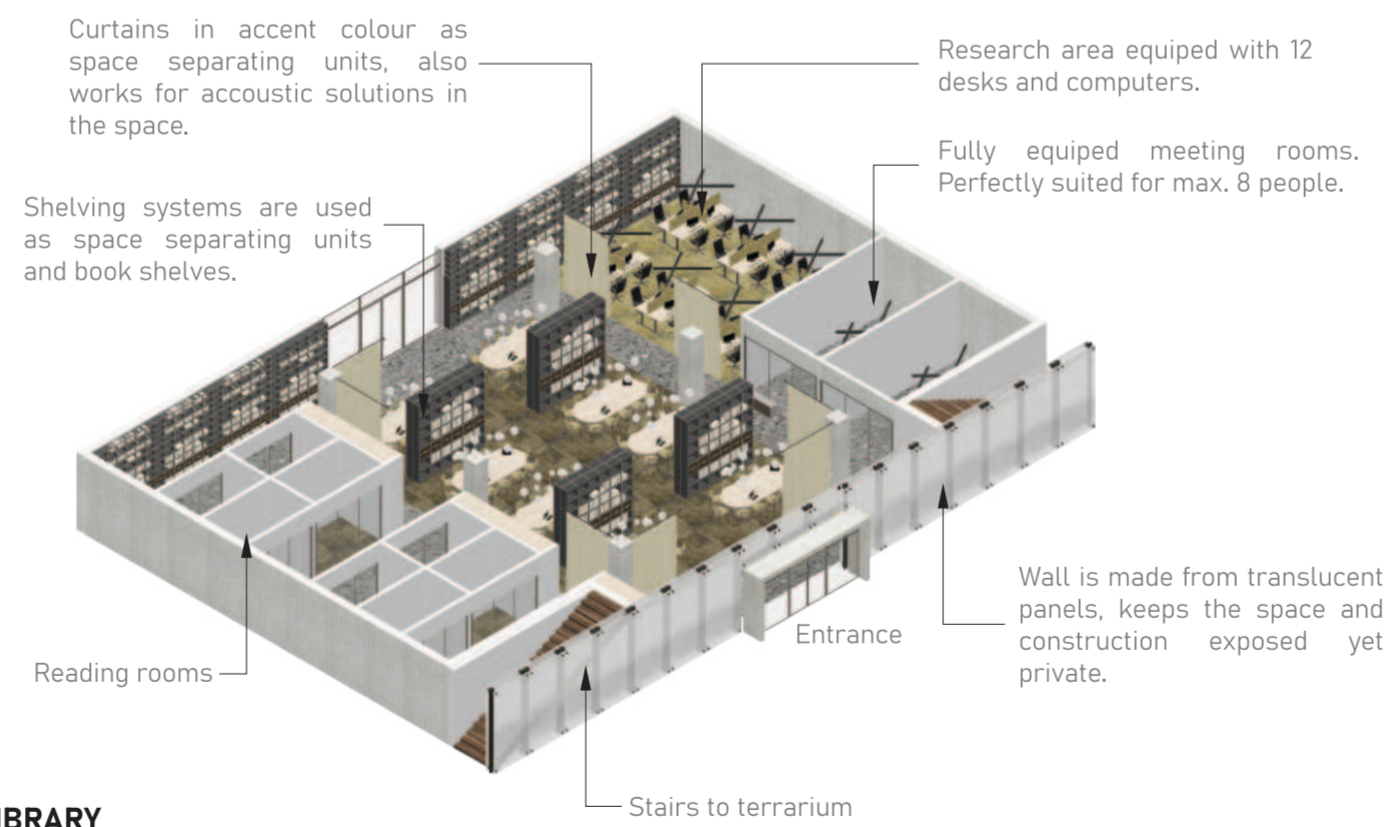

LIBRARY

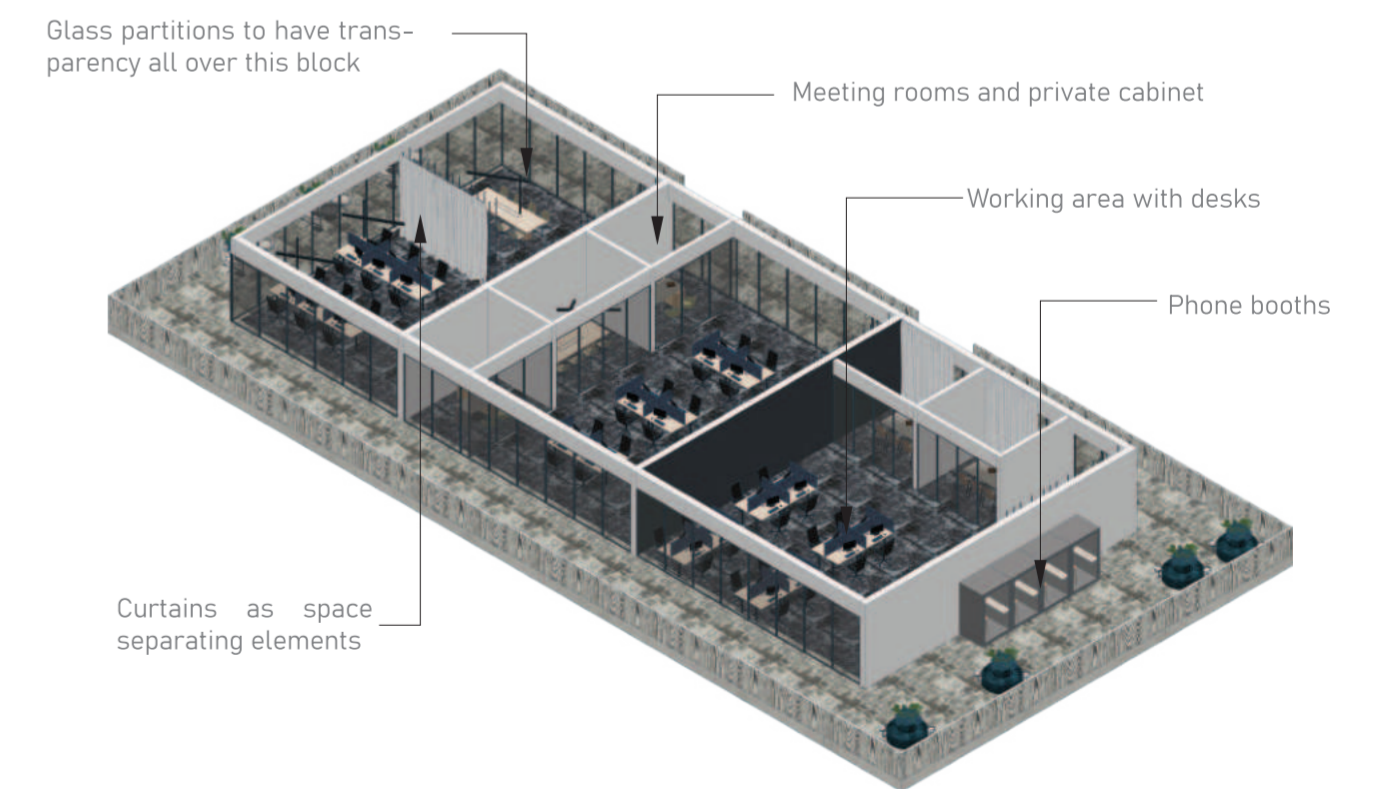
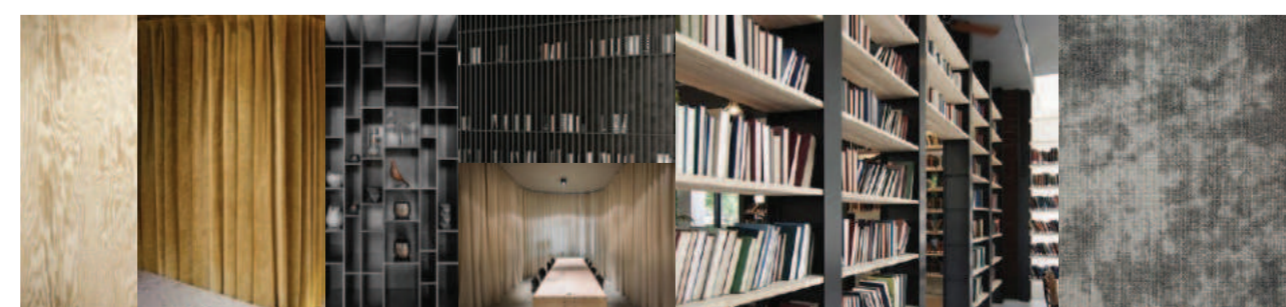

OFFICES



EXPLODED BUILDING AXO

showing where the architectural layer is situated in the building

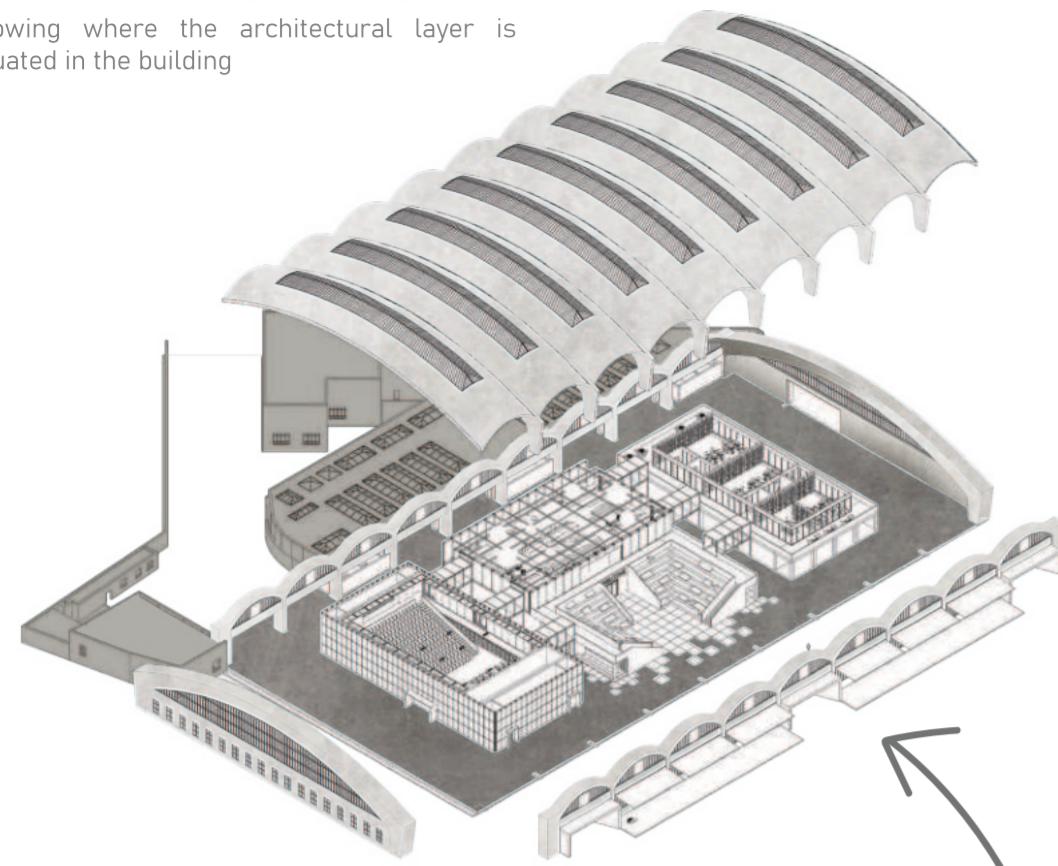

ARCHITECTURAL LAYER AXO

showing the layer that is integrated in the existing building and how all functional blocks connects together

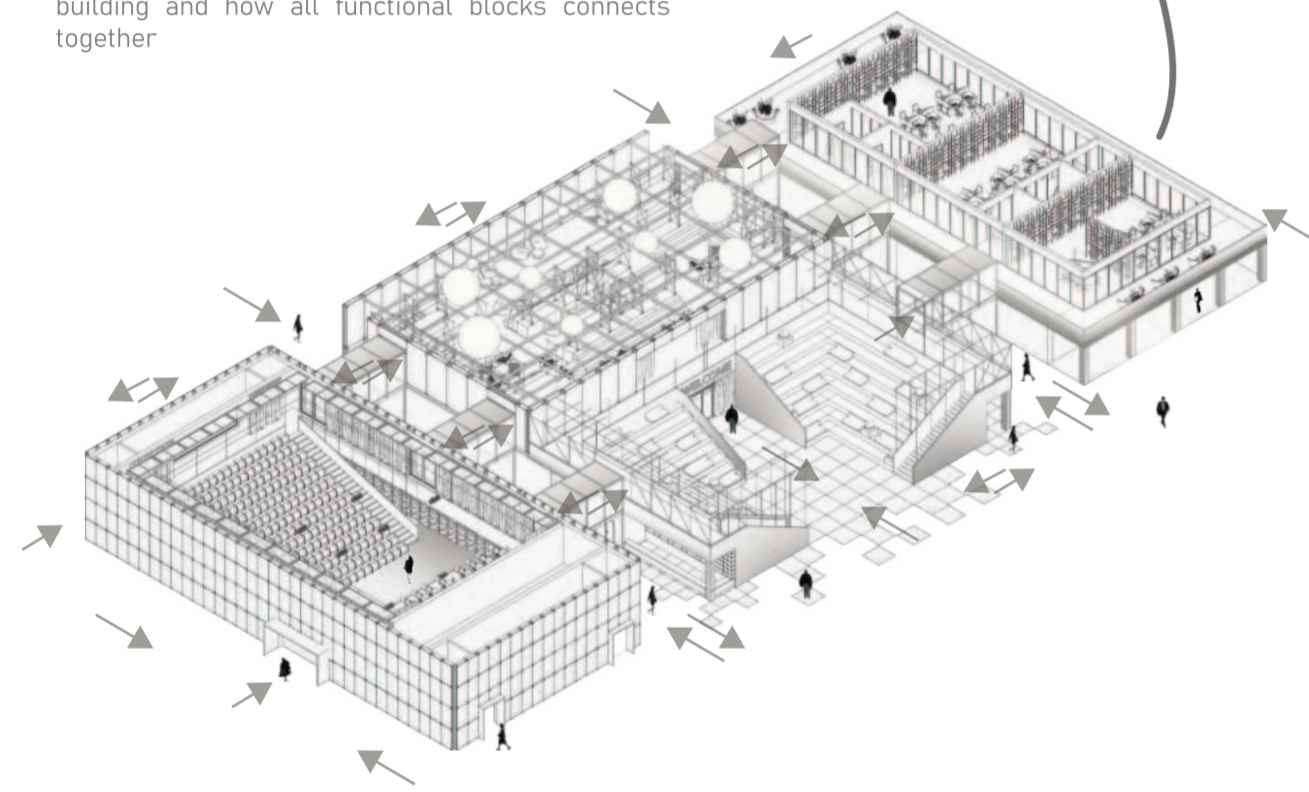

EXPLODED AXO

showing separate building blocks and where they will be placed

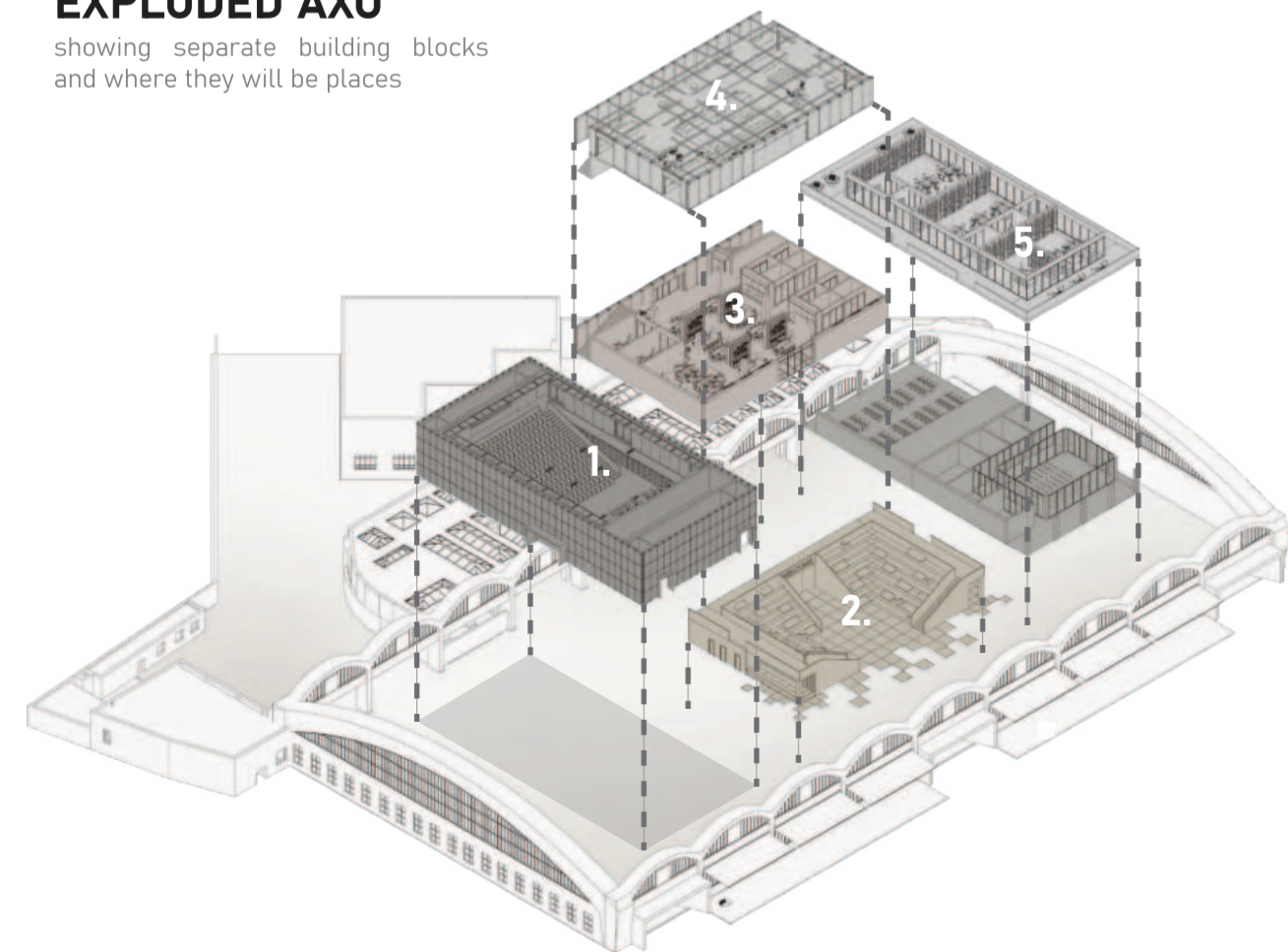

GROUND FLOOR

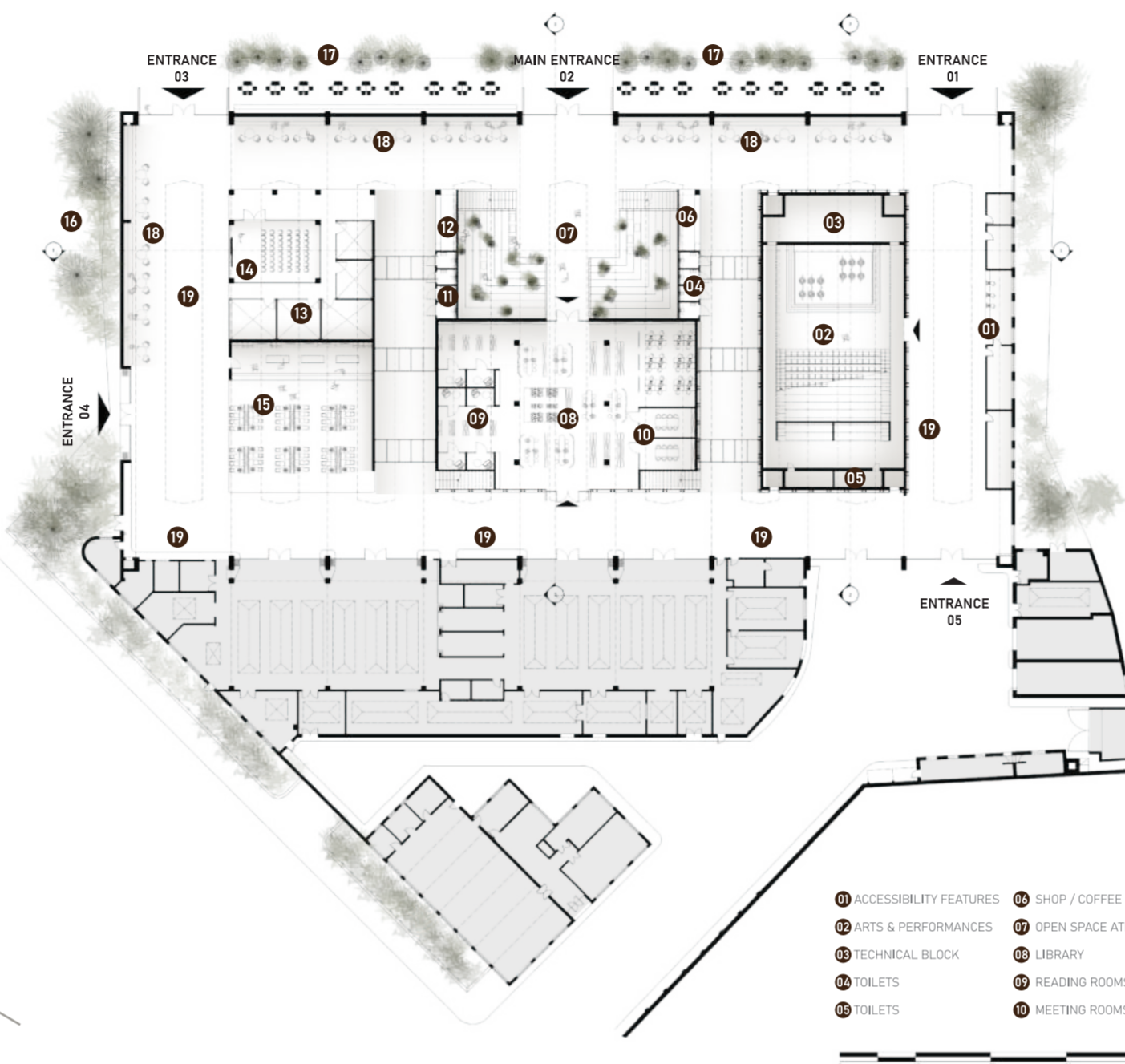

FIRST FLOOR

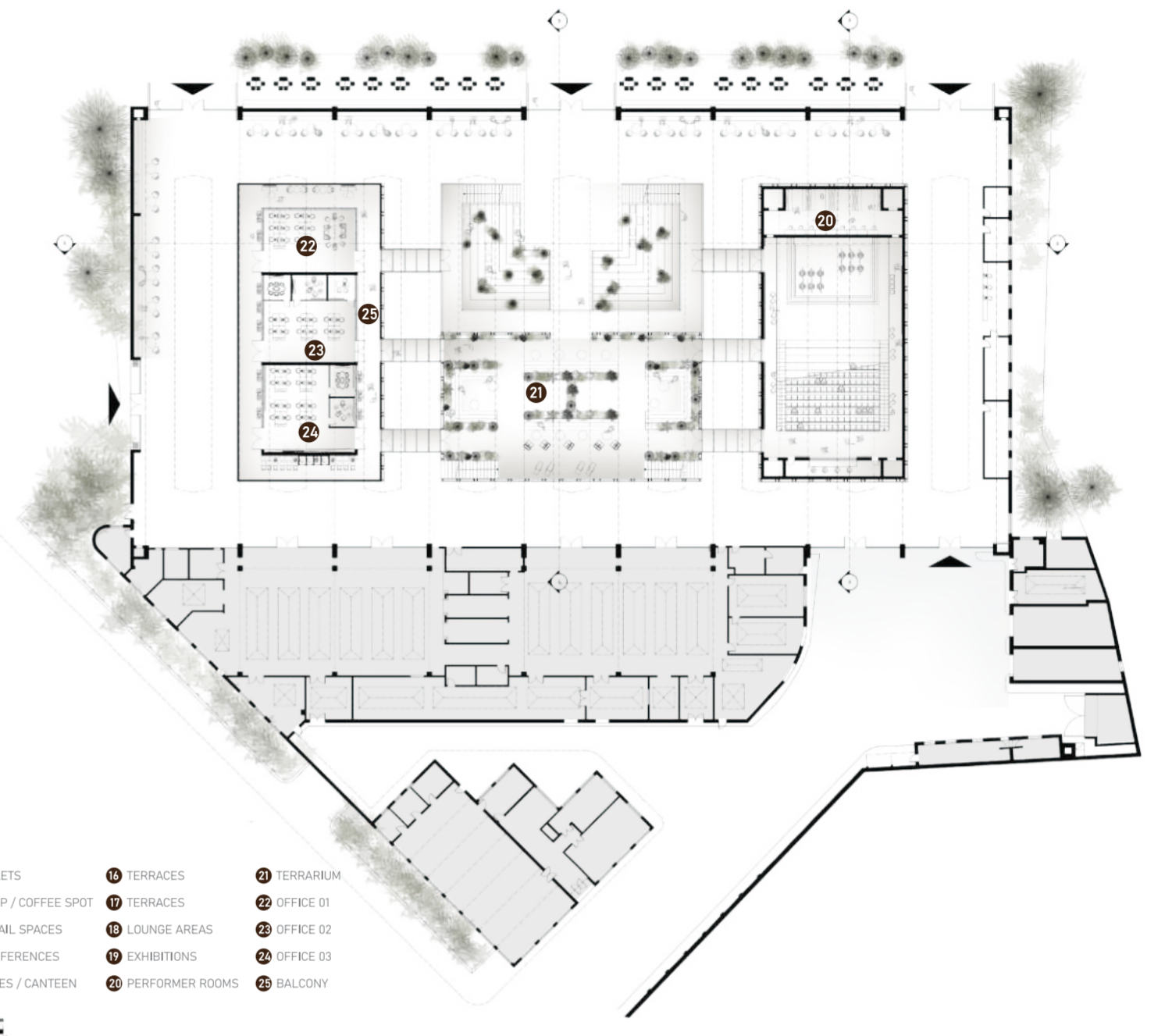

- 01 ACCESSIBILITY FEATURES
- 02 ARTS & PERFORMANCES
- 03 TECHNICAL BLOCK
- 04 TOILETS
- 05 TOILETS
- 06 SHOP / COFFEE SPOT
- 07 OPEN SPACE ATRIUM
- 08 LIBRARY
- 09 READING ROOMS
- 10 MEETING ROOMS
- 11 TOILETS
- 12 SHOP / COFFEE SPOT
- 13 RETAIL SPACES
- 14 CONFERENCES
- 15 CAFES / CANTEEN
- 16 TERRACES
- 17 TERRACES
- 18 LOUNGE AREAS
- 19 EXHIBITIONS
- 20 TERRARIUM
- 21 OFFICE 01
- 22 OFFICE 02
- 23 OFFICE 03
- 24 OFFICE 03
- 25 BALCONY

LONG SECTION 1-1

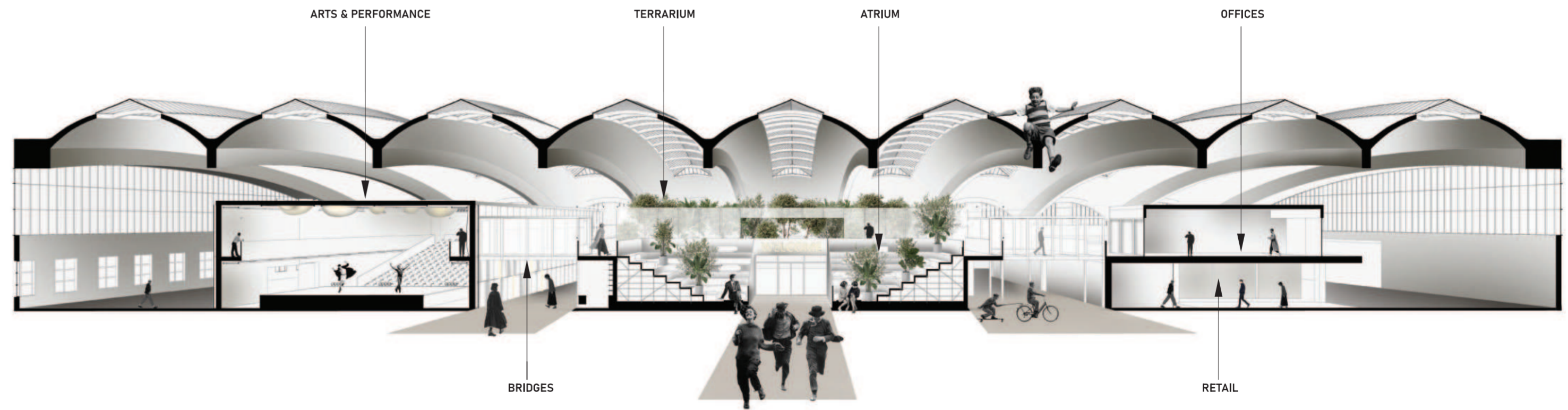

SHORT SECTION 2-2

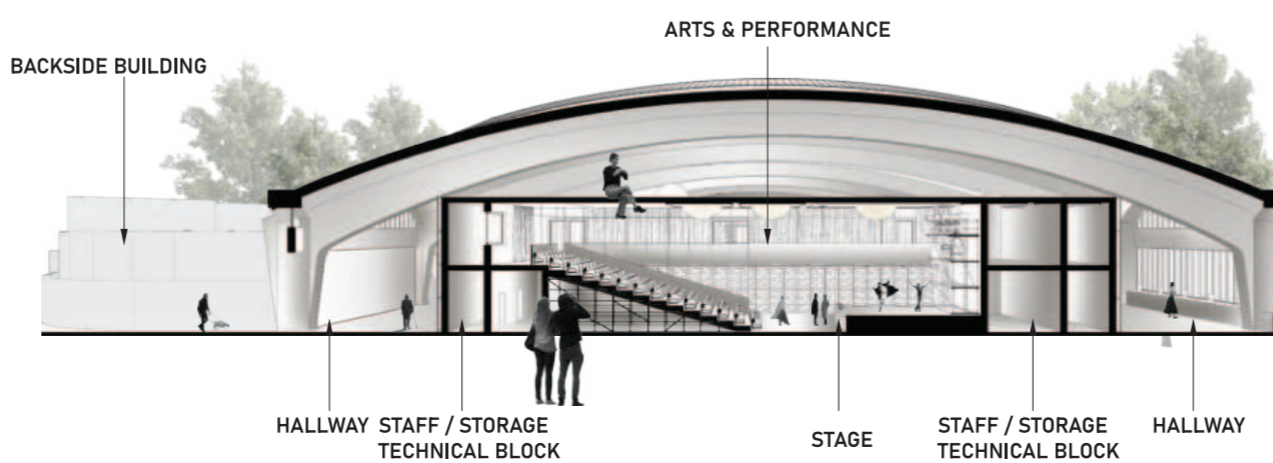

SHORT SECTION 3-3

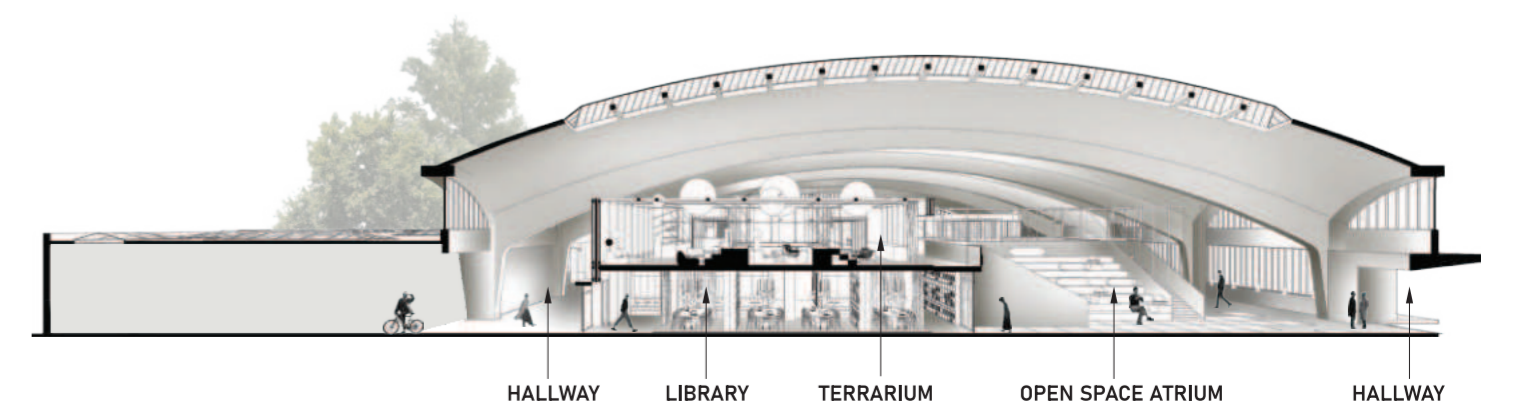

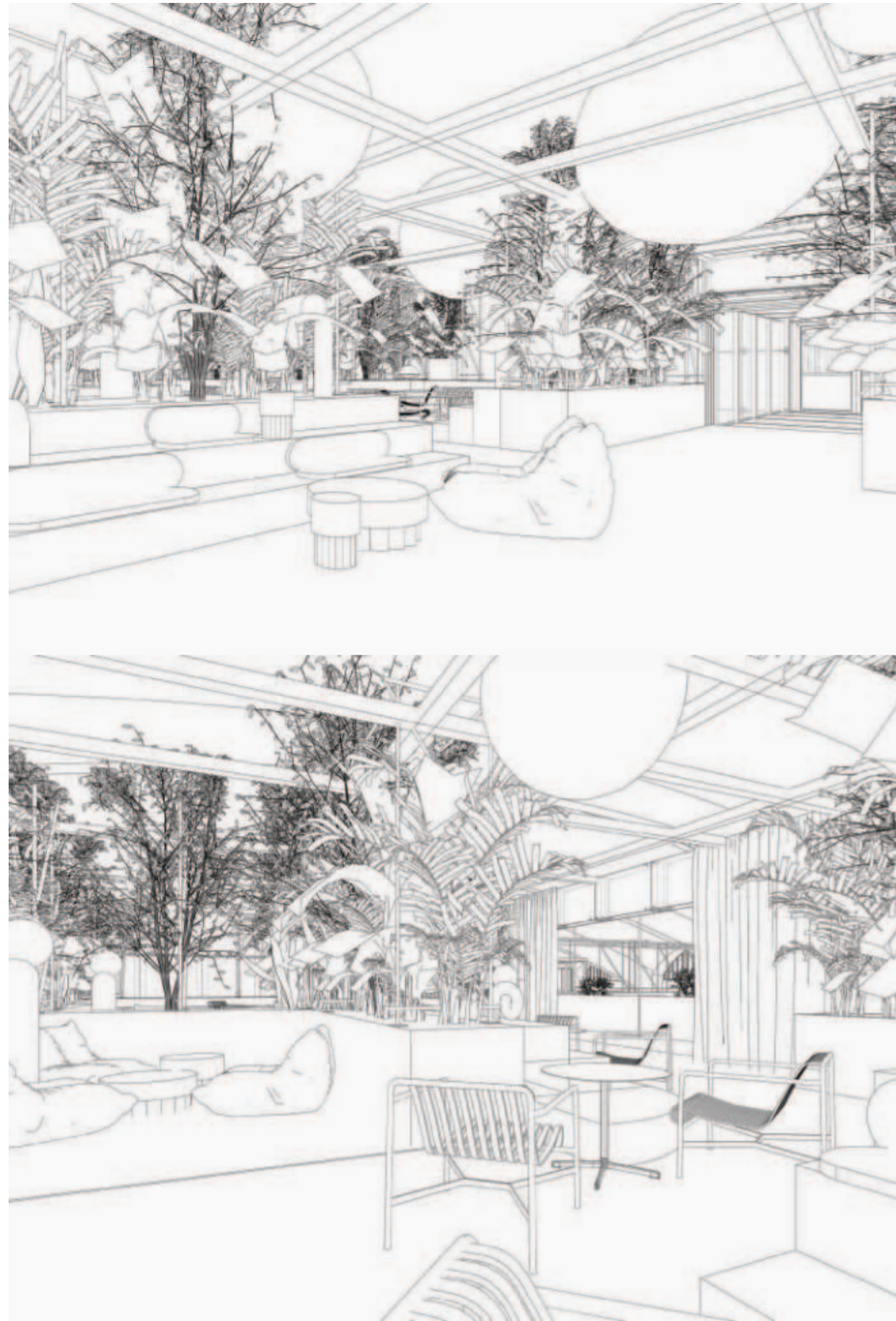

Lamps are connected to ceiling construction
This block doesn't have roof so plants can provide better air quality in the building

DOMINOES TERRARIUM

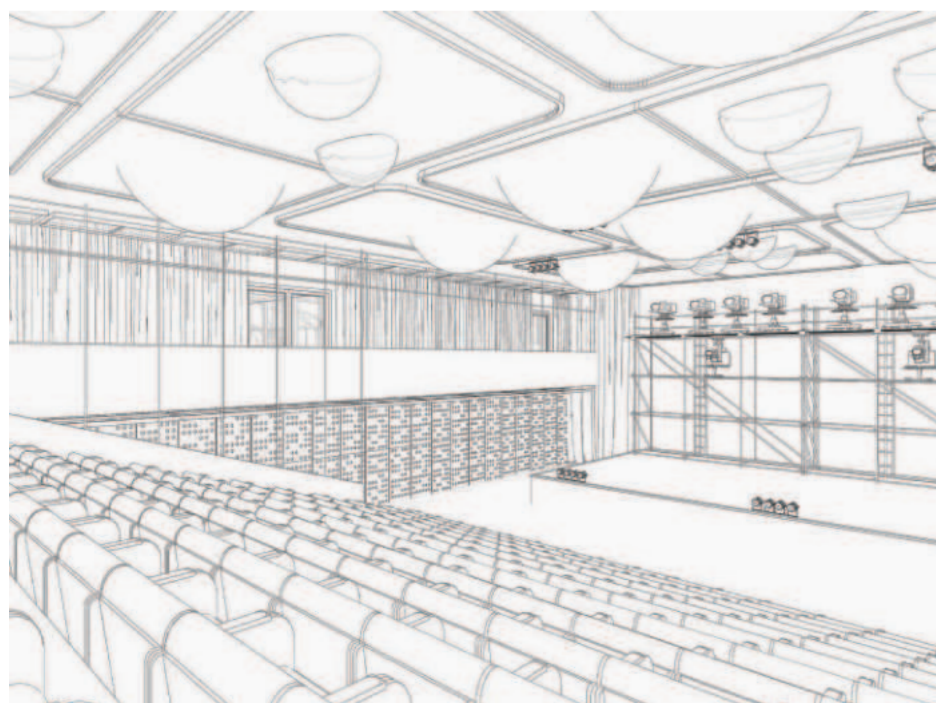
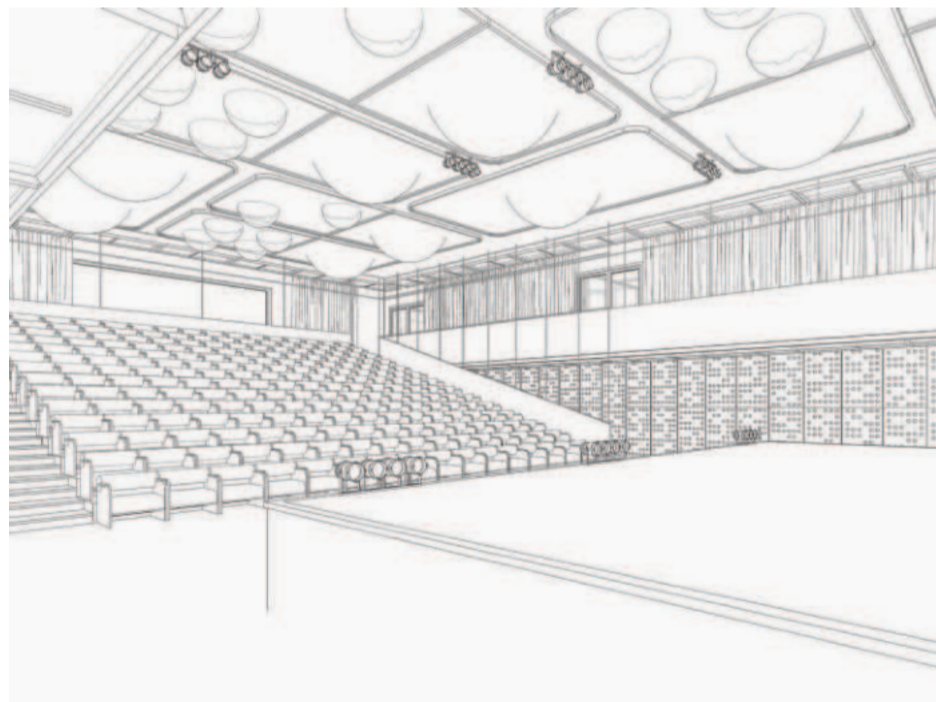
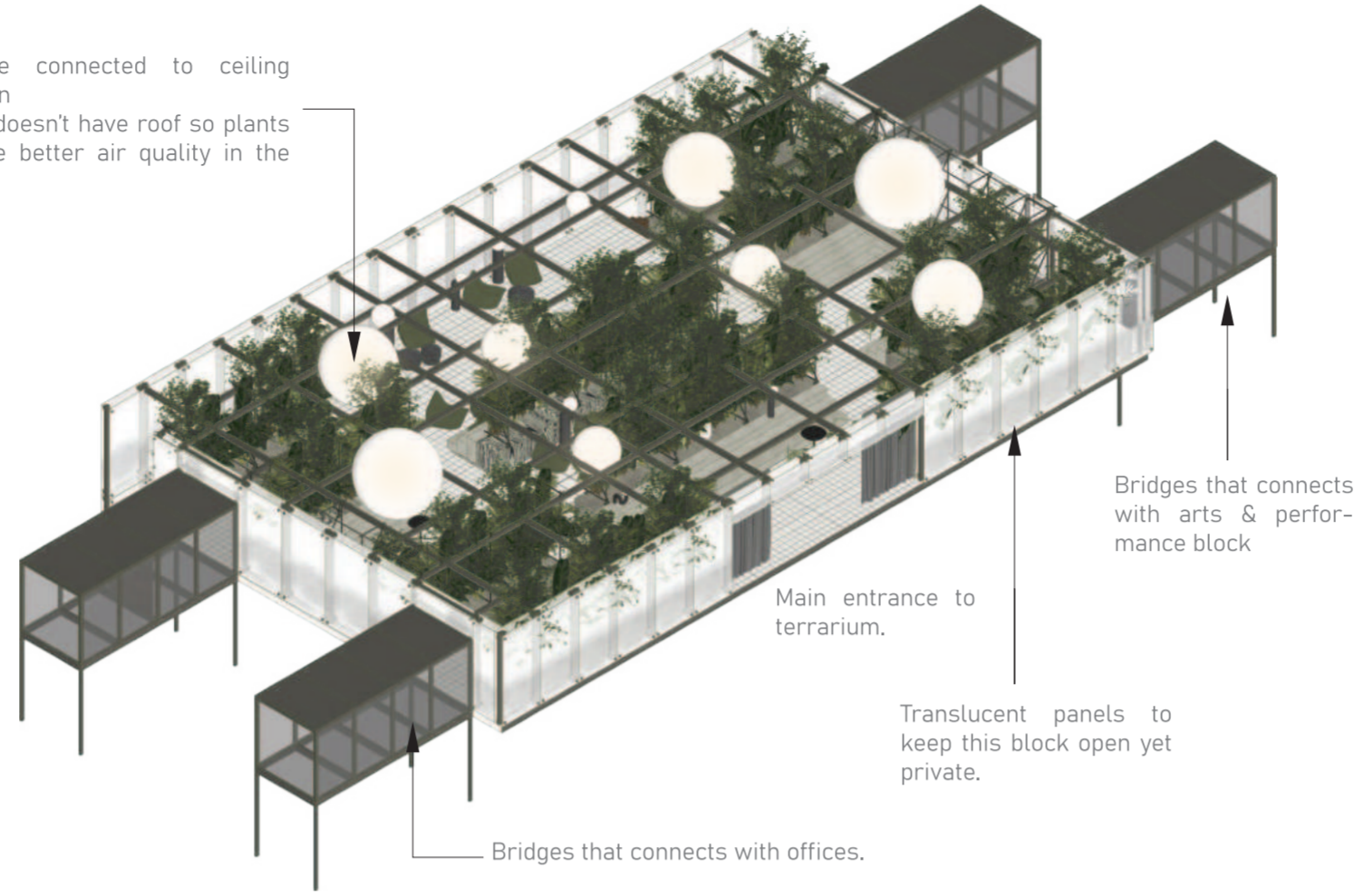

ARTS & PERFORMANCE

