

FLATPACK FARMING

As more people move into city centre, it poses a threat to our environment through concentrated emissions and strain to our food supply. Flatpack farming looks at the answer to localising our food system.

GREATER MANCHESTER GROWERS

RESTAURANTS

CAFE / TAKE AWAY

FOOD STOCKIST

84% of fruits are produced outside of the UK
66% of vegetables are produced outside of the UK

LOW CARBON SPOT

Plans put in place by Manchester City Council for the pedestrianisation of the city centre provides a low carbon spots for urban growing.

Vacant sites which are hidden amongst our streets offer an opportunity for urban growth. Envisioning a healthy, sustainable city for Manchester in the form of Urban Farming.

PROTOTYPE STRUCTURE

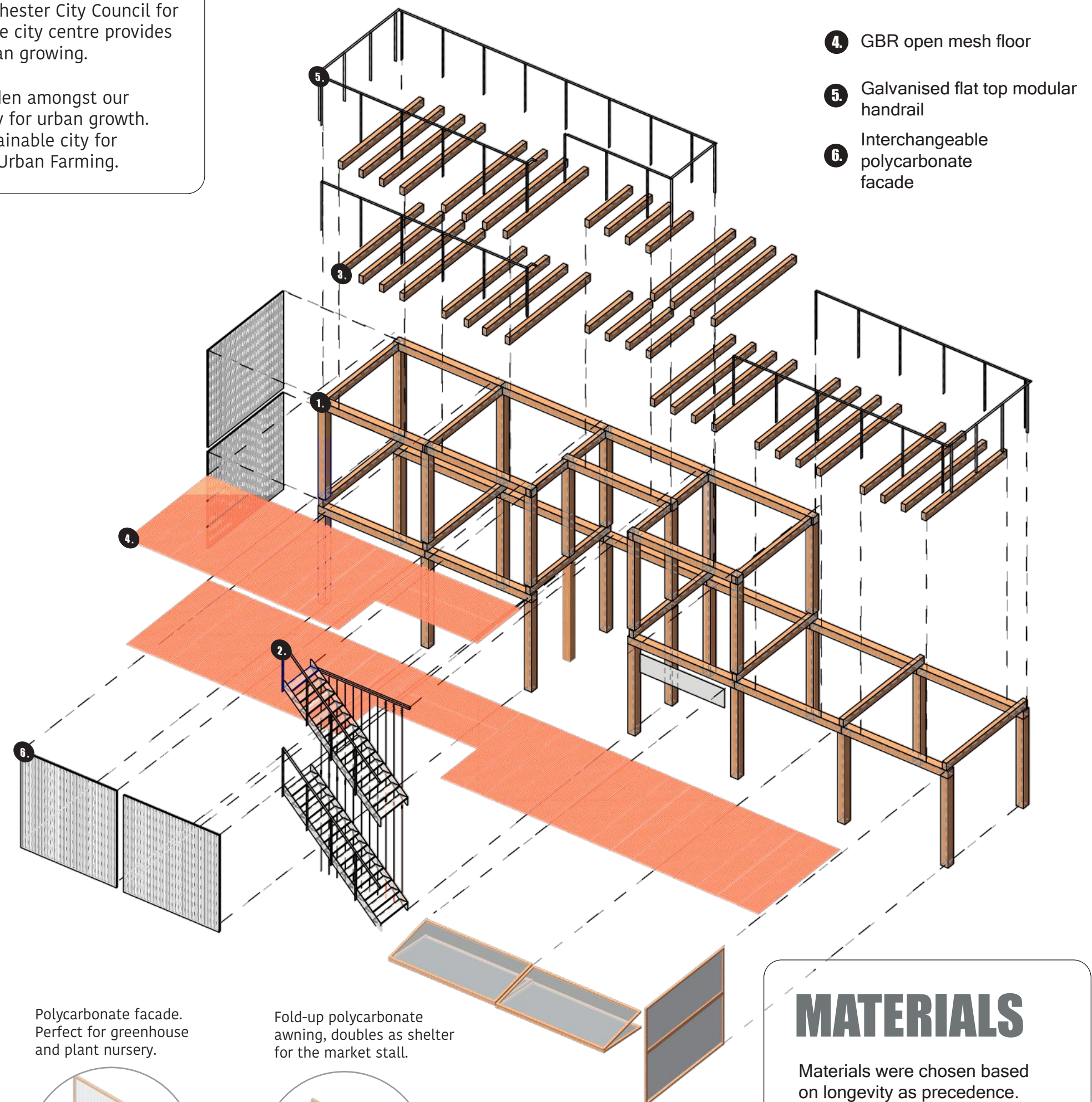

MATERIALS

Materials were chosen based on longevity as precedence. They required adaptability, high durability and low maintenance. But most of all, an uncomplicated and attainable construction process.

LOCATE

Vacant sites offer eco-agricultural locations for urban farms, whilst acting as pocket parks for the community.

BUILD

Prefabricated materials removes the need for on-site machinery. Creating a flatpack, self-build structure.

SHAPE

Assorted facades allow the user to create a desired configuration and modify the pods to suit differing climates.

SHARE

As the population is predicted to live in cities in the future, the need for urban agriculture and localising our food system is becoming apparent.

EXPAND

The pods use a modular system, fully reusable and designed to connect and adapt. Providing an opportunity for a collaborative allotment.

GROW

Effective forms of farming such as hydroponic techniques, efficient LED lighting and specialist greenhouses eliminates the boundaries on seasonal growth.

Open facade, with handrails. Option for rooftop allotment.

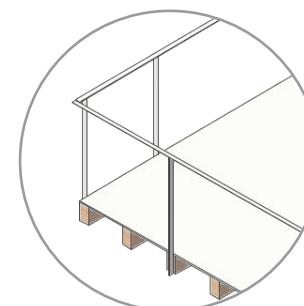

Polycarbonate facade. Perfect for greenhouse and plant nursery.

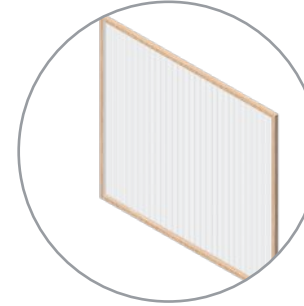

Fold-up polycarbonate awning, doubles as shelter for the market stall.

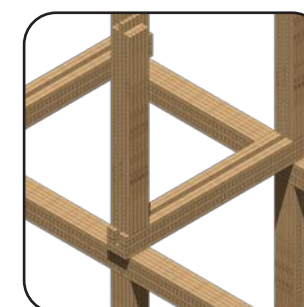
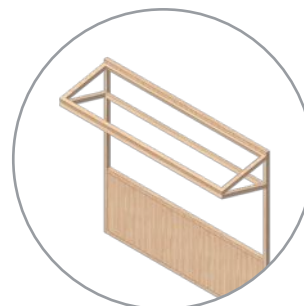

Cross-laminated timber (CLT) provides a healthy alternative to concrete in construction.

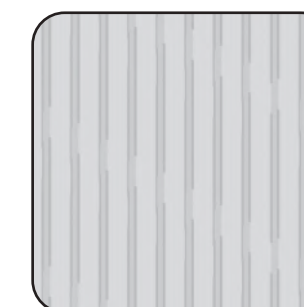

Polycarbonate is shatter-proof and impact resistance. It's lightweight form provides ease during maneuvering and installation.

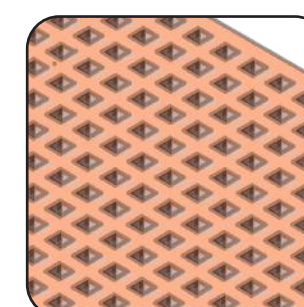

GRP mesh grating is half the weight of steel grid flooring which offers ease of installation with equal credibility.

2 STOREY URBAN ALLOTMENT

Instruction Manual

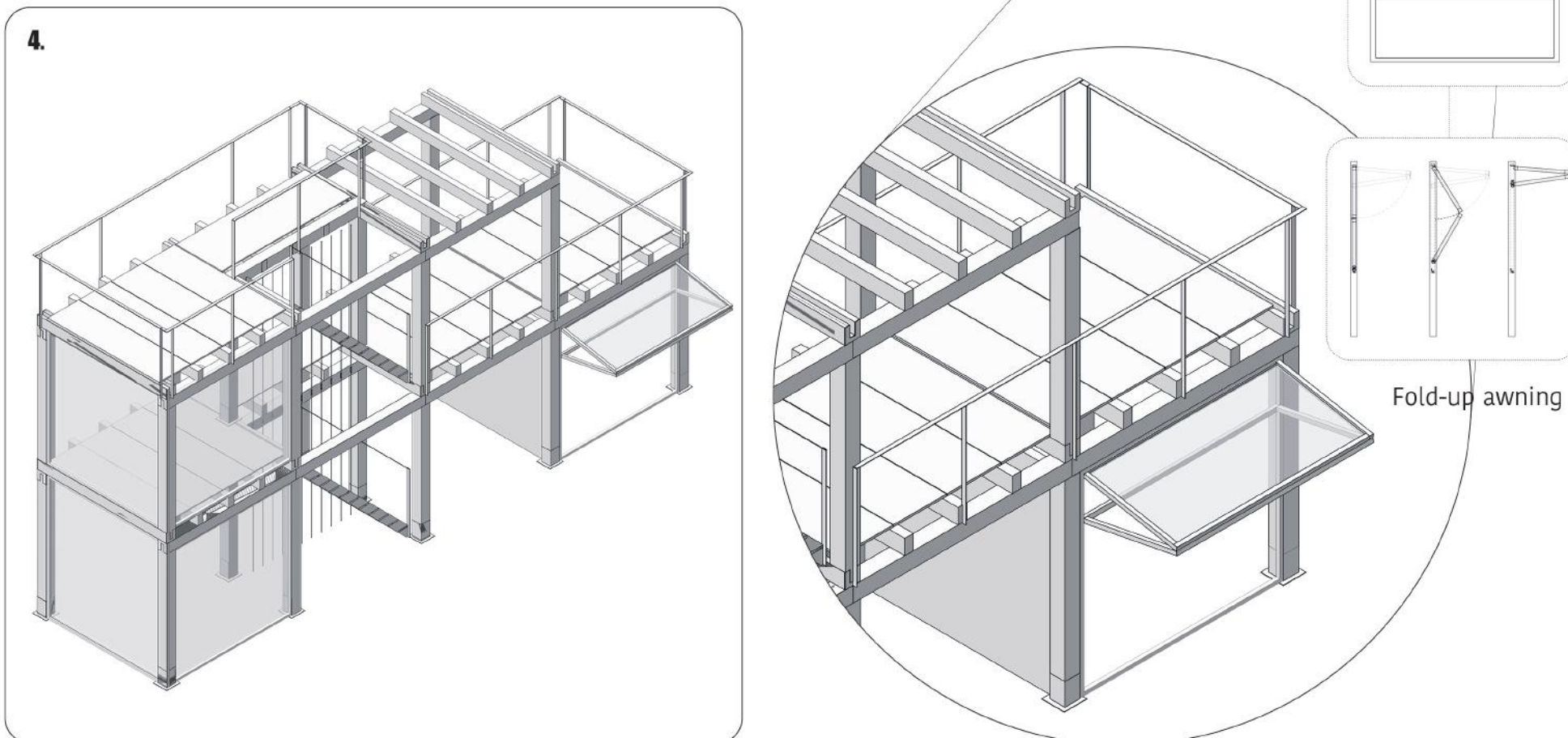
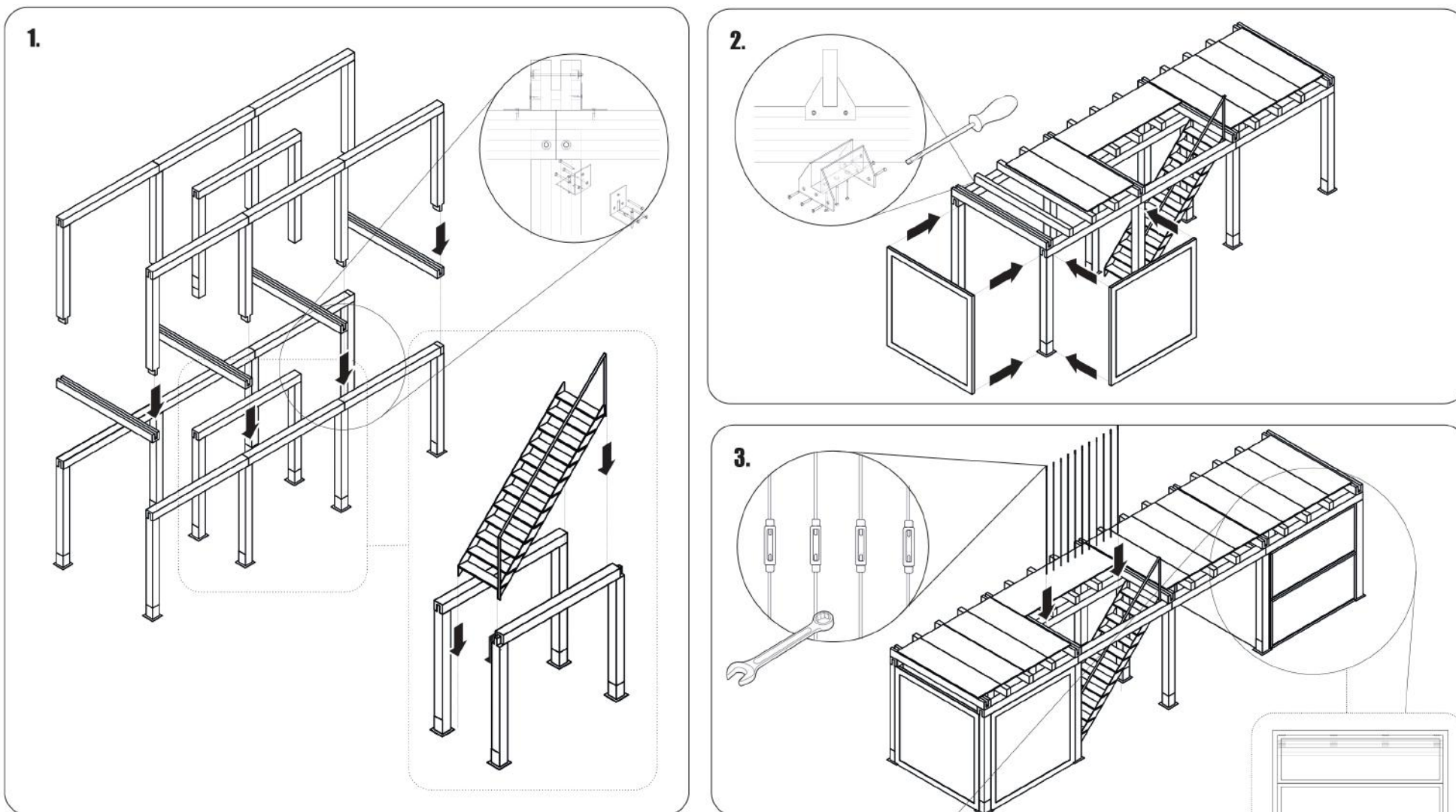
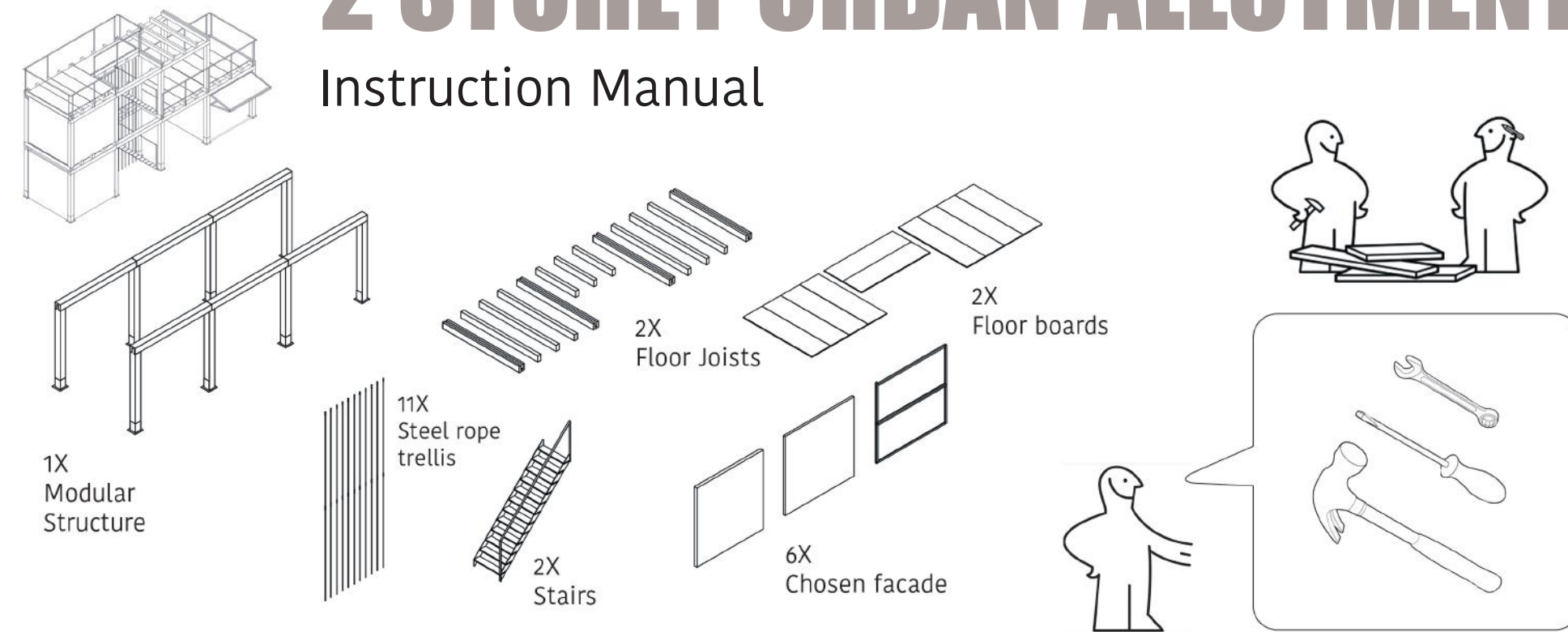

Inside the greenhouse, polycarbonate facade



First floor, pergola and stairwell trellis



Market stall, displaying fold-up awning facade

