



SAFE
 PRIVACY
 ENCLOSURE
 ALIVE
 SECURE
 COMFORTABLE

WATERLOO STATION

Waterloo Station is a **transitional space**, however many people work at the station, with others using it as a **meeting place, shelter** from the **weather** or **semi-public space to linger between appointments**.

Brutally honest through its industrial structural mastery and its paired back aesthetics stands Waterloo Station. The immense space provokes a skeleton state through its architectural constructive details. This is heavily shown with the geometric language of structural steel beams used for the framework of Waterloo Station. Consequently, creating harsh angular forms, bold technical structures and notions of rhythm through repetitiveness. The harsh contrasting materiality not only forms a bold design statement, but heightens a spatial emotional impact through the characteristics of the components.

THOUGHTS

- How is it best to support someone in distress?
- How do you make people feel safe?
- Ground floor active open/ 1st floor calm/private?
- How can I explore construction methods, materials and design solutions which promote a sustainable agenda without compromising aesthetics?
- How can human led, joyous, exciting design guide us to a sustainable future?

FRAGMENTED BONDS

OFFICE FOR THE WATERLOO BASED TEAM OF POLICE OFFICERS

DIVERSITY, EQUALITY AND INCLUSION

- How can I raise awareness there is a place to seek help from at Waterloo Station?
- What is the next big idea after recycling for my design?
- Notions of privacy for the public

REQUIREMENTS

- A space to report an incident
A commuter in distress is in a state of panic. It is crucial that the space and method to report an incident is clear, fast and straightforward.
- Distribute information
Breaking away from the usual and conventional leaflets. A new, engaging and interactive format needs to be explored - Creating a buzz for our safety.
- Kitchenette/WC
Private and discreet
- Briefing room// computers
Vibrancy and fluid motion. Creating a space to communicate in an active upbeat way than a standard desk and chairs.
- A space to disconnect
A high pressure job requires a space where officers can breath and recollect themselves
- Medical area for an injured person
It is crucial that this area is easily accessible in an emergency situation.
Openness// Visibility// Access

PROJECT BRIEF

The **issue of mistrust** between the Met and public results that The British Transport Police can be met with **hostility** as well. Therefore, one of the priorities today is to **rebuild that trust** within communities. This can be achieved by raising standards of working ways and culture, as well as **creating environments** where a concerned member of the public would be **confident** to enter and raise any concerns.

What is currently a busy Costa Coffee shop, will be transformed into a **workplace station** for The British Transport Police at Waterloo Station. The project aims to create a space that feels **positive, engaging and reassuring in a new dynamic approach**.

HOW CAN THE POLICE
 BEST SERVE THE
 COMMUNITY?

HOW CAN DESIGN HELP
 PROMOTE SOCIAL JUSTICE
 AND EQUITY FOR ALL?

WATERLOO STATION FOR THE TRANSPORT POLICE

THE BRITISH TRANSPORT POLICE BASE

The facade consists of multiple elements where the British Transport Police has **full control to adapt and manipulate** to their needs. The lower level includes **functional openings** where surfaces change into areas for **seating, leaning and putting objects onto**. This allows various areas for the British Transport Police to **communicate to members of the public in a semi-private casual environment**.

On the upper level, openings are positioned to allow **levels of light to be exposed within the interior, as well as creating intimate spaces**. As a result, the ambience of the interior is ever changing and is never constant. The inclusivity of the design through its multi-functional facade and interior blurs the boundary between the police and the public.



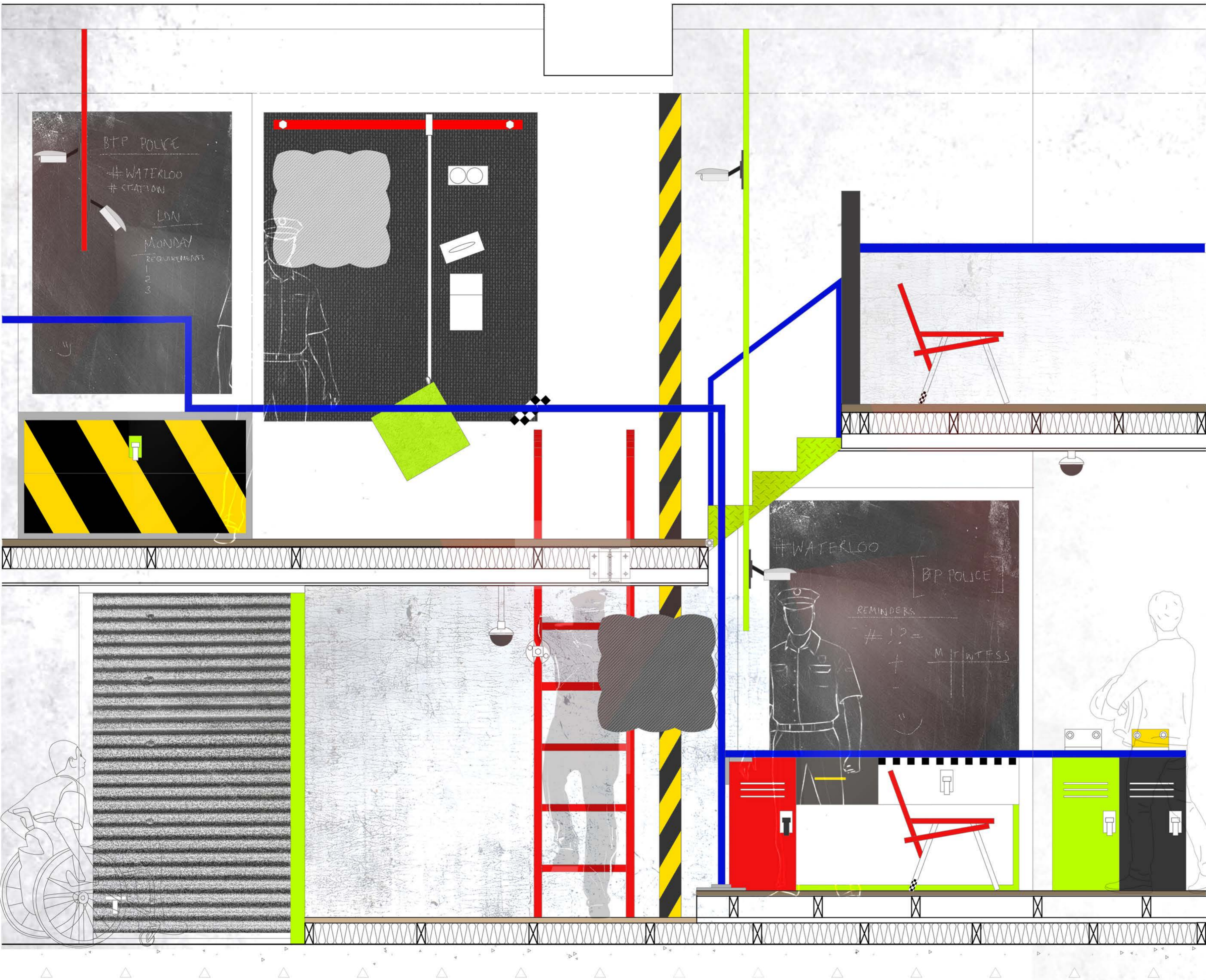

FRAGMENTED BONDS
 The broken forms is constructed together by exposed fastenings. The constructive detail bonding pieces together expresses the re-established relationship between the public and the Police force.

DECONSTRUCTION OF THE POLICE UNIFORM
 The colour palette is a reflection of the British Transport Police uniform. The design becomes an extension of the police and is a safe space for the public to immerse into.

DYNAMIC WORKING ENVIRONMENTS
 An interactive working area is situated on the ground floor. This is where the public and the Police force are in constant interaction. The working surface area then folds vertically an extends onto the first floor. The private working area deals with sensitive confidential incidents reported by the public.

ALTERNATIVE ROUTES
 To navigate through the two different working areas a ladder is positioned for The British Transport Police. This encourages the choice of how they wish to navigate throughout the space.

VELCRO WALL
 Inspiration of the uniform materiality and functioning has been translated into design. This has been achieved through Velcro panels where objects have been adhered onto for different purposes of usage.

Also, the velcro symbolically represents the public and the police. The idea of the hooks of the velcro surface only working with the loops acts as a bond, and shows the need of both in order to work together.

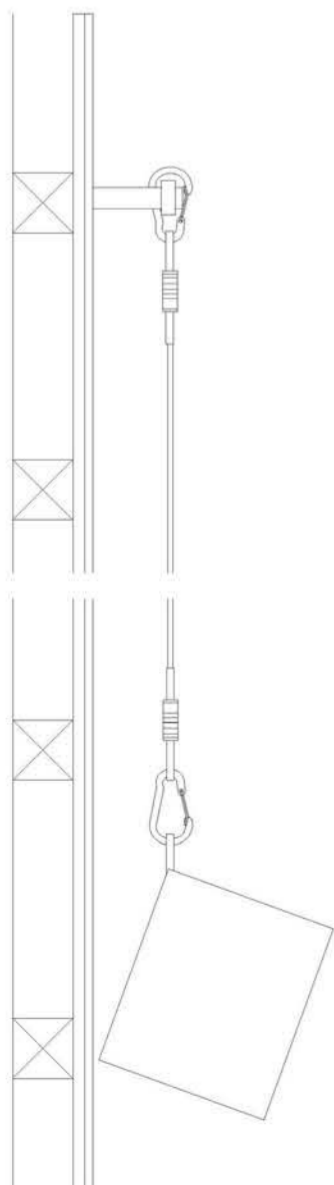
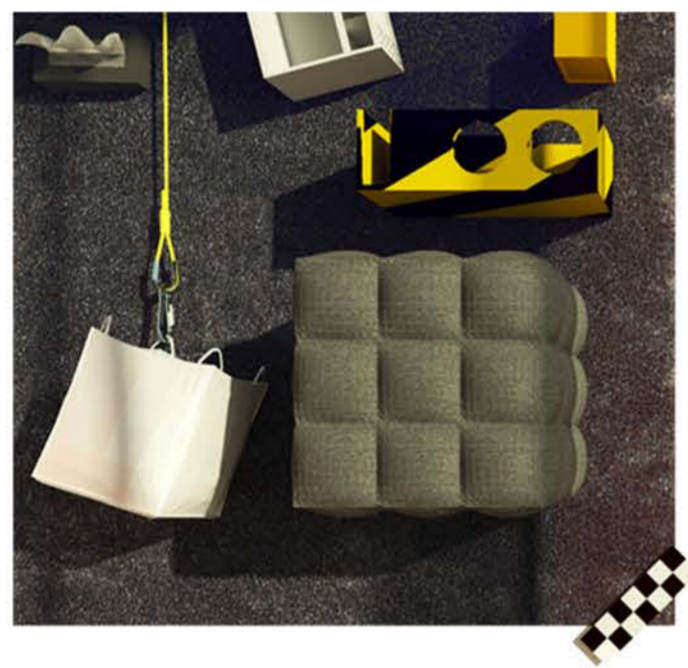
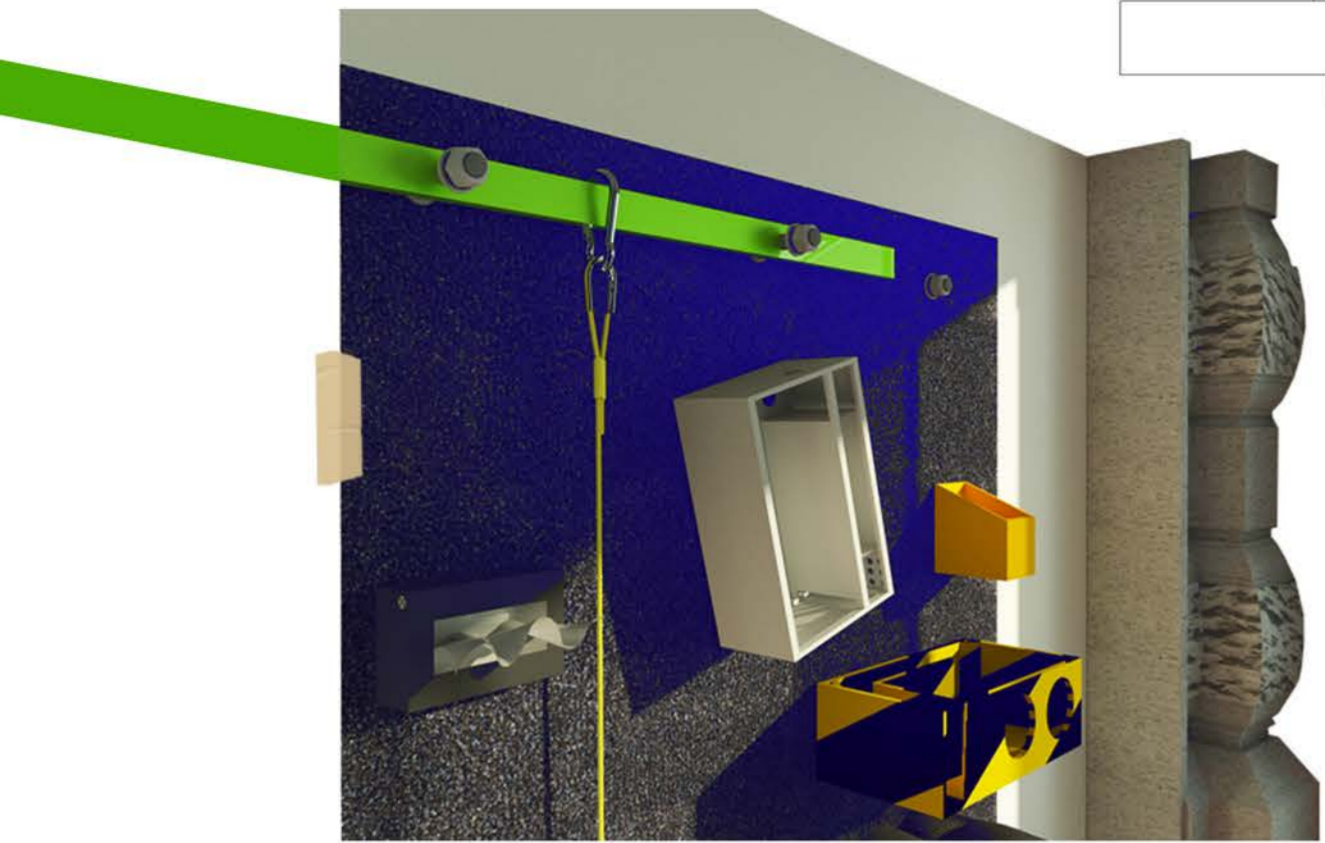

A RELATIONSHIP BETWEEN THE PUBLIC AND THE POLICE

RE-ESTABLISH

The casualness and freedom of expression in the Police office aims to recognise the levels of public concern and the need to regain trust of the public.





Due the **awkward dimensions** of the interior structure a **new wall** has been constructed to **remove the angular forms** from pillars. A **wall alcove** has been inserted and made into **moments of purpose**. As the user navigates three steps up a **semi-private space awaits**. This consists of **two foldable chairs** and a space to **charge phones**. **City details of traffic lights** has been used as an indicator when the phone is charged in the charging portal.

Along the staircase **lime green steps** are used as an indication of a moment of pause. The change in materiality signifies a seating surface where users can sit, decompress and communicate with the police officer.

Further along the staircase a **velcro wall** is constructed where The British Transport Police can secure **stationary** such as note pads, pens and other practical items.

AWKWARD SPACES
TURNED INTO
PRACTICAL MOMENTS

The project was created with the vision of **re-establishing a relationship between the public and The British Transport Police**. The **informal atmosphere** was achieved by **breaking away from the usual and conventional ways of a 'typical' police office**. This is shown through a **deconstruction of the police uniform**. The hard shell (exterior) evokes the **strength** of The British Transport Police, whilst the interior exposes the **human softness and emotional support**. The final result of the space is achieved through colour, materiality and functionality where "compassionate, courageous, professional and always acting with integrity" **police officers can serve the community**.

TRUST & SOCIAL JUSTICE FOR ALL