

# THE BEE HIVE

When placed on a dark background, there is a bigger contrast, making the model stand out. Working in low light allowed for experimentation with different placements of the lighting source and seeing where the shadows fall, giving an idea of how the pavilion would look in reality.

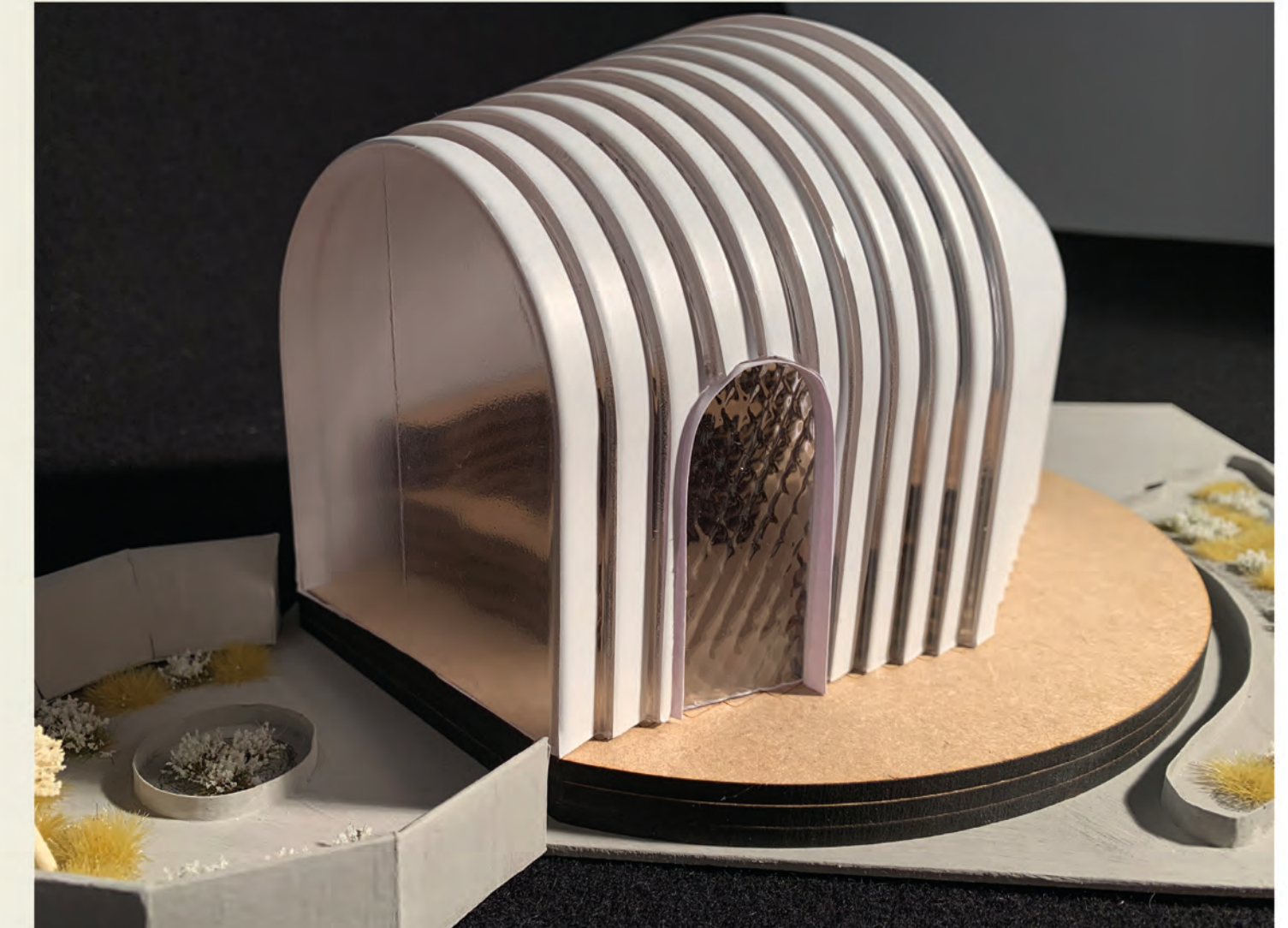

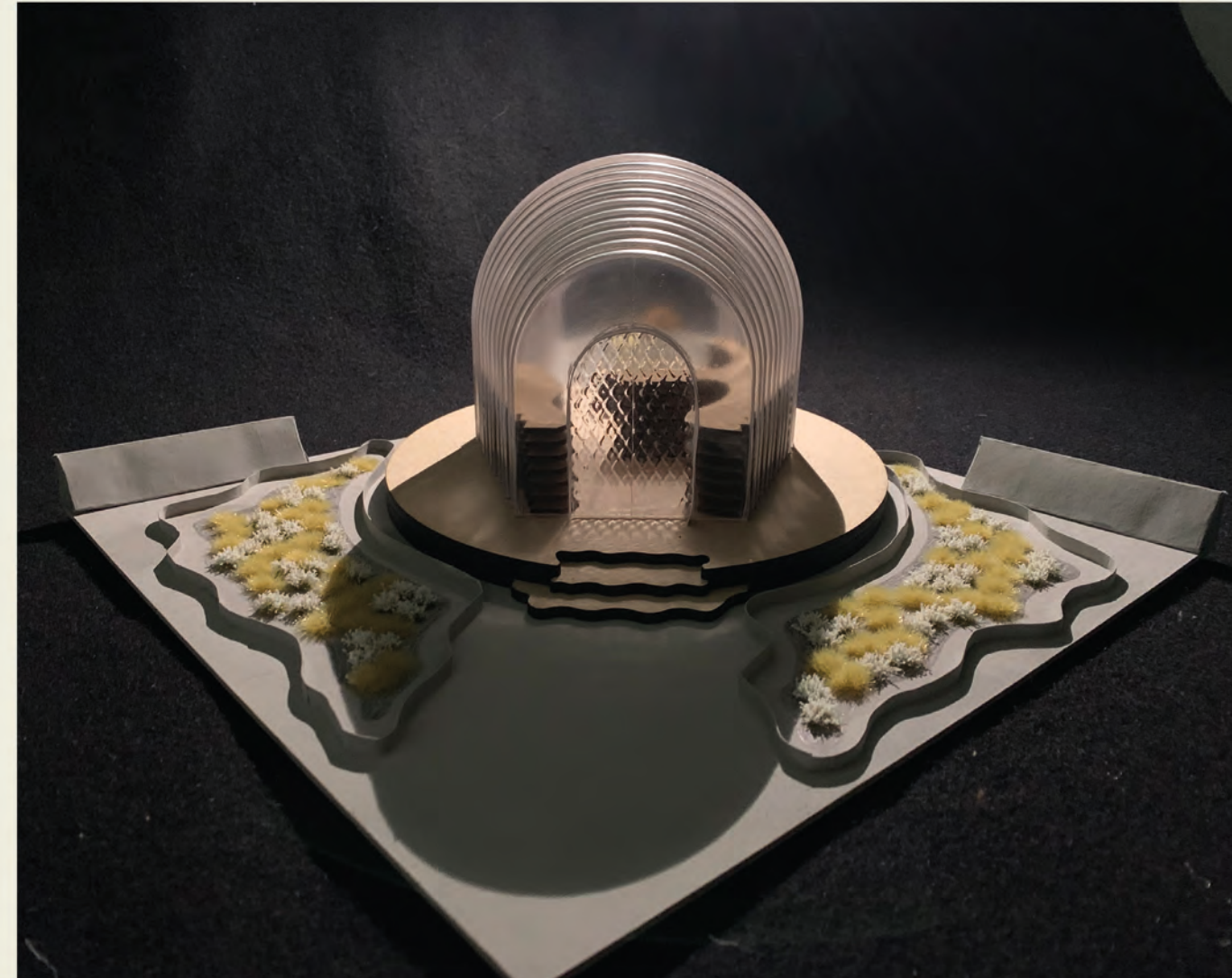
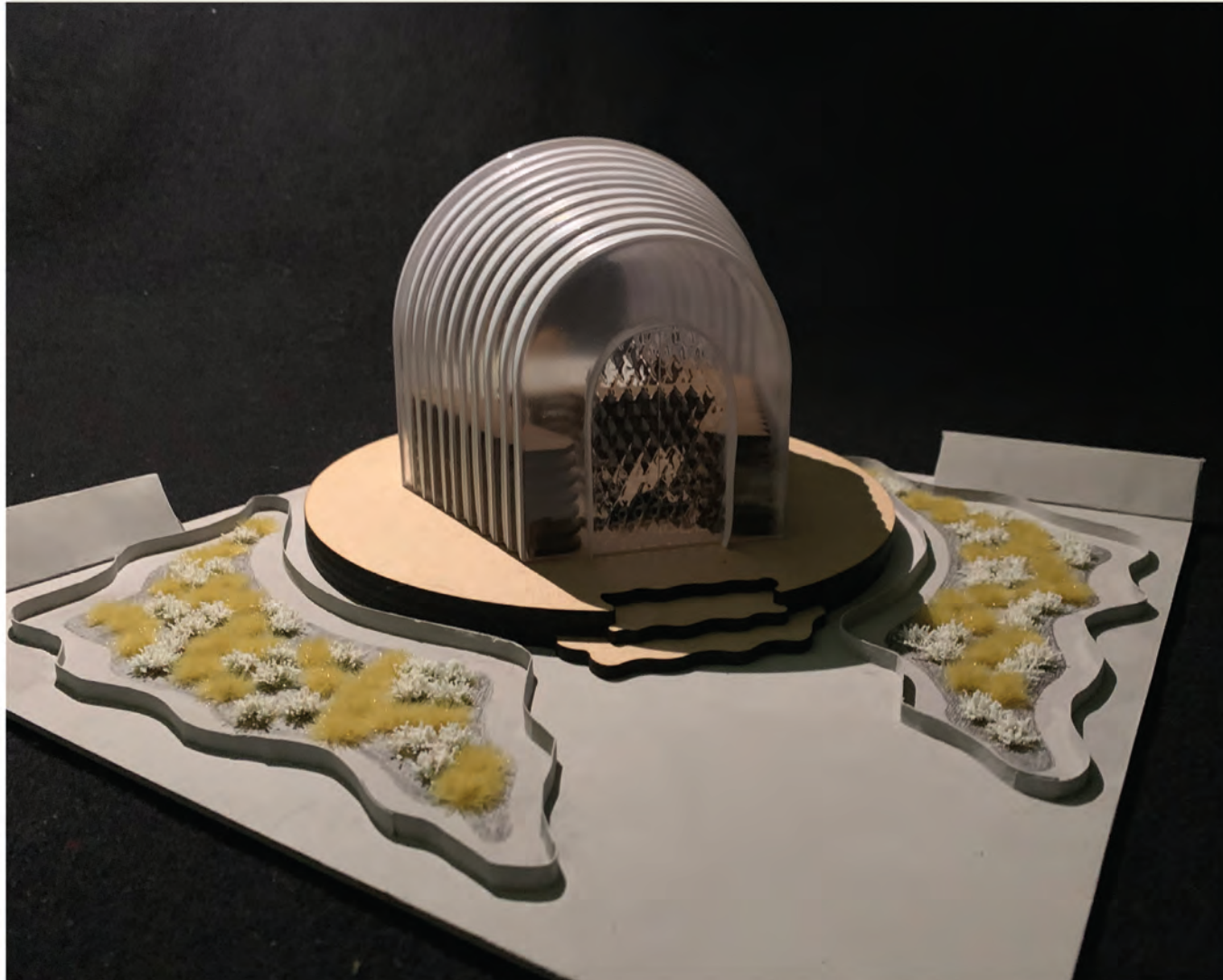
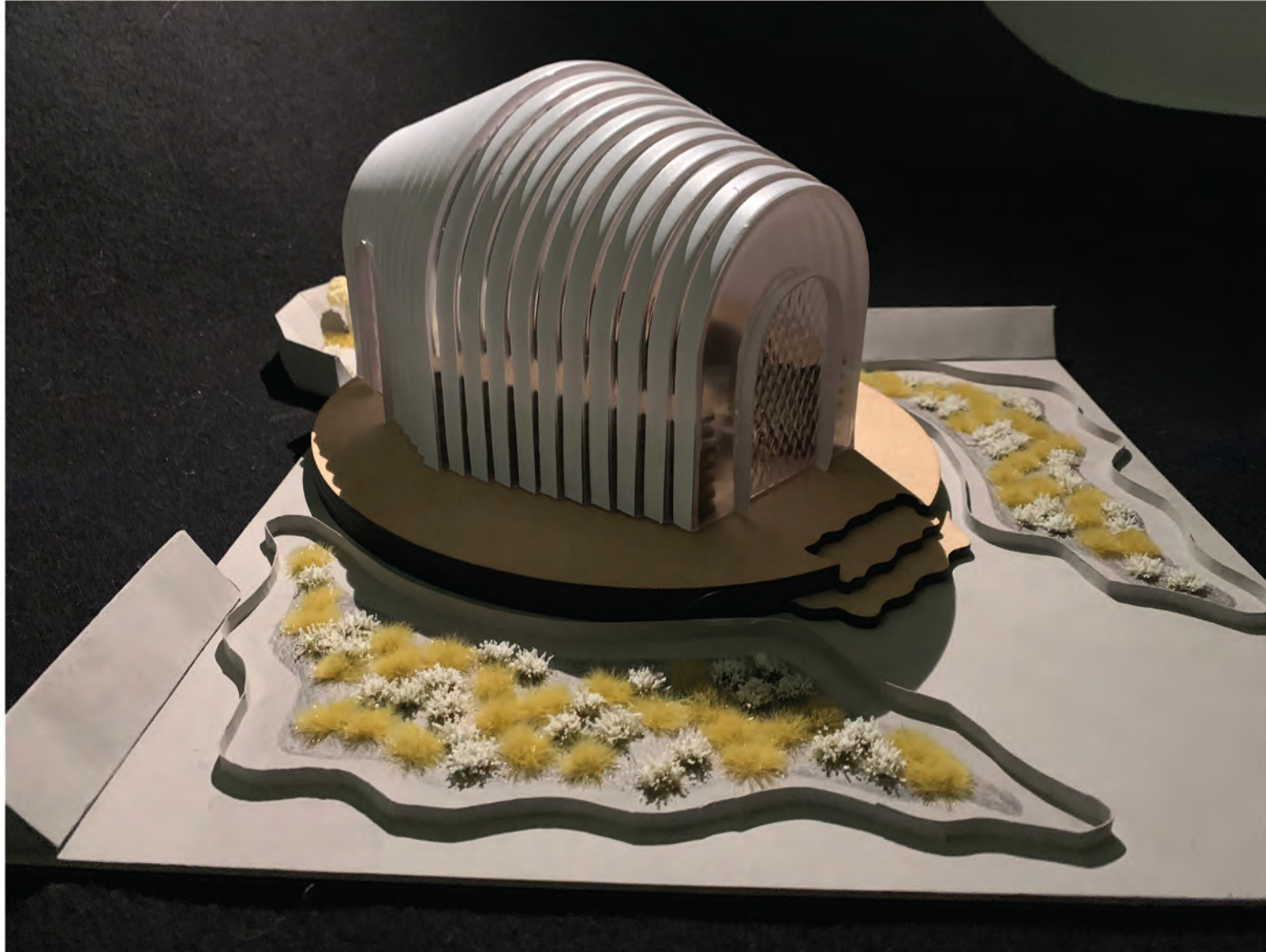

# THE BEE HIVE



## THE BEE GARDEN

Located at the rear of the pavilion, its purpose is to draw in bees from around the area of Sovereign House, allowing them to be observed from inside the pavilion. The garden includes bee friendly flowers like daffodils, shaded areas and bee hotels. As well as this, there are two small trees to encourage the bees to make their hives in the branches, which is something they do in nature. It is inassessable to the public, so they do not disturb the bees.



## THE OBSERVATION AREA

In the rear of the pavilion, the entire back wall is glazed, allowing customers to look out onto the bee garden while they shop, additionally they can also sit on the provided bench and watch them from there. The front wall of the pavilion is also glazed but this glass is meant to mimic a bee's vision. When looking into the pavilion customers will see its interior the way a bee would, drawing their attention. Since both the front and rear walls are glazed, customers will see through the entire pavilion and into the bee garden from outside of it.

## THE ROOF

This roof is also the pavilion's walls, windows and doors, allowing it to serve many functions at once. The structure is quite covered to mimic the amount of cover in a natural bee hive. There are strips of glass between the differing heights of the arches, allowing light to enter at interesting angles. Its shape is directly inspired by the shape of a beehive



## THE DOORS

The doors are glazed and are textured in a way that mimics that pattern of a honeycomb or possibly the texture of a bee's wing. Both doors open outwards to maximise space inside the pavilion. They are also automatic, allowing the customers to enter the retail space with ease. They are both arched in order to maintain the soft curves present in the entire pavilion.

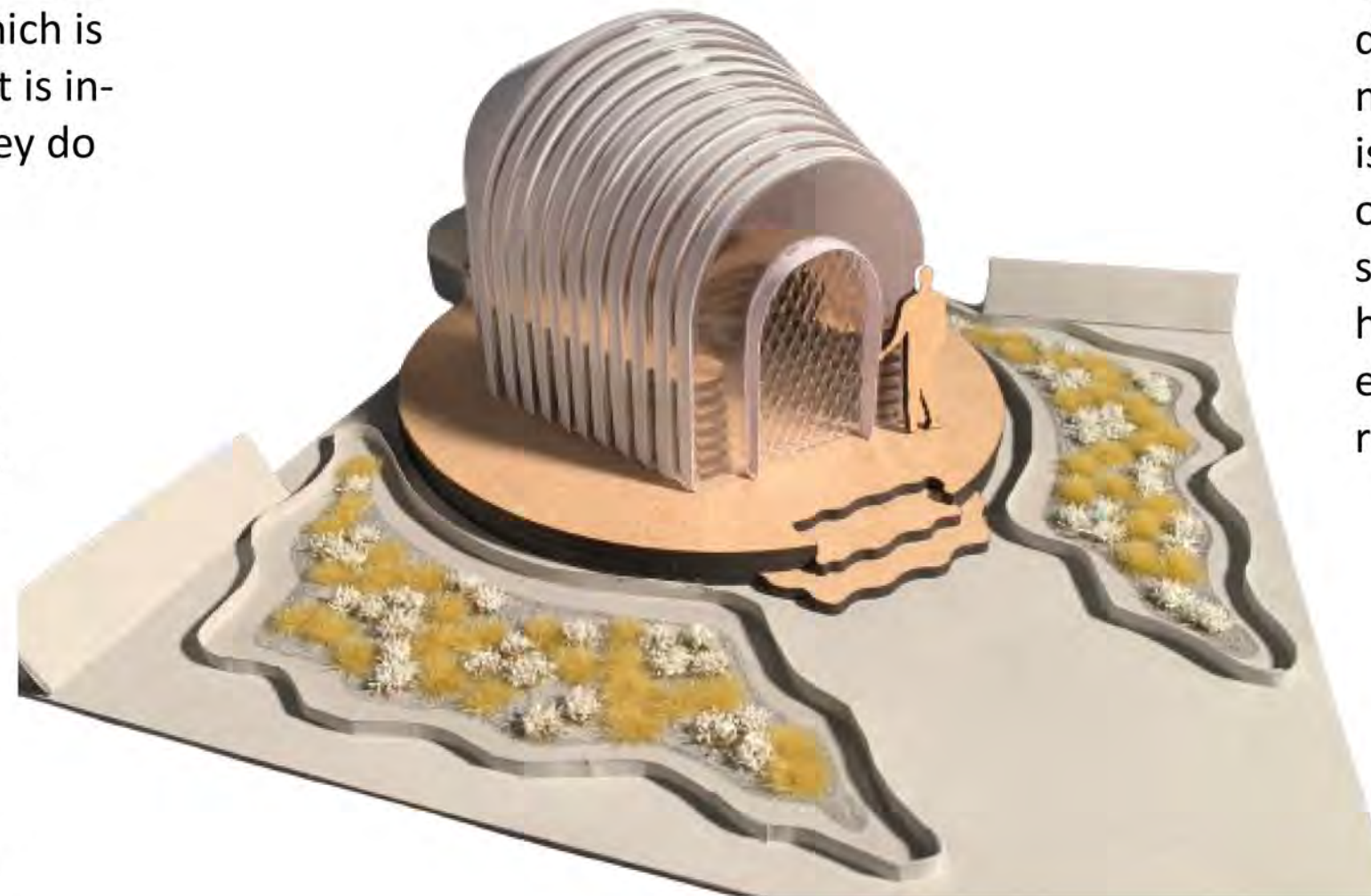

## THE INTERIOR

The organic shapes of the counters was influenced by the softness and flow of honey. In addition to their regular height, the counters have a space for children as well as a seating area at the back to observe the bees from.



## THE PLANTERS

There is planters in the front of the pavilion in order to encourage the bees to bring their activity around the entire pavilion, once again referencing the way beeswax wraps wrap around objects. They would contain plants that are appropriate for bees in every season.



## THE PLATFORM

The pavilion is situated on a platform that envelops the building, relating to how the beeswax wraps envelop food. The steps into the pavilion are influenced by slices of honeycombs and would be lit up with warm white lighting to soften their appearance even more. The customers can walk around the building and can enter via the main entrance or the side entrance on the left.

