

# GLIMPSE OF THE FUTURE



There are countless global issues which the general public have been informed on for decades, yet we have made little significant progress to improve our future trajectory. Clearly hearing about global issues like climate change, wealth inequality and technological addiction is not enough to elicit meaningful change. Because seeing is believing I have designed three versions of a future narrative to show the audience a 'Glimpse of the Future' to visualise what could happen to our world.

Using a city street, a recognisable and universal location, each of the three future scenarios will follow our main character on his journey from waking up on a normal day, to him going and getting a morning coffee; the simple domesticity of the act capturing something that any audience member can imagine themselves doing, enhancing the relatability of the world building.

Designing these three future scenarios depicting two dystopias and a final utopia to show audiences what world they could be living in if we let the worst, or alternatively best, aspects of our society develop.

The goal of this project is to leave a lasting impression on the audience member, highlighting the urgency for the need to change, to challenge the current systems which have enabled our society to become what it is today, and make the right steps to building a better future for not only ourselves but the generations to come.

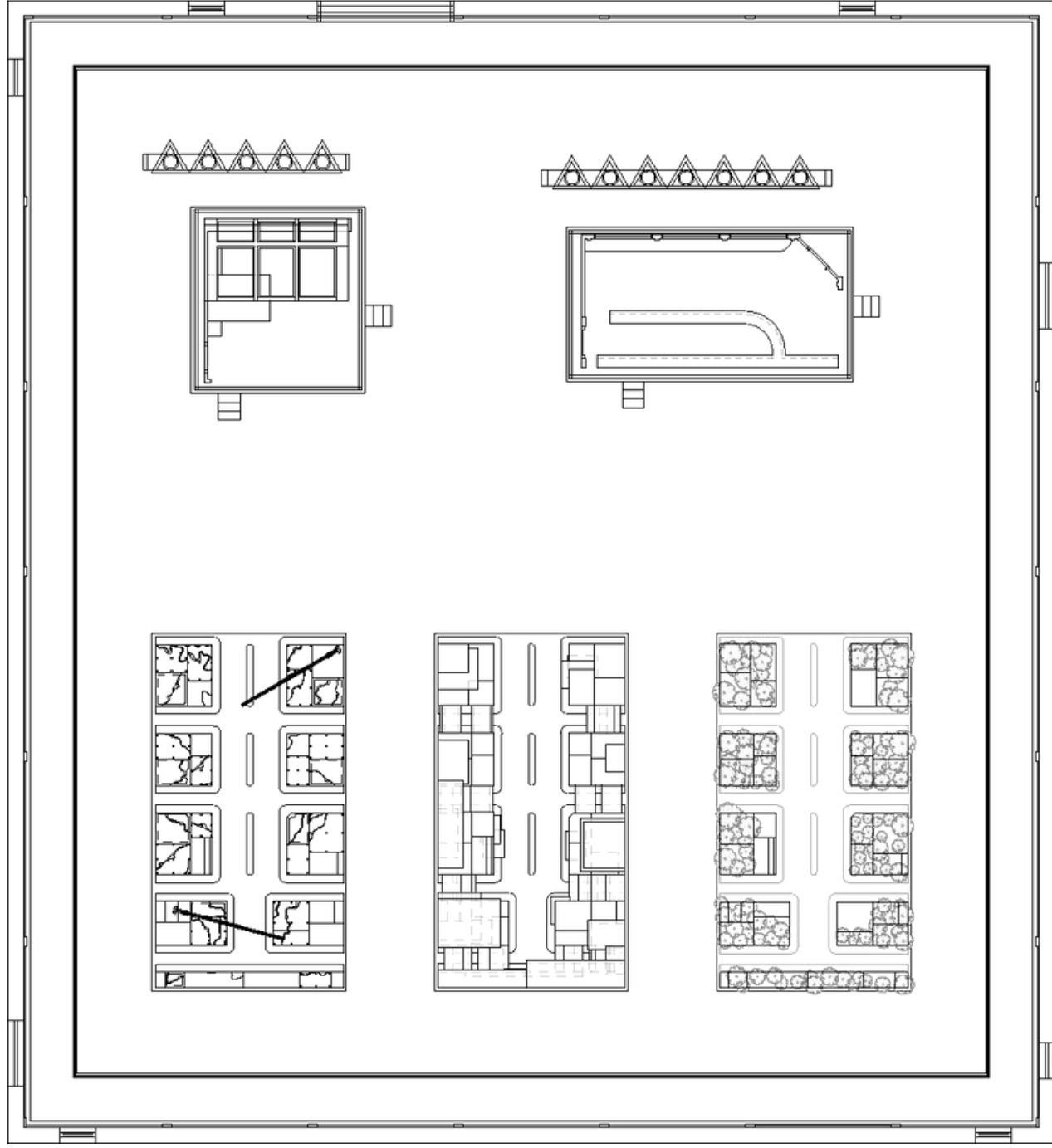
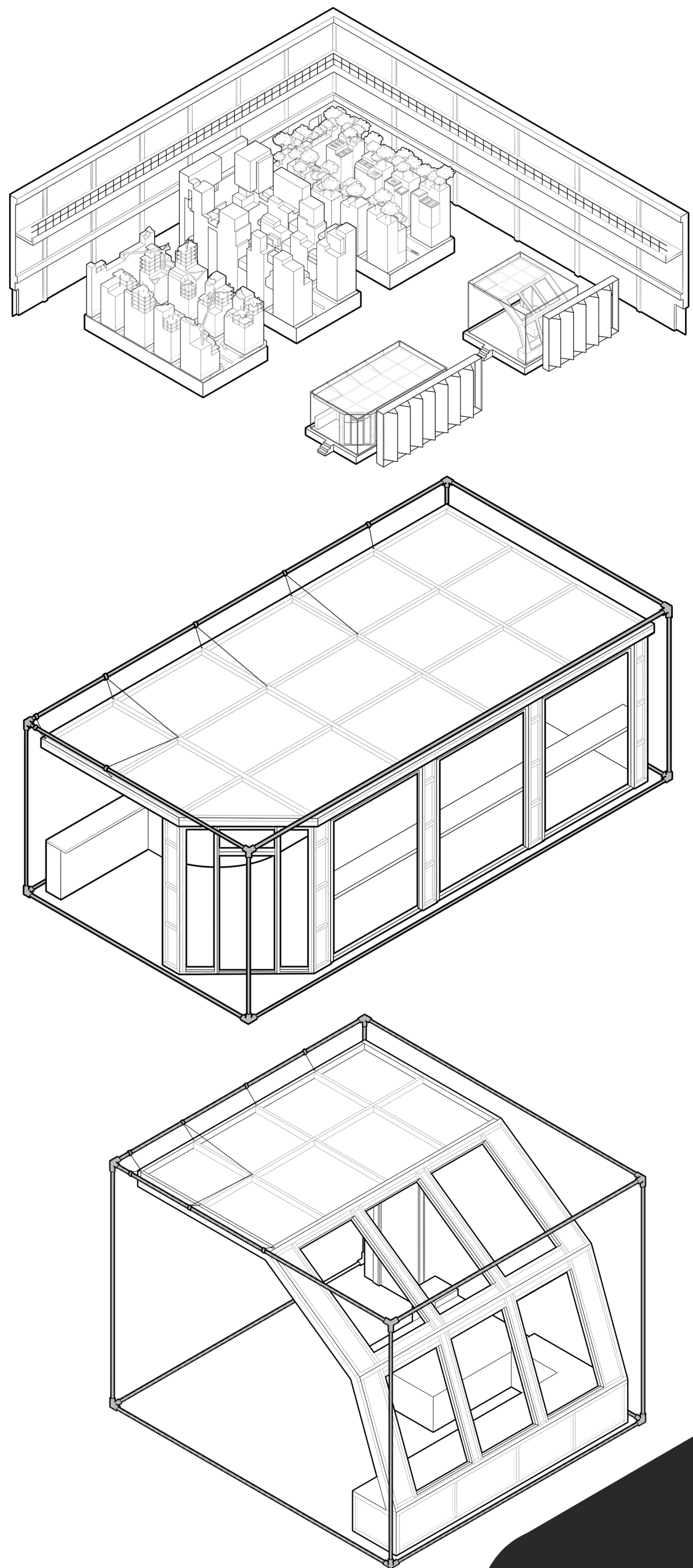

1:200

Scene one

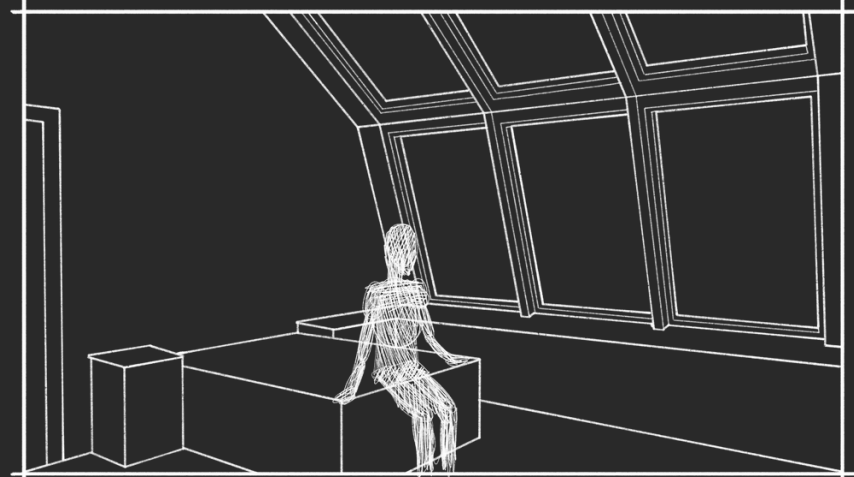

Scene two

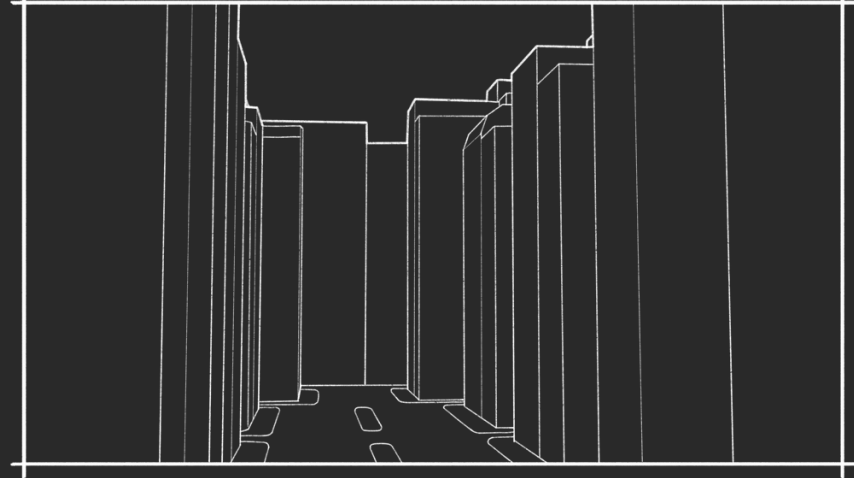

Scene three

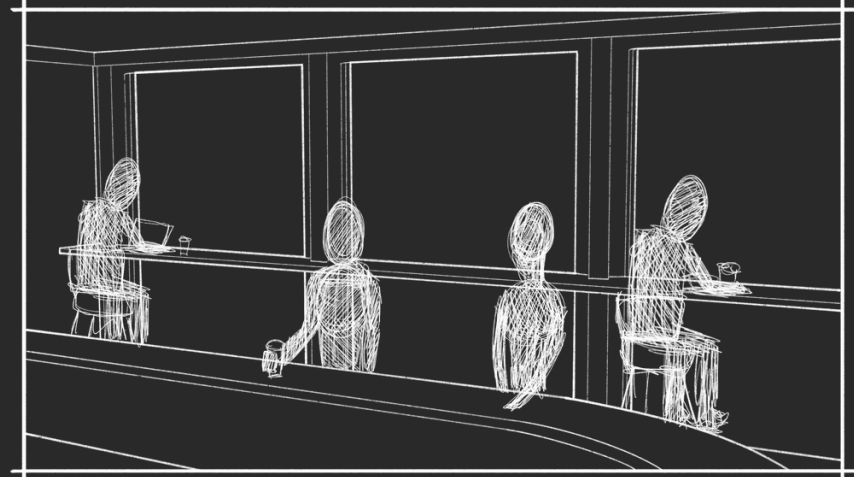



# ENVIRONMENTAL DESTRUCTION

Environmental Destruction – A future in which we have changed our environment to the point of inhabitability, no one is left to fix the problem and nothing can be done to reverse our mistakes.

Evidence of struggle can be seen within the environment, humanities desperate attempts to push their progress and growth to their bitter end.

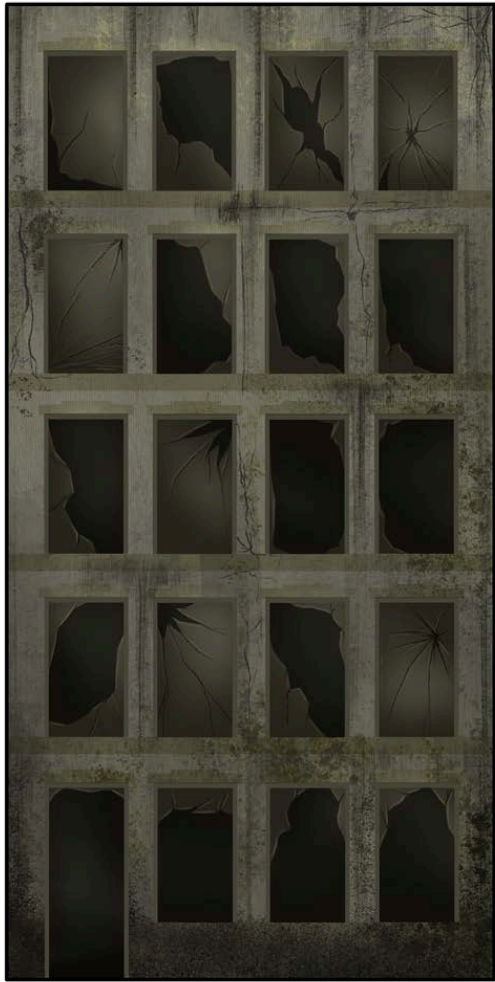

Set painting stencil

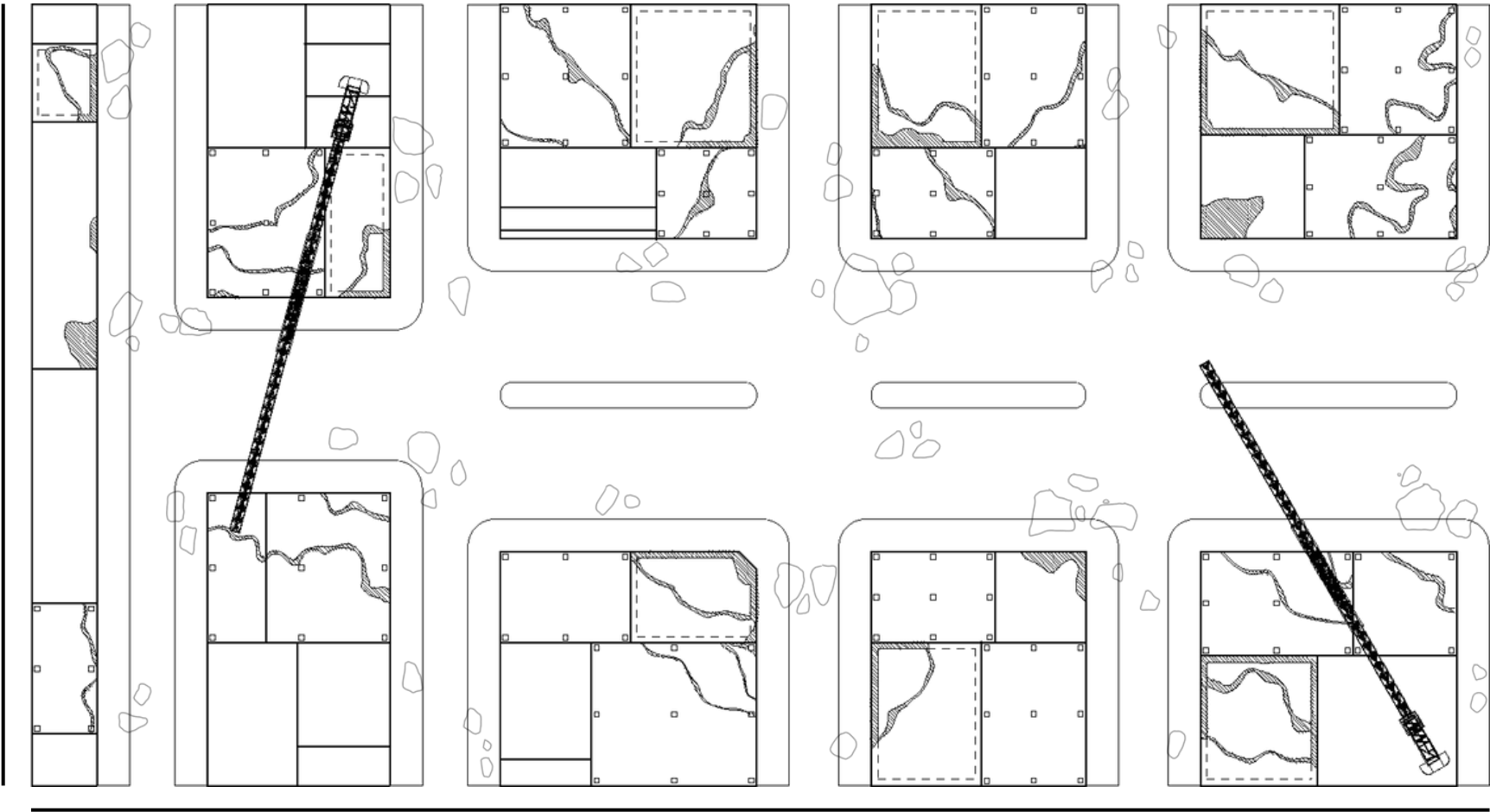

Drawings 1:20

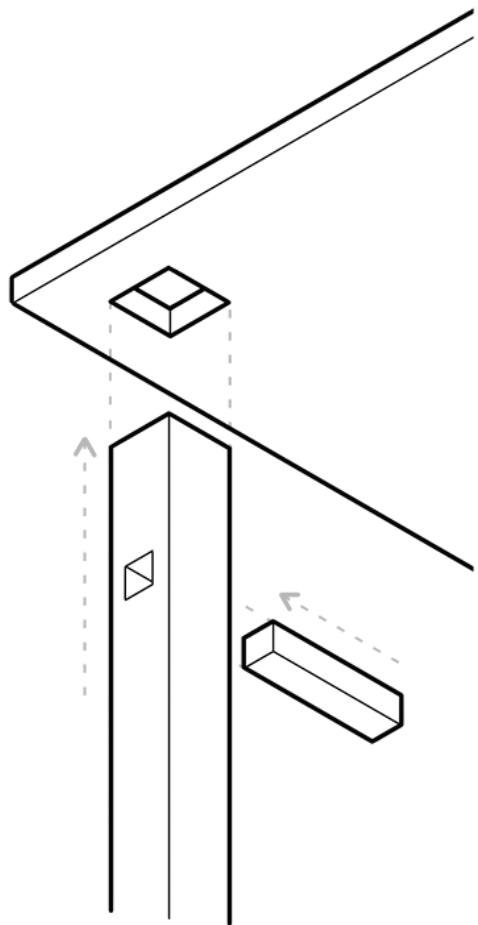
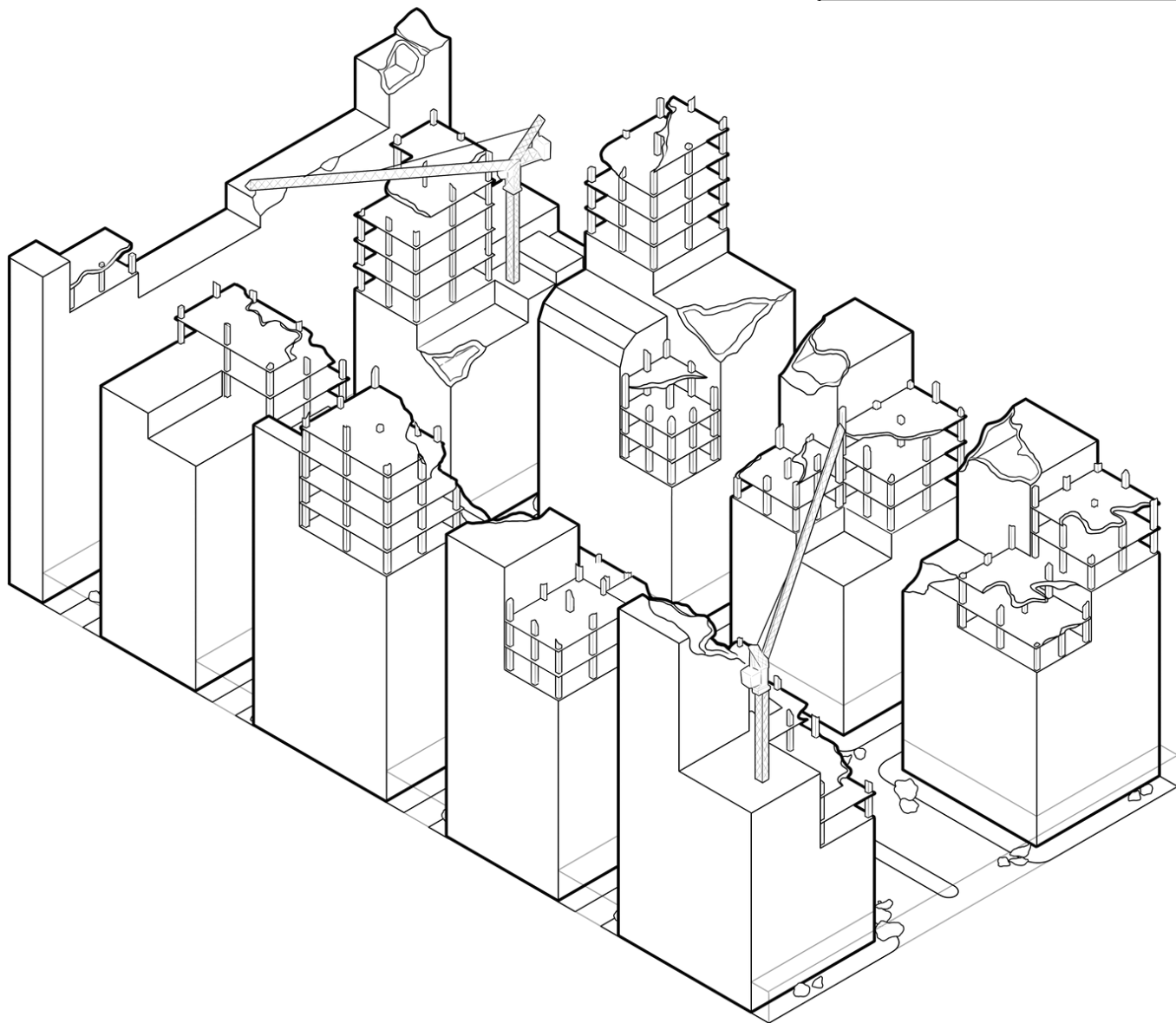
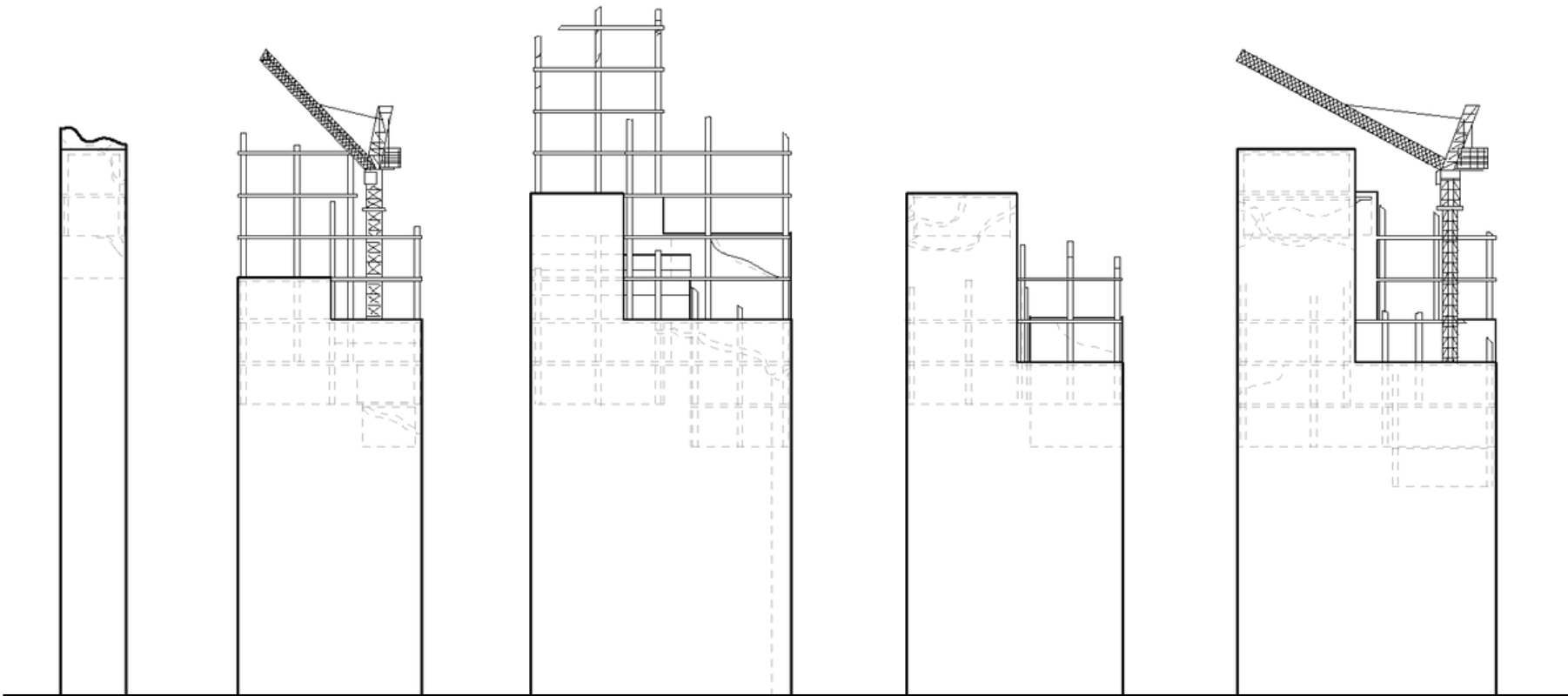

The raw constructed structures in this set use wooden Mortise and Tenon joins to hold the floors in place.





# TECHNOLOGICAL CONTROL

Technological Control – A future in which the gap between wealth classes has become gargantuan, autonomy and free will is stifled at every turn and the repercussions of corporate greed have exploited the working class to the brink of human capacity.

Structures tower over human scale, these man made monoliths becoming the very thing that snuffs out the hope of sunlight.



Set painting stencil

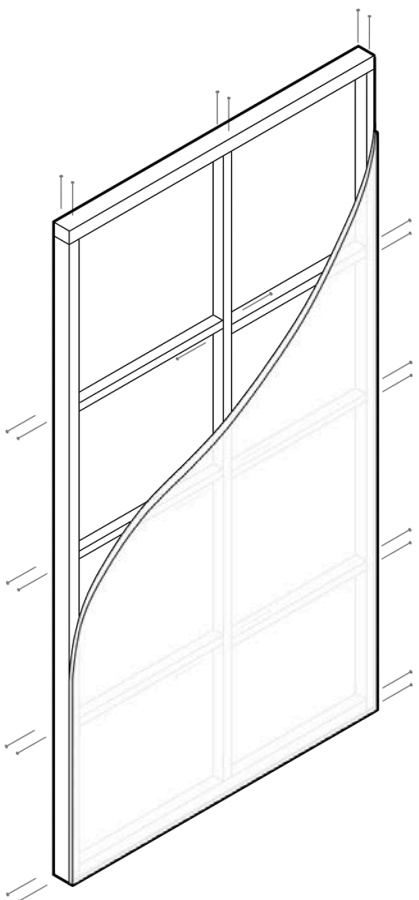
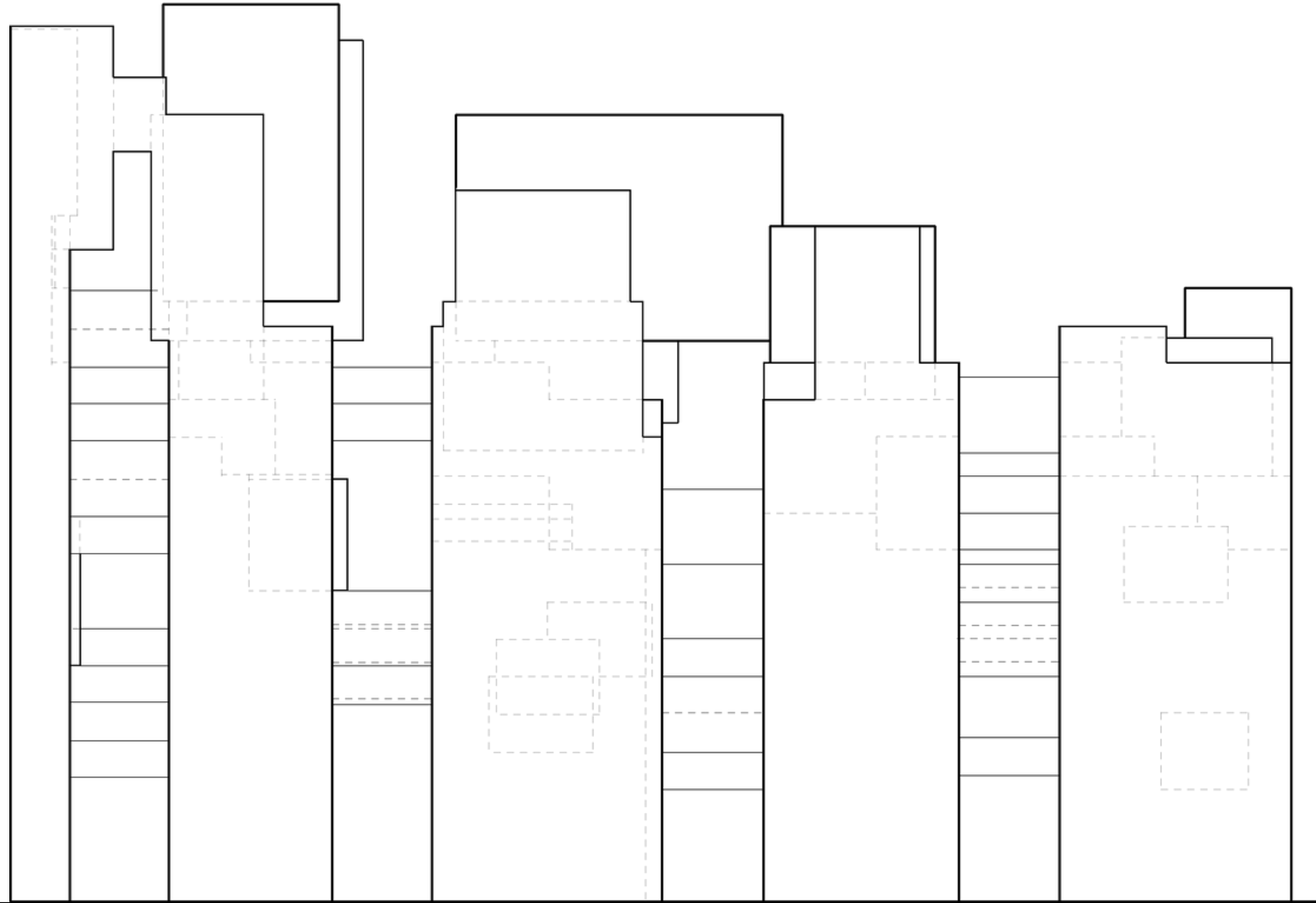
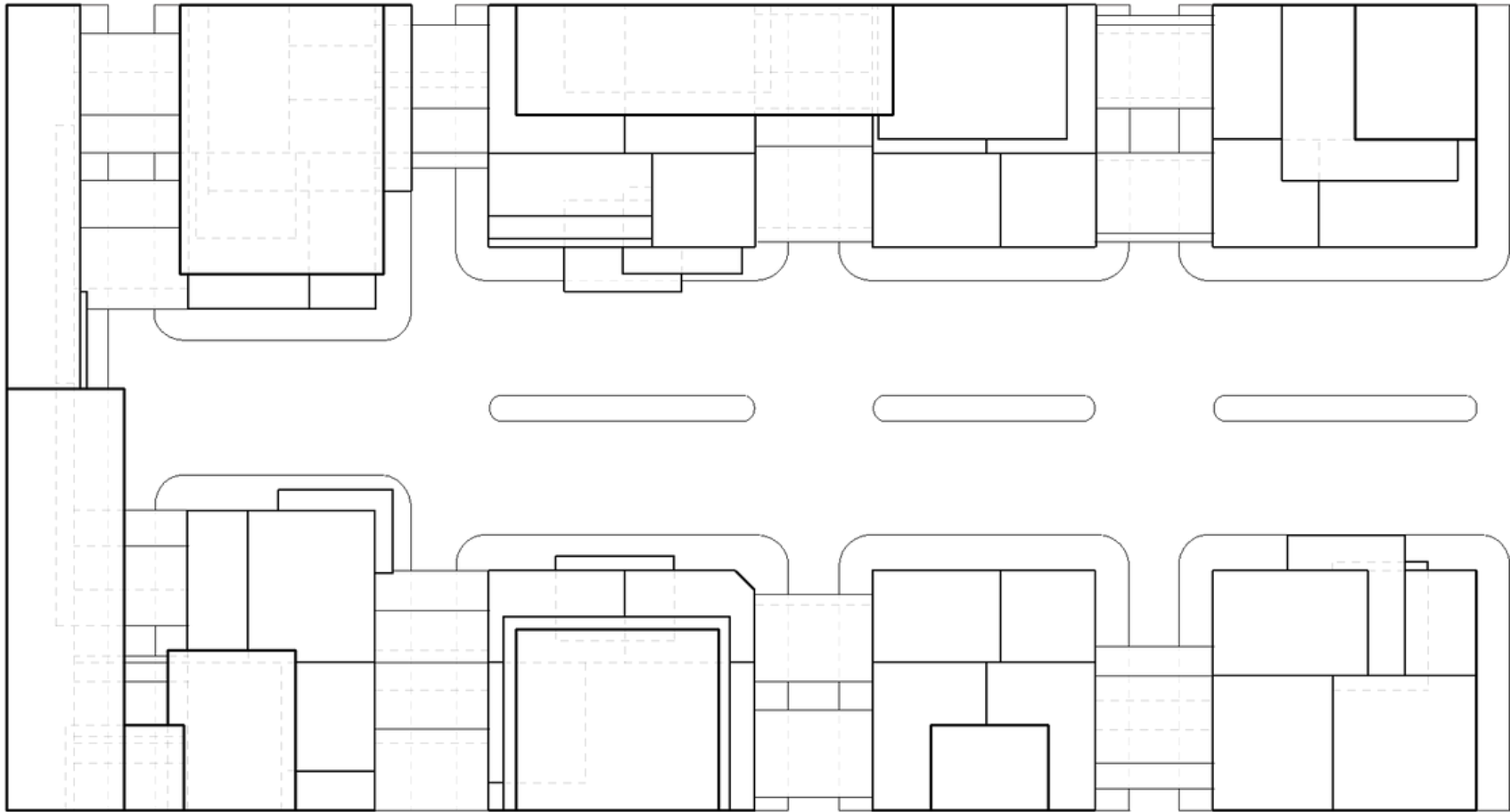
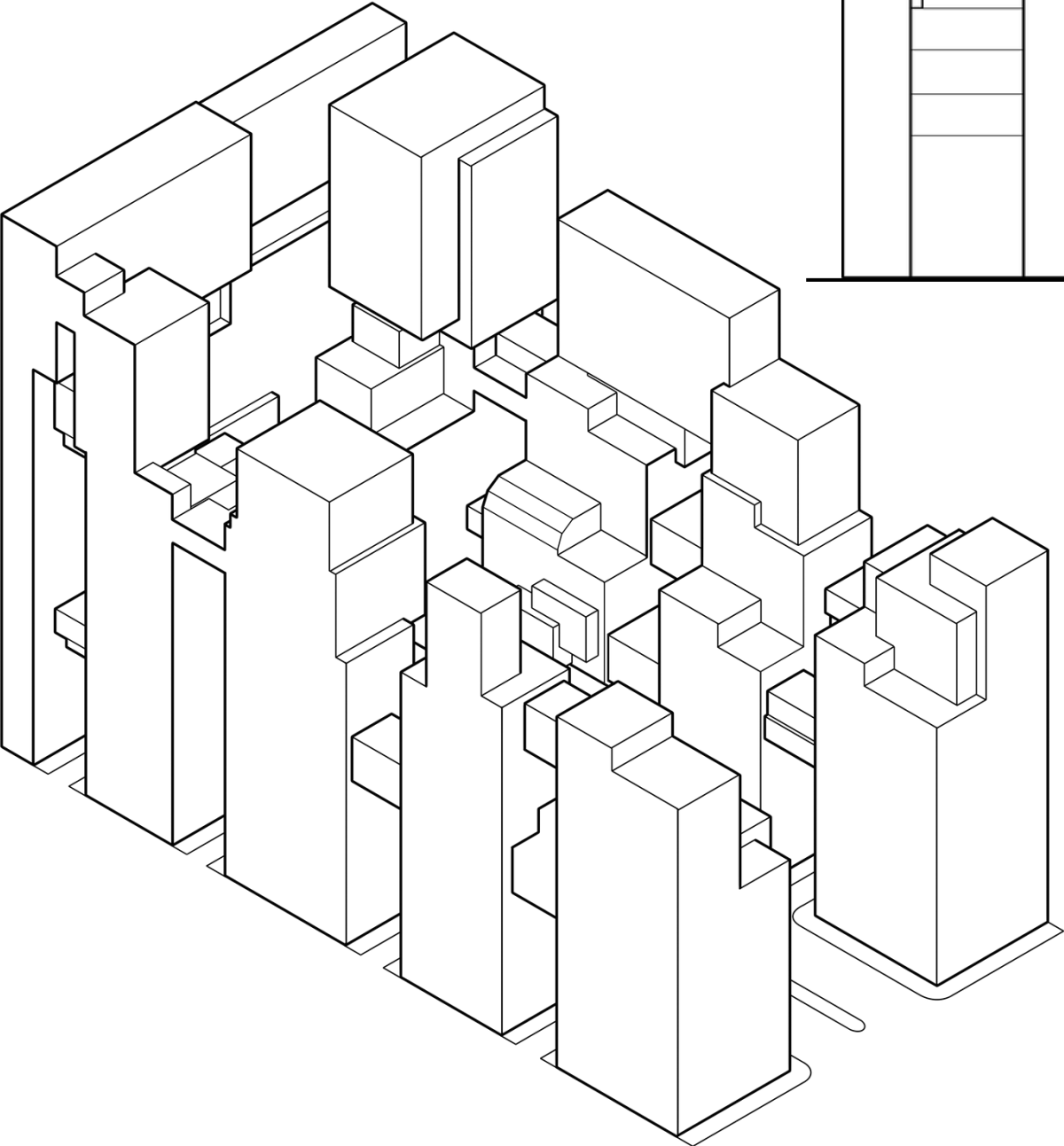

To construct my faux structures I have created a recycled timber frame which will be clad and then painted





# PROSPEROUS SURVIVAL

Prosperous Survival - A future in which we have found and maintained our harmony between technological advancements and the protection of our environment, allowing our society and our environment to thrive.

A utopia not far from our reach, all it requires is a change of direction.

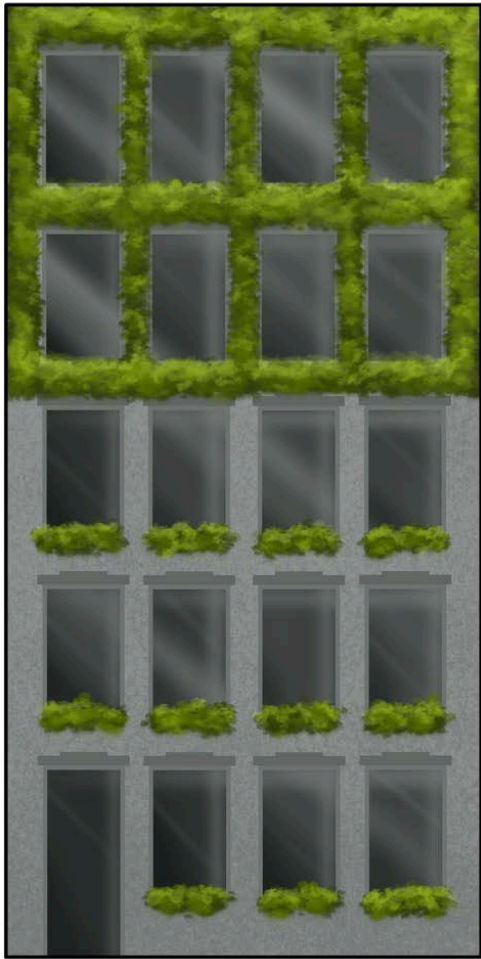

Set painting stencil

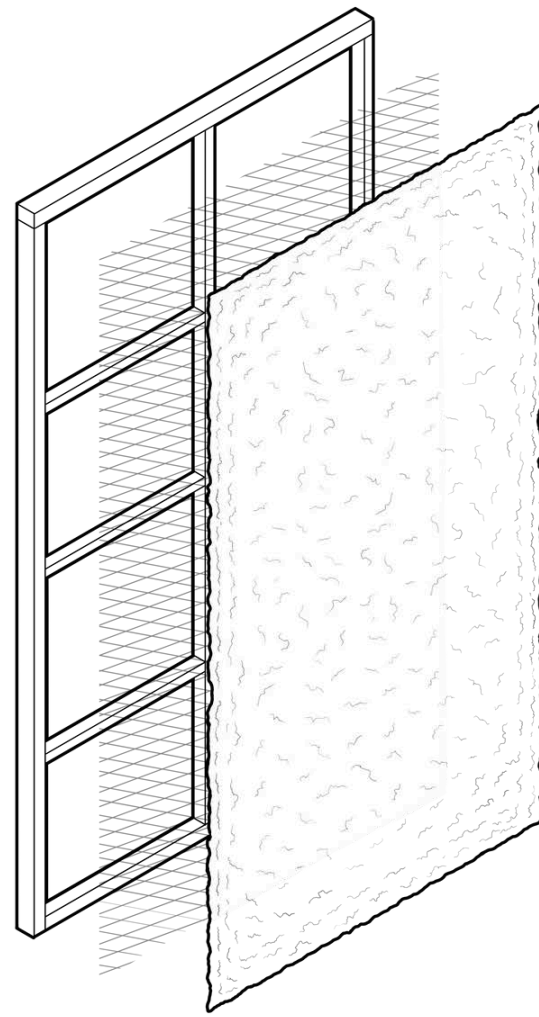
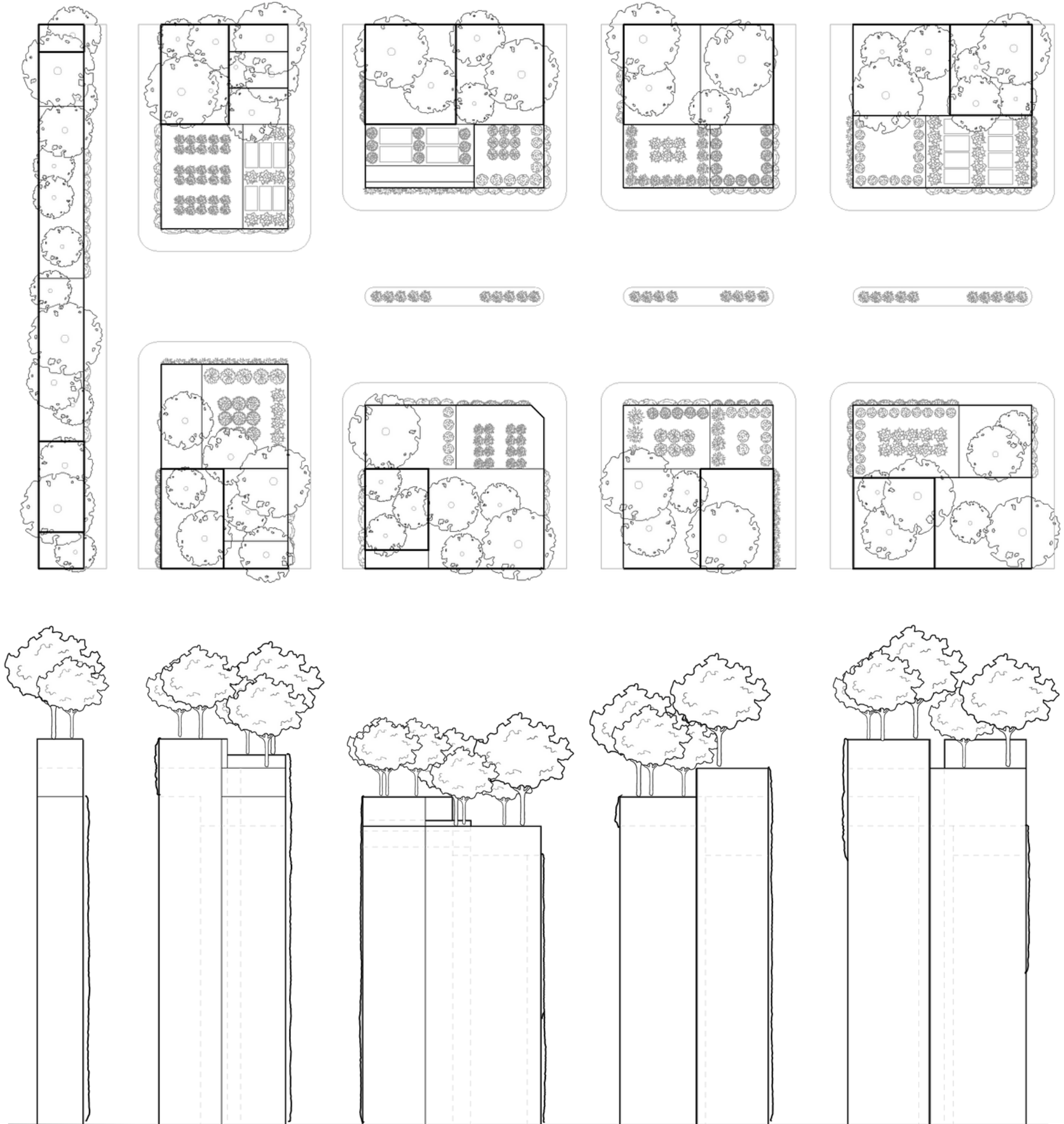
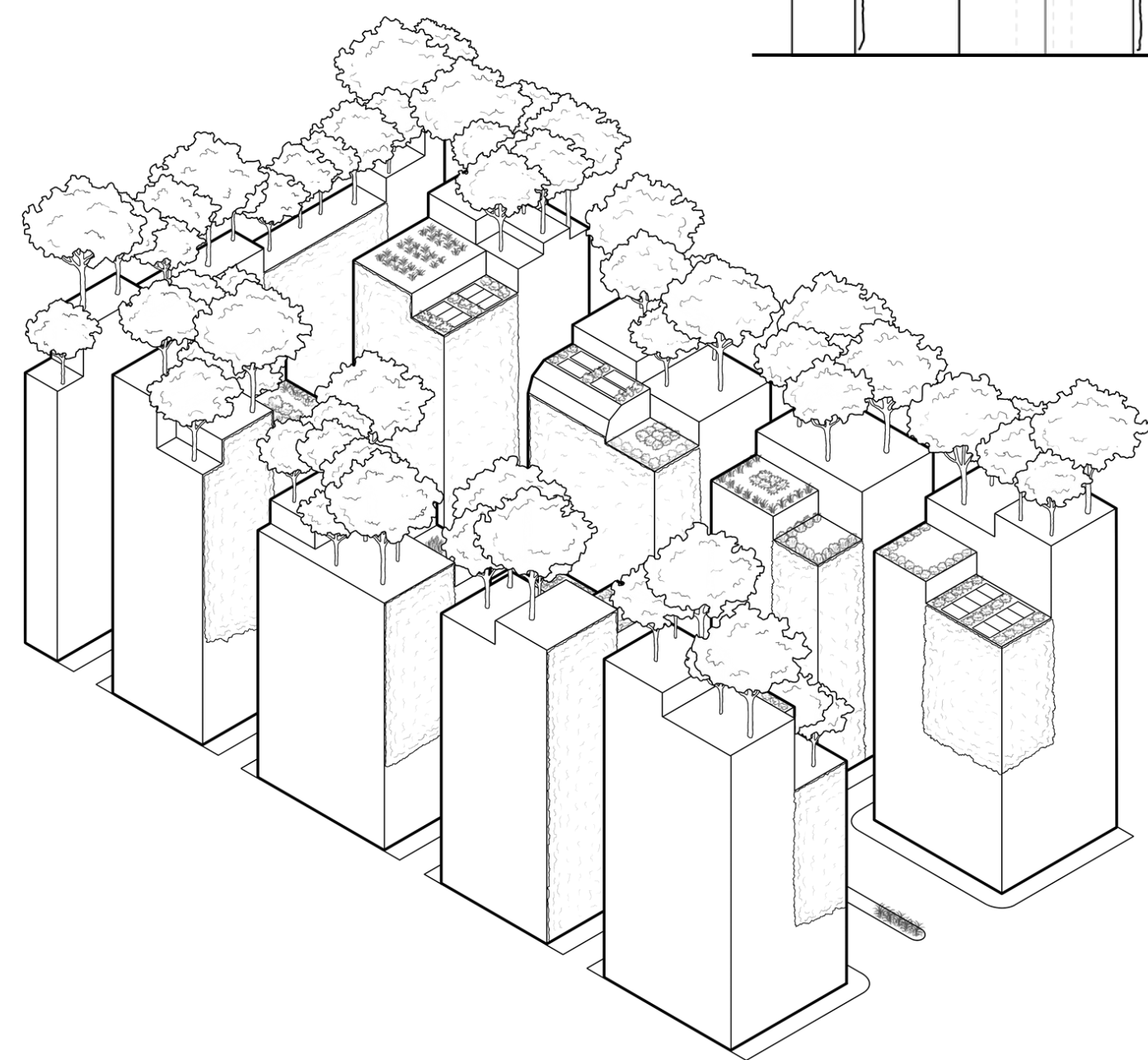

To construct the living walls in my design I will attach a wire mesh to a recycled timber frame, and then weave faux foliage into the mesh.





