

A LIVING HUB

Creating Waves of Interaction & Creativity

Lina Utterman



Project

This project responds to the theme of conflict and resolution by using design as a tool to reduce social disparity and foster inclusion. Working with Fusion Arts, a local organisation committed to supporting underrepresented communities through creativity, the design transforms a community site in West Oxford into a space for shared expression and empowerment. Key design strategies promote social justice by ensuring accessibility, flexibility, and shared ownership: open ground-floor areas invite public interaction, while quieter upper zones support focused, creative work. Multi-level platforms accommodate diverse users and activities, enabling cross-cultural exchange and inclusive programming. A central “furniture” staircase acts as both a symbolic and functional connector, encouraging movement and encounters across groups. By blending domestic warmth with open, communal infrastructure, the project enables equitable participation and supports ongoing community-led transformation. It’s not only a space for creativity but a spatial framework for dialogue and social cohesion.



Designing for Fusion Arts

Fusion Arts is a socially engaged arts organization in Oxford dedicated to diversity, inclusion, and community empowerment. Since 1977, it has championed underrepresented voices through creative projects that address social issues. By blending arts, education, and activism, Fusion Arts fosters cultural exchange and uses creativity as a powerful tool for social justice.

Fusion Arts Timeline



Fusion Arts over the Years

Founded as Bloomin' Arts in 1977, the organisation evolved from grassroots community projects into a key player in Oxford's cultural scene. Renamed Fusion Arts to reflect its interdisciplinary and inclusive vision, it expanded into arts education, environmental activism, and large-scale collaborations with schools, universities, and museums. Through public art, youth programmes, and cross-cultural initiatives, Fusion Arts continues to build bridges between diverse communities, embedding creativity into everyday life.



Internal View



THE LIVING HUB

Context & Community - Understanding Place and People

Fusion Arts is located on Park End Street in Oxford, a **key route that acts as a funnel** for commuters and passersby traveling between the train station and city center. The area is **well-connected** and surrounded by cafes, shops, and cultural attractions like Oxford Castle & Prison and Westgate Shopping Centre, making it a **lively and convenient spot**.

Where Do People Go To & Come From?

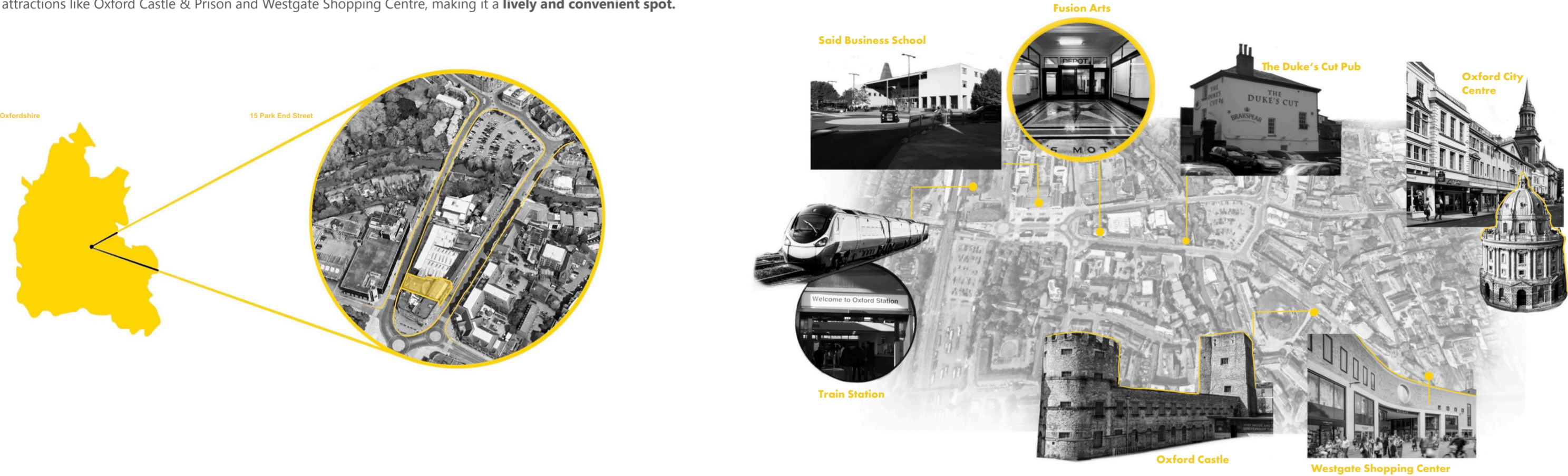

Good footpath connections and public transport links make the Fusion Art Centre easily accessible. Walkable routes encourage sustainability, while nearby buses and trains ensure convenience and inclusivity for visitors from all areas.



Who are the Users?

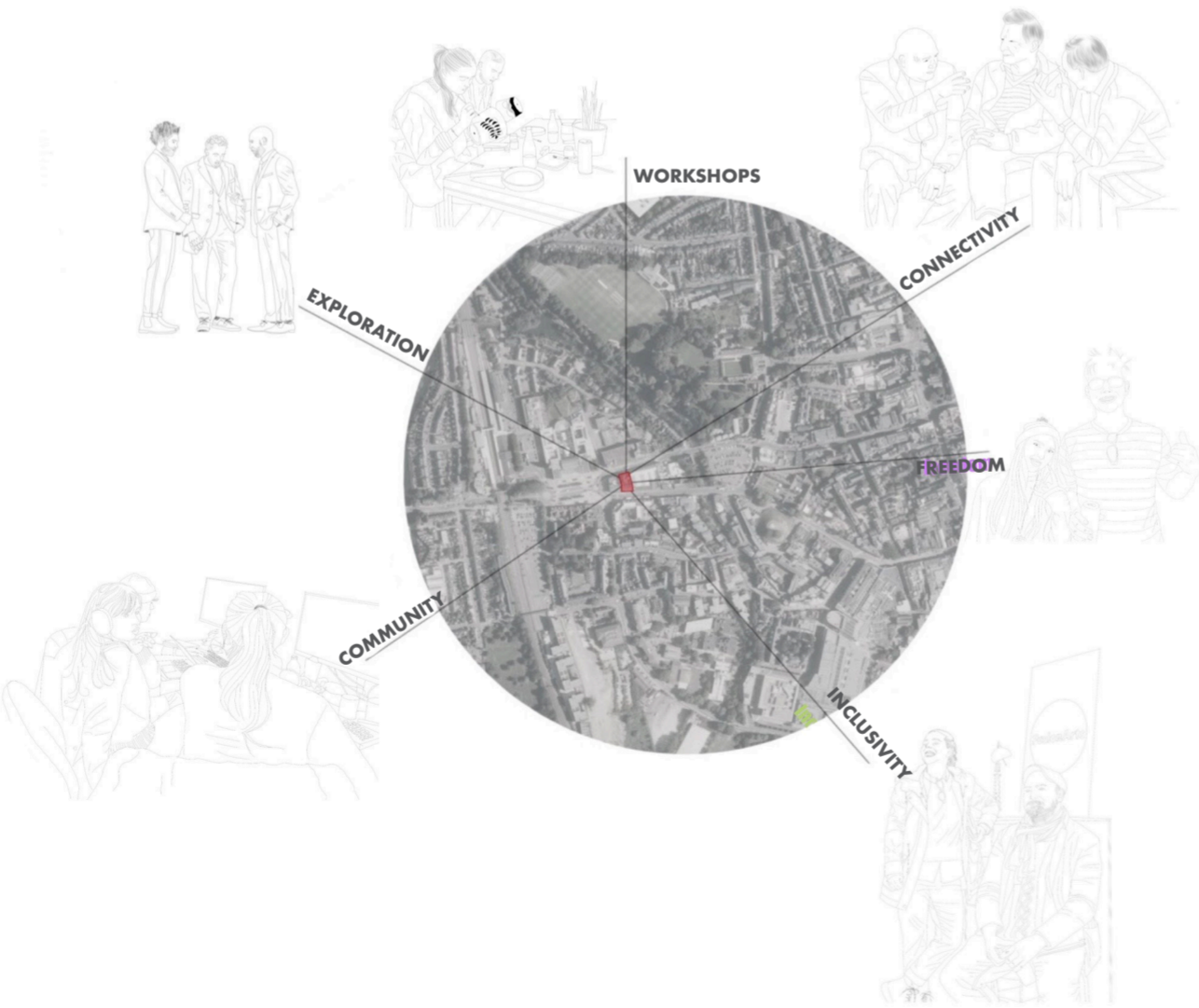
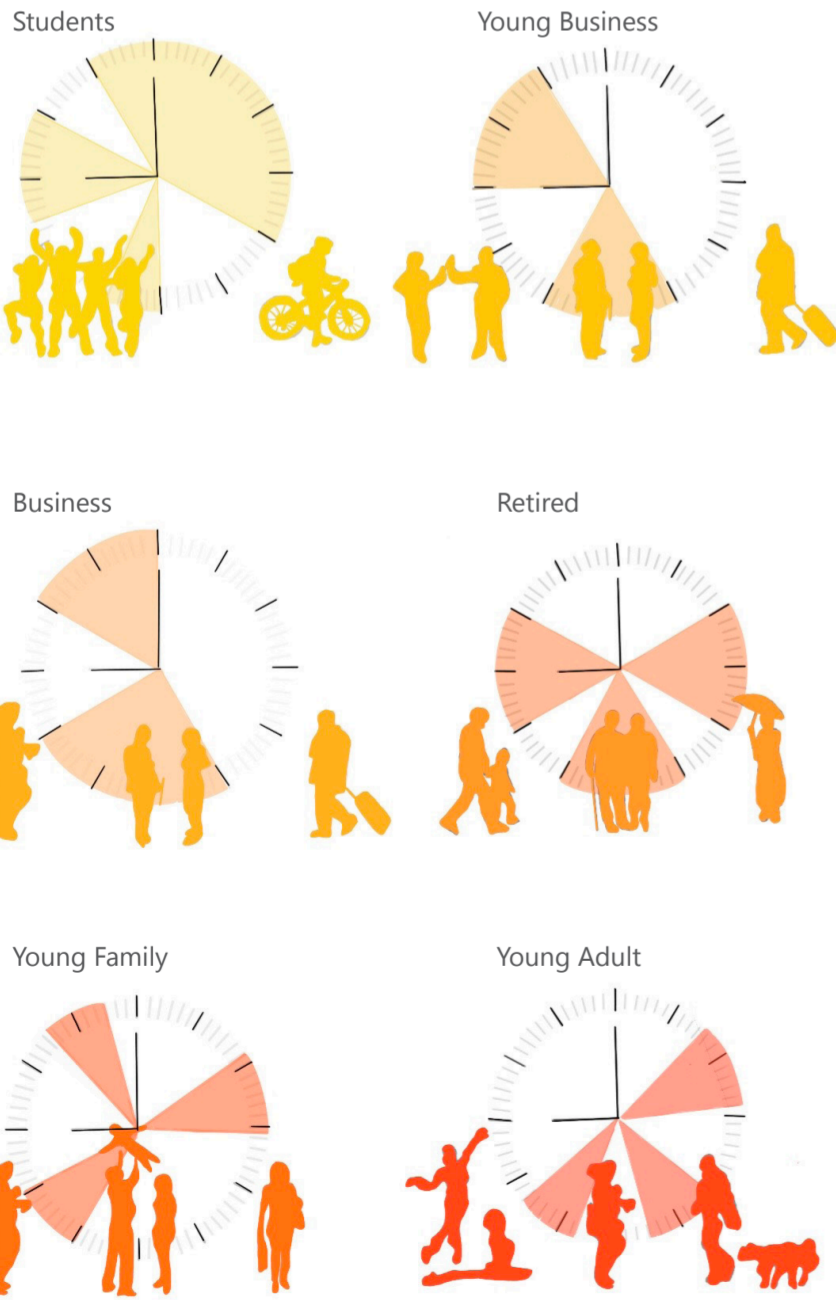

Understanding the users passing through or already interacting with the site helps shape the art centre's design and programming. Identifying patterns in foot traffic, local routines, and visitor demographics ensures the space meets community needs. Catering to both regular users and passersby can enhance engagement, attract new audiences, and create a welcoming and usable space.

Materiality



Existing Section A



Existing Section A



THE LIVING HUB

Shared Space - Dividing & Uniting

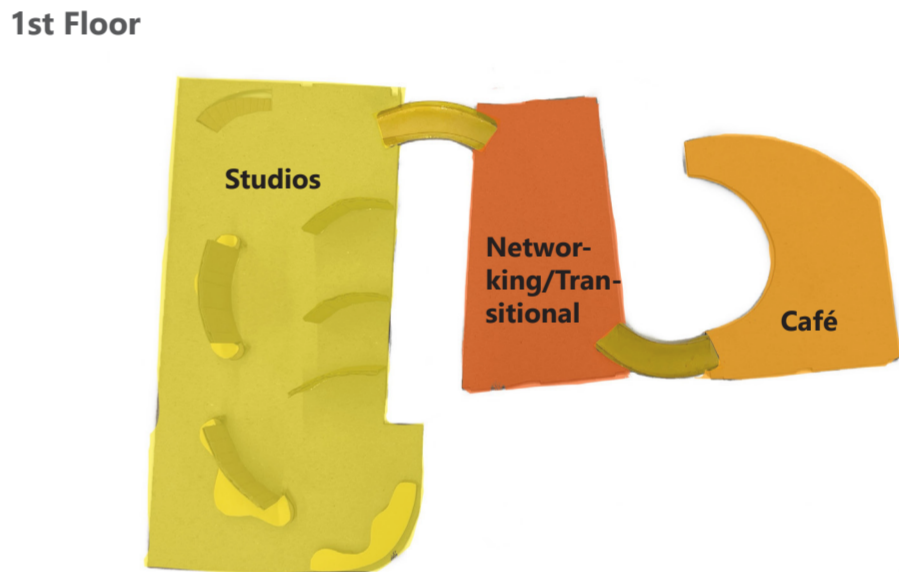
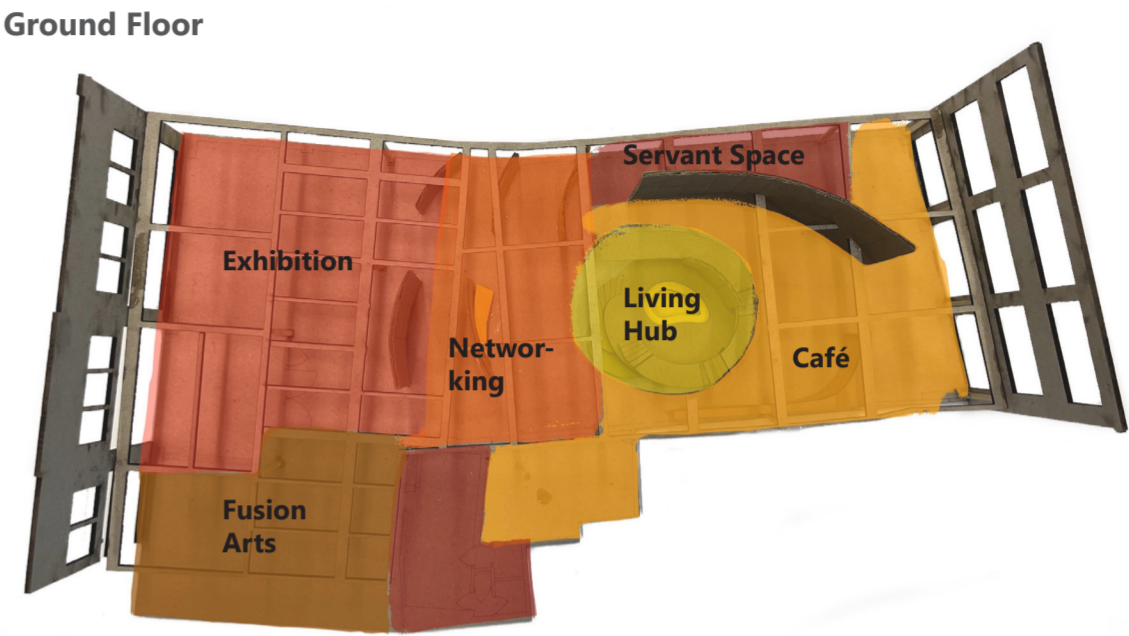
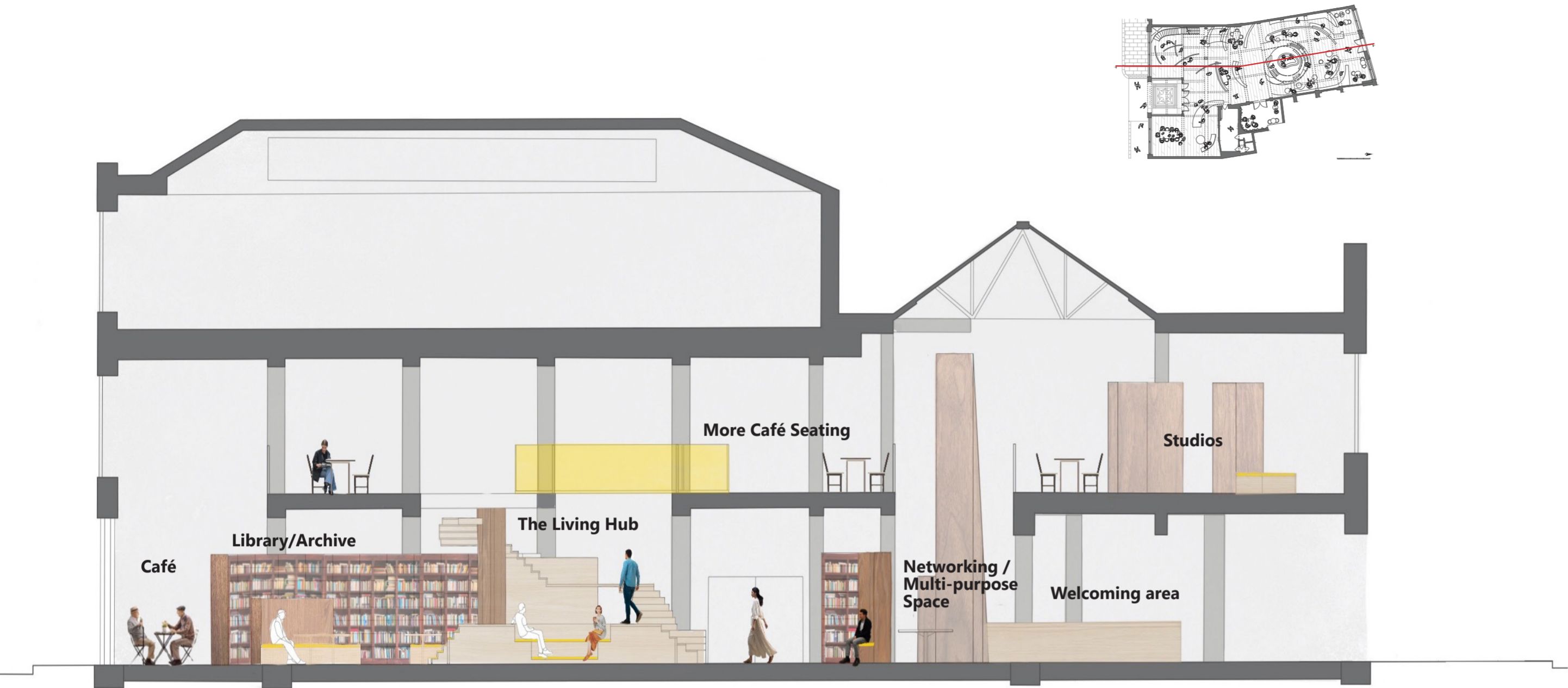

The design thoughtfully balances openness and privacy by dividing the space across levels while maintaining a sense of unity. The ground floor remains largely public, fostering spontaneous interaction and community engagement. In contrast, the first floor is more secluded, opening up to natural light while offering quieter, more exclusive zones for artists and Fusion Arts collaborators. This spatial layering allows for diverse activities to coexist, supporting both collective experiences and the need for focused, private work.



Living Hub - Communal Space



Community Arts Library



Café & Seating Area



Precedents

Richard Serra Installation, Guggenheim Museum - Bilbao

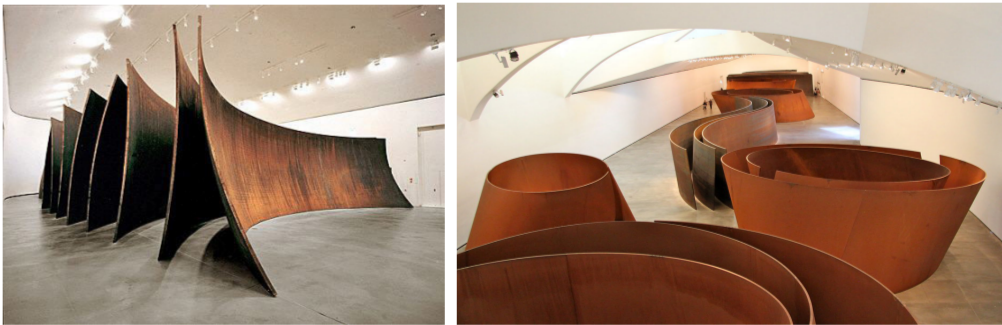

Clapham Library, Studio Egret West - London



THE LIVING HUB

User Profile & their relation to the Building

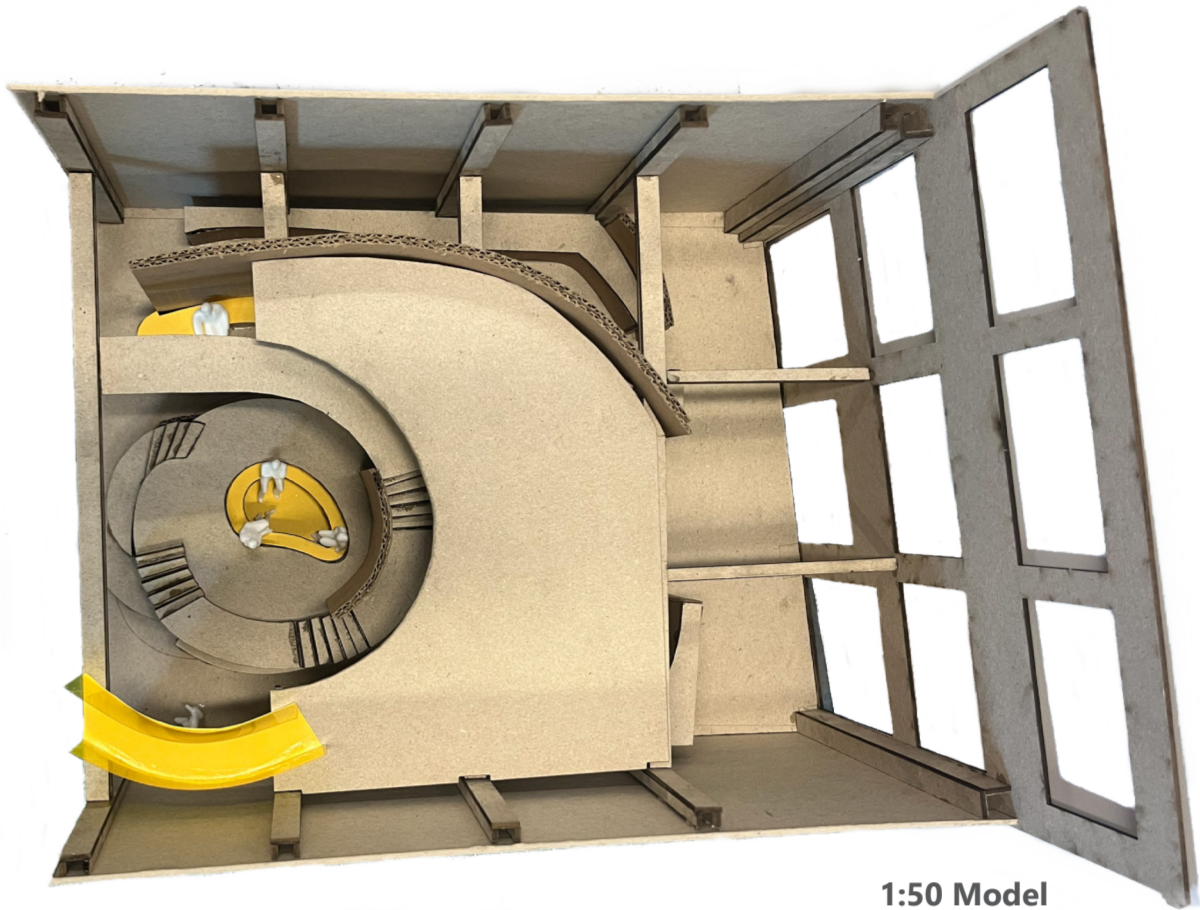
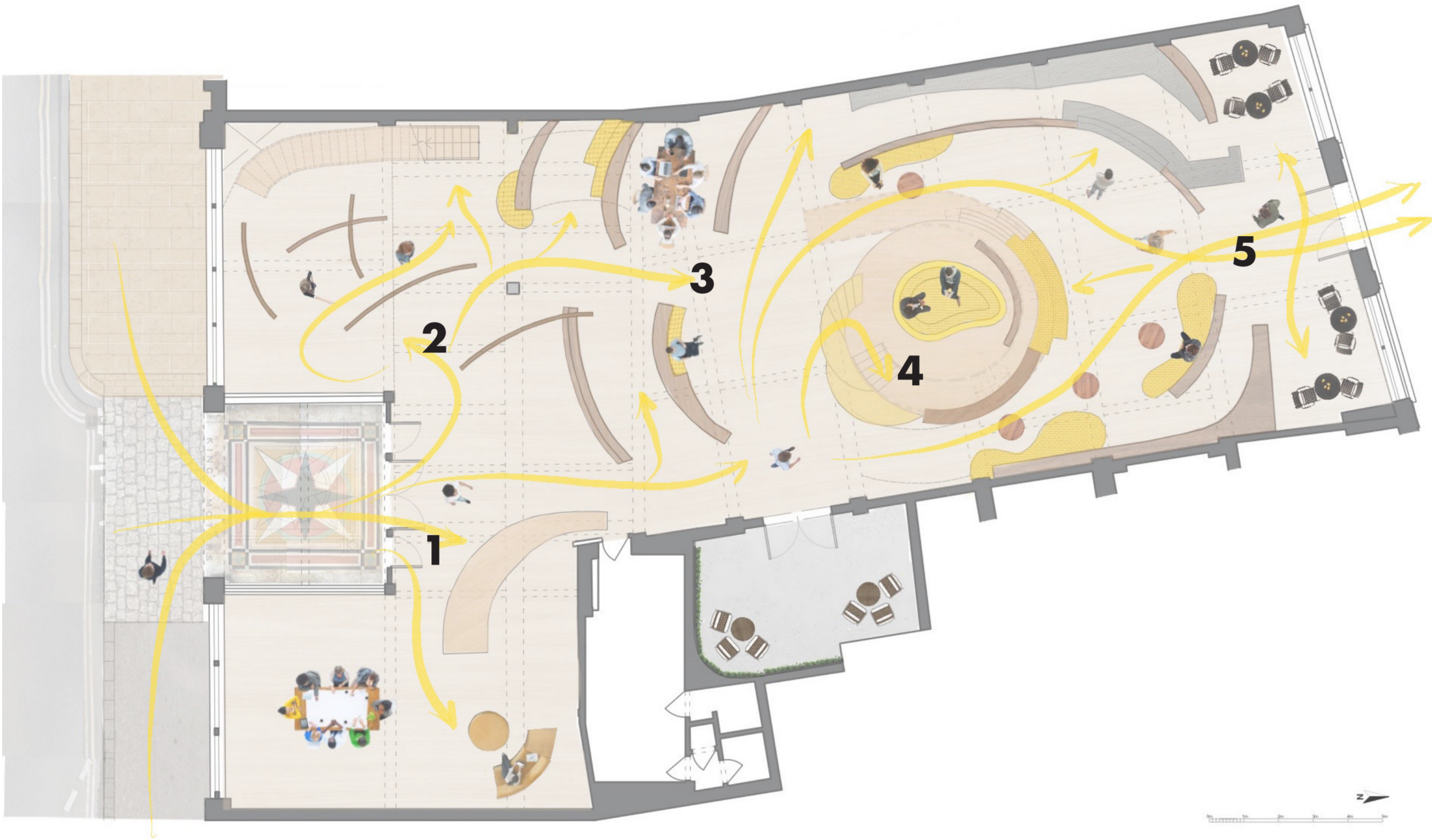

Elderly



1, 2, 4, 5

Younger People



1, 2, 4, 5, 6

Artists/Creatives



2, 3, 4, 5, 6

Passerby



1, 2, 5

1 Welcoming Area

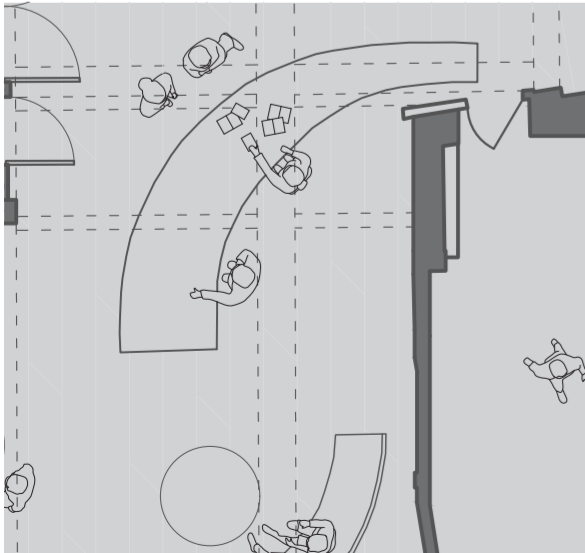

2 Exhibition



3 Networking



4 Living Hub



5 Café



6 Studios (1st Floor)



THE LIVING HUB

„Furniture“ - Spatial Catalyst

1:20 Sectional Model

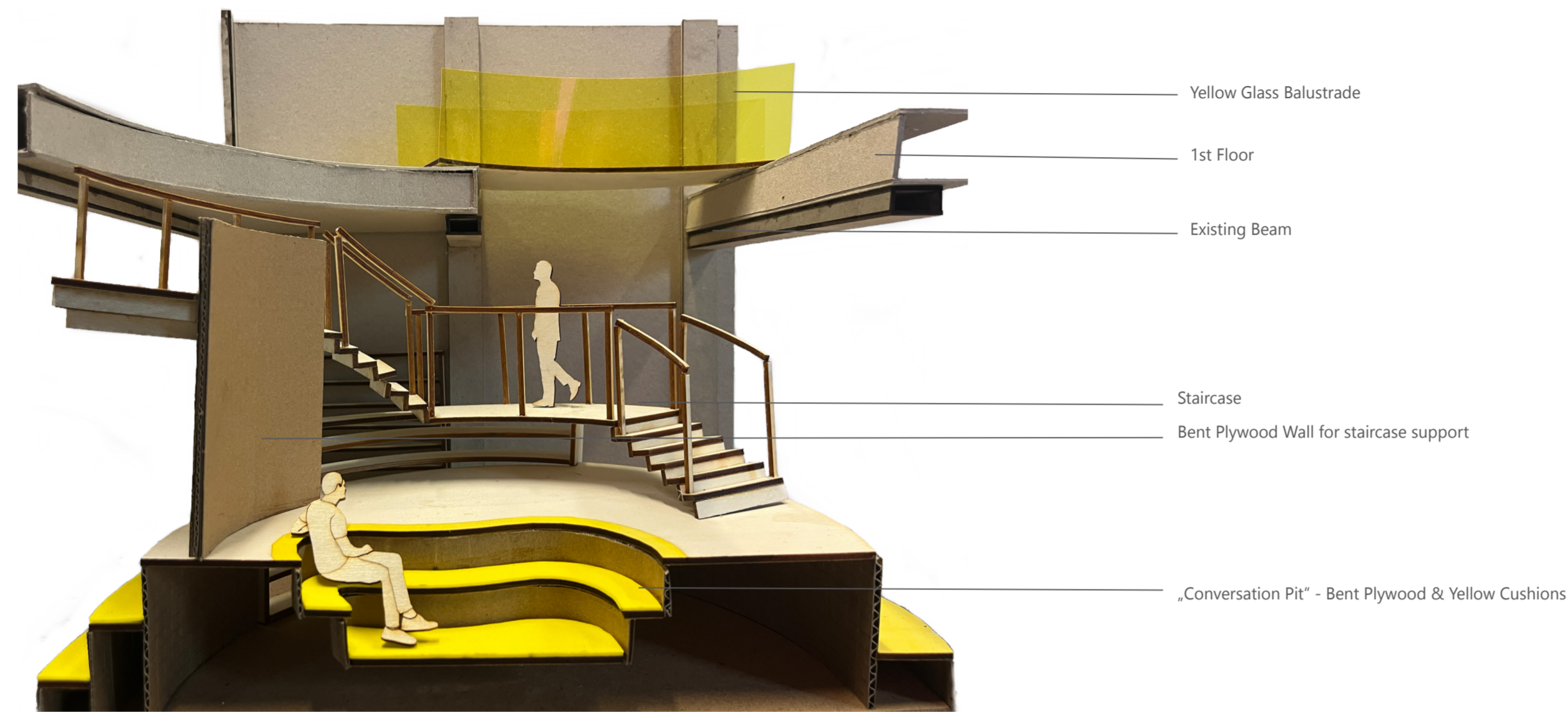

Precedents

Trommen Cultural Centre / Arkitema Architects



Furniture Sketch Model



The furniture staircase serves as the central hub of the space, merging furniture and architecture to encourage gathering, movement, and interaction. Like a drop creating ripples, it anchors the design and radiates outward, shaping the surrounding communal zones and embodying art as a lived, everyday experience.

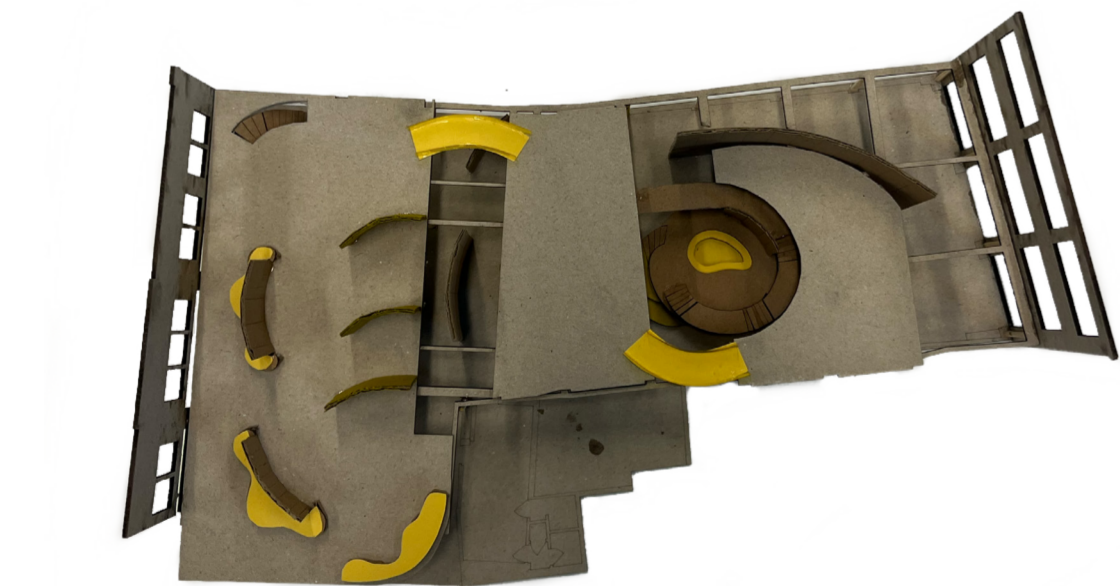

The Ripple Effect

My design revolves around a central furniture staircase, serving as a **living hub** that anchors the space. From this focal point, everything radiates outward, forming a **ripple effect** — much like a drop falling into water. The **drop symbolizes Fusion Arts**, representing the vibrant **heart of the community**. Just as ripples expand and connect, the design fosters movement, interaction, and connection, emphasizing the role of art as a **catalyst for social engagement and communal growth**.

Rendered Internal View

