



Repair

Bikes and belongings.

Library of Things

Appliances, tools and other useful items to hire.

Biking accessories shop to support use of bikes.

Community space

Creating a space for interaction and friendships.



MENDING CONSUMERISM WITH REPAIR

Project details:



Westgate, Oxford



Monday-Sunday, 10:00-19:00
1 year project (Student Volunteers are able to attend during the school holidays and as part of their school curriculum).



A team of 15 members including SHARE Oxford and Broken Spoke organisers, students and retired members volunteering on rotation.



Workshops open to the public with assistance, or items in need or repairing can be dropped off to be repaired by a crafts person.

- Items repaired for free (unless parts are required).
- Items varying cost from the Library of Things.

Main Facilitators:



SHARE Oxford is a local organisation aimed at reducing consumption and waste through "sharing and repairing" things to reduce buying new things. They offer a library of things to hire tools, repair cafes and a sharing hub.



Broken Spoke is a non-profit social enterprise in Oxford created by people who are passionate about cycling. They provide workshops, courses and cycle training and a hub of information for cyclists.

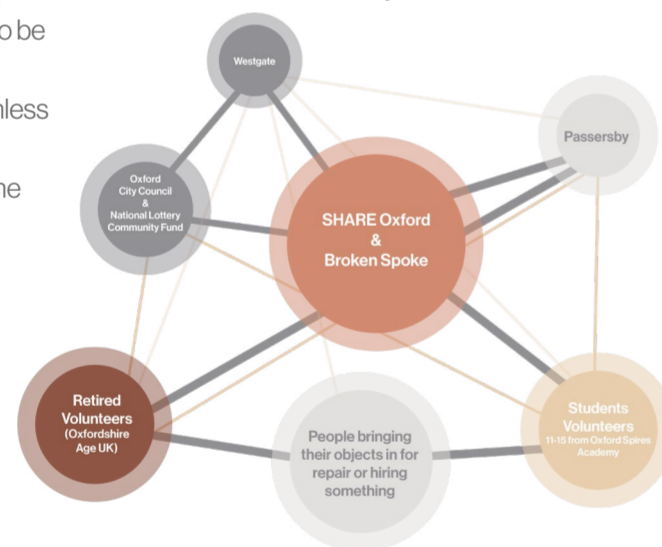

Repair conscious people bringing their objects in to have repaired.

Learning how to repair with an facilitator

Meeting someone new in the community.

Social Interaction
Increase in craft
Less waste
Customised belongings
Objects reimaged



Reducing stress involved in fixing

Skills and knowledge shared

Social interaction

Re-using and sharing objects

Increase value seen in objects

Community Agency



Hiring a tool from the Library of Things, delivered by bike.

Facilitators

Students Volunteers (11-15 years)

Students from Oxford Spire school looking to gain some repair skills during the summer holidays.

Retired Volunteers

Through Oxfordshire Age UK, retired people who have good DIY and repair knowledge and are looking to share and connect.

People passing by Re:pair and seeing repair in the community.

Loneliness
Unused and broken objects
Waste



Re:Pair is a scheme in Oxford that puts people and repair first in a central space in the city primarily focussed on consumerism. Located in Westgate shopping centre, spanning into the only public square in Oxford, the project acts as a community take over; offering public repair workshops for bikes and belongings, a tool and object hiring library, as well as social spaces.

Zero Carbon Oxford aims to achieve net zero carbon emissions by 2040 and reduce transport emissions by 88% (Oxford City Council, 2024). Whilst cycling in Oxford is already a popular method of transport, the city currently has inadequate cycling infrastructure to support cyclists (Lingwood, 2020) and improvement is needed to encourage this zero direct emission method of transport. Re:Pair aims to provide cyclists with a community space to encourage agency over repairing their bikes and belongings, as well as providing the physical cycling infrastructure and highlighting responsible consumption in the centre of the city.

Through repairing bikes and belongings, different members of the community come together to share knowledge and skills. The project spans across the city, with the main centre located in Westgate shopping centre, smaller Re:Pair centres throughout the city, as well as bike lanes to improve cycling infrastructure and connecting the projects together as a form of wayfinding. Not only does the project aim to change the dynamic of Westgate shopping centre through bringing people together, but also to create a more sustainable city, encouraging a circular economy and giving the community more agency over their belongings and retaliating to the current consumerist society.



Re:pair
Bringing people together



Repair
Restoring function



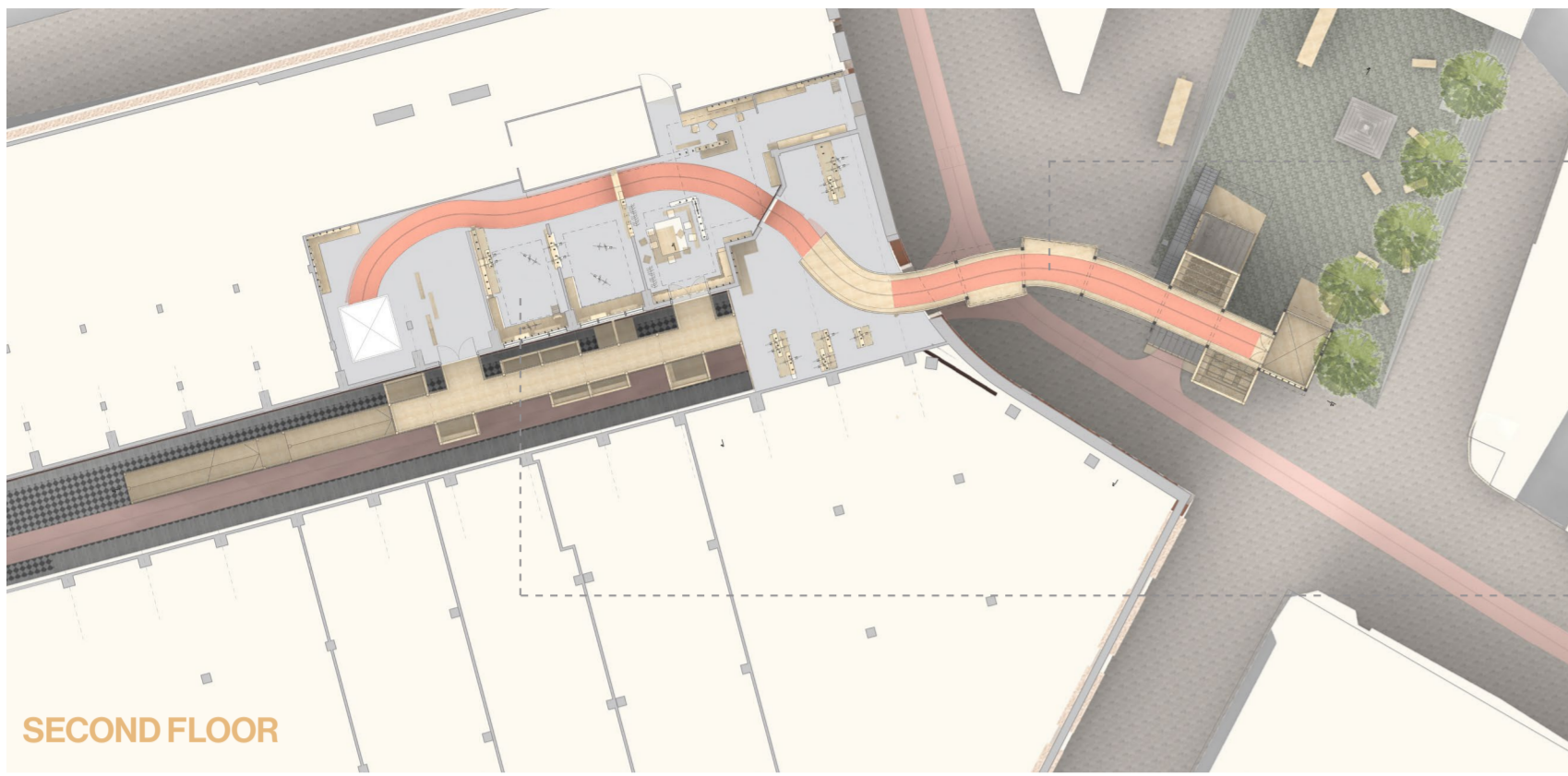

SECOND FLOOR



Spaces for contemplation

The Re:Pair structure spans across a public square into the entrance of Westgate shopping centre through a bridge passing through an existing opening in the shopping centre facade. This offers visitors a unique experience to look down and reflect about the nature of the project in a consumerist environment.



Re:Pair Workshops

On the second floor workshops are available for the public to use free of charge. This can be with the assistance of volunteer DIY experts to guide people or sole use if they are more confident using alone.

Bike paths route directly from the pavement outside the shopping centre into the workshops so that people can travel by bike.

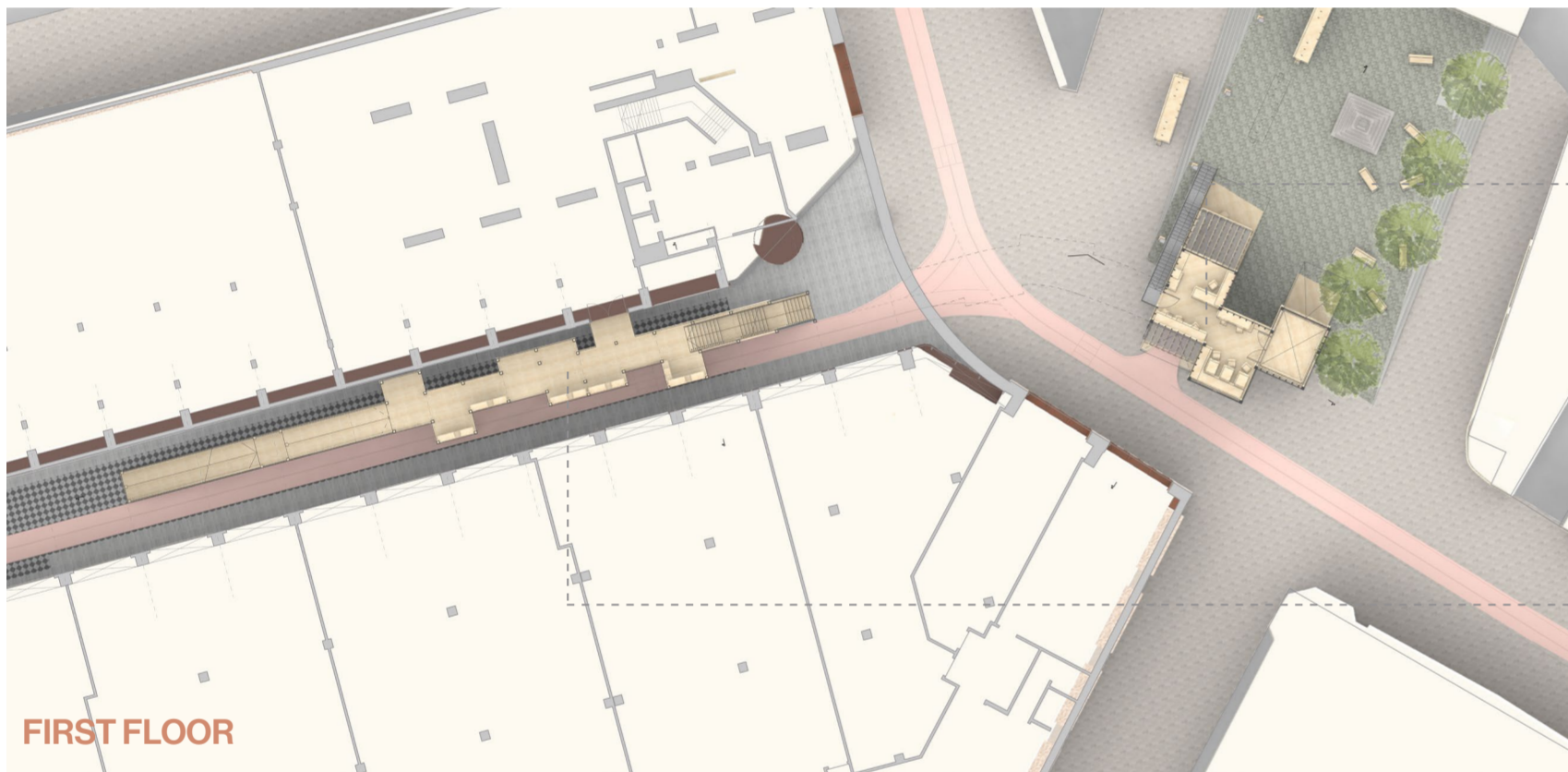

FIRST FLOOR



Cafe

A cafe is located on the first floor in Bonn Square, accessible through a lift which also goes to the second floor, or a separate set of stairs from the square. This is a space for people using Re:Pair to gather after repairing an item or anyone else in the community.



Library of Things

A place to hire different tools and equipment is located on the first floor in the entrance of Westgate shopping centre. This directly encourages visitors to avoid buying new items where possible.

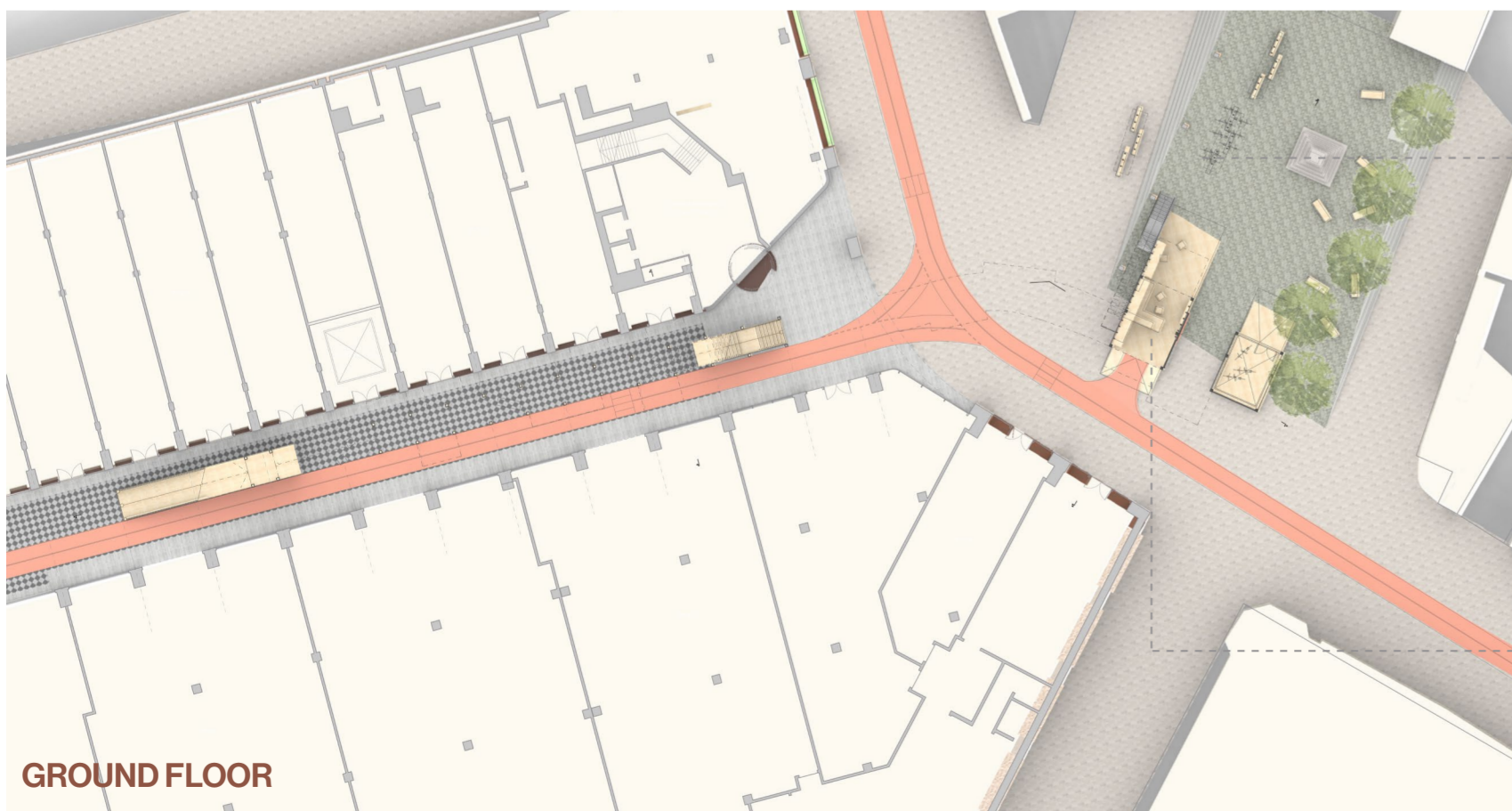

GROUND FLOOR



Bike Parking

New bike parking stations offer visitors more space to securely park their bike whilst visiting Re:Pair or the shopping centre, encouraging a more sustainable method of transport.



A first visit to Re:Pair

A first point of contact where new visitors can discuss repairing an item or have quick fixes undertaken, being directed to the workshops if applicable. A small coffee station is also located here spreading into the square to encourage a more relaxed and welcoming environment.

Repairing bikes & belongings

Re:pairing objects through hiring not buying

Repairing the planet

Re:pairing relationships and community

Repairing the city



FUNCTIONS OVER THREE LEVELS

Westgate Shopping Centre as the host building

The Re:Pair intervention is a parasite structure to the existing Westgate shopping centre.



Bikes & Belonging[s] in a Cycling City

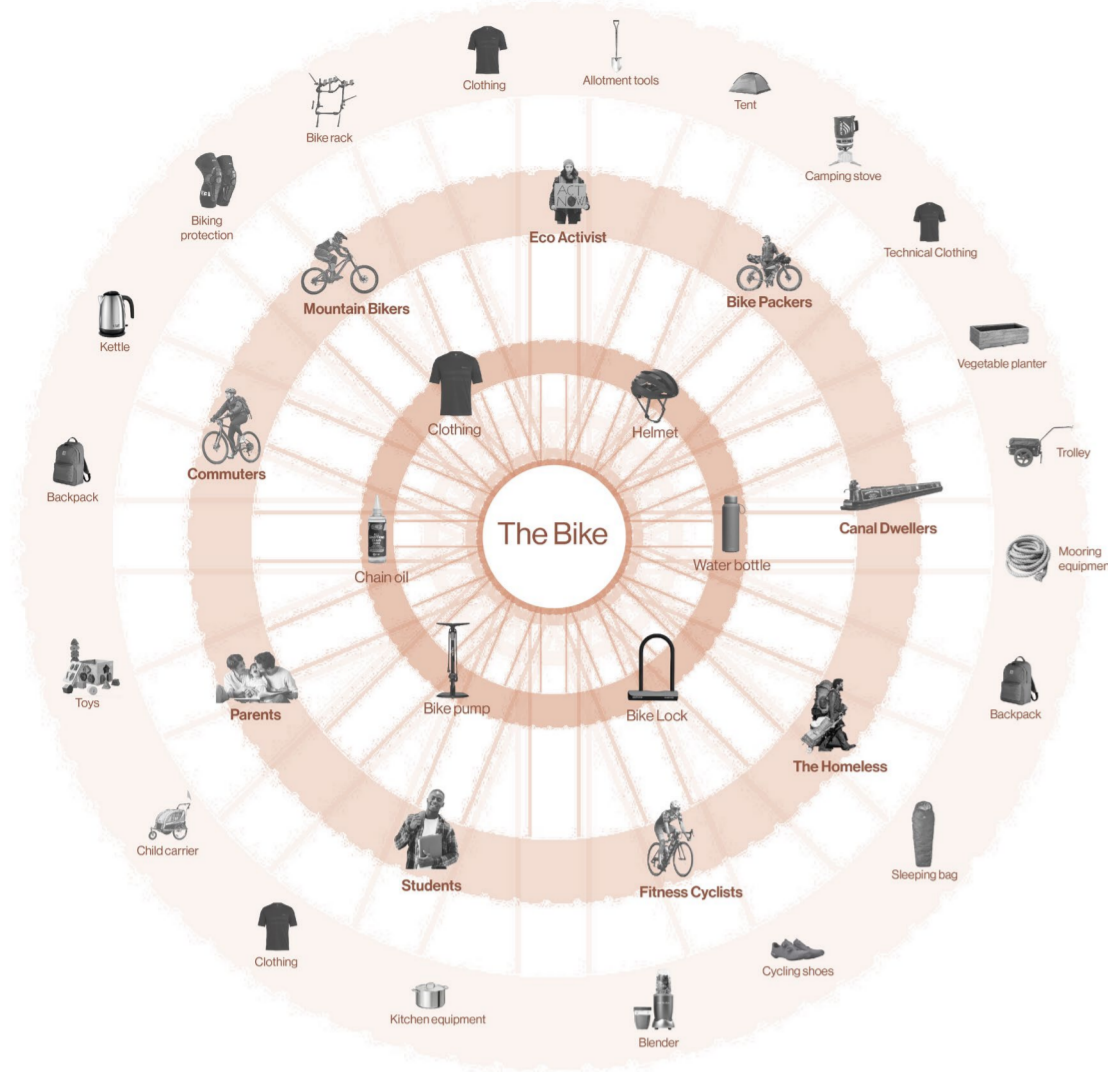

"I really enjoy spending my spare time to volunteer at Re:Pair, it gives me a chance to meet new people and is also rewarding to share my skills with others."

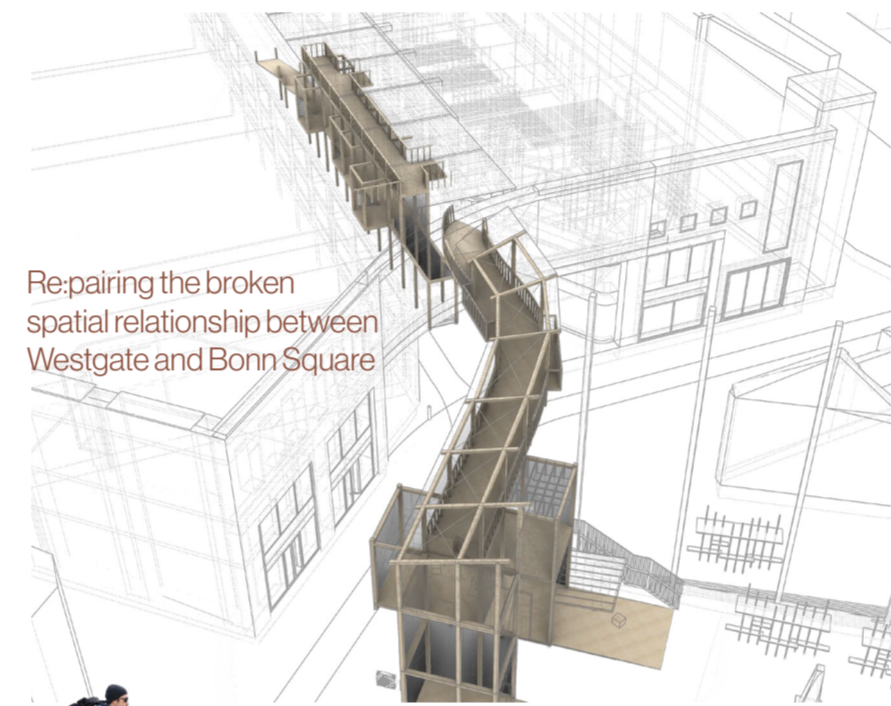

Re:pairing the broken spatial relationship between Westgate and Bonn Square



IMPACTING THE OXFORD COMMUNITY

Creating a more playful spatial dynamic for cyclists

- = Repairing the broken spatial relationship between Westgate (semi-public) and Bonn Square (public)
- = Breaking the existing flat facades with a push and pull effect from skin and partitions at differing points in the intervention, creating a more playful feel in Westgate
- = Circulation routes - breaking up the banal
- = New 'street' dynamic - cutting through the alley with a new intervention to change the spatial experience through a parasite structure
- = New bike lanes travelling right through the city into the heart of Westgate and Re:Pair workshops

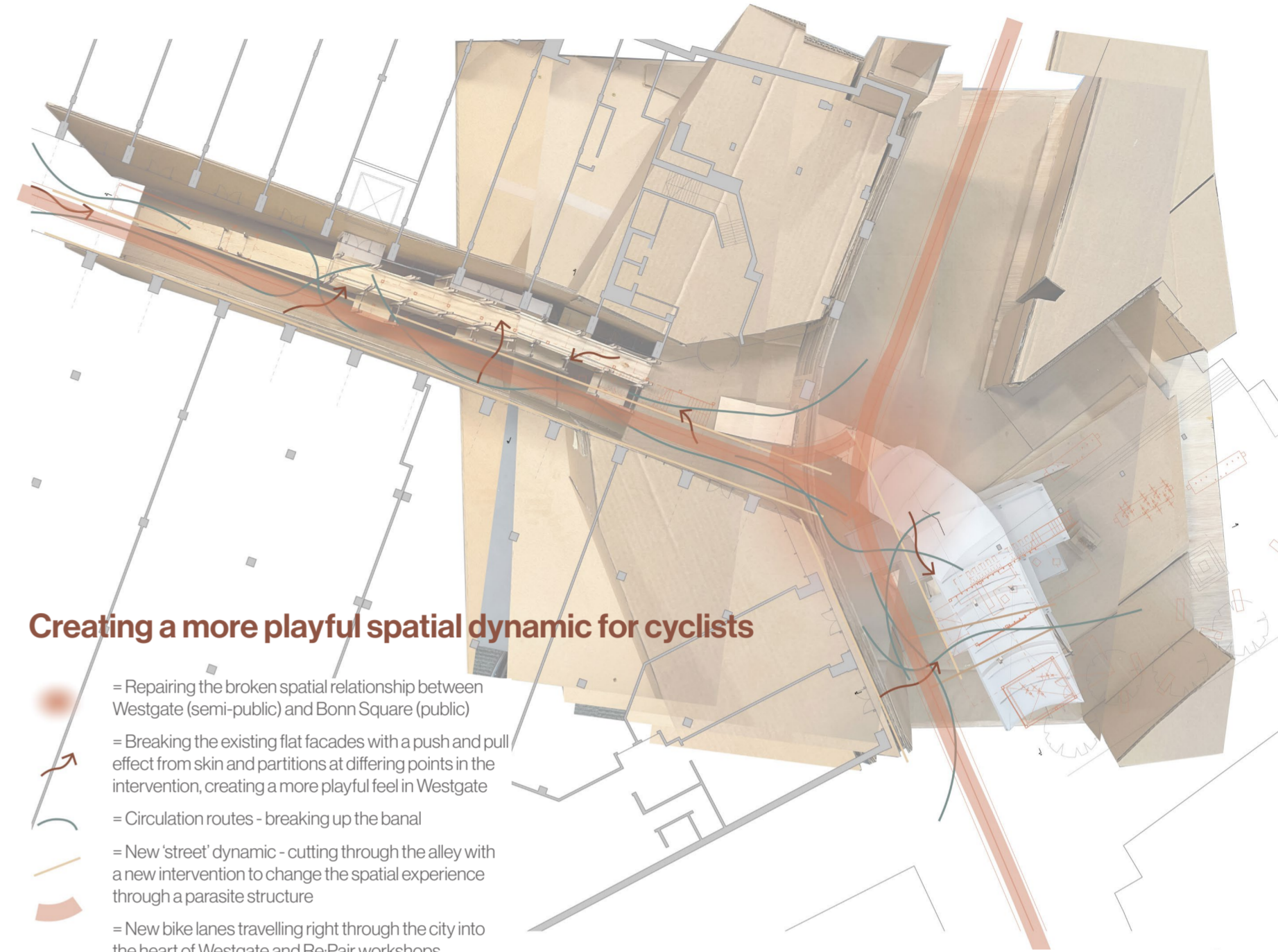

"I've never been anywhere like this before but my bike needed repairing, so my Dad brought me here. I will tell my friends what I learnt at school next week."



"I didn't really want to volunteer at Re:Pair as all my mates were hanging out, but it has actually been really good fun and I've been able to help other people fix their stuff as well as learning from others too."



Smaller sub-stations with assistance

Oxford Local Cycling and Walking Infrastructure Plan: Aims to be a world class cycling city

In March 2020, Oxford City Council set out "measures and programmes to achieve transformation change in the levels of cycling and the attractiveness of walking in Oxford" in the Oxford Local Cycling and Walking Infrastructure Plan. This aims to help residents benefit from the positives of these transport methods such as "health, decongestion, safety, air quality and climate change mitigation". It supports Oxfordshire County Councils plans "for Oxford to become a "world class cycling city"" (Lingwood, 2020).

Oxfordshire County Council has identified the main factors which are important to making cycling in Oxford safer and promote it as a transport method "a town-wide cycle network, a cycle friendly public realm, traffic restraint, a cultural norm of cycling and Council commitment" (Lingwood, 2020, p. 10).

Extending Re:Pair through the city and beyond

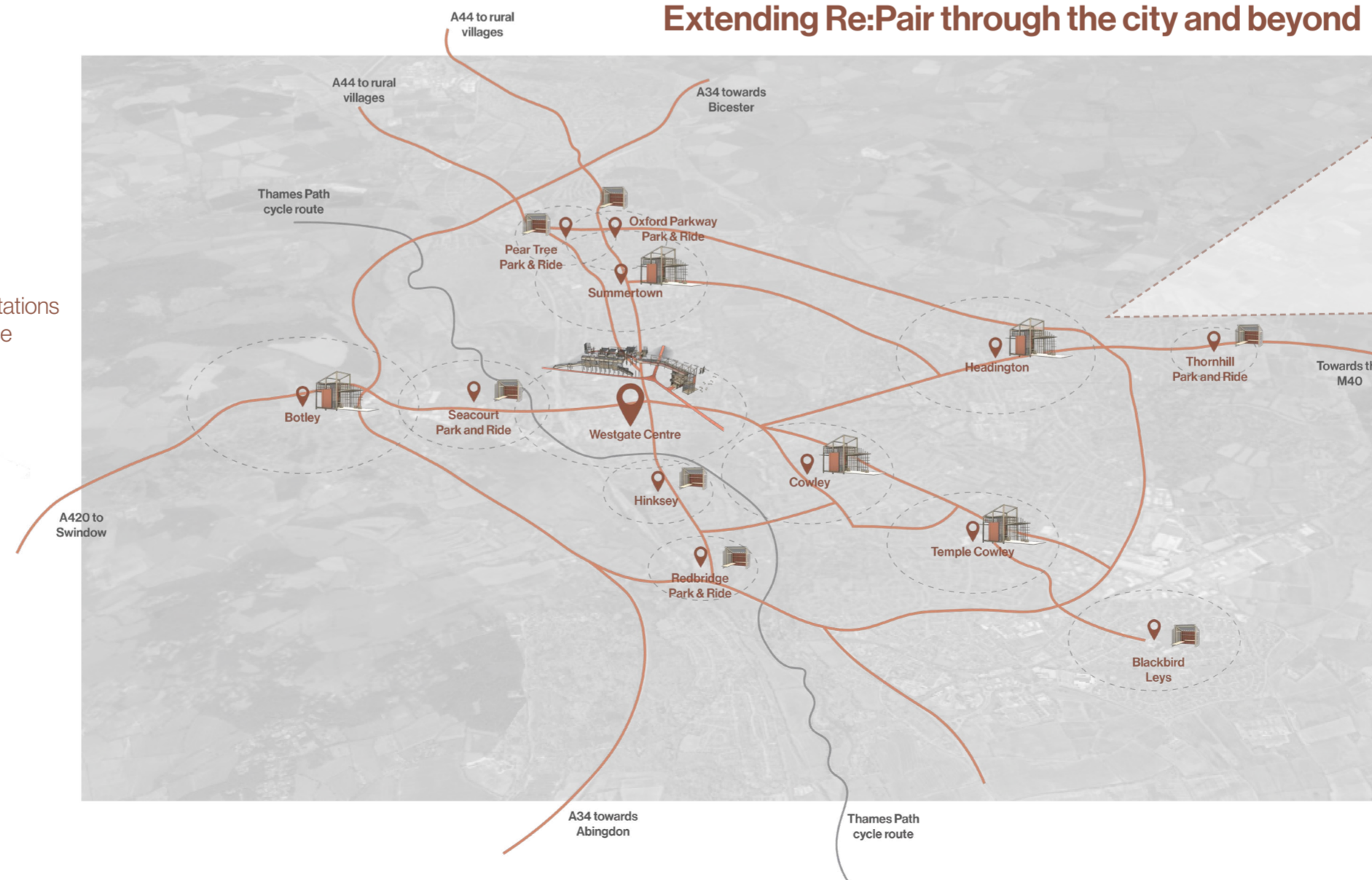

City wide bike lanes connecting Re:Pair



Self-service bike repair stations



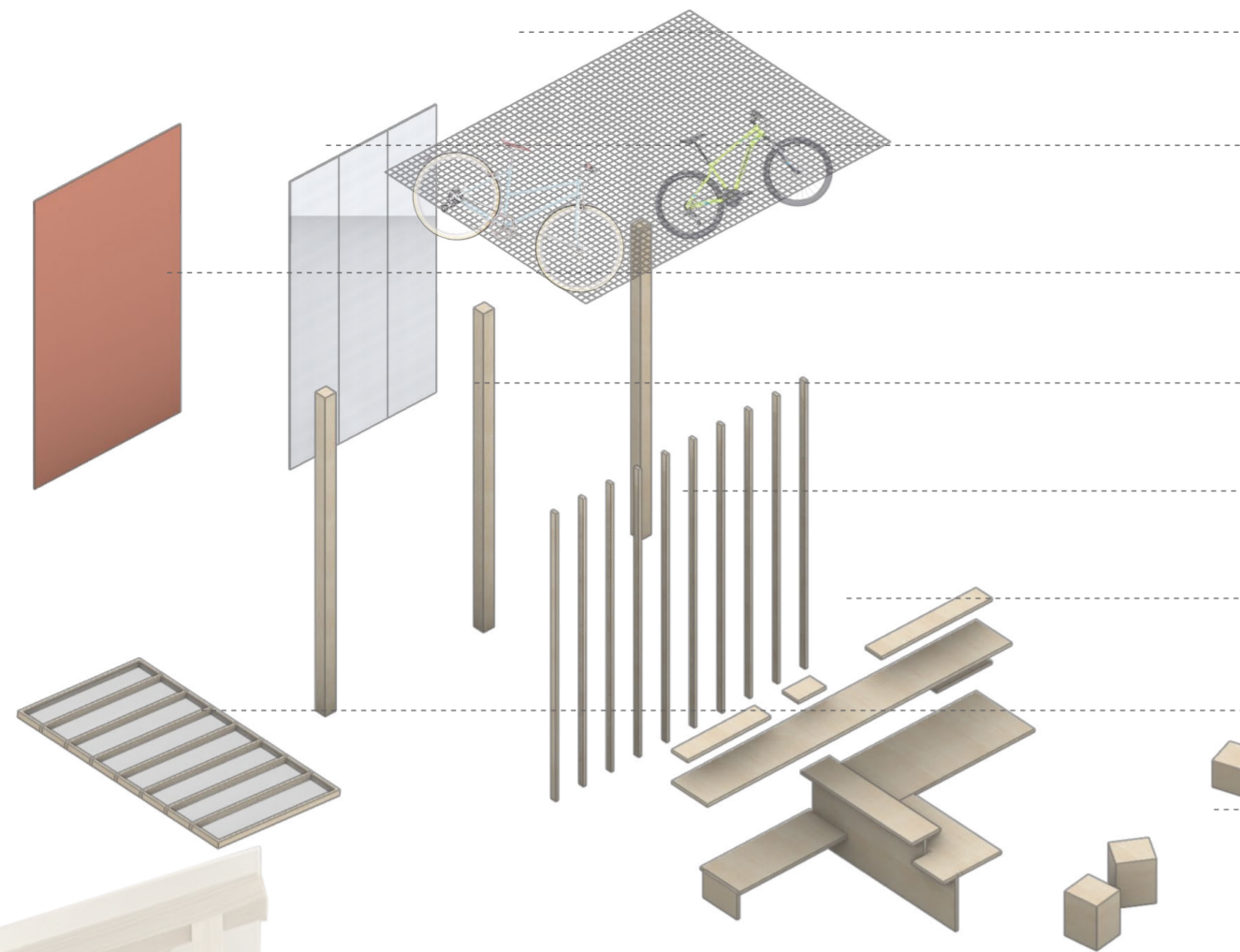

Ceiling racking

Hanging biking and repair items from

Polycarbonate cladding

To create a light environment and open up Re:Pair to everyone

Recycled plastic cladding

Weather protection, privacy

Glulam parasite structure

Housing Re:Pair and connecting to Westgate

Secondary structure

Attachment of shelving to the main structure

Adjustable shelving, seating, tables and bike parking

Opening canopies

To extend space

Bike Lanes

Expanding through the city

A modular structure that can be reused

The Glulam and CLT structure has been designed in modular elements so that it can be taken down and repurposed for future project as required.

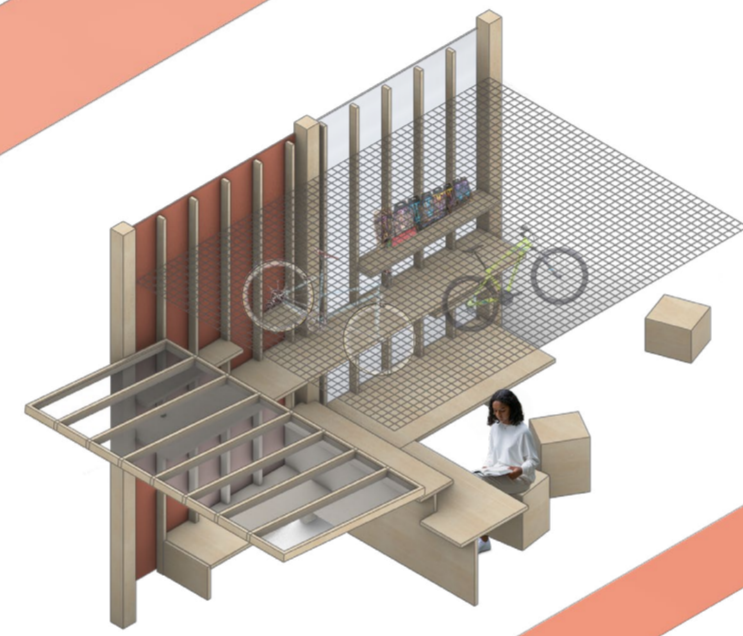

ADAPTABLE SHELVING FURNITURE



Variety of work stations

Differing heights and sizes to suit collaborative and individual working.



Spatial partitions

Shelving acts as partitions to create connected spatial zones, recycled plastic cladding is used when more privacy is required.



Multi-purpose shelving

Shelving that integrates display, storage and seating.



1:10 prototype model exploring structure connections and spatial qualities of furniture.



"The personal agency that comes with repair goes against consumerism and represents a challenge to a broken system"

Ava Haidar, in Broken.

