

Nature Woven In

By Ruby Cox

Nature Woven In regenerates the underused Nature Club at Islington Ecology Centre as a shared landscape for humans and nature. Located within Islington's largest nature reserve, it responds to the need for more accessible green spaces, which support wellbeing, environmental learning, and community engagement in an urban setting. Through the redesign of the Nature Club and the creation of an educational pavilion, this proposal creates opportunities for growing, gathering, and learning while encouraging biodiversity. The project promotes coexistence between human and non-human life, renovating a neglected site into a flexible and inclusive environment that supports present and future communities and the long-term health of the local environment.

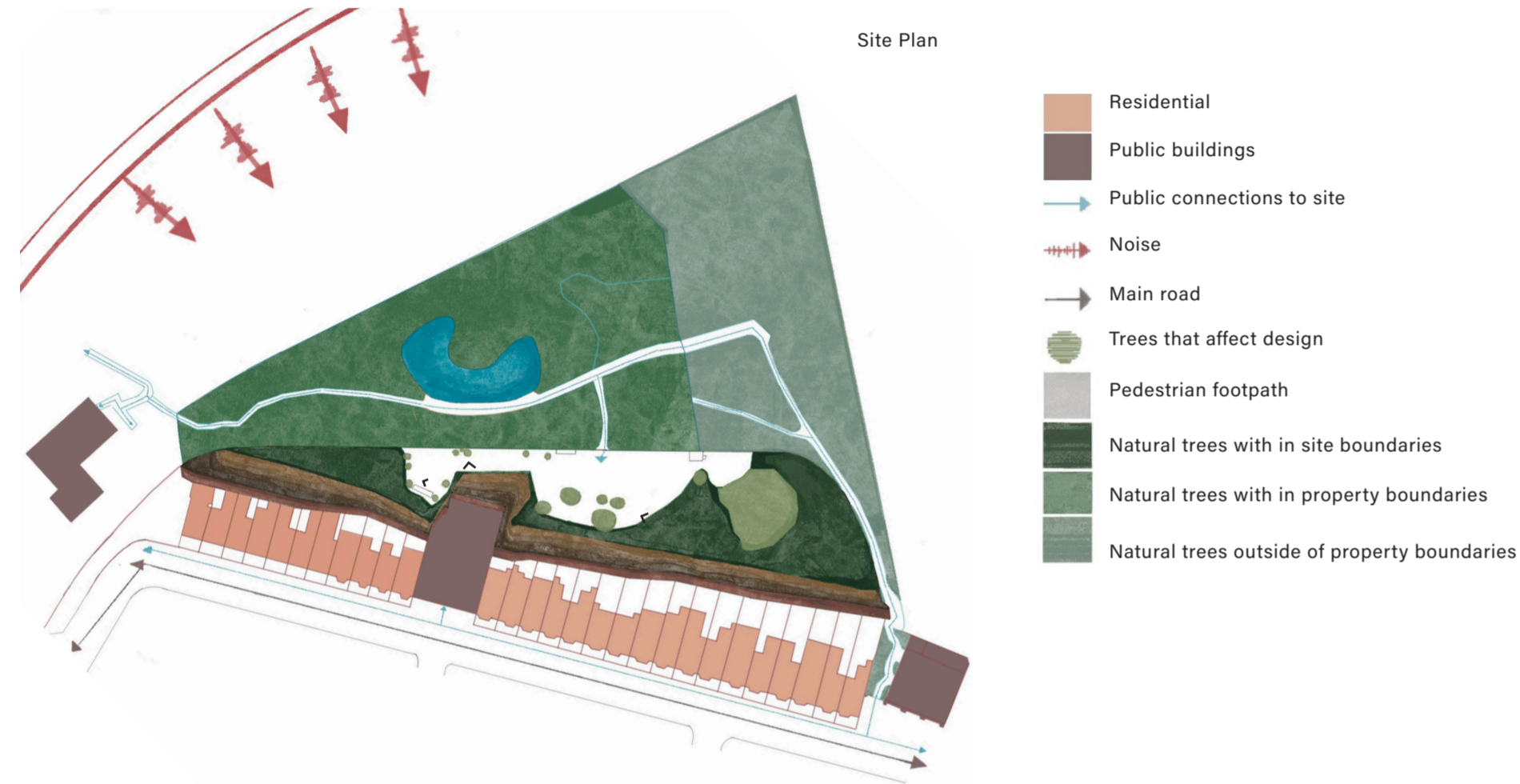

Site Photos-
of Main trees in
site

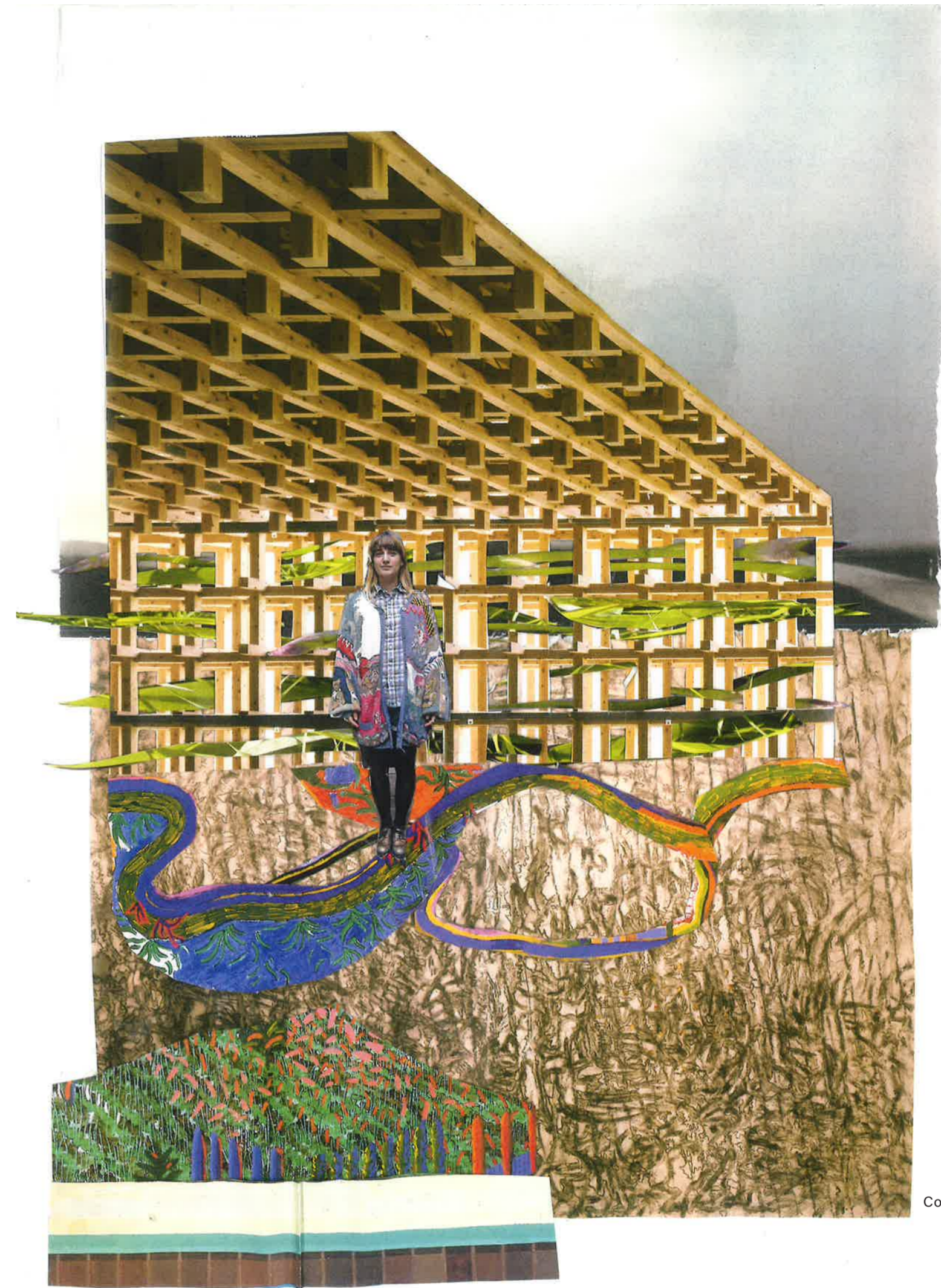

Conceptual Collage

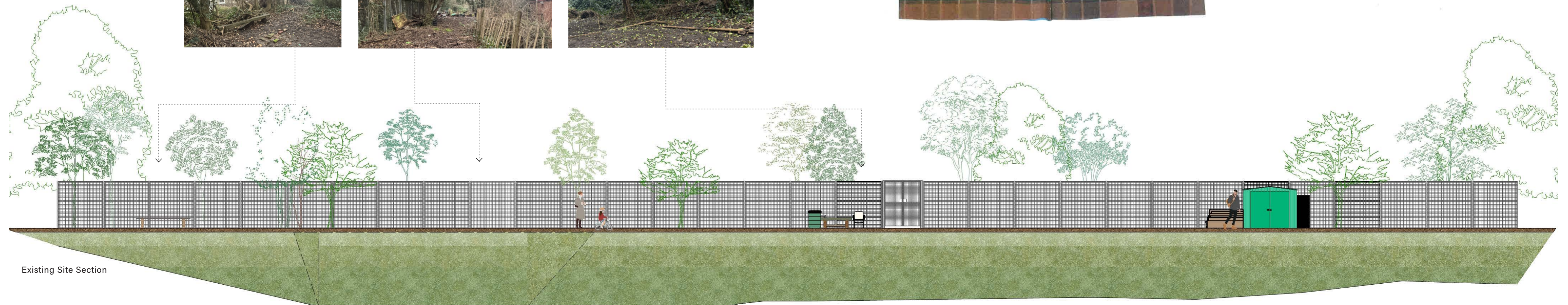

Existing Site Section

Nature Woven In

By Ruby Cox

The project began through collage as a method of exploring relationships between people, landscape and ecology. Layering elements of vegetation, movement and activity revealed opportunities for new connections across the site, establishing the initial design principles. Through an iterative process of sketching, testing and refinement, forms and spatial relationships identified within the collage were translated into a geometric framework that informed the masterplan. This process from considered exploration to structured design shifted the focus from individual elements to a connected network of spaces that support biodiversity, environmental learning and community interaction.



1. Rigid Elements



2. Dynamic Flow of Landscape

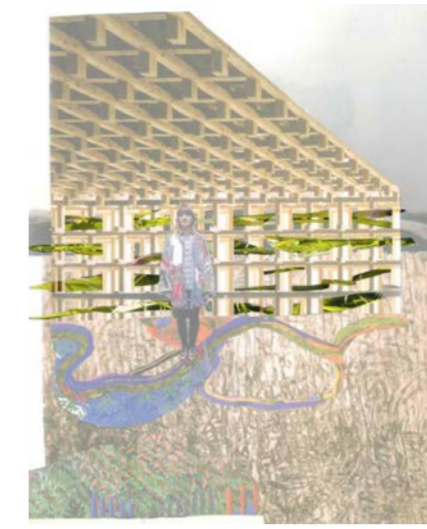

3. Woven Connection

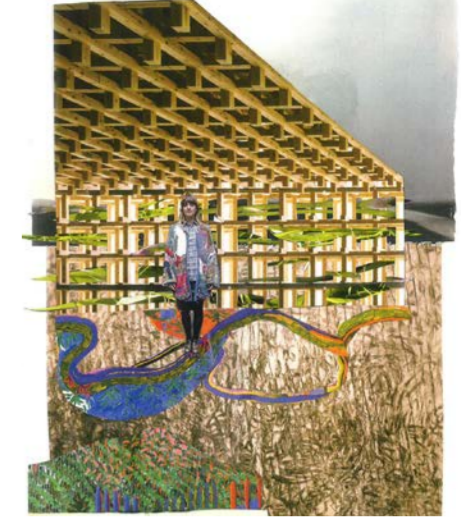

4. Nature

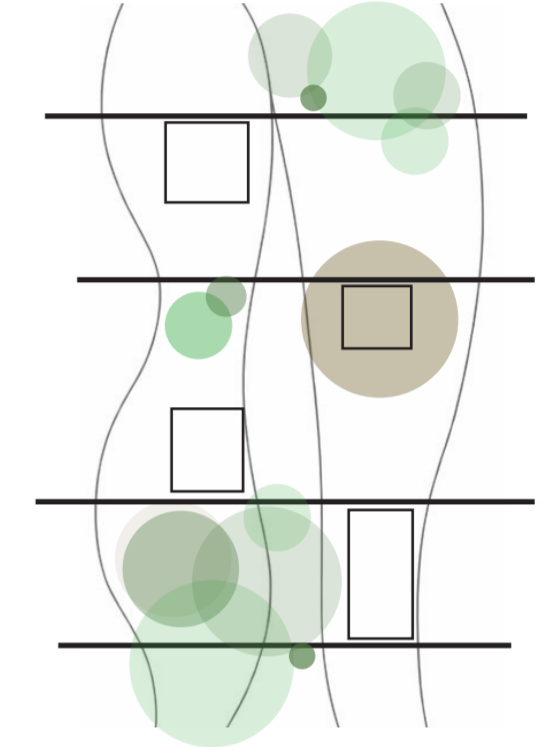
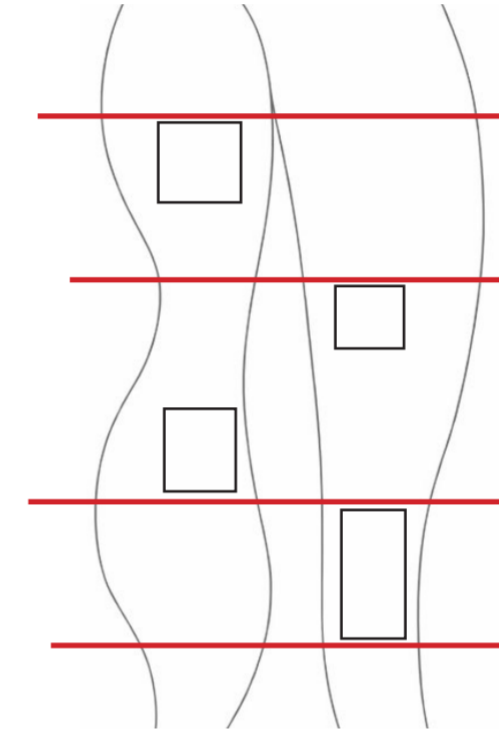
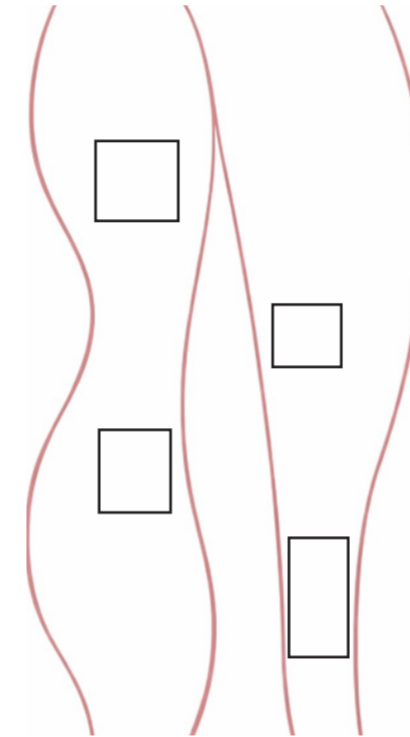
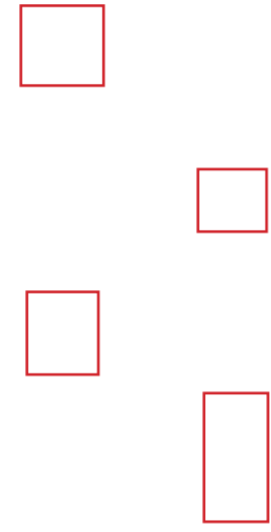
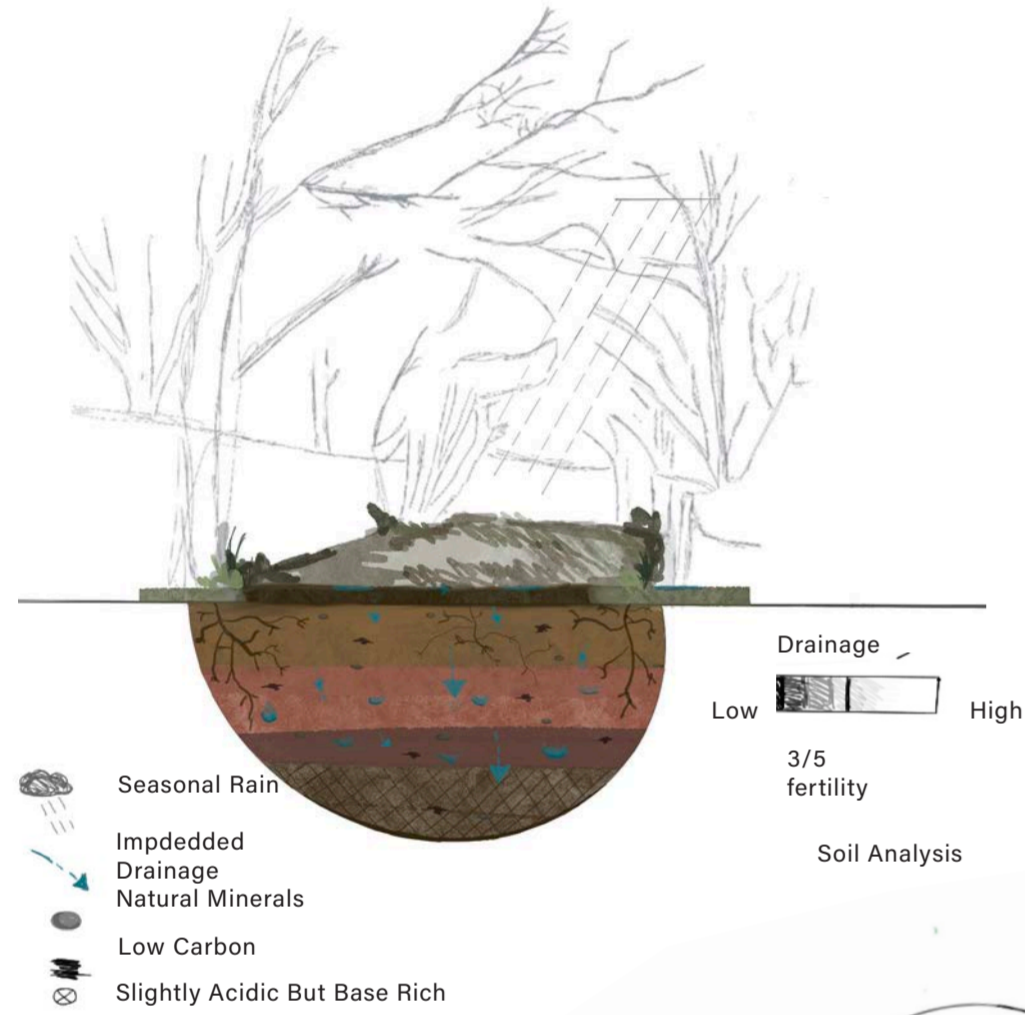

1. Flowing Guide

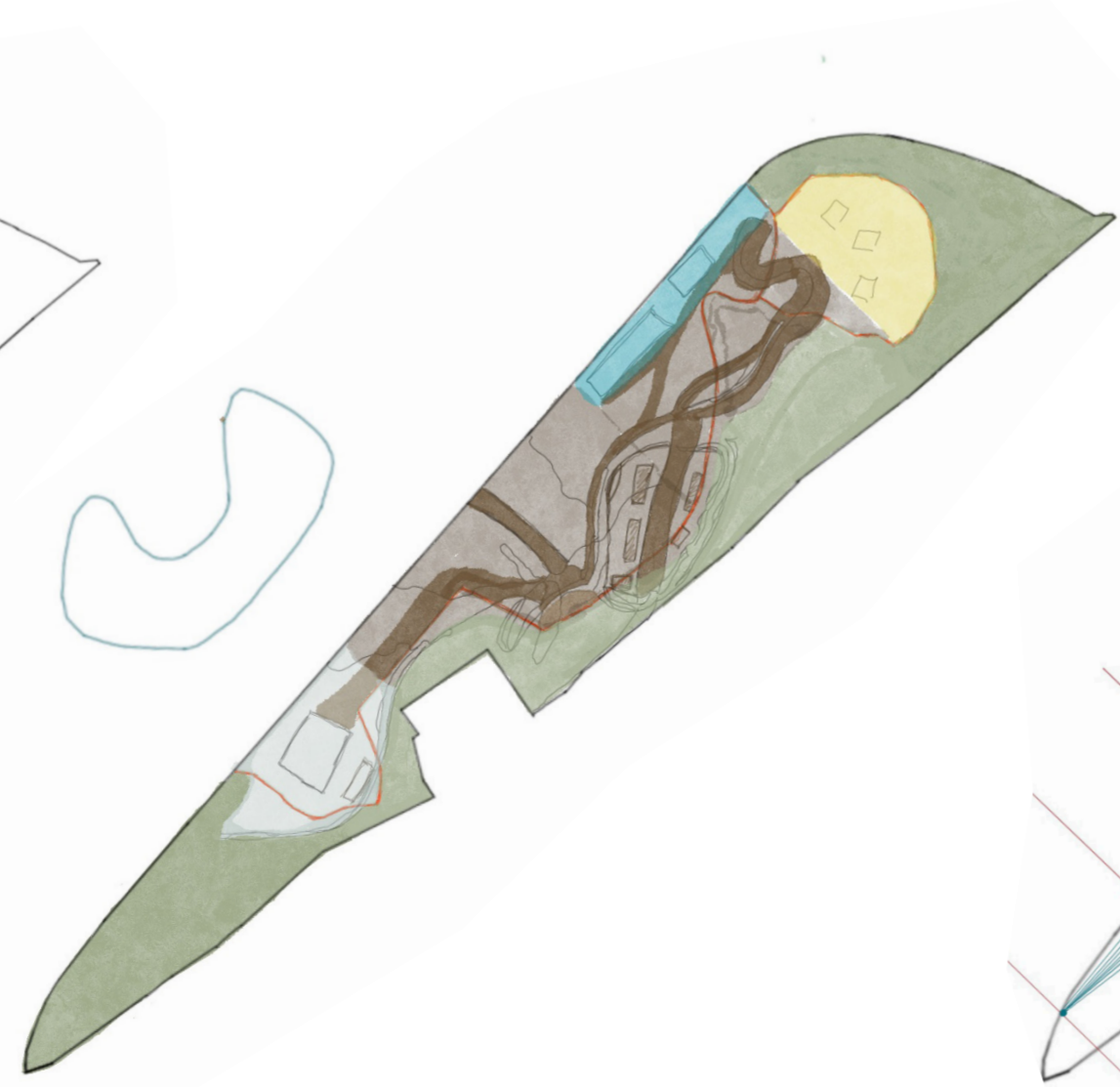

2. Zoning

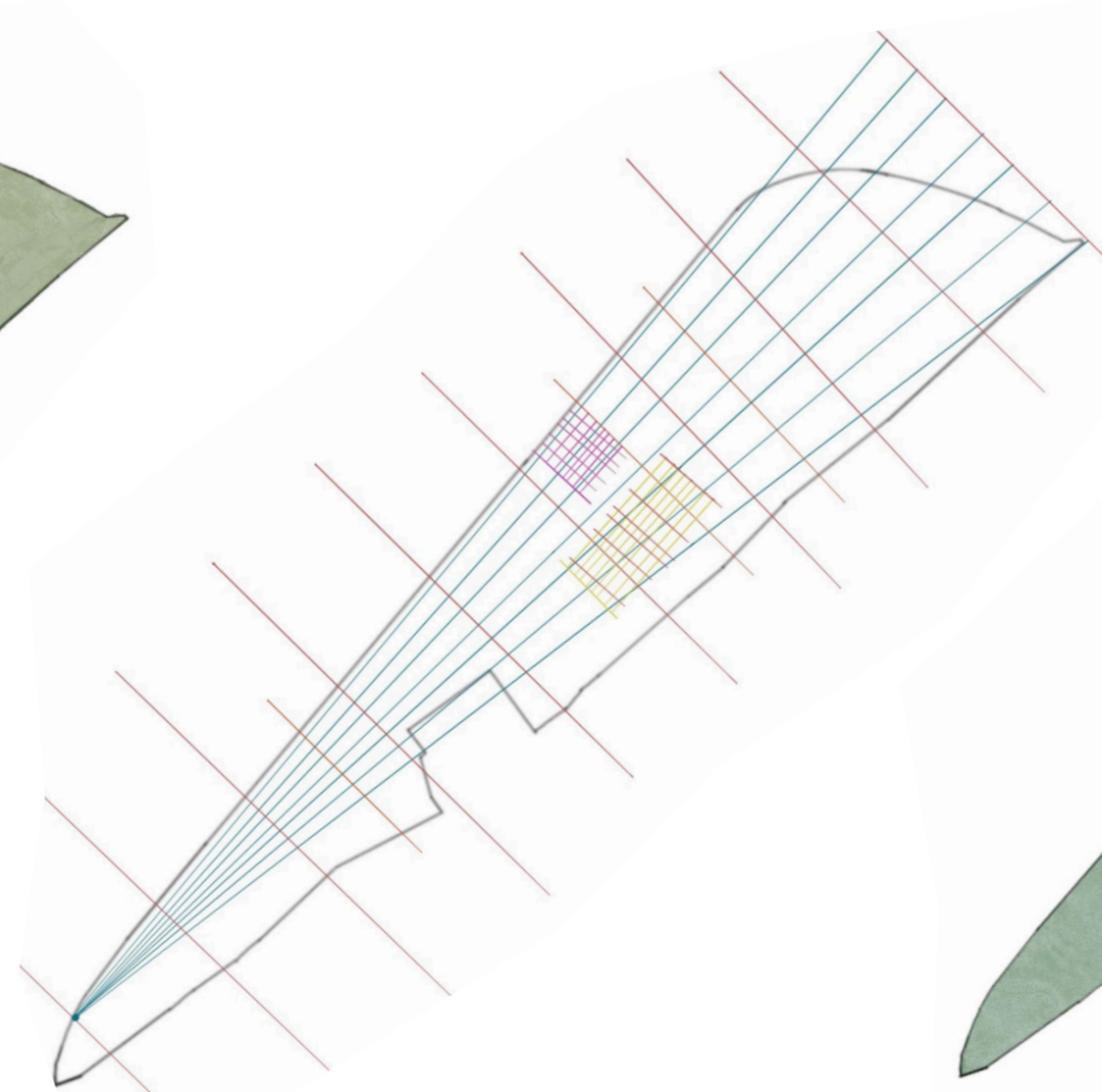

3. Proposed Grid

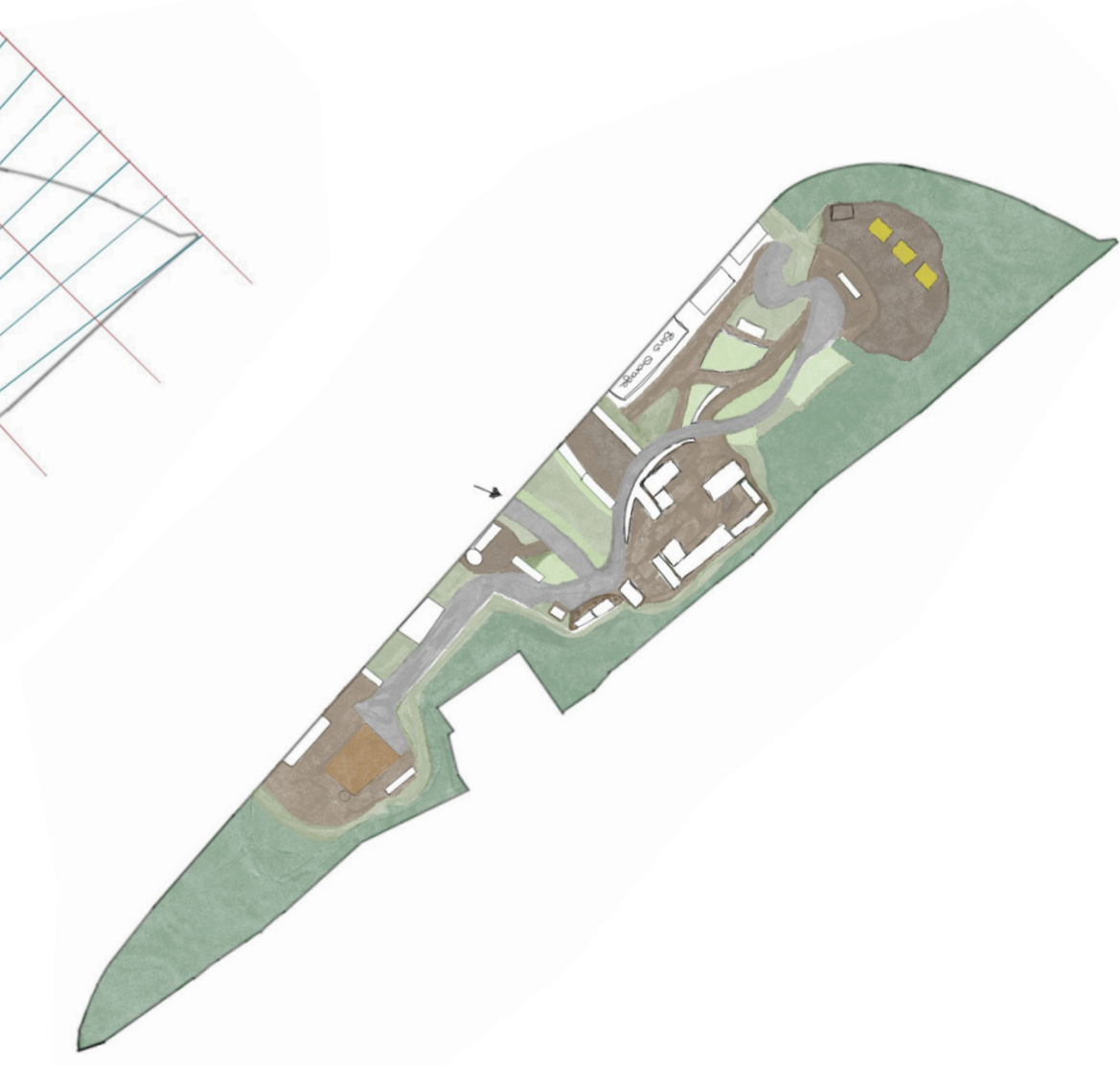

4. Proposed Sketch

Nature Woven In

By Ruby Cox

The masterplan establishes a framework for social and ecological regeneration across the site. New routes, gathering spaces and learning environments are integrated within the existing landscape, creating a new community space for everyone. Accessibility is embedded within the project from the earliest stages of design. Clear routes, inclusive thresholds and varied spaces for participation ensure that the Nature Club can be experienced by people of different ages, abilities and backgrounds. By reducing physical and social barriers, the proposal promotes fair access to nature, learning and community life.



Accessible Planter Design

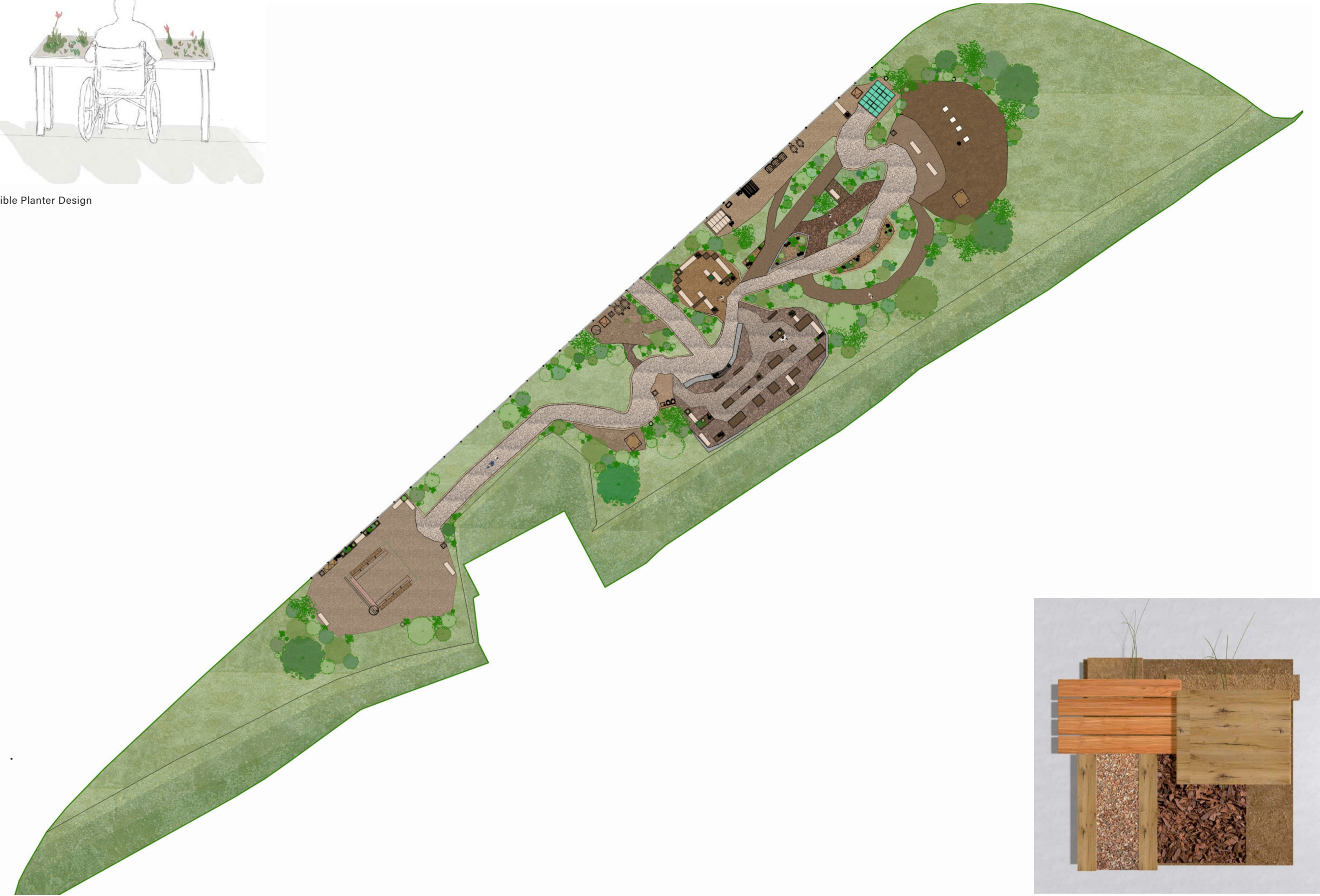

Proposed Master Plan



Final Visual- Collage



Materials



Proposed Site Section

Nature Woven In

By Ruby Cox

The pavilion design emerged from an exploration of materiality, landscape and form. Early collage studies informed spatial relationships and geometries, which were developed through a process of sketching and refinement. Inspiration was drawn from rammed earth construction and the layered qualities of the collages, while the timber lattice structure reflects patterns and textures identified during the design process. Formed as a space for education, gathering and rest, the pavilion encourages engagement with the natural environment. An integrated rainwater collection system supports environmental growth across the site, reinforcing the project's wider ecological strategy. The design aims to push coexistence between people and nature, creating an inclusive space that supports learning, wellbeing and biodiversity.

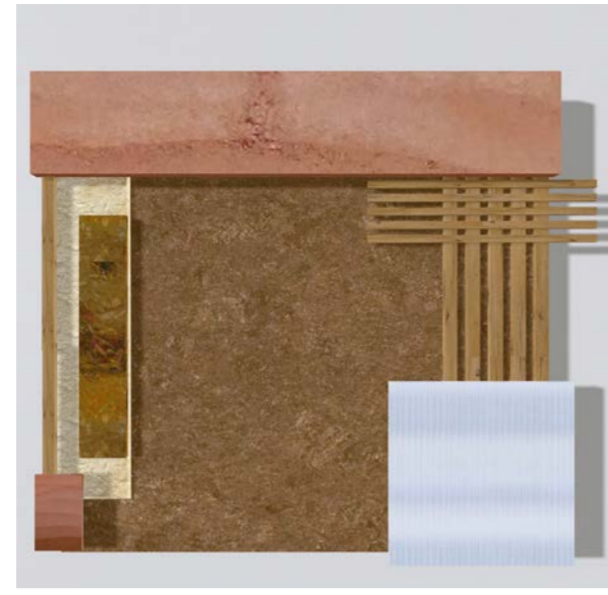

Materials

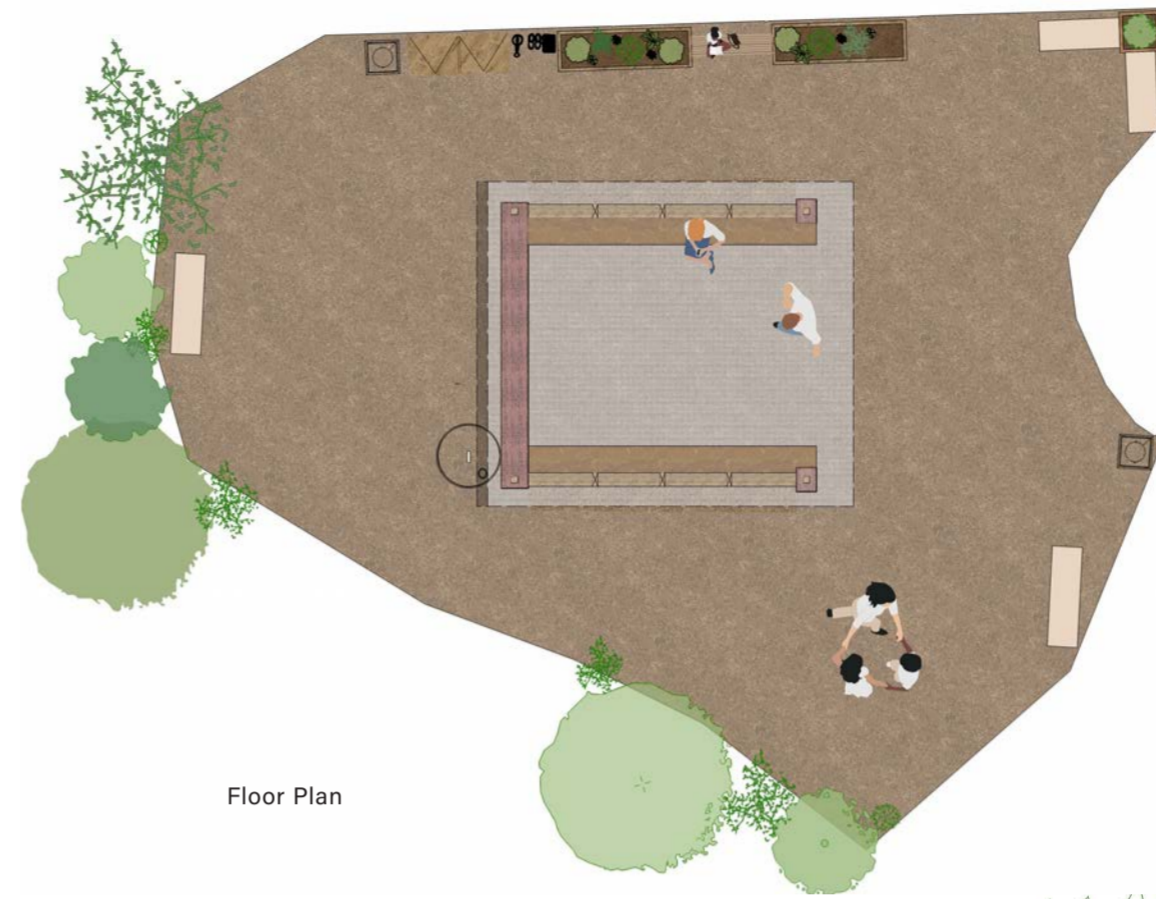

Floor Plan

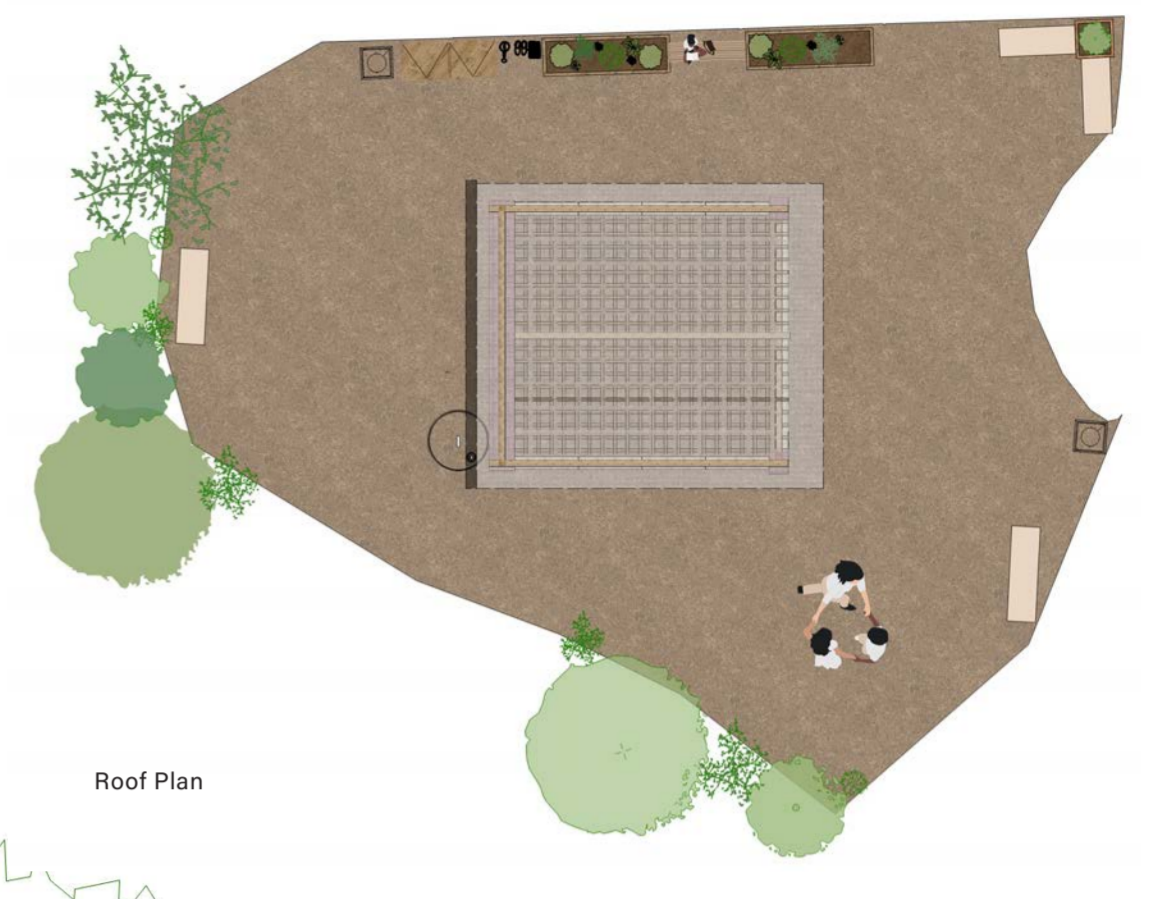

Roof Plan

Site Section



Concept Diagram

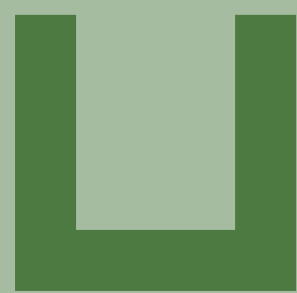

1. Stone Foundation

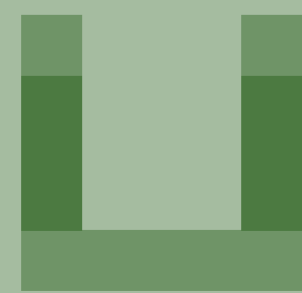

2. Rammed Earth Elements

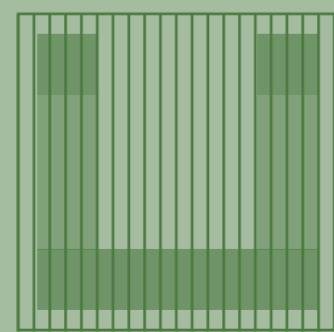

3. Lattice

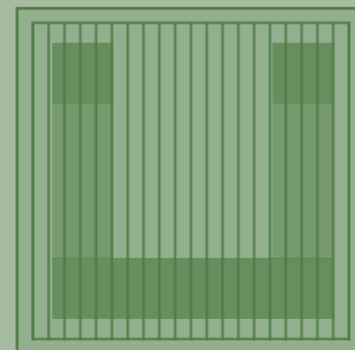

4. Polycarbonate

Nature Woven In

By Ruby Cox

The final visual captures the project's vision of coexistence, illustrating how the pavilion can support relationships between people, place and ecology. Through spaces for gathering, learning and observation, the Nature Club and Pavilion become catalysts for community engagement and environmental awareness. The proposal reimagines the site as a living landscape that evolves alongside the needs of both present and future generations. Returning to collage as a mode of representation, the visual reflects the methodology that informed the project's development from initial concept to final design proposal.



Briey (Concrete Cabin) Peter Doig, 1996



Model Image With Collaged Elements



Concept Collage



Final Visual