

KILELE

LOLLDAIGA • LAIKIPIA • KENYA

PROJECT DESCRIPTION

This project is to design a High-End luxury lodge for high net worth clients to come and escape the challenges of daily life and come and experience a safari like no other. Built on Lolldaiga in Laikipia, Kenya it brings the exclusivity that lots of these clients require. This project aims to provide my clients with an experience that they will never forget, with a range of activities it will be the perfect place of adventure and relaxation. The design will allow for this while allowing the clients to be completely immersed in nature. This will be done through the floor to ceiling glass windows allowing for unobstructed views of the landscape below along with using colours drawn from the traditional Samburu Tribe whose native land is only an hours drive from the site of the lodge.

There is also a strong concept story of “A Space of Stillness set above the plains” - which can be seen throughout the lodge, from the names of the bedroom to the very name of the lodge the concept is seen throughout this design and allows guests to feel fully immersed in their surroundings.



Lolldaiga is set in Laikipia in Kenya at the foothills of Mount Kenya. The closest town is an hours drive from the front gate of the ranch, this is where all supplies that can't be grown on site will be found. The area that I have chosen for the site of the lodge is on a hill with the rooms placed slightly lower than the top facing the mountain or the dam in the valley ensuring that there are unobstructed views whichever room you are in. It is a short drive from the airstrip where most of the clientele will fly into from Nairobi and is 1hr30mins flight from Nairobi in a private plane.

An important part of this project is the ability to maintain being off grid so looking into environmental factors such as the weather, the wind direction and the sun direction is vital. The data collected for this has allowed me to see that the measures that I have put into place to collect electricity and water will work in this site.

AVERAGE RAINFALL - LAIKIPIA PLATEAU

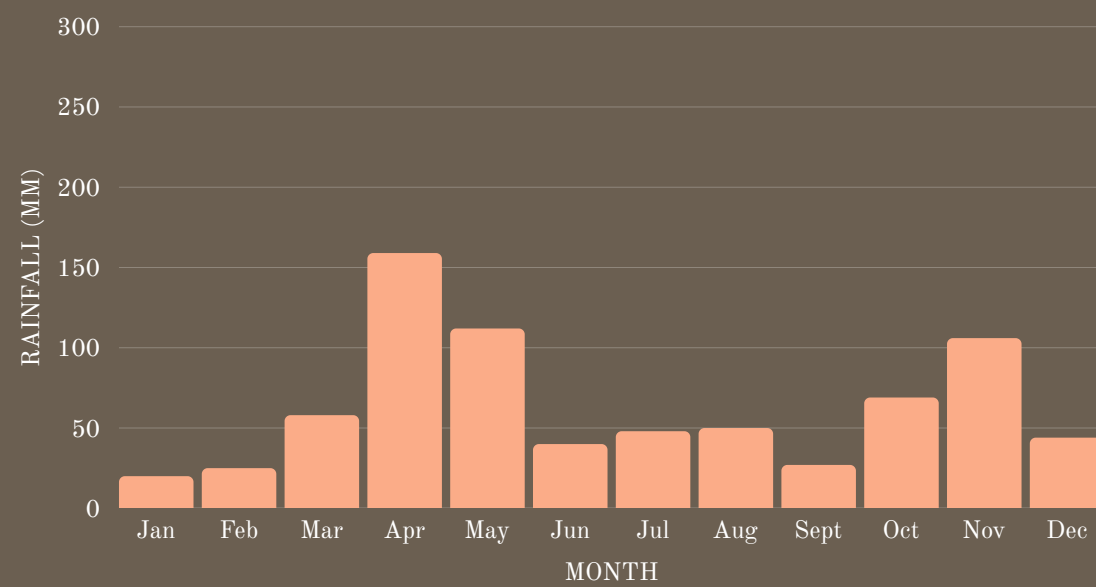

These graphs show the Average rainfall and temperature in the Laikipia Plateau which is where Lolldaiga Ranch is located. These figures depict not only the best time to visit the ranch but also potential opportunities for energy generating and maintaining water supply and storage. This shows that it would be possible for the lodge to be in the site planned and still remain off grid, generating its own electricity and water supply.

TEMPERATURE - LAIKIPIA PLATEAU

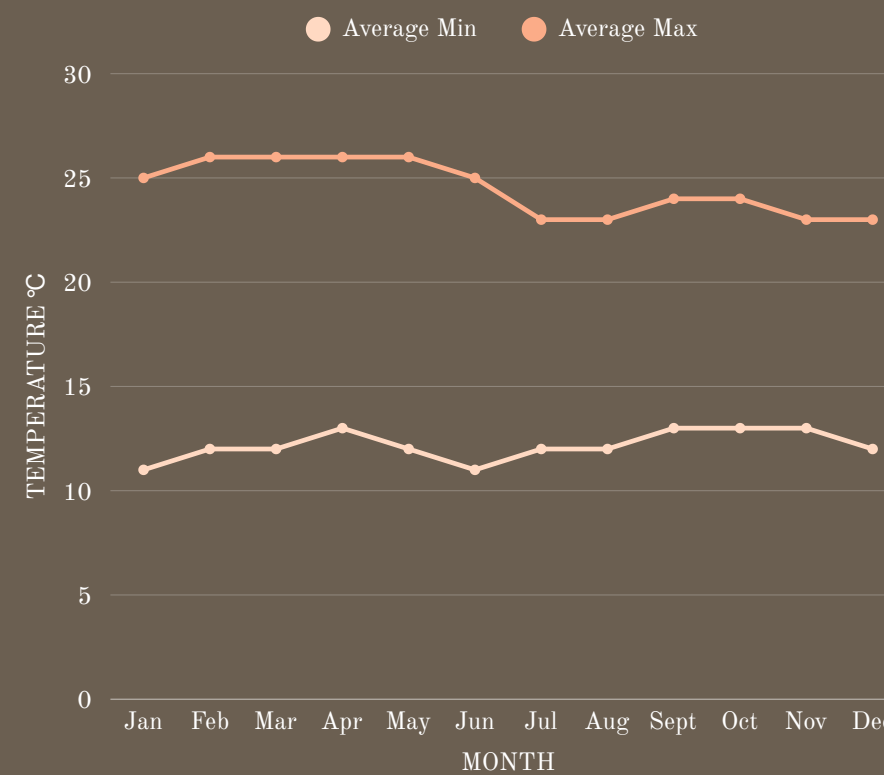

This diagram demonstrates the wind direction on the 1st of February throughout the day. While the speed of the wind varies throughout the day it stays coming from the East fluctuating from South East, East and North East.

This means that the wind will be Eastern facing, coming from the Ole Naishu side of the ranch. This is also the same for the rest of the week proving that the majority of the time the wind is Easterly facing. This means that if there are any wind catching systems for generating power they need to be facing the East to capture the majority of the wind.

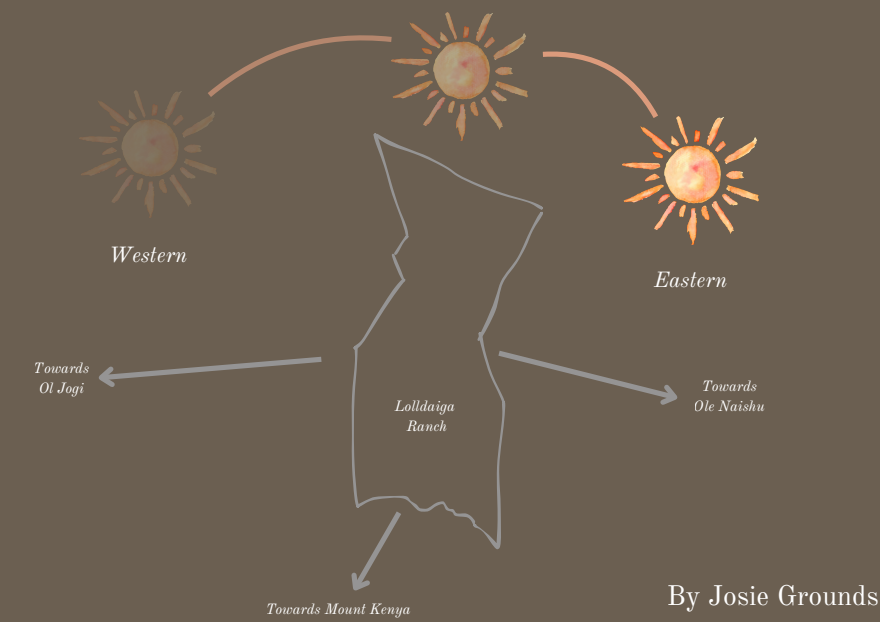

Lolldaiga as it is based just North of the Equator there is lots of sun throughout the day this means that there is lots of opportunity to use solar panels and other way of harvesting the sun to generate power to allow it to maintain off grid. This is important as it means that the lodge will have limited to no impact and will only use natural resources to keep it separate and self reliant.

The sun rises on the Eastern side of the ranch (towards Ole Naishu) and sets on the Western side (towards Ol Jogi Conservancy). Normally Lolldaiga, Laikipia gets about 7-9 hours of sun a day all year round.

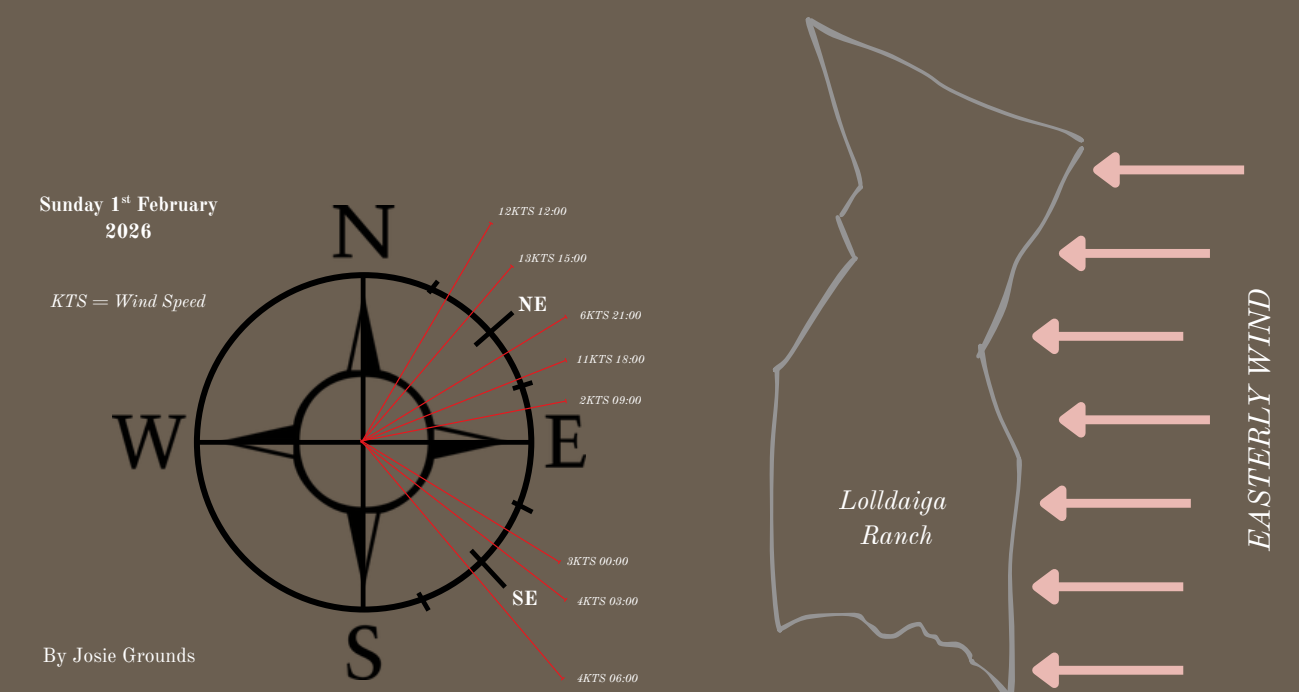

CANOPY COLLECTION



Kilele
Swahili ← → **Peak**
English

-A Space of Stillness set above the plains-

‘STILLNESS’

The concept story has been taken and used throughout the lodge. The ultimate stillness is the sky, this is embedded into the lodge because of the glass domes with the solar glass to be under the stars. There are also firepits under the stars to be under the night sky.

I have chosen the bedroom names based on tree types which I have named “The Canopy Collection”. Naming the bedrooms after the trees is fitting as the tree is the ultimate stillness above the ground/plains. It provides respite from the normal life on the ground, an escape.

‘PLAINS’

The aspect of the plains means remote and therefore offgrid. This means that electricity is generated on-site and using natural sources/resources. Therefore there must be less machines and electrical items which adds to the experience of it being a respite.

THIS COLLECTION HONOURS THE CONCEPT STORY OF ‘A SPACE OF SILENCE HIGH ABOVE THE PLAINS’. THIS REPRESENTS TREES AS THEY TOWER OVER THE PLAINS AND ARE A SPACE OF SERENITY AND QUIET GRANDEUR SO THEREFORE THE CANOPY COLLECTION IS THE CHOICE OF BEDROOM NAMES.

SAMBURU COMPOUND LAYOUT

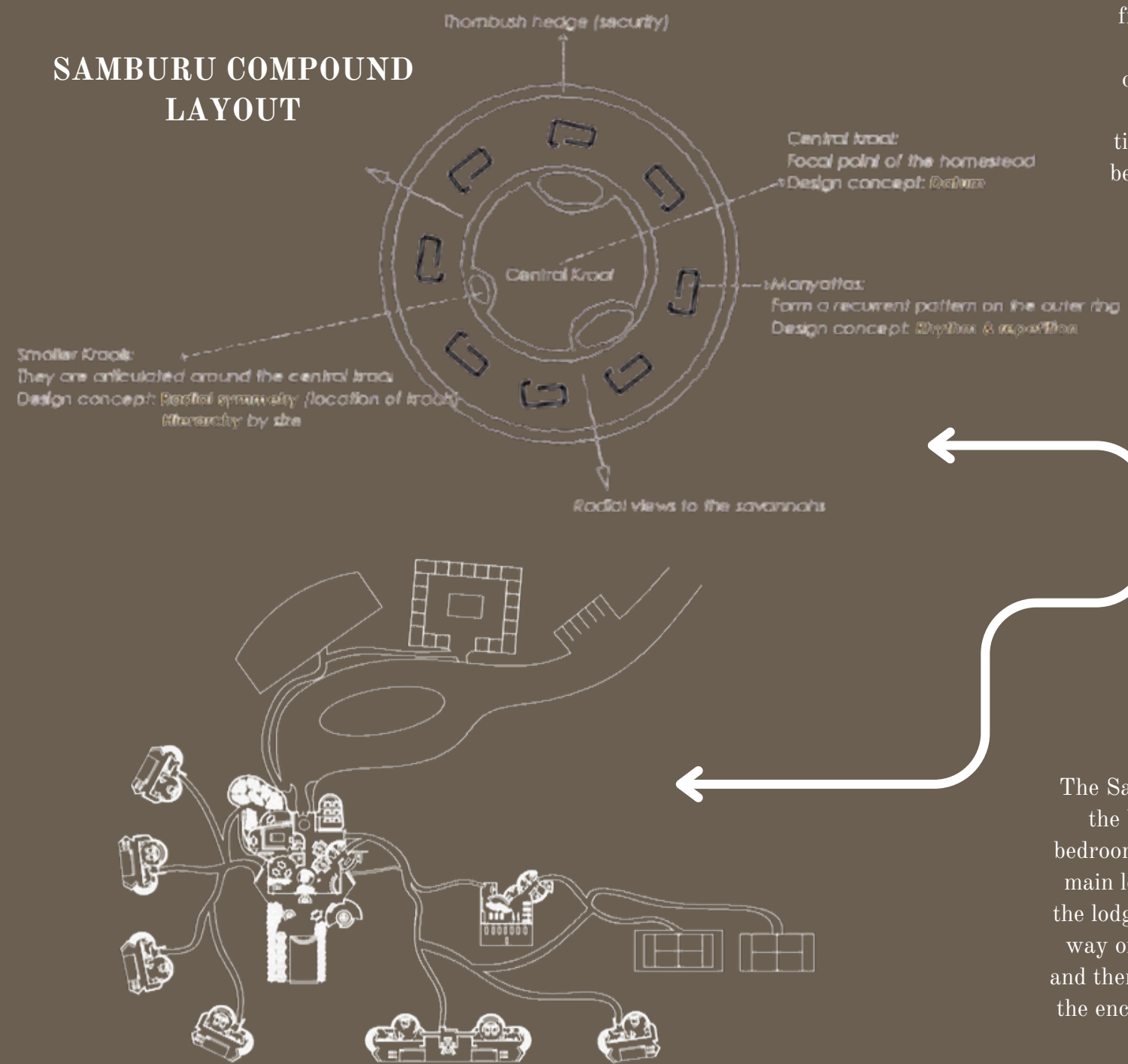

As Lolldaiga is so remote all power and water has to be generated on site. I have done this by using a water filter which filters the water from gutters that are running around the buildings. Once the water goes through the filter it gets stored in rainwater storage tanks and used in the showers and sinks where it then goes to be used in the toilets and then out to an onsite sewage treatment which is an anaerobic biodigester. The sun will be used to generate the electricity via solar panels and the solar glass which is what the glass domes on the buildings are made from ensuring maximum solar energy at all times. Any excess electricity will be stored particularly when the lodge is not in use but is still collecting solar energy so will be saved for when it is needed. To top it off there will be some wind collectors on the top of the stables which will be pointing to the East as that is where the wind direction comes from. These will be from the company Airturb using the Model 1 which is much more subtle in the landscape it will be placed and perfect for generating excess energy for the lodge.

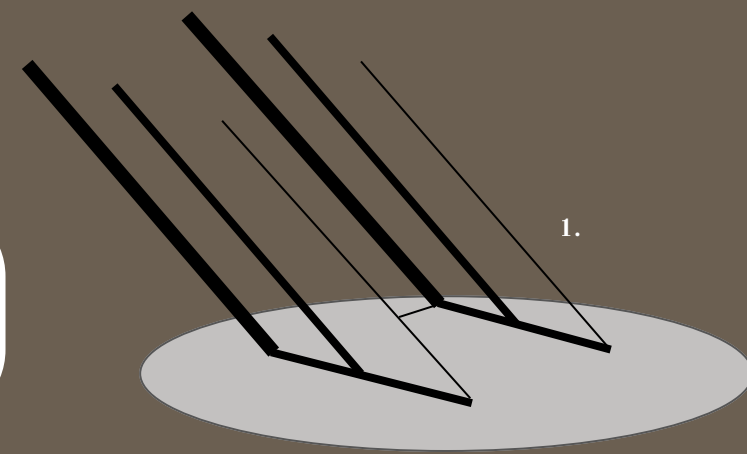

TIMBER POLES WITH METAL GUTTING AT THE FRONT TO CHANNEL THE WATER DOWN INTO THE MEMBRANE FILTER

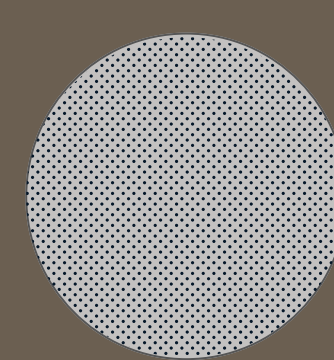

THE MEMBRANE FILTERS STOP THE DUST, SOLID PARTICLES AND ANYTHING ELSE FROM GOING INTO THE SYSTEM THAT WOULD STOP IT FROM RUNNING SMOOTHLY. IT DOES THIS THROUGH A SERIES OF FILTRATION TECHNOLOGY - MICROFILTRATION, ULTRAFILTRATION, NANOFILTRATION AND REVERSE OSMOSIS

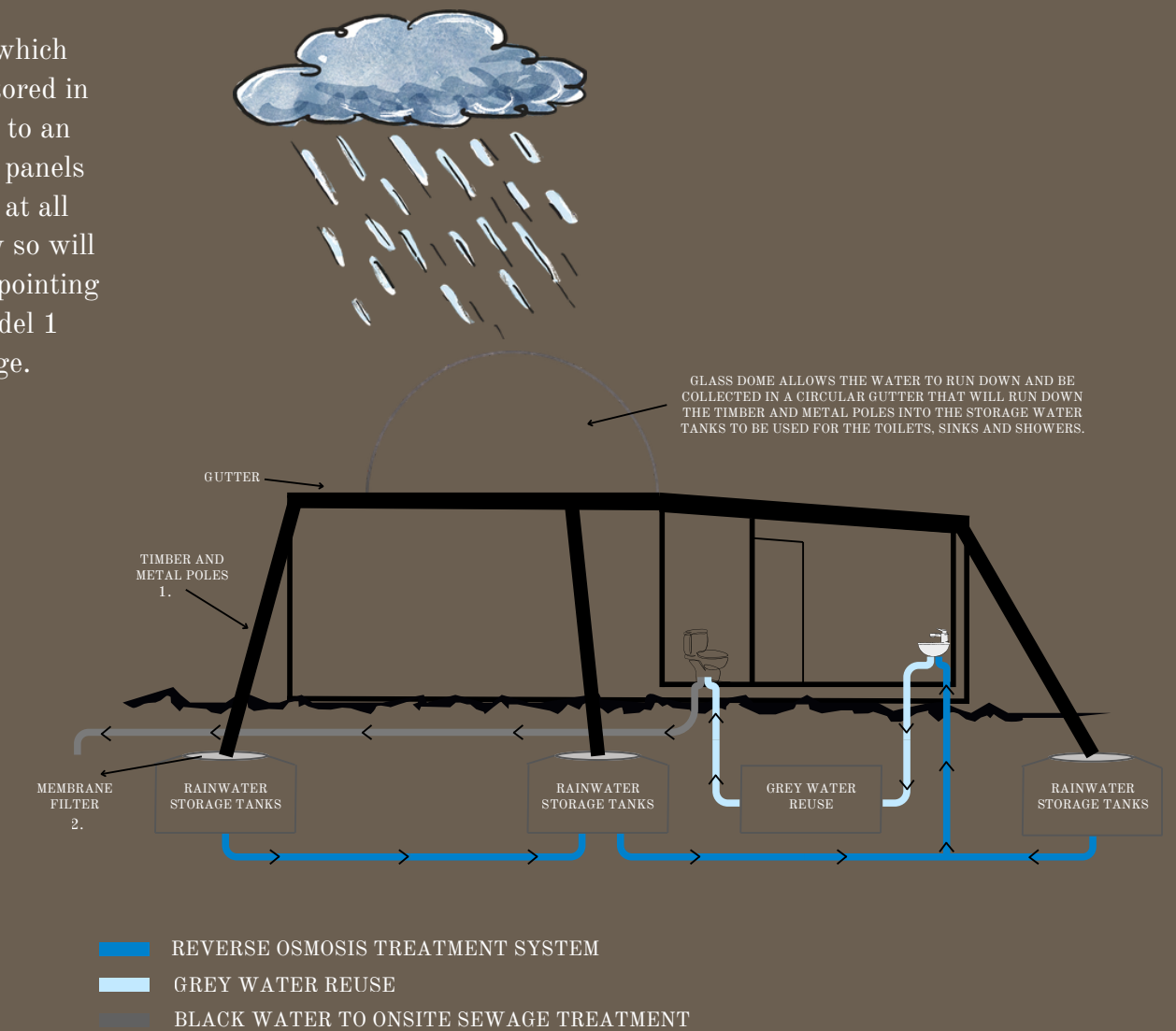

The Samburu Tribe has influenced the shapes of the buildings. There is a dome on all of the bedrooms and then there is multiple domes on the main lodge. It has also had an influence on how the lodge footprint is, the Samburu have a certain way of laying out their homes around the outer and then the cattle and the animals on the inner of the enclosure to protect them from predators and from cattle rustlers.

I looked at the needs of the guests and then designed from there using the Samburu tribal influences. For example when looking at designing Kilele I looked at the way that the Samburu Tribe lays out their compounds and tried to mirror Kilele site in the same way. The Samburu Tribe has also had an influence on the colours in the fabrics and materials in the lodge using the colours of the beads that they create their jewellery from, blues, reds, yellows, oranges and greens. The red of the ochre dye that the tribe uses to dye their hair can be seen in the colour palette in the Main Lodge and in the double bedroom within the Family Room.

Guests come and stay for unforgettable safaris so therefore wildlife and unobstructed views play a major part in the feel of this lodge. I have ensured that this is felt through the large floor to ceiling windows throughout the lodge overlooking the beautiful Lolldaiga making it feel as though it is in the room with you. I have also ensured that the animals are all around you through the wildlife drawings on the wall done by Kenyan artist Andrew Kamiti.

GUESTS

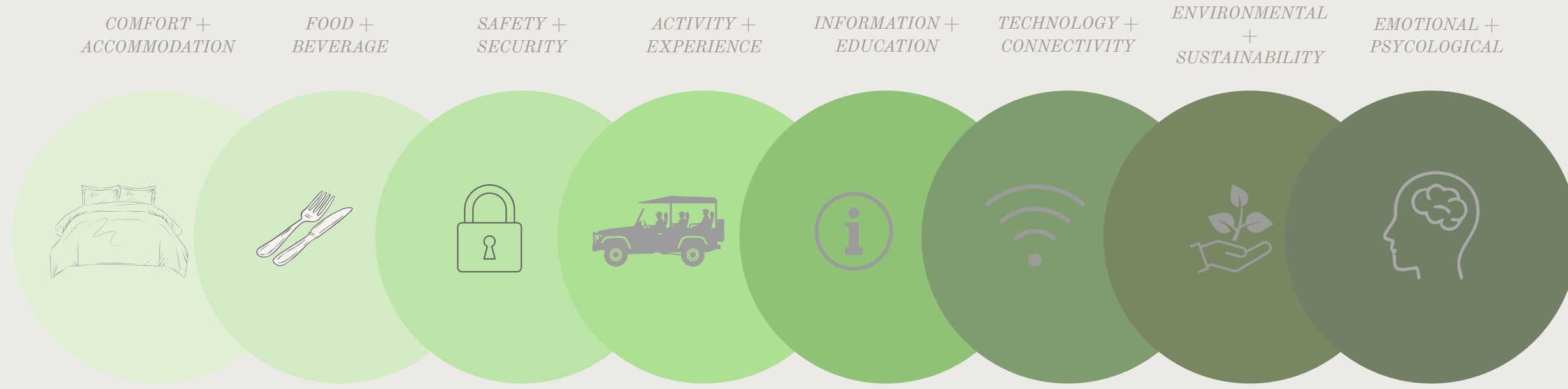

COMFORT + ACCOMMODATION



- Comfortable bed
- Mosquito net
- Hot water
- Climate control
- Quiet at night
- Secure storage
- Charging ability

FOOD + BEVERAGE



- Breakfast
- Lunch
- Dinner
- Snacks when needed
- Safe drinking water at all times
- Dietary accommodation

SAFETY + SECURITY



- Escort to rooms at night
- Secure storage for valuables
- Briefings on animal behaviour
- Secure fencing/natural barriers
- Armed/trained professional guards at night
- First aid trained staff
- Emergency evacuation plan
- Medical support/evacuation if needed

ACTIVITY + EXPERIENCE



- Guided game drives
- Knowledgeable guides
- Walking safaris

INFORMATION + EDUCATION



- Conservation
- Animal behaviour
- Identification of species
- Cultural context about local communities

TECHNOLOGY + CONNECTIVITY



- Wifi in main areas
- Charging stations
- Backup power during outages

ENVIRONMENTAL + SUSTAINABILITY



- Solar power
- Reduced/no plastic
- Water conservation systems
- Local employment + community support
- Ethical wildlife practice

EMOTIONAL + PSYCHOLOGICAL



- Adventure + safety
- Personal attention
- Relaxation
- Connection with nature
- Memorable moments

Each person at the lodge has different needs, for example the guests need are very different to the general lodge staff and that is then different still to the safari guides. All of this needs to be taken into consideration.



One of the activities and experiences is a horseback safari where you can enjoy the animals up close recognised as another animal.



You can also enjoy safaris from the safety of a vehicle with an experienced safari guide who can track down animals and is a fountain of knowledge about the land and animals around them.

MAIN LODGE



This entrance is important as it is the first part of the safari lodge experience and 'home' for the guests for the duration of their stay.



This is the entrance seating where guests can enjoy some refreshments after a dusty game drive.



This fireplace is a lovely place to sit in the evening before or after dinner with a drink, chatting or playing board games.



The dining room is where all meals are eaten and then in the evening can be followed up with a game of pool.



You can go for a swim in the pool and then sunbathe on the sun beds in the heat of the day.



Enjoy the views over the savannah and try to spot animals from the sun beds.

FAMILY ROOM



The family room has two swimming pools to allow for members of the family to split up and enjoy privacy.



The family room has a double room with an ensuite and an outdoor shower. The bed has beautiful views over the savannah.



Both the twin room and the double rooms have glass domes to watch the stars as you fall asleep.



The twin room has a walk in shower while the double room has a large bath.



Both rooms have an outdoor shower surrounded by plants for a different experience 'showering under the stars.'



The pools are well lit for swims in the evening as well as in the day.

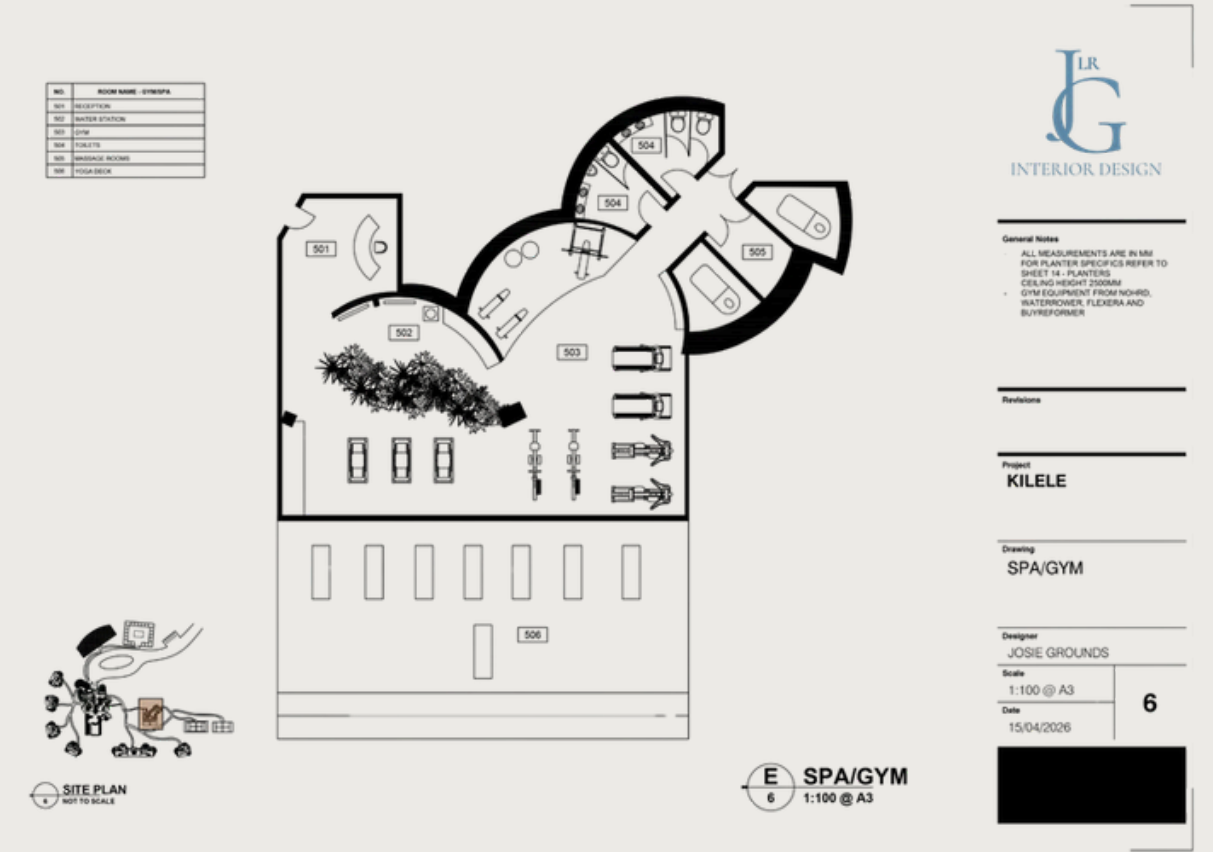
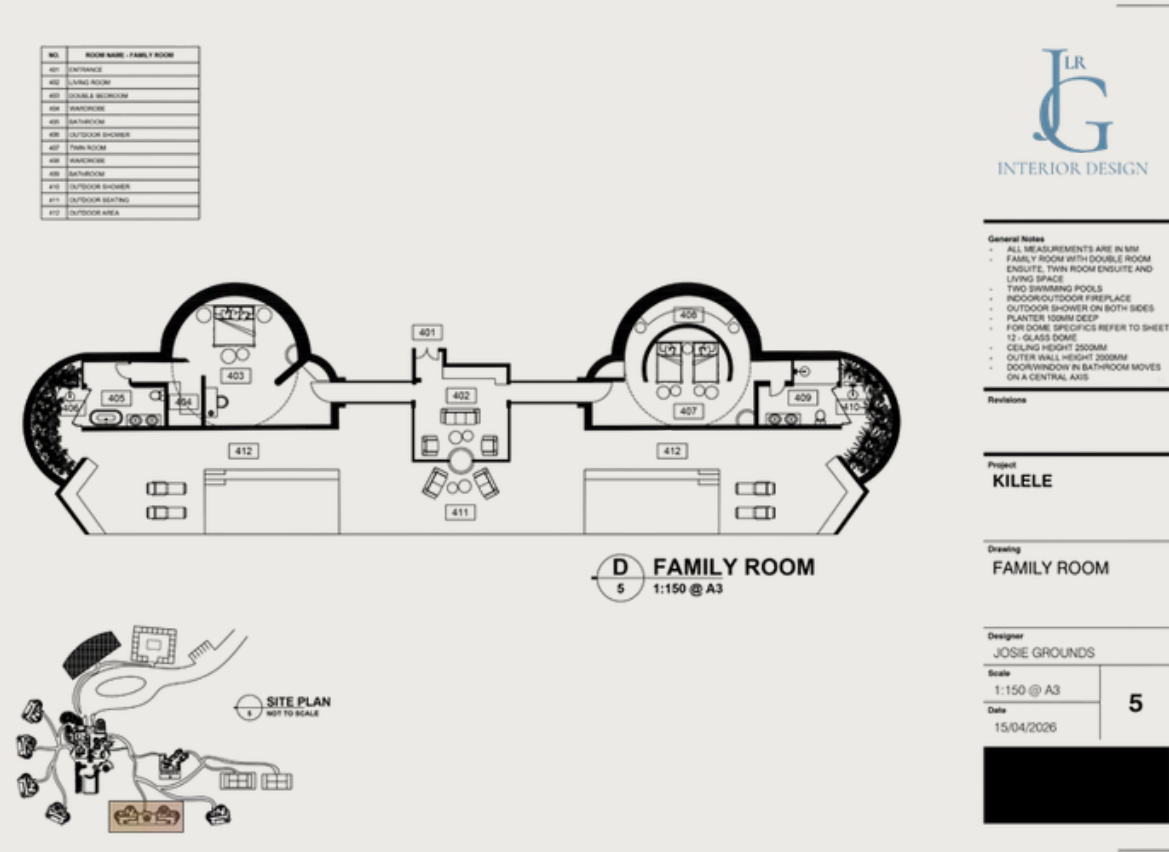
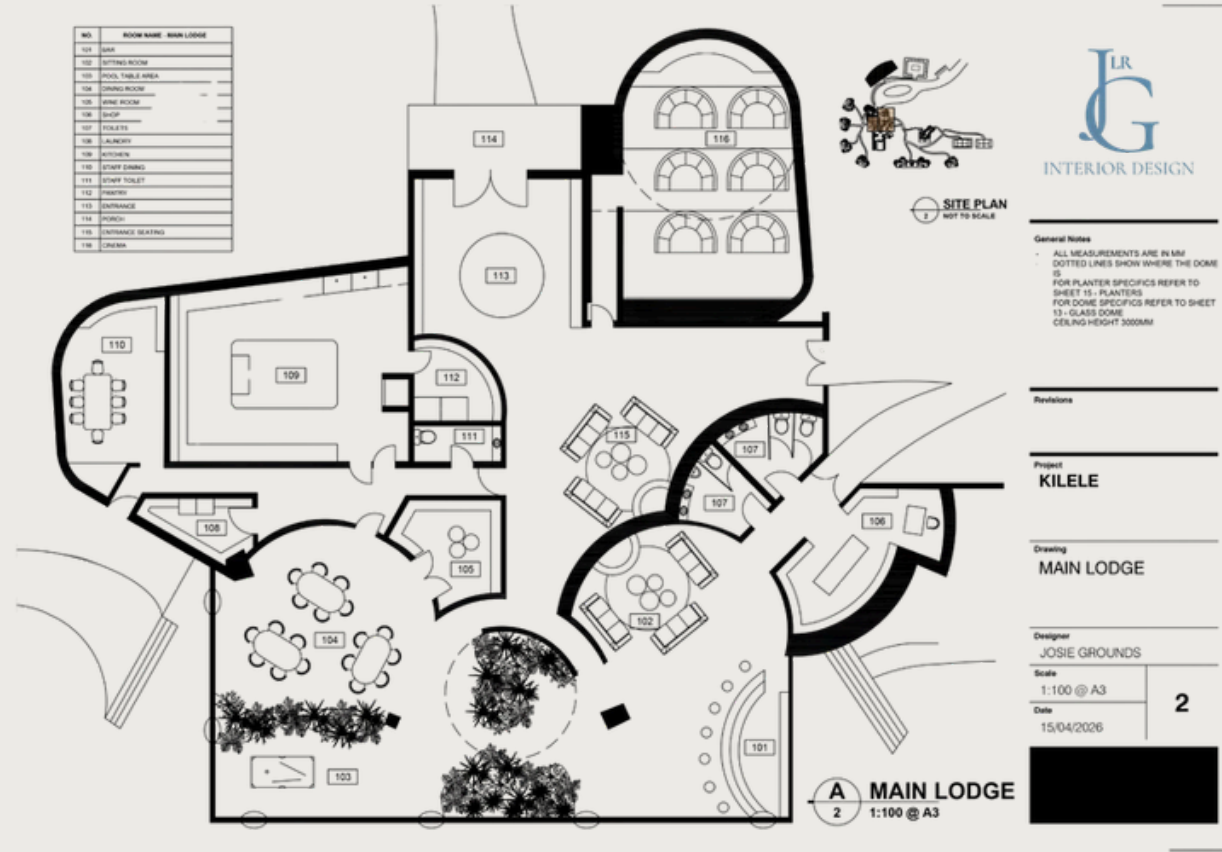

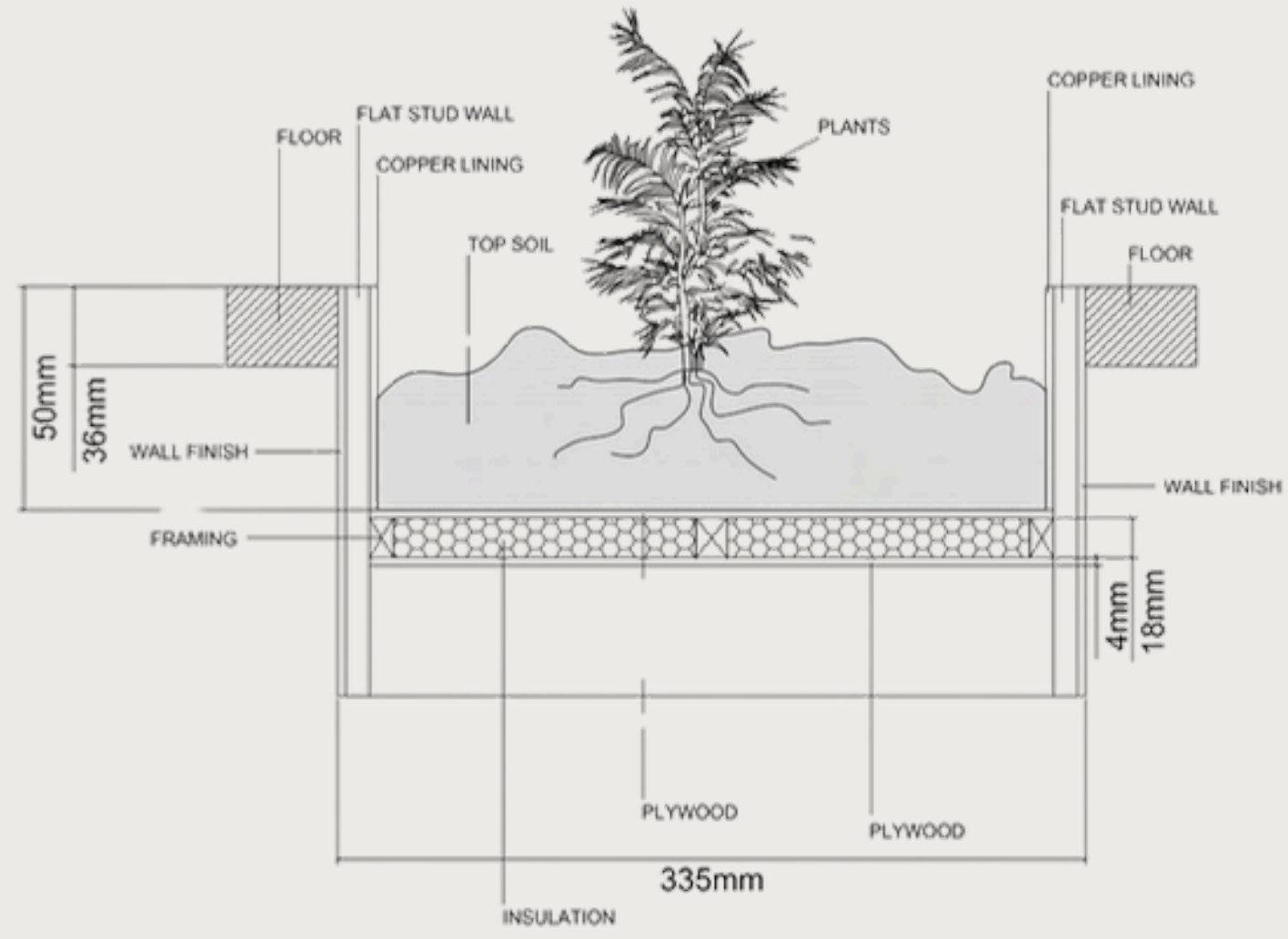

4 Planters in Floor
15 1:2 @ A3

JR G INTERIOR DESIGN

General Notes

- ALL MEASUREMENTS ARE IN MM
- THESE ARE THE PLANTERS THAT ARE IN THE FLOOR IN THE MAIN LODGE AND THE SPA/OTM
- MULTIPLE PLANTS IN THE PLANTERS
- KENYAN NATIVE PLANTS

Revisions

Project
KILELE

Drawing
DETAIL 4 - PLANTERS IN THE FLOOR

Designer
JOSIE GROUNDS

Scale
1:2 @ A3

Date
15/04/2026

15

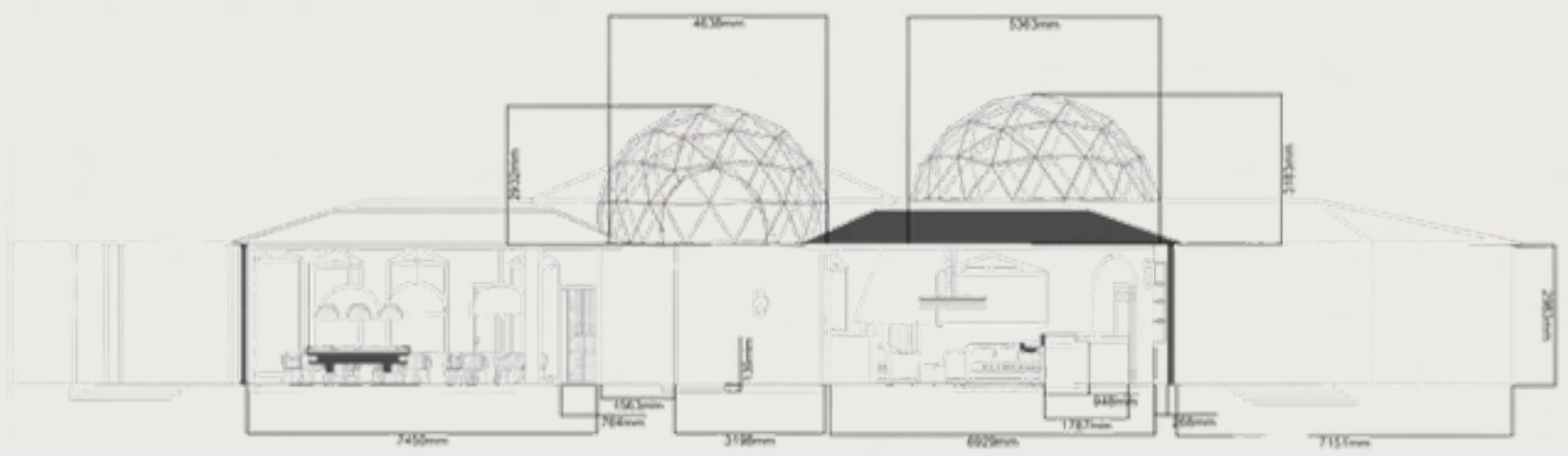

A1 Front View
18 1:100 @ A3

JR G INTERIOR DESIGN

General Notes

- ALL MEASUREMENTS ARE IN MM
- THIS IS A SECTION FROM THE POOL SIDE LOOKING TOWARDS THE MAIN LODGE SHOWING THE CROSS SECTION OF THE BAR AND THE BACK BAR AND THE DINING ROOM
- PLANTER DEPTH 138MM INTO THE FLOOR

Revisions

Project
KILELE

Drawing
MAIN LODGE FRONT VIEW SECTION

Designer
JOSIE GROUNDS

Scale
1:100 @ A3

Date
21/04/2026

18

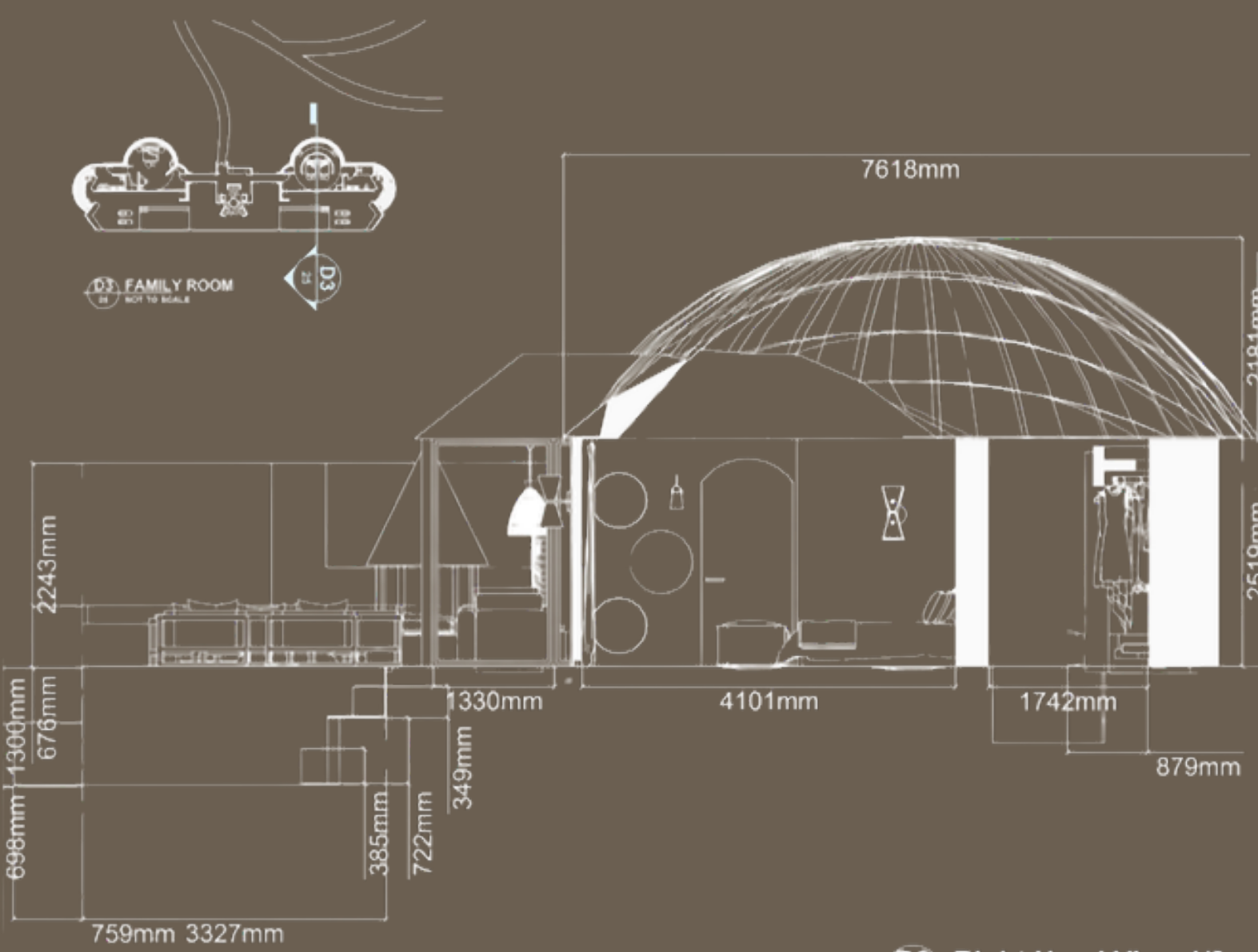

D3 Right Hand View 1/3
25 1:40 @ A3

JR G INTERIOR DESIGN

General Notes

- ALL MEASUREMENTS ARE IN MM
- THIS IS A SECTIONAL CUT THROUGH THE TWIN ROOM IN THE FAMILY ROOM (L.S. FROM THE RIGHT AND SHOWS THE DEPTHS OF THE POOL AND THE VIEW LOOKING FROM THE RIGHT IN THE TWIN ROOM)

Revisions

Project
KILELE

Drawing
FAMILY ROOM RIGHT HAND VIEW SECTION 1/3

Designer
JOSIE GROUNDS

Scale
1:40 @ A3

Date
21/04/2026

25

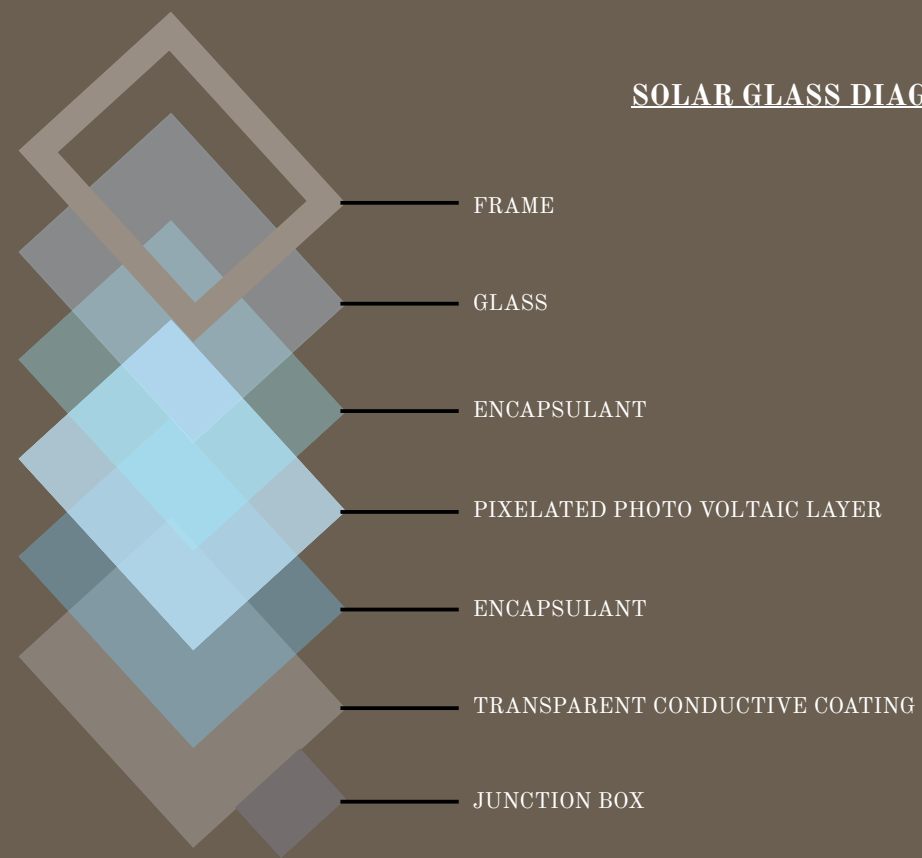

SOLAR GLASS DIAGRAM

THE GLASS DOME ON THE TOPS OF THE BEDROOMS ABOVE THE BED SO THAT THEY CAN STAR GAZE WHEN LYING IN BED. BY USING THE SOLAR GLASS IT MEANS THAT ELECTRICITY IS BEING COLLECTED WITHOUT ANY EFFORT DUE TO THE HIGH LEVEL OF SOLAR ENERGY THROUGHOUT THE DAY.

THE SOLAR GLASS WORKS TO COLLECT THE SOLAR ENERGY THROUGHOUT THE DAY DUE TO THE HIGH UV RAYS THAT LOLDAIGA GETS THROUGHOUT THE YEAR. THE JUNCTION BOX WILL GO INTO A POWER STORAGE TO THAT EVEN WHEN THE GUESTS AREN'T THERE THERE WILL BE AN ABUNDANCE FOR THE NEXT GUESTS AS IT WILL BE STORED AND ALWAYS COLLECTING.

THE DOME WILL HAVE AN ELECTRIC COVER THAT GOES OVER THE INNER OF THE DOME TO ALLOW THE GUESTS THE CHOICE OF A DARK ROOM AT NIGHT. EVEN WHEN THE COVER IS CLOSED IT STILL COLLECTS THE SOLAR ENERGY AND IS ABLE TO USE IT FOR THE ROOM.

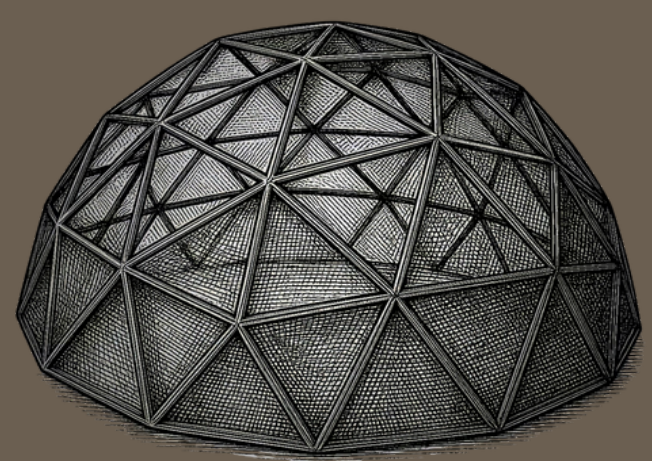

WITH COVER

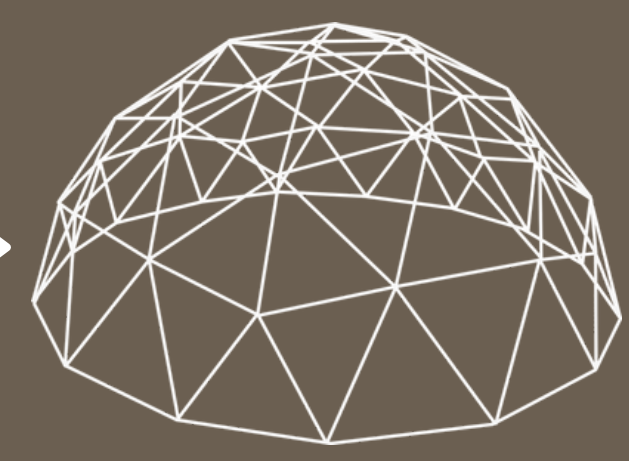

WITHOUT COVER