



Kat Sanchez's work

Surreal Landscape

The brief for this project, Surreal Landscape, is to develop a design proposal that aims to create an engaging public exhibition space at Sheffield Midlands Train Station, inspired by artist Katrina Sanchez's exploration of structure, movement, and play. Merging art, design, and public interaction, the exhibition transforms the station's cycle hub into a dynamic space that enhances the station's identity and fosters cultural engagement.

The design will reflect the station's physical, environmental, and cultural context, incorporating themes of motion and connectivity. It prioritises visitor experience, offering a meditative, immersive environment where art and travel intersect, allowing exploration and escape from daily chaos. The exhibition seeks to provide unique, ever-changing experiences, transforming the space into a memorable cultural landmark that leaves a lasting impression on its visitors.



Interpretation of artists work - hand knitted

Site analysis



- 1 Site - Sheffield Train Station
- 2 A61 Ring Road
- 3 South Street Open Space
- 4 Showroom Cinema
- 5 Pond Street
- 6 Surrey Lane
- 7 Howard Street
- 8 Sheffield Hallam Students Union
- 9 Sheffield Hallam University - City Campus
- 10 Ovens Building
- 11 Harmer Lane

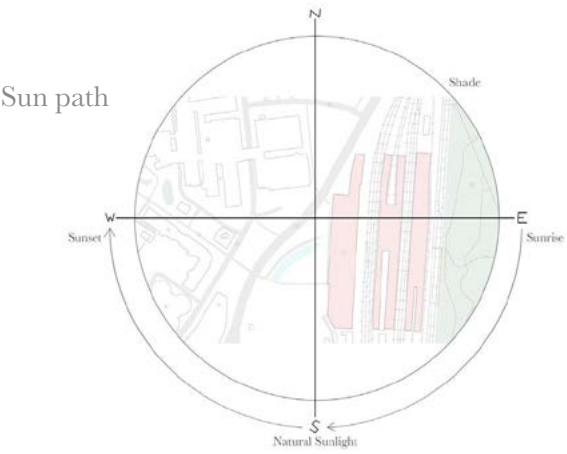

Sun path



Early conceptual visualisations

Site photos



Existing building analysis



Roof structure analysis

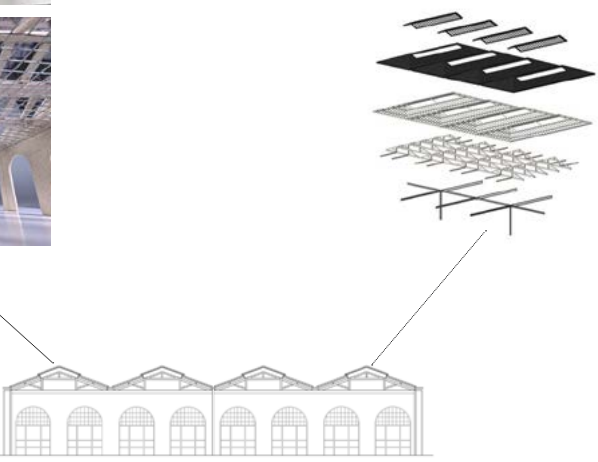
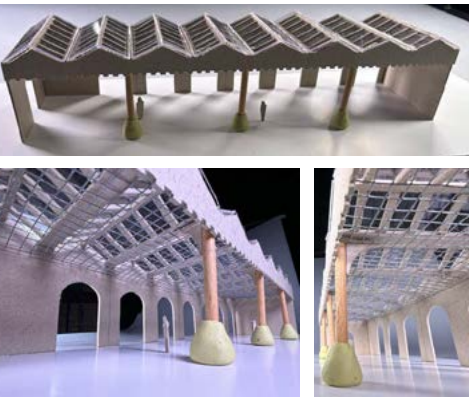

Development Work

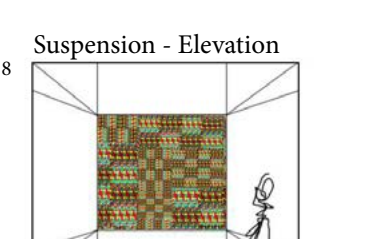
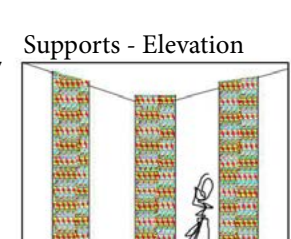
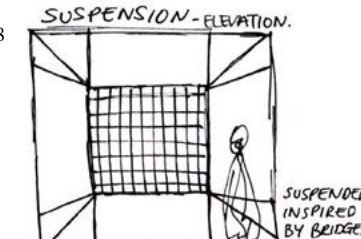
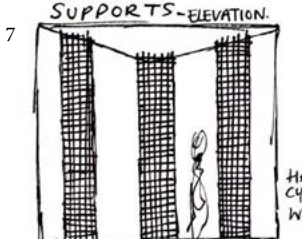
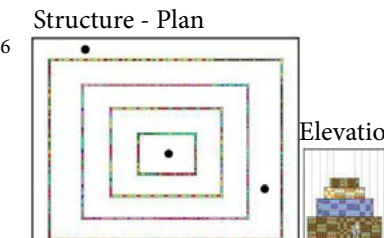
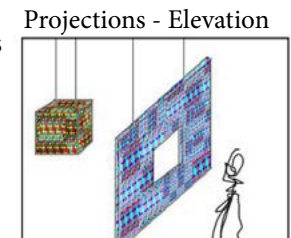
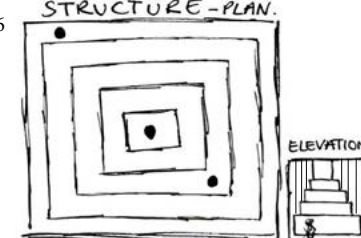
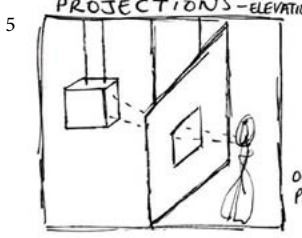
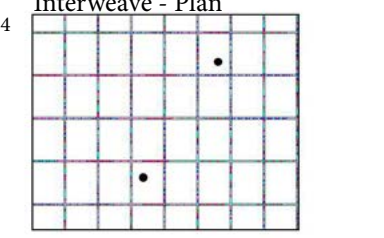
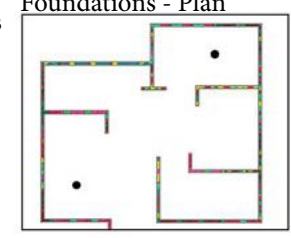
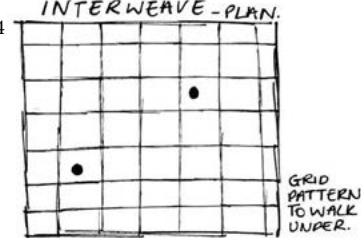
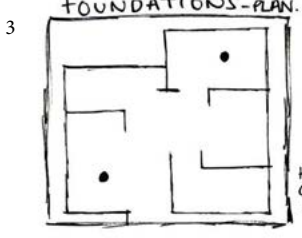
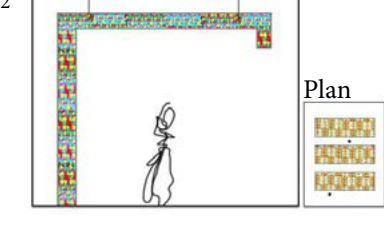
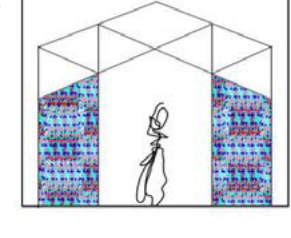
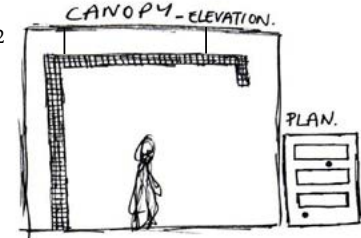
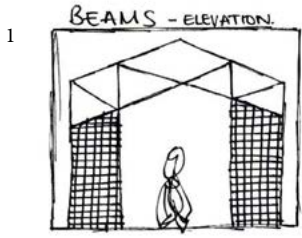

1. Beams

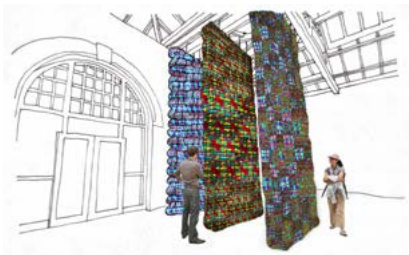

2. Canopy



3. Foundations

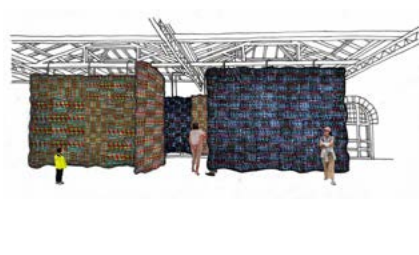

4. Interweave



Materials Board



Precedent Study



The Brutalist Playground is a unique fusion of architecture, art, and nostalgia, inspired by the post-war Brutalist design movement. Created as an interactive installation by Assemble Studio and artist Simon Terrill, it reimagines mid-20th-century concrete playgrounds in soft, foam forms, offering a playful and tactile experience. These structures celebrate the bold, geometric shapes of Brutalist architecture while exploring its social ambitions and its legacy in urban design. The combination of structure and play within this design is something that I feel I have reflected within my proposal, creating a surreal landscape for the visitors of the exhibition.

Proposed Floorplan

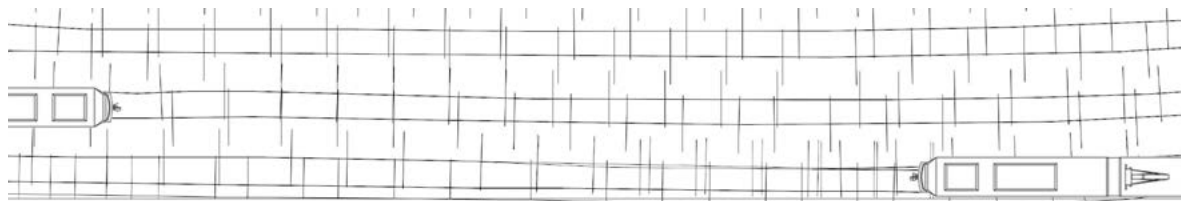

Scale Bar 0 5 10 15 20m

Key for proposed floorplan:
1 Beams 7 Supports
2 Canopy 8 Suspension
3 Foundations 9 Knitted entrance/exit
4 Interweave 10 Canopy/Taxi rank
5 Projections 11 Train platform
6 Structure

Proposed knitted entrance/exit



Kat Sanchez's wall mural



My interpretation of Sanchez's wall mural as a drawing



Images of knitted entrance/exit based off mural drawing added to site model at scale 1:50

Reflected Ceiling Plan

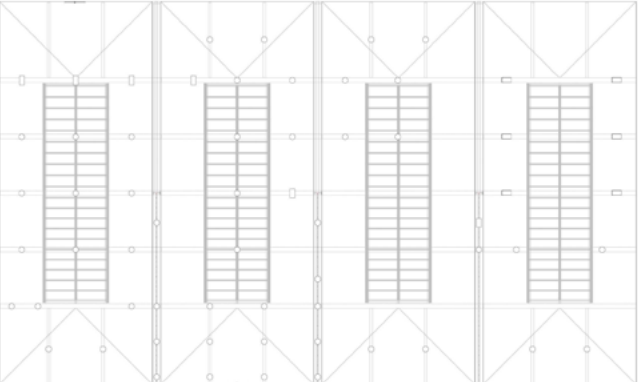

Scale Bar 0 5 10 15 20m

Key:
○ Spotlights
□ Floodlights
— Light switch panel

Scale Bar 0 5 10 15 20m

Section 2 showing the proposal through the building with the context of the train platform, canopy and taxi rank.

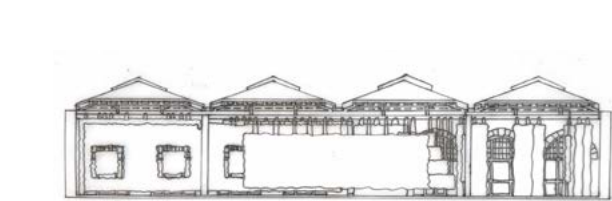

Scale Bar 0 5 10 15 20m



Section 3 showing the length of the building from the back view of the site.

Scale Bar 0 5 10 15 20m



Section 4 showing the length of the building from the front view of the site.

Key for where sections are taken:

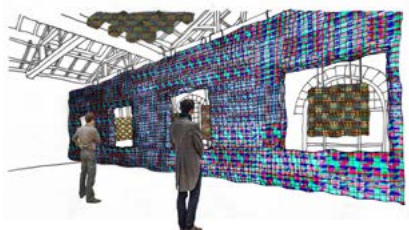
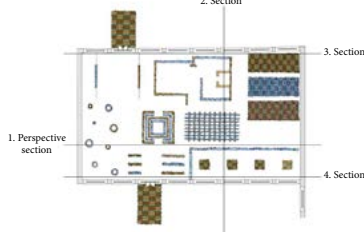

5. Projections

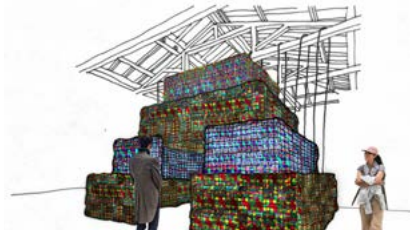

6. Structure



7. Supports

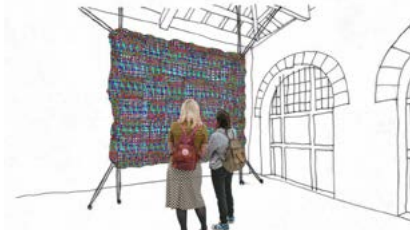

8. Suspension



Kat Sanchez's hanging system Uses hanging wire which is attached to the ceiling on one end and to a pole on the other which the knitting 'noodles' are woven over.



Knitted elements construction Each knitted element when in the construction process will be woven over a metal pole which will be attached to the hanging system to suspend within the exhibition.



Adjustable hanging system/wire This will attach to the steel beams in the existing roofing design to suspend the knitted elements.



Turnbuckle This will attach to the flooring and walls to hang the suspension knitted element. Type: Hook/Hook turnbuckle



Hanging wire Diameter: 6mm

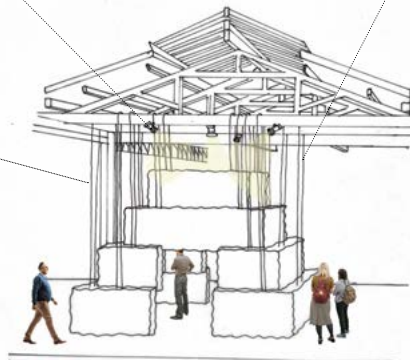
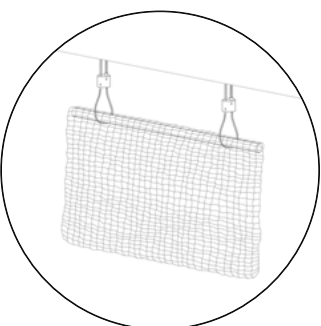
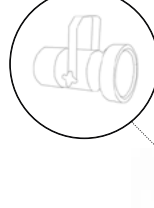

Technical detailing of how knitted elements are hung within the space and how they are lit using artificial lighting.

Proposed perspective of exhibition design

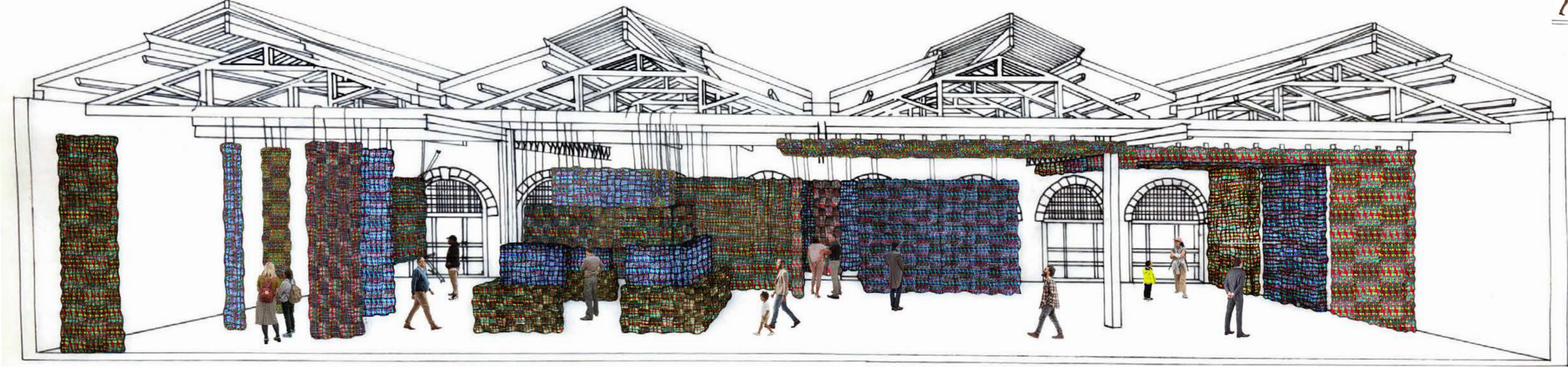

Key for where sections are taken:

