

CHAMBAL RESORT RECEPTION

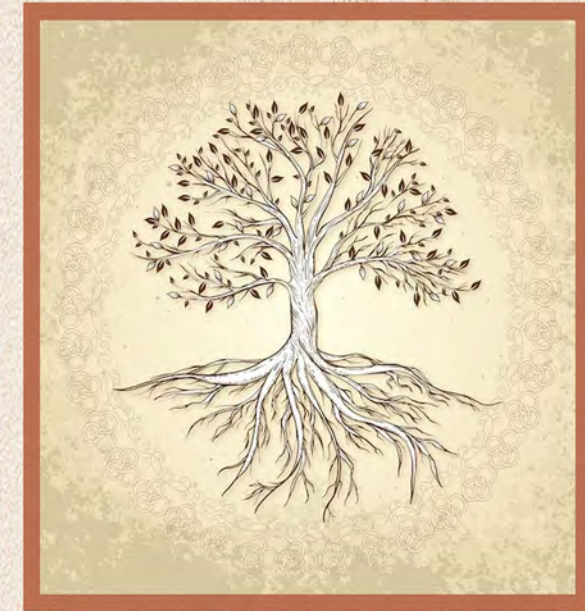

The reception is the starting point of every guest's safari journey. A welcoming space designed to spark excitement and curiosity from the moment they arrive. Inspired by the Indian folktale, The Wishing Tree, the area blends storytelling with design, creating a warm and inviting atmosphere. The space includes a reception desk, a relaxed seating area for waiting guests, and natural textures throughout.

The design features a palette of soft neutrals, complemented by pops of muted red tones that echo the desert landscape where the story is set. The walls feature Zinc Textile's Monazite woven wall covering that reflects the soft, flowing movement of desert sands, with subtle shimmers that catch the light like sun on dunes.



Not to Scale



Scale 1:100



Scale 1:100



Scale 1:100



Hannah Edmunds.ADB615



Also found within the reception is a wishing tree, designed to spark imagination and add a sense of wonder to the space. A nearby table allows children and adults to write down their wishes, which can then be hung down the tree's branches. This simple yet meaningful gesture encourages imagination and connection, adding a personal touch to the start of each guest's journey.

CHAMBAL RESORT RESTAURANT

The restaurant is a vibrant celebration of culture and creativity. An immersive space inspired by the lively colours and bold patterns of Patrika Gate. Brightly painted walls, patterned textiles, and bespoke details reflect the joyful energy of the gate itself, creating a dynamic setting that feels both welcoming and exciting. The layout is thoughtfully divided into two distinct areas: a lively, family-friendly section for bigger partys, and a more serene dining space designed for adults to enjoy a peaceful meal. From the colourful tiled floors to bespoke wall panelling, every element tells a story.

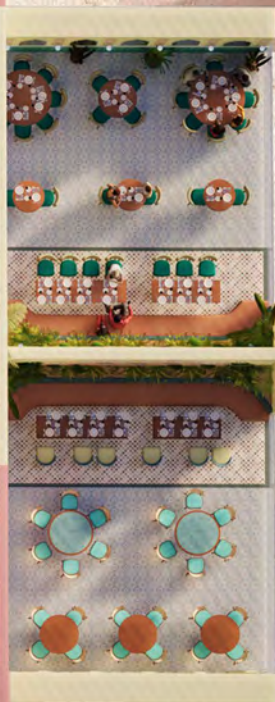

Scale 1:100



Patrika Gate

In this area, low seating inspired by authentic Indian design creates a relaxed and intimate atmosphere. Partition walls between each seating arrangement offer privacy without disrupting the flow of the space, ensuring guests can enjoy a more personal experience. The varied seating options, from cosy corners to larger group settings, cater to different needs while maintaining a sense of openness and comfort.



CHAMBAL RESORT RESTAURANT

Tall seating is positioned in front of beautiful brass partitions, which reflect light throughout the space and create a detailed backdrop. Inspired by the intricate designs seen at Patrika Gate, these partitions add both structure and softness to the restaurant, dividing zones without blocking the vibrant atmosphere. As the light shifts across the metal, it enhances the space with a soft shimmer, adding depth and drama to the overall design.

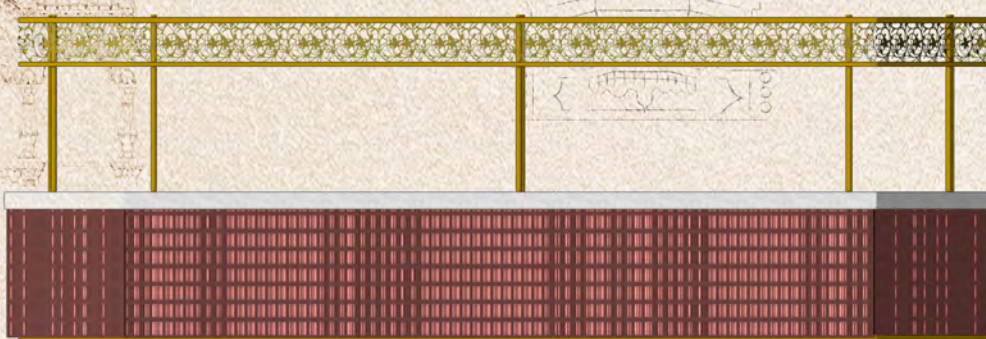

Scale 1:50

The bar features pink fluted tiles along its sides, paired with a sleek marble counter top for a refined, contemporary finish. A decorative element runs above the bar - delicate brass detailing in a floral pattern, where glassware is suspended. Integrated lighting within the brass details casts a warm glow, creating intricate shadows that enhance the atmosphere and add a touch of story-telling to the space.



Patrika Gate



Hannah Edmunds. ADB615

Seating throughout the restaurant is varied to give guests multiple options, from intimate tables for two to larger group settings. Plants surround many of the seating areas, creating a sense of privacy and bringing life into the space. Above, delicate gold leaf details catch the light on the ceiling, adding a subtle touch of luxury to the vibrant surroundings.



Scale 1:50

A mural featuring peacocks mimics one of the paintings at Patrika Gate and is framed within an Indian-style arch, adding character to the space.

CHAMBAL RESORT RESTAURANT

OUTSIDE SEATING AND LIVE COOKING



Patrika Gate



For a more private experience, the terrace offers two exclusive seating options, each featuring the same traditional Indian seating but arranged separately to accommodate two parties. These seating areas, which include Jhula swings, charpais, and more, offer a comfortable and authentic setting for guests. A stunning mosaic of trees, inspired by Patrika Gate, mirrors the nature from outside, creating a seamless connection between the interior and the outdoor surroundings.



On the terrace, guests will also find a live cooking station where staff demonstrate how naan bread is made, a fun and interactive experience for both children and adults that adds a touch of luxury to the visit.

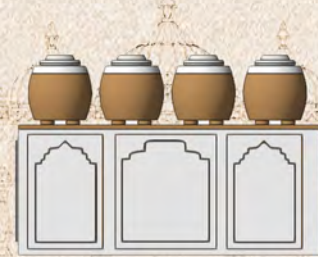

Scale 1:50

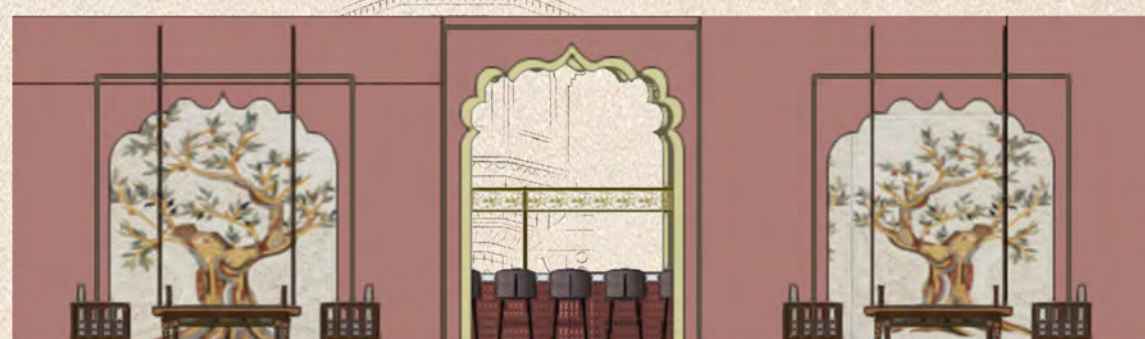

Scale 1:100

CHAMBAL RESORT KIDS' ZONE

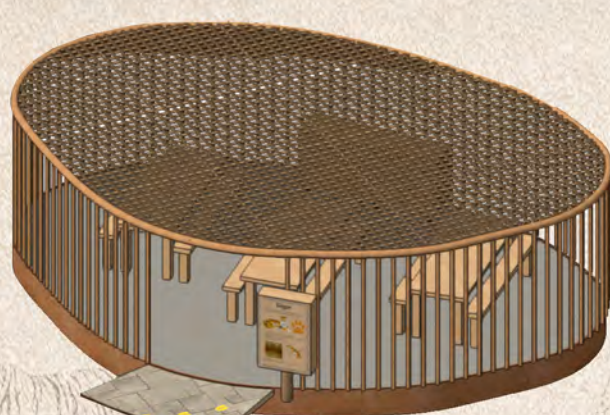

1. Here the children can make arts and crafts which is local to the area.

Scale 1:100

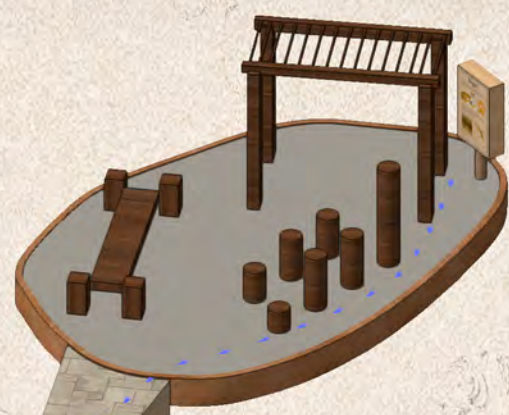

2. A jungle climb for fun and exercise.

Scale 1:100

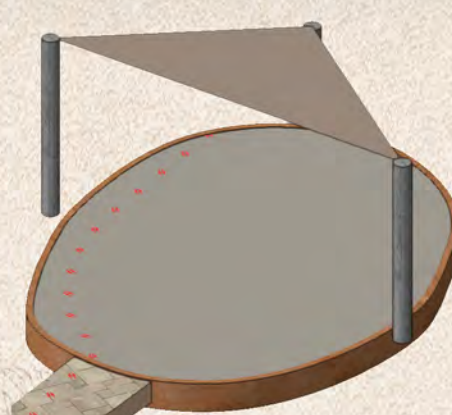

3. Designed for dancing, with flexible room that adapt's to a variety of other activities.

Scale 1:100

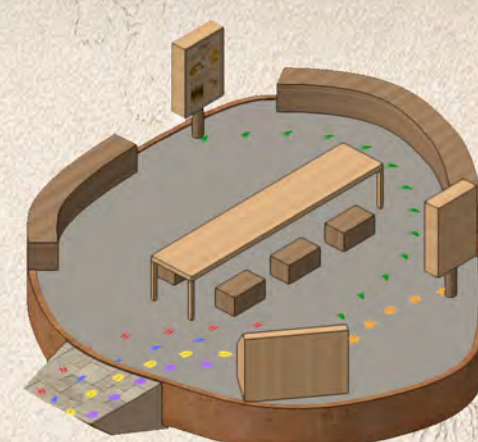

4. The learning zone. Here children can learn about the animals in the safari.

Scale 1:100

The Kids' Zone is a dedicated space where children can have fun while learning through immersive activities. At the centre, a circular seating area invites children to share stories together. The layout takes the shape of a tiger's paw, inspired by the Indian folktale The Tiger, the Brahman and the Jackal. Elements from the story are woven throughout, including a cage-inspired room and a central tree.

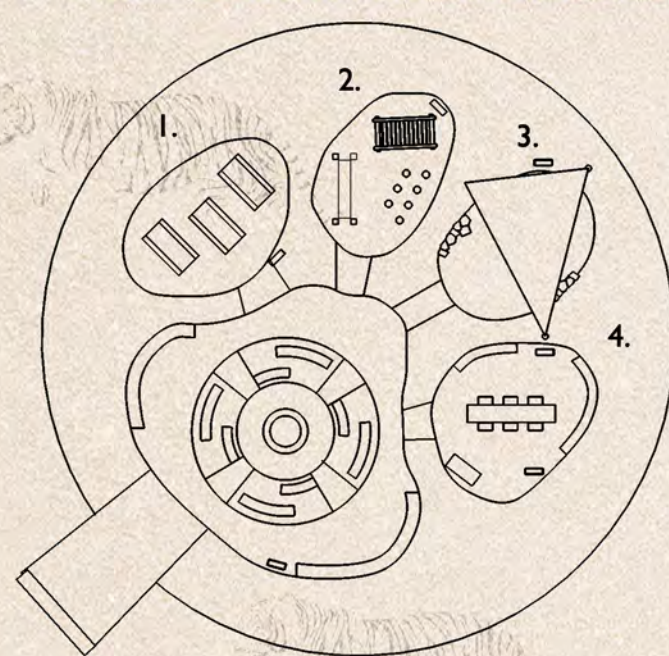

Scale 1:300



Another key feature of the Kids' Zone is an interactive trail where children can follow the footsteps of the main safari animals. These playful tracks guide them through the space, leading to wooden stands that share fun and educational facts. Each stand is designed to be interactive, allowing children to touch, play, and discover more about the creatures they're following. This hands-on approach makes learning feel like an adventure.



Hannah Edmunds.ADB615

CHAMBAL RESORT

THE VILLA

LIVING AREA AND TERRACE

The villa is designed to comfortably accommodate 6-7 people, making it ideal for multi-generational families seeking both space and privacy. Complete with its own private swimming pool, cooking facilities, and multiple balconies for relaxing outdoors, the villa offers a luxurious and flexible home-away-from-home experience. Each room within the villa is uniquely inspired by traditional Rajasthani paintings, with every space telling its own story through colour, pattern, and artwork—allowing guests to feel immersed in Indian culture while enjoying the comfort of modern living.



Not to Scale

The main living area, which includes the lounge, kitchen, and dining space, is inspired by the Saranga Ragini painting by Nasiruddin. Key elements from the artwork—such as the peacocks, are reflected in the design through patterned wallpaper and peacock-inspired light feature.

The rich colours of the painting have also influenced the overall palette, bringing warmth and depth to the space. The backs of the dining chairs take inspiration from the architectural forms seen in the background of the painting, recreated using embroidered fabrics to add texture and cultural reference to the room.

The kitchen features bespoke cabinets crafted with traditional Indian materials and intricate detailing, bringing authenticity and cultural richness to the heart of the villa.



Scale 1:100



VL-M8 - Samode Fabric.
Osborne & Little



VL-M13 - Giallo Sienna.
Variostone



VL-M5 - Kalapi
Wallpaper. Sanderson



Hannah Edmunds. ADB615

CHAMBAL RESORT THE VILLA MASTER BEDROOM



The master bedroom is inspired by the Mithila wedding painting, with soft pastel tones of pink, yellow, and blue guiding the overall colour palette. Elements from the artwork, such as the bird being gifted and the delicate floral patterns in the background, are reflected in the room's textiles and details. The skirting around the base of the room mimics the decorative top border of the painting, adding a subtle storytelling feature that ties the design together in a calm and elegant way. The room also includes bespoke wardrobes and a softly arched entrance to the shower, with an open en-suite design that places a free-standing bath within the bedroom for a calm, spa-like atmosphere.



VM-M4 - Eglantine
Wallpaper. Laura Ashley



VM-M2 - Milano.
The Surface Studio



VM-M6 - Dune
DTTP 10. Domus



Hannah Edmunds. ADB615



Not to Scale



Scale 1:50

The bespoke headboard, which backs onto additional wardrobe space, features a patterned design of birds and flowers, along with a soft arch shape to echo the room's doors and archways. It's complemented by bird-shaped lights and subtle gold detailing.

CHAMBAL RESORT THE VILLA TWIN BEDROOM

The twin bedroom is inspired by the Maharani Princess painting, with every detail carefully considered to reflect its delicate beauty. The floral elements in the artwork are echoed through a mix of flower motif fabrics used across bedding and soft furnishings, creating a gentle feel. The bespoke wardrobe features an arched shape that mirrors the architectural backdrop in the painting, adding a subtle yet striking design feature. Even the trimmings have been thoughtfully chosen - taking inspiration from the beaded details in the princess's headwear, they add a touch of refinement and storytelling to the space.



Not to Scale



VT-M1 - Fez Weave
peacock. Guy
goodfellow collection



VT-M1 - Mallow
BorderCortez. Ian
Sanderson



VT-M4 -
Cara. JAB ANSTOETZ

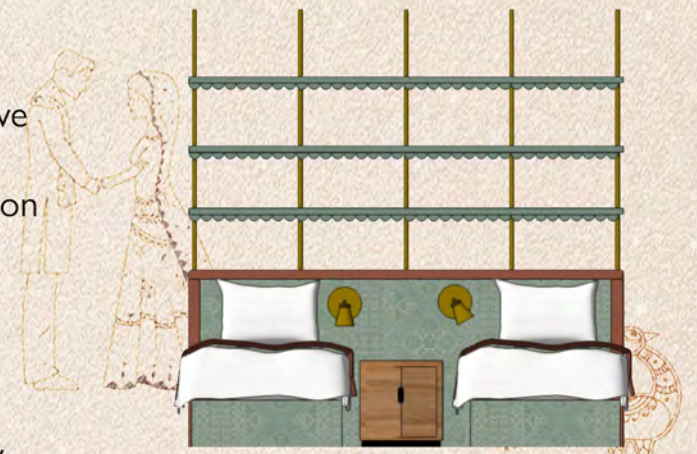

Scale 1:50

The twin room includes a custom-made headboard with built-in shelves and a desk, designed as one piece. The carved shapes on the shelves are inspired by the details in the painting, adding a subtle link to the artwork. It's a practical and thoughtful design that brings extra character to the room.

