

Section AA 1:200

## (RE)REMEMBERING

A Landscape for Memory, Gathering, & Reflection

This project seeks to rewrite the narrative surrounding graveyards, seeing them as a living landscape where memory and community intertwine. The graveyard is reimagined as a green lung within the Wymondham community, acting as a site for gathering and collective memory.

Glass posts form a continuous route through the graveyard, leading visitors to each of the seven memory gardens. The gardens symbolise a community minded approach to grief through the act of planting in remembrance. The glass route allows visitors to choose the direction they want to take through the graveyard. One direction allows for remembrance of those buried within the site, with inscriptions and gravestones facing the visitor, while the other reflects the journey of souls towards the afterlife.

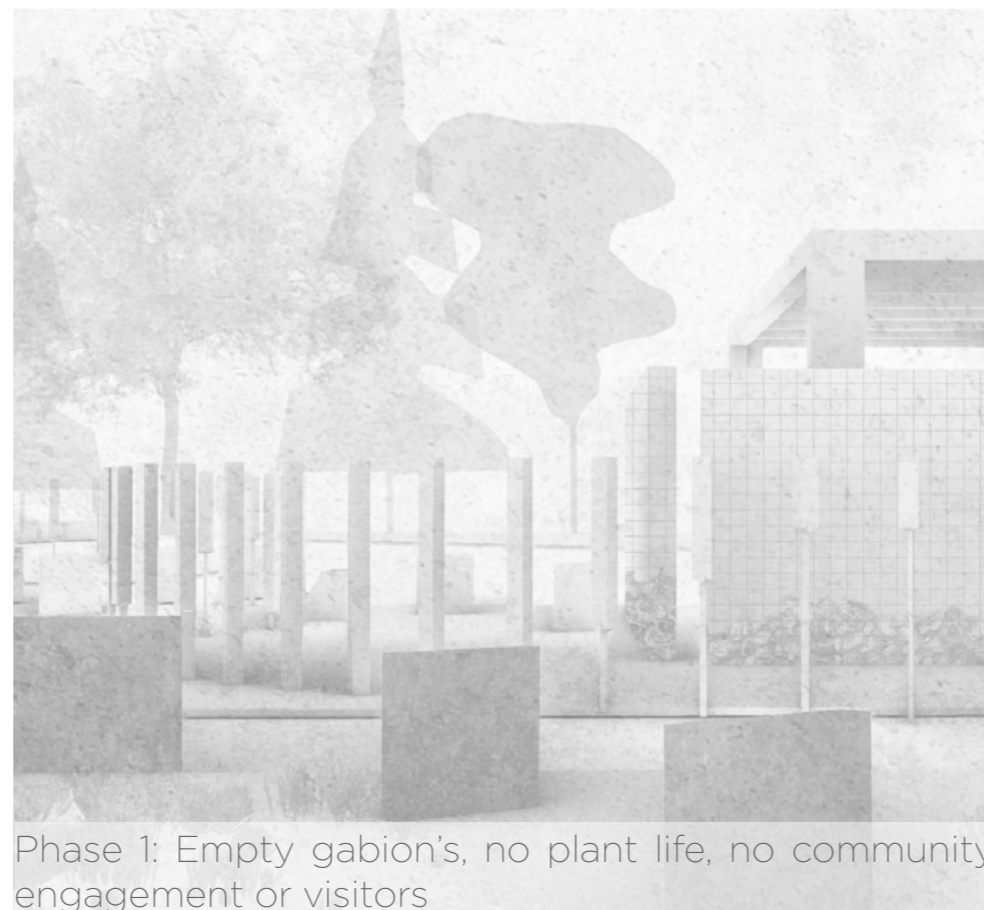

Phase 1: Empty gabion's, no plant life, no community engagement or visitors



Phase 2: Partial growth, emerging use, first visitors present

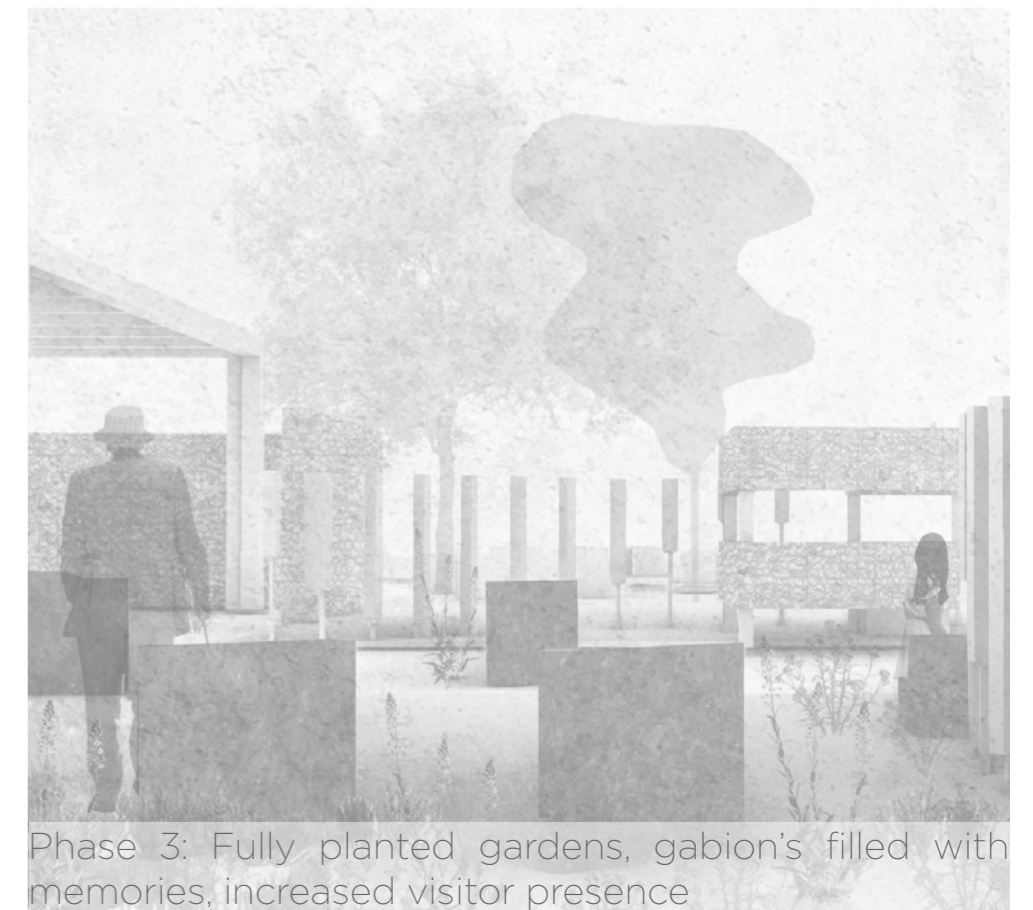

Phase 3: Fully planted gardens, gabion's filled with memories, increased visitor presence

## Reflection spaces:

Across the site, a series of private walled spaces have been designed for individuals or small groups to use for grieving and self-reflection. Each of these spaces has been formed with privacy as the central intention. They allow visitors to withdraw and hold moments of personal self reflection.

To sensitively respond to the site's layers of history, the design draws directly from its existing architectural language; forms reinterpret the arches of the abbey, whilst materiality is expressed through gabion walls filled with flint and other reclaimed stones found across the graveyard.

Some of the spaces use forced perspectives to direct a visitor's attention towards specific views of the gravestones and abbey, whilst others remain fully enclosed to reinforce a sense of stillness and serenity.

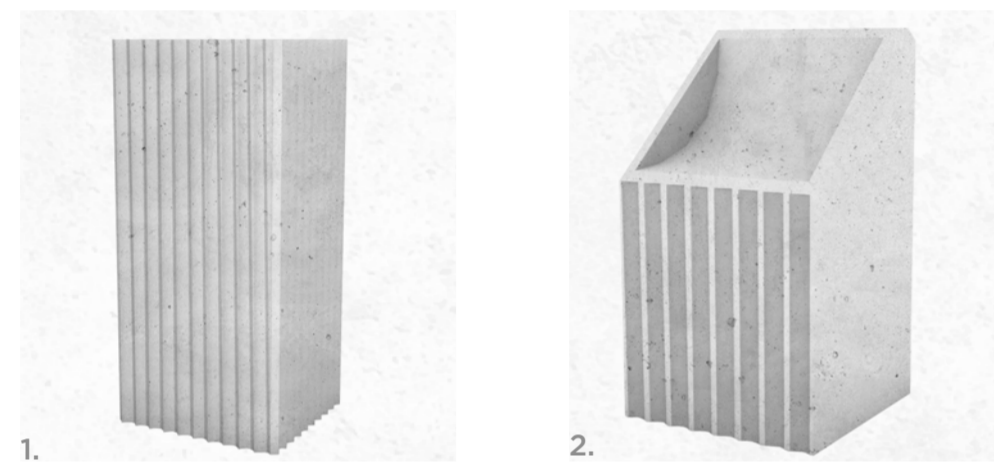

A larger public reflection space can be found at the centre of the site, providing a shared setting for gathering and remembrance. This space acts as core for collective memory and community engagement.

Across the site, four variations of reflection pools are designed in response to the uniqueness of the surrounding gravestones. They vary in scale and height, from monumental forms to smaller pools.

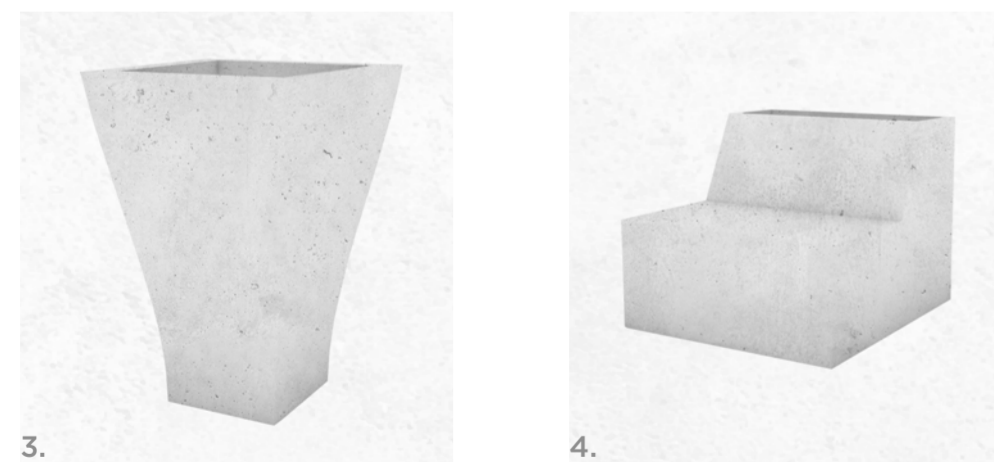

Each reflection pool offers a different form of engagement; one acts as integrated seating, two recirculate rainwater to create a subtle trickling effect, and another functions as a looking glass reflecting the sky.

These pools are designed to encourage different forms of pause and reflection, shaping how visitors engage with memory and the surrounding environment.



Plan 1:500



Rendered Perspective of private reflection space



5. Wayfinding through the site



6. Collective memory in the central gathering space



7. Private spaces for self reflection and grieving

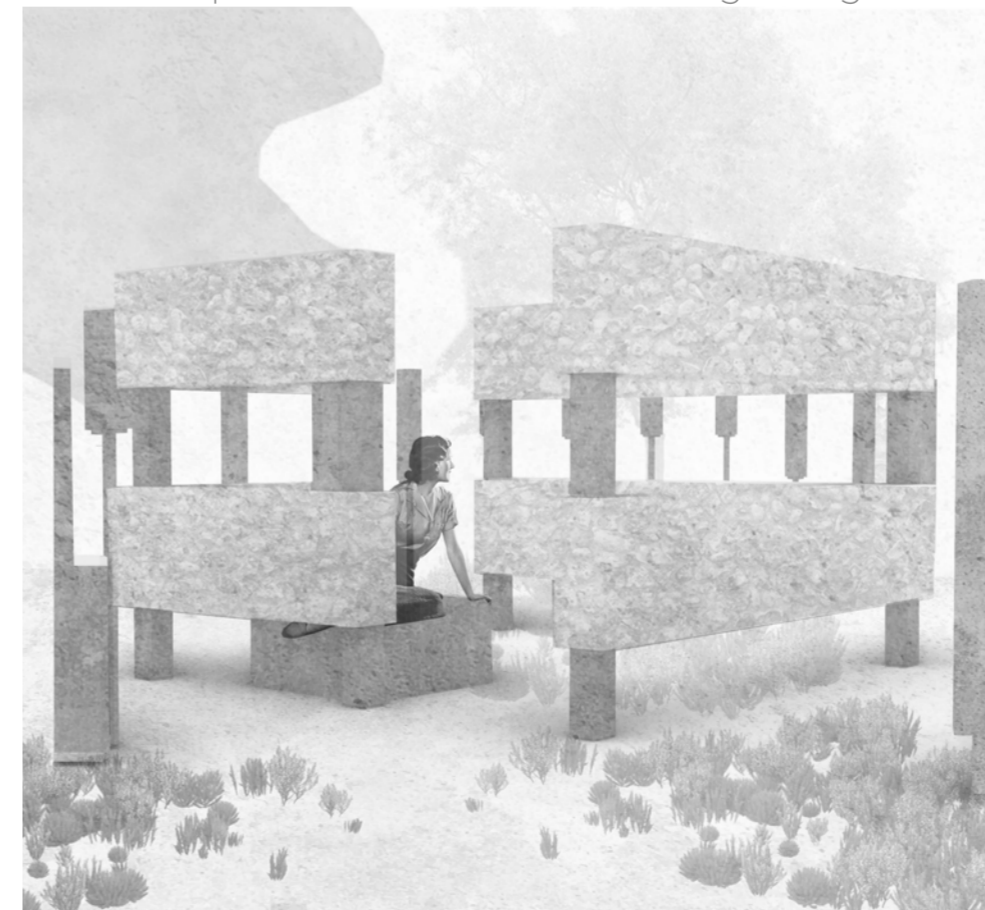

8. Planting wild flowers in a memory garden

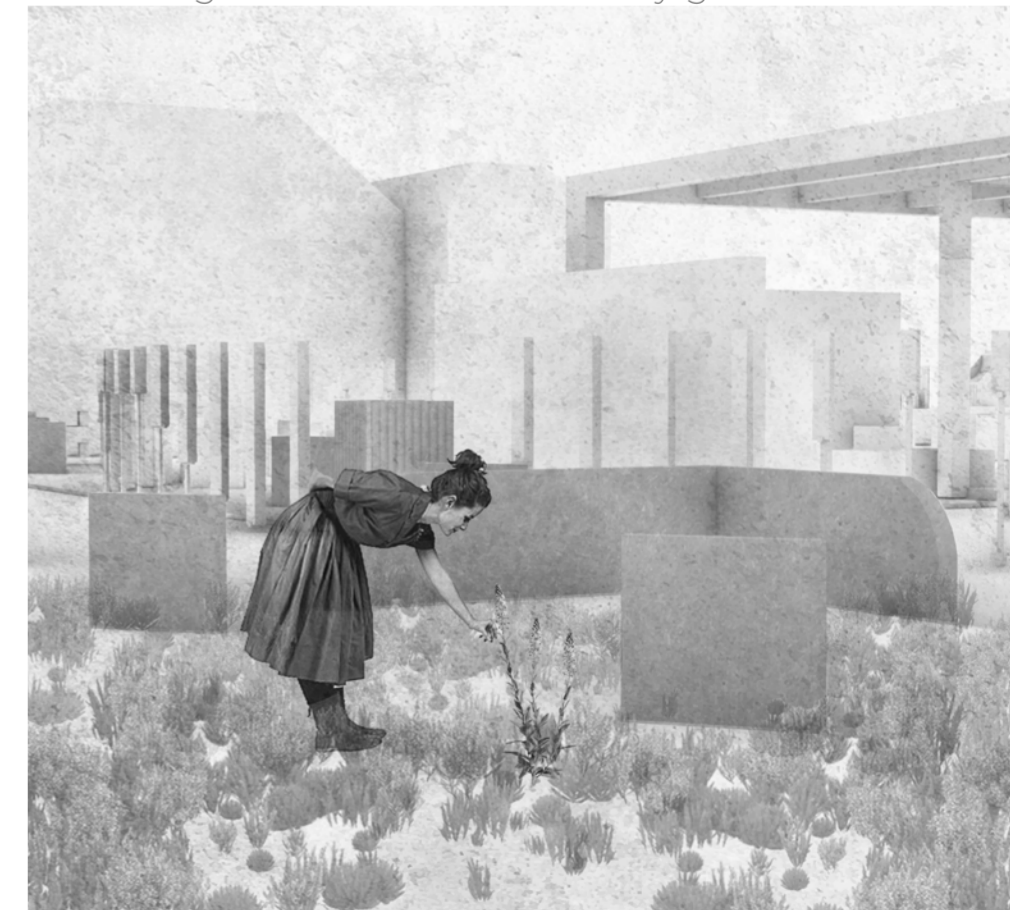

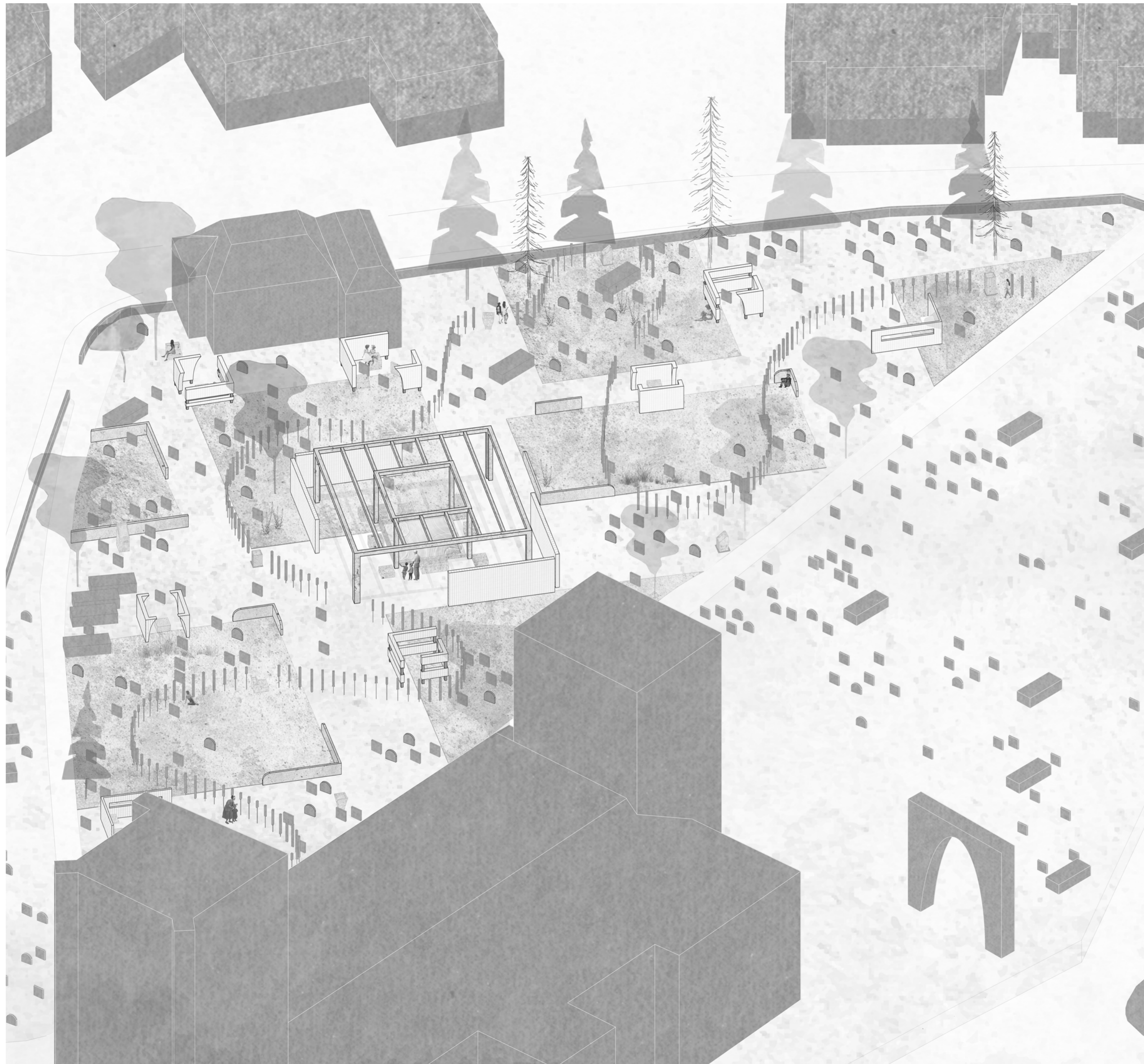

Axonometric 1:200

#### Sustainability & Material choices:

Materiality has been used throughout the design to reinforce a sense of memory within the landscape. Recycled materials are used to show how new life can emerge through reuse, reflecting the evolving nature of the site.

Gabion walls form a key part of this approach. Each gabion is gradually filled with reused stones and fragments, acting as a living archive for the community. The gabions allow the site to form new memories and narratives over time. Additionally, reused concrete and glass bottles are used in the formation of the reflection pools, glass posts and other structures.

The design is grounded in the idea of the past informing the future, prioritising reuse over new materiality. Locally sourced flint and Norfolk wild flowers allow for a community-wide and sustainable approach to sourcing.

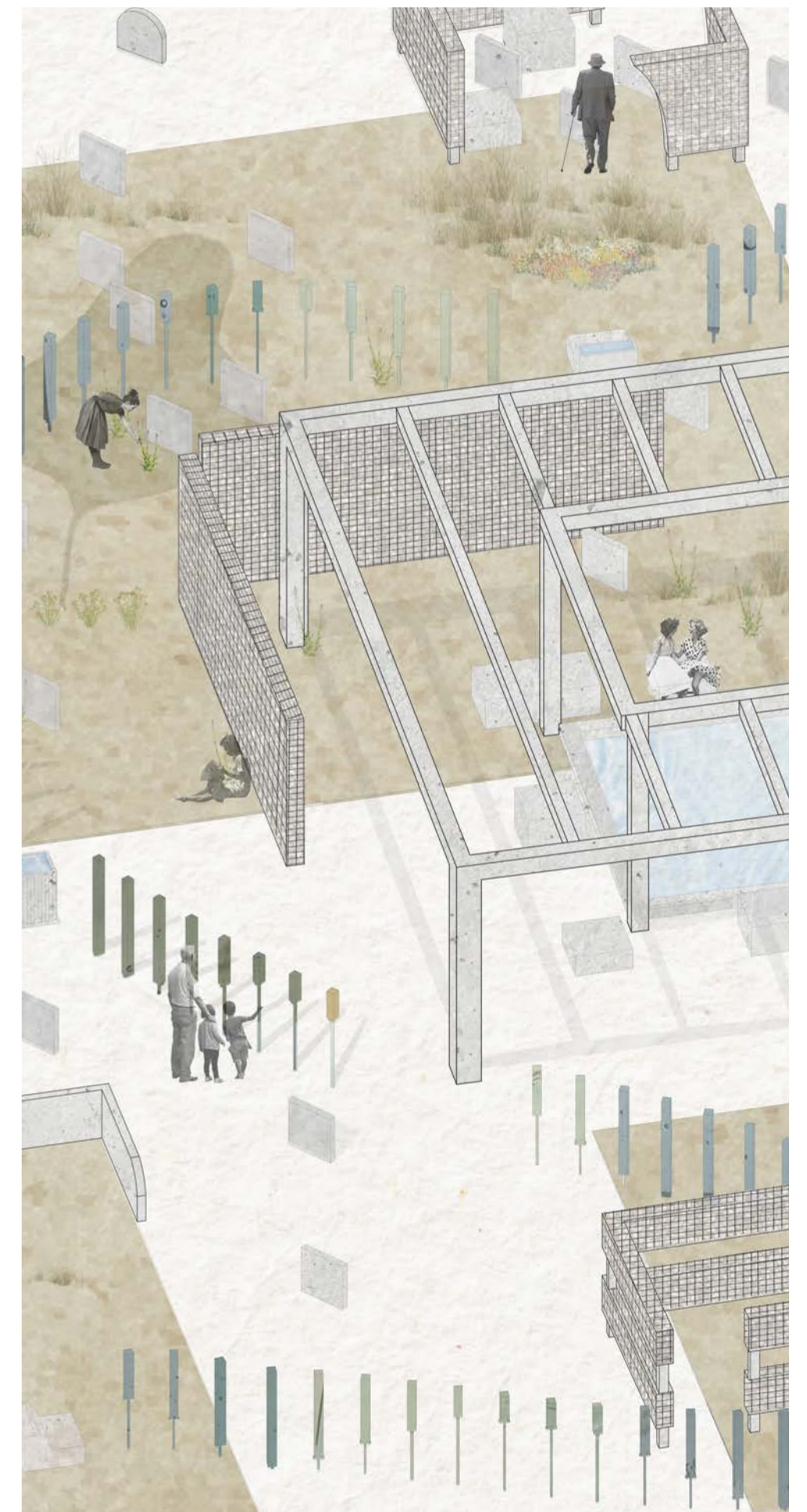

Axonometric Call out 1:100



Rendered Perspective of central public reflection area

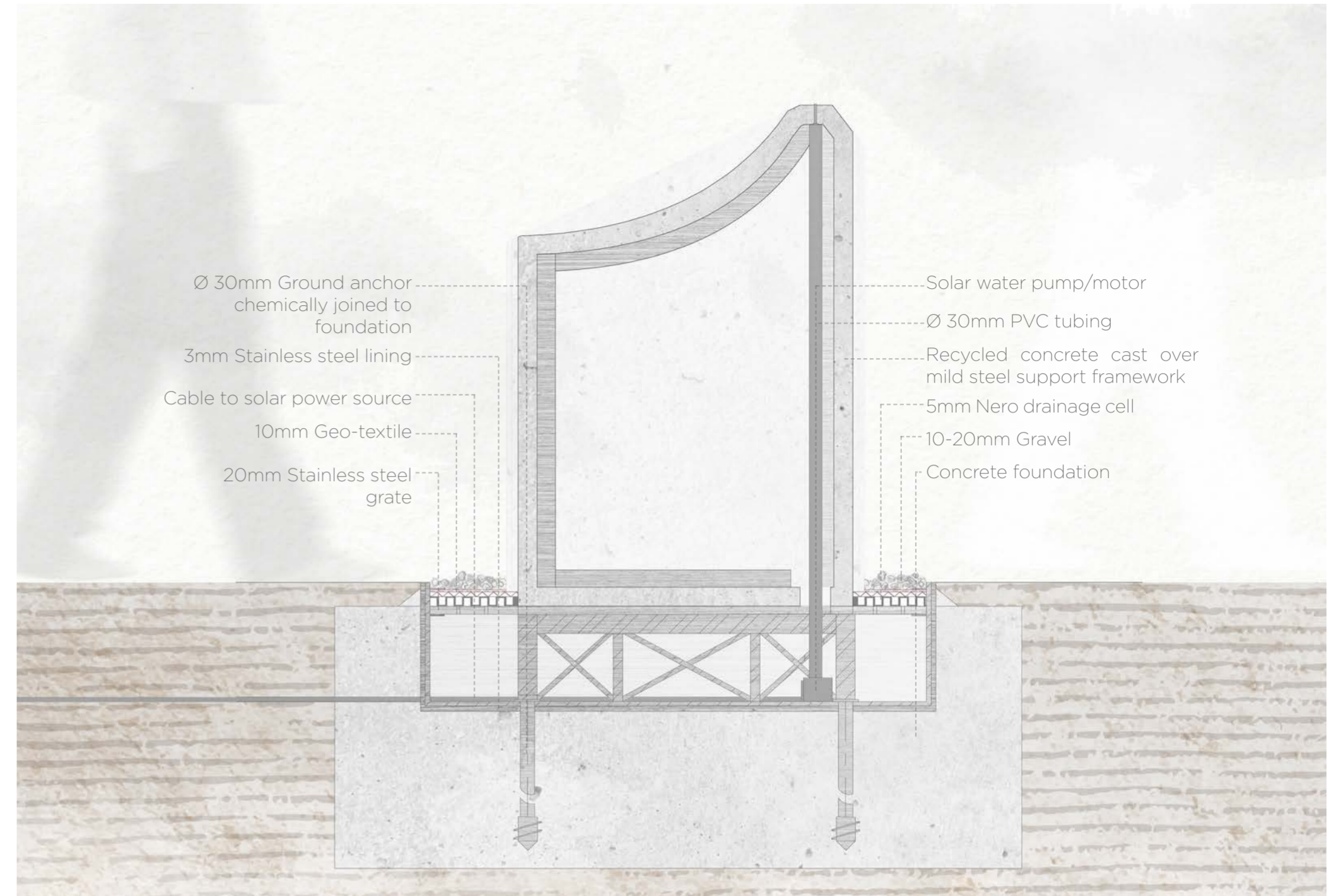

Detail 1, Reflection Pool drainage, 1:10



Rendered Perspective of reflection pool interaction