

Material & Digital Practices : Guerrilla

Lottie Crow



Guerrilla is a multi-programme space that combines rave culture, skateboarding and graffiti. Its a place where self-expression is encouraged and for those to embrace chaos and escape the outside world. By night you can immerse yourself in club culture and listen to a variety of genres of music such as Techno, Drum & Bass, EDM and Hip-hop. During the day the space is open to skateboard freely and for people to engage in graffiti activities.

The main materials of glass, concrete and steel make the design cohesive with the surrounding site and the urban/industrial nature of the functions taking place. I decided to use distortion janus glass blocks to naturally change the lighting as well as normal glass for the windows. In addition all the graffiti walls move allowing for an ever changing design.

I also chose to keep my colour palette predominantly monochromatic, with the exception of the skating obstacles in tangerine and mint, to allow the graffiti to stand out.

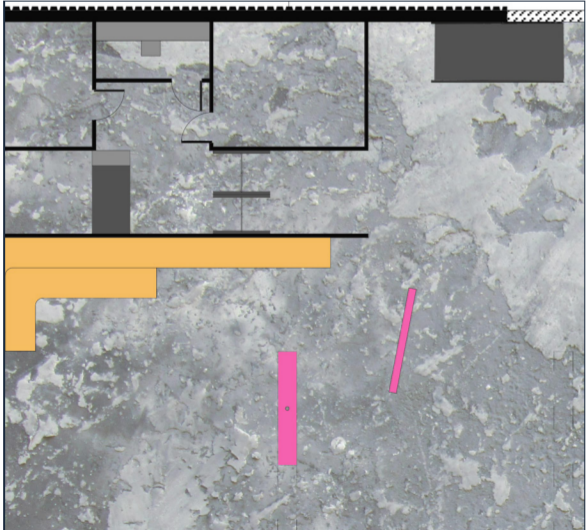

First Floor Plan 1:200 (A)

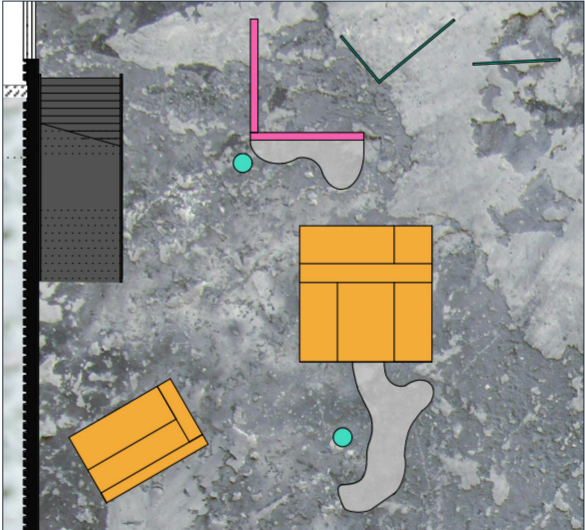

Second Floor Plan 1:200 (B)

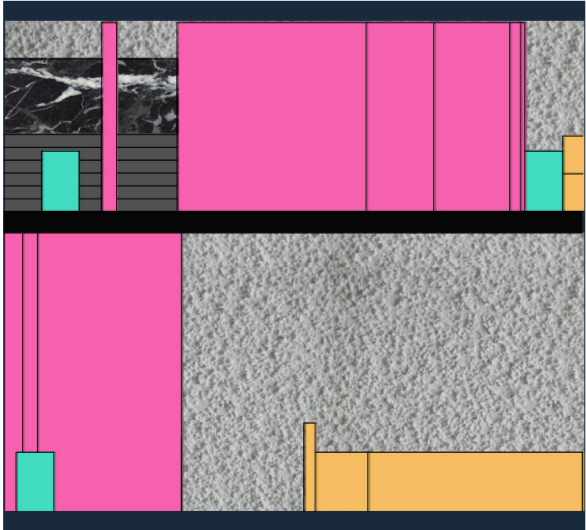

Section 1:200 (C)



Section with elevation 1:200 (D)

20/70 Axonometric 1:200

