

# Reading the Digital

## Digital Archive Observatory

The integration of digital technology has made significant progress over the course of COVID-19. There has been a mass post-digital movement appearing in the past 3 years. As a result - we have seen industries, such as education, evolve into technologically orientated experiences. creatives.

Placed in the fifth floor of Arnolfini, Bristol. This project aims to address the growing integration of digital services within contemporary life, and how we can integrate this aspect within the built environment. I have created a proposal that showcases how the 'Digital' can be used as a tool in education that allows for exhibition, presentation, and reinterpretation of work for creatives.

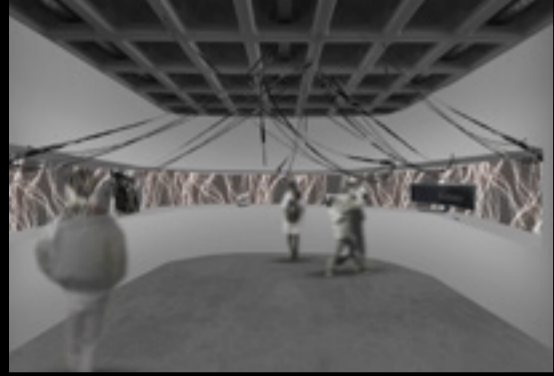

1. "The sunlight is overwhelming, and it displays. Transitioning from old to new, it is clear to see different media of art."



2. "Being placed in Reflections of Harbourside is quite an intimate experience. There are multiple overlapping interior walls - all displaying reflections of Harbourside."

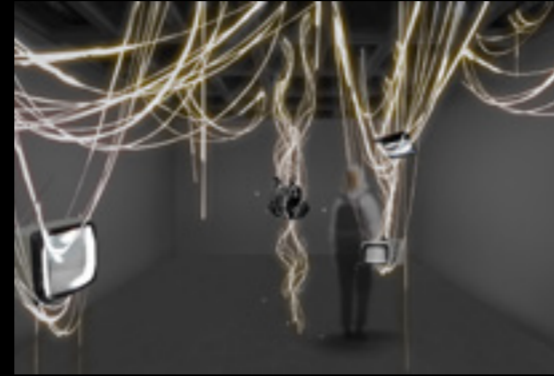

3. "It's easy to look outwards from the room rather than inwards to the centre. It's easy to hyper focus experiences."

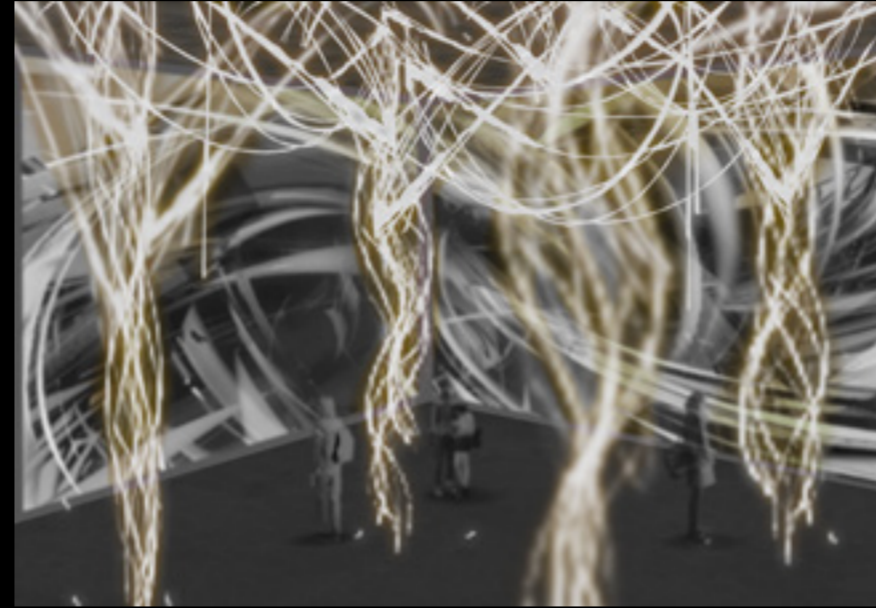

4. "Compared to the surroundings - moving into the exhibition, the lighting is dark. With the only illumination coming as mirrors and wires."

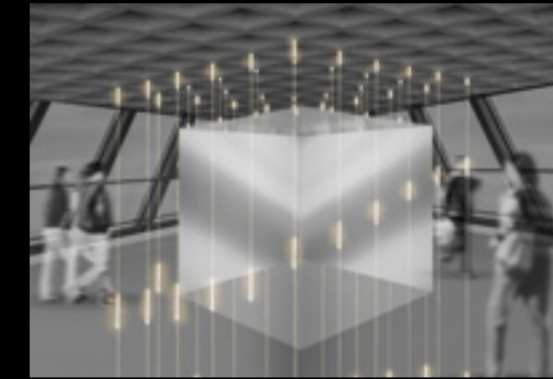

5. "Entering the art studio is disorienting, at first. Including wiring as an opportunity to play with - the exterior bounding walls are glass."

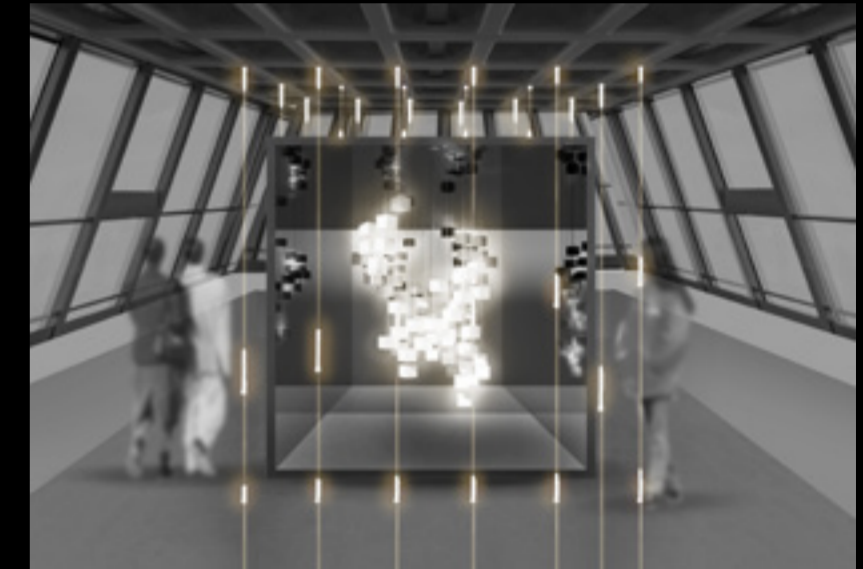

6. "With the clarity of using a white box instead, we can also use interactivity such as acts of swinging, hanging, or suspension when exhibiting from the windows and, more importantly, the projections."

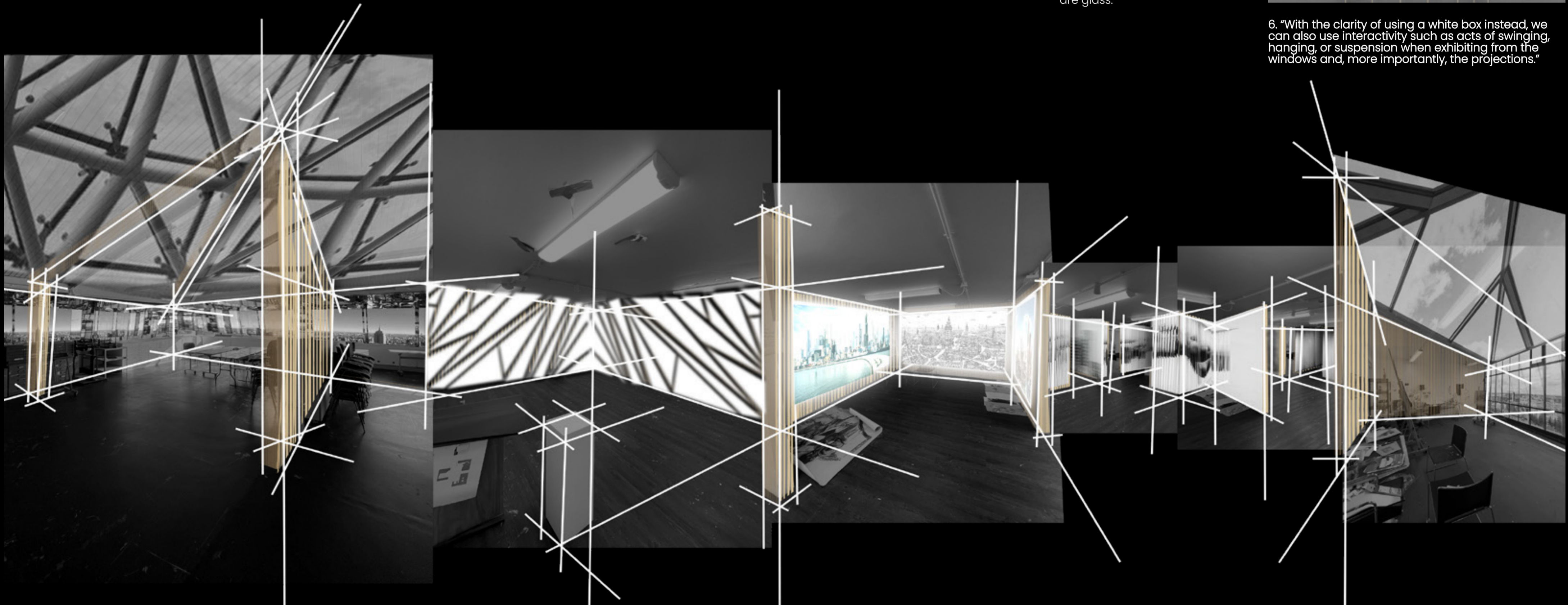

Existing Site - Outward Openings

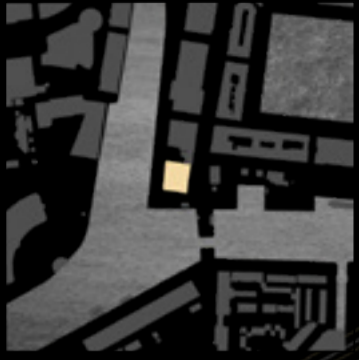

Composite Drawing - Analysing the brief

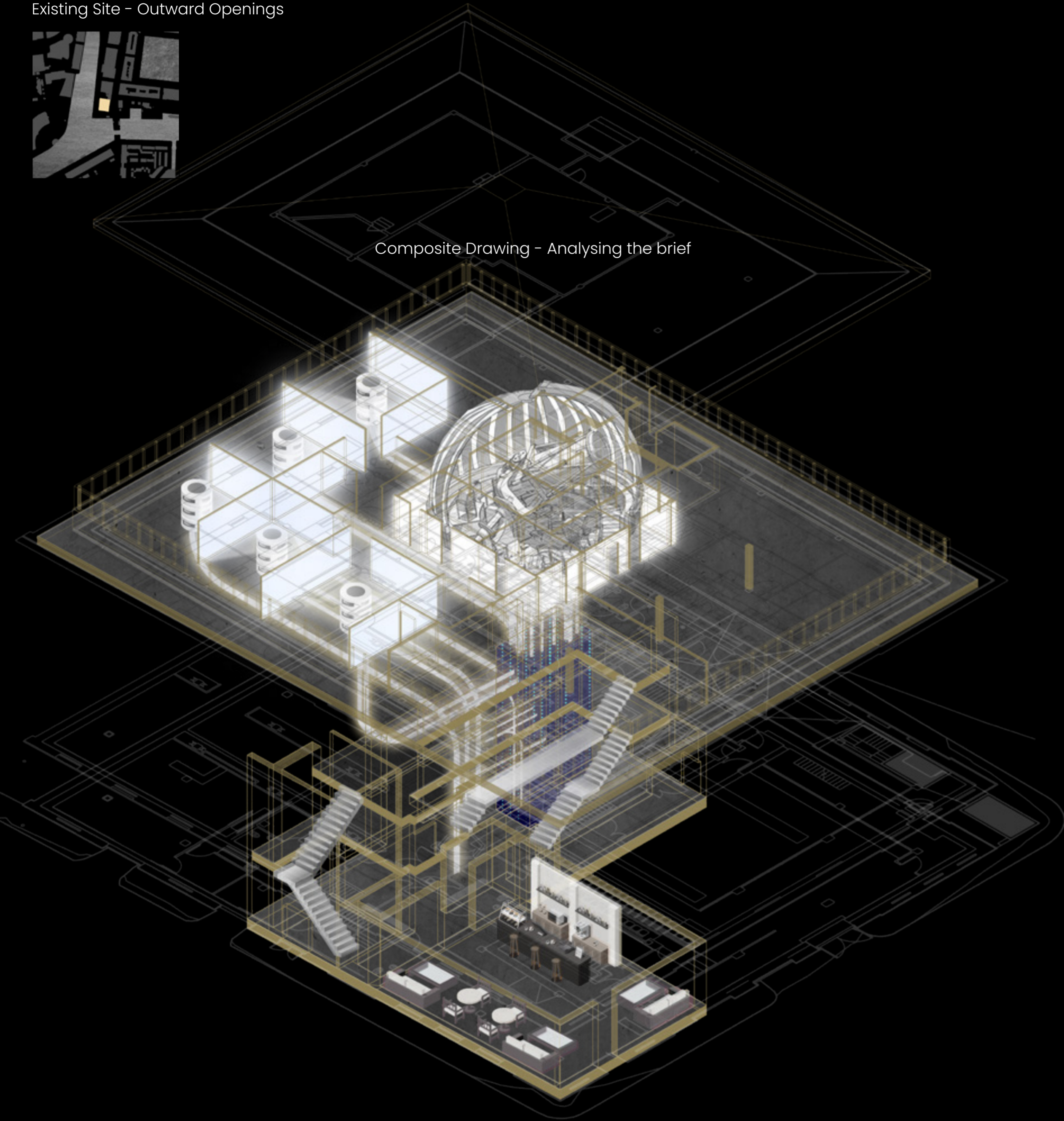

Section Concept Design

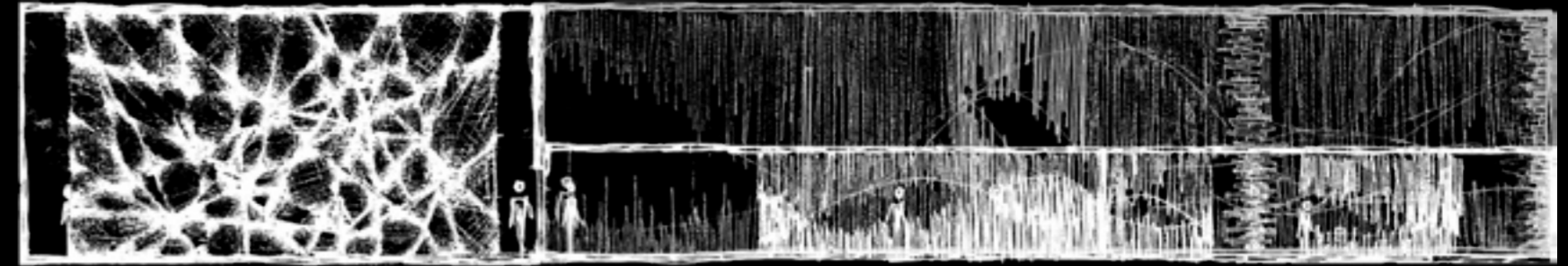

Circulation Space

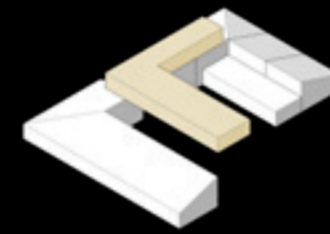

Main Observatory

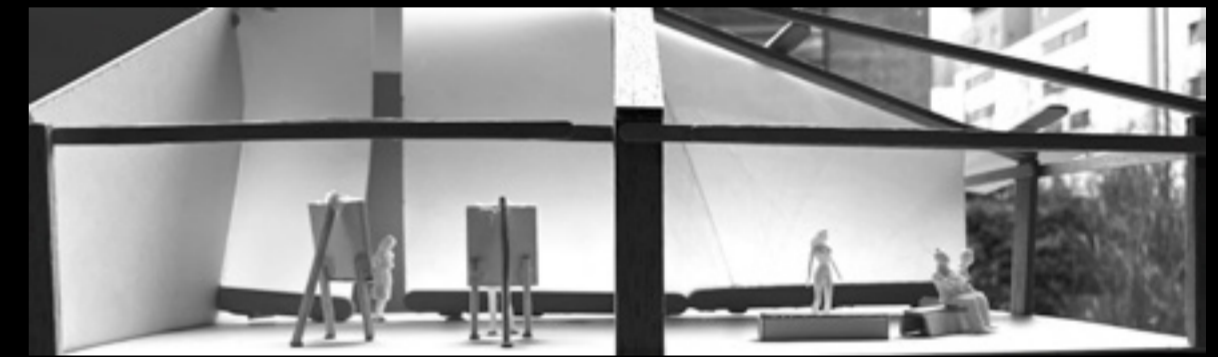
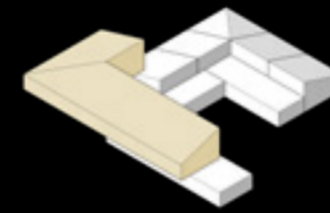

Digital Archive

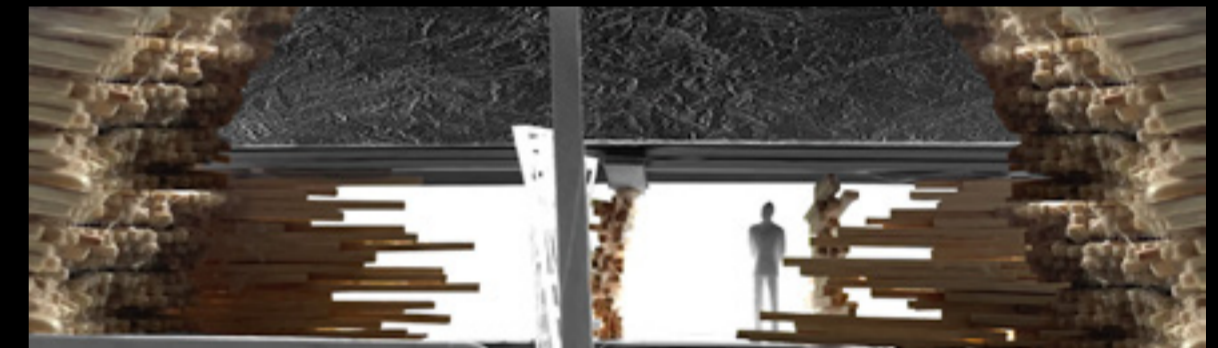
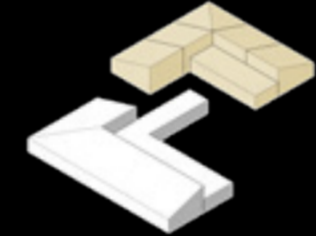

Digital Archive - Concept



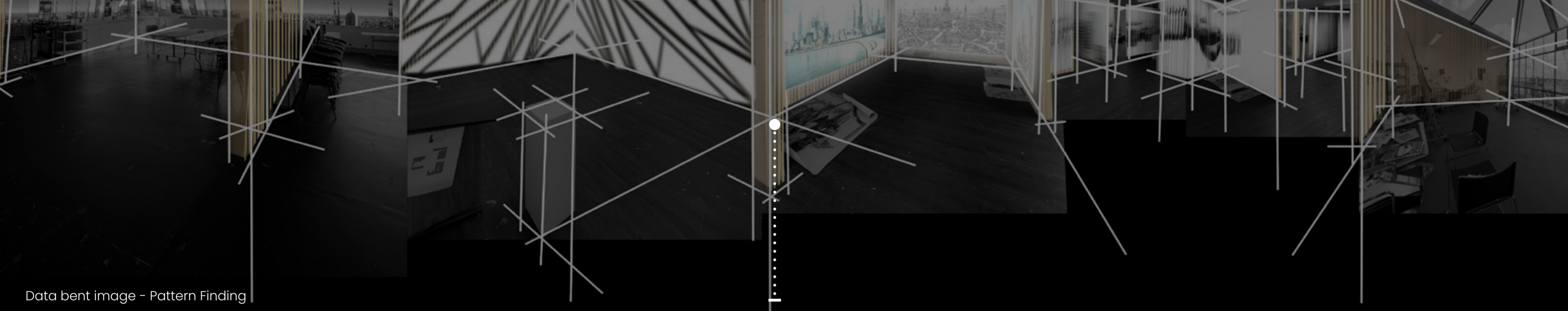

Data bent image - Pattern Finding

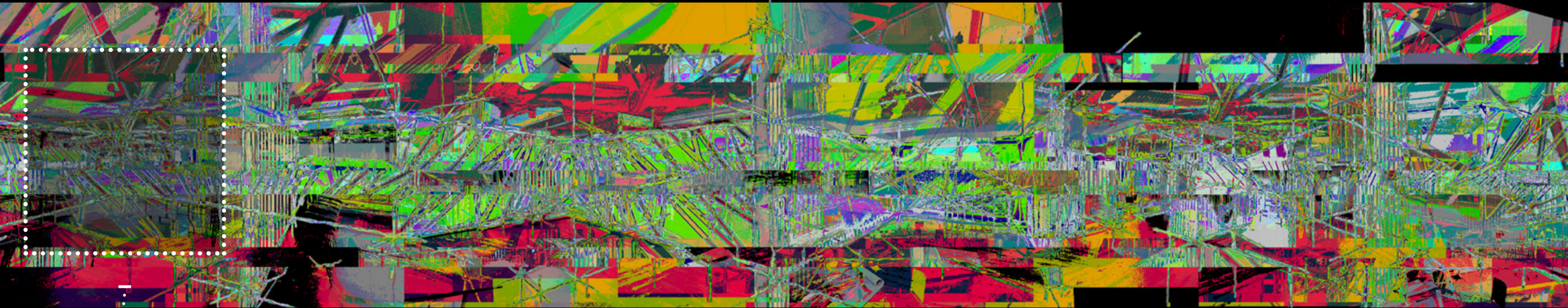

Drawn syntax derived from glitching exercise.

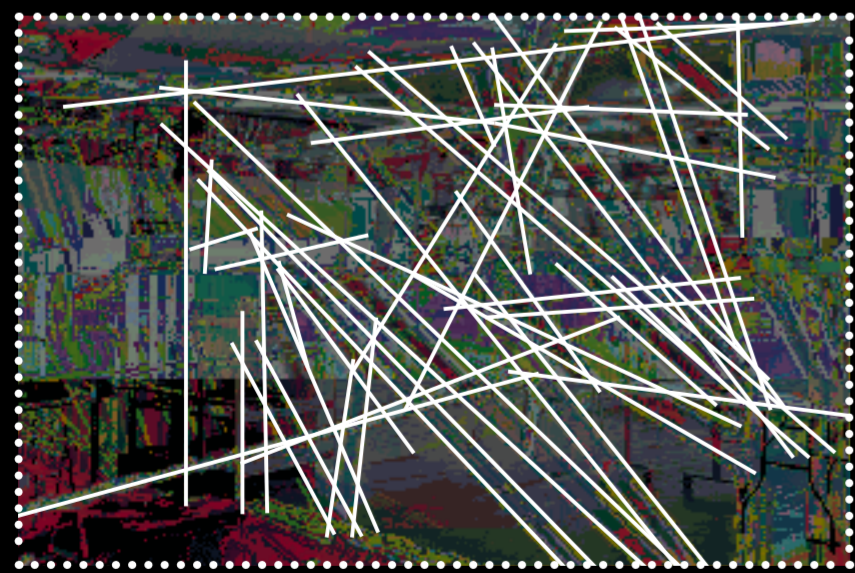

Orientation and duplication of patterns.

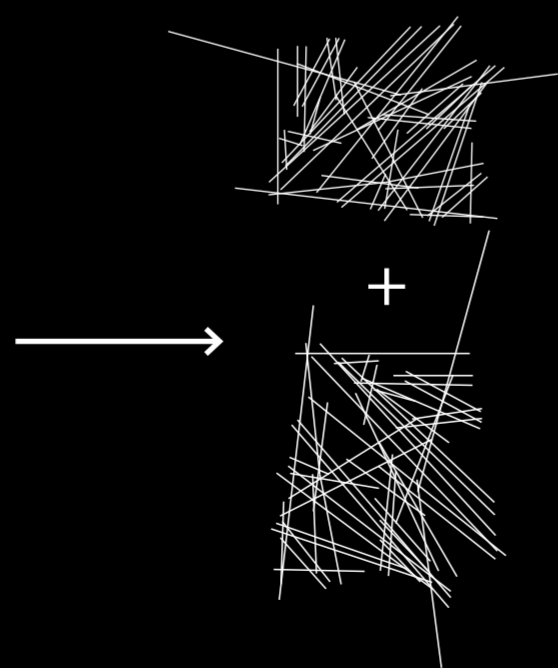

Creation of "grid" system.

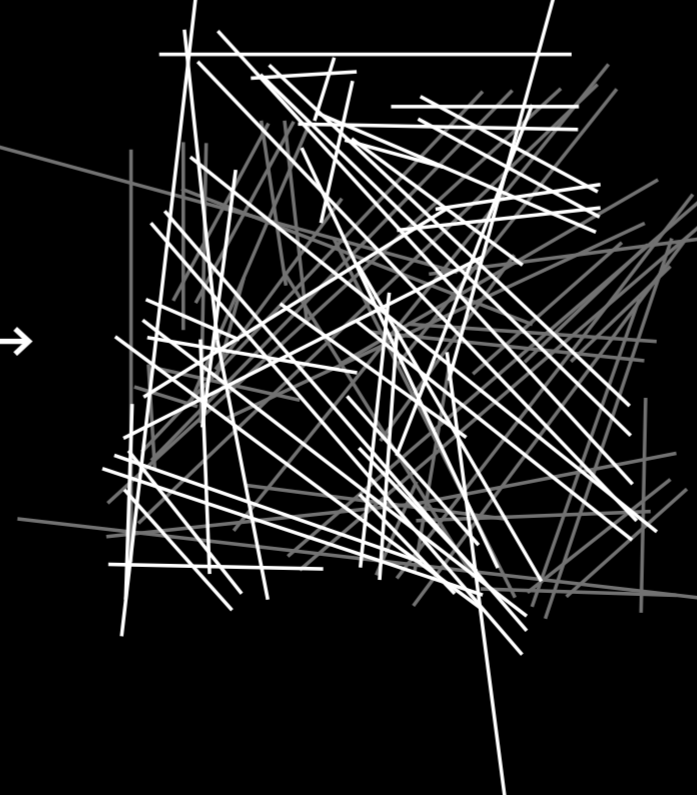

Application of "grid" to 3D form.

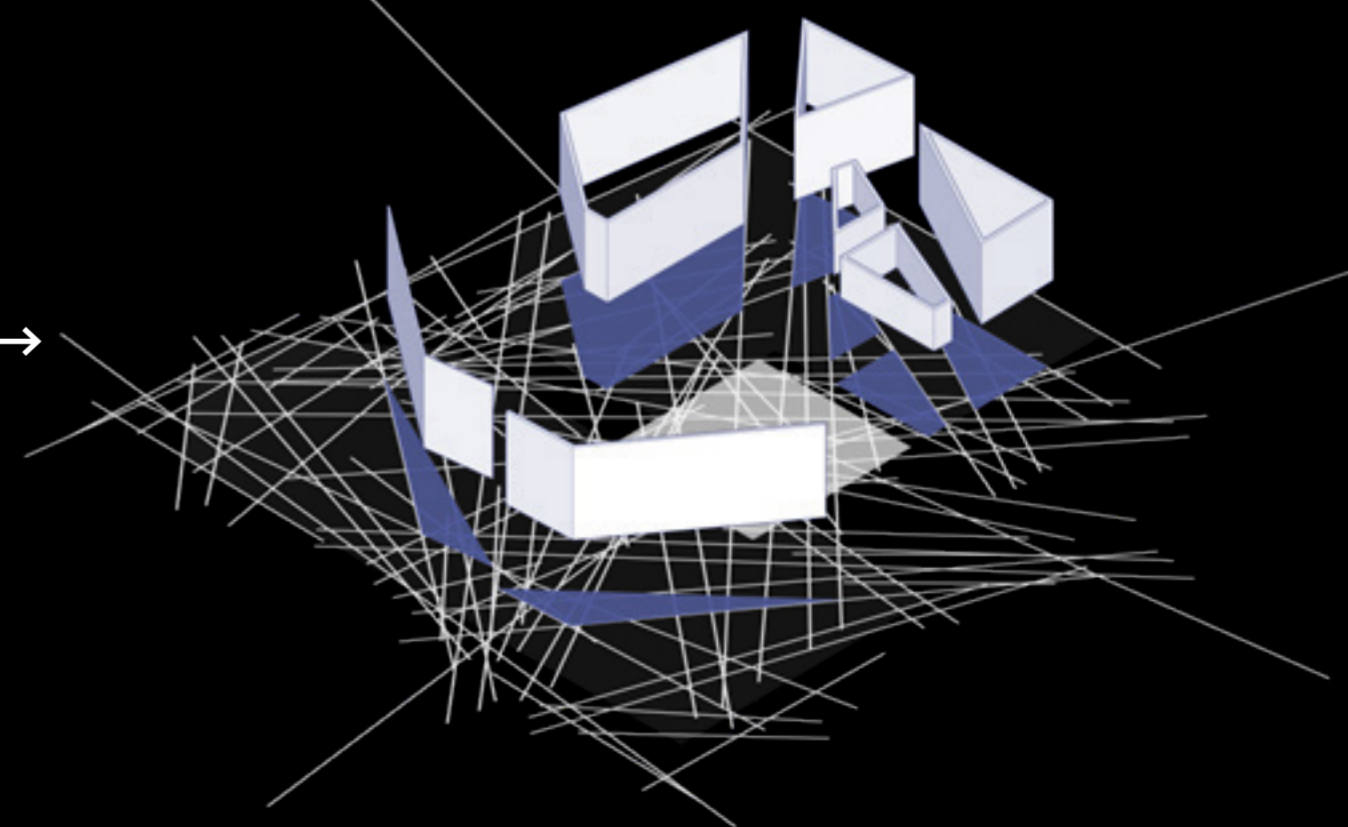



Section A

- Virtual Zones
- Circulation
- Viewing Areas

Facade Detail

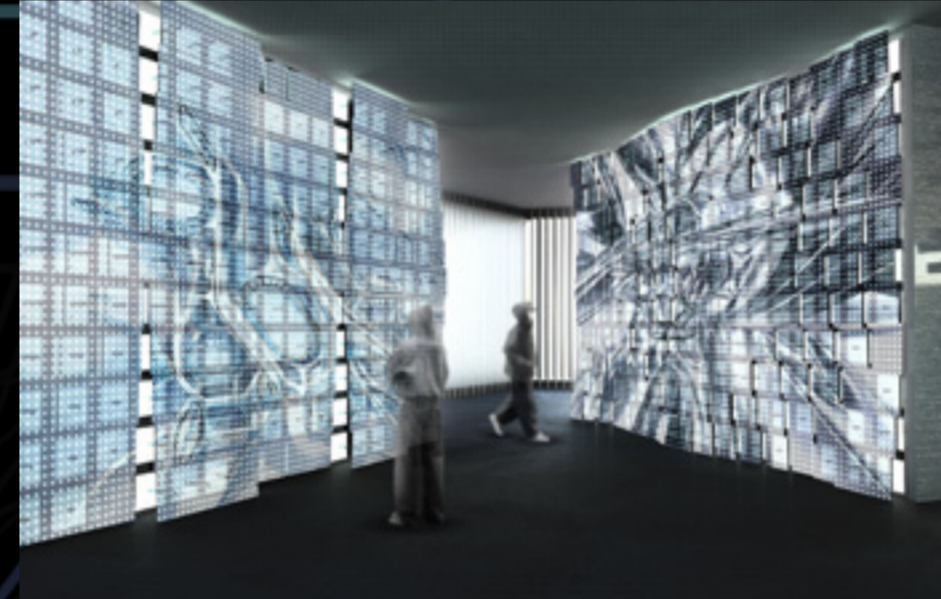
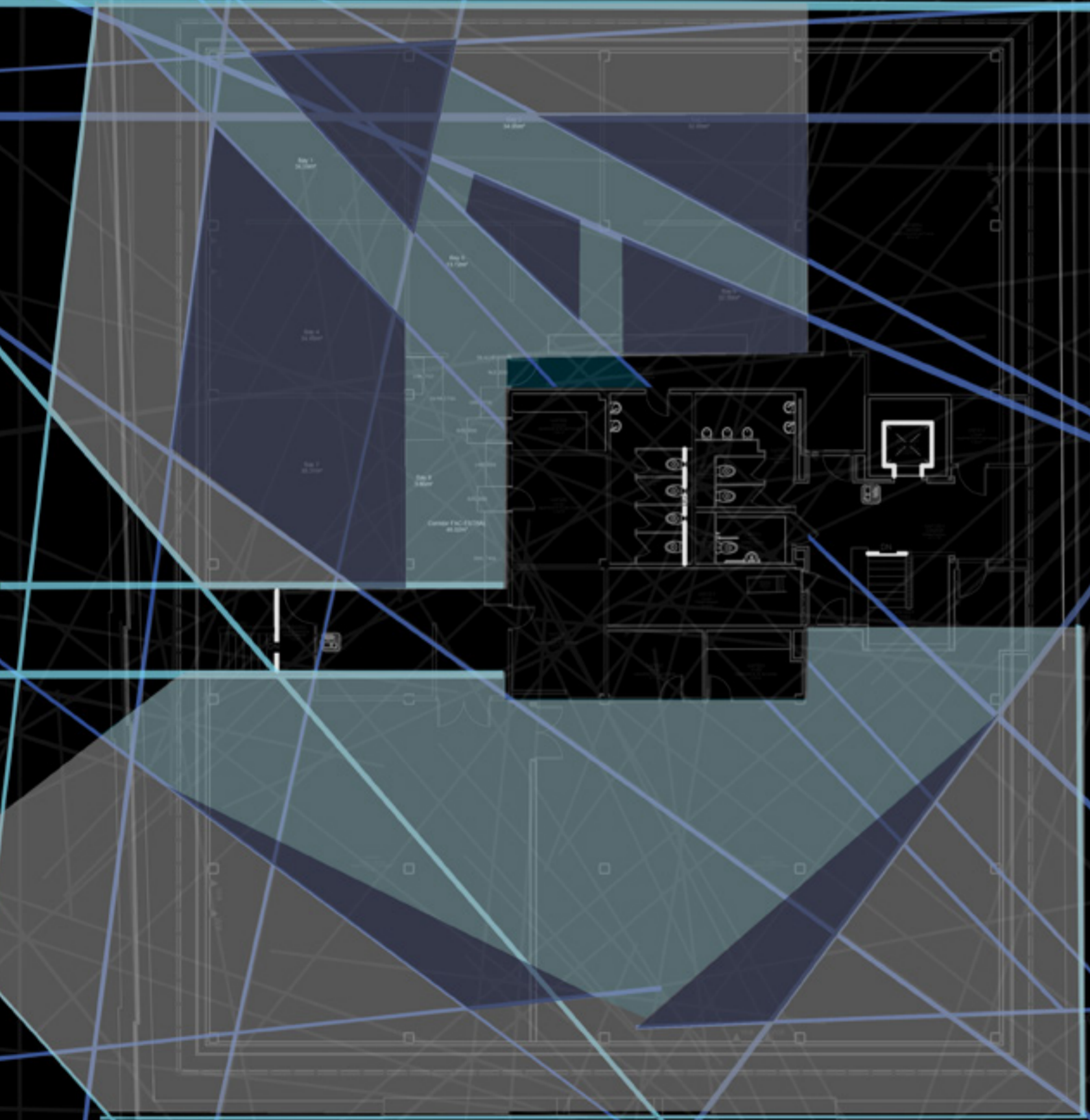

Virtual Zone

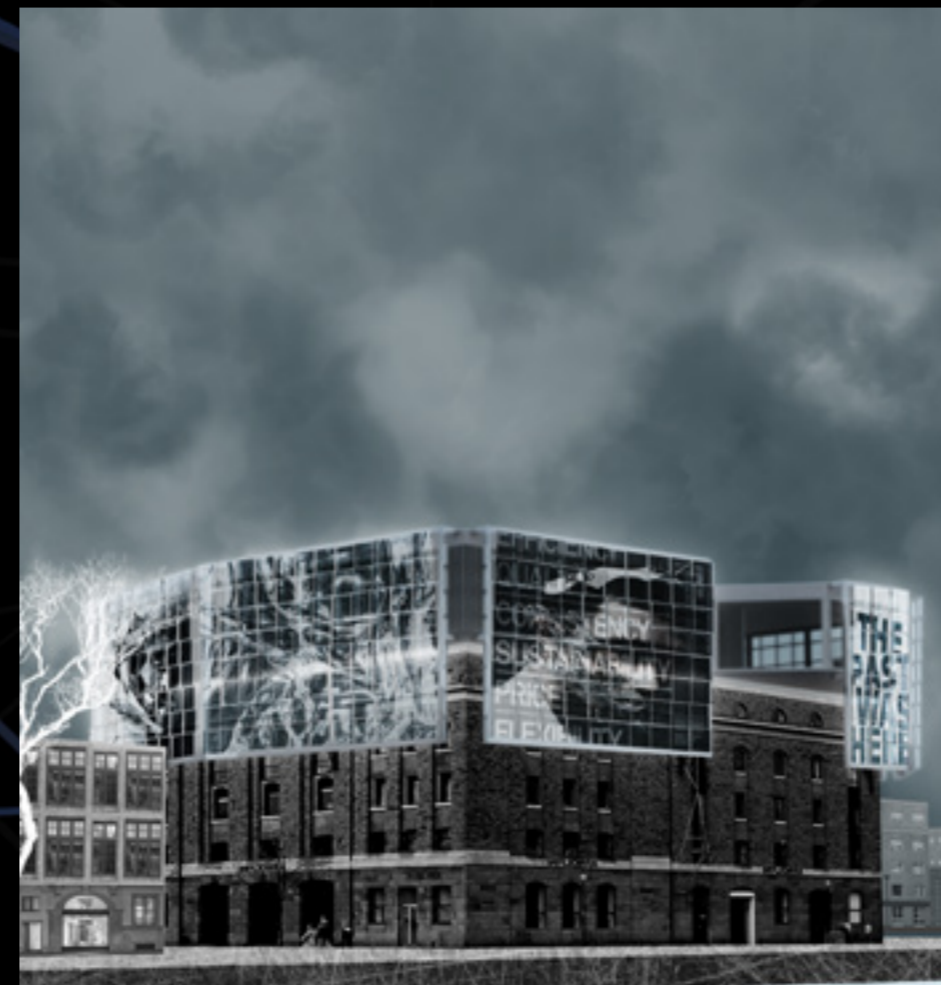

Exterior View

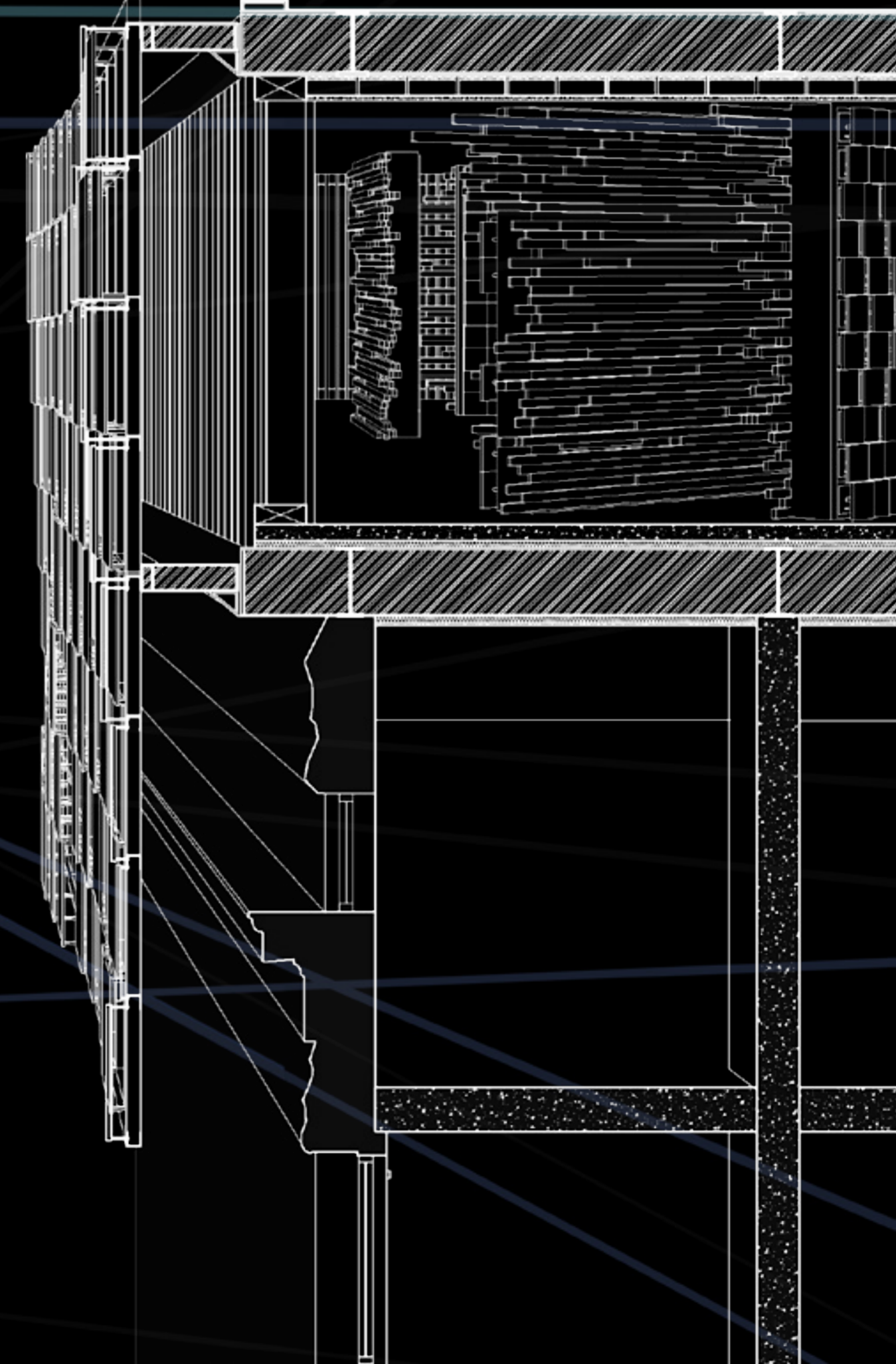

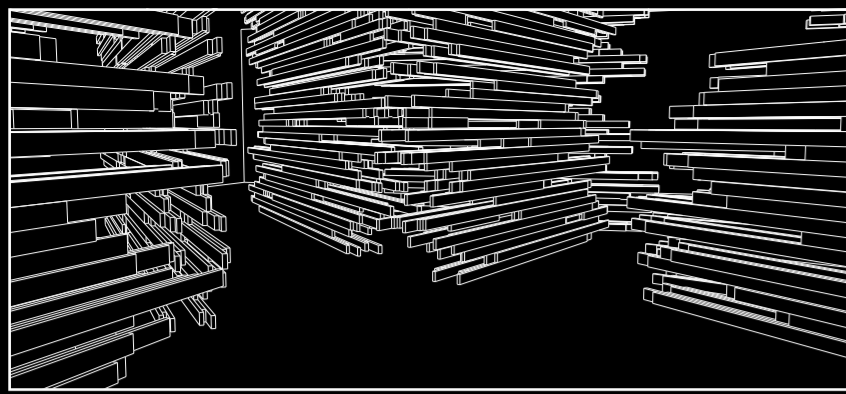

Circulation Space - Form and Lighting

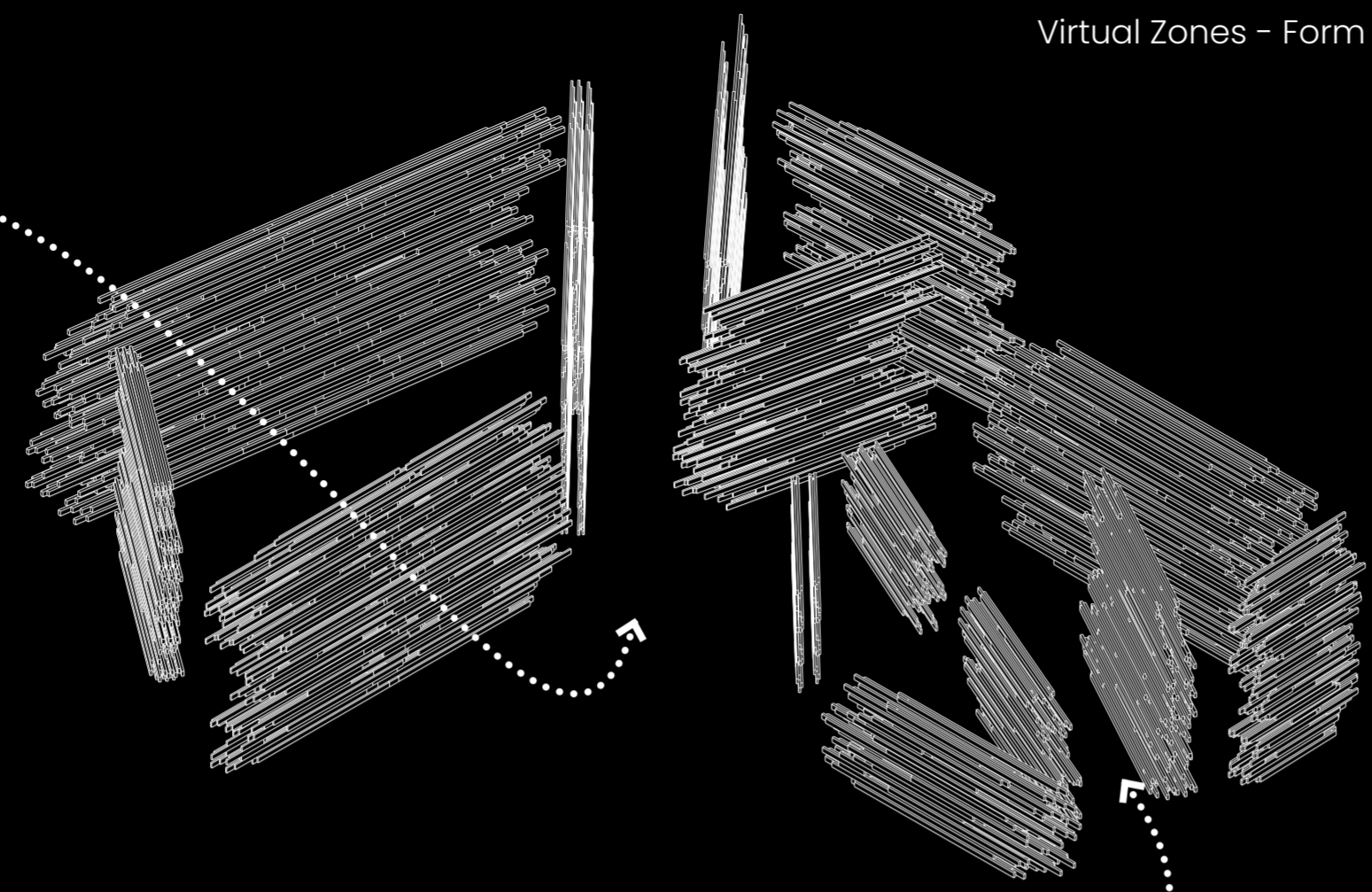
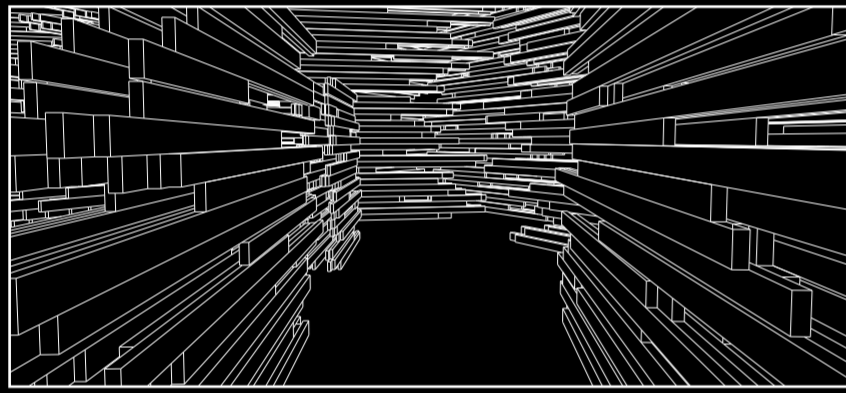

Virtual Zones - Form

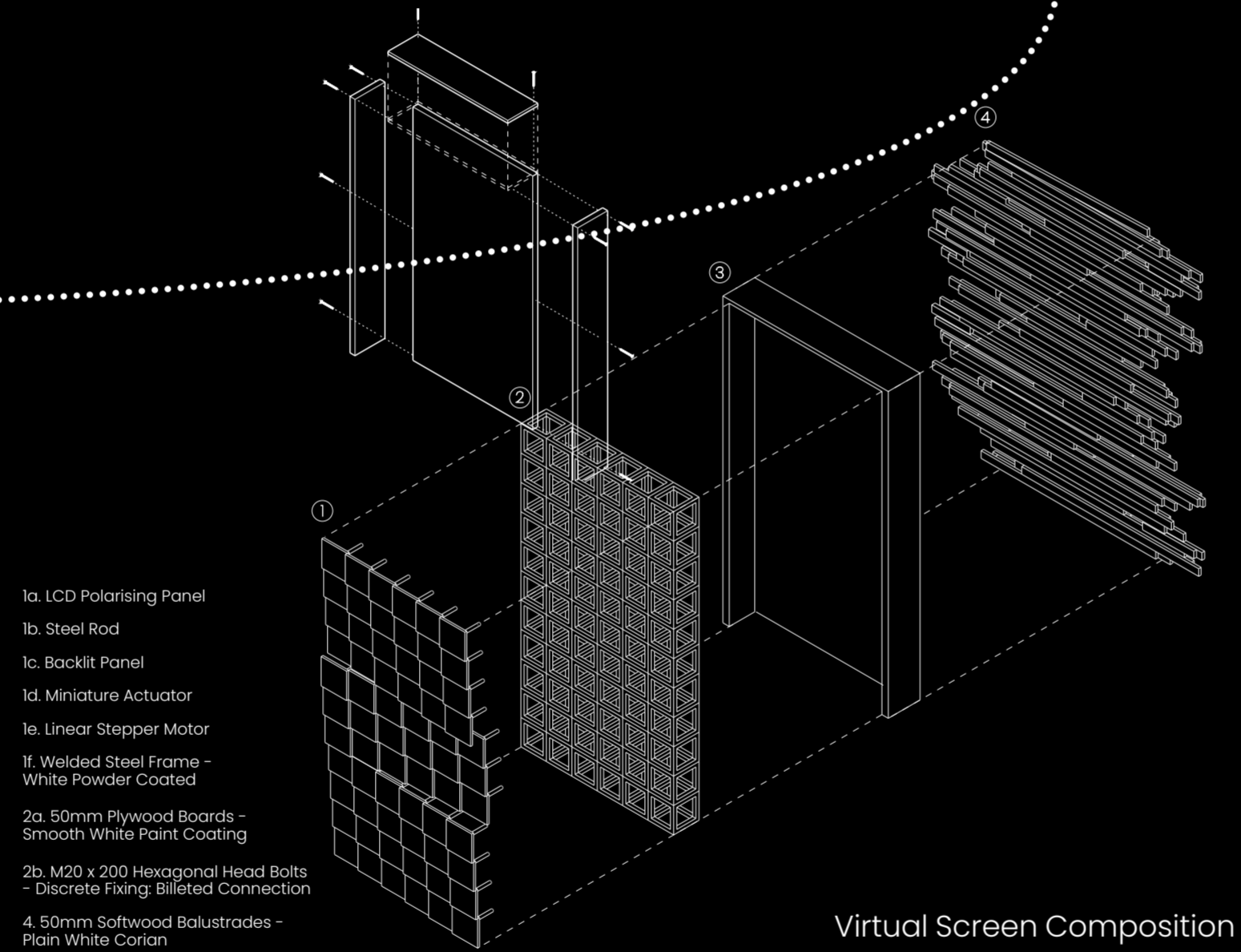

- 1a. LCD Polarising Panel
- 1b. Steel Rod
- 1c. Backlit Panel
- 1d. Miniature Actuator
- 1e. Linear Stepper Motor
- 1f. Welded Steel Frame - White Powder Coated
- 2a. 50mm Plywood Boards - Smooth White Paint Coating
- 2b. M20 x 200 Hexagonal Head Bolts - Discrete Fixing; Billeted Connection
- 4. 50mm Softwood Balustrades - Plain White Corian

Virtual Screen Composition

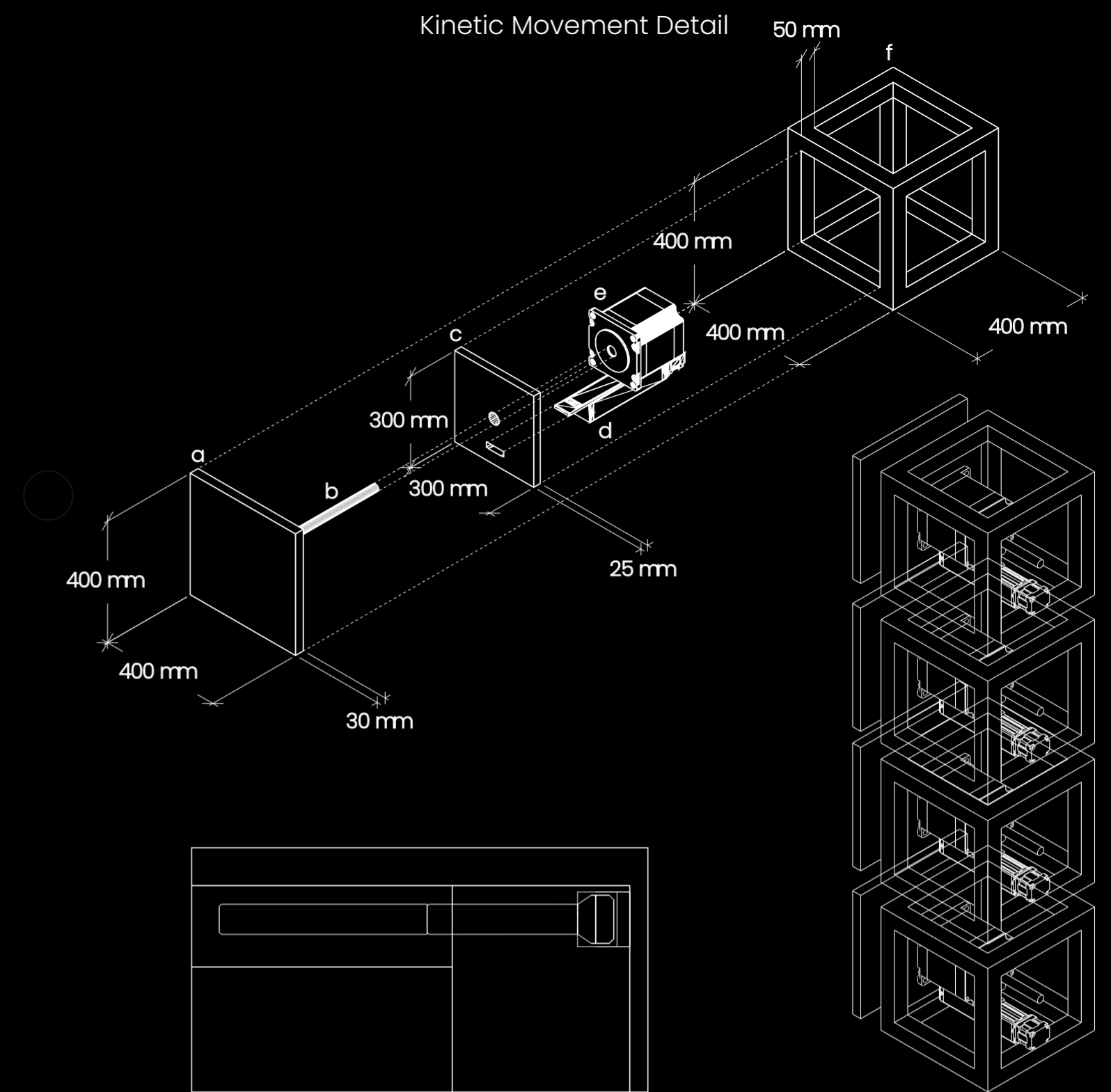

Kinetic Movement Detail

