

PAGAN RESURRECTION

SITE CONTEXT

FOR THIS PROJECT A 12TH CENTURY CISTERCIAN ABBEY SITUATED BY THE RIVER WEY IN SURREY WAS CHOSEN AS THE BUILDING SITE. THIS ABBEY WAS THE FIRST CISTERCIAN MONASTERY FOUNDED IN BRITAIN BY THE REFORMING CISTERCIAN ORDER. THIS CURRENT VERSION WAS BUILT DURING THE PEAK OF MEDIEVAL CHURCH'S RULING OVER THE MAJORITY OF EUROPE - THE PEAK POINT OF 'THE CATHOLIC CLENSE' A.K.A. PAGAN EXTERMINATION.

THE PARLOUR IN PARTICULAR WAS CHOSEN TO SITUATE THE NEW INSERTION DUE TO ITS MEANING OF COMMUNICATION. HAVING AN OPPORTUNITY TO TALK ABOUT PAGANISM, SPECIFICALLY ON THIS SITE IS A RARE OPPORTUNITY OF SETTING EQUALITY OF SOME SORT. THE CHURCH USED TO TAKE OVER SIGNIFIKANT PAGAN PLACES AND ERECT THEIR BUILDINGS IN THEM, BUT NOW A CATHOLIC RUIN IS GOING TO SITUATE A PAGAN-CENTRED BUILDING.

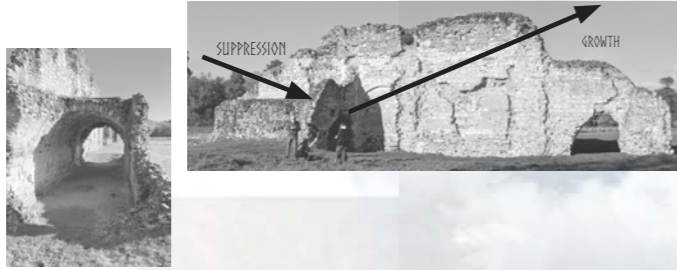
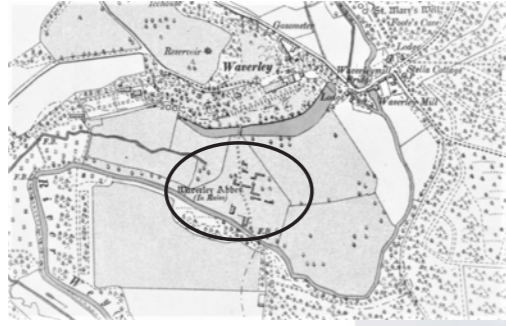

CONCEPT APPROACH

THE KEY PRINCIPLE OF PAGANISM IS BEING A PART OF THE SURROUNDING WORLD - THE NATURE. BEING A PART OF THE NATURAL LIFE CYCLE AND RESPECTING WHAT SURROUNDS YOU. THE MOST MEANINGFUL PART OF THIS CYCLE IS THE SUN, ITS MOVEMENT SIGNIFIES PASSAGE OF TIME, GROWTH AND CONSTANT CHANGE. PAGAN CALENDAR IS BASED ON THE POSITION OF THE SUN THROUGHOUT THE YEAR.

THE CALENDAR EVENTS THAT I HAVE DECIDED TO FOCUS ON ARE THE SOLSTICES AND THE EQUINOXES SINCE THESE FOUR DATES SIGNIFY THE DIFFERENCE BETWEEN SEASONS. THE SUN PLACEMENT AROUND THE SITE DURING THESE EVENTS CREATE A PERFECT WAY OF DIVIDING THE SPACE INTO INDIVIDUAL AREAS. CATEGORISING DATA BY SEASONS WOULD ALSO ALLOW A MORE COHESIVE FLOW OF THE JOURNEY AND WOULD NOT OVERLOAD THE AUDIENCE WITH THE AMOUNT OF INFORMATION TO PROCESS.

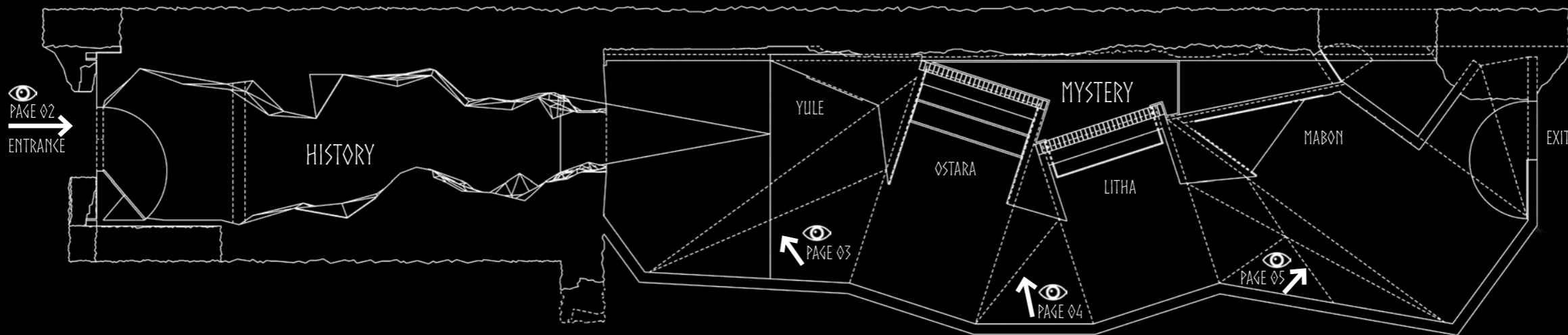
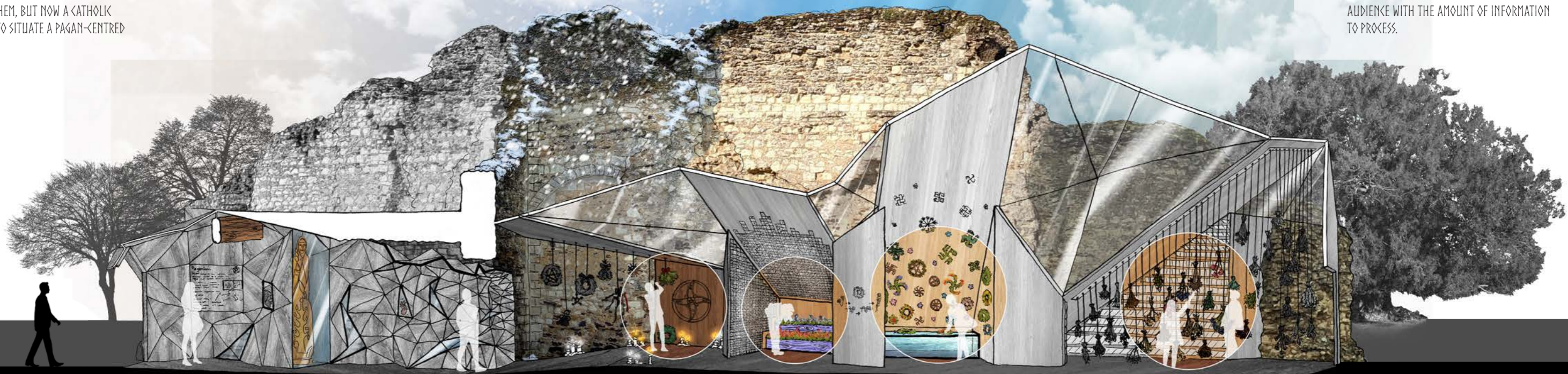



LIGHT OAK TIMBER FOR BIG WALLS AND CEILINGS



REINFORCED DARK OAK TIMBER FOR CUSTOM CUT WALL PIECES



CLEAR REINFORCED GLASS FOR DISPLAY UNITS AND WALL INSERTS

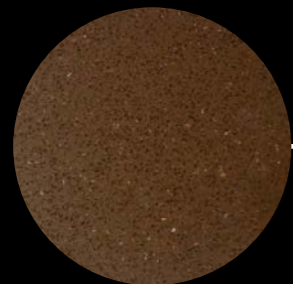

STONE EFFECT SEAMLESS VINYL TILES FOR ALL FLOORS

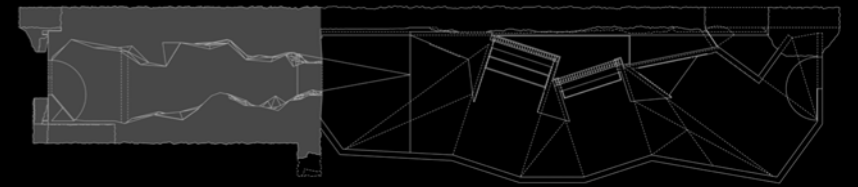
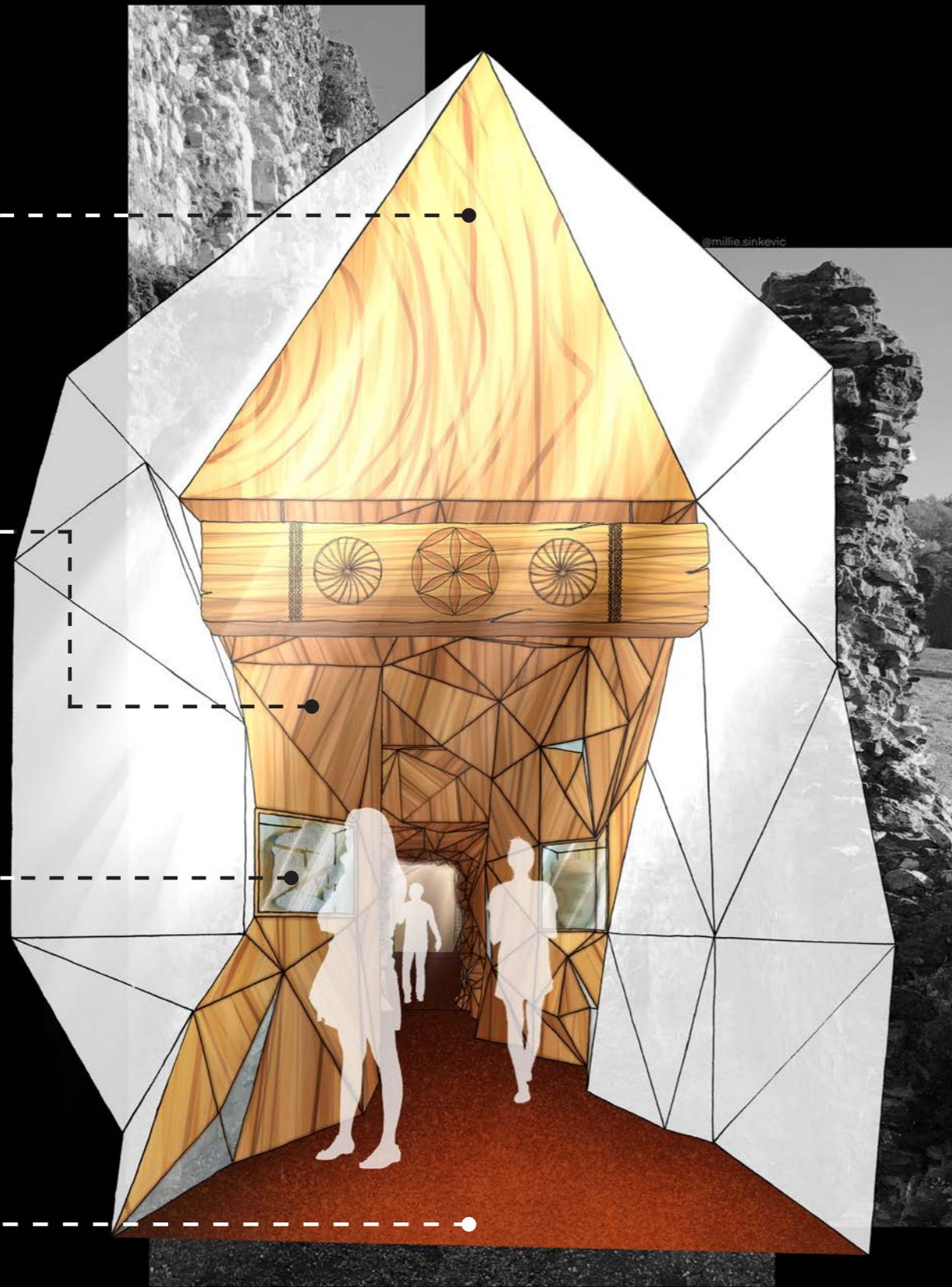

HISTORY

THROUGHOUT HISTORY PAGAN COMMUNITY WAS SUBJECTED TO HATE AND SUPPRESSION. TARGETED AND CONSTANTLY CONTROLLED BY THE ROMAN CHURCH THROUGHOUT THE MEDIEVAL TIMES IT ALMOST LOST ITS MEANING AND IDENTITY. THE RESULTS OF THIS STILL AFFECT THE WAY PEOPLE VIEW AND TREAT PAGANISM. THIS AREA REPRESENTS THE WEIGHT THAT PAGANISM WAS AND STILL IS CARRYING. ITS GRADUAL FRACTURE AND STRESS ARE REPRESENTED THROUGH THE SEVERE COMPRESSION AND THE SIZE CHANGE OF THE SPACE

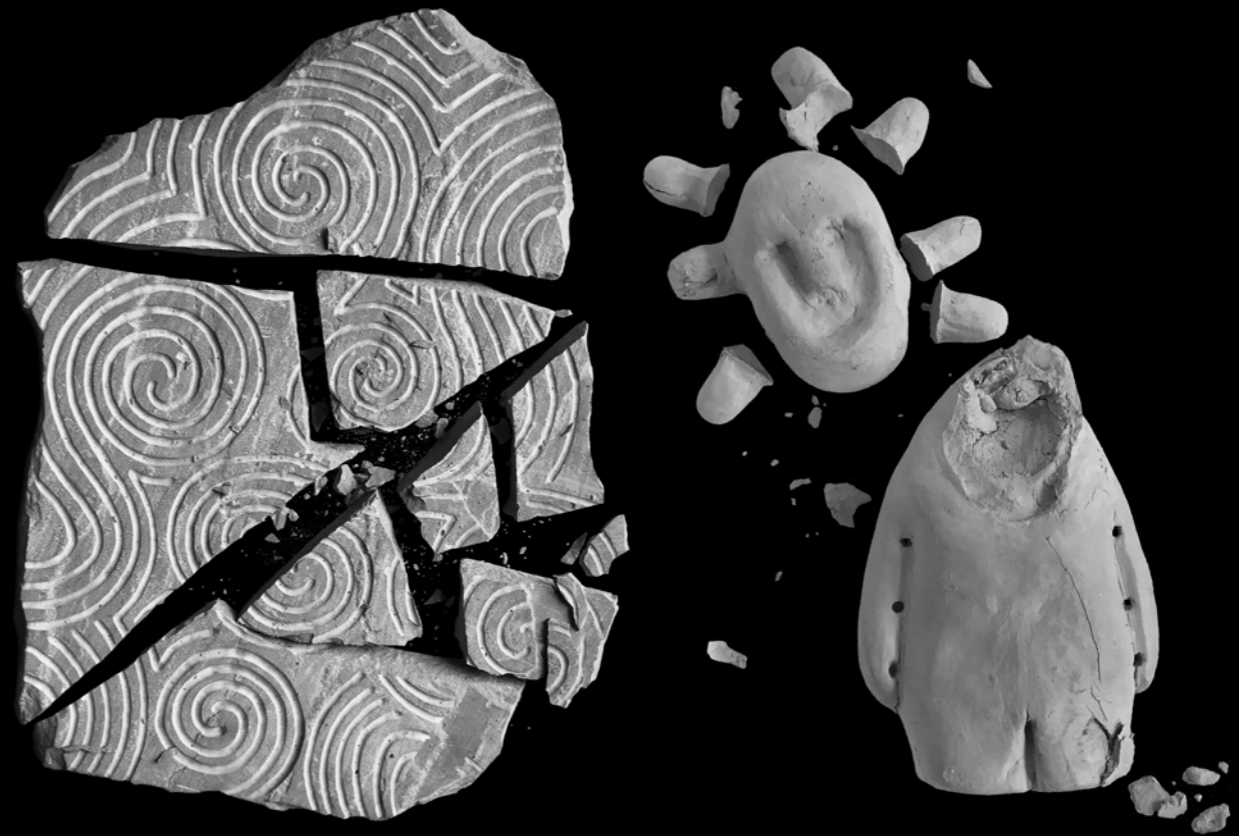

THIS AREA IS TO HOUSE DISPLAYS WITH DIFFERENT PAGAN ARTEFACTS FROM ALL OF CENTRAL EUROPE - FROM THE GREAT BRITAIN, TO THE RUSSIAN BORDER AND THE BALTIC SEA. CELTIC ROCK CARVINGS FROM THE UK, CLAY STATUES FROM THE NORSE GERMANY, TIMBER CARVINGS FROM THE SLAVIC AND BALTIC COUNTRIES. ALL OF THE ARTEFACTS ARE BROKEN, SHATTERED INTO PIECES, SHOWING THE DESTRUCTION OF THE PAGAN CULTURE AND ITS IDENTITY. ALL OF THE BEAUTIFUL AND MEANINGFUL PHYSICAL ELEMENTS OF PAGANISM LEFT IN PIECES, AS EVIDENCE THAT THEIR SPIRITUAL AND RELIGIOUS MEANING WAS DESTROYED AS WELL.

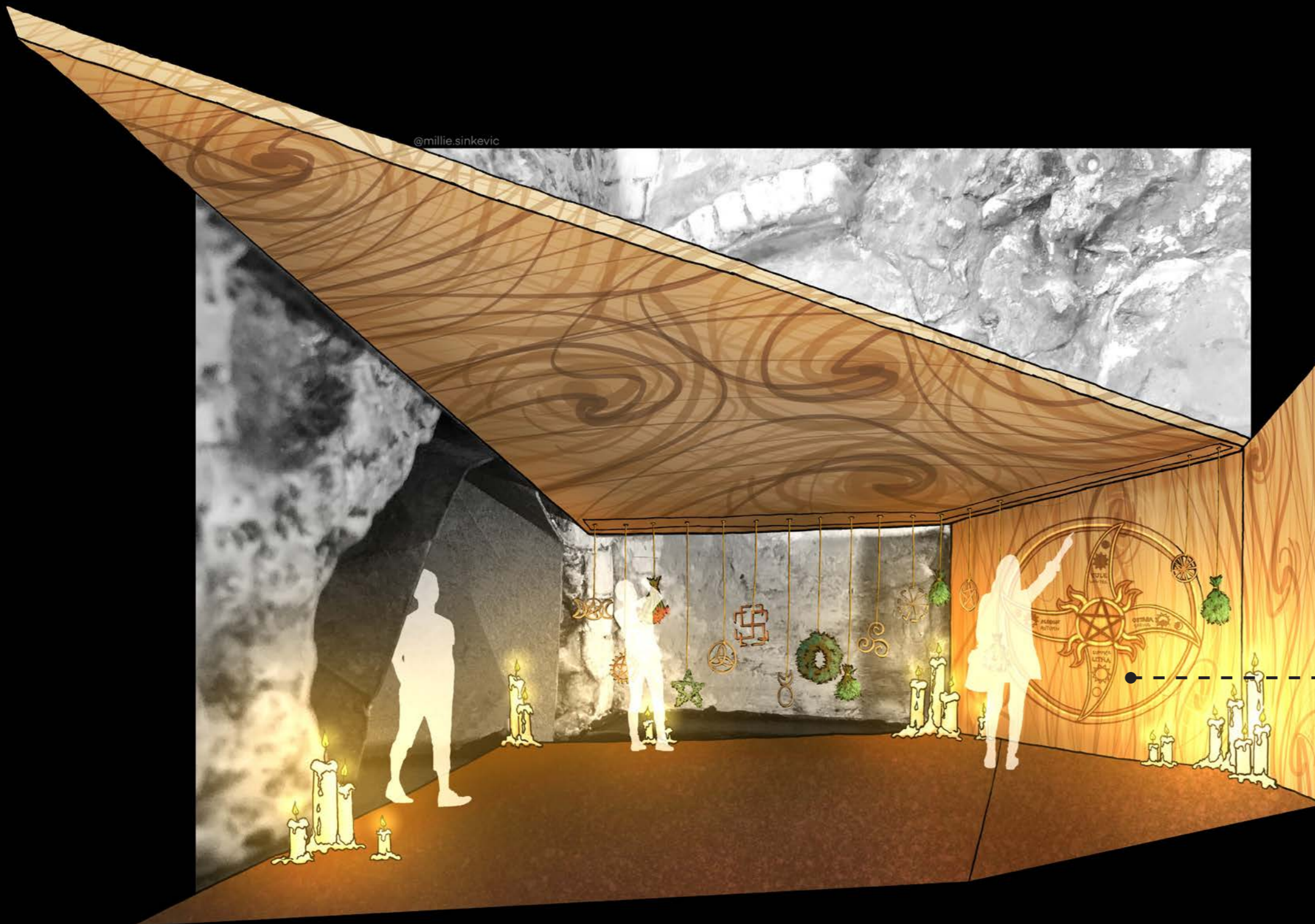

@millie.sinkevic

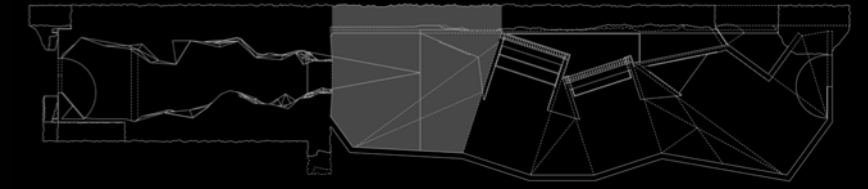

YULE

THE WHEEL OF THE YEAR MARKS ALL OF THE MOST IMPORTANT PAGAN CELEBRATIONS THROUGHOUT THE YEAR. ALL OF THEM ARE BASED ON THE SUN MOVEMENT, THE MOON PHASES AND THE CHANGE OF SEASONS. EACH OF THESE NEXT FOUR AREAS REPRESENTS ONE OF THE FOUR KEY DATES IN A PAGAN YEAR - BOTH SOLSTICES AND EQUINOXES.

YULE IS THE WINTER EQUINOX CELEBRATION. IT IS THE TRUE BEGINNING OF A NEW YEAR. UNFORTUNATELY, THIS CELEBRATION WAS CONVERTED BY THE CHURCH INTO CHRISTMAS AND THE CURRENTLY CELEBRATED VERSION OF THE NEW YEAR'S EVE IS VASTLY DIFFERENT WITHOUT ITS PAGAN ORIGINS. IN PAGANISM, WINTER IS THE TIME OF SOLITUDE, SELF-REFLECTION AND PEACE. THIS AREA IS THE TRANSITIONAL PEACE AFTER HEAVINESS OF THE HISTORY AREA.

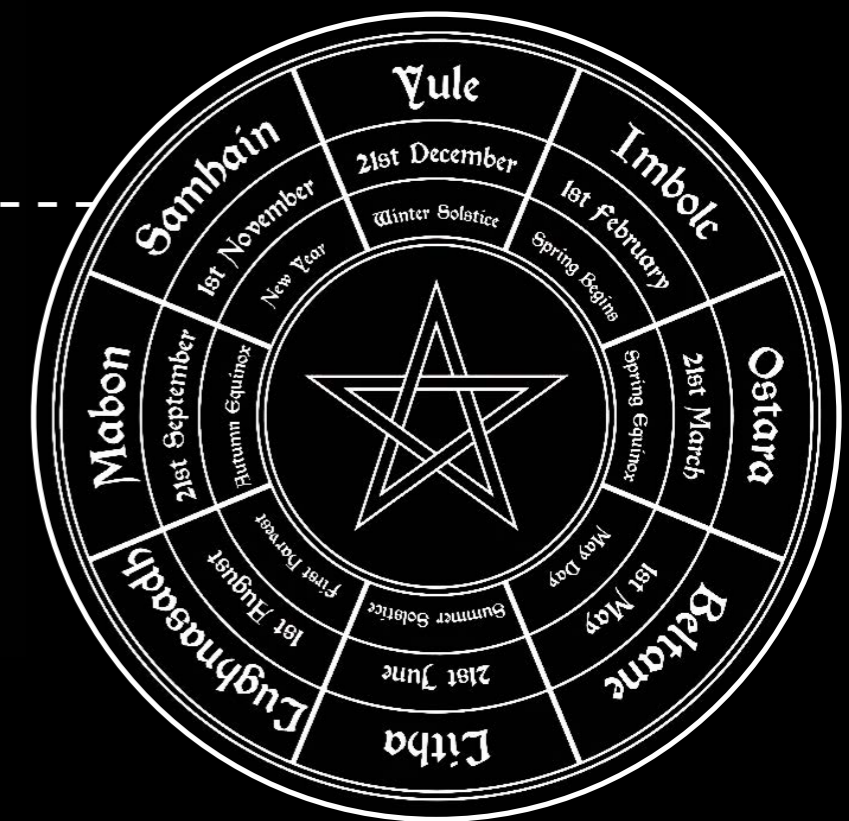

THE WHEEL OF THE YEAR COMES IN A LOT OF DIFFERENT VARIATIONS. SOME OF THEM DEPICT THE PAGAN PENTACLE - A SYMBOL OF FOUR ELEMENTS AND OUR SPIRIT, OTHERS SHOW THE SUN/MOON PHASES AND THE ZODIAC SIGNS. ALL OF THEIR MEANING IS THE SAME THOUGH - EVERYTHING MOVES TOGETHER IN A NATURAL LIFECYCLE, YEAR ROUND, CONSTANTLY.

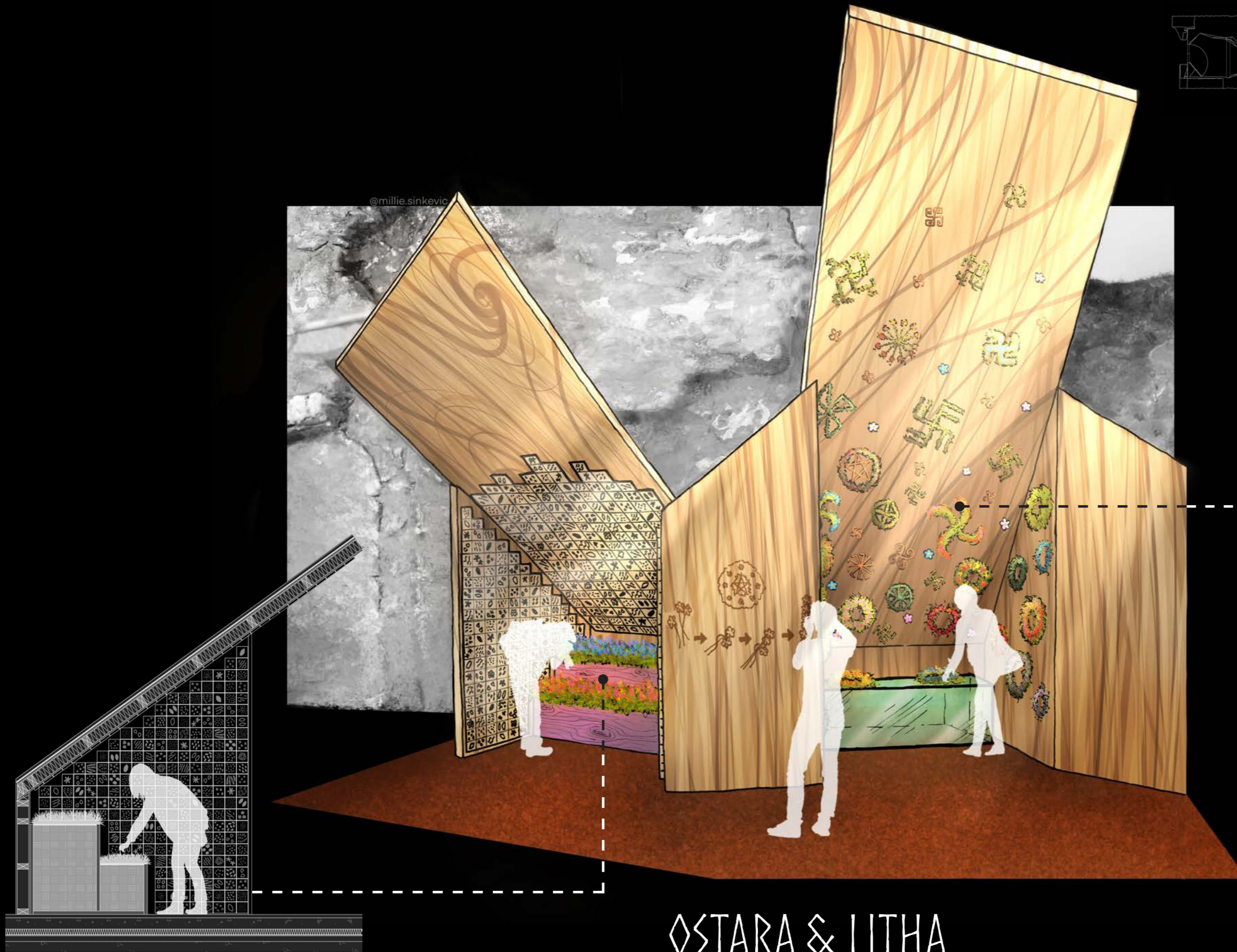

OSTARA IS THE CELEBRATION OF A NEW BEGINNING, NEW LIFE, NEW HOPE AFTER THE SOLITUDE OF WINTER. THE PLANTER WITH LIVE SPRING FLOWERS AND HUNDREDS OF RESIN TILES WITH DIFFERENT SEEDS SYMBOLISE THAT.

OSTARA & LITHA

OSTARA IS THE SPRING EQUINOX AND LITHA IS THE SUMMER SOLSTICE CELEBRATION. THESE TWO AREAS ARE CONNECTED, BECAUSE VISITORS ARE INVITED TO COLLECT FLOWERS FROM THE OSTARA AND WEAVE CROWNS OUT OF THEM FOR THE LITHA TRADITION OF PUTTING FLOWER CROWNS ON WATER.

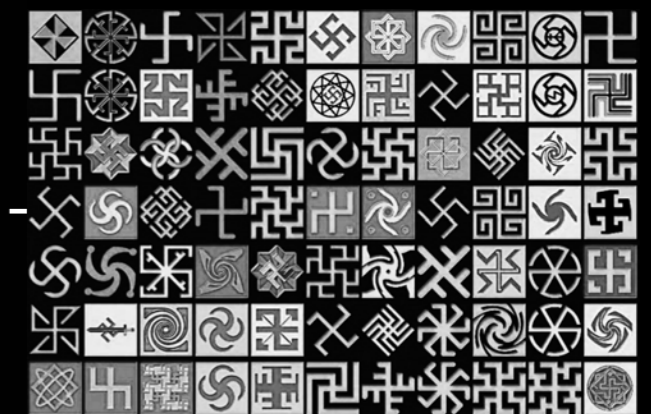

LITHA IS A CELEBRATION OF THE SUN BEING AT ITS HIGHEST POINT. IT IS THE MOST POWERFUL AT THIS TIME AND ITS LIGHT IS THE BRIGHTEST - THIS TIES WITH THE LIGHT SYMBOL THAT IS REPETITIVELY USED THROUGHOUT THIS AREA. IT ORIGINATED IN EARLY DAYS OF PAGANISM AND REPRESENTED THE POWER OF THE SUN AND ITS CONSTANT MOVEMENT. IT HAS BEEN MISUSED BY DIFFERENT PEOPLE THROUGHOUT HISTORY - MOST NOTEABLY BY THE NAZI GERMANY DURING THE WWII AND SO ITS TRUE MEANING HAS BEEN FORGOTTEN.



@millie.sinkevic

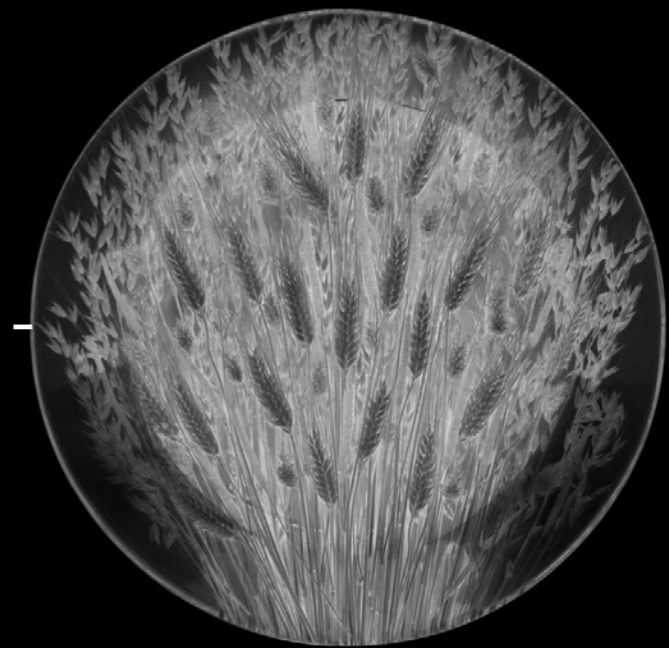
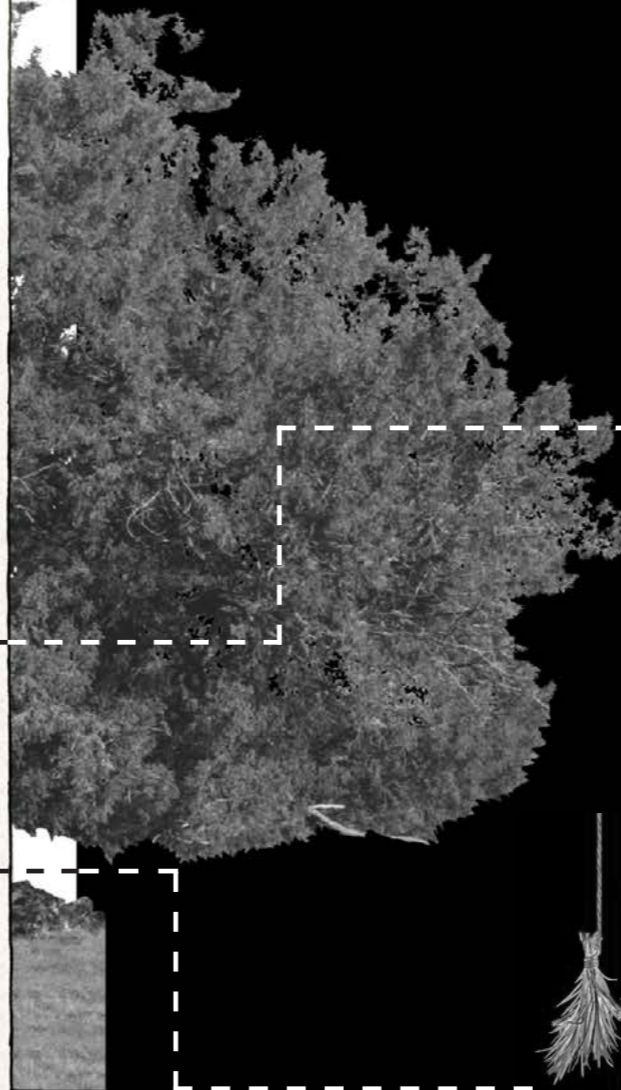
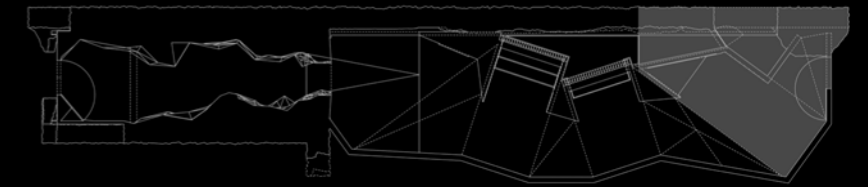

MABON

THIS AREA CELEBRATES MABON - THE AUTUMN EQUINOX. AUTUMN IS A VERY IMPORTANT TIME IN PAGANISM, IT IS THE TIME OF HARVEST AND PREPARATION FOR WINTER. IN PAGAN CULTURE PRESERVING AUTUMN HARVEST AND SACRIFICING A PART OF IT FOR PRAYERS IS EXTREMELY IMPORTANT.

IN THIS AREA AUTUMN PRODUCE CASTED IN RESIN - DRIED FRUITS, BERRIES, NUTS AND WHEATS - IS DISPLAYED ON THE WALLS.

THERE IS ALSO A VARIETY OF DRYING PLANTS HANGING FROM THE CEILING - THIS IS AN OLD PAGAN WAY OF PRESERVING HERBS AND SPICES FOR THE WINTER.

VISITORS ARE ABLE TO INTERACT WITH PLANTS FOR THEY WOULD BE EXCHANGED YEARLY SO THAT THE AREA IS ALWAYS FILLED WITH A RANGE OF HERBAL AROMAS.

AT THE END OF THIS LAST AREA, AS THEY GO THROUGH THE EXIT DOOR VISITORS SEE A BIG YEW TREE THAT HAS TAKEN OVER A PART OF THE OLD CHURCH. IT IS A SIMPLE RETURN TO THE REAL WORLD, A VERY FITTING TRANSITION VIEW THAT SUBCONSCIOUSLY CONTINUES THE USER JOURNEY EVEN AFTER THEY LEAVE THE SPACE.

THE WHOLE BUILDING IS ABOUT THE PAST AND THE PRESENT, SO THIS NATURAL TRANSITION OUT OF IT LEAVES IT UP FOR THE VISITORS' INTERPRETATION AS TO WHAT THE FUTURE WILL BE.