

WELCOME TO.....

HORIZON HIVE

My floating microhome, inspired by the form and function of a deconstructed beehive, is a speculative response to the urgent challenges shaping the future of interior design. Set on water, this compact dwelling reimagines how we inhabit space in an era marked by political, economic, and social transformation.

The project addresses the growing need for adaptable, sustainable housing in the face of climate change, urban density, and housing crises. By occupying underused water bodies, the micro-home challenges traditional notions of land-based living and offers a future-forward solution to space scarcity and rising sea levels.

HORIZON HIVE ETHOS

Inspired by the intricate architecture of the honeycomb, this floating micro-home embodies the life and spirit of the artist: adaptive, innovative, and interconnected with nature. Its modular, hive-like structure promotes both individuality and community—encouraging a shared, yet private model of living that responds to shifting social dynamics.



FRONT OF STRUCTURE



GENESIS IMAGE



CONCEPT COLLAGE



CONCEPT COLLAGE

As cities continue to grow and urban land becomes increasingly scarce, the concept of designing micro-homes on bodies of water—such as London's Victoria Docks—presents an innovative and necessary response to the ongoing housing crisis.

In areas like Victoria Docks, floating micro-homes could reinvigorate neglected waterfronts, transforming them into vibrant, livable, and inclusive spaces. This reimagining of urban living demonstrates how design can respond proactively to social, economic, and environmental pressures—offering a scalable solution that redefines how we think about home, land, and city life.

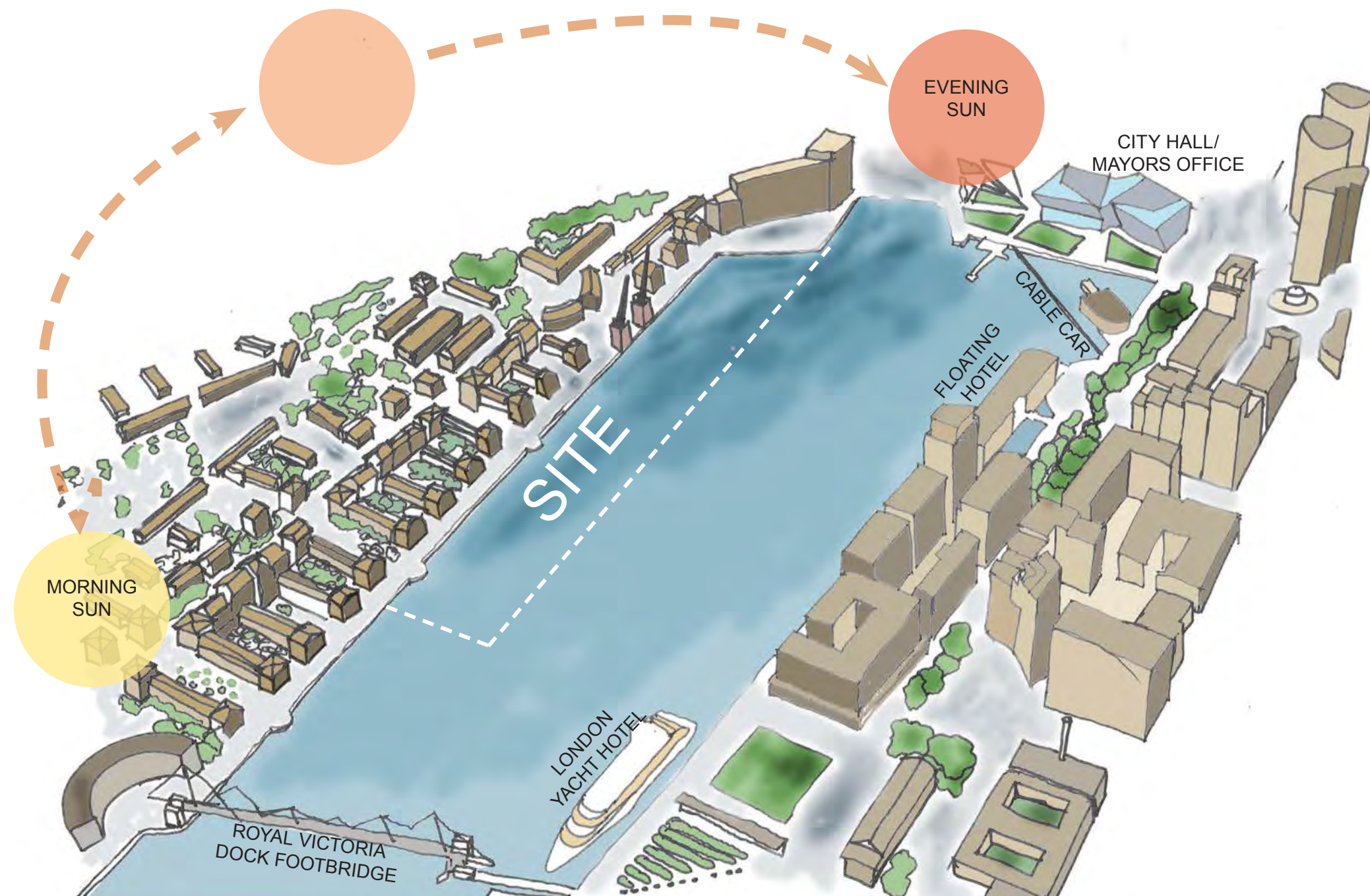

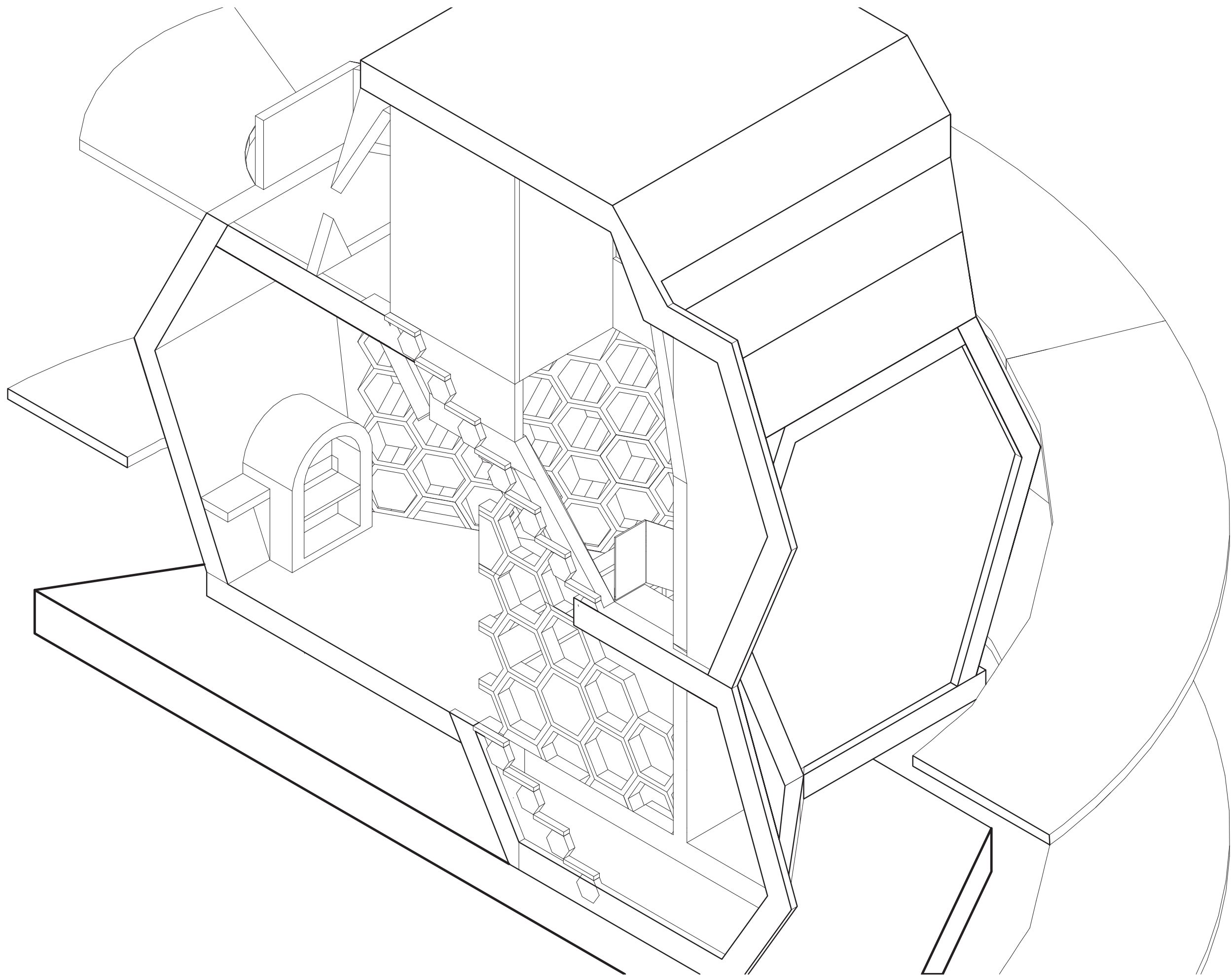

AXONOMETRIC 1:20

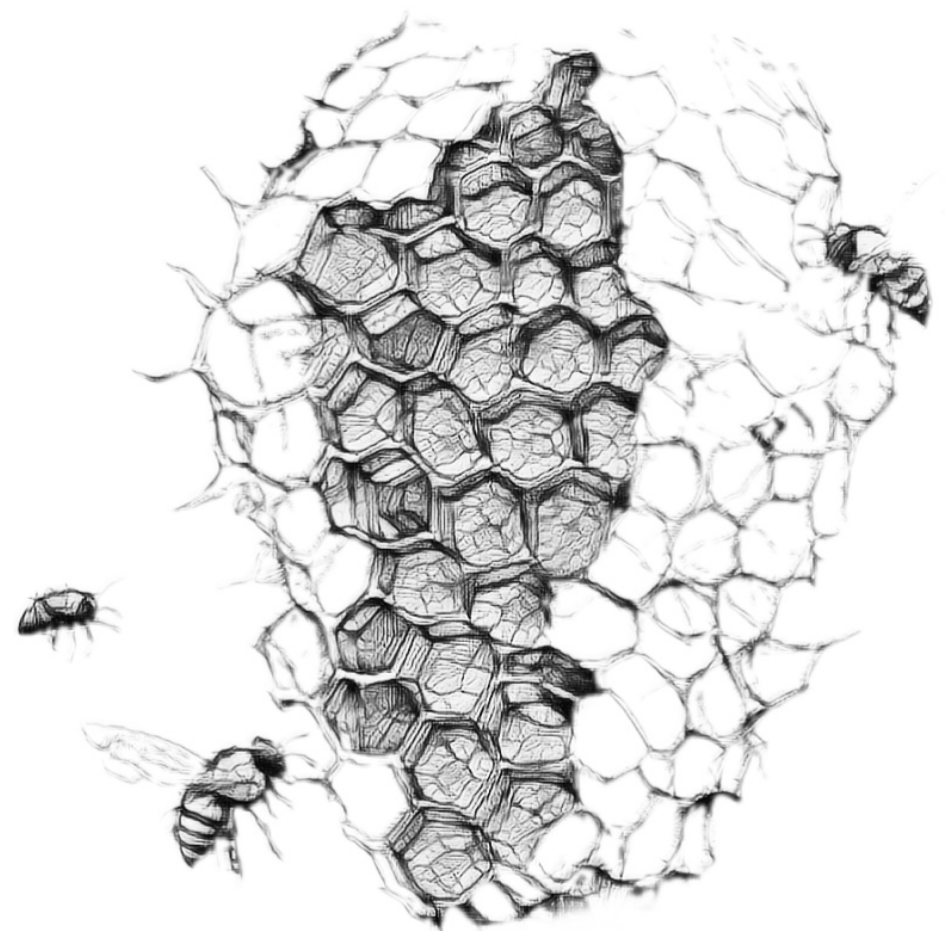

DECONSTRUCTED BEEHIVE SKETCH



MIDJOURNEY



MIDJOURNEY



MIDJOURNEY

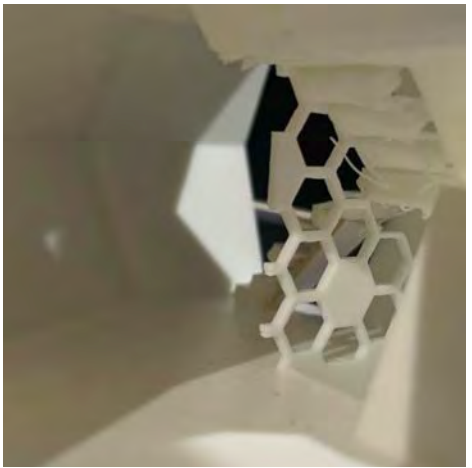
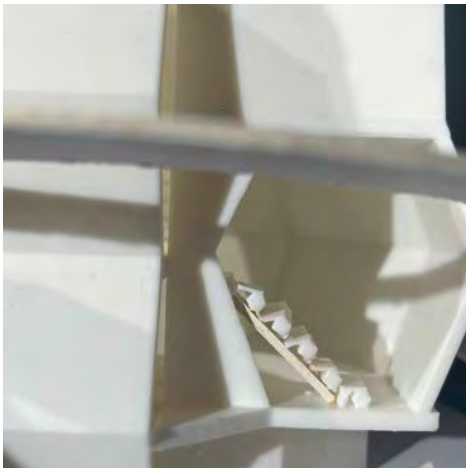

3D PRINTED MODEL MADE FROM PLA

BATHROOM

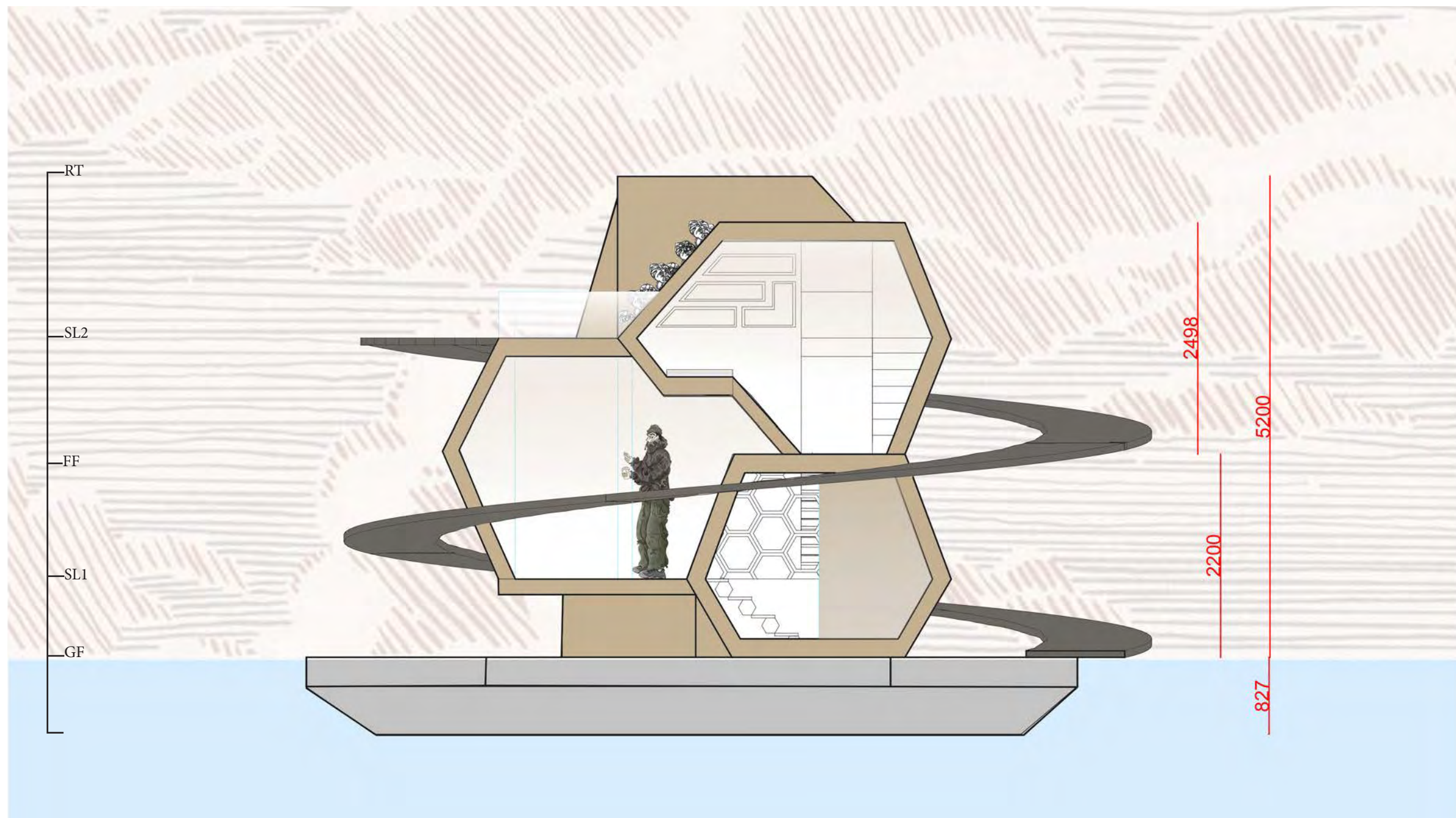

FRONT ELEVATION 1:50

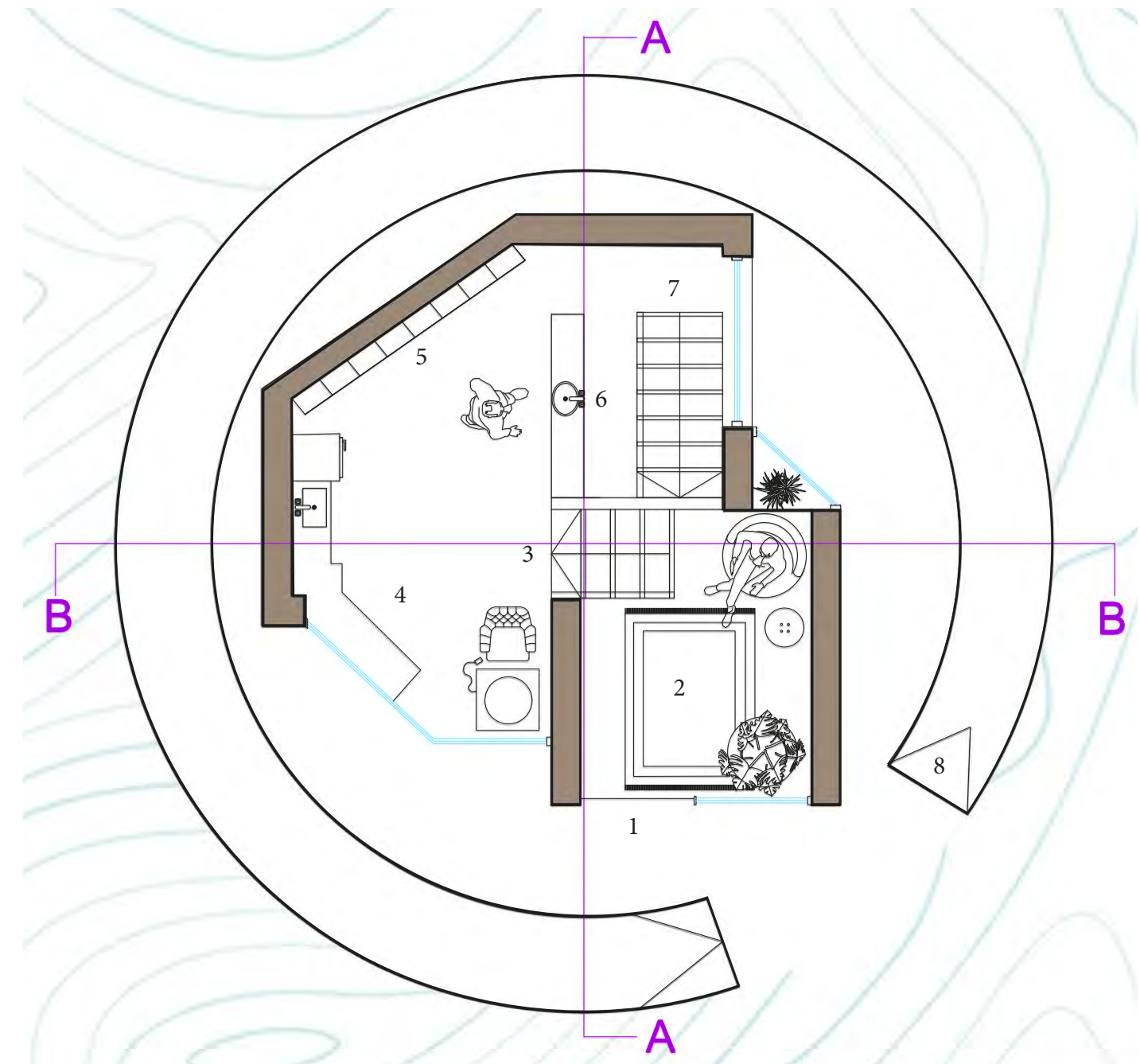
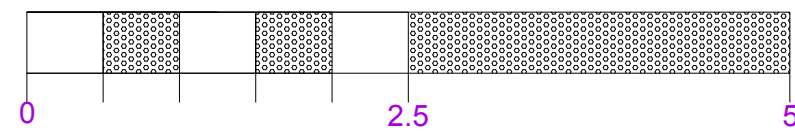

GROUND / SPLIT LEVEL 1 FLOOR PLAN 1:50

1. ENTRANCE
2. LOUNGE
3. STAIRS TO SPLIT LEVEL ONE
4. ARTIST WORKSPACE
5. STORAGE
6. KITCHEN
7. BOTTOM OF STAIRS TO FIRST FLOOR
8. BOTTOM OF RAMP

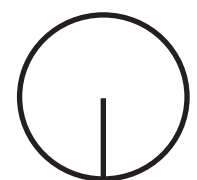

ENTRANCE / CHILL AREA



CLAY PLASTER



CORK



THERMALLY MODIFIED WOOD (TMW)



ASHCRETE

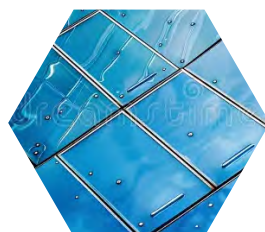

SOLAR GLASS

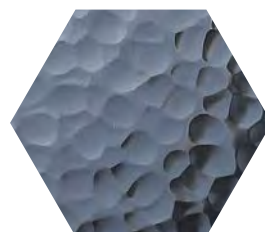

RECYCLED ALUMINUM:



TIMBER (OAK)

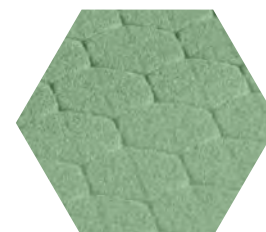

RECYCLED PET FOAM

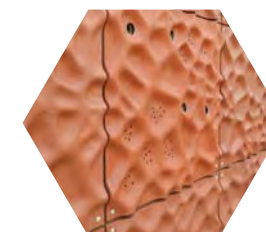

BIO-BASED RESIN PANELS



CROSS-LAMINATED TIMBER (CLT):



MYCELIUM INSULATION PANELS

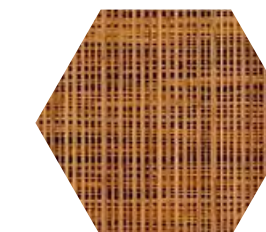

BAMBOO COMPOSITE PANELS:

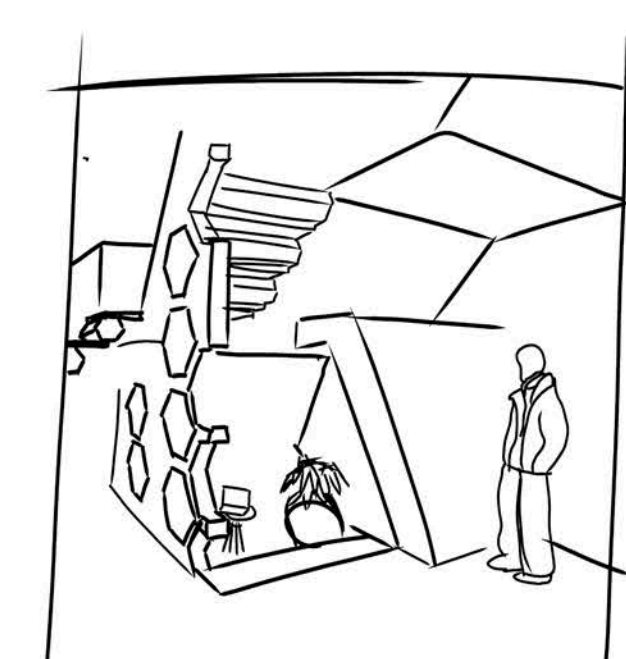
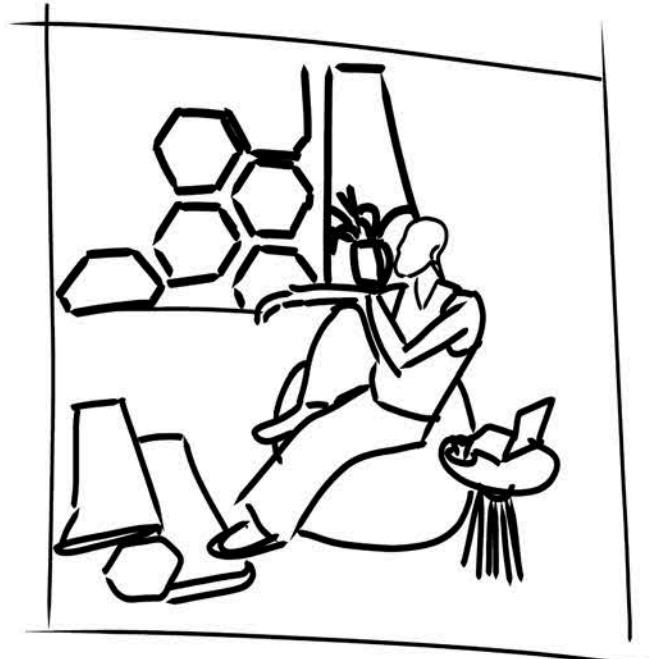
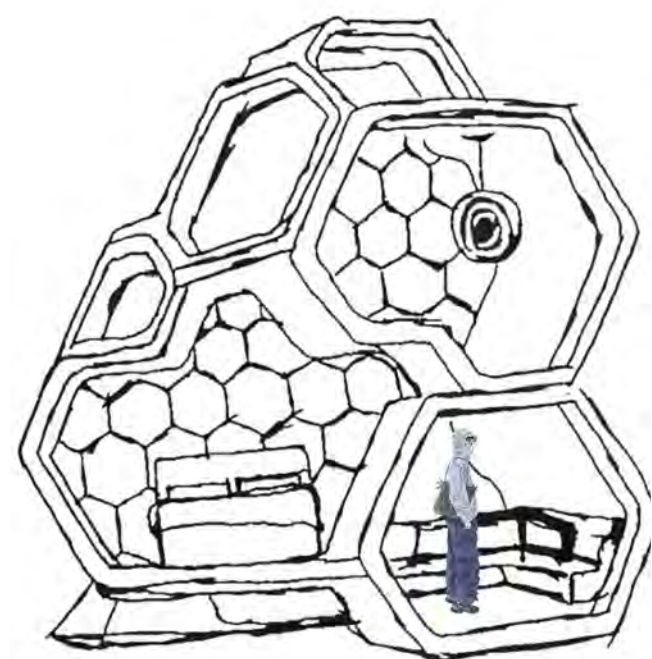

JOURNEY

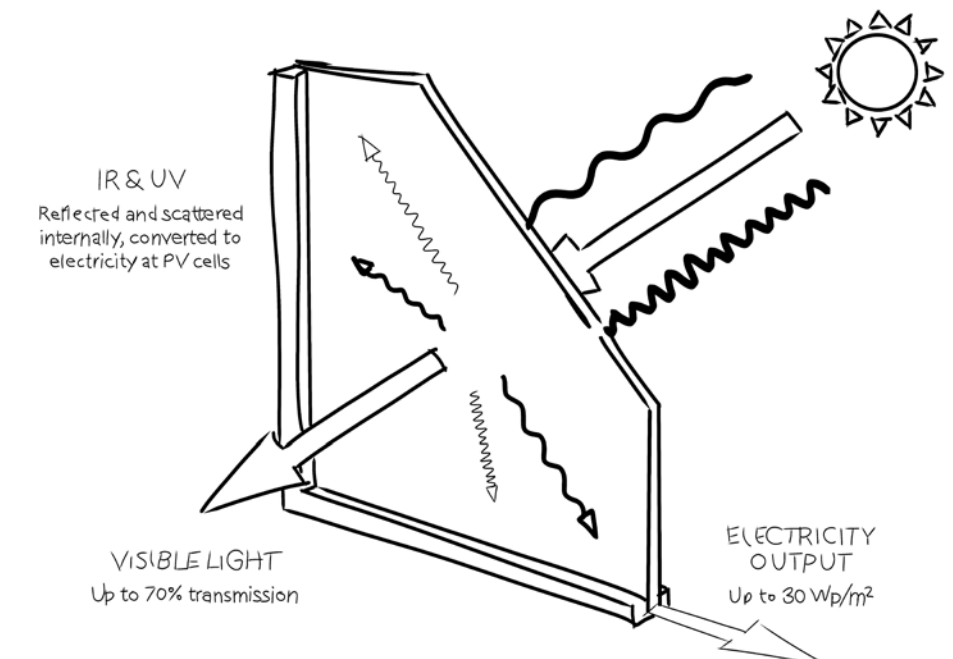
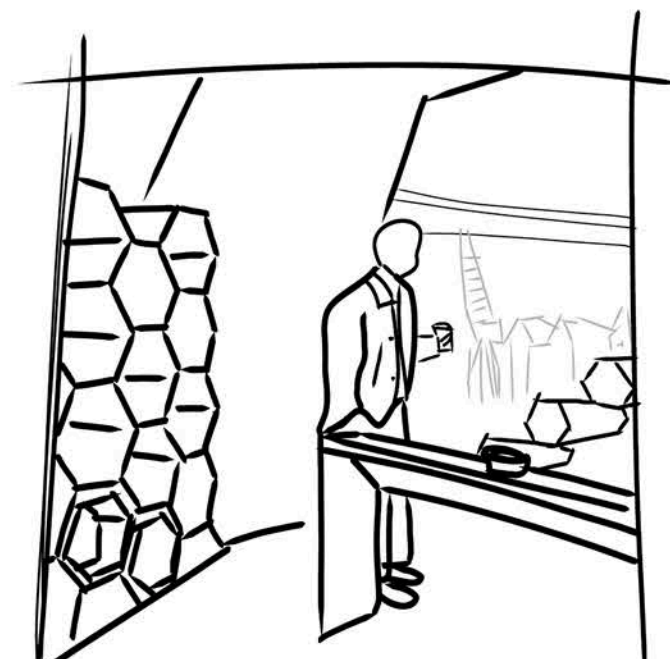

SOLAR GLASS DIAGRAM