

WONDER

Beneath the Surface

Wonder reimagines interior design through an innovative physical-digital methodology that translates biological systems into spatial experience. Inspired by the organisational intelligence of ant colonies, the project combines analogue model making, 3D scanning, digital modelling and simulation within an iterative workflow that moves between physical experimentation and digital development. Rather than replicating natural forms, Wonder uses biological behaviours as a design generator for circulation, gathering and atmosphere. This interdisciplinary process creates new modes of spatial and experiential engagement, demonstrating how hybrid methods can generate immersive communal environments and expand how interiors are conceived, developed and experienced today.

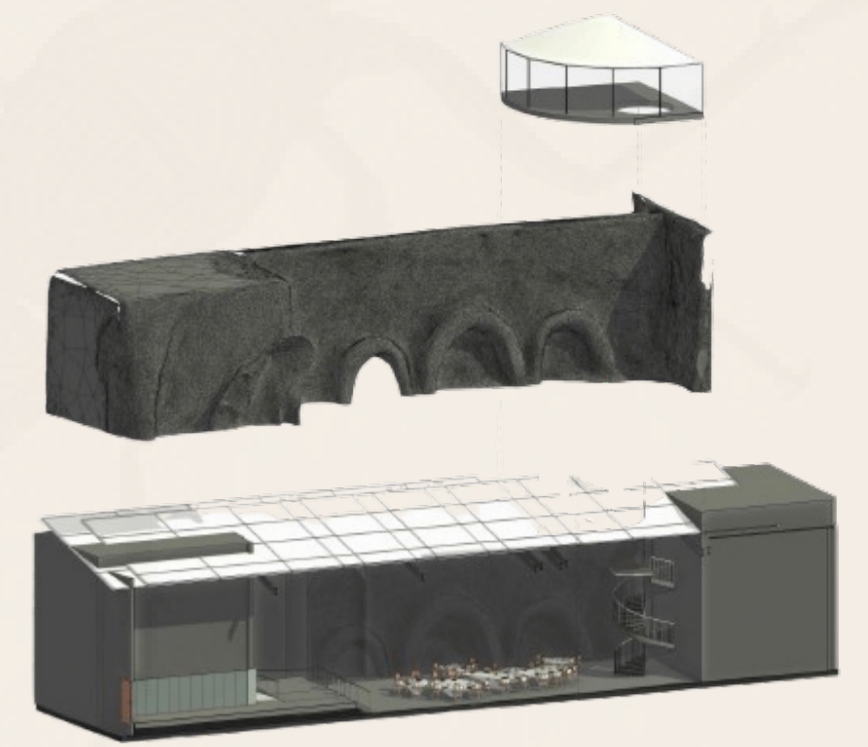

We don't just dine in WONDER, we become part of it.



Methodology + Process

From Colony to Collective space: A Physical-Digital Design Methodology

Wonder is not a surface experience but something embedded within structure and process.

Wonder translates ant colony intelligence into immersive spatial environments through a physical-digital design methodology combining observation, analogue model making, 3D scanning, digital modelling and simulation. Rather than replicating the appearance of colonies, the project uses their organisational intelligence as a spatial generator to inform circulation, communal gathering and adaptive atmospheric environments.

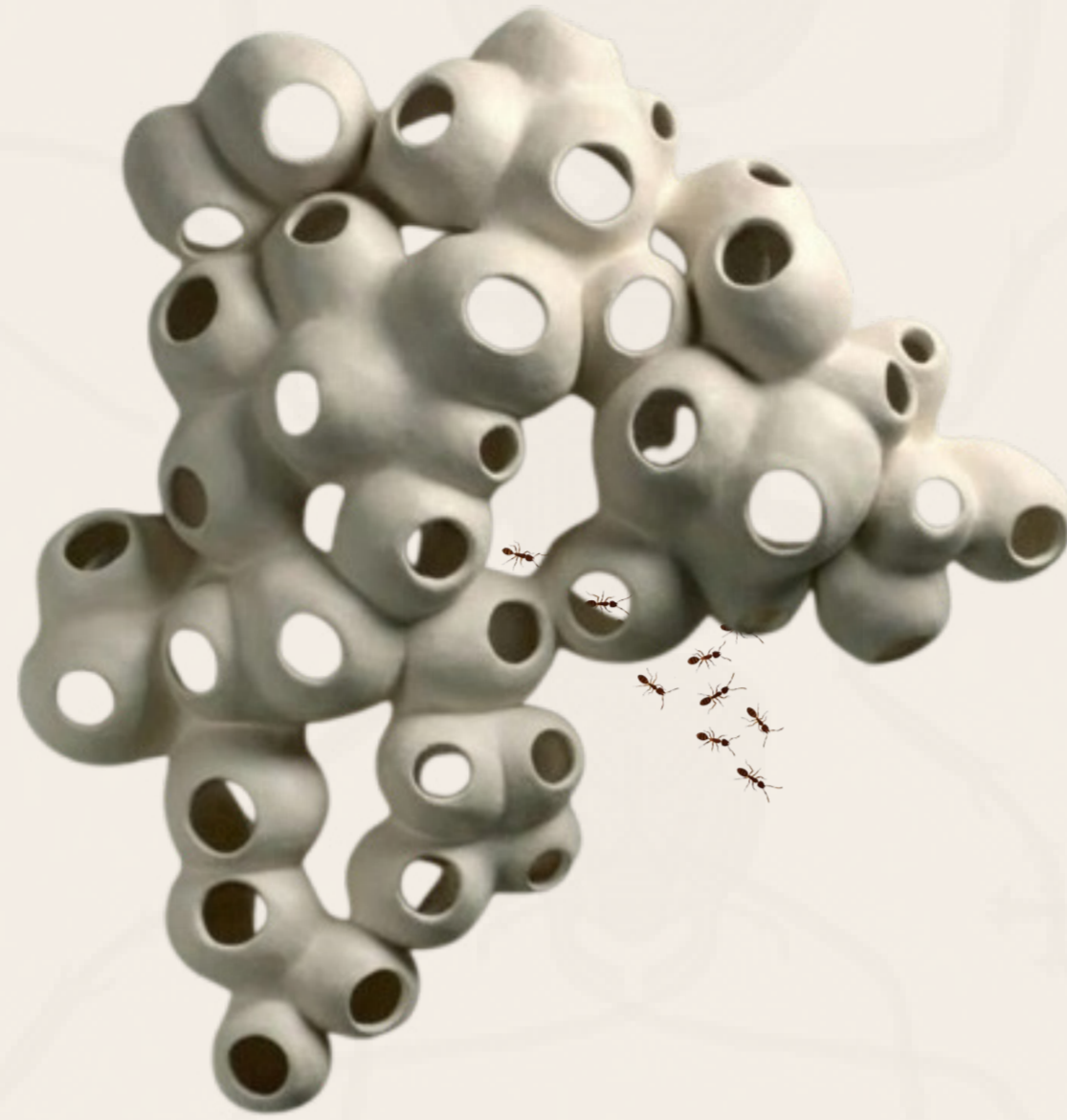

Digital furniture making on Rhino

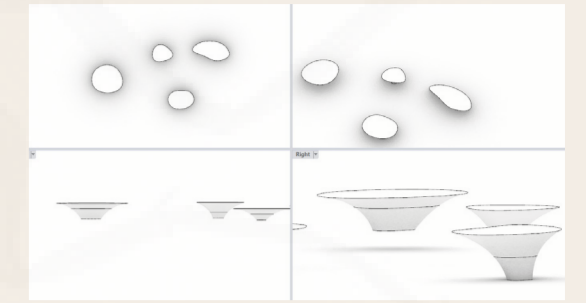

1. Observe

Ant colony systems and behaviours.

2. Experiment

Physical models exploring circulation, chambers and connectivity.

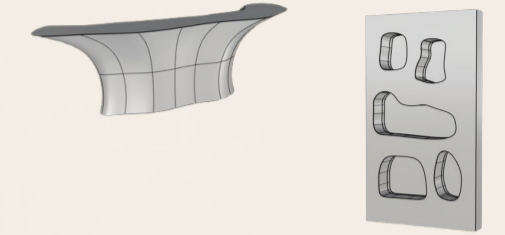

3. Translate

Digital modelling used to develop spatial organisation and atmosphere.

4. Experience

Immersive environments that encourage gathering, exploration, and collective dining.

Physical clay models were digitally scanned and iteratively refined in Rhino, creating a cyclical workflow between analogue experimentation and digital spatial development.

OBSERVE

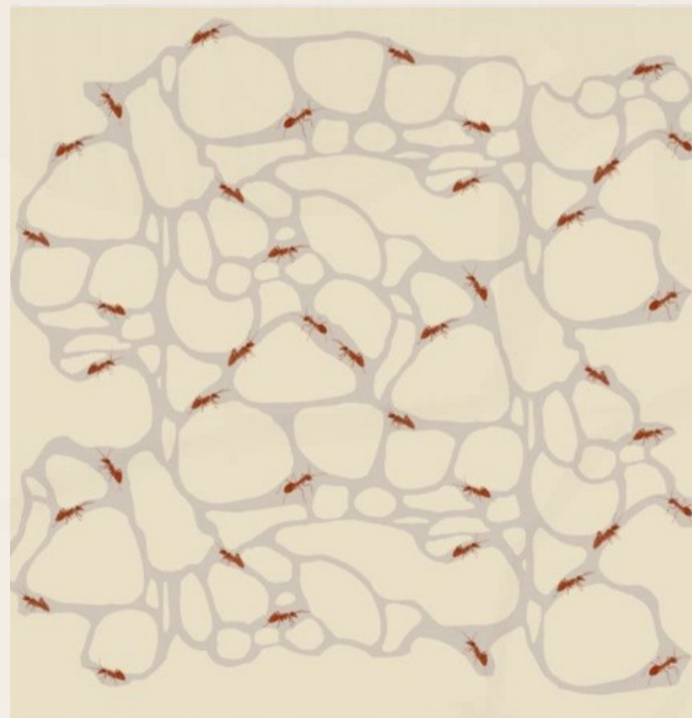

Colony systems

EXPERIMENT



Physical clay model

TRANSLATE



Digital 3D scanned model

EXPERIENCE



Rendered Immersive dining perspective

Material exploration



Organic materials featuring porous textures, natural patterns, and soft sculptural forms.



Hand-made scaled clay model exploring the integration of an organic form within the existing brick structure.

Light + Atmosphere

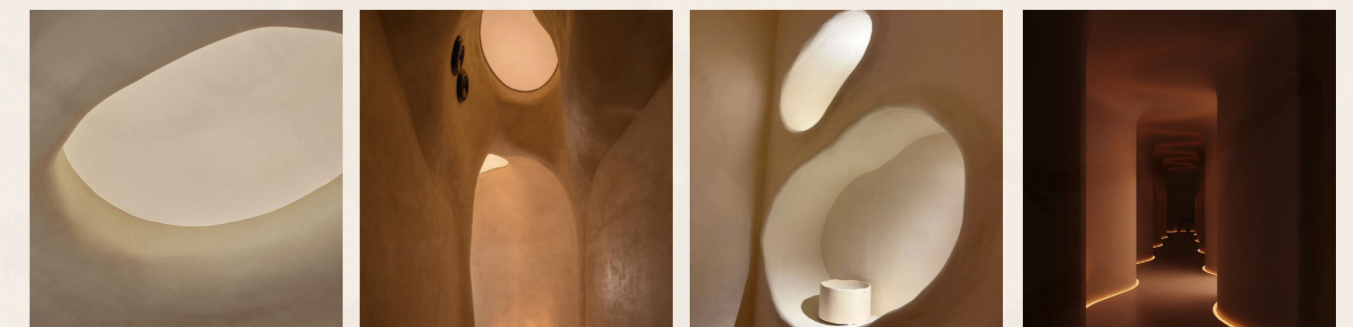

Recessed and seamlessly integrated lighting within the structure, providing soft ambient illumination.

The Journey

Translating Colony Intelligence into Spatial Experience

Guests move through interconnected chambers shaped by changing atmospheric conditions. Inspired by patterns of movement, aggregation and connectivity observed in ant colonies, the journey translates biological systems into spatial experience. Light, sound and immersive technologies evolve throughout the sequence, guiding visitors through communal and reflective environments that encourage participation, exploration and social interaction.



Stucco base plan structure



• = Entry points

— Circulation

Main dining chamber
The primary communal environment where collective dining, conversation and shared experience converge.

Kitchen chamber
Introduces visitors to future food systems and the relationship between food, ecology and community.

Bar Chamber
A transient node designed to encourage movement, encounter and spontaneous connection between moments of gathering.

START.
Cosmic Origins
Introduces visitors to the hidden systems that shape collective life.

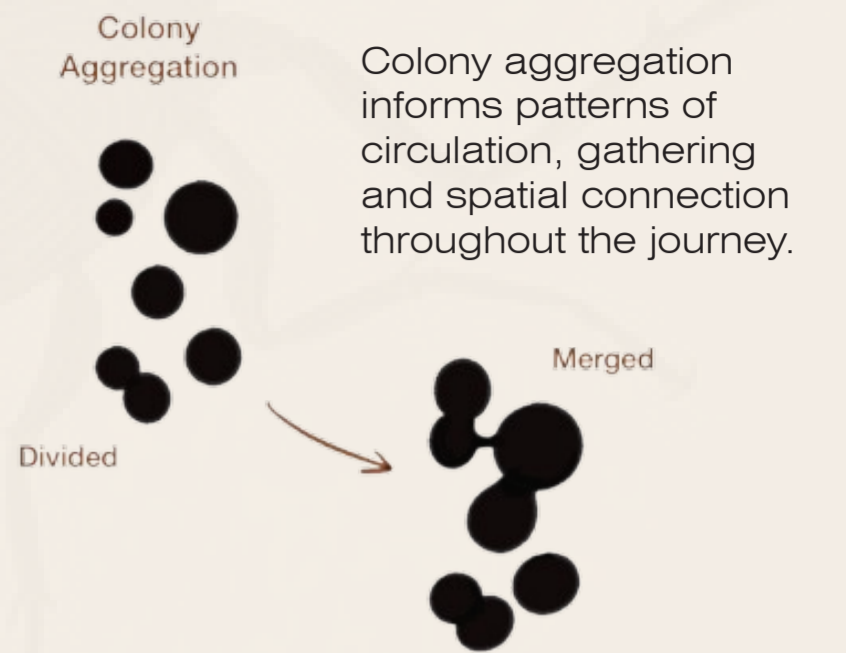

01. Thermal atmosphere
Warm lighting and dynamic atmospheres encourage energy, activity, and social interaction.

02. Reflective atmosphere
Cooler conditions encourage pause, reflection, and awareness.

03. Living atmosphere
Living systems promote growth, abundance, and ecological connection.

END.
Observation Deck
Concludes the experience with reflection on community, food systems and collective futures.



Spaces + Architecture

Translating colony aggregation into interconnected communal environments

Colony aggregation informed the formation of interconnected chambers, circulation routes and communal dining spaces. Organic forms encourage gathering while maintaining visual and spatial connections across the environment.

Base floor plan



Village Underground



Formed integrated layout

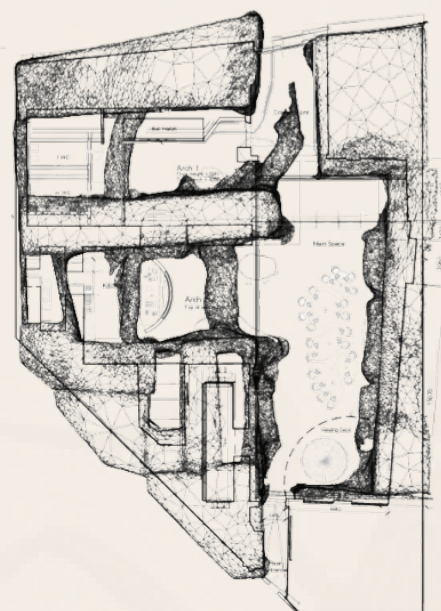

SECTION A-A | MAIN DINING CHAMBER

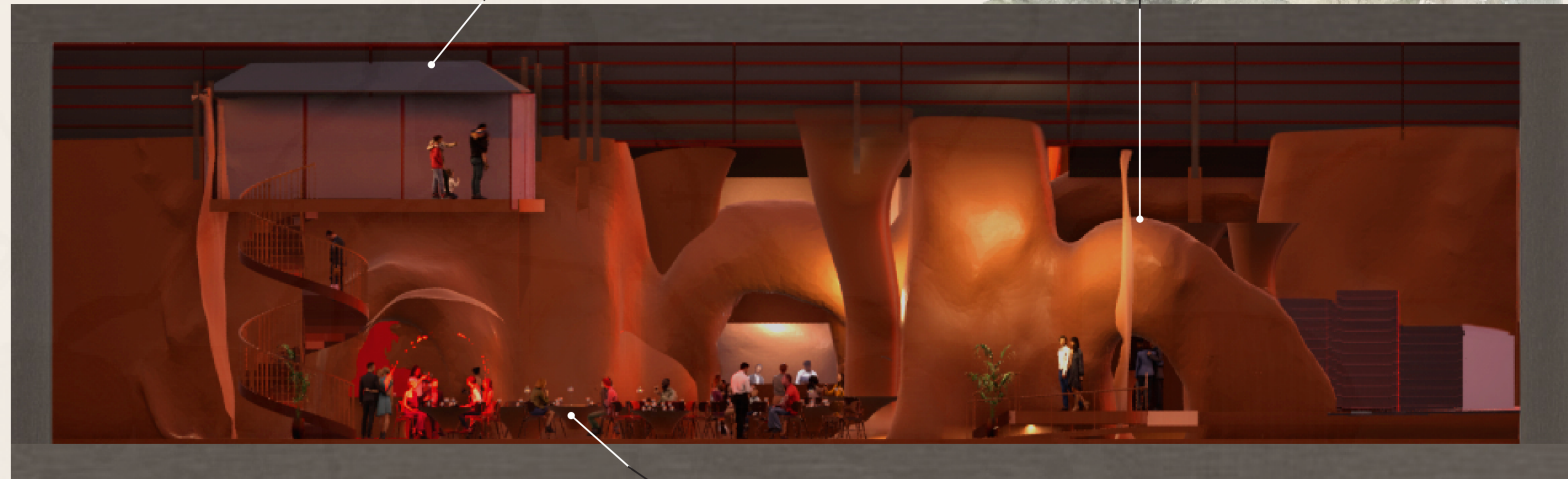

Elevated Perspective

Layered pathways and observation points inspired by colony movement and interaction.

Interconnected Chambers

Organic spaces linked through continuous circulation, encouraging exploration and discovery.

Collective Gathering

Shared dining environments that bring guests together through communal experience.

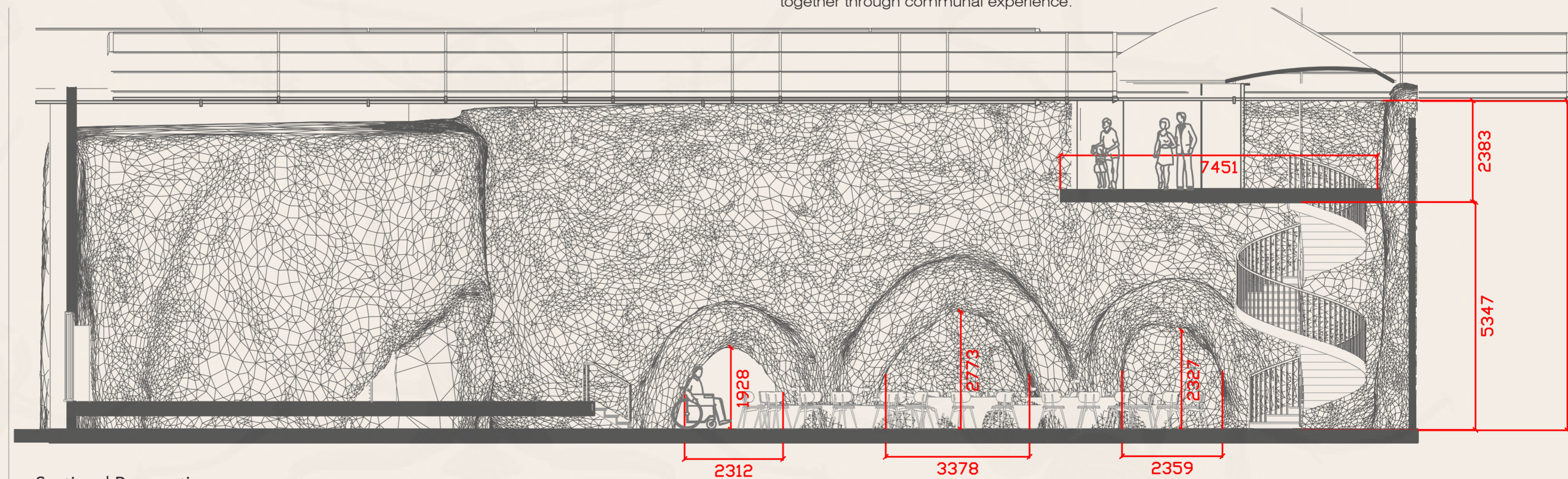

Sectional Perspective

Colony aggregation informs interconnected chambers, communal dining spaces and vertical circulation, translating collective behaviours into spatial experience.

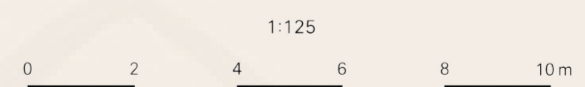

Atmosphere + Experience

An atmosphere of belonging

Through light, sound, scent, taste and touch, Wonder transforms biological observations into a multi-sensory spatial experience. Organic forms, adaptive atmospheres and communal dining environments encourage participation, reflection and social interaction, demonstrating how a physical-digital design process can generate meaningful collective experiences.

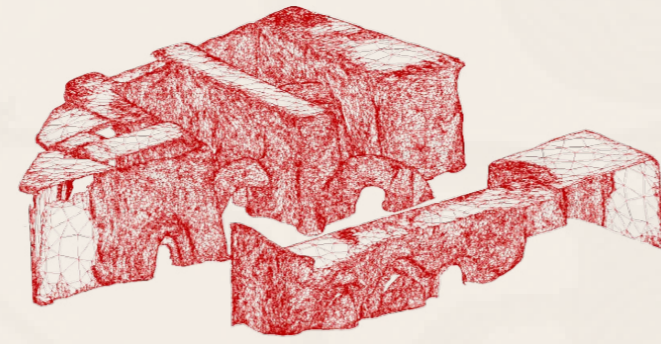

Video walkthrough of Wonder



LIGHT

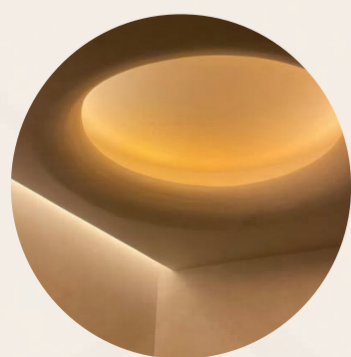

Adaptive illumination responding to atmosphere and communal gathering.



SOUND



Layered soundscapes that subtly evolve throughout the dining journey.



SCENT



Natural aromas inspired by earth, food and seasonal change.



TASTE



Shared dining experiences that encourage connection.



TOUCH



Organic textures that enhance sensory engagement.