









- 

Reception
- 

Wi-Fi & Tech
- 

Stocked Fridges
- 

Printers
- 

Meeting Rooms
- 

Sanitizing Stations
- 

Cleaning Services
- 

Outdoor Spaces
- 

Break-out Spaces
- 

Wellness Pods
- 

Bar & Restaurant
- 

Events Spaces

THE CONCRETE JUNGLE

ELLIE TURNER

PROJECT PROPOSAL

Paradise Circus car park, a structure set for demolition in the centre of Birmingham, has been re-imagined as a mixed-use co-working facility. In a location that benefits from local transport networks and UK wide rail links the facility provides space for locals, short-stay visitors and overnight guests to utilise as they visit the city.

Collaborative and independent work spaces provide visitors with the opportunity to meet, work as a group or individual using a flexible rental system. Rooftop overnight residences, external break out space and bar allow guests to unwind or have more informal discussions as part of their visit. The floors below house co-working, social and rejuvenation areas that incorporate planting and natural lighting to promote health and well-being. The ground floor offers flexible exhibition space, an auditorium and restaurant which is surrounded by a double height planted buffer zone that separates the interior from the city beyond.

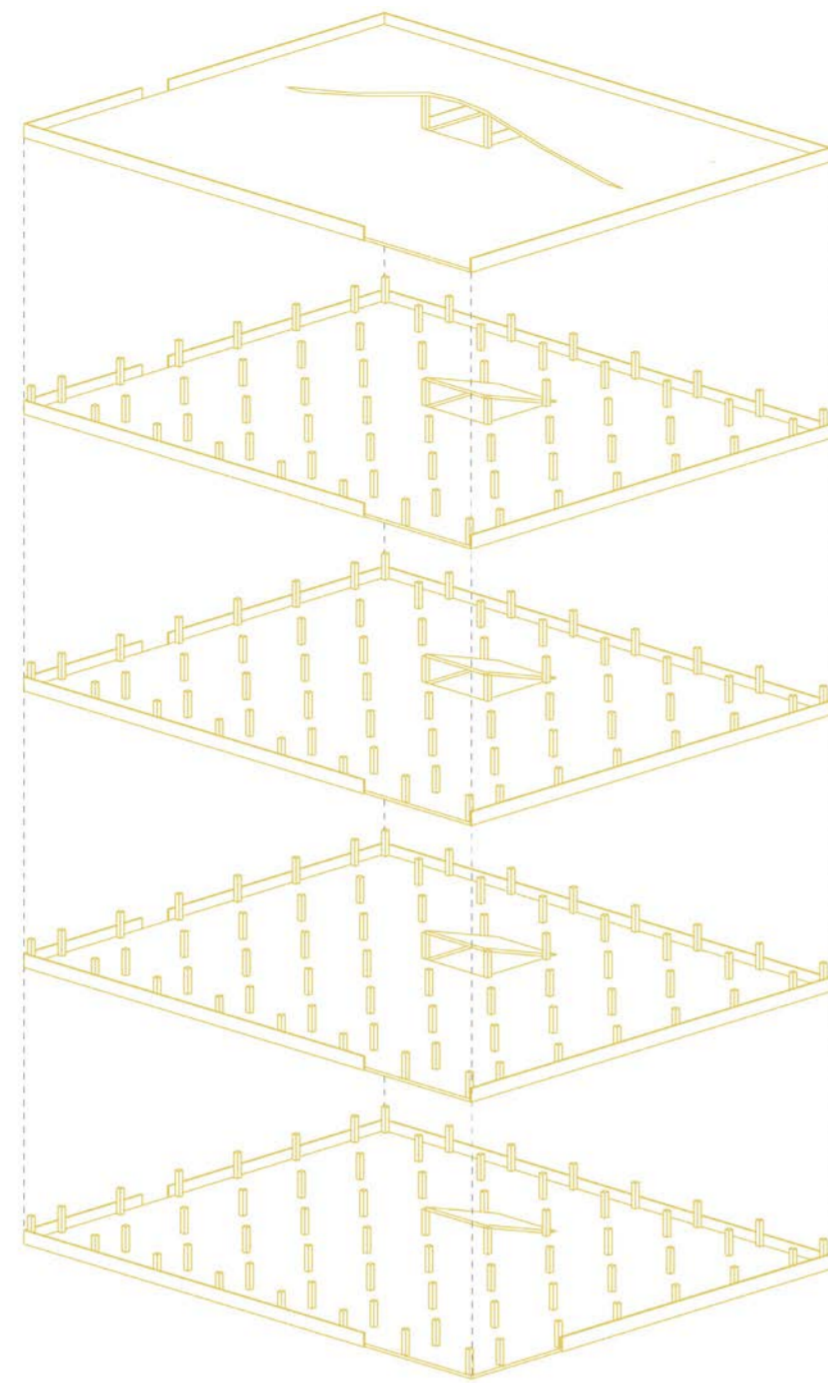

PRIMARY STRUCTURE OF EXISTING BUILDING

The original building has five floors of car parking with ramped vehicular access between floors and two escape stairs. Slabs, columns, beams, staircases, ramps and an inclined area of rooftop parking are made of reinforced concrete.

WAYFINDING



1. Pinpoint Location.



2. Locate Available Pods.



3. Sign In Via QR Code.

SPATIAL EXPLORATION. INTERIOR



SPATIAL EXPLORATION. EXTERIOR



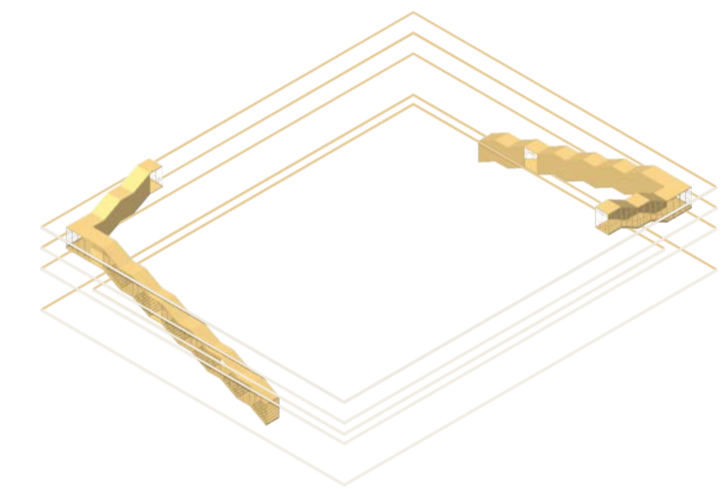
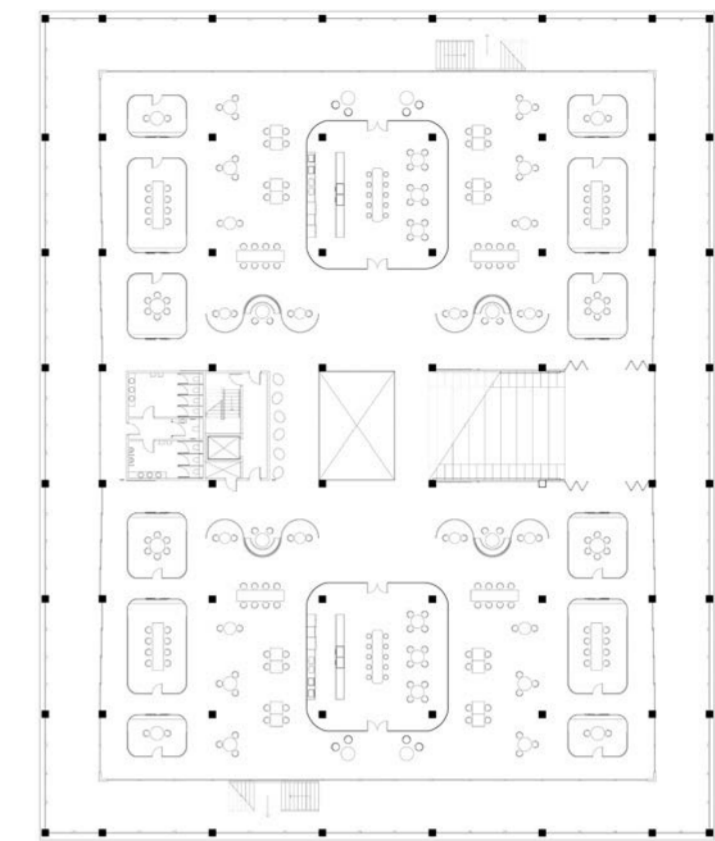

CIRCULATION

The facility includes a number of different types of circulation routes including lifts, bleacher stairs, fire exits and cascading external stairs. These provide a variety of means of vertical movement and enable occupants to move around the facility efficiently and with minimal obstruction.

Circulation stairs wrap around either side of the building's façade, puncturing through the existing floor plates. The staircase structures provide designated exit points at each floor level, that pour out onto exterior biophilic balconies.

The staircase structures blur the boundary between inside and outside, integrate multiple floors and encourage movement around the edges of the building.

FLOOR 00. AUDITORIUM



FLOOR 00. BAR & RESTAURANT



FLOOR 00 & 02. MEETING PODS



FLOOR 04.
SHORT STAY ACCOMMODATION



FLOOR 03.
WELLNESS FLOOR



FLOOR 02.
CO-WORKING FLOOR



FLOOR 01.
CO-WORKING FLOOR



FLOOR 00.
MIXED-USE FLOOR



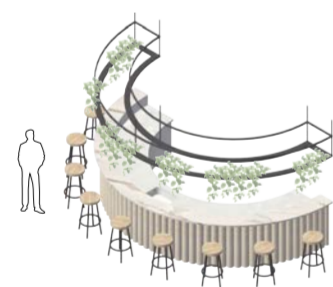

BAR / RESTAURANT

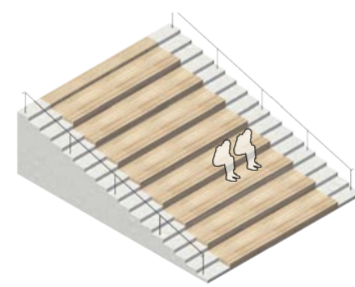

AUDITORIUM

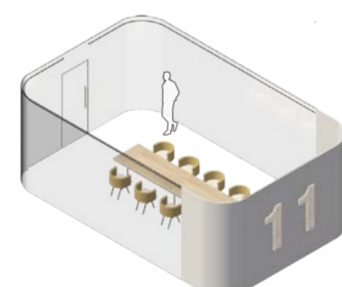

MEETING PODS



FOCUSED WORKING

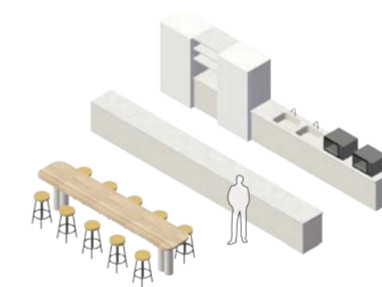

SHARED KITCHEN

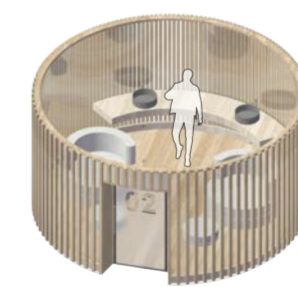

WELLNESS POD

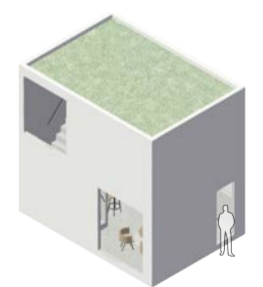

ACCOMMODATION

SECTION

The Concrete Jungle seeks to provide a hybrid facility of collaborative and private immersive spaces that promote user health and wellbeing through design and planting. Wellness focused amenities offer relief from the pressure of work and consider users physical and mental health. Green spaces offer employees an opportunity to disconnect from work, promoting casual interaction and improving cognitive behaviour which in turn will boost the economy.