

PIROUETTE

PIROUETTE IS A BESPOKE DANCE-WEAR RETAIL STORE THAT SELLS GARMENTS AND SHOES AND ALLOWS FITTINGS AND DRESSING ROOMS WITHIN A LONG NARROW WOOLWICH SHOP FOOTPRINT. POWIS STREET IS A DYING HIGH STREET THAT NEEDS TO BE REINVIGORATED WITH SPECIALIST SHOPS TO COMPETE WITH THE GENERIC GENTRIFICATION OF ROYAL ARSENAL AND NEIGHBOURING DEVELOPMENTS THAT ARE HOMOGENISING THE LOCAL AREA.

PART OF MY AIM WAS TO CROSS-DISCIPLINES BETWEEN CHOREOGRAPHY, RETAIL AND DANCING. I LIKE SURREALIST AESTHETICS AND THE USE OF CURVES WITHIN THE SPACE THAT INDICATE A FLOW OF FORM AND ACTION.

I WAS INFLUENCED AND INSPIRED BY UNDULATING CURVES CREATED BY MY OWN SKETCHES, MY OWN DOCUMENTATION OF DANCING FROM MY PAST AND ALSO FROM THE CURRENT PRACTICE OF BALLET AND CONTEMPORARY DANCING. THE MOVEMENTS ALLOW FOR A FORM TO BE TRACED, IMAGINING THE FLOW AS A LINE AND THE MOVEMENT OF A USER IN THE SPACE AS A TWIRL, SWIRL OR CURVE.

I WANTED MY RESULT TO PRESENT AN INTERIOR-INSTALLATION THAT HAS RIBBONS MADE OF FABRIC AND MATERIAL TWISTING AND TURNING WITHIN THE SPACE THAT BECOME DIFFERENT TYPES OF ACCOMMODATION AND FUNCTION THROUGHOUT THE SAME CONTINUOUS FORM.



Pirouette
66 Powis Street

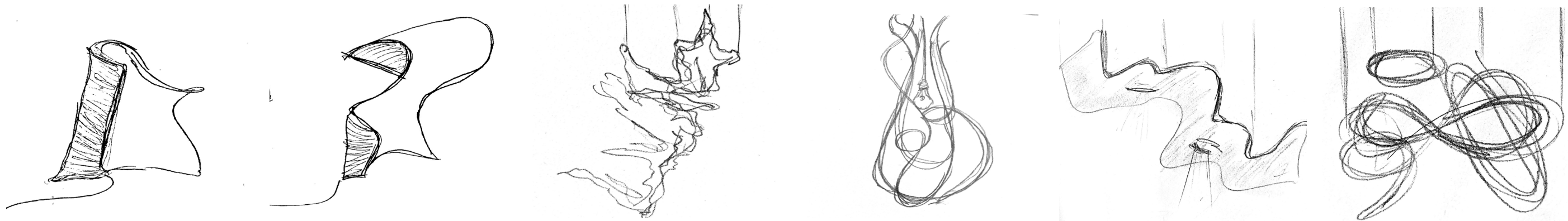
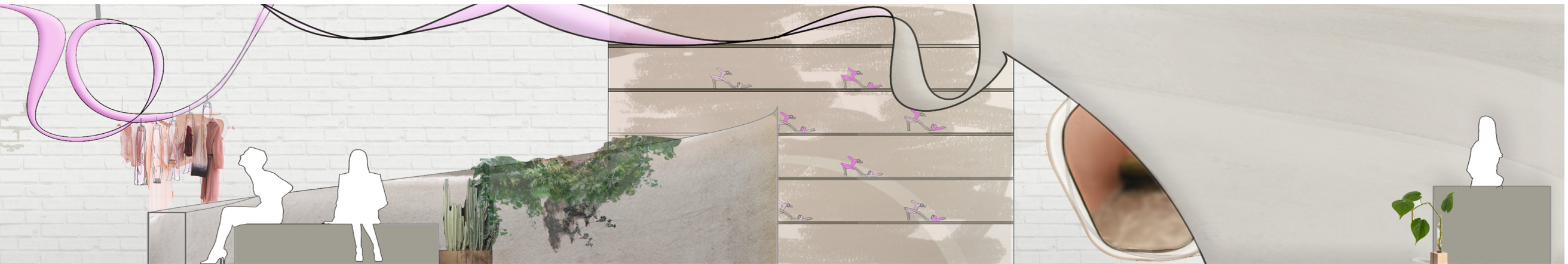
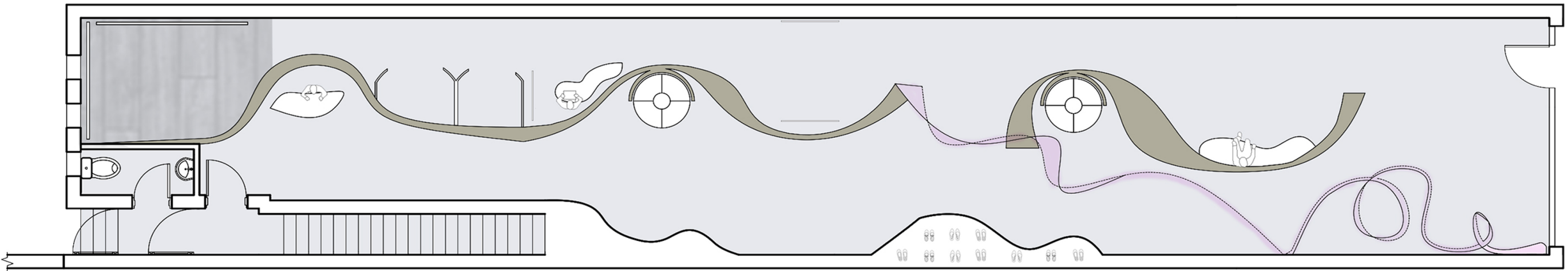

DESIGN DEVELOPMENT

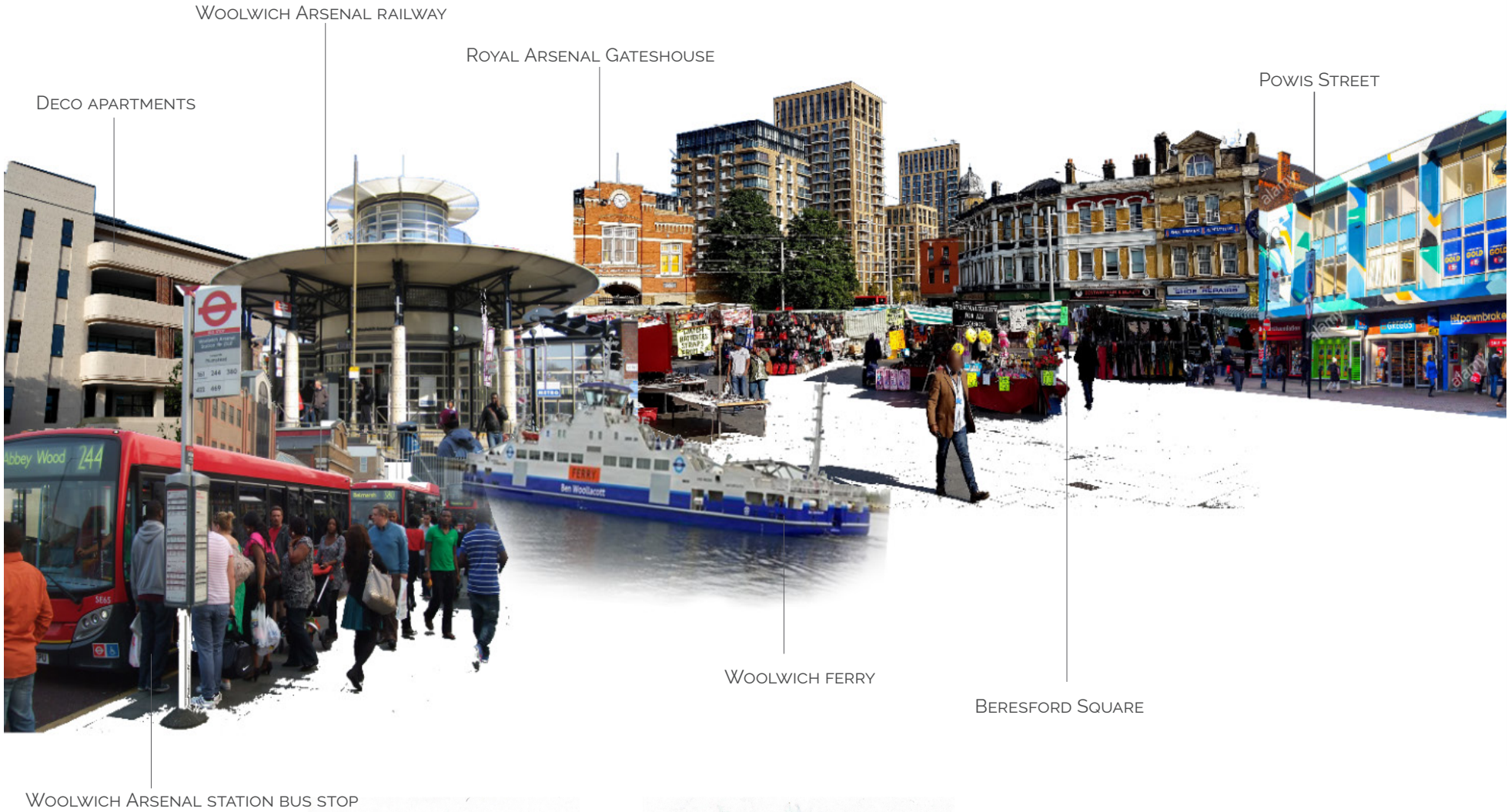

SKETCH OF SHOPS ON POWIS ST

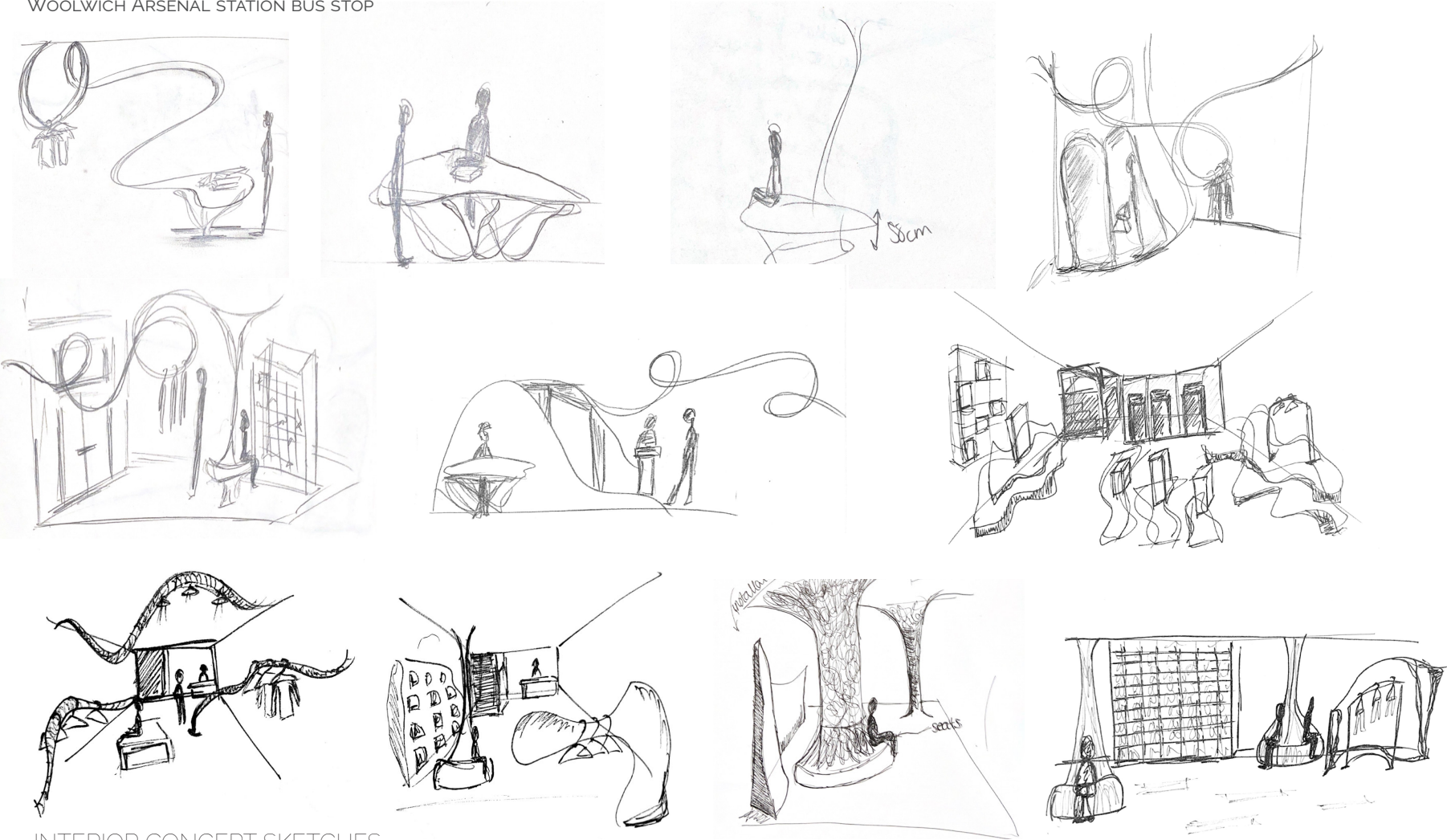

INTERIOR CONCEPT SKETCHES

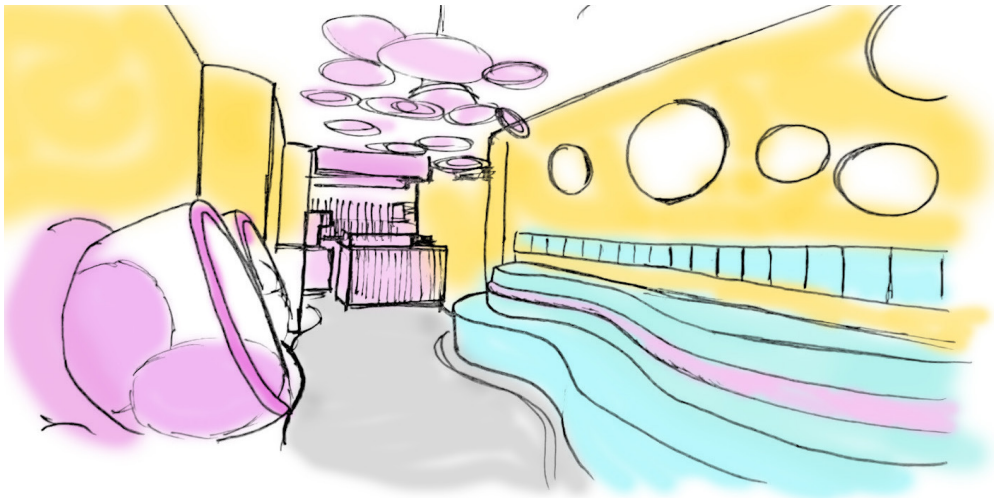
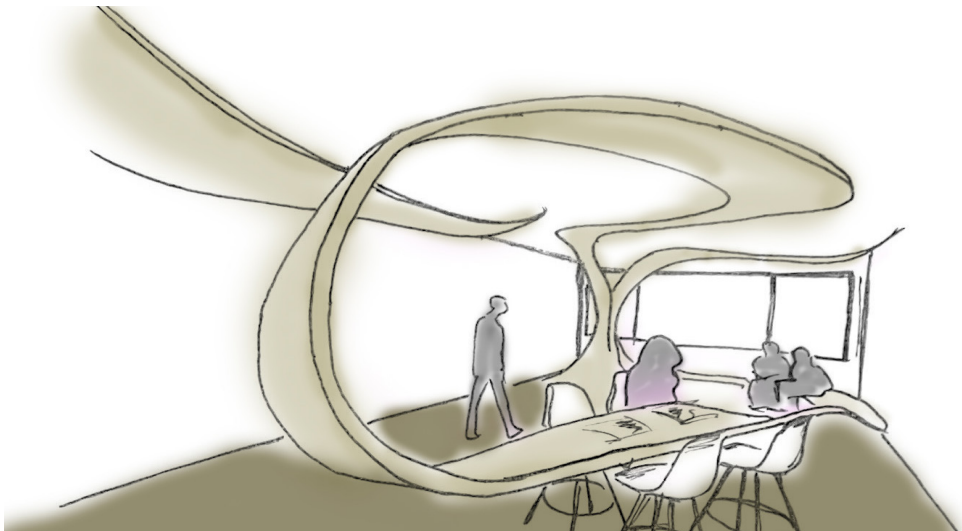

DRAWINGS OF PRECEDENT SHOPS



SKETCH OF POWIS ST

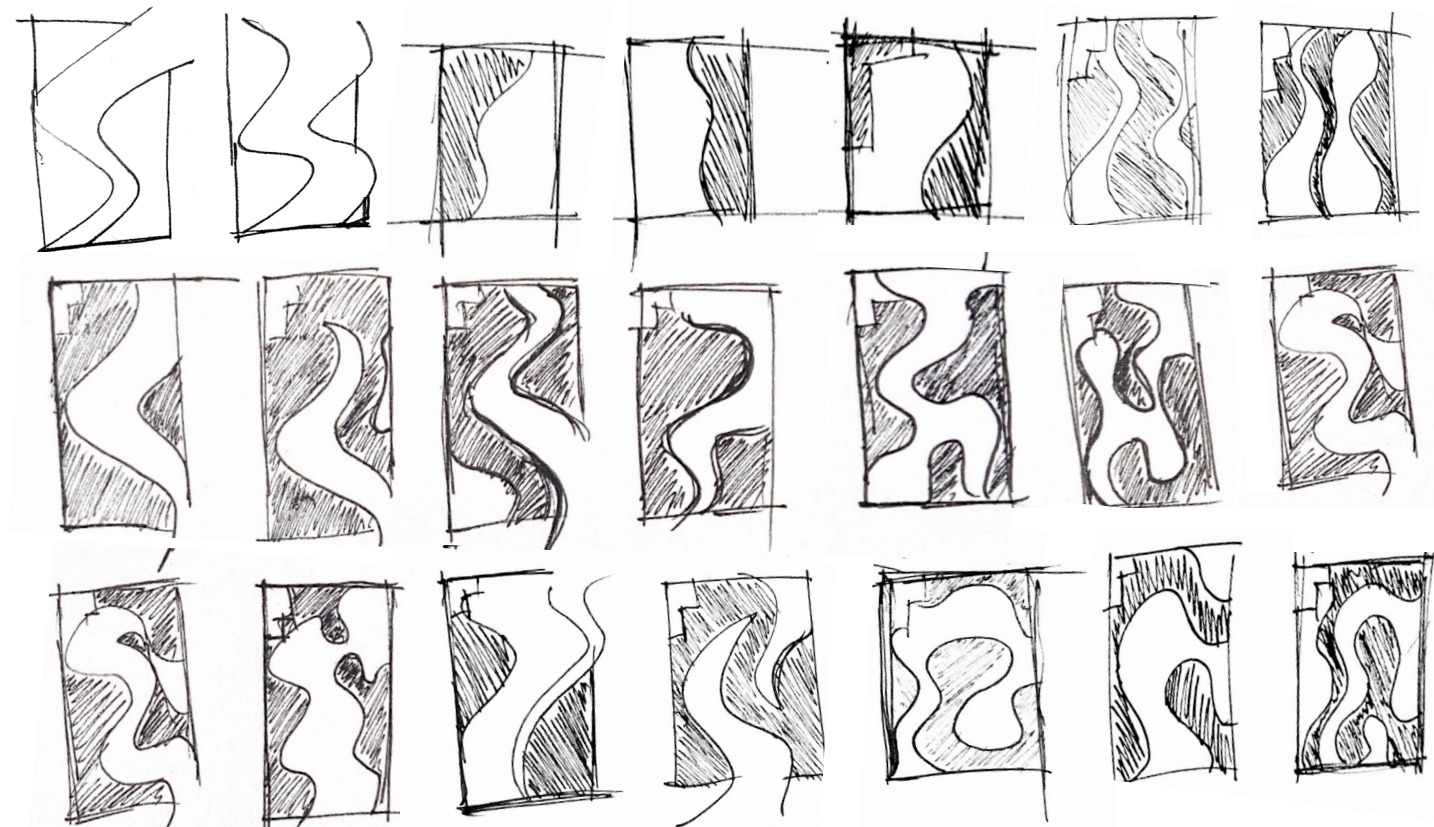

FLOOR PLAN CONCEPT SKETCHES

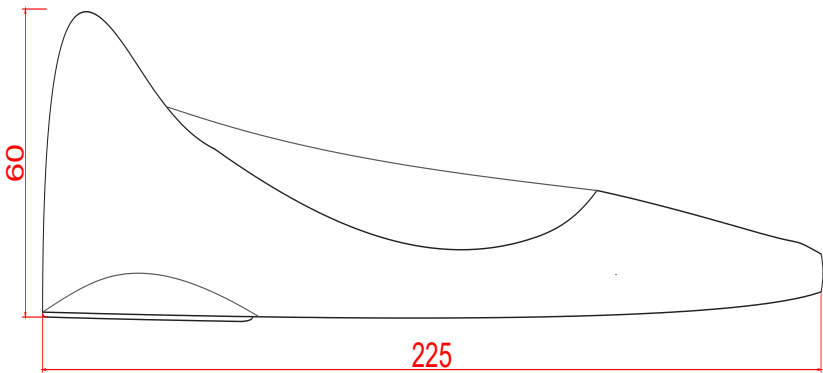
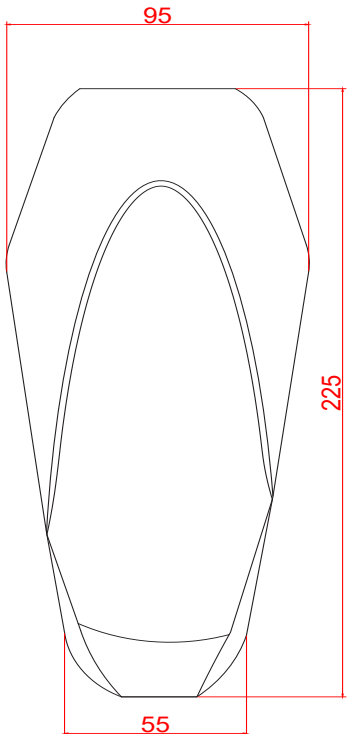

PLAN AND SECTION OF A BALLET SHOE
NOT TO SCALE

TECHNICAL DRAWINGS 01

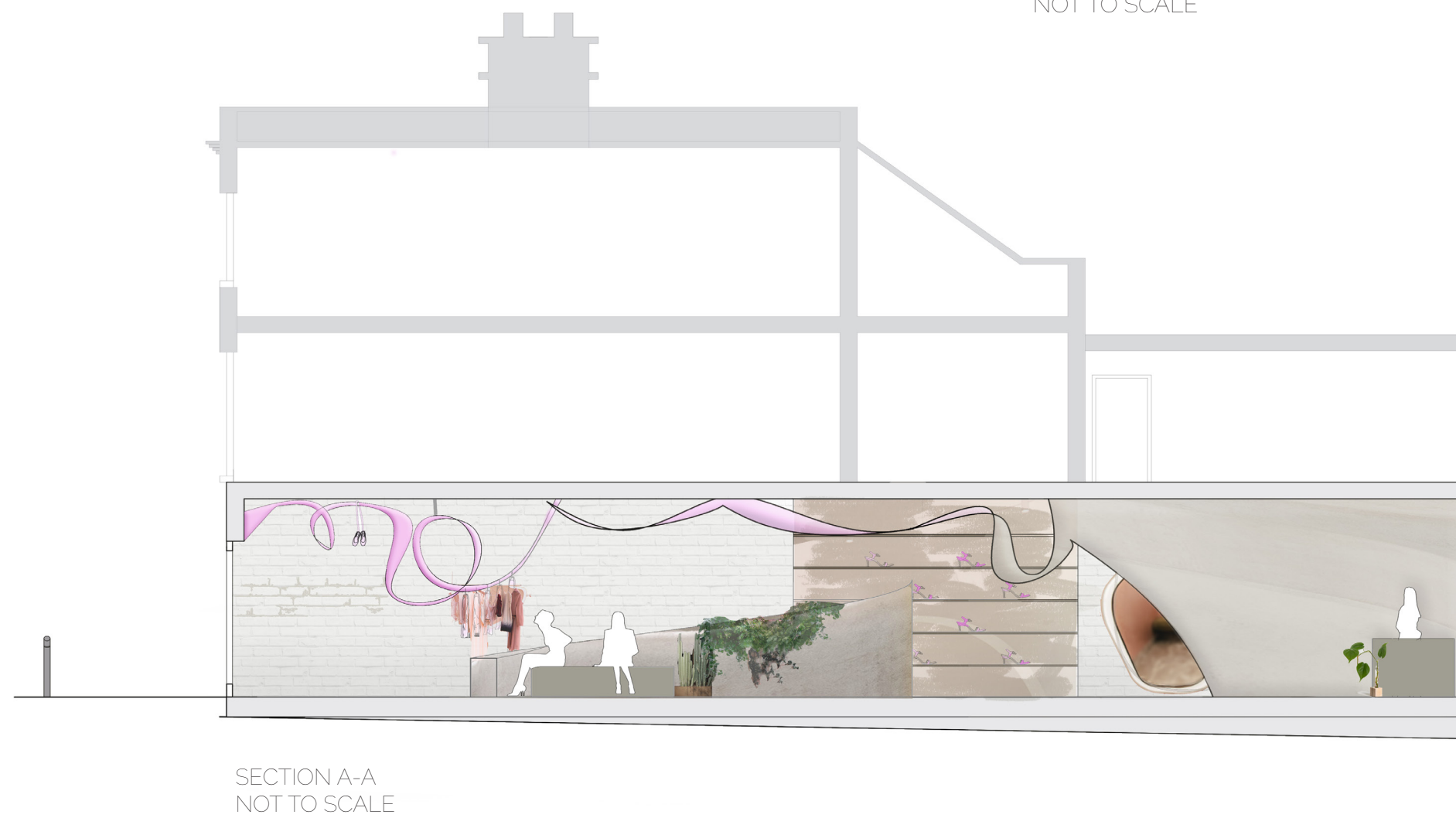
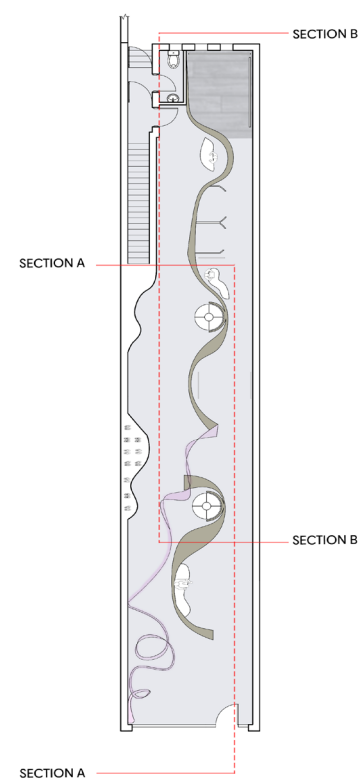
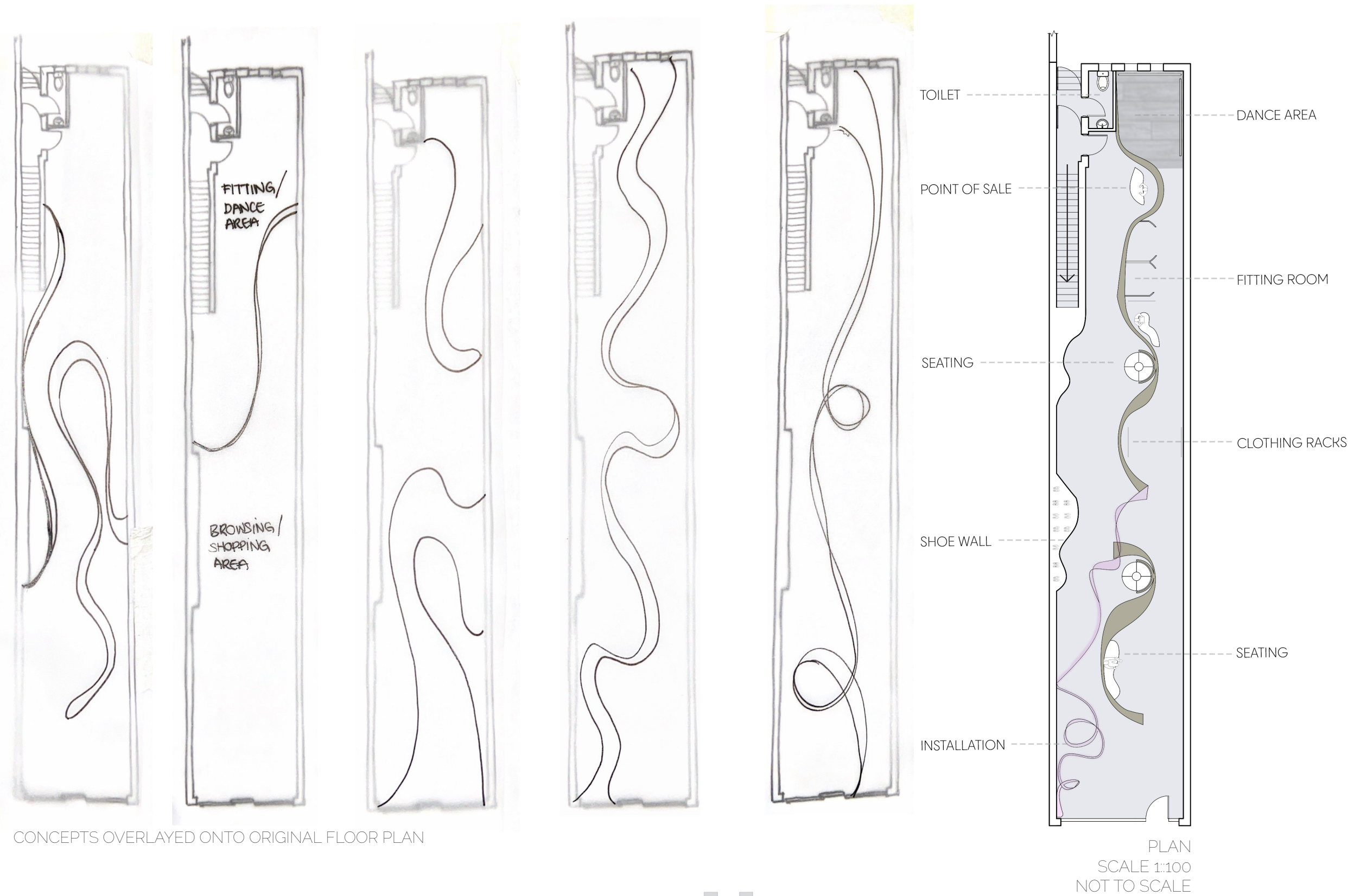

TECHNICAL DRAWINGS 02

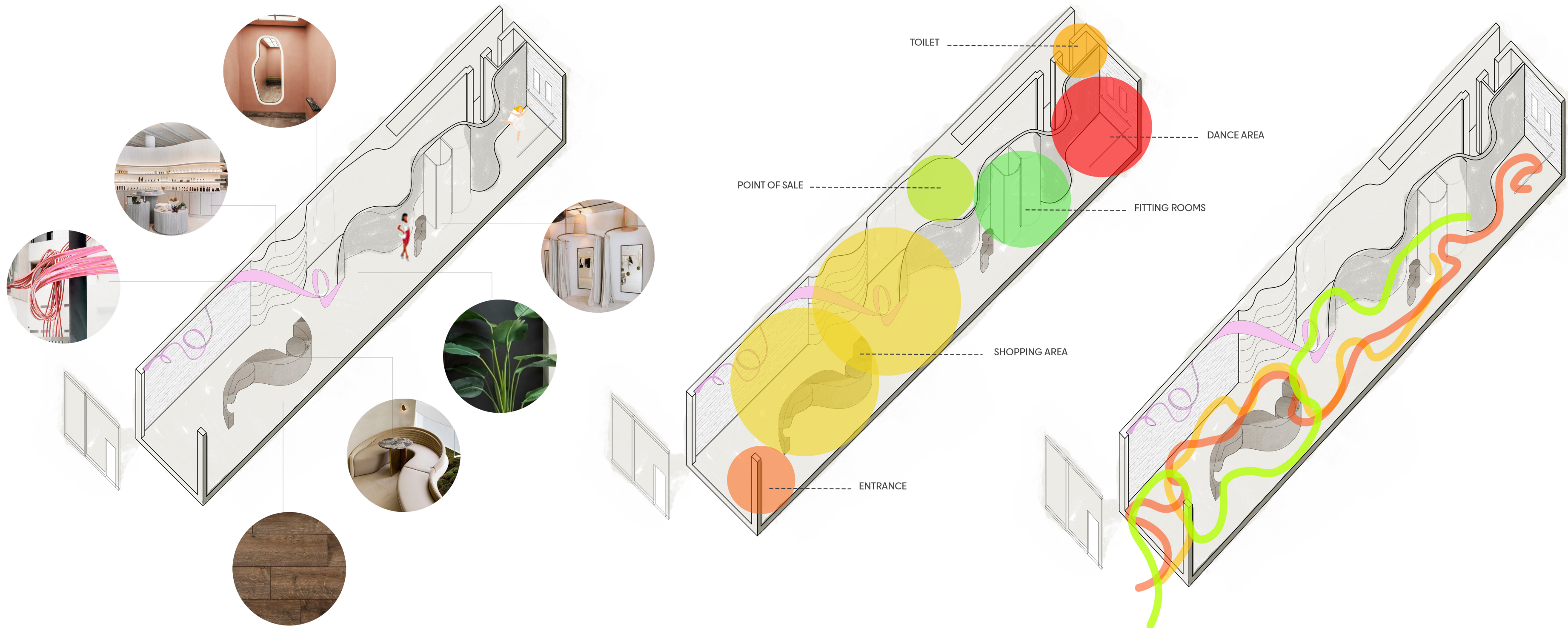

AXONOMETRIC DRAWINGS DISPLAYING MATERIALS, ZONES AND CIRCULATION

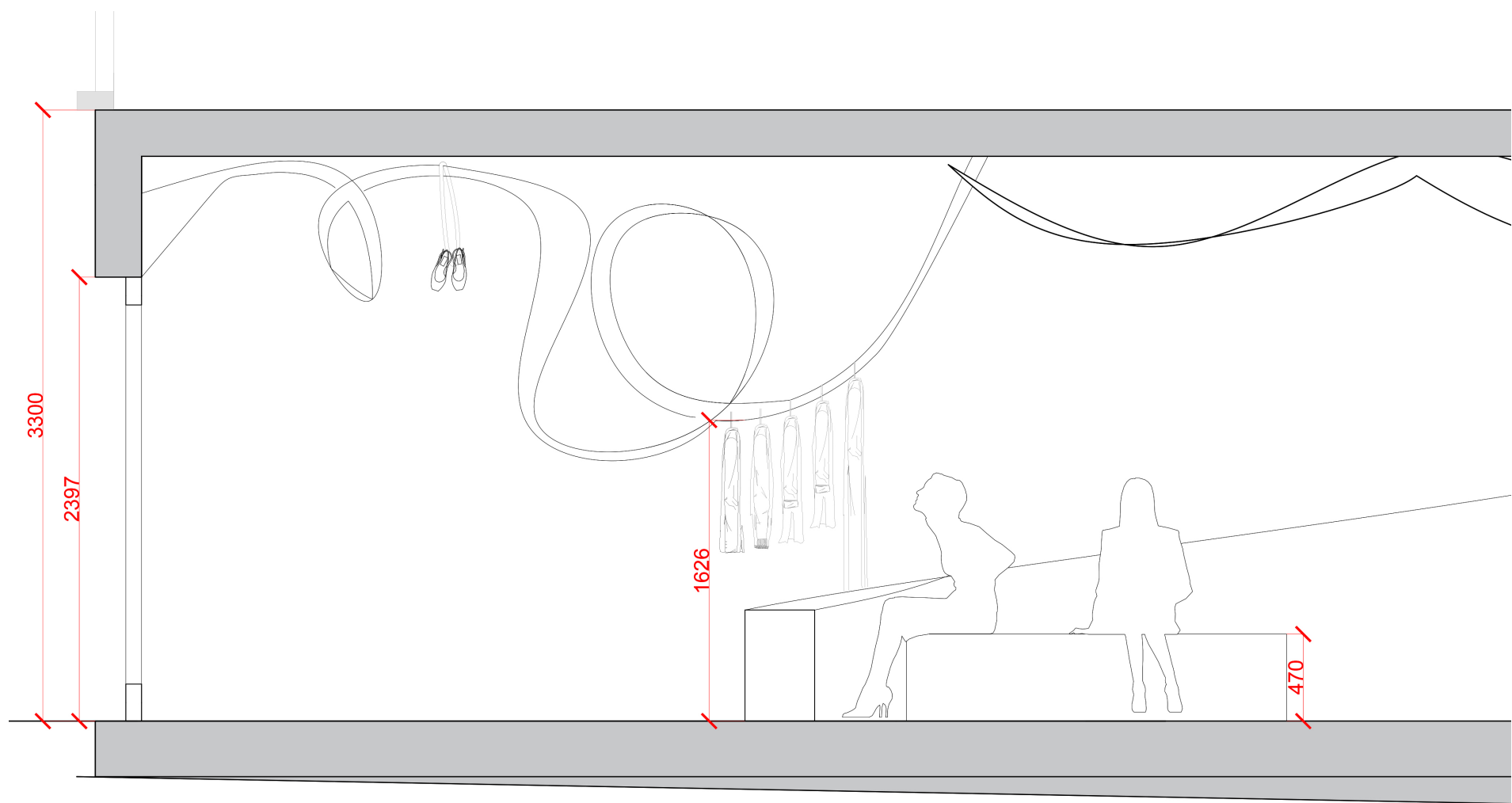

SECTION A-A
NOT TO SCALE



ELEVATION
NOT TO SCALE

LAMP DESIGN

TO CONSTRUCT MY LAMP, I PURCHASED A 600X400MM FROSTED ACRYLIC SHEET AND BENT THE PANEL INTO A CURVY, FLUID SHAPE USING A HEAT GUN. THEN, USING ELECTRICAL TAPE, I ATTACHED A LED STRIP TO THE SIDES OF THE SHEET AND MASKED IT BY COVERING IT OVER WITH THIN COPPER SHEET MATERIAL.

I WANTED TO CREATE A LIGHT, MALLEABLE SHAPE TO EXPRESS DANCE, FLUIDITY AND MOVEMENT. THIS ALIGNED WITH THE CONCEPT OF MY 'PIROUETTE' DANCEWEAR SHOP.

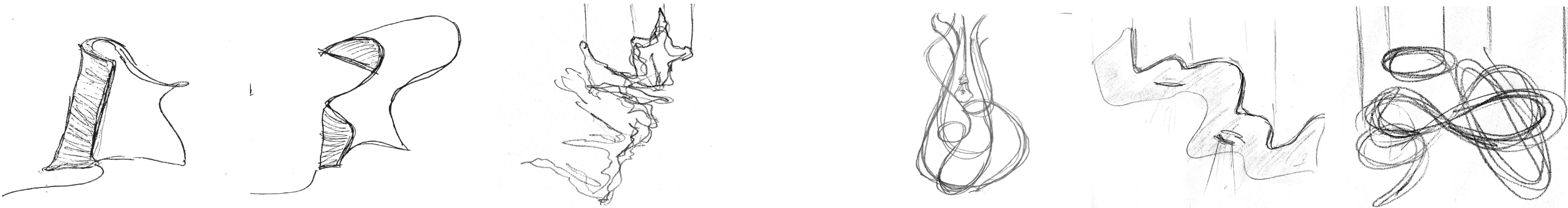

LAMP CONCEPT SKETCHES

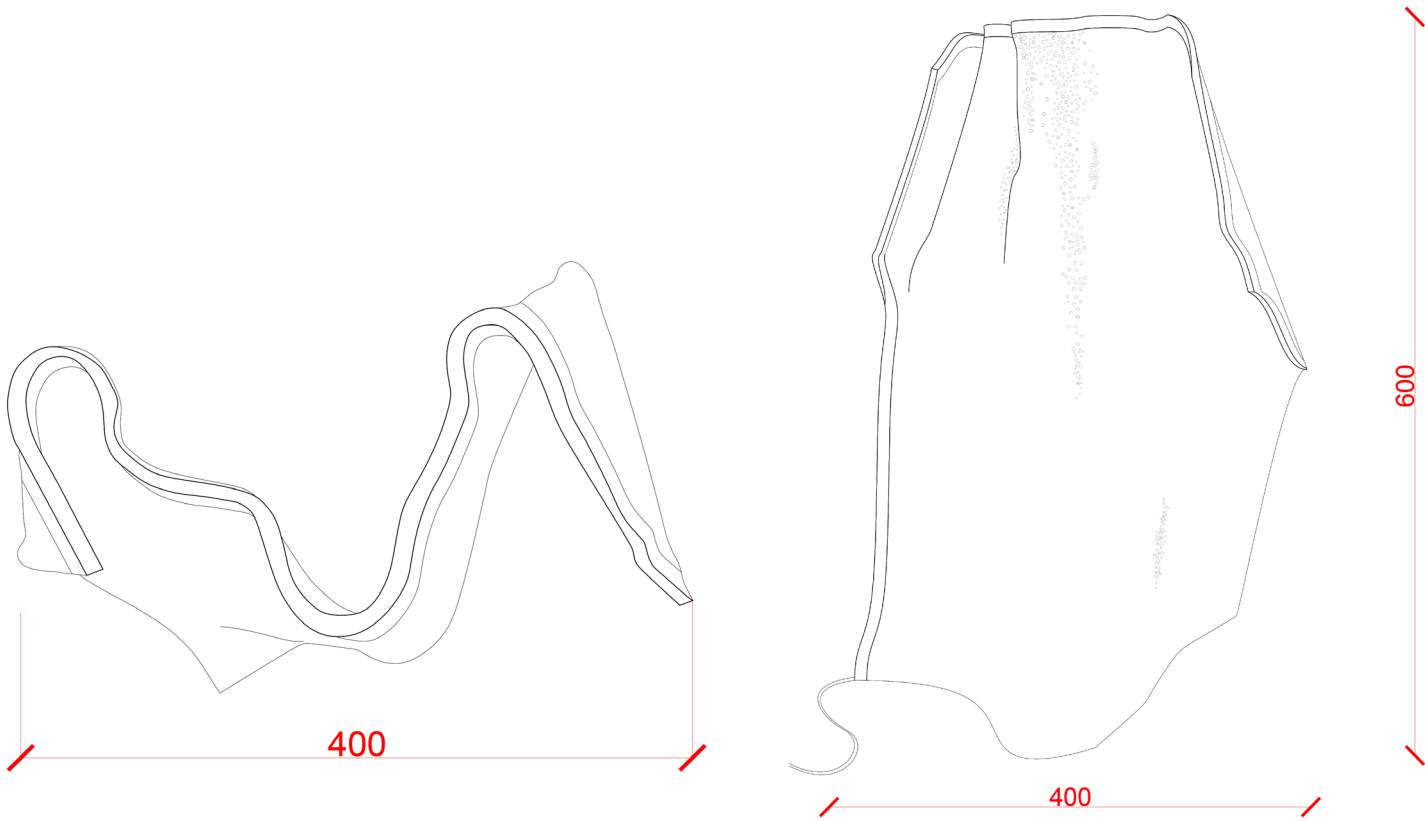

PLAN AND SECTION
NOT TO SCALE

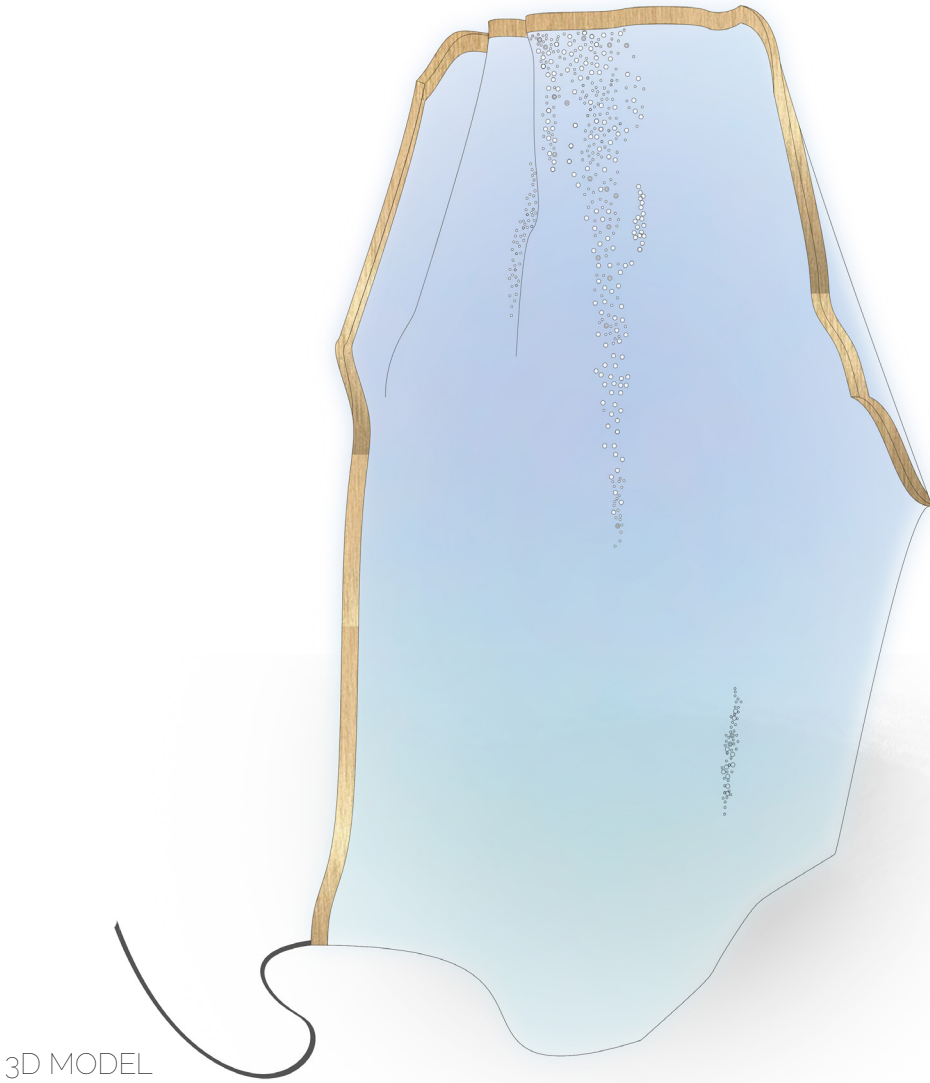

3D MODEL

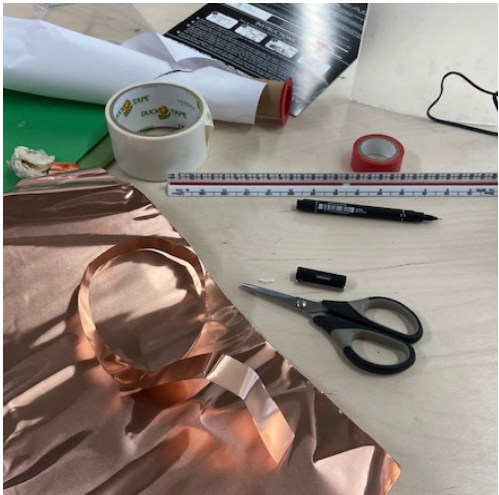

CONSTRUCTION PROCESS



FINAL PROTOTYPE

