

Diner & A Show

The Tramshed by Sara Trevain

The focus of this project was to challenge me as a designer to re-design a community theatre, which is situated in the heart of Woolwich in London.

The Tramshed is a listed building set in historical Woolwich town and was originally a generating station that provided power for the local Tram system between 1916 and 1953. It has had a variety of uses since then but has primarily been a place of entertainment and social gatherings.

The brief encouraged me to create a multi-functional space to allow diversity and to bring together the community. By designing a space that could adapt to host a variety of social gatherings from but not limited to, theatre productions, musical performances, art exhibitions along with a restaurant and bar area. The design process challenged me to develop my design through various design developments as well including building a physical model. To add to the making of this project, I designed a lamp and screen to feature in the multi-functional space.



PHYSICAL MODEL RENDERED IN PHOTOSHOP,
FEATURING SCREEN & LAMP PROTOTYPES

THE SCREEN
‘I’m Still Standing’

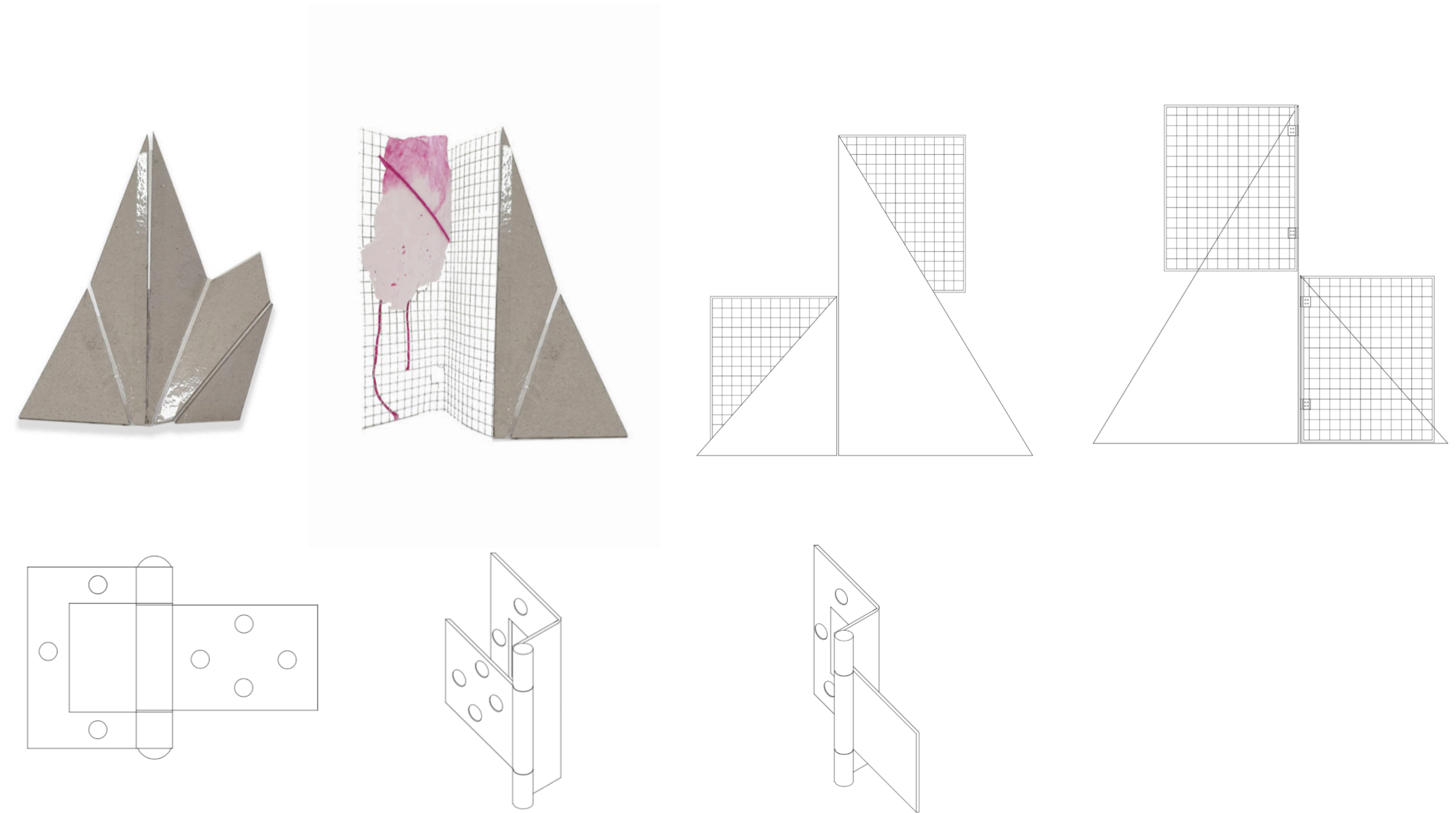
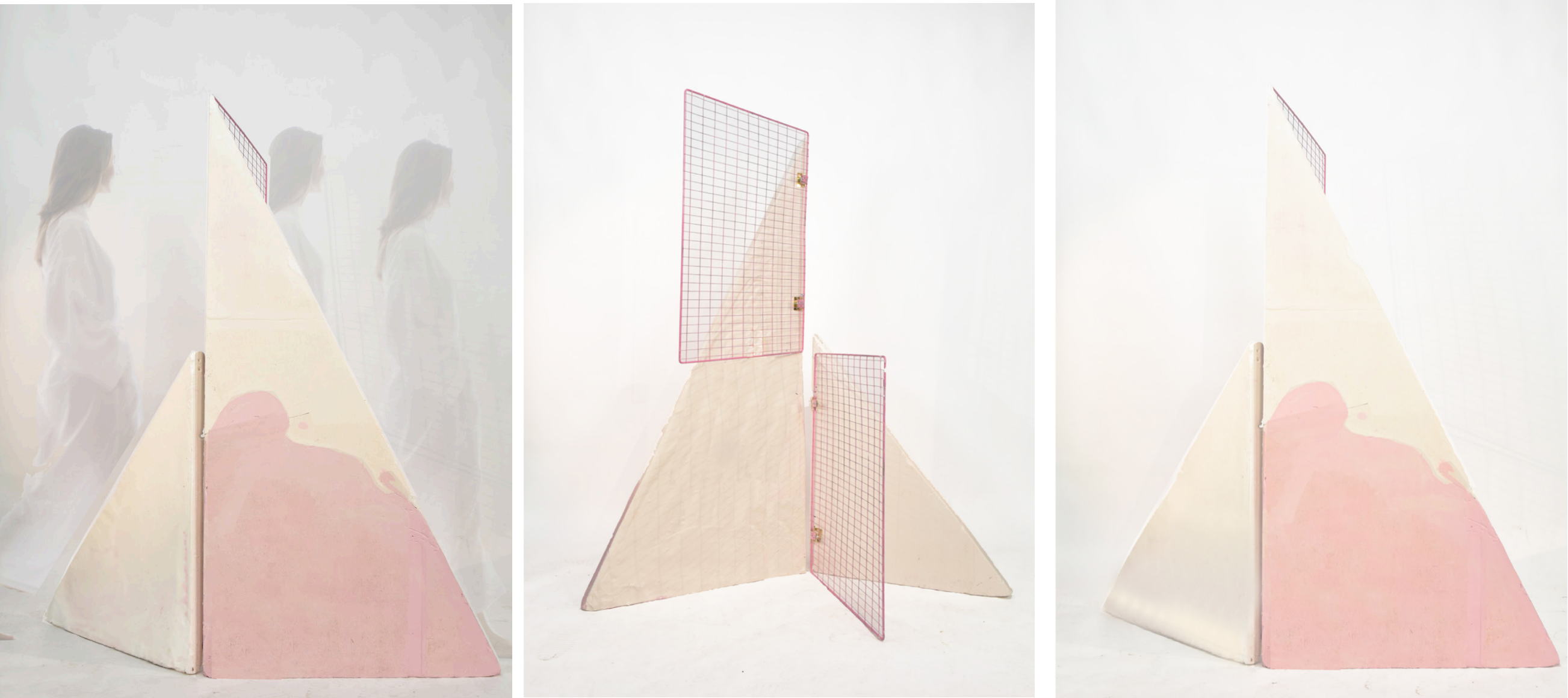

The Screen was designed and made using plaster and upcycled materials, such as, a copper fire guard, metal safety plates, left over pink paint, and discarded wood that i used to create my mould to cast the screen. The screen was a challenge as was created through the second lockdown and the entire process was produced in a home garage.

THE LAMP

'Treading on Eggshells'

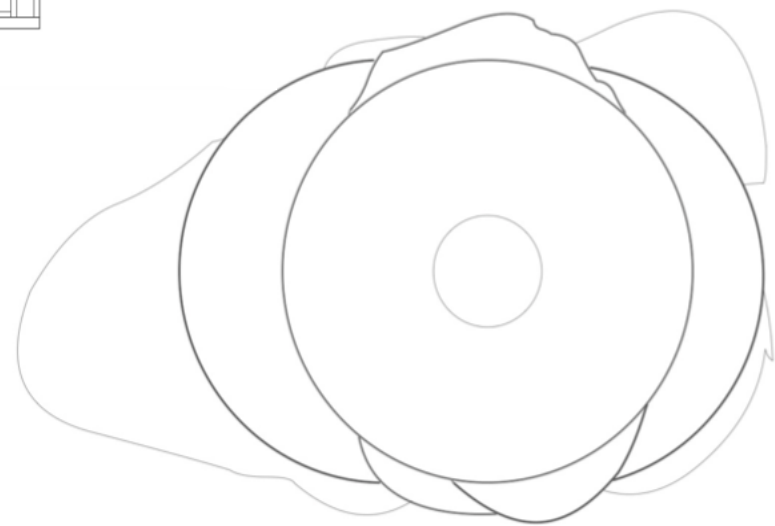
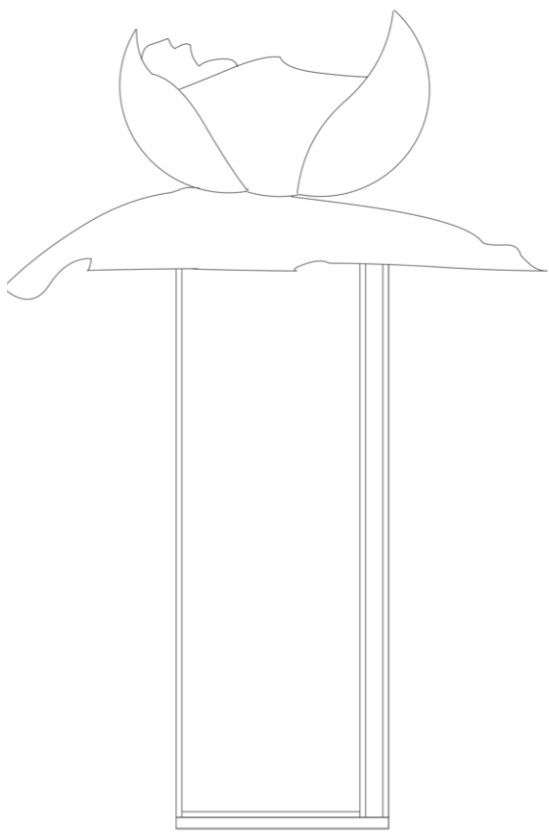

The Lamp was designed and made using plaster and pink paint with hessian rags soaked in plaster to hold the delicate casts together. The stand is made from black steel. The concept of the design which reflects in the title 'Walking on Eggshells' represents a humans reaction to a delicate situation that many of us feel throughout our lives.

DESIGN DEVELOPMENT



BUBBLE DIAGRAM

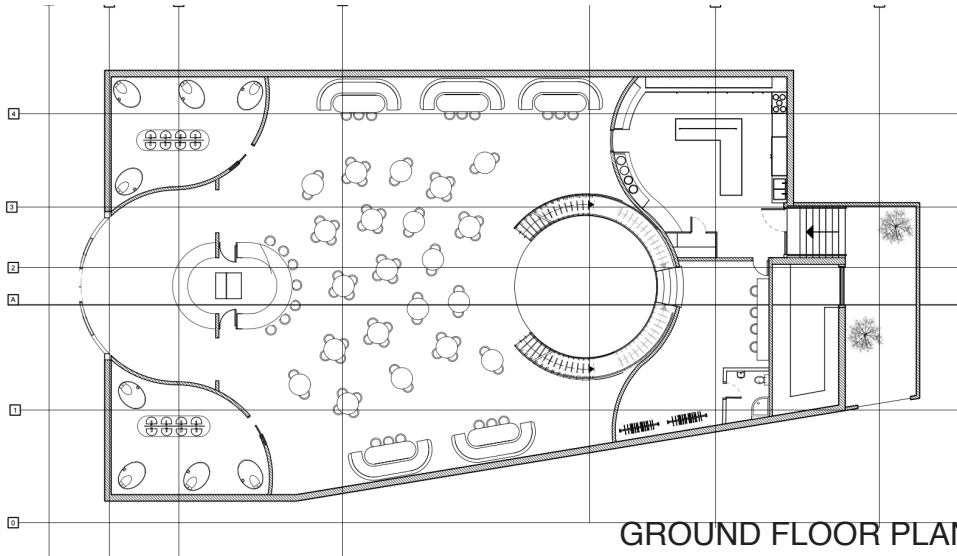

GROUND FLOOR PLAN

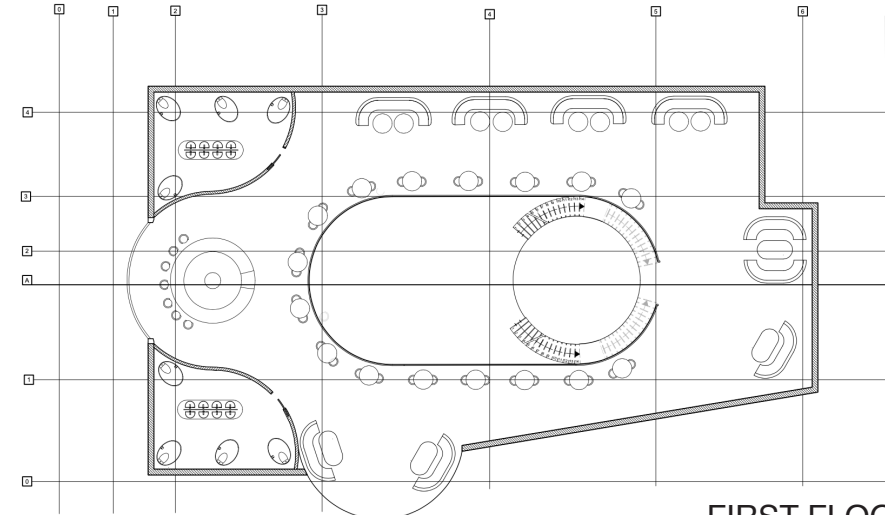

FIRST FLOOR PLAN

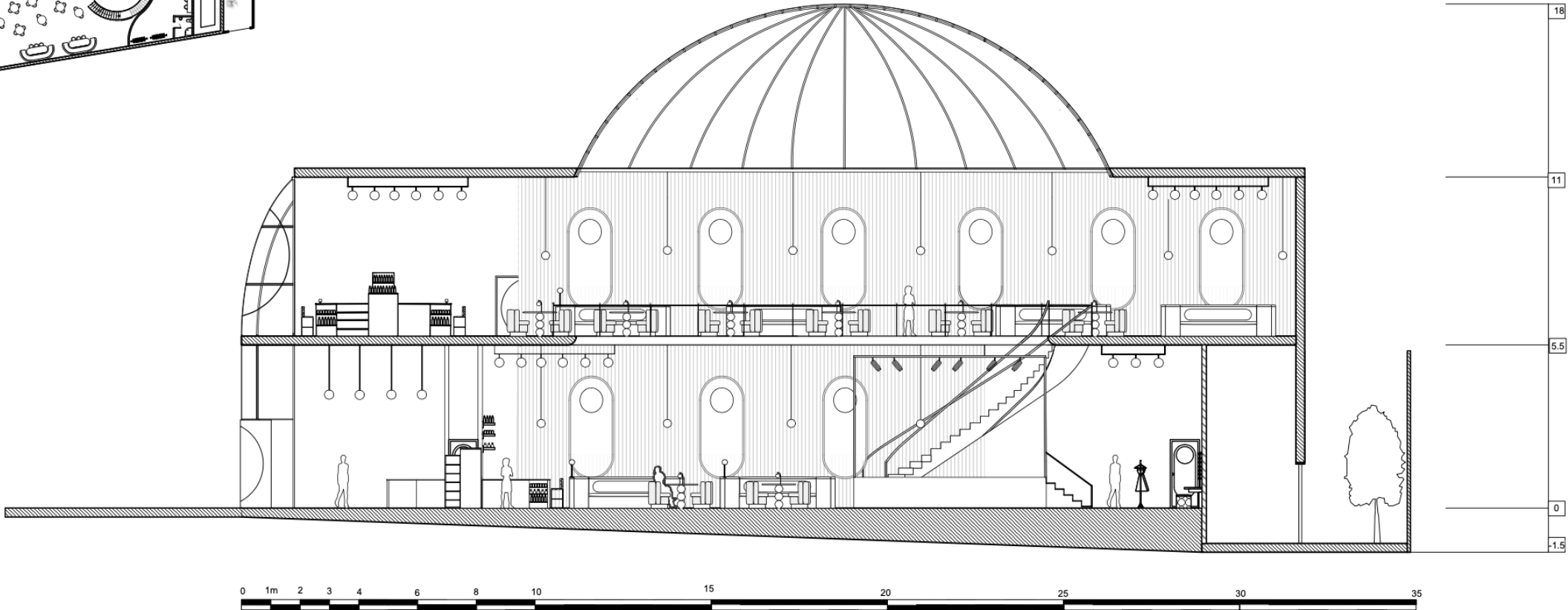
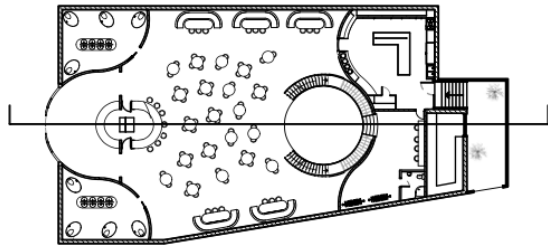

LONG SECTION



CONCEPT COLLAGE

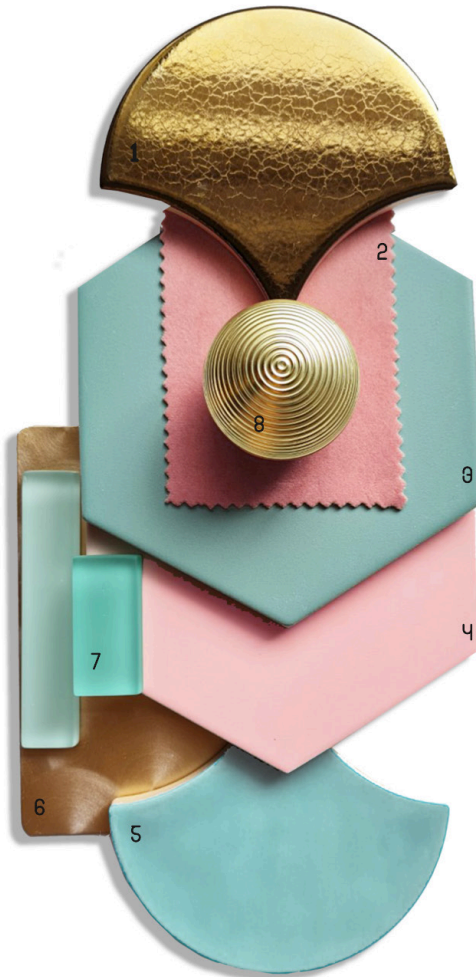

MATERIAL PALETTE

1- Drop gold tile 2-Pink Velve 3-Jade Hexagon Tile 4-Glush Hexagon Tile 5-Porcelain Corsica Pan Tile 6-Glass 7-Byzantine Emerald tile

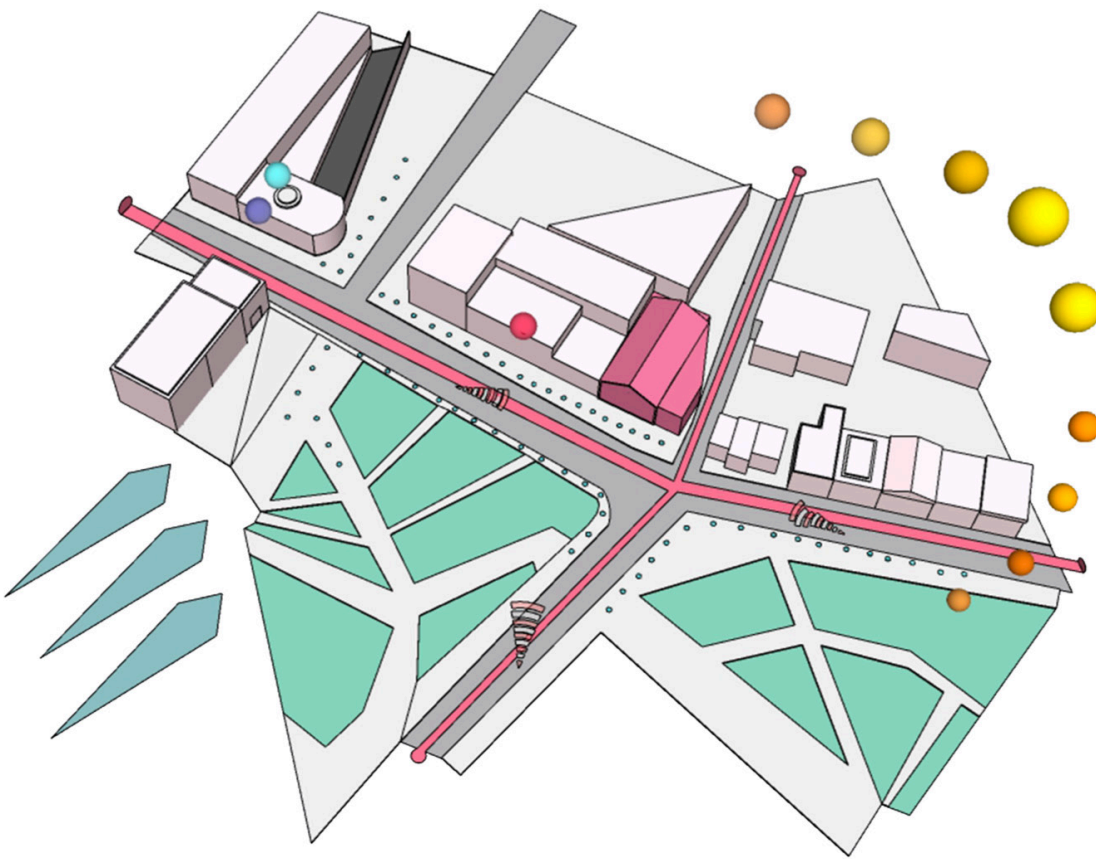
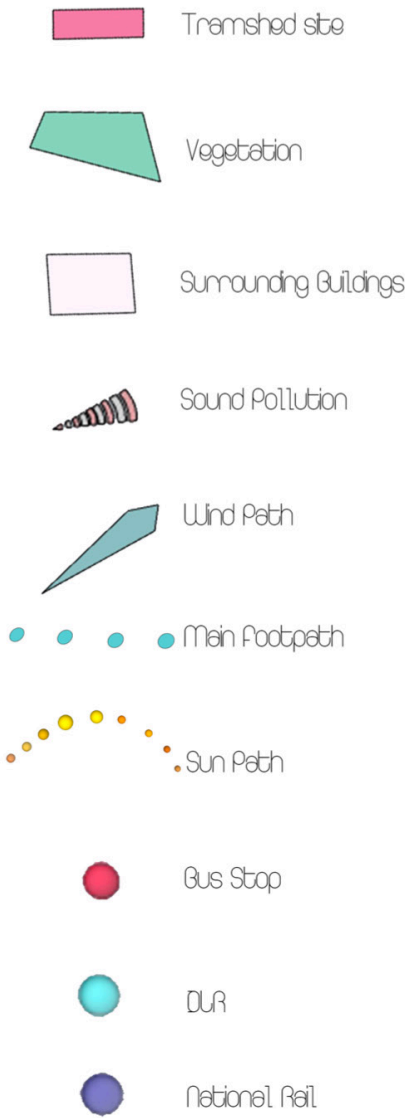

SITE ANALYSIS

PHYSICAL MODEL

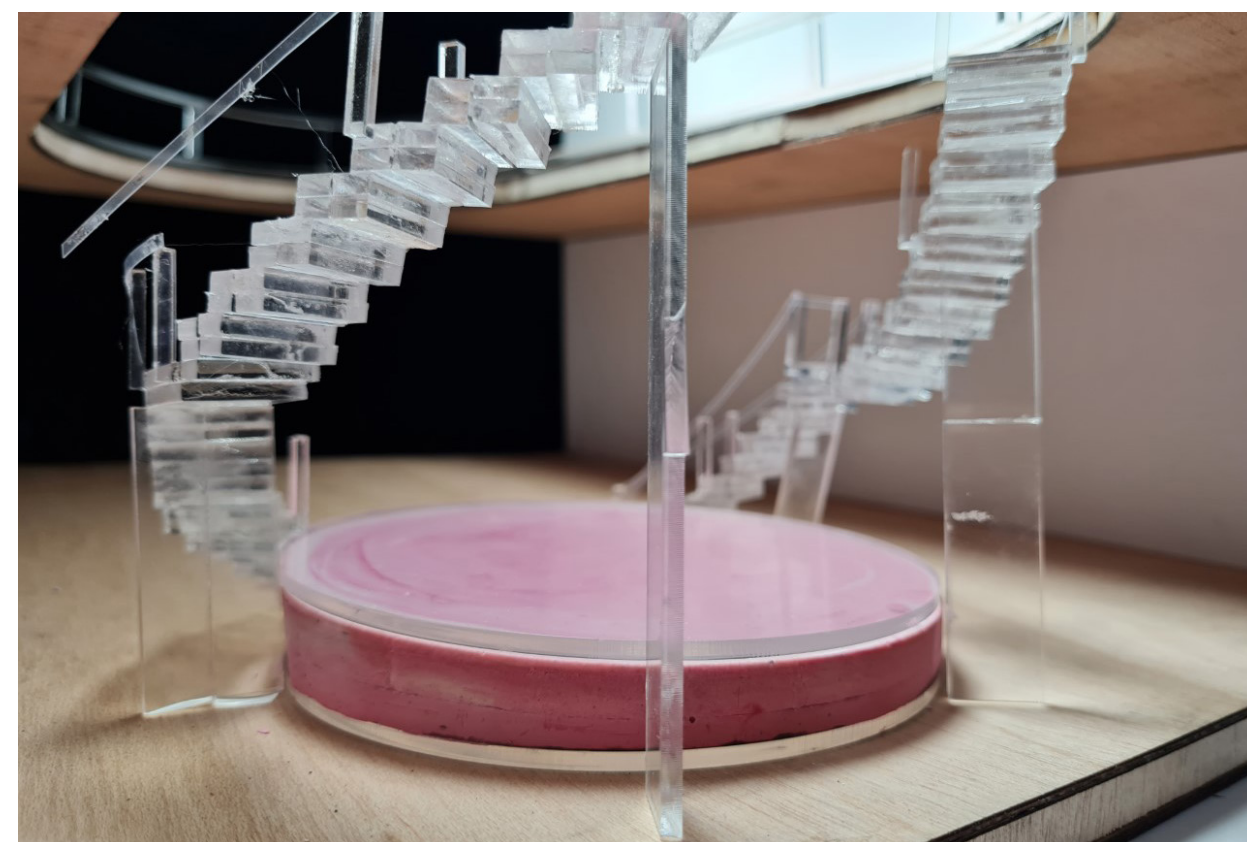
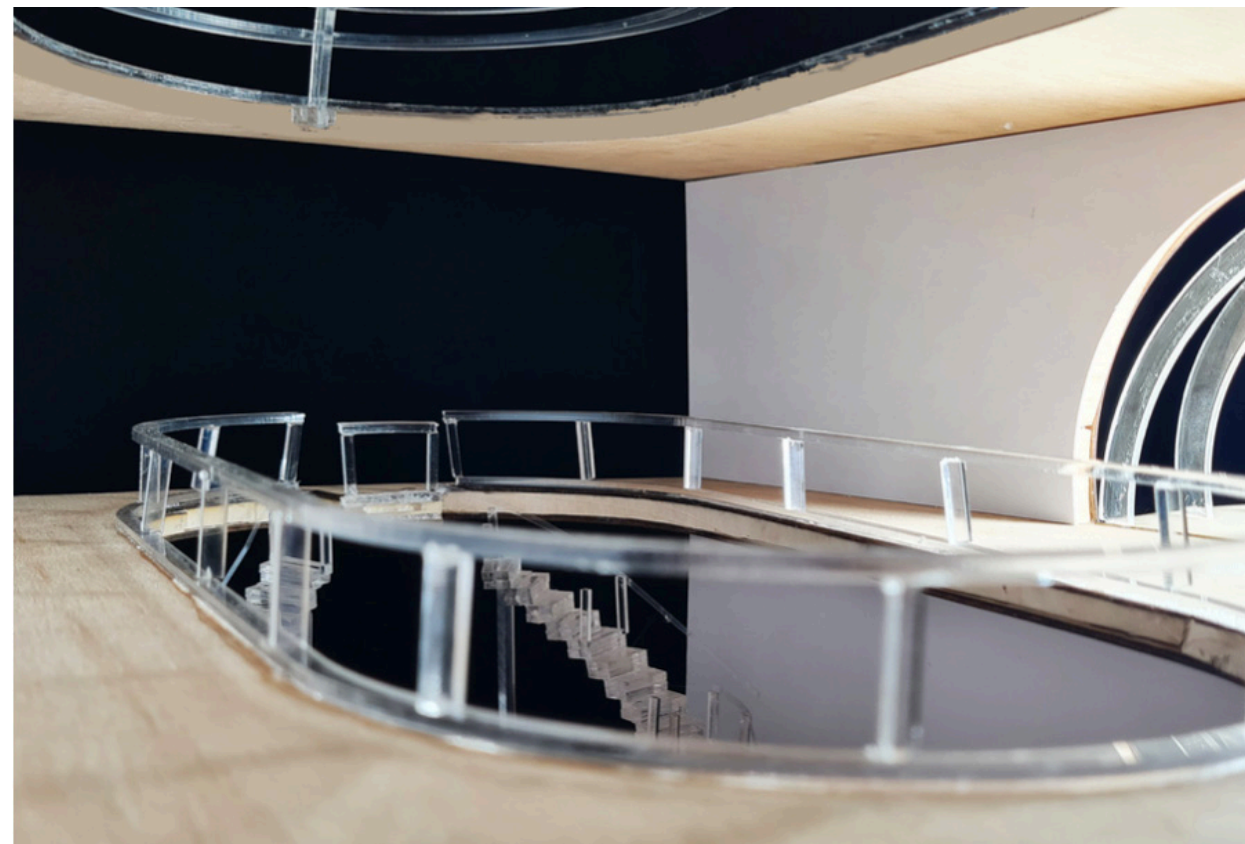
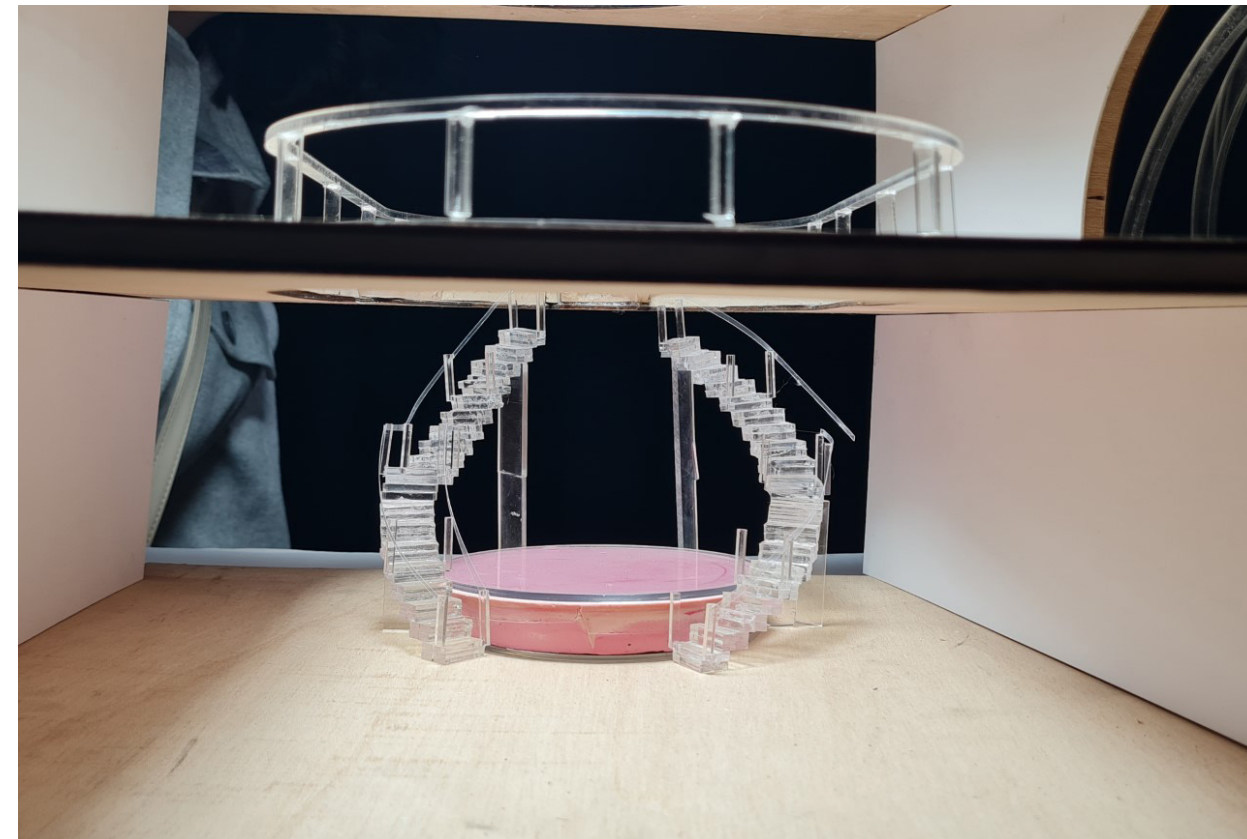
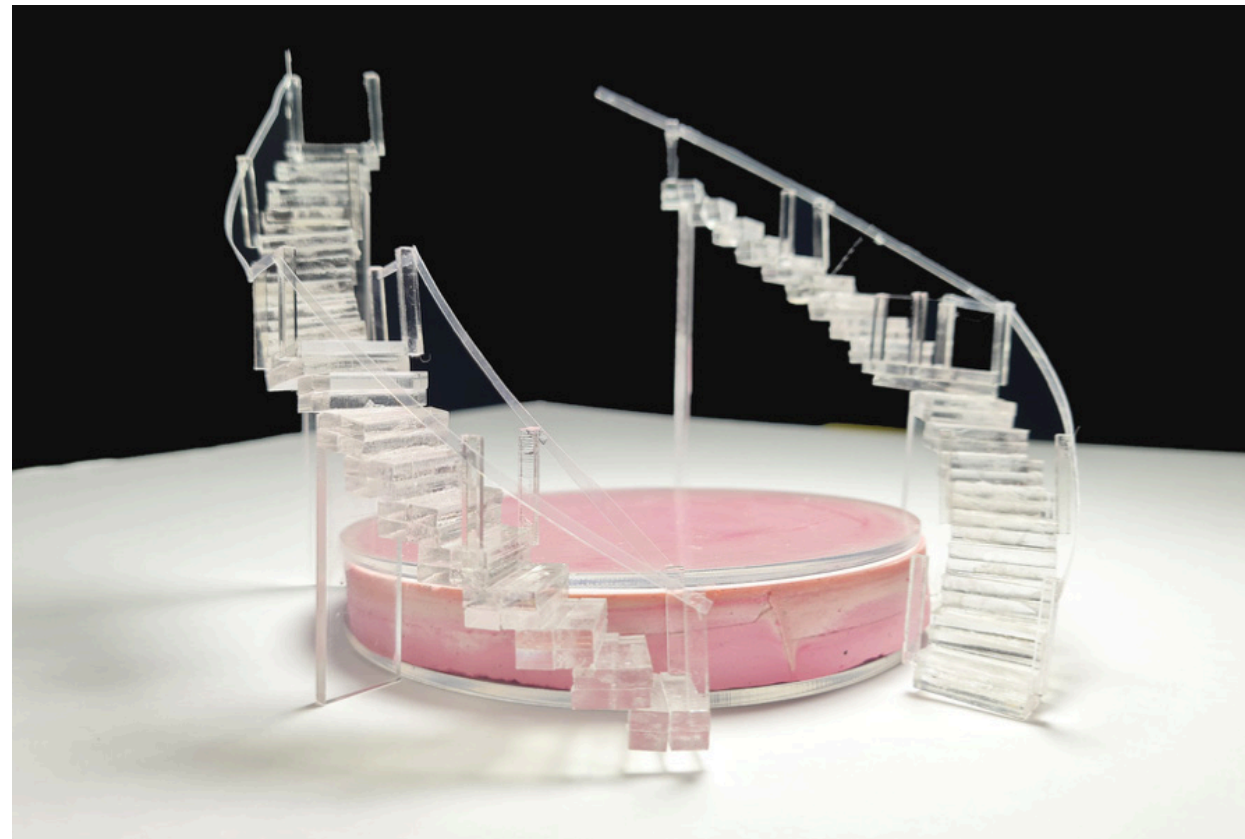

The physical model for this brief was made from white card, plywood and clear acrylic. I drew up the plans to lazer cut all the main elements of the model and using glue put the stairs and elements together by hand. I then photographed the model in an immersive photographic space, and used photoshop to render the model featuring my lamp and screen.